

CITY COUNCIL COMMUNICATION 97-152
MARCH 24, 1997 AGENDA

SUBJECT:	TYPE:	SUBMITTED BY:
TRAFFIC REGULATION CHANGES	◆ RESOLUTION ORDINANCE RECEIVE/FILE	HAROLD E. SMITH CITY ENGINEER

SYNOPSIS —

The following traffic regulation change has been reviewed by staff and is recommended for approval:

Request for *No Stopping-No Standing* parking restrictions on both sides of East Douglas Avenue in front of Douglas Elementary School.

FISCAL IMPACT —

N/A.

RECOMMENDATION —

Refer to Legal Department for preparation of ordinance revisions.

BACKGROUND —

The Office of Traffic and Transportation received a request to evaluate the existing signage in front of Douglas Elementary School between East 38th Street and East 39th Street. This request was based upon continued problems with parents stopping and picking up their children on the south side of Douglas Avenue. The Police Department requested that this area be signed as *No Stopping, No Standing*.

Staff has reviewed the existing signage and ordinance restrictions. We concur that no stopping, standing, or parking should take place on the south side of Douglas Avenue School from East 38th Street to Belmar Drive, as is currently signed on the north side of the street.

The existing ordinance for the south side of the street is inconsistent. From East 38th Street to East 38th Court, no ordinance exists. From East 38th Court to Belmar Drive, a *No Parking Any Time* ordinance exists. This action proposed simply applies a similar no stopping, no standing restriction to the south side as exists to the north side. Once approved, this will be signed accordingly.

These restrictions have been coordinated with the school principal and are in accordance with the plan for parental pickup and drop-off for this school. This original plan was worked out between staff and the school in January of 1987. A copy of this plan is attached. Once these actions are approved, staff will install the necessary signage.

These additional changes modify the ordinance to allow for parking on the north side of Douglas during non-school hours.

Another ordinance change must be made to establish no parking any time on the north side of Douglas Avenue between East 38th Street and Hubbell Avenue. This area is currently signed as no parking any time, but no language exists within the ordinance.

SEC. 27-2128. EAST DOUGLAS AVENUE---DELAWARE AVENUE TO EAST CITY LIMITS.

~~East Douglas Avenue, on the south side, from East Thirty-eighth Court to Belmar Drive, no parking any time.~~

East Douglas Avenue, on the north side, from East Thirty-eighth Street to a point 355 feet east thereof, no stopping or standing, 7:00 a.m. to 5:00 p.m., school days.

East Douglas Avenue, on the north side, from Belmar Drive to a point 225 feet east thereof, no stopping or standing, 7:00 a.m. to 5:00 p.m. school days.

East Douglas Avenue, on the south side, from East Thirty-eighth Street to Belmar Drive, no stopping or standing.

East Douglas Avenue, on the south side, from Belmar Drive to a point 50 feet east thereof, no parking any time.

East Douglas Avenue, on the north side, from Avenue Frederick M. Hubbell to East Thirty-eighth Street, no parking any time.

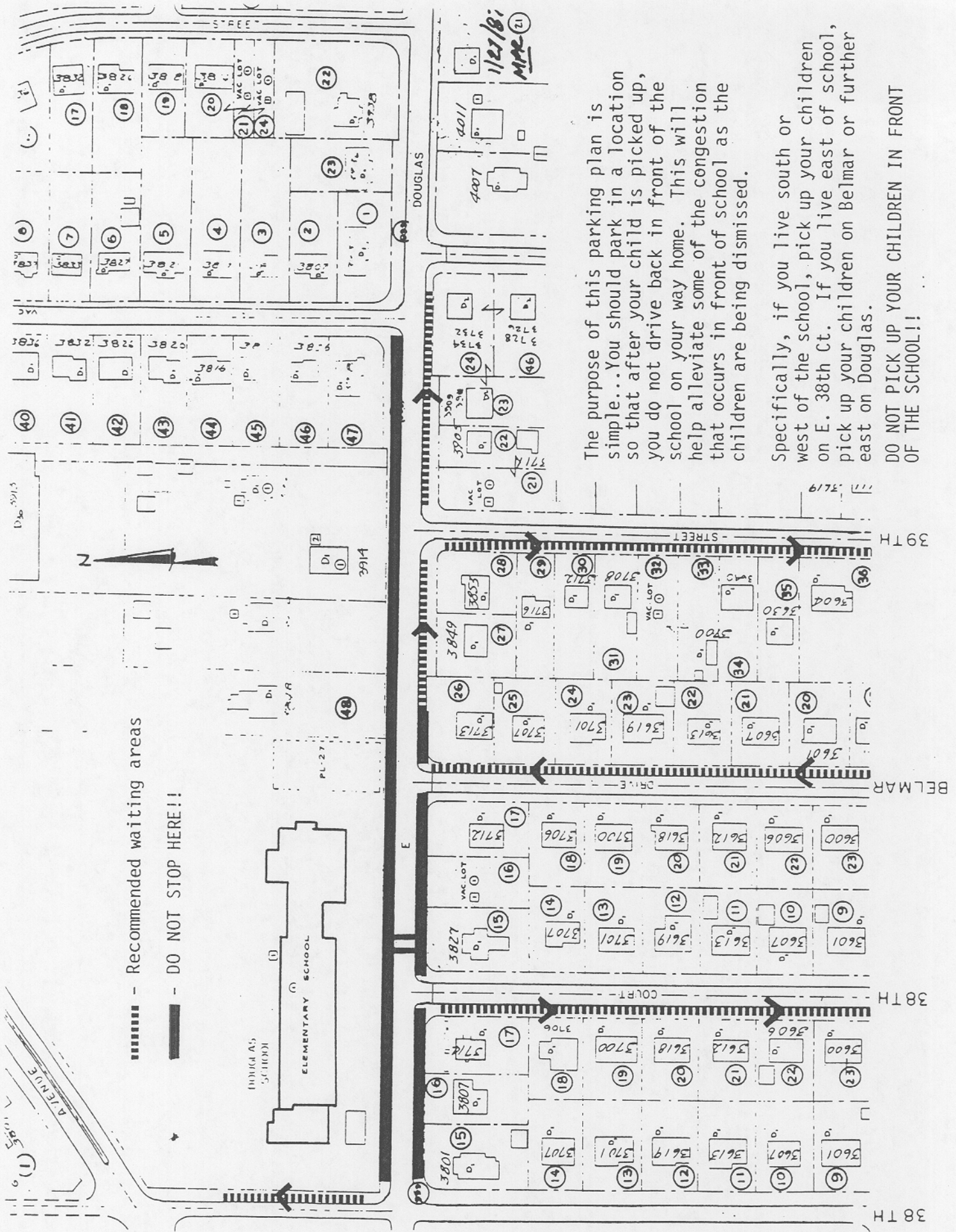

----- Recommended waiting areas
 ————— DO NOT STOP HERE!!

The purpose of this parking plan is simple... You should park in a location so that after your child is picked up, you do not drive back in front of the school on your way home. This will help alleviate some of the congestion that occurs in front of school as the children are being dismissed.

Specifically, if you live south or west of the school, pick up your children on E. 38th Ct. If you live east of school, pick up your children on Belmar or further east on Douglas.

DO NOT PICK UP YOUR CHILDREN IN FRONT OF THE SCHOOL!!

11/27/81
 MPR (21)

39TH

BELMAR

38TH

38TH