

DATE February 11, 2008

PUBLIC HEARING, APPROVING PLANS, SPECIFICATIONS, FORM OF CONTRACT DOCUMENTS, AND ENGINEER'S ESTIMATE ON SCOTT AVENUE BRIDGE OVER LEETOWN CREEKWAY; RECEIVE AND FILE BIDS; AND DESIGNATION OF LOWEST RESPONSIVE, RESPONSIBLE BIDDER AS STERNQUIST CONSTRUCTION INC., BRITT STERNQUIST, PRESIDENT, \$473,632.74

WHEREAS, on January 7, 2008, under Roll Call No. 08-018, plans, specifications, form of contract documents, and Jurisdictional Engineer's estimate of construction cost were filed with the City Clerk, for the construction of the following improvement:

Scott Avenue Bridge over Leetown Creekway, 12-2006-002

The improvement includes removal of the existing bridges and substructure, construction of a triple 12' x 6' x 64' long reinforced concrete box culvert, pavement removal, storm sewer and intakes, borrow and grading, PCC subbase, pavement, curb and gutter, sidewalks and driveways, HMA pavement and driveways, hydrant adjustment, sanitary manhole adjustments, fencing removal and installation, seeding, sodding, rip rap, construction survey, project sign, traffic control and mobilization; all in accordance with the contract documents including Plan File Nos. 478-137/168, in the 3100 to 3300 blocks of Scott Avenue, Des Moines, Iowa

WHEREAS, notice of the hearing on the plans, specifications, form of contract documents, and Engineer's estimate of construction cost was published as required by law.

WHEREAS, on January 29, 2008, sealed bids for said improvement were received and opened at a public meeting presided over by the Chief Civil Engineer, and the bid received from Sternquist Construction Inc., Britt Sternquist, President, 1110 N 14th Street, Indianola, IA, 50125, was read under advisement because Proposal Attachment: Part F - Additional Requirements, Item 1 - Identity of Subcontractors was not properly completed in that Sternquist Construction Inc. did not check the box to indicate that the Bidder does or does not intend to utilize subcontractors over \$25,000; however, Sternquist Construction Inc. did list three subcontractors in the space provided on the proposal to identify its subcontractors; and

WHEREAS, Engineering Department Staff contacted Mr. Brad Sternquist, of Sternquist Construction Inc. who stated that he listed the subcontractors over \$25,000 but inadvertently did not check the box on the proposal form, and that Sternquist Construction Inc. fully intends to use the subcontractors listed; and after further review, the Engineering and Legal Departments have determined that this was a minority irregularity that could be waived.

NOW, THEREFORE, BE IT RESOLVED BY THE CITY COUNCIL OF THE CITY OF DES MOINES, IOWA: That the hearing on the plans, specifications, form of contract documents, and Jurisdictional Engineer's estimate of construction cost for said improvement be closed; and that said plans, specifications, form of contract documents, and Jurisdictional Engineer's estimate of construction cost are hereby approved as the plans, specifications, form of contract documents, and Jurisdictional Engineer's estimate of construction cost for said improvement.

DATE February 11, 2008

BE IT FURTHER RESOLVED: That the City Council concurs in the recommendation of the Engineering Department and the Legal Department regarding the bid submitted by Sternquist Construction Inc., waives said minor irregularity, and hereby receives the bid submitted by Sternquist Construction Inc..

BE IT FURTHER RESOLVED: That sealed bids for said improvement were submitted by the following bidders:

Sternquist Construction Inc.	Indianola, IA Bid read under advisement
Jenco Construction Inc.	Des Moines, IA
Herberger Construction Co., Inc.	Indianola, IA
Iowa Bridge & Culvert, LC	Washington, IA

which were received and opened at a public meeting presided over by the Jurisdictional Engineer in the City Council Chambers, 2nd Floor, City Hall, 400 Robert D. Ray Drive, Des Moines, Iowa at 11:00 a.m. on January 29, 2008. Said bids and the attached tabulation of bids for said improvement be and are hereby received and filed.

BE IT FURTHER RESOLVED: That the Jurisdictional Engineer has determined that the lowest responsive, responsible bid for the construction of said improvement was submitted by Sternquist Construction Inc., Britt Sternquist, President, 1110 N 14th Street, Indianola, IA, 50125 in the amount of \$473,632.74, and said bid be and the same is hereby accepted.

BE IT FURTHER RESOLVED: That the bid security of the unsuccessful bidders be and is hereby authorized and directed to be returned.

DATE February 11, 2008

BE IT FURTHER RESOLVED: That the Jurisdictional Engineer is hereby directed to secure execution by the lowest responsible, responsive Bidder and its surety of the contract documents in the form heretofore approved by this Council; that the Jurisdictional Engineer is directed to thereafter present said contract documents to this Council for approval and authorization to the Mayor to sign; and that no contract shall be deemed to exist between the City of Des Moines and said Bidder until said contract has been executed by the Bidder, and shall have been approved by this Council and executed by the Mayor and attested to by the City Clerk.

(City Council Communication Number 08-070 attached.)

Moved by _____ to adopt.

FORM APPROVED:

FUNDS AVAILABLE

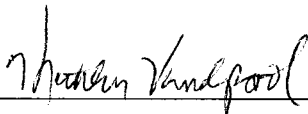

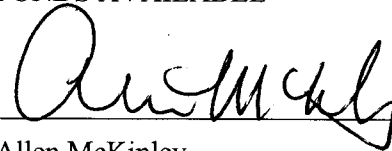

Kathleen Vanderpool
Deputy City Attorney

Allen McKinley
Des Moines Finance Director

Funding Source: 2007-2008 CIP, Page Bridge-13, Scott Avenue Bridge over Leetown Creekway, BRV037,
Being: Gaming Monies from the Agreement with Polk County and The Racing Association of Central Iowa

COUNCIL ACTION	YEAS	NAYS	PASS	ABSENT
COWNIE				
COLEMAN				
HENSLEY				
KIERNAN				
MAHAFFEY				
MEYER				
VLASSIS				
TOTAL				

MOTION CARRIED

APPROVED

Mayor

I, Diane Rauh, City Clerk of said City Council, hereby certify that at a meeting of the City Council, held on the above date, among other proceedings the above was adopted.

IN WITNESS WHEREOF, I have hereunto set my hand and affixed my seal the day and year first above written.

City Clerk

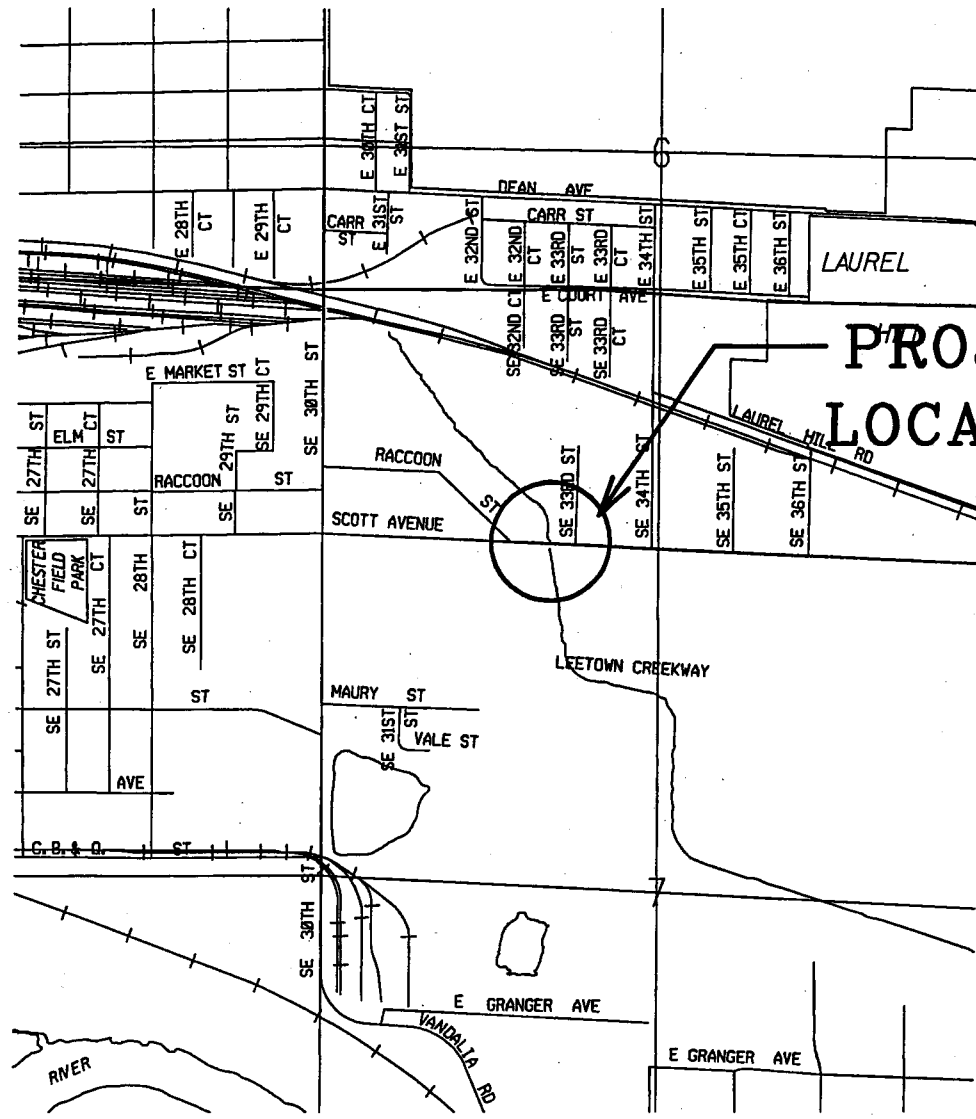

**PROJECT
LOCATION**

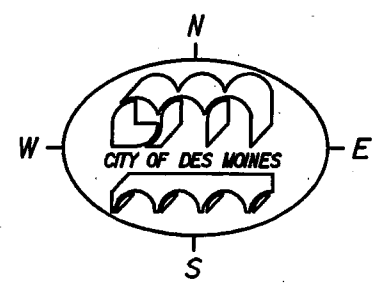

**SCOTT AVENUE OVER LEETOWN
CREEKWAY BRIDGE REPLACEMENT
ACTIVITY ID 12-2006-002**

TABULATED BY: Jon Fussell APPROVED BY: *John A. McKen*
CHECKED BY: *M. HUTCHENS*

CONTRACTOR'S BID TABULATION
SCOTT AVENUE OVER LEETOWN CREEKWAY BRIDGE REPLACEMENT

ESTIMATE

REVISED PER ADDENDUM NO. 1

ITEM	DESCRIPTION	QUANTITY	UNIT	PRICE	AMOUNT	STERNQUIST CONSTRUCTION INDIANOLA, IA		JENCO CONSTRUCTION DES MOINES, IA		HERBERGER CONSTRUCTION CO., INC INDIANOLA, IA		IOWA BRIDGE & CULVERT, LLC WASHINGTONIA	
						BID SECURITY 10% BID BOND BID PRICE	BID SECURITY 10% BID BOND BID PRICE	BID SECURITY 10% BID BOND BID PRICE	BID SECURITY 10% BID BOND BID PRICE	BID SECURITY 10% BID BOND BID PRICE	BID SECURITY 10% BID BOND BID PRICE		
1	Mobilization	1 LS		\$50,000.00	\$50,000.00	\$25,000.00	\$25,000.00	\$25,000.00	\$25,000.00	\$28,500.00	\$28,500.00	\$50,000.00	\$50,000.00
2	Traffic Control	1 LS		\$9,921.40	\$9,921.40	\$2,850.00	\$4,300.00	\$4,300.00	\$4,300.00	\$5,500.00	\$5,500.00	\$2,850.00	\$2,850.00
3	Clearing and Grubbing	1 LS		\$15,000.00	\$15,000.00	\$10,600.00	\$10,600.00	\$11,000.00	\$11,000.00	\$11,500.00	\$11,500.00	\$11,000.00	\$11,000.00
4	Pavement Removal	1242 SY		\$10.00	\$12,420.00	\$3.25	\$4,036.50	\$14.00	\$17,388.00	\$3.40	\$4,222.80	\$3.25	\$4,036.50
5	Sidewalk Removal	161 SY		\$10.00	\$1,610.00	\$2.98	\$479.78	\$14.00	\$2,254.00	\$3.10	\$499.10	\$3.00	\$483.00
6	Removal of Existing Bridge	1 LS		\$10,000.00	\$10,000.00	\$15,000.00	\$15,000.00	\$15,600.00	\$15,600.00	\$11,000.00	\$11,000.00	\$17,500.00	\$17,500.00
7	Removal of Storm Sewer Pipe	325 LF		\$15.00	\$4,875.00	\$10.00	\$3,250.00	\$17.00	\$5,525.00	\$10.50	\$3,412.50	\$10.00	\$3,250.00
8	Topsoil Strip, Salvage, and Respread	322 CY		\$5.00	\$1,610.00	\$6.50	\$2,093.00	\$9.00	\$2,898.00	\$6.75	\$2,173.50	\$6.50	\$2,093.00
9	Excavation, Class 10, Roadway	46 CY		\$4.00	\$184.00	\$5.25	\$241.50	\$7.00	\$322.00	\$5.50	\$253.00	\$5.25	\$241.50
10	Excavation, Class 10, Channel	150 CY		\$4.00	\$600.00	\$12.00	\$1,800.00	\$7.00	\$1,050.00	\$12.40	\$1,860.00	\$8.00	\$1,200.00
11	Modified Subbase	436 SY		\$10.00	\$4,360.00	\$26.00	\$11,336.00	\$25.00	\$10,900.00	\$27.00	\$11,772.00	\$26.00	\$11,336.00
12	Borrow	1512 CY		\$9.00	\$13,608.00	\$11.25	\$17,010.00	\$14.00	\$21,168.00	\$12.00	\$18,144.00	\$11.25	\$17,010.00
13	Excavation, Class 20	990 CY		\$15.00	\$14,850.00	\$10.00	\$9,900.00	\$10.00	\$9,900.00	\$15.00	\$14,850.00	\$17.00	\$17,010.00
14	Compaction w/Moisture & Density Control	3072 CY		\$3.00	\$9,216.00	\$1.25	\$3,840.00	\$5.00	\$15,360.00	\$1.30	\$3,993.60	\$1.25	\$3,840.00
15	Subgrade Preparation	2261 SY		\$2.50	\$5,652.50	\$2.25	\$5,087.25	\$2.75	\$6,217.75	\$2.40	\$5,426.40	\$2.25	\$5,652.50
16	Storm Sewer, 15" RCP Class III	240 LF		\$80.00	\$19,200.00	\$69.00	\$16,560.00	\$39.00	\$9,360.00	\$72.00	\$17,280.00	\$60.00	\$14,400.00
17	Storm Sewer, 18" RCP Class III	38 LF		\$100.00	\$3,800.00	\$127.00	\$4,826.00	\$44.00	\$1,672.00	\$130.00	\$4,940.00	\$75.00	\$2,850.00
18	15" RCP FES w/ Footing and Apron Guard	2 EA		\$2,500.00	\$5,000.00	\$1,365.00	\$2,730.00	\$1,500.00	\$3,000.00	\$1,450.00	\$2,900.00	\$2,000.00	\$4,000.00
19	Connection to RCB	2 EA		\$500.00	\$1,000.00	\$1,300.00	\$2,600.00	\$2,500.00	\$5,000.00	\$1,350.00	\$2,700.00	\$750.00	\$1,500.00
20	Drill and Dowel Pavement	31 LF		\$5.00	\$155.00	\$3.55	\$110.05	\$10.50	\$325.50	\$3.75	\$116.25	\$3.60	\$111.60
21	Pavement, Non-Reinforced PCC Class C, 8"	1395 SY		\$45.00	\$62,775.00	\$32.50	\$45,337.50	\$38.85	\$54,195.75	\$33.70	\$47,011.50	\$32.50	\$45,337.50
22	Pavement Reinforcing Steel, Epoxy Coated	386 SY		\$15.00	\$5,790.00	\$18.50	\$7,141.00	\$24.00	\$9,264.00	\$19.00	\$7,334.00	\$18.50	\$7,141.00
23	PCC Curb and Gutter, 3"	82 LF		\$20.00	\$1,640.00	\$25.00	\$2,050.00	\$23.30	\$4,288.60	\$26.00	\$2,132.00	\$25.00	\$2,050.00
24	Pavement, HMA (300K ESAL), 8"	361 SY		\$135.00	\$48,735.00	\$50.00	\$18,050.00	\$55.65	\$20,089.65	\$52.00	\$18,772.00	\$50.00	\$18,050.00
25	Pavement, Driveway, PCC 6"	92 SY		\$35.00	\$3,220.00	\$37.50	\$3,450.00	\$40.00	\$3,680.00	\$39.00	\$3,588.00	\$37.50	\$3,450.00
26	Pavement, Driveway, HMA 6"	41 SY		\$35.00	\$1,435.00	\$115.00	\$4,715.00	\$128.00	\$5,248.00	\$120.00	\$4,920.00	\$115.00	\$4,715.00
27	Granular Surfacing, Driveway, 6"	75 TON		\$30.00	\$2,250.00	\$27.00	\$2,025.00	\$22.00	\$1,650.00	\$28.00	\$2,100.00	\$27.00	\$2,025.00
28	Sidewalk, 4" PCC	1952 SF		\$4.00	\$7,808.00	\$3.00	\$5,856.00	\$4.50	\$8,784.00	\$3.20	\$6,246.40	\$3.00	\$5,856.00
29	Intake, Type M-A	1 EA		\$2,200.00	\$2,200.00	\$1,750.00	\$1,750.00	\$2,000.00	\$2,000.00	\$1,800.00	\$1,800.00	\$2,200.00	\$2,200.00
30	Intake, Type M-C	1 EA		\$3,500.00	\$3,500.00	\$3,500.00	\$3,500.00	\$3,000.00	\$3,000.00	\$3,600.00	\$3,600.00	\$3,000.00	\$3,000.00
31	Intake, Type M-D	2 EA		\$4,000.00	\$8,000.00	\$2,200.00	\$4,400.00	\$4,000.00	\$6,000.00	\$2,300.00	\$4,600.00	\$3,500.00	\$7,000.00
32	Storm Sewer Manhole, Type M-B	1 EA		\$4,000.00	\$4,000.00	\$5,889.00	\$5,889.00	\$3,000.00	\$3,000.00	\$6,100.00	\$6,100.00	\$2,500.00	\$2,500.00
33	Storm Sewer, Special Drop Structure	1 LS		\$2,000.00	\$2,000.00	\$1,703.00	\$1,703.00	\$1,400.00	\$1,400.00	\$1,800.00	\$1,800.00	\$2,500.00	\$2,500.00
34	Structural Concrete (RCB Culvert)	365.1 CY		\$304.00	\$110,990.40	\$295.00	\$107,704.50	\$290.00	\$105,879.00	\$400.00	\$146,040.00	\$342.00	\$124,864.20
35	Reinforcing Steel (RCB Culvert)	57833 LBS		\$0.80	\$46,266.40	\$0.82	\$47,423.06	\$0.70	\$40,483.10	\$0.90	\$52,049.70	\$1.00	\$57,833.00
36	Sanitary Manhole Adjustment, Minor	1 EA		\$750.00	\$750.00	\$930.00	\$930.00	\$750.00	\$750.00	\$1,000.00	\$1,000.00	\$750.00	\$750.00
37	Sodding	277 SQ		\$35.00	\$9,695.00	\$56.00	\$15,512.00	\$30.05	\$8,323.85	\$32.00	\$8,864.00	\$31.00	\$8,587.00
38	Seeding, Fertilization - Urban	0.1 AC		\$1,500.00	\$150.00	\$3,245.00	\$3,245.00	\$969.70	\$969.70	\$3,300.00	\$3,300.00	\$3,245.00	\$3,245.00
39	Mulching	1 AC		\$500.00	\$500.00	\$350.00	\$350.00	\$501.00	\$501.00	\$360.00	\$360.00	\$350.00	\$350.00
40	Temporary Seeding	0.9 AC		\$500.00	\$450.00	\$225.00	\$225.00	\$433.00	\$389.70	\$260.00	\$234.00	\$250.00	\$225.00

53

53

ITEM	DESCRIPTION	QUANTITY	UNIT PRICE	AMOUNT	UNIT PRICE	AMOUNT	UNIT PRICE	AMOUNT	UNIT PRICE	AMOUNT	UNIT PRICE	AMOUNT
41	Silt Fence	1200 LF	\$2.00	\$2,400.00	\$1.60	\$1,920.00	\$1.95	\$2,340.00	\$1.65	\$1,980.00	\$2.50	\$3,000.00
42	Remove Silt Fence	1200 LF	\$2.00	\$2,400.00	\$0.10	\$120.00	\$0.12	\$144.00	\$0.11	\$132.00	\$0.10	\$120.00
43	Erosion Control	1 LS	\$8,000.00	\$8,000.00	\$1,800.00	\$1,800.00	\$7,000.00	\$7,000.00	\$2,000.00	\$2,000.00	\$5,000.00	\$5,000.00
44	Rip Rap, Class E	508 TN	\$40.00	\$20,320.00	\$50.00	\$25,400.00	\$35.00	\$17,780.00	\$37.00	\$18,796.00	\$50.00	\$25,400.00
45	Chain Link Fence, Vinyl Coated	1.4 STA	\$6,000.00	\$8,400.00	\$4,000.00	\$5,600.00	\$4,452.00	\$6,232.80	\$4,200.00	\$5,880.00	\$4,000.00	\$5,600.00
46	Fence, Chain Link, 48" Height, Remove and Replace	2.47 STA	\$2,000.00	\$4,940.00	\$690.00	\$2,198.30	\$890.50	\$2,446.54	\$925.00	\$2,284.75	\$890.00	\$2,198.30
47	Ornamental Metal Railing	79 LF	\$90.00	\$7,110.00	\$75.70	\$5,980.30	\$84.25	\$6,655.75	\$79.00	\$6,241.00	\$75.70	\$5,980.30
48	Temporary Fence	300 LF	\$3.00	\$900.00	\$5.05	\$1,515.00	\$5.60	\$1,680.00	\$5.25	\$1,575.00	\$5.05	\$1,515.00
49	Construction Survey	1 LS	\$5,000.00	\$5,000.00	\$3,975.00	\$3,975.00	\$4,425.00	\$4,425.00	\$6,100.00	\$6,100.00	\$3,975.00	\$3,975.00
50	Project Sign, Large	1 LS	\$1,200.00	\$1,200.00	\$1,000.00	\$1,000.00	\$751.00	\$751.00	\$1,800.00	\$1,800.00	\$1,000.00	\$1,000.00
51	Sanitary Manhole Adjustment, Major	1 EA	\$1,500.00	\$1,500.00	\$1,360.00	\$1,360.00	\$1,800.00	\$1,800.00	\$1,500.00	\$1,500.00	\$2,000.00	\$2,000.00
52	Relocate Fire Hydrant Assembly	1 EA	\$3,500.00	\$3,500.00	\$2,653.00	\$2,653.00	\$1,500.00	\$1,500.00	\$2,100.00	\$2,100.00	\$3,500.00	\$3,500.00
53	Fence, Chain Link, 60" Height, Remove and Replace	2.45 STA	\$2,500.00	\$6,125.00	\$990.00	\$2,425.50	\$1,101.85	\$2,699.63	\$1,100.00	\$2,695.00	\$990.00	\$2,425.50
TOTAL CONSTRUCTION COST				\$577,011.70		\$473,632.74		\$503,591.22		\$521,008.50		\$530,091.15
PERCENT OF ENGINEER'S ESTIMATE						-17.92%		-12.72%		-9.71%		-8.13%

BID READ UNDER
 ADVISEMENT
 Bidder Did Not Mark Box
 To Indicate Subcontractors
 on Proposal Attachment
 Part F, Item 1; However,
 They Did Indicate
 Subcontractors In The
 Space Provided