

★ **Roll Call Number**

Agenda Item Number

54

Date March 10, 2008

An Ordinance entitled, "AN ORDINANCE to amend the Municipal Code of the City of Des Moines, Iowa, 2000, adopted by Ordinance No. 13,827, passed June 5, 2000, and amended by Ordinance No. 13,948 passed May 7, 2001, and Ordinance No. 13,997 passed September 24, 2001, and Ordinance No. 14,244 passed June 23, 2003, and Ordinance No. 14,428 passed April 11, 2005 and Ordinance No. 14,476 passed August 8, 2005 by amending Sections 114-361.06, 114-2823, 114-3274, 114-3578 and 114-3760 thereof, relating to traffic and vehicle regulations",

which was considered and voted upon for the first time under Roll Call No. 08- 244 of February 11, 2008, and considered and voted upon for the second time under Roll Call No. 08- 327 of February 25, 2008, again presented.

Moved by _____ that this ordinance do now pass.

ORDINANCE NO. _____

COUNCIL ACTION	YEAS	NAYS	PASS	ABSENT
COWNIE				
COLEMAN				
HENSLEY				
KIERNAN				
MAHAFFEY				
MEYER				
VLASSIS				
TOTAL				

CERTIFICATE

I, DIANE RAUH, City Clerk of said City hereby certify that at a meeting of the City Council of said City of Des Moines, held on the above date, among other proceedings the above was adopted.

IN WITNESS WHEREOF, I have hereunto set my hand and affixed my seal the day and year first above written.

MOTION CARRIED APPROVED

Mayor

City Clerk



**Council
Communication**
Office of the City Manager

Date February 11, 2008

Agenda Item No. 41
 Roll Call No. 08- 244 08/327
 Communication No. 08-069
 Submitted by: Jeb E. Brewer, P.E.
 City Engineer

5442

AGENDA HEADING:

Amending Chapter 114 of the Municipal Code regarding traffic regulation changes as follows:

- A. Parking Revisions - Public Library lots.
- B. Parking Revisions - West Side of 24th Street between Carpenter and University.
- C. Parking Restriction - Both Sides of Pleasant View Drive at Dead-End East of SW 5th Street.
- D. Parking Restriction - North Side of East Watrous Avenue West of Indianola Avenue.
- E. Request for Loading Zone – 1500 Block of East Grand Avenue.

SYNOPSIS:

Approval of the Traffic and Transportation Division staff recommendations, including first reading of the Ordinance regarding the traffic regulation changes.

FISCAL IMPACT:

Amount: Minor costs.

Funding Source: 2007-2008 Operating Budget, Page 133, Engineering Department Traffic & Transportation – Sign Installation and Maintenance, ENG100413.

ADDITIONAL INFORMATION:

- A. The Traffic and Transportation Division has worked with the Library Director regarding designating parking restrictions in the underground library parking lot at the new main library. The current section of the municipal code that regulates parking at the main library still refers to the location of the old main library at 2nd Avenue and Walnut Street.

The following changes to the municipal code are necessary to provide for the operation of the underground parking area at the new central library:

Sec. 114-361.06. Public Library lots.

(a) No person shall park a vehicle in the ~~southeast~~ reserved section of the main library underground parking lot at First Tenth Street and Walnut Grand Avenue without ~~displaying an authorized city parking permit which is specifically designated~~ authorization granted by the library director. ~~All parking spaces in this area are reserved for official library vehicles only. All non-reserved parking spaces in this area are public parking spaces and are restricted to two hour parking.~~

- B. The Police Department Traffic Unit is moving to a new location on 24th Street in the Drake University area, and because of limited off-street parking has requested that an area be designated on the west side of 24th Street for a limited amount of official police vehicles and also a short-term parking area for customers. Traffic and Transportation Division staff have reviewed this request and recommend approval.

The following changes to the municipal code are necessary to implement these parking restrictions:

Sec. 114-2823. Twenty-fourth Street--Ingersoll Avenue to Bennett Avenue.

Twenty-fourth Street, on the west side, from University Avenue to a point 50 feet south of Carpenter Avenue 240 feet north thereof, no parking any time.

Twenty-fourth Street, on the west side, from a point 50 feet south of Carpenter Avenue to a point 50 feet north of Carpenter Avenue, no parking any time 240 feet north of University Avenue to a point 60 feet north thereof, two-hour parking.

Twenty-fourth Street, on the west side, from a point 300 feet north of University Avenue to a point 50 feet north thereof, no parking anytime.

Twenty-fourth Street, on the west side, from a point 25 feet south of Carpenter Avenue to a point 75 feet south thereof, reserved parking for marked police vehicles only.

Twenty-fourth Street, on the west side, from Carpenter Avenue to a point 25 feet south thereof, no parking anytime.

- C. The Solid Waste Division of the Public Works Department has requested a parking restriction at the end of the dead-end section of Pleasant View Drive east of Southwest Fifth Street to allow solid waste vehicles to turn around. Staff has reviewed this request and recommends that parking be restricted on both sides of the street for a distance of 60' at this dead-end.

The following change to the municipal code is necessary to implement this parking restriction:

Sec. 114-3578. Pleasant View Drive—South Union Street to Southwest Eighteenth Street.

Pleasant View Drive, on both sides, from the dead end east of Southwest Fifth Street to a point 60 feet west thereof, no parking any time.

- D. The Traffic and Transportation Division has reviewed on-street parking on East Watrous Avenue near Jackson Elementary School. Currently, parking is prohibited on the south side of the street,

but is allowed on the north side. However, there is a curve where Watrous connects to Indianola Avenue. Parked vehicles on the north side of Watrous at this curve block visibility for traffic and create congestion at the intersection where students cross Indianola Avenue. Staff recommends that parking be prohibited on Watrous through this curve to enhance safety for both motorists and students.

The following change to the municipal code is necessary to restrict parking at this curve:

Sec. 114-3760. East Watrous Avenue—South Union Street to Hartford Avenue.

East Watrous Avenue, on the north side, from Indianola Avenue to a point 180 feet west thereof, no parking any time.

- E. The Traffic and Transportation Division has received a request from the owners of the commercial buildings located at 1514-1552 East Grand Avenue to designate a commercial loading zone. These buildings house a variety of retail businesses, including a grocery store at 1524 East Grand, and the loading zone would provide a convenient location for deliveries to serve these businesses. Staff has reviewed this location and recommends approval of the request for a loading zone.

The following changes to the municipal code are necessary to designate this loading zone:

Sec. 114-3274. East Grand Avenue--East Fifteenth Street to East Eighteenth Street.

East Grand Avenue, on the north side, from East Fifteenth Street to a point ~~460~~ 300 feet east thereof, no parking any time.

East Grand Avenue, on the north side, from a point ~~460~~ 300 feet east of East Fifteenth Street to a point 50 feet west of East Sixteenth Street, no parking 7:00 a.m. to 9:00 a.m.

East Grand Avenue, on the north side, from a point ~~460~~ 300 feet east of East Fifteenth Street to a point 50 feet west of East Sixteenth Street, no parking 4:00 p.m. to 6:00 p.m.

East Grand Avenue, on the north side, from a point ~~460~~ 300 feet east of East Fifteenth Street to a point ~~35~~ 50 feet east thereof, commercial loading zone, 9:00 a.m. to 4:00 p.m.

East Grand Avenue, on the north side, from a point ~~495~~ 350 feet east of East Fifteenth Street to a point 50 feet west of East Sixteenth Street, two-hour parking 9:00 a.m. to 4:00 p.m.

PREVIOUS COUNCIL ACTION(S): NONE

BOARD/COMMISSION ACTION(S): NONE

ANTICIPATED ACTIONS AND FUTURE COMMITMENTS:

Second and third readings of Ordinance.

08-244
4108/307
42
54

SUMMARY OF ORDINANCE NO. _____

AN ORDINANCE to amend the Municipal Code of the City of Des Moines, Iowa, 2000, adopted by Ordinance No. 13,827, passed June 5, 2000, as heretofore amended, by amending Chapter 114 Traffic & Vehicle Regulations as summarized below. The complete text of the ordinance is available in the City of Des Moines City Clerk's Office, 400 Robert D. Ray Drive, Des Moines, Iowa, or on the City of Des Moines' website at www.dmgov.org.

DES MOINES TRAFFIC REGULATION CHANGES

Amending Chapter 114 of the Municipal Code regarding traffic regulation changes as follows:

- A. Parking Revisions - Public Library Lots.
- B. Parking Revisions - West Side of 24th Street between Carpenter and University.
- C. Parking Restriction - Both Sides of Pleasant View Drive at Dead-End East of SW 5th Street.
- D. Parking Restriction - North Side of East Watrous Avenue West of Indianola Avenue.
- E. Request for Loading Zone - 1500 Block of East Grand Avenue.

FORM APPROVED:

Katharine Massier, Assistant City Attorney

T.M. Franklin Cownie, Mayor

Attest:

I, Diane Rauh, City Clerk of the City of Des Moines, Iowa, hereby certify that the above and foregoing is a summary of Ordinance No. _____, passed by the City Council of said City on _____, signed by the Mayor on _____, and published as provided by law in the Business Record on _____. Authorized by Publication Order No. _____.

Diane Rauh, City Clerk

08-244
41 JC
54

ORDINANCE NO. _____

AN ORDINANCE to amend the Municipal Code of the City of Des Moines, Iowa, 2000, adopted by Ordinance No. 13,827, passed June 5, 2000, and amended by Ordinance No. 13,948 passed May 7, 2001, and Ordinance No. 13,997 passed September 24, 2001, and Ordinance No. 14,244 passed June 23, 2003, and Ordinance No. 14,428 passed April 11, 2005 and Ordinance No. 14,476 passed August 8, 2005 by amending Sections 114-361.06, 114-2823, 114-3274, 114-3578 and 114-3760 thereof, relating to traffic and vehicle regulations.

Be It Ordained by the City Council of the City of Des Moines, Iowa:

Section 1. That the Municipal Code of the City of Des Moines, Iowa, 2000, adopted by Ordinance No. 13,827, passed June 5, 2000, and amended by Ordinance No. 13,948 passed May 7, 2001, and Ordinance No. 13,997 passed September 24, 2001, and Ordinance No. 14,244 passed June 23, 2003, and Ordinance No. 14,428 passed April 11, 2005 and Ordinance No. 14,476 passed August 8, 2005 is hereby amended by amending Sections relating to 114-361.06, 114-2823, 114-3274, 114-3578 and 114-3760 thereof, relating to traffic and vehicle regulations, as follows:

Sec. 114-361.06. Public library lots.

- (a) No person shall park a vehicle in the ~~southeast~~underground reserved section of the main library parking lot at ~~First~~Tenth Street and ~~Walnut~~Grand Avenue without ~~displaying an authorized city parking permit which is specifically designated~~authorization granted by the library director. ~~All parking spaces in this area are reserved for official library vehicles only.~~All non-reserved parking spaces in this area are considered public parking spaces and is restricted to two hour parking only
- (b) No person shall park a vehicle in the paved parking lot immediately south of the branch library at 3516 Fifth Avenue after business hours. This lot is reserved for library customers only during business hours.
- (c) No person shall park a vehicle in the paved parking lot adjacent to the branch library at 5000 Franklin Avenue after

business hours. This lot is reserved for library customers only during business hours.

- (d) No person shall park a vehicle in the paved parking lots immediately adjacent to the mid-city branch library at 1305 University Avenue and directly south of the branch library on the south side of University after business hours. These lots are reserved for library customers only during business hours.
- (e) A person who violates any provision of this section shall pay a fine of \$15.00.

Sec. 114-2823. Twenty-fourth Street--Ingersoll Avenue to Bennett Avenue.

Twenty-fourth Street, on the east side, from Ingersoll Avenue to Olive Street, no parking any time.

Twenty-fourth Street, on the west side, from Ingersoll Avenue to a point 200 feet north of Woodland Avenue, no parking any time.

Twenty-fourth Street, on the east side, from Rollins Avenue to Cottage Grove Avenue, no parking any time.

Twenty-fourth Street, on the west side, from a point 50 feet south of Pleasant Street to a point 50 feet north of Pleasant Street.

Twenty-fourth Street, on the west side, from a point 50 feet south of Center Street to a point 50 feet north of Center Street.

Twenty-fourth Street, on the west side, from a point 50 feet south of Rollins Avenue to a point 50 feet north of Rollins Avenue.

Twenty-fourth Street, on the west side, from Olive Street north to the dead end at I-235, no parking any time.

Twenty-fourth Street, on both sides, from a point 50 feet south of Drake Park Avenue to a point 50 feet north of Drake Park Avenue.

Twenty-fourth Street, on the east side, from University Avenue to a point 50 feet south thereof, no parking any time.

Twenty-fourth Street, on the east side, from a point 160 feet south of University Avenue to a point 110 feet south thereof, two-hour parking, 9:00 a.m. to 4:00 p.m.

Twenty-fourth Street, on the east side, from a point 270 feet south of University Avenue to a point 293 feet south thereof, is designated a handicapped parking space and is subject to the same prohibition as is found in section 114-616(a) of this Code.

Twenty-fourth Street, on the west side, from University Avenue to a point 260 feet south thereof, two-hour parking, 9:00 a.m. to 4:00 p.m.

Twenty-fourth Street, on the east side, from University Avenue to a point 50 feet north thereof, no parking any time.

Twenty-fourth Street, on the west side, from University Avenue to a point ~~50 feet south of Carpenter Avenue~~ 240 feet north thereof, no parking any time.

Twenty-fourth Street, on the east side, from Carpenter Avenue to a point 100 feet north thereof, no parking any time.

Twenty-fourth Street, on the east side, from a point 250 feet north of University Avenue to a point 50 feet north thereof, loading zone.

Twenty-fourth Street, on the east side, from a point 300 feet north of University Avenue to Carpenter Avenue, no parking any time.

~~Twenty-fourth Street, on the west side, from a point 50 feet south of Carpenter Avenue to a point 50 feet north of Carpenter Avenue, no parking any time~~240 feet north of University Avenue to a point 60 feet north thereof, two-hour parking.

Twenty-fourth Street, on the west side, from a point 300 feet north of University Avenue to a point 50 feet north thereof, no parking any time.

Twenty-fourth Street, on the west side, from a point 25 feet south of Carpenter Avenue to a point 75 feet south thereof, reserved parking for marked police vehicles only.

Twenty-fourth Street, on the west side, from Carpenter Avenue to a point 25 feet south thereof, no parking any time.

Twenty-fourth Street, on the west side, from Forest Avenue to a point 100 feet north thereof, no parking any time.

Twenty-fourth Street, on the west side, from Clark Street to Twenty-fourth Drive, no parking any time.

Twenty-fourth Street, on the east side, from a point 50 feet south of Clark Street to a point 53 feet north of Clark Street, no parking any time.

Twenty-fourth Street, on the east side, from Forest Avenue to Clark Street, no parking any time.

Twenty-fourth Street, on the east side, from a point 50 feet south of Twenty-fourth Drive to a point 50 feet north of Twenty-fourth Drive, no parking any time.

Twenty-fourth Street, on the west side, from College Avenue to a point 95 feet north thereof, no parking any time.

Twenty-fourth Street, on the east side, from College Avenue to a point 50 feet south thereof, no parking any time.

Twenty-fourth Street, on the east side, from Twenty-fourth Drive to a point 500 feet north of Franklin Avenue, no parking any time.

Twenty-fourth Street, on the east side, from Hickman Road to Bennett Avenue, no parking any time.

Twenty-fourth Street, on the west side, from a point 100 feet south of Holcomb Avenue to a point 100 feet north of Holcomb Avenue, no parking any time.

Sec. 114-3274. East Grand Avenue--East Fifteenth Street to East Eighteenth Street.

East Grand Avenue, on the south side, from East Fifteenth Street to a point 300 feet east thereof, no parking any time.

East Grand Avenue, on the south side, from a point 300 feet east of East Fifteenth Street to a point 50 feet west of East

Sixteenth Street, no parking 7:00 a.m. to 9:00 a.m.

East Grand Avenue, on the north side, from East Fifteenth Street to a point ~~460~~300 feet east thereof, no parking any time.

East Grand Avenue, on the north side, from a point ~~460~~300 feet east of East Fifteenth Street to a point 50 feet west of East Sixteenth Street, no parking 7:00 a.m. to 9:00 a.m.

East Grand Avenue, on the south side, from a point 300 feet east of East Fifteenth Street to a point 50 feet west of East Sixteenth Street, no parking 4:00 p.m. to 6:00 p.m.

East Grand Avenue, on the south side, from a point 300 feet east of East Fifteenth Street to a point 50 feet west of East Sixteenth Street, two-hour parking 9:00 a.m. to 4:00 p.m.

East Grand Avenue, on the south side, from East Sixteenth Street to a point 82 feet east thereof, loading zone.

East Grand Avenue, on the south side, from East Sixteenth Street to a point 50 feet west thereof, no parking any time.

East Grand Avenue, on the south side, from a point 82 feet east of East Sixteenth Street to a point 150 feet west of East Eighteenth Street, no parking 7:00 a.m. to 9:00 a.m.

East Grand Avenue, on the south side, from a point 82 feet east of East Sixteenth Street to a point 150 feet west of East Eighteenth Street, no parking 4:00 p.m. to 6:00 p.m.

East Grand Avenue, on the south side, from a point 82 feet west of East Sixteenth Street to a point 150 feet west of East Eighteenth Street, two-hour parking 9:00 a.m. to 4:00 p.m.

East Grand Avenue, on the north side, from a point ~~460~~300 feet east of East Fifteenth Street to a point 50 feet west of East Sixteenth Street, no parking 4:00 p.m. to 6:00 p.m.

East Grand Avenue, on the north side, from a point ~~460~~300 feet east of East Fifteenth Street to a point ~~350~~50 feet east thereof, commercial loading zone, 9:00 a.m. to 4:00 p.m.

East Grand Avenue, on the north side, from a point ~~495~~350 feet east of East Fifteenth Street to a point 50 feet west of East Sixteenth Street, two-hour parking 9:00 a.m. to 4:00 p.m.

East Grand Avenue, on the north side, from a point 50 feet west of East Sixteenth Street to a point 50 feet east of East Sixteenth Street, no parking any time.

East Grand Avenue, on the north side, from a point 50 feet east of East Sixteenth Street to a point 150 feet west of East Eighteenth Street, no parking 7:00 a.m. to 9:00 a.m.

East Grand Avenue, on the north side, from a point 50 feet east of East Sixteenth Street to a point 150 feet west of East Eighteenth Street, no parking 4:00 p.m. to 6:00 p.m.

East Grand Avenue, on both sides, from East Eighteenth Street to a point 150 feet west thereof, no parking any time.

Sec. 114-3578. Pleasant View Drive--South Union Street to Southwest Eighteenth Street.

Pleasant View Drive, on the south side, from a point 150 feet

east of Southwest Second Street to a point 70 feet west of Southwest Second Street, no parking any time.

Pleasant View Drive, on both sides, from the dead end east of Southwest Fifth Street to a point 60 feet west thereof, no parking any time.

Pleasant View Drive, on the south side, from Southwest Sixth Street to a point 50 feet east thereof, no parking any time.

Pleasant View Drive, on the south side, from Southwest Ninth Street to a point 50 feet east thereof, no parking any time.

Pleasant View Drive, on the south side, from a point 90 feet east of Southwest Ninth Street to a point 25 feet east thereof, no parking any time.

Pleasant View Drive, on the south side, from Southwest Ninth Street to a point 50 feet west thereof, no parking any time.

Pleasant View Drive, on the north side, from a point 400 feet east of Southwest Fifth Street to Southwest Fourteenth Street, no parking any time.

Pleasant View Drive, on the south side, from Southwest Twelfth Street to a point 50 feet east thereof, no parking any time.

Pleasant View Drive, on the south side, from Southwest Thirteenth Place to a point 50 feet west thereof, no parking any time.

Pleasant View Drive, on the north side, from Druid Hill Drive to Southwest Eighteenth Street, no parking any time.

Sec. 114-3760. East Watrous Avenue--South Union Street to Hartford Avenue.

East Watrous Avenue, on the north side, from South Union Street to a point 50 feet east of Southeast Fourteenth Street, no parking any time.

East Watrous Avenue, on the south side, from a point 50 feet west of Southeast Fourteenth Street to a point 50 feet east of Southeast Fourteenth Street, no parking any time.

East Watrous Avenue, on the north side, from Indianola Avenue to a point 180 feet west thereof, no parking any time.

East Watrous Avenue, on both sides, from Southeast Twenty-fourth Street to Hartford Avenue, no parking any time.

Sec. 2. This ordinance shall be in full force and effect from and after its passage and publication as provided by law.

FORM APPROVED:

Katharine Massier
Assistant City Attorney

08-244 41A

09-30-21
54

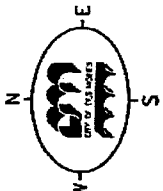

Parking Restriction Revisions Public Library Lots

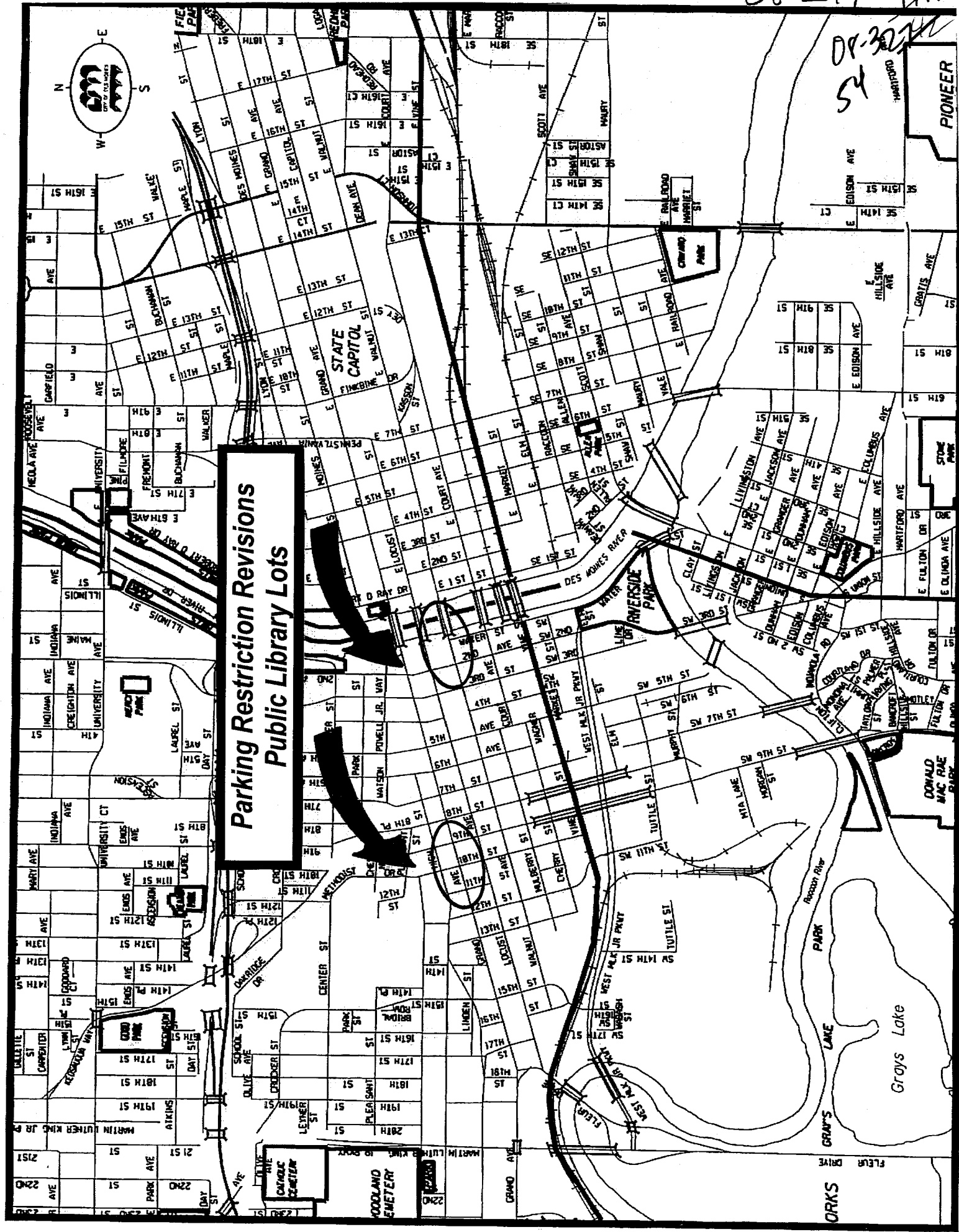
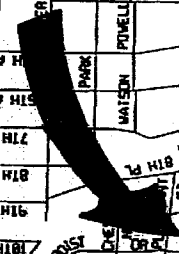

54 42
08-244 4/B

08.321

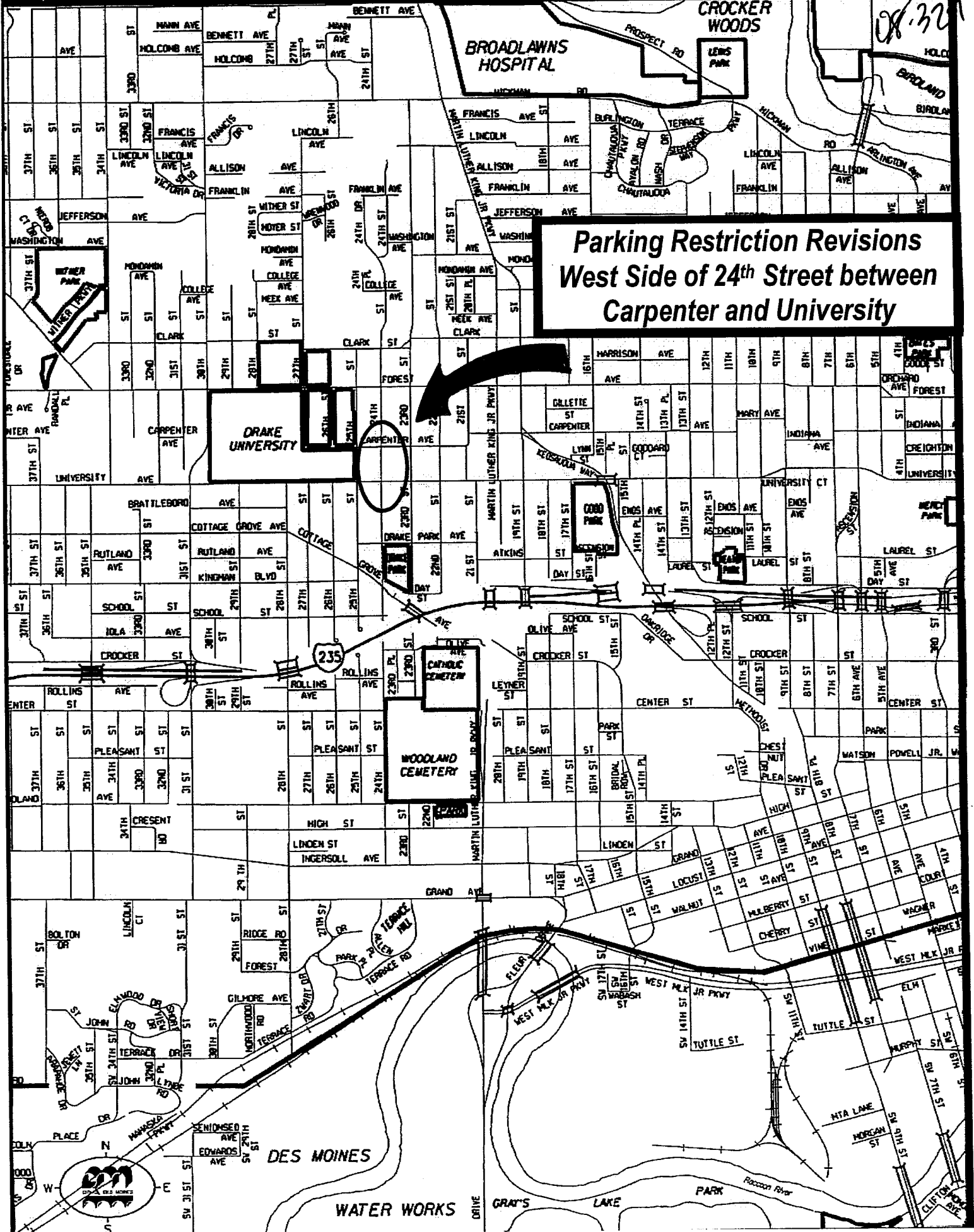

**Parking Restriction Revisions
West Side of 24th Street between
Carpenter and University**

08-244 ⁵⁴ ₄₁₂ *AKC*

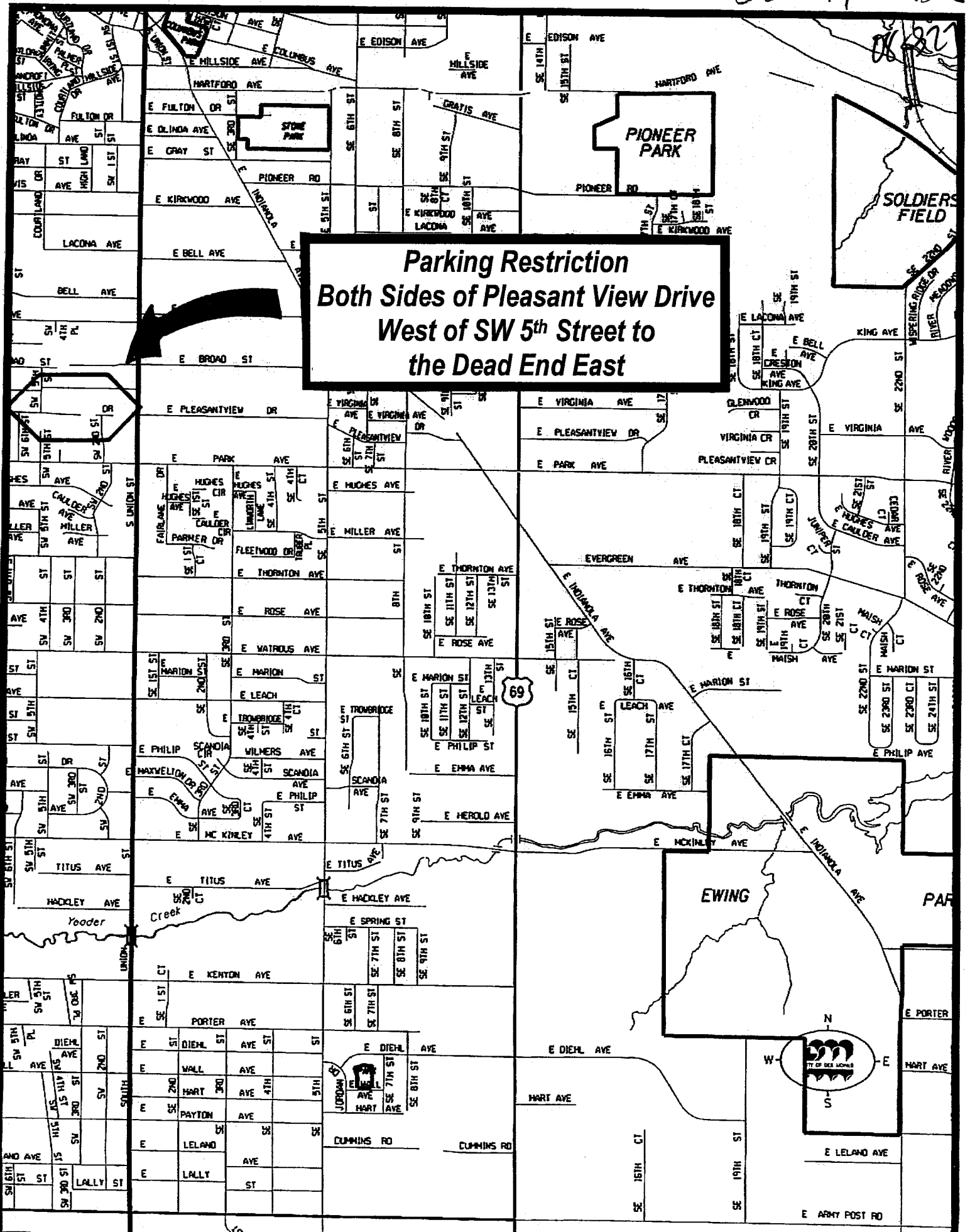

Parking Restriction
Both Sides of Pleasant View Drive
West of SW 5th Street to
the Dead End East

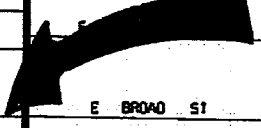

08-244 54 4/15/92

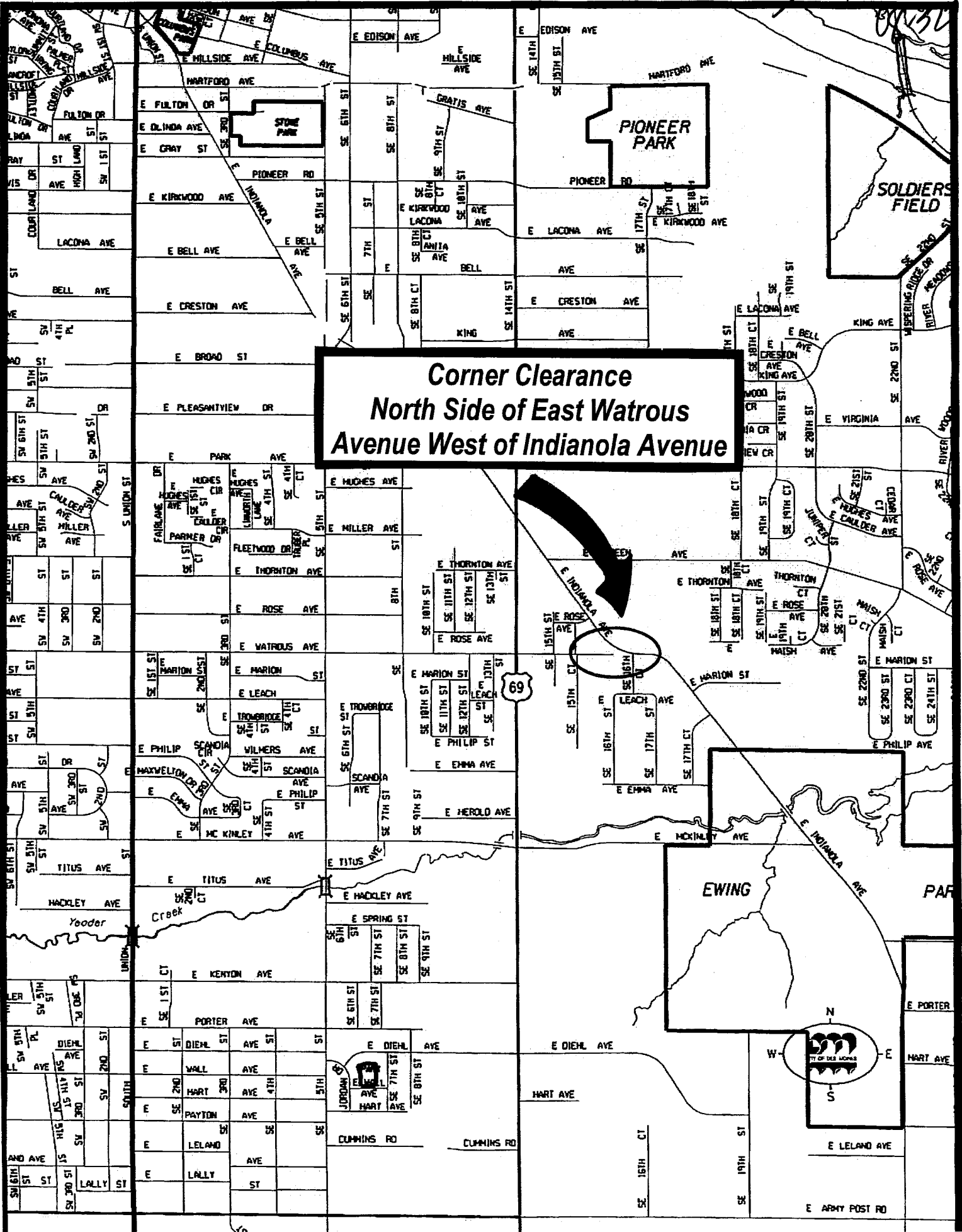

**Corner Clearance
North Side of East Watrous
Avenue West of Indianola Avenue**

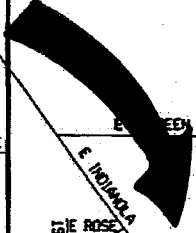

69

