

DATE March 10, 2008

ORDERING CONSTRUCTION OF
INGERSOLL AVENUE STREETScape IMPROVEMENTS – 29TH TO 31ST STREETS
AND FIXING A DATE FOR RECEIVING OF BIDS ON MARCH 18, 2008
AND PUBLIC HEARING ON APRIL 7, 2008
ENGINEER'S ESTIMATE IS \$1,061,823.00

WHEREAS, this Council deems it advisable and necessary to construct the below referenced improvement, all in accordance with the plans and specifications, and has caused to be prepared plans, specifications, and form of contract, together with estimate of cost, which are now on file in the City Engineer's Office, 2nd Floor, City Hall, 400 Robert D. Ray Drive, Des Moines, Iowa 50309-1891, for public inspection for the construction of said improvements, and said plans, specifications and form of contract are deemed suitable for the making of said improvement, for which the State of Iowa Department of Transportation (IDOT) and the City of Des Moines, (CITY) have an agreement, previously approved by this Council, under which the IDOT has agreed to advertise, receive, open and tabulate sealed bids, and

WHEREAS, before said plans, specifications, form of contract, and estimated cost of the improvement may be approved, and contract for the construction of the improvement entered into, it is necessary to hold a public hearing.

BE IT RESOLVED BY THE CITY COUNCIL OF THE CITY OF DES MOINES, IOWA: That the attached communication recommending construction of the following improvement and the method of financing; and also including the recommendation of the Des Moines City Engineer, as the Jurisdictional Engineer, submitting plans, specifications, form of contract documents, and Jurisdictional Engineer's estimate of cost for the construction of the following improvement:

Ingersoll Avenue Streetscape Improvements – 29th to 31st Streets, 04-2005-011
STP-E-1945(706)-8V-77

The improvement includes constructing curb, sidewalks, driveways, storm sewer, planters, landscaping, and other incidental items; in accordance with the contract documents, including Plans File Nos. 487-001/072 on Ingersoll Avenue from 29th to 31st Streets, Des Moines, Iowa

be and the same are hereby approved and accepted. The estimated construction cost for said improvement is \$1,061,823.00. The proposed plans, specifications, and form of contract documents are available for public inspection in the City Engineer's Office.

BE IT FURTHER RESOLVED: That this Council hereby determines that it is necessary and advisable to construct said improvement in the manner set forth in the plans, specifications, and form of contract documents submitted by the Jurisdictional Engineer; and that payment for the cost of said improvement shall be paid from from the funding source identified below.

BE IT FURTHER RESOLVED: That a public hearing on said plans, specifications, form of contract documents, and Jurisdictional Engineer's estimate of construction cost for said improvement be held in the City Council Chambers, 2nd Floor, City Hall, 400 Robert D. Ray Drive, Des Moines, Iowa, at 5:00 p.m. on April 7, 2008, at which time this Council will consider any objections offered thereto or to the making of said improvement.

★ **Roll Call Number**

Agenda Item Number

8A

DATE March 10, 2008

BE IT FURTHER RESOLVED: That proposals will be received by the Iowa Department of Transportation, for the construction of said improvements, and the taking of bids in the manner required by law. Proposals received will be opened and tabulated by the Iowa Department of Transportation on March 18, 2008, after which the bids together with a report and recommendation of the Chief Civil Engineer, will be presented to City Council at its next meeting for action thereon.

BE IT FURTHER RESOLVED: That an appropriate Notice to Bidders and Notice of Public Hearing for said improvement be published in the Des Moines Register as provided and directed by Chapter 26 and/or 314, Code of Iowa.

(City Council Communication Number 08-118 attached.)

Moved by _____ to adopt.

FORM APPROVED:

FUNDS AVAILABLE

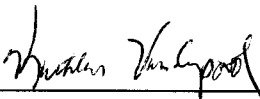

 Kathleen Vanderpool
 Deputy City Attorney



 Allen McKinley
 Des Moines Finance Director

Funding Source: 2007-2008 CIP, Page Street-24, Ingersoll Streetscape Improvements 28th - 31st, STR221, Being: \$52,507 in G. O. Bonds, \$584,316 in Storm Water Utility Funds, \$275,000 in Vision Iowa CAT Grant, and \$150,000 in Federal Surface Transportation Program funds under STP-E-1945(706)-8V-77

COUNCIL ACTION	YEAS	NAYS	PASS	ABSENT
COWNIE				
COLEMAN				
HENSLEY				
KIERNAN				
MAHAFFEY				
MEYER				
VLASSIS				
TOTAL				

MOTION CARRIED APPROVED

 Mayor

I, Diane Rauh, City Clerk of said City Council, hereby certify that at a meeting of the City Council, held on the above date, among other proceedings the above was adopted.

IN WITNESS WHEREOF, I have hereunto set my hand and affixed my seal the day and year first above written.

 City Clerk

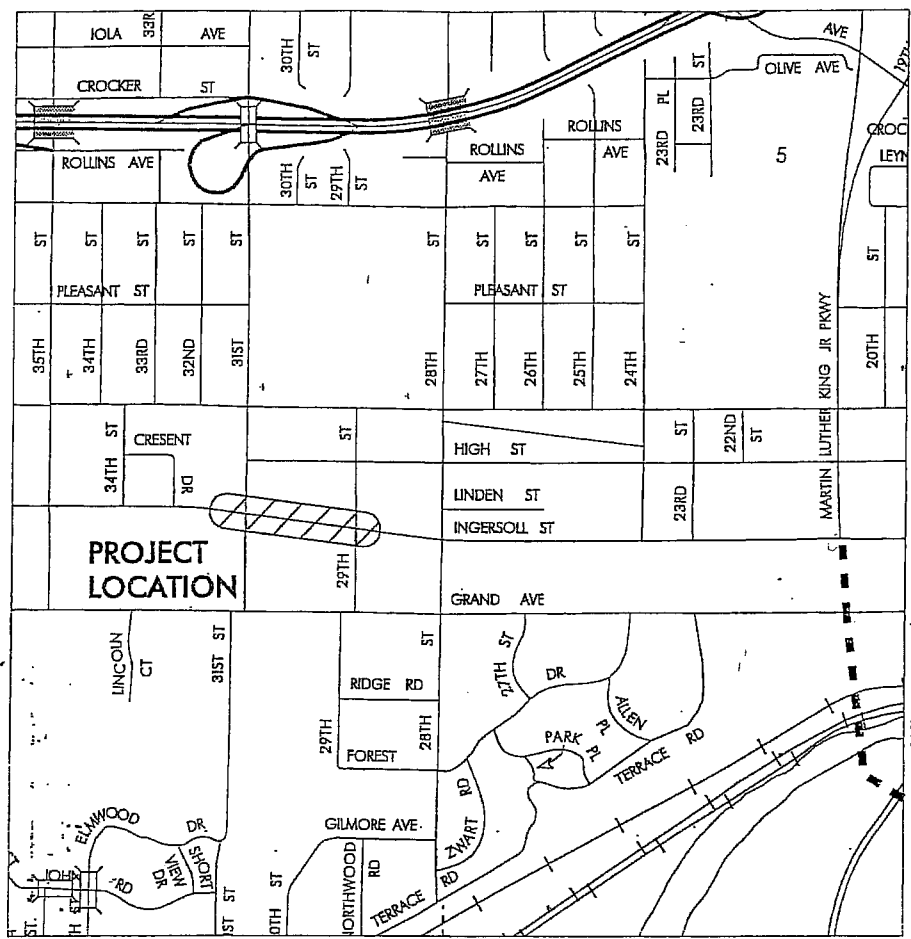

**INGERSOLL AVENUE STREETSCAPE IMPROVEMENTS – 29TH TO 31ST STREETS
ACTIVITY ID 04-2005-011**

Opinion of Probable Costs
 Ingersoll Avenue Streetscape 29th to 31st
 STP-E-1945(706)-8V-77
 3/18/2008
 Activity ID 04-2005-011

ITEM NO.	ITEM CODE	ITEM	UNIT	UNIT PRICE	STREETSCAPE QUANTITY	STREETSCAPE EXTENDED PRICE	STORM SEWER QUANTITY	STORM SEWER EXTENDED PRICE	TOTAL QUANTITY	TOTAL EXTENDED PRICE
1	12101-0850001	CLEAR+GRUBB	ACRE	\$5,000.00	0.22	\$1,100.00	0	\$0.00	0.22	\$1,100.00
2	2101-0850002	CLEAR+GRUBB	UNIT	\$25.00	202	\$5,050.00	0	\$0.00	202	\$5,050.00
3	2102-2710070	EXCAVATION, CL 10, RDWY+BORROW	CY	\$10.00	120	\$1,200.00	0	\$0.00	120	\$1,200.00
4	2105-8425005	TOPSOIL, FURN+SPREAD	CY	\$15.00	11	\$165.00	0	\$0.00	11	\$165.00
5	2201-0505100	BASE, STD/S-F PCC, 10"	SY	\$79.00	293	\$23,147.00	795	\$62,805.00	1088	\$85,952.00
6	2213-8745500	RMVL OF CURB	STA	\$1,200.00	11.75	\$14,100.00	2.08	\$2,496.00	13.83	\$16,596.00
7	2214-5145150	PAVT, SCARIFICATION	SY	\$5.00	800	\$6,400.00	1000	\$8,000.00	1800	\$14,400.00
8	2301-1003100	STD/S-F PCC PAVT, QM-C CL 3, 10"	SY	\$85.00	0	\$0.00	237	\$20,145.00	237	\$20,145.00
9	2303-0000100	HMA COMMERCIAL MIX	TON	\$150.00	5	\$750.00	0	\$0.00	5	\$750.00
10	2303-0133500	HMA (3M ESAL) SURF, 1/2", NO FRIC	TON	\$120.00	130	\$15,600.00	160	\$19,200.00	290	\$34,800.00
11	2303-0248422	ASPH BINDER, PG 64-22	TON	\$250.00	8	\$2,000.00	10	\$2,500.00	18	\$4,500.00
12	2303-3400000	ADJUSTMENT OF FIXTURE	EACH	\$250.00	0	\$0.00	11	\$2,750.00	11	\$2,750.00
13	2401-8745910	RMVL OF SIGN	EACH	\$200.00	3	\$600.00	0	\$0.00	3	\$600.00
14	2401-8745915	RMVL OF SIGN SUPRT STRUCT+FOOTING	EACH	\$250.00	4	\$1,000.00	0	\$0.00	4	\$1,000.00
15	2401-8750001	REML	LS	\$2,500.00	1	\$2,500.00	0	\$0.00	1	\$2,500.00
16	2403-0100000	STRUCT CONC (MISCELLANEOUS)	CY	\$300.00	5.6	\$1,680.00	0	\$0.00	5.6	\$1,680.00
17	2502-2308100	TRENCH DRAIN	LF	\$450.00	0	\$0.00	128	\$57,600.00	128	\$57,600.00
18	2503-4460010	INTAKE, TYPE M-A	EACH	\$3,000.00	0	\$0.00	9	\$27,000.00	9	\$27,000.00
19	2503-4460030	INTAKE, TYPE M-C	EACH	\$3,500.00	0	\$0.00	8	\$28,000.00	8	\$28,000.00
20	2503-7181036	RMV STORM SWR PIPE LE 36"	LF	\$50.00	0	\$0.00	63	\$3,150.00	63	\$3,150.00
21	2503-7325015	SWR, 2000D STORM, 15"	LF	\$50.00	0	\$0.00	735	\$36,750.00	735	\$36,750.00
22	2503-7325018	SWR, 2000D STORM, 18"	LF	\$55.00	0	\$0.00	113	\$6,215.00	113	\$6,215.00
23	2503-7325024	SWR, 2000D STORM, 24"	LF	\$60.00	0	\$0.00	332	\$19,920.00	332	\$19,920.00
24	2503-7325030	SWR, 2000D STORM, 30"	LF	\$65.00	0	\$0.00	523	\$33,995.00	523	\$33,995.00
25	2503-8462300	UTILITY ACCESS, SPECIAL	EACH	\$3,500.00	0	\$0.00	9	\$31,500.00	9	\$31,500.00
26	2506-4984000	FLOWABLE MORTAR	CY	\$300.00	0	\$0.00	10	\$3,000.00	10	\$3,000.00
27	2510-8745850	RMVL OF PAVT	SY	\$10.00	600	\$6,000.00	650	\$6,500.00	1250	\$12,500.00
28	2510-8750600	RMVL OF INTAKE+UTILITY ACCESS	EACH	\$1,500.00	0	\$0.00	2	\$3,000.00	2	\$3,000.00
29	2511-8745800	RMVL OF SIDEWALK	SY	\$5.00	976	\$4,880.00	163	\$815.00	1139	\$5,695.00
30	2511-7526004	SIDEWALK, PCC, 4"	SY	\$45.00	0	\$0.00	170	\$7,650.00	170	\$7,650.00
31	2511-7526005	SIDEWALK, PCC, 5"	SY	\$50.00	1315	\$65,750.00	0	\$0.00	1315	\$65,750.00
32	2511-7526008	SIDEWALK, PCC, 8"	SY	\$50.00	61.6	\$3,080.00	0	\$0.00	61.6	\$3,080.00
33	2511-7528100	DETECTABLE WARNING - CURB RAMP	SF	\$40.00	104	\$4,160.00	0	\$0.00	104	\$4,160.00
34	2512-1725306	CURB+GUTTER, PCC, 3.0"	LF	\$40.00	0	\$0.00	252	\$10,080.00	252	\$10,080.00
35	2512-1859000	CURB, SPECIAL	LF	\$35.00	720	\$25,200.00	1430	\$24,850.00	1430	\$50,050.00
36	2515-2475007	DRIVEWAY, PCC, 7"	SY	\$45.00	280	\$12,600.00	344	\$15,480.00	624	\$28,080.00
37	2515-8745600	RMVL OF PAVED DRIVEWAY	SY	\$10.00	950	\$9,500.00	94	\$940.00	1044	\$10,440.00
38	2518-6910000	SAFETY CLOSURE	EACH	\$5,000.00	0	\$0.00	7	\$35,000.00	7	\$35,000.00
39	2519-1002048	FENCE, CHAIN LINK, 48" HEIGHT	LF	\$50.00	10	\$500.00	0	\$0.00	10	\$500.00
40	2519-1010020	RMVL OF CHAIN LINK FENCE	LF	\$20.00	10	\$200.00	0	\$0.00	10	\$200.00
41	2525-0000100	TRAFFIC SIGNALIZATION	LS	\$17,500.00	1	\$17,500.00	0	\$0.00	1	\$17,500.00
42	2525-0000200	LOOP DETECTOR (ADD/RPLCMNT TO EXIST SYS)	EACH	\$1,500.00	5	\$7,500.00	5	\$7,500.00	10	\$15,000.00
43	2527-9263110	PAINTED PAVT MARK, WATERBORNE/SOLVENT	STA	\$333.33	0	\$0.00	3	\$1,000.00	3	\$1,000.00
44	2528-8445110	TRAFFIC CONTROL	LS	\$25,000.00	0.5	\$12,500.00	0.5	\$25,000.00	1	\$25,000.00
45	2533-4980005	MOBILIZATION	LS	\$50,000.00	0.5	\$25,000.00	0.5	\$25,000.00	1	\$50,000.00
46	2535-2000440	MODULAR BLOCK RETAIN WALL	SF	\$40.00	890	\$35,600.00	0	\$0.00	890	\$35,600.00
47	2537-8900000	REMEDIATION OF PETRO CONTAMINATED SOIL	CY	\$100.00	0	\$0.00	100	\$10,000.00	100	\$10,000.00
48	2598-1980100	CURB STOP+VALVE BOX, 1"	EACH	\$1,500.00	0	\$0.00	7	\$10,500.00	7	\$10,500.00

ITEM NO.	ITEM CODE	ITEM	UNIT	UNIT PRICE	STREETSCAPE QUANTITY	STREETSCAPE EXTENDED PRICE	STORM SEWER QUANTITY	STORM SEWER EXTENDED PRICE	TOTAL QUANTITY	TOTAL EXTENDED PRICE
49	2598-8821000	DISCONNECT WATER SERVICE	EACH	\$1,500.00	0	\$0.00	7	\$10,500.00	7	\$10,500.00
50	2598-8821003	LOWER WATER SERVICE W/COPPER	EACH	\$500.00	0	\$0.00	7	\$3,500.00	7	\$3,500.00
51	2598-8821300	RELOCATE WATER SERVICE	EACH	\$1,500.00	0	\$0.00	7	\$10,500.00	7	\$10,500.00
52	2598-8821301	RELOCATE WATER SERVICE STOP BOX	EACH	\$1,000.00	0	\$0.00	7	\$7,000.00	7	\$7,000.00
53	2598-8821302	ADJUST WATER SERVICE STOP BOX	EACH	\$500.00	7	\$3,500.00	0	\$0.00	7	\$3,500.00
54	2599-9999005	INLET PROTECTION DEVICE	EACH	\$175.00	0	\$0.00	19	\$3,325.00	19	\$3,325.00
55	2599-9999009	PLANTER CURB	LF	\$35.00	2046	\$71,576.00	0	\$0.00	2046	\$71,576.00
56	2599-9999010	TEMPORARY CONSTRUCTION ACCESS - STREETSCAPE	LLS	\$12,500.00	1	\$12,500.00	0	\$0.00	1	\$12,500.00
57	2599-9999010	TEMPORARY CONSTRUCTION ACCESS - STORM SEWELS	LLS	\$12,500.00	0	\$0.00	1	\$12,500.00	1	\$12,500.00
58	2599-9999014	SALVAGE AND REINSTALL MODULAR BLOCK WALL	SF	\$40.00	319	\$12,760.00	0	\$0.00	319	\$12,760.00
59	2599-9999018	BRICK SIDEWALK WITH 4" CONCRETE BASE	SF	\$125.00	65	\$8,125.00	0	\$0.00	65	\$8,125.00
60	2601-2639010	SOD	SQ	\$80.00	12.5	\$1,000.00	5	\$400.00	17.5	\$1,400.00
61	2602-0000020	SILT FENCE	LF	\$2.50	100	\$250.00	100	\$500.00	200	\$750.00
62	2602-0000060	RMVL OF SILT FENCE	LF	\$5.00	100	\$500.00	100	\$500.00	200	\$1,000.00
63	2610-0000110	SHRUB	EACH	\$40.00	340	\$13,600.00	0	\$0.00	340	\$13,600.00
64	2610-0000120	TREE	EACH	\$450.00	23	\$10,350.00	0	\$0.00	23	\$10,350.00
65	2610-0000180	FLOWER	EACH	\$15.00	2539	\$38,085.00	0	\$0.00	2539	\$38,085.00
					\$477,507.00		\$584,316.00		\$1,061,823.00	