

DATE March 24, 2008

PUBLIC HEARING, APPROVING PLANS, SPECIFICATIONS, FORM OF CONTRACT DOCUMENTS, AND ENGINEER'S ESTIMATE ON INGERSOLL RUN STORM SEWER - 34TH STREET TO 35TH STREET; RECEIVE AND FILE BIDS; AND DESIGNATION OF LOWEST RESPONSIVE, RESPONSIBLE BIDDER AS VAN HAUEN & ASSOCIATES, INC., MARK VAN HAUEN, CEO/VICE PRESIDENT, \$588,000.00

WHEREAS, on February 25, 2008, under Roll Call No. 08-284, plans, specifications, form of contract documents, and Jurisdictional Engineer's estimate of construction cost were filed with the City Clerk, for the construction of the following improvement:

Ingersoll Run Storm Sewer - 34th Street to 35th Street, 08-2007-006

The improvement includes construction of 6' x 6' reinforced concrete box culvert, 12" and 15" storm sewer, storm manholes, storm intakes, special structure, 8" PCC pavement, 7" and 8" PCC driveways, 4" and 6" PCC sidewalk, 6" water main relocation, and miscellaneous associated work including cleanup; in accordance with the contract documents, including Plan File Nos. 479-139/149, and located from 34th Street to 35th Street, between Ingersoll Avenue and Woodland Avenue, Des Moines, Iowa

WHEREAS, notice of the hearing on the plans, specifications, form of contract documents, and Engineer's estimate of construction cost was published as required by law.

NOW, THEREFORE, BE IT RESOLVED BY THE CITY COUNCIL OF THE CITY OF DES MOINES, IOWA: That the hearing on the plans, specifications, form of contract documents, and Jurisdictional Engineer's estimate of construction cost for said improvement be closed; and that said plans, specifications, form of contract documents, and Jurisdictional Engineer's estimate of construction cost are hereby approved as the plans, specifications, form of contract documents, and Jurisdictional Engineer's estimate of construction cost for said improvement.

BE IT FURTHER RESOLVED: That sealed bids for said improvement were submitted by the following bidders:

- Van Hauen & Associates, Inc. Clive, IA
- The Underground Company, Ltd. Carlisle, IA
- Priority Excavating LLC Waukee, IA
- Corell Contractor, Inc. West Des Moines, IA
- Reilly Construction Co., Inc. Ossian, IA
- H & W Contracting LLC Sioux Falls, SD
- Eco-Tech Construction, LLC Grimes, IA
- Bid read under advisement

which were received and opened at a public meeting presided over by the Jurisdictional Engineer in the City Council Chambers, 2nd Floor, City Hall, 400 Robert D. Ray Drive, Des Moines, Iowa at 11:00 a.m. on March 11, 2008. Said bids and the attached tabulation of bids for said improvement be and are hereby received and filed.

★ **Roll Call Number**

Agenda Item Number

62

DATE March 24, 2008

BE IT FURTHER RESOLVED: That the Jurisdictional Engineer has determined that the lowest responsive, responsible bid for the construction of said improvement was submitted by Van Hauen & Associates, Inc., Mark Van Hauen, CEO/Vice President, 13185 Pineview Drive, Clive, IA, 50325 in the amount of \$588,000.00, and said bid be and the same is hereby accepted.

BE IT FURTHER RESOLVED: That the bid security of the unsuccessful bidders be and is hereby authorized and directed to be returned.

BE IT FURTHER RESOLVED: That the Jurisdictional Engineer is hereby directed to secure execution by the lowest responsible, responsive Bidder and its surety of the contract documents in the form heretofore approved by this Council; that the Jurisdictional Engineer is directed to thereafter present said contract documents to this Council for approval and authorization to the Mayor to sign; and that no contract shall be deemed to exist between the City of Des Moines and said Bidder until said contract has been executed by the Bidder, and shall have been approved by this Council and executed by the Mayor and attested to by the City Clerk.

(City Council Communication Number 08-170 attached.)

Moved by _____ to adopt.

FORM APPROVED:

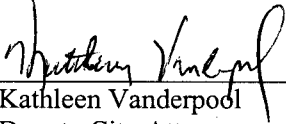
 Kathleen Vanderpool
 Deputy City Attorney

FUNDS AVAILABLE

 Allen McKinley
 Des Moines Finance Director

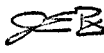
 Funding Source: 2007-2008 CIP, Page Sanitary-5, City-wide Sanitary Sewers, SAE054, Various Funding, Being: 50% in Sanitary Sewer Funds from SAE054, and 50% in Storm Water Utility Funds from STE057, Page Storm Water-5, City-Wide Storm Water Utility Projects

COUNCIL ACTION	YEAS	NAYS	PASS	ABSENT
COWNIE				
COLEMAN				
HENSLEY				
KIERNAN				
MAHAFFEY				
MEYER				
VLASSIS				
TOTAL				

MOTION CARRIED APPROVED

 Mayor

I, Diane Rauh, City Clerk of said City Council, hereby certify that at a meeting of the City Council, held on the above date, among other proceedings the above was adopted.

IN WITNESS WHEREOF, I have hereunto set my hand and affixed my seal the day and year first above written.

 City Clerk

T:\ENR\Drawings\08-2007\006\Drawings\Loc_Map\LOC_MAP.DGN 08-FEB-2008 14:21

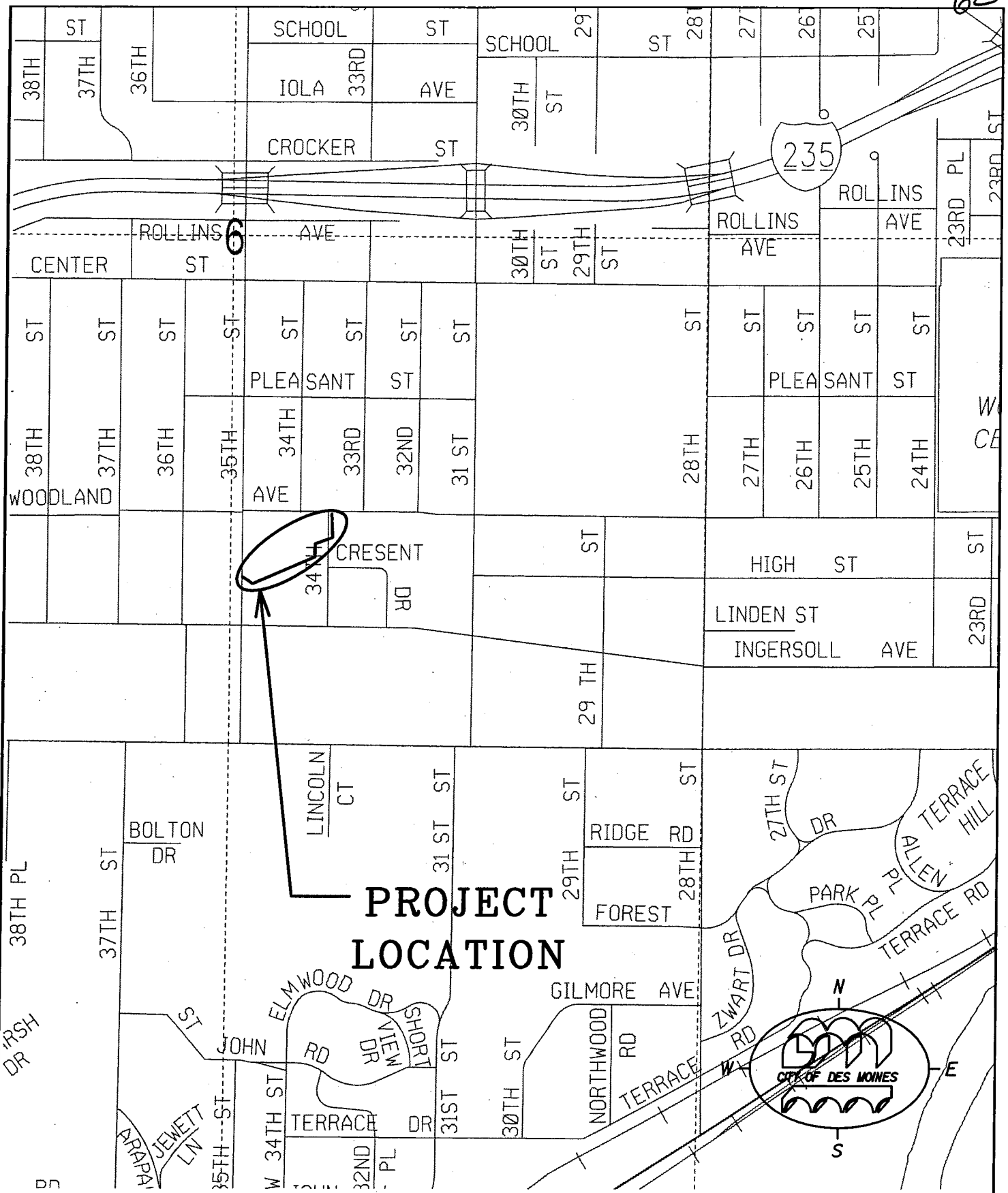

**PROJECT
LOCATION**

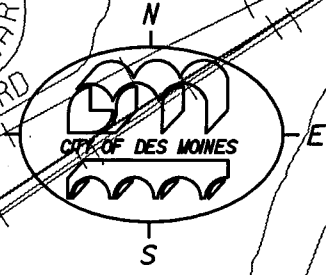

**INGERSOLL RUN STORM SEWER
34TH STREET TO 35TH STREET
ACTIVITY I.D. 08-2007-006**

ACTIVITY ID 08-2007-006
 IDOT PROJ NO.: None
 BID DATE: 3/11/08

DEPARTMENT OF ENGINEERING
 CITY OF DES MOINES, IOWA

APPROVED BY: *R. Joanning* 03/11/08
 CHECKED BY: *John F. McKen*

CONTRACTOR'S BID TABULATION
 PROJECT: INGERSOLL RUN STORM SEWER - 34TH ST. TO 35TH ST.

ESTIMATE

ITEM	DESCRIPTION	QUANTITY	UNIT		AMOUNT		UNIT PRICE	AMOUNT		UNIT PRICE	AMOUNT		UNIT PRICE	AMOUNT		UNIT PRICE	AMOUNT		UNIT PRICE	
			PRICE	AMOUNT	PRICE	AMOUNT		PRICE	AMOUNT		PRICE	AMOUNT		PRICE	AMOUNT					
1	Project Sign	1 LS	\$1,000.00	\$1,000.00	\$500.00	\$500.00	\$1,000.00	\$500.00	\$500.00	\$1,000.00	\$1,000.00	\$1,000.00	\$1,000.00	\$1,000.00	\$1,000.00	\$1,000.00	\$1,000.00	\$1,000.00	\$1,000.00	\$1,000.00
2	Mobilization	1 LS	\$80,000.00	\$80,000.00	\$22,370.00	\$22,370.00	\$80,000.00	\$22,370.00	\$22,370.00	\$80,000.00	\$10,917.00	\$10,917.00	\$80,000.00	\$10,917.00	\$80,000.00	\$10,917.00	\$80,000.00	\$10,917.00	\$80,000.00	\$10,917.00
3	Traffic Control	1 LS	\$2,000.00	\$2,000.00	\$2,200.00	\$2,200.00	\$2,000.00	\$2,200.00	\$2,200.00	\$2,000.00	\$4,720.00	\$4,720.00	\$2,000.00	\$4,720.00	\$2,000.00	\$4,720.00	\$2,000.00	\$4,720.00	\$2,000.00	\$4,720.00
4	Pavement Removal / Disposition	2,844 SY	\$7.00	\$19,908.00	\$7.00	\$19,908.00	\$7.00	\$19,908.00	\$19,908.00	\$7.00	\$19,908.00	\$11,376.00	\$11,376.00	\$7.00	\$19,908.00	\$13.00	\$36,972.00	\$7.00	\$19,908.00	\$13.00
5	Sidewalk, Driveway, Removal / Disposition	398 SY	\$7.00	\$2,786.00	\$5.00	\$1,990.00	\$7.00	\$2,786.00	\$1,990.00	\$5.00	\$1,990.00	\$3,980.00	\$3,980.00	\$7.00	\$2,786.00	\$17.50	\$6,965.00	\$7.00	\$2,786.00	\$17.50
6	Subgrade Preparation	2,082 SY	\$5.00	\$10,410.00	\$8.00	\$16,656.00	\$5.00	\$10,410.00	\$16,656.00	\$8.00	\$16,656.00	\$10,410.00	\$10,410.00	\$5.00	\$10,410.00	\$1.75	\$3,643.50	\$5.00	\$10,410.00	\$1.75
7	Subgrade Treatment, Flyash, 6% by Weight	612 SY	\$1.00	\$612.00	\$6.00	\$3,672.00	\$1.00	\$612.00	\$3,672.00	\$6.00	\$3,672.00	\$30.60	\$30.60	\$1.00	\$612.00	\$42.70	\$26,132.40	\$1.00	\$612.00	\$42.70
8	PCC Pavement, 8"	1,838 SY	\$60.00	\$110,280.00	\$49.00	\$90,062.00	\$60.00	\$110,280.00	\$90,062.00	\$49.00	\$90,062.00	\$91,900.00	\$91,900.00	\$60.00	\$110,280.00	\$51.25	\$94,197.50	\$60.00	\$110,280.00	\$51.25
9	PCC Driveway, 7" Type A	25 SY	\$60.00	\$1,500.00	\$36.00	\$900.00	\$60.00	\$1,500.00	\$900.00	\$36.00	\$900.00	\$1,575.00	\$1,575.00	\$60.00	\$1,500.00	\$95.00	\$2,375.00	\$60.00	\$1,500.00	\$95.00
10	PCC Driveway, 8" Commercial, M-4 Mix	93 SY	\$60.00	\$7,440.00	\$39.00	\$3,627.00	\$60.00	\$7,440.00	\$3,627.00	\$39.00	\$3,627.00	\$6,696.00	\$6,696.00	\$60.00	\$7,440.00	\$95.00	\$8,835.00	\$60.00	\$7,440.00	\$95.00
11	PCC Sidewalk, 4"	76 SY	\$40.00	\$3,040.00	\$26.00	\$1,976.00	\$40.00	\$3,040.00	\$1,976.00	\$26.00	\$1,976.00	\$2,432.00	\$2,432.00	\$40.00	\$3,040.00	\$60.00	\$4,560.00	\$40.00	\$3,040.00	\$60.00
12	PCC Sidewalk, 6"	213 SY	\$50.00	\$10,650.00	\$29.00	\$6,177.00	\$50.00	\$10,650.00	\$6,177.00	\$29.00	\$6,177.00	\$9,585.00	\$9,585.00	\$50.00	\$10,650.00	\$60.00	\$12,780.00	\$50.00	\$10,650.00	\$60.00
13	Storm Sewer, 12" DI Class 350	12 LF	\$100.00	\$1,200.00	\$130.00	\$1,560.00	\$100.00	\$1,200.00	\$1,560.00	\$130.00	\$1,560.00	\$1,296.00	\$1,296.00	\$100.00	\$1,200.00	\$75.00	\$900.00	\$100.00	\$1,200.00	\$75.00
14	Storm Sewer, 12" PVC AWWA C900	22 LF	\$60.00	\$1,320.00	\$75.00	\$1,650.00	\$60.00	\$1,320.00	\$1,650.00	\$75.00	\$1,650.00	\$1,980.00	\$1,980.00	\$60.00	\$1,320.00	\$45.50	\$1,001.00	\$60.00	\$1,320.00	\$45.50
15	Storm Sewer, 15" Class 3 RCP	19 LF	\$100.00	\$1,900.00	\$90.00	\$1,710.00	\$100.00	\$1,900.00	\$1,710.00	\$90.00	\$1,710.00	\$1,349.00	\$1,349.00	\$100.00	\$1,900.00	\$45.00	\$855.00	\$100.00	\$1,900.00	\$45.00
16	Storm Sewer, 6' x 6' RCB	695 LF	\$600.00	\$417,000.00	\$350.00	\$243,250.00	\$600.00	\$417,000.00	\$243,250.00	\$350.00	\$243,250.00	\$312,750.00	\$312,750.00	\$600.00	\$417,000.00	\$514.00	\$357,230.00	\$600.00	\$417,000.00	\$514.00
17	Bulkhead	3 EA	\$1,000.00	\$3,000.00	\$1,100.00	\$3,300.00	\$1,000.00	\$3,000.00	\$3,300.00	\$1,100.00	\$3,300.00	\$3,000.00	\$3,000.00	\$1,000.00	\$3,000.00	\$9,000.00	\$9,000.00	\$1,000.00	\$3,000.00	\$9,000.00
18	Storm Manhole, Type M-D, MOD 48"	4 EA	\$2,000.00	\$8,000.00	\$2,100.00	\$8,400.00	\$2,000.00	\$8,000.00	\$8,400.00	\$2,100.00	\$8,400.00	\$11,080.00	\$11,080.00	\$2,000.00	\$8,000.00	\$23,347.35	\$9,389.40	\$2,000.00	\$8,000.00	\$23,347.35
19	Special Structure 4	1 EA	\$30,000.00	\$30,000.00	\$40,000.00	\$40,000.00	\$30,000.00	\$30,000.00	\$40,000.00	\$40,000.00	\$30,000.00	\$30,000.00	\$30,000.00	\$30,000.00	\$29,000.00	\$29,000.00	\$3,500.00	\$3,500.00	\$29,000.00	\$3,500.00
20	Intake, Type M-D	1 EA	\$4,500.00	\$4,500.00	\$3,200.00	\$3,200.00	\$4,500.00	\$3,200.00	\$3,200.00	\$3,200.00	\$3,374.00	\$3,374.00	\$3,374.00	\$3,374.00	\$3,500.00	\$3,500.00	\$5,000.00	\$5,000.00	\$3,500.00	\$5,000.00
21	Intake, RA-43	1 EA	\$3,500.00	\$3,500.00	\$4,400.00	\$4,400.00	\$3,500.00	\$3,500.00	\$4,400.00	\$4,400.00	\$4,486.00	\$4,486.00	\$4,486.00	\$4,486.00	\$5,000.00	\$5,000.00	\$1,500.00	\$1,500.00	\$5,000.00	\$1,500.00
22	Manhole Removal, Storm	1 EA	\$500.00	\$500.00	\$500.00	\$500.00	\$500.00	\$500.00	\$500.00	\$500.00	\$500.00	\$500.00	\$500.00	\$500.00	\$1,500.00	\$1,500.00	\$1,500.00	\$1,500.00	\$1,500.00	\$1,500.00
23	Intake Removal	2 EA	\$500.00	\$1,000.00	\$500.00	\$1,000.00	\$500.00	\$1,000.00	\$1,000.00	\$500.00	\$1,000.00	\$800.00	\$800.00	\$500.00	\$1,000.00	\$1,500.00	\$1,500.00	\$500.00	\$1,000.00	\$1,500.00
24	Remove Storm / Sanitary Pipe	170 LF	\$10.00	\$1,700.00	\$6.00	\$1,020.00	\$10.00	\$1,700.00	\$1,020.00	\$6.00	\$1,020.00	\$170.00	\$170.00	\$10.00	\$1,700.00	\$51.00	\$8,670.00	\$10.00	\$1,700.00	\$51.00
25	6" Water Main Relocation Location No. 1	1 EA	\$15,000.00	\$15,000.00	\$7,000.00	\$7,000.00	\$15,000.00	\$7,000.00	\$7,000.00	\$7,000.00	\$6,940.00	\$6,940.00	\$6,940.00	\$6,940.00	\$4,500.00	\$4,500.00	\$8,670.00	\$4,500.00	\$8,670.00	\$4,500.00
26	Water Service Relocation, 1"	4 EA	\$4,000.00	\$16,000.00	\$2,000.00	\$8,000.00	\$4,000.00	\$16,000.00	\$8,000.00	\$2,000.00	\$8,000.00	\$12,152.00	\$12,152.00	\$4,000.00	\$16,000.00	\$750.00	\$3,000.00	\$4,000.00	\$16,000.00	\$750.00
27	Temporary Granular Surfacing Material	120 TON	\$25.00	\$3,000.00	\$20.00	\$2,400.00	\$25.00	\$3,000.00	\$2,400.00	\$20.00	\$2,400.00	\$3,000.00	\$3,000.00	\$25.00	\$3,000.00	\$2,000.00	\$2,000.00	\$2,000.00	\$2,000.00	\$2,000.00
28	Clearing and Grubbing	1 LS	\$1,000.00	\$1,000.00	\$500.00	\$500.00	\$1,000.00	\$1,000.00	\$500.00	\$500.00	\$800.00	\$800.00	\$800.00	\$800.00	\$2,000.00	\$2,000.00	\$2,000.00	\$2,000.00	\$2,000.00	\$2,000.00
29	Sodding	57 SQ	\$70.00	\$3,990.00	\$43.00	\$2,451.00	\$70.00	\$3,990.00	\$2,451.00	\$43.00	\$2,451.00	\$2,850.00	\$2,850.00	\$70.00	\$3,990.00	\$52.63	\$2,999.91	\$70.00	\$3,990.00	\$52.63
30	Construction Staking	1 LS	\$3,000.00	\$3,000.00	\$3,000.00	\$3,000.00	\$3,000.00	\$3,000.00	\$3,000.00	\$3,000.00	\$3,500.00	\$3,500.00	\$3,500.00	\$3,500.00	\$3,750.00	\$3,750.00	\$4,500.00	\$3,750.00	\$3,750.00	\$4,500.00
31	Erosion Control	1 LS	\$3,000.00	\$3,000.00	\$1,800.00	\$1,800.00	\$3,000.00	\$1,800.00	\$1,800.00	\$1,800.00	\$4,240.00	\$4,240.00	\$4,240.00	\$4,240.00	\$4,500.00	\$4,500.00	\$82,250.00	\$4,500.00	\$82,250.00	\$4,500.00
32	Pipe Bedding Material Trench Backfill	2,350 CY	\$35.00	\$82,250.00	\$25.00	\$58,750.00	\$35.00	\$82,250.00	\$58,750.00	\$25.00	\$58,750.00	\$78,725.00	\$78,725.00	\$35.00	\$82,250.00	\$35.00	\$82,250.00	\$35.00	\$82,250.00	\$35.00
33	Modified Subbase	410 TON	\$20.00	\$8,200.00	\$28.00	\$11,480.00	\$20.00	\$8,200.00	\$11,480.00	\$28.00	\$11,480.00	\$10,250.00	\$10,250.00	\$20.00	\$8,200.00	\$16.00	\$6,560.00	\$20.00	\$8,200.00	\$16.00
34	HMA Millings, 2"	278 SY	\$12.00	\$3,336.00	\$10.00	\$2,780.00	\$12.00	\$3,336.00	\$2,780.00	\$10.00	\$2,780.00	\$1,668.00	\$1,668.00	\$12.00	\$3,336.00	\$18.00	\$5,016.00	\$12.00	\$3,336.00	\$18.00
35	2' PCC Curb and Gutter, 7" Thick	187 LF	\$35.00	\$6,545.00	\$21.00	\$3,927.00	\$35.00	\$6,545.00	\$3,927.00	\$21.00	\$3,927.00	\$5,423.00	\$5,423.00	\$35.00	\$6,545.00	\$28.00	\$5,236.00	\$35.00	\$6,545.00	\$28.00
36	HMA Overlay	30 TON	\$80.00	\$2,400.00	\$130.00	\$3,900.00	\$80.00	\$2,400.00	\$3,900.00	\$130.00	\$3,900.00	\$4,500.00	\$4,500.00	\$80.00	\$2,400.00	\$125.00	\$3,750.00	\$80.00	\$2,400.00	\$125.00
37	Raised Domed-Sidewalk	64 SF	\$35.00	\$2,240.00	\$31.00	\$1,984.00	\$35.00	\$2,240.00	\$1,984.00	\$31.00	\$1,984.00	\$3,840.00	\$3,840.00	\$35.00	\$2,240.00	\$40.00	\$2,560.00	\$35.00	\$2,240.00	\$40.00
TOTAL CONSTRUCTION COST				\$873,207.00		\$588,000.00		\$873,207.00		\$588,000.00		\$663,244.60		\$873,207.00		\$763,103.71		\$873,207.00		\$763,103.71
PERCENT OF ENGINEER'S ESTIMATE						-32.66%				-32.66%		-24.04%				-12.61%				-12.61%

DEPARTMENT OF ENGINEERING
CITY OF DES MOINES, IOWA

ACTIVITY ID 08-2007-006
IDOT PROJ NO.: None
BID DATE: 3/11/08

TABULATED BY: R. Joanning
CHECKED BY: 

APPROVED BY: 

CONTRACTOR'S BID TABULATION

PROJECT: INGERSOLL RUN STORM SEWER - 34TH ST. TO 35TH ST.

ESTIMATE

ITEM	DESCRIPTION	QUANTITY	UNIT PRICE		AMOUNT		UNIT PRICE	AMOUNT		UNIT PRICE	AMOUNT	
			PRICE	AMOUNT	PRICE	AMOUNT		PRICE	AMOUNT		PRICE	AMOUNT
1	Project Sign	1 LS	\$1,000.00	\$1,000.00	\$1,000.00	\$1,000.00						
2	Mobilization	1 LS	\$80,000.00	\$80,000.00	\$22,500.00	\$22,500.00						
3	Traffic Control	1 LS	\$2,000.00	\$2,000.00	\$2,200.00	\$2,200.00						
4	Pavement Removal / Disposition	2,844 SY	\$7.00	\$19,908.00	\$7.25	\$20,619.00						
5	Sidewalk, Driveway, Removal / Disposition	398 SY	\$7.00	\$2,786.00	\$6.50	\$2,587.00						
6	Subgrade Preparation	2,082 SY	\$5.00	\$10,410.00	\$3.00	\$6,246.00						
7	Subgrade Treatment, Flyash, 6% by Weight	612 SY	\$1.00	\$612.00	\$5.75	\$3,519.00						
8	PCC Pavement, 8"	1,838 SY	\$60.00	\$110,280.00	\$48.00	\$88,224.00						
9	PCC Driveway, 7" Type A	25 SY	\$60.00	\$1,500.00	\$55.00	\$1,375.00						
10	PCC Driveway, 8" Commercial, M-4 Mix	93 SY	\$80.00	\$7,440.00	\$70.00	\$6,510.00						
11	PCC Sidewalk, 4"	76 SY	\$40.00	\$3,040.00	\$36.00	\$2,736.00						
12	PCC Sidewalk, 6"	213 SY	\$50.00	\$10,650.00	\$44.00	\$9,372.00						
13	Storm Sewer, 12" DI Class 350	12 LF	\$100.00	\$1,200.00	\$120.00	\$1,440.00						
14	Storm Sewer, 12" PVC AWWA C900	22 LF	\$60.00	\$1,320.00	\$90.00	\$1,980.00						
15	Storm Sewer, 15" Class 3 RCP	19 LF	\$100.00	\$1,900.00	\$75.00	\$1,425.00						
16	Storm Sewer, 6' x 6' RCBC	695 LF	\$600.00	\$417,000.00	\$555.00	\$385,725.00						
17	Bulkhead	3 EA	\$1,000.00	\$3,000.00	\$2,475.00	\$7,425.00						
18	Storm Manhole, Type M-D, MOD 48"	4 EA	\$2,000.00	\$8,000.00	\$1,650.00	\$6,600.00						
19	Special Structure 4	1 EA	\$30,000.00	\$30,000.00	\$33,800.00	\$33,800.00						
20	Intake, Type M-D	1 EA	\$4,500.00	\$4,500.00	\$2,900.00	\$2,900.00						
21	Intake, RA-43	1 EA	\$3,500.00	\$3,500.00	\$5,150.00	\$5,150.00						
22	Manhole Removal, Storm	1 EA	\$500.00	\$500.00	\$500.00	\$500.00						
23	Intake Removal	2 EA	\$500.00	\$1,000.00	\$1,050.00	\$1,050.00						
24	Remove Storm / Sanitary Pipe	170 LF	\$10.00	\$1,700.00	\$13.00	\$2,210.00						
25	6" Water Main Relocation Location No. 1	1 EA	\$15,000.00	\$15,000.00	\$7,700.00	\$7,700.00						
26	Water Service Relocation, 1"	4 EA	\$4,000.00	\$16,000.00	\$2,500.00	\$10,000.00						
27	Temporary Granular Surfacing Material	120 TON	\$25.00	\$3,000.00	\$20.00	\$2,400.00						
28	Clearing and Grubbing	1 LS	\$1,000.00	\$1,000.00	\$6,000.00	\$6,000.00						
29	Sodding	57 SQ	\$70.00	\$3,990.00	\$42.00	\$2,394.00						
30	Construction Staking	1 LS	\$3,000.00	\$3,000.00	\$2,950.00	\$2,950.00						
31	Erosion Control	1 LS	\$3,000.00	\$3,000.00	\$2,175.00	\$2,175.00						
32	Pipe Bedding Material Trench Backfill	2,350 CY	\$35.00	\$82,250.00	\$40.00	\$94,000.00						
33	Modified Subbase	410 TON	\$20.00	\$8,200.00	\$24.00	\$9,840.00						
34	HMA Millings, 2"	278 SY	\$12.00	\$3,336.00	\$10.00	\$2,780.00						
35	2" PCC Curb and Gutter, 7" Thick	187 LF	\$35.00	\$6,545.00	\$25.00	\$4,675.00						
36	HMA Overlay	30 TON	\$80.00	\$2,400.00	\$125.00	\$3,750.00						
37	Raised Domed-Sidewalk	64 SF	\$35.00	\$2,240.00	\$40.00	\$2,560.00						
				\$873,207.00		\$768,317.00						
TOTAL CONSTRUCTION COST												
PERCENT OF ENGINEER'S ESTIMATE												

Corell Contractor, Inc
West Des Moines IA

BID SECURITY
10% Bid Bond
BID PRICE

Reilly Construction Inc
Osasian IA

BID SECURITY
10% Bid Bond
BID PRICE

H&W Contracting LLC
Sioux Falls SD

BID SECURITY
10% Bid Bond
BID PRICE

TOTAL CONSTRUCTION COST
PERCENT OF ENGINEER'S ESTIMATE

\$797,955.10
-8.62%

\$768,317.00
-12.01%

\$633,060.00
-4.60%

ACTIVITY ID 08-2007-006
 IDOT PROJ NO.: None
 BID DATE: 3/11/08

DEPARTMENT OF ENGINEERING
 CITY OF DES MOINES, IOWA

TABULATED BY: *R. Joanning*
 CHECKED BY: *John F. McKee*
 APPROVED BY: *John F. McKee*

CONTRACTOR'S BID TABULATION
PROJECT: INGERSOLL RUN STORM SEWER - 34TH ST. TO 35TH ST.

ESTIMATE

ITEM	DESCRIPTION	QUANTITY	UNIT PRICE	AMOUNT
1	Project Sign	1 LS	\$1,000.00	\$1,000.00
2	Mobilization	1 LS	\$80,000.00	\$80,000.00
3	Traffic Control	1 LS	\$2,000.00	\$2,000.00
4	Pavement Removal / Disposition	2,844 SY	\$7.00	\$19,908.00
5	Sidewalk, Driveway, Removal / Disposition	398 SY	\$21.00	\$8,358.00
6	Subgrade Preparation	2,082 SY	\$5.00	\$10,410.00
7	Subgrade Treatment, Flyash, 6% by Weight	612 SY	\$1.00	\$612.00
8	PCC Pavement, 8"	1,838 SY	\$60.00	\$110,280.00
9	PCC Driveway, 7" Type A	25 SY	\$60.00	\$1,500.00
10	PCC Driveway, 8" Commercial, M-4 Mix	93 SY	\$80.00	\$7,440.00
11	PCC Sidewalk, 4"	76 SY	\$40.00	\$3,040.00
12	PCC Sidewalk, 6"	213 SY	\$50.00	\$10,650.00
13	Storm Sewer, 12" DI Class 350	12 LF	\$100.00	\$1,200.00
14	Storm Sewer, 12" PVC AWWA C900	22 LF	\$60.00	\$1,320.00
15	Storm Sewer, 15" Class 3 RCP	19 LF	\$100.00	\$1,900.00
16	Storm Sewer, 6' x 6' RCBC	695 LF	\$600.00	\$417,000.00
17	Bulkhead	3 EA	\$1,000.00	\$3,000.00
18	Storm Manhole, Type M-D, MOD 48"	4 EA	\$2,000.00	\$8,000.00
19	Special Structure 4	1 EA	\$30,000.00	\$30,000.00
20	Intake, Type M-D	1 EA	\$4,500.00	\$4,500.00
21	Intake, RA-43	1 EA	\$3,500.00	\$3,500.00
22	Manhole Removal, Storm	1 EA	\$500.00	\$500.00
23	Intake Removal	2 EA	\$500.00	\$1,000.00
24	Remove Storm / Sanitary Pipe	170 LF	\$10.00	\$1,700.00
25	6" Water Main Relocation Location No. 1	1 EA	\$15,000.00	\$15,000.00
26	Water Service Relocation, 1"	4 EA	\$4,000.00	\$16,000.00
27	Temporary Granular Surfacing Material	120 TON	\$25.00	\$3,000.00
28	Clearing and Grubbing	1 LS	\$1,000.00	\$1,000.00
29	Sodding	57 SQ	\$70.00	\$3,990.00
30	Construction Staking	1 LS	\$3,000.00	\$3,000.00
31	Erosion Control	1 LS	\$3,000.00	\$3,000.00
32	Pipe Bedding Material Trench Backfill	2,350 CY	\$35.00	\$82,250.00
33	Modified Subbase	410 TON	\$20.00	\$8,200.00
34	HMA Millings, 2"	278 SY	\$12.00	\$3,336.00
35	2" PCC Curb and Gutter, 7" Thick	187 LF	\$35.00	\$6,545.00
36	HMA Overlay	30 TON	\$80.00	\$2,400.00
37	Raised Domed-Sidewalk	64 SF	\$35.00	\$2,240.00

TOTAL CONSTRUCTION COST
 PERCENT OF ENGINEER'S ESTIMATE

\$873,207.00

Eco-Tech Construction
 Grimes IA

BID SECURITY
 10% Bid Bond
 BID PRICE

UNIT PRICE	AMOUNT
\$1,040.00	\$1,040.00
\$71,000.00	\$71,000.00
\$5,160.00	\$5,160.00
\$6.60	\$18,770.40
\$8.20	\$3,263.60
\$2.90	\$6,037.80
\$2.50	\$1,530.00
\$40.00	\$73,520.00
\$40.00	\$1,000.00
\$43.00	\$3,999.00
\$28.00	\$2,128.00
\$31.00	\$6,603.00
\$119.00	\$1,428.00
\$116.00	\$2,552.00
\$85.00	\$1,615.00
\$727.00	\$505,265.00
\$1,050.00	\$3,150.00
\$2,190.00	\$8,760.00
\$55,500.00	\$55,500.00
\$5,380.00	\$5,380.00
\$5,840.00	\$5,840.00
\$1,050.00	\$1,050.00
\$964.00	\$1,928.00
\$2,040.00	\$2,040.00
\$9,370.00	\$9,370.00
\$2,320.00	\$9,280.00
\$32.00	\$3,840.00
\$520.00	\$520.00
\$49.00	\$2,793.00
\$4,300.00	\$4,300.00
\$6,600.00	\$6,600.00
\$41.00	\$96,350.00
\$23.00	\$9,430.00
\$11.00	\$3,058.00
\$22.00	\$4,114.00
\$137.00	\$4,110.00
\$33.00	\$2,112.00

\$944,436.80 Bid read under advisement
 +8.16% Bidder failed to include proposal
 attachment item 4 completion provisions