

DATE April 7, 2008

PUBLIC HEARING, APPROVING PLANS, SPECIFICATIONS, FORM OF CONTRACT DOCUMENTS, AND ENGINEER'S ESTIMATE ON FLEUR DRIVE BRIDGE OVER THE RACCOON RIVER REHABILITATION; RECEIVE AND FILE BIDS; AND DESIGNATION OF LOWEST RESPONSIVE, RESPONSIBLE BIDDER AS THE TRUESDELL CORPORATION OF WISCONSIN, INC., KURT L. CLINK, PRESIDENT, \$1,424,424.00

WHEREAS, on February 25, 2008, under Roll Call No. 08-283, plans, specifications, form of contract documents, and Jurisdictional Engineer's estimate of construction cost were filed with the City Clerk, for the construction of the following improvement:

Fleur Drive Bridge over the Raccoon River Rehabilitation, 12-2007-005

The improvement includes rehabilitation of the existing bridge superstructure and substructure including concrete removal, structural concrete (bridge), structural steel, reinforced neoprene, steel extrusion joint with neoprene, concrete repair (median and sidewalk), concrete repair (barrier rail), concrete repair (substructure), bridge floor overlay repairs, bridge floor overlay (full depth), sidewalk removal and replacement, jack girders and reset bearings, trim girder ends, drain pipe, epoxy injection, pavement joint repairs, reinforced neoprene trough installation, carbon fiber reinforcing polymer furnish and install, approach repairs, curb repairs, concrete waterproofing, containment, blast cleaning structural steel, paint waste transport/disposal, painting of structural steel, pavement markings/symbols and message boards, construction survey, project sign, traffic control and mobilization; all work in accordance with the contract documents including Plan File Nos. 486-082/134, on the Fleur Drive Bridge over the Raccoon River in Des Moines, Iowa

WHEREAS, notice of the hearing on the plans, specifications, form of contract documents, and Engineer's estimate of construction cost was published as required by law.

NOW, THEREFORE, BE IT RESOLVED BY THE CITY COUNCIL OF THE CITY OF DES MOINES, IOWA: That the hearing on the plans, specifications, form of contract documents, and Jurisdictional Engineer's estimate of construction cost for said improvement be closed; and that said plans, specifications, form of contract documents, and Jurisdictional Engineer's estimate of construction cost are hereby approved as the plans, specifications, form of contract documents, and Jurisdictional Engineer's estimate of construction cost for said improvement.

BE IT FURTHER RESOLVED: That sealed bids for said improvement were submitted by the following bidders:

DATE April 7, 2008

The Truesdell Corporation of Wisconsin, Inc.	Tempe, AZ
Cramer and Associates, Inc.	Grimes, IA
Herberger Construction Co., Inc.	Indianola, IA
United Contractors, Inc.	Johnston, IA

which were received and opened at a public meeting presided over by the Jurisdictional Engineer in the City Council Chambers, 2nd Floor, City Hall, 400 Robert D. Ray Drive, Des Moines, Iowa at 11:00 a.m. on March 25, 2008. Said bids and the attached tabulation of bids for said improvement be and are hereby received and filed.

BE IT FURTHER RESOLVED: That the Jurisdictional Engineer has determined that the lowest responsive, responsible bid for the construction of said improvement was submitted by The Truesdell Corporation of Wisconsin, Inc., Kurt L. Clink, President, 1310 W 23rd Street, Tempe, AZ, 85282 in the amount of \$1,424,424.00, and said bid be and the same is hereby accepted.

BE IT FURTHER RESOLVED: That the bid security of the unsuccessful bidders be and is hereby authorized and directed to be returned.

BE IT FURTHER RESOLVED: That the Jurisdictional Engineer is hereby directed to secure execution by the lowest responsible, responsive Bidder and its surety of the contract documents in the form heretofore approved by this Council; that the Jurisdictional Engineer is directed to thereafter present said contract documents to this Council for approval and authorization to the Mayor to sign; and that no contract shall be deemed to exist between the City of Des Moines and said Bidder until said contract has been executed by the Bidder, and shall have been approved by this Council and executed by the Mayor and attested to by the City Clerk.

(City Council Communication Number 08-198 attached.)

Moved by _____ to adopt.

FORM APPROVED:

FUNDS AVAILABLE

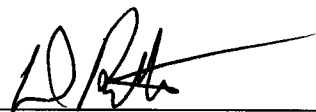
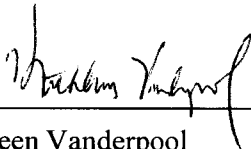

Kathleen Vanderpool
Deputy City Attorney

Allen McKinley
Des Moines Finance Director

JEB Funding Source: 2007-2008 CIP, Page Bridge-17, Structural Repair - Corrosion Protection, BRV039, Being: \$800,000 in Tax Increment Funds and \$624,424 in G. O. Bonds

★ **Roll Call Number**

Agenda Item Number

55

DATE April 7, 2008

COUNCIL ACTION	YEAS	NAYS	PASS	ABSENT
COWNIE				
COLEMAN				
HENSLEY				
KIERNAN				
MAHAFFEY				
MEYER				
VLASSIS				
TOTAL				

MOTION CARRIED

APPROVED

Mayor

I, Diane Rauh, City Clerk of said City Council, hereby certify that at a meeting of the City Council, held on the above date, among other proceedings the above was adopted.

IN WITNESS WHEREOF, I have hereunto set my hand and affixed my seal the day and year first above written.

City Clerk

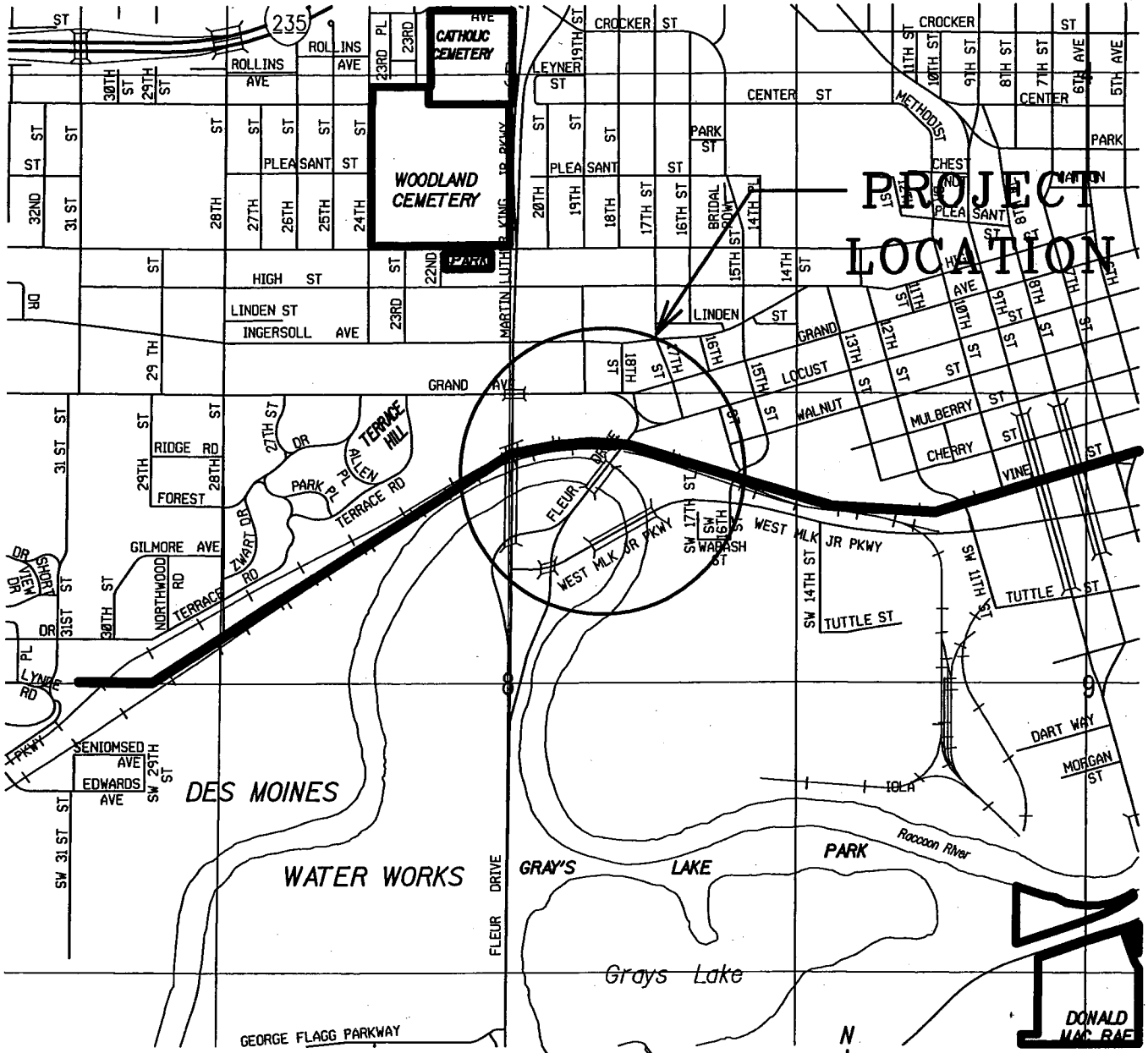

FLEUR DRIVE BRIDGE OVER THE
 RACCOON RIVER
 REHABILITATION
 ACTIVITY I.D. 12-2007-005

TABULATED BY: Jon Fassel
CHECKED BY: *[Signature]*
APPROVED BY: *[Signature]*

CONTRACTOR'S BID TABULATION
PROJECT: FLEUR DRIVE BRIDGE OVER THE RACCOON RIVER REHABILITATION

ESTIMATE

ITEM	DESCRIPTION	QUANTITY	UNIT PRICE	AMOUNT	THE TRUESDELL CORP. OF WISC., INC. PHOENIX, AZ.	CRAMER & ASSOC., INC. GRIMES, IA	HERBERGER CONST. COMPANY, INC. INDIANOLA, IA	UNITED CONTRACTORS, INC. JOHNSTON, IA
			PRICE		BID SECURITY 10% BID BOND BID PRICE	BID SECURITY 10% BID BOND BID PRICE	BID SECURITY 10% BID BOND BID PRICE	BID SECURITY 10% BID BOND BID PRICE
0001	Removals, as Per Plan	1 LS	\$46,000.00	\$46,000.00	\$48,000.00	\$105,000.00	\$85,000.00	\$100,000.00
0002	Structural Concrete (Bridge)	11.3 CY	\$700.00	\$7,910.00	\$888.00	\$3,300.00	\$1,700.00	\$4,000.00
0003	Reinforcing Steel, Epoxy Coated	2318 LB	\$1.50	\$3,477.00	\$2.30	\$5,795.00	\$2.00	\$4,636.00
0004	Structural Steel	9828 LB	\$8.25	\$81,081.00	\$14.00	\$137,592.00	\$23.00	\$226,044.00
0005	Reinforced Neoprene	389 SF	\$45.00	\$17,505.00	\$70.00	\$27,230.00	\$82.00	\$31,898.00
0006	Steel Extrusion Joint with Neoprene	235.25 LF	\$131.00	\$30,817.75	\$188.00	\$44,227.00	\$165.00	\$38,816.25
0007	Concrete Repair for Median and Sidewalks	1267 SF	\$90.00	\$114,030.00	\$50.00	\$63,350.00	\$105.00	\$133,035.00
0008	Concrete Repair for Barrier Rails	684 SF	\$95.00	\$64,980.00	\$50.00	\$34,200.00	\$100.00	\$68,400.00
0009	Concrete Repair for Substructures	1778 SF	\$110.00	\$195,580.00	\$115.00	\$204,470.00	\$160.00	\$284,480.00
0010	Blast Cleaning of Structural Steel	1 LS	\$100,000.00	\$100,000.00	\$67,300.00	\$66,000.00	\$67,000.00	\$74,200.00
0011	Containment	1 LS	\$75,000.00	\$75,000.00	\$62,100.00	\$51,000.00	\$53,000.00	\$42,800.00
0012	Paint Waste Transport and Disposal	1 LS	\$50,000.00	\$50,000.00	\$3,680.00	\$3,600.00	\$4,000.00	\$21,060.00
0013	Painting of Structural Steel	1 LS	\$125,000.00	\$125,000.00	\$131,000.00	\$107,000.00	\$110,000.00	\$206,085.00
0014	Removal of Sidewalk	160 SY	\$7.00	\$1,120.00	\$16.50	\$2,640.00	\$12.00	\$1,920.00
0015	Sidewalk, PCC, 4"	160 SY	\$35.00	\$5,600.00	\$43.00	\$6,880.00	\$43.00	\$6,880.00
0016	Curb, Special	170 LF	\$9.00	\$1,530.00	\$10.50	\$1,785.00	\$10.50	\$1,785.00
0017	Safety Closure	2 EA	\$250.00	\$500.00	\$300.00	\$200.00	\$200.00	\$200.00
0018	Construction Survey	1 LS	\$8,000.00	\$8,000.00	\$7,600.00	\$500.00	\$8,000.00	\$8,000.00
0019	Painted Pav't Mark, Waterborne/Solvent	32 STA	\$50.00	\$1,600.00	\$64.00	\$2,048.00	\$46.00	\$1,472.00
0020	Permanent Tape Mark, Regular Mark Tape	9 STA	\$400.00	\$3,600.00	\$315.00	\$2,835.00	\$245.00	\$2,205.00
0021	Painted Symbol + Legend, Waterborne/Solvent	2 EA	\$100.00	\$200.00	\$150.00	\$90.00	\$80.00	\$85.00
0022	Traffic Control	1 LS	\$10,000.00	\$10,000.00	\$7,620.00	\$9,500.00	\$6,100.00	\$10,000.00
0023	Changeable Message Sign, Portable	42 CDAY	\$75.00	\$3,150.00	\$68.00	\$2,856.00	\$63.00	\$2,646.00
0024	Mobilization	1 LS	\$112,420.00	\$112,420.00	\$77,489.20	\$105,000.00	\$155,000.00	\$210,000.00
0025	Jack Girders and Reset Rocker Bearings	20 EA	\$750.00	\$15,000.00	\$1,150.00	\$23,000.00	\$975.00	\$19,500.00
0026	Temporary Shoring of Girder Ends	8 EA	\$3,300.00	\$26,400.00	\$4,150.00	\$33,200.00	\$5,500.00	\$44,000.00
0027	Trim Steel Girder Ends	3 EA	\$2,000.00	\$6,000.00	\$2,500.00	\$7,500.00	\$2,100.00	\$6,300.00
0028	Drain Pipe	83 LF	\$310.00	\$25,730.00	\$195.00	\$16,185.00	\$175.00	\$14,591.00
0029	Epoxy Crack Injection	100 LF	\$60.00	\$6,000.00	\$21.00	\$2,100.00	\$70.00	\$7,000.00
0030	Pavement Joint Repair	126 LF	\$75.00	\$9,450.00	\$53.50	\$6,741.00	\$50.00	\$6,300.00
0031	Pier 3 Joint Cover Plates	16.75 LF	\$645.00	\$10,803.75	\$540.00	\$9,045.00	\$350.00	\$5,862.50
0032	Sidewalk Rail Repair	1776 LF	\$101.50	\$180,264.00	\$85.00	\$150,960.00	\$105.00	\$186,480.00
0033	Chain Link Fence Repair	1 LS	\$2,000.00	\$2,000.00	\$1,738.00	\$3,500.00	\$2,500.00	\$2,500.00
0034	Reinforced Neoprene Trough Installation	1 LS	\$20,000.00	\$20,000.00	\$27,600.00	\$15,500.00	\$17,000.00	\$10,000.00
0035	Carbon Fiber Reinforcing Polymer (Furnish)	1149 SF	\$14.00	\$16,086.00	\$14.00	\$16,086.00	\$16.30	\$18,728.70
0036	Carbon Fiber Reinforcing Polymer (Installation)	1149 SF	\$20.00	\$22,980.00	\$20.00	\$22,980.00	\$17.40	\$19,992.60
0037	Concrete Waterproofing	989 SF	\$13.00	\$12,857.00	\$9.00	\$8,901.00	\$13.00	\$12,857.00
0038	Bridge Floor Overlay Repair	645 SY	\$156.50	\$100,942.50	\$170.00	\$109,650.00	\$200.00	\$129,000.00
0039	Bridge Floor Overlay Repair (Full Depth)	15 SY	\$270.00	\$4,050.00	\$488.00	\$7,320.00	\$350.00	\$5,250.00
0040	Paint West ML King Bridge Arches Per Specification	1 LS	\$59,000.00	\$59,000.00	\$29,500.00	\$35,000.00	\$30,000.00	\$47,250.00
0041	Project Sign, Supply and Install	1 EA	\$1,000.00	\$1,000.00	\$1,050.00	\$460.00	\$700.00	\$450.00
				\$1,577,664.00	\$1,424,424.00	\$1,525,594.00	\$1,853,809.05	\$2,148,932.20
TOTAL CONSTRUCTION COST								
PERCENT OF ENGINEER'S ESTIMATE					-9.71%	-3.30%	+17.50%	+36.21%

55