

DATE April 7, 2008

ORDERING CONSTRUCTION OF
21ST STREET AND CARPENTER AVENUE STORM SEWER IMPROVEMENTS
AND FIXING A DATE FOR RECEIVING OF BIDS ON APRIL 22, 2008
AND PUBLIC HEARING ON MAY 5, 2008
ENGINEER'S ESTIMATE IS \$1,463,388.50

BE IT RESOLVED BY THE CITY COUNCIL OF THE CITY OF DES MOINES, IOWA: That the attached communication recommending construction of the following improvement and the method of financing; and also including the recommendation of the Des Moines City Engineer, as the Jurisdictional Engineer, submitting plans, specifications, form of contract documents, and Jurisdictional Engineer's estimate of cost for the construction of the following improvement:

21st Street and Carpenter Avenue Storm Sewer Improvements, 07-2006-006

The improvement includes constructing 3,100 LF of 12" through 54" storm sewers, 15 storm manholes, 32 storm intakes, special structure, 8" and 9" base PCC pavement with HMA overlay, 6" and 8" PCC driveways, 4" PCC sidewalks, water main relocation, and miscellaneous associated work including cleanup; in accordance with the contract documents, including Plan File Nos. 489-025/043, located on Carpenter Avenue from 21st Street to 25th Street, on University Avenue from 22nd Street to 23rd Street and on 22nd Street from Carpenter Avenue to University Avenue, Des Moines, Iowa

be and the same are hereby approved and accepted. The estimated construction cost for said improvement is \$1,463,388.50. The proposed plans, specifications, and form of contract documents are available for public inspection in the City Engineer's Office.

BE IT FURTHER RESOLVED: That this Council hereby determines that it is necessary and advisable to construct said improvement in the manner set forth in the plans, specifications, and form of contract documents submitted by the Jurisdictional Engineer; and that payment for the cost of said improvement shall be paid from from the funding source identified below.

BE IT FURTHER RESOLVED: That a public hearing on said plans, specifications, form of contract documents, and Jurisdictional Engineer's estimate of construction cost for said improvement be held in the City Council Chambers, 2nd Floor, City Hall, 400 Robert D. Ray Drive, Des Moines, Iowa, at 5:00 p.m. on May 5, 2008, at which time this Council will consider any objections offered thereto or to the making of said improvement.

BE IT FURTHER RESOLVED: That proposals will be received by the City of Des Moines, at the office of the City Clerk until 11:00 a.m. on April 22, 2008, for the construction of said improvement, and the taking of bids in the manner required by law. Proposals received will be opened at a public meeting presided over by the Jurisdictional Engineer in the City Council Chambers, 2nd Floor, City Hall, 400 Robert D. Ray Drive, Des Moines, Iowa, at 11:00 a.m. on April 22, 2008, after which the bids together with a bid tabulation and recommendation of the Jurisdictional Engineer will be presented to the City Council at its next meeting for action thereon.

Roll Call Number

Agenda Item Number

7C

DATE April 7, 2008

BE IT FURTHER RESOLVED: That the City Clerk is further directed to publish a Public Notice of Storm Water Discharge in the Des Moines Register and The Business Record as required by the Iowa Department of Natural Resources.

BE IT FURTHER RESOLVED: That the City Manager be and is hereby authorized and directed to certify the "Notice of Intent for NPDES Coverage under General Permit No. 2 for Storm Water Discharges associated with Industrial Activity for Construction Activities" on behalf of the City of Des Moines and submit said document to the Iowa Department of Natural Resources with appropriate application and permit fees.

BE IT FURTHER RESOLVED: That an appropriate Notice to Bidders and Notice of Public Hearing for said improvement be published in the Des Moines Register as provided and directed by Chapter 26 and/or 314, Code of Iowa.

(City Council Communication Number 08-194 attached.)

Moved by _____ to adopt.

FORM APPROVED:

FUNDS AVAILABLE

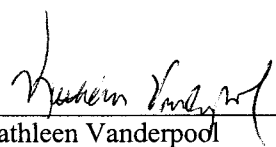

Kathleen Vanderpool
Deputy City Attorney

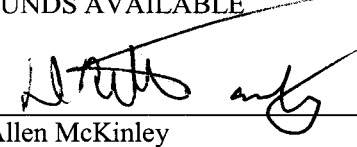

Allen McKinley
Des Moines Finance Director

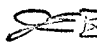
 Funding Source: 2007-2008 CIP, Page Sanitary-7, CSO Flow Meter Installation, SAE083, Being: \$713,388.50 in Sanitary Sewer Funds and \$750,000 in Storm Water Utility Funds

COUNCIL ACTION	YEAS	NAYS	PASS	ABSENT
COWNIE				
COLEMAN				
HENSLEY				
KIERNAN				
MAHAFFEY				
MEYER				
VLASSIS				
TOTAL				
MOTION CARRIED		APPROVED		
_____ Mayor				

CERTIFICATE

I, DIANE RAUH, City Clerk of said City hereby certify that at a meeting of the City Council of said City of Des Moines, held on the above date, among other proceedings the above was adopted.

IN WITNESS WHEREOF, I have hereunto set my hand and affixed my seal the day and year first above written.

City Clerk

TI:\ENG\Design\07-2006\006\Drawings\Loc_Map\LOC_MAP.DGN 12-MAR-2008 15:05

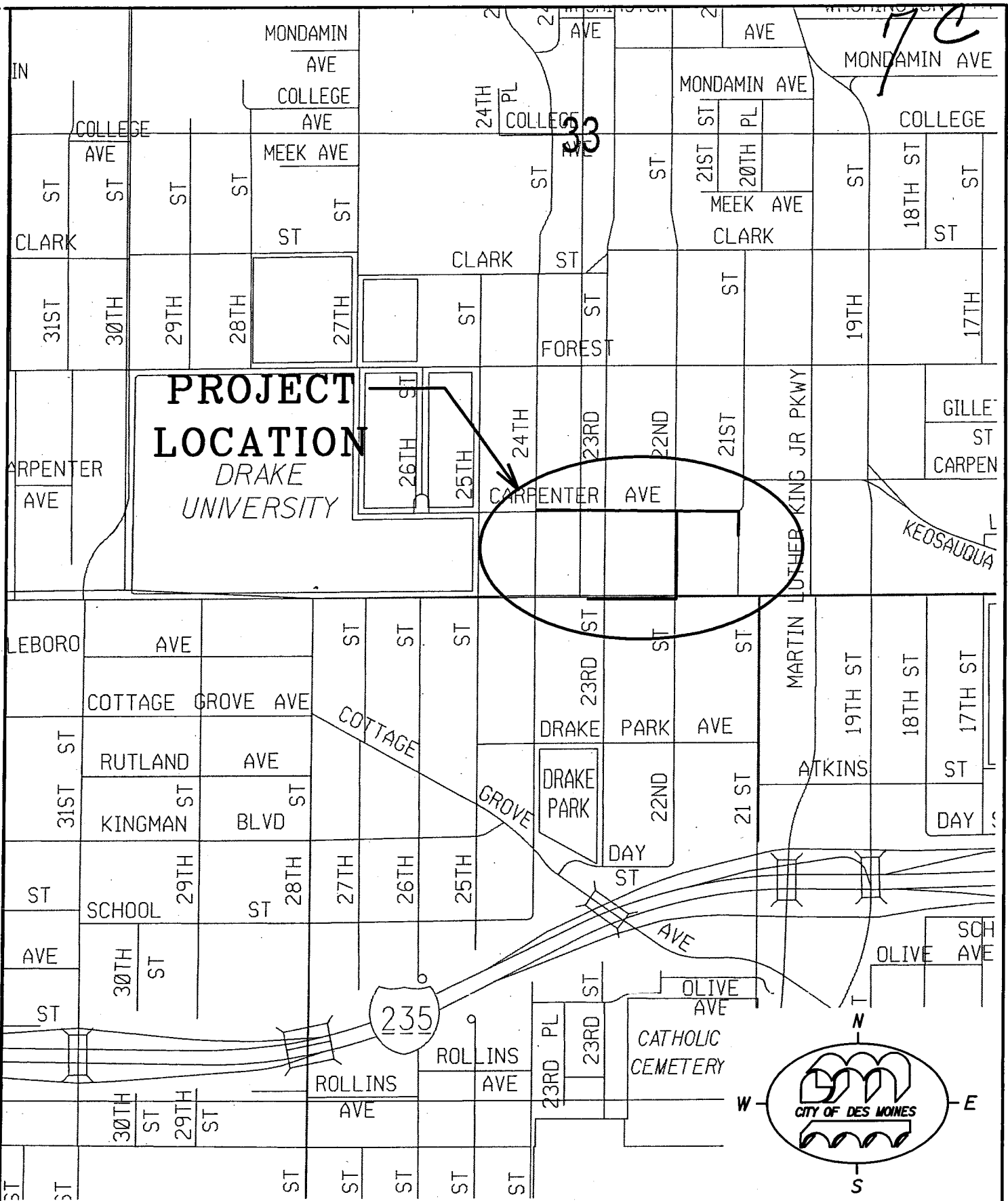

**21ST STREET AND CARPENTER AVENUE
STORM SEWER IMPROVEMENTS
ACTIVITY I.D. 07-2006-006**

7c

CONSTRUCTION ESTIMATE

DEPARTMENT OF ENGINEERING
CITY OF DES MOINES, IOWA

ACTIVITY ID 07-2006-006
IDOT PROJ NO.: None
DATE: 3/24/2008

PROJECT: 21ST STREET AND CARPENTER AVENUE STORM SEWER IMPROVEMENTS

NO.	DESCRIPTION	ESTIMATED UNITS			AMOUNT
		UNIT	TOTAL	UNIT PRICE	TOTAL
1	* Project Sign, Small	LS	1	\$1,000.00	\$1,000.00
2	* Mobilization	LS	1	\$70,000.00	\$70,000.00
3	* Traffic Control	LS	1	\$10,000.00	\$10,000.00
4	* Pavement Scarification, HMA Milling	SY	7,600	\$5.00	\$38,000.00
5	* Pavement Removal/Disposition	SY	4,995	\$5.00	\$24,975.00
6	* Sidewalk, Driveway, Removal/Disposition	SY	850	\$4.00	\$3,400.00
7	Subgrade Preparation	SY	5,502	\$3.00	\$16,506.00
8	Subgrade Treatment, Flyash, 6% by Weight	SY	2,750	\$6.00	\$16,500.00
9	PCC Pavement, 8" Base, Integral Curb	SY	4,012	\$47.00	\$188,564.00
10	PCC Pavement, 9" Base, Integral Curb	SY	983	\$50.00	\$49,150.00
11	HMA 3M S 1/2, 2" Thickness	TON	930	\$70.00	\$65,100.00
12	PCC Commercial Driveway, 8" Type C, 10' Radius	SY	100	\$45.00	\$4,500.00
13	PCC Driveway, 6" Type A	SY	200	\$35.00	\$7,000.00
14	PCC Sidewalk, 4"	SY	600	\$30.00	\$18,000.00
15	Detectable Warnings	SF	320	\$30.00	\$9,600.00
16	Storm Sewer, 12" Class 3 RCP	LF	7.5	\$60.00	\$450.00
17	Storm Sewer, 15" Class 3 RCP	LF	234.5	\$65.00	\$15,242.50
18	Storm Sewer, 18" Class 3 RCP	LF	442.3	\$70.00	\$30,961.00
19	Storm Sewer, 21" Class 3 RCP	LF	75.5	\$80.00	\$6,040.00
20	Storm Sewer, 24" Class 3 RCP	LF	185.5	\$100.00	\$18,550.00
21	Storm Sewer, 30" Class 3 RCP	LF	363.5	\$120.00	\$43,620.00
22	Storm Sewer, 36" Class 3 RCP	LF	550	\$140.00	\$77,000.00
23	Storm Sewer, 42" Class 3 RCP	LF	397.5	\$180.00	\$71,550.00
24	Storm Sewer, 48" Class 3 RCP	LF	381	\$220.00	\$83,820.00

70

NO.	DESCRIPTION	ESTIMATED UNITS			AMOUNT
		UNIT	TOTAL	UNIT PRICE	TOTAL
25	Storm Sewer, 54" Class 3 RCP	LF	334	\$245.00	\$81,830.00
26	Storm Sewer, 54" Class 3 RCAP	LF	24	\$280.00	\$6,720.00
27	Storm Sewer, 18" Class 4 RCP Jacked in Place without Casing Pipe	LF	32	\$500.00	\$16,000.00
28	Storm Sewer, 36" Class 4 RCP Jacked in Place without Casing Pipe	LF	56	\$700.00	\$39,200.00
29	Storm Sewer, 36" DI	LF	15	\$160.00	\$2,400.00
30	Storm Manhole, Type M-A, 60"	EACH	2	\$3,500.00	\$7,000.00
31	Storm Manhole, Type M-A, 72"	EACH	3	\$4,500.00	\$13,500.00
32	Storm Manhole, Type M-C	EACH	7	\$7,500.00	\$52,500.00
33	Storm Manhole, Type M-D	EACH	3	\$8,500.00	\$25,500.00
34	Connection to Existing Manhole, Storm	LS	1	\$20,000.00	\$20,000.00
35	Intake, Type M-A	EACH	2	\$2,500.00	\$5,000.00
36	Intake, Type M-D	EACH	1	\$3,500.00	\$3,500.00
37	Intake, Type M-F	EACH	17	\$3,000.00	\$51,000.00
38	Intake, Type M-I	EACH	10	\$4,000.00	\$40,000.00
39	Intake, Type M-I Modified	EACH	1	\$4,500.00	\$4,500.00
40	Intake, Type RA-41	EACH	1	\$3,500.00	\$3,500.00
41	Special Structure 1	LS	1	\$12,000.00	\$12,000.00
42 *	Manhole Removal, Storm	EACH	2	\$1,000.00	\$2,000.00
43 *	Intake Removal	EACH	15	\$500.00	\$7,500.00
44	Standard Sewer Plug, 8"-30"	EACH	25	\$250.00	\$6,250.00
45	Special Sewer Plug, 48"	LS	1	\$5,000.00	\$5,000.00
46	Sanitary Sewer, 16" DI	LF	20	\$125.00	\$2,500.00
47	Sanitary Sewer Service Pipe, 6"	LF	400	\$60.00	\$24,000.00
48	Sanitary Sewer Service Connections	EACH	14	\$1,000.00	\$14,000.00
49	8" Water Main Relocation Location No. 1	LS	1	\$12,000.00	\$12,000.00
50	8" Water Main Relocation Location No. 2	LS	1	\$12,000.00	\$12,000.00
51 *	Water Service Depth Check	EACH	14	\$500.00	\$7,000.00
52	Lower Water Service	EACH	6	\$1,500.00	\$9,000.00

7c

NO.	DESCRIPTION	ESTIMATED UNITS			AMOUNT
		UNIT	TOTAL	UNIT PRICE	TOTAL
53	New Water Service	EACH	8	\$3,500.00	\$28,000.00
54	Water Service Relocation	EACH	1	\$4,000.00	\$4,000.00
55	New Water Service Corporation	EACH	8	\$500.00	\$4,000.00
56	Granular Stabilization Material	TON	240	\$30.00	\$7,200.00
57 *	Temporary Granular Surfacing Material	TON	300	\$30.00	\$9,000.00
58 *	Clearing and Grubbing	LS	1	\$5,000.00	\$5,000.00
59 *	Sodding	SQ	300	\$50.00	\$15,000.00
60 *	Silt Fence	LF	200	\$3.00	\$600.00
61 *	Inlet Filter	EACH	33	\$20.00	\$660.00
62 *	Construction Staking	LS	1	\$10,000.00	\$10,000.00
63 *	Erosion Control	LS	1	\$7,000.00	\$7,000.00
64	Tree Planting, Swamp White Oak, 1-1/2", B&B	EACH	4	\$500.00	\$2,000.00
65	Tree Planting, Skyline Honeylocust, 1-1/2", B&B	EACH	2	\$500.00	\$1,000.00
66	Road Closure, Remove and Replace	EACH	2	\$7,500.00	\$15,000.00

Prepared By: Roger Joanning

Checked By: _____

TOTAL CONSTRUCTION COST \$1,463,388.50

* Item does not have to be included in 4-year maintenance bond, but shall be covered by a 1-year maintenance bond.

* Estimate Total= \$218,335.00