

DATE June 14, 2010

ORDERING CONSTRUCTION OF  
LOWER UNION PARK SEWER SEPARATION  
AND FIXING A DATE FOR RECEIVING OF BIDS ON JUNE 29, 2010  
AND PUBLIC HEARING ON JULY 12, 2010  
ENGINEER'S ESTIMATE IS \$4,923,217.00

BE IT RESOLVED BY THE CITY COUNCIL OF THE CITY OF DES MOINES, IOWA: That the attached communication recommending construction of the following improvement and the method of financing; and also including the recommendation of the Des Moines City Engineer, as the Jurisdictional Engineer, submitting plans, specifications, form of contract documents, and Jurisdictional Engineer's estimate of cost for the construction of the following improvement:

Lower Union Park Sewer Separation, 08-2010-008  
08-DRI-033

This improvement includes approximately 9,300 linear feet of 12-inch through 60-inch storm sewer pipe, 880 linear feet of 12-inch through 20-inch sanitary sewer pipe, 24,000 square yards of PCC pavement, 1,500 tons of 2-inch HMA overlay, 1,800 square yards of PCC driveway, 3,450 square yards of PCC sidewalk, storm and sanitary manholes, intakes, sanitary sewer service line, erosion control, tree removal and protection, sewer abandonment and other related items; all in accordance with the contract documents, including Plan File Nos. 517-050/121. This project is located along Thompson Avenue from East Ninth Street to York Street, on East 12th Street and on East 13th Street from Thompson Avenue to Mattern Avenue, on East Washington Avenue from Pennsylvania Avenue to East Ninth Street, on East Ninth Street from East Washington Avenue to Garfield Avenue, on Cleveland Avenue from East Ninth Street to East 13th Street, on Garfield Avenue from East Ninth Street to East 12th Street, on East 13th Street from East Washington Avenue south 1/2 block, on East 15th Street from Garfield Avenue to East University Avenue and on East 13th Street from Morton Avenue to East Sheridan Avenue; all in the City of Des Moines, Iowa

be and the same are hereby approved and accepted. The estimated construction cost for said improvement is \$4,923,217.00. The proposed plans, specifications, and form of contract documents are available for public inspection in the City Engineer's Office.

BE IT FURTHER RESOLVED: That this Council hereby determines that it is necessary and advisable to construct said improvement in the manner set forth in the plans, specifications, and form of contract documents submitted by the Jurisdictional Engineer; and that payment for the cost of said improvement shall be paid from the funding source identified below.

BE IT FURTHER RESOLVED: That a public hearing on said plans, specifications, form of contract documents, and Jurisdictional Engineer's estimate of construction cost for said improvement be held in the City Council Chambers, 2nd Floor, City Hall, 400 Robert D. Ray Drive, Des Moines, Iowa, at 5:00 p.m. on July 12, 2010, at which time this Council will consider any objections offered thereto or to the making of said improvement.



**Roll Call Number**

**Agenda Item Number**

7C

DATE June 14, 2010

BE IT FURTHER RESOLVED: That proposals will be received by the City of Des Moines, at the office of the City Clerk until 11:00 a.m. on June 29, 2010, for the construction of said improvement, and the taking of bids in the manner required by law. Proposals received will be opened at a public meeting presided over by the Jurisdictional Engineer in the City Council Chambers, 2nd Floor, City Hall, 400 Robert D. Ray Drive, Des Moines, Iowa, at 11:00 a.m. on June 29, 2010, after which the bids together with a bid tabulation and recommendation of the Jurisdictional Engineer will be presented to the City Council at its next meeting for action thereon.

BE IT FURTHER RESOLVED: That the City Clerk is further directed to publish a Public Notice of Storm Water Discharge in the Des Moines Register and The Business Record as required by the Iowa Department of Natural Resources.

BE IT FURTHER RESOLVED: That the City Manager be and is hereby authorized and directed to certify the "Notice of Intent for NPDES Coverage under General Permit No. 2 for Storm Water Discharges associated with Industrial Activity for Construction Activities" on behalf of the City of Des Moines and submit said document to the Iowa Department of Natural Resources with appropriate application and permit fees.

BE IT FURTHER RESOLVED: That an appropriate Notice to Bidders and Notice of Public Hearing for said improvement be published in the Des Moines Register as provided and directed by Chapter 26 and/or 314, Code of Iowa.

(City Council Communication Number 10-345 attached.)

Moved by \_\_\_\_\_ to adopt.

FORM APPROVED:

FUNDS AVAILABLE

Kathleen Vanderpool  
Deputy City Attorney

Allen McKinley  
Des Moines Finance Director

Funding Source: 2010-2011 CIP, Page Sanitary-7, CSS - Lower Union Park Sewer Separation Project, SAE126, Being: \$4,923,217 in HUD Disaster funds from the Iowa Department of Economic Development for 100% of construction costs associated with the Lower Union Park Sewer Separation with a \$5,000,000 maximum in Federal Jumpstart Infrastructure Assistance funds



**Roll Call Number**

.....

**Agenda Item Number**

7C

**Date** June 14, 2010

COUNCIL ACTION	YEAS	NAYS	PASS	ABSENT
COWNIE				
COLEMAN				
GREISS				
HENSLEY				
MAHAFFEY				
MEYER				
MOORE				
TOTAL				

**CERTIFICATE**

I, DIANE RAUH, City Clerk of said City hereby certify that at a meeting of the City Council of said City of Des Moines, held on the above date, among other proceedings the above was adopted.

IN WITNESS WHEREOF, I have hereunto set my hand and affixed my seal the day and year first above written.

MOTION CARRIED APPROVED

\_\_\_\_\_  
Mayor

\_\_\_\_\_  
City Clerk

7C

PROJECT LOCATION

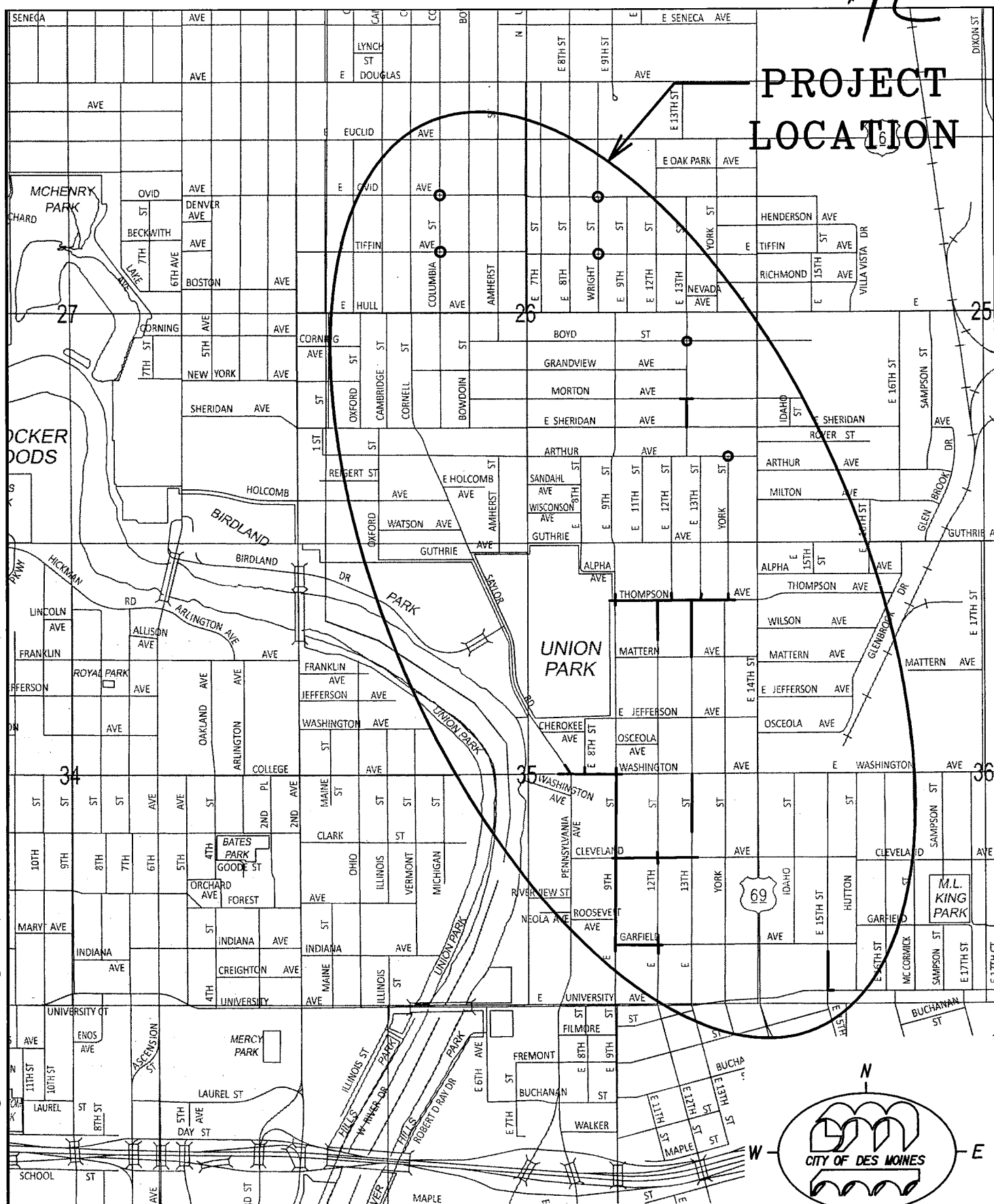

Tr:\ENCL\Design\08\2010\008\Drawings\Loc\_Map\LOC\_MAP.DGN 15-APR-2010 11:16

**LOWER UNION PARK  
STORM SEWER IMPROVEMENTS  
ACTIVITY ID 08-2010-00**

70

**CONSTRUCTION ESTIMATE**DEPARTMENT OF ENGINEERING  
CITY OF DES MOINES, IOWAActivity ID 08-2010-008  
IDOT PROJ NO.: None  
DATE: 6/10/10**PROJECT: LOWER UNION PARK SEWER SEPARATION**

NO.	DESCRIPTION	ESTIMATED UNITS			AMOUNT
		UNIT	TOTAL	UNIT PRICE	TOTAL
1	* Large Project Sign - IDED	LS	1	\$2,000.00	\$2,000.00
2	* Mobilization	LS	1	\$112,578.00	\$112,578.00
3	* Field Office and Staging Area	LS	1	\$30,000.00	\$30,000.00
4	* Traffic Control	LS	1	\$30,000.00	\$30,000.00
5	* Driveway, Alley, Sidewalk Removal/Disposition	SY	5454	\$8.00	\$43,632.00
6	* Pavement Removal/Disposition	SY	21221	\$8.00	\$169,768.00
7	Subgrade Preparation	SY	23980	\$4.00	\$95,920.00
8	PCC Pavement, 8"	SY	12877	\$50.00	\$643,850.00
9	PCC Pavement, 9"	SY	2118	\$65.00	\$137,670.00
10	PCC Pavement, 8" Base, Integral Curb	SY	6158	\$45.00	\$277,110.00
11	PCC Curb and Gutter, 8", 3.0' Wide	LF	15	\$50.00	\$750.00
12	* Milling for Resurfacing	SY	7605	\$2.00	\$15,210.00
13	HMA 1M S 1/2, 2" Thickness	TON	1502	\$75.00	\$112,650.00
14	PCC Alley, 7" Type C, 5'-10' Radius	SY	192	\$45.00	\$8,640.00
15	PCC Driveway, 6" Type A	SY	1824	\$40.00	\$72,960.00
16	PCC Sidewalk, 4"	SY	3510	\$35.00	\$122,850.00
17	Detectable Warnings	SF	798	\$45.00	\$35,910.00
18	Storm Sewer, 12" Class 3 RCP	LF	321.5	\$85.00	\$27,327.50
19	Storm Sewer, 15" Class 3 RCP	LF	2061.9	\$100.00	\$206,190.00
20	Storm Sewer, 18" Class 3 RCP	LF	466.7	\$100.00	\$46,670.00
21	Storm Sewer, 21" Class 3 RCP	LF	478.5	\$120.00	\$57,420.00
22	Storm Sewer, 24" Class 3 RCP	LF	804.9	\$130.00	\$104,637.00
23	Storm Sewer, 27" Class 3 RCP	LF	786.4	\$135.00	\$106,164.00
24	Storm Sewer, 30" Class 3 RCP	LF	306.9	\$140.00	\$42,966.00

7c

NO.	DESCRIPTION	ESTIMATED UNITS			AMOUNT
		UNIT	TOTAL	UNIT PRICE	TOTAL
25	Storm Sewer, 36" Class 3 RCP	LF	852.4	\$145.00	\$123,598.00
26	Storm Sewer, 36" Class 5 RCP	LF	110	\$200.00	\$22,000.00
27	Storm Sewer, 42" Class 3 RCP	LF	911.1	\$180.00	\$163,998.00
28	Storm Sewer, 42" Class 5 RCP	LF	14.4	\$280.00	\$4,032.00
29	Storm Sewer, 48" Class 3 RCP	LF	494	\$220.00	\$108,680.00
30	Storm Sewer, 48" Class 4 RCP	LF	204.7	\$270.00	\$55,269.00
31	Storm Sewer, 54" Class 4 RCP	LF	179.6	\$350.00	\$62,860.00
32	Storm Sewer, 60" Class 3 RCP	LF	604.2	\$450.00	\$271,890.00
33	Storm Sewer, 48" RCAP	LF	535.1	\$250.00	\$133,775.00
34	Storm Sewer, 42" Class 5 RCP, Jacked in Place	LF	90	\$650.00	\$58,500.00
35	Storm Sewer, 6' X 5' RCBC	LF	10	\$400.00	\$4,000.00
36	Storm Manhole, Type M-A, 48"	EA	8	\$3,000.00	\$24,000.00
37	Storm Manhole, Type M-A, 60"	EA	3	\$4,500.00	\$13,500.00
38	Storm Manhole, Type M-A, 84"	EA	2	\$8,500.00	\$17,000.00
39	Storm Manhole, Type M-C	EA	14	\$4,500.00	\$63,000.00
40	Storm Manhole, Type M-C (modified)	EA	2	\$4,500.00	\$9,000.00
41	Storm Manhole, Type M-D	EA	6	\$8,500.00	\$51,000.00
42	Storm Manhole, Type M-E	EA	1	\$2,500.00	\$2,500.00
43	Special Structure 1	LS	1	\$15,000.00	\$15,000.00
44	Intake, Type M-A	EA	13	\$2,500.00	\$32,500.00
45	Intake, Type M-B	EA	2	\$2,500.00	\$5,000.00
46	Intake, Type M-D	EA	15	\$3,000.00	\$45,000.00
47	Intake, Type M-E	EA	2	\$3,000.00	\$6,000.00
48	Intake, Type M-F	EA	19	\$2,500.00	\$47,500.00
49	Intake, Type M-F (modified)	EA	1	\$2,750.00	\$2,750.00
50	Intake, Type M-I	EA	10	\$3,000.00	\$30,000.00
51	Intake, RA-41 w/ RA-42 Extension	EA	2	\$3,500.00	\$7,000.00
52	Intake, RA-43	EA	3	\$3,500.00	\$10,500.00

70

NO.	DESCRIPTION	ESTIMATED UNITS			AMOUNT
		UNIT	TOTAL	UNIT PRICE	TOTAL
53 *	Manhole Removal, Storm	EA	7	\$600.00	\$4,200.00
54 *	Abandon Manhole	EA	1	\$500.00	\$500.00
55 *	Intake Removal	EA	34	\$600.00	\$20,400.00
56	Storm Sewer Service, 8"	EA	3	\$1,500.00	\$4,500.00
57 *	Remove Storm/Sanitary Pipe, less than or equal to 30"	LF	1425	\$10.00	\$14,250.00
58 *	Remove Storm/Sanitary Pipe, greater than 36"	LF	30	\$15.00	\$450.00
59	Standard Sewer Plug 8" -30"	EA	45	\$100.00	\$4,500.00
60	Standard Sewer Plug 36" or greater	EA	9	\$250.00	\$2,250.00
61 *	Abandon Storm/Sanitary Sewer in place with Flowable Mortar 12"-30"	LF	225	\$15.00	\$3,375.00
62 *	Abandon Storm/Sanitary Sewer in place with Flowable Mortar 36"	LF	508	\$20.00	\$10,160.00
63	Sanitary Sewer, 10" DI	LF	30	\$150.00	\$4,500.00
64	Sanitary Sewer, 12"	LF	8	\$150.00	\$1,200.00
65	Sanitary Sewer, 12" DI	LF	150	\$180.00	\$27,000.00
66	Sanitary Sewer, 15"	LF	435	\$150.00	\$65,250.00
67	Sanitary Sewer, 18"	LF	83	\$180.00	\$14,940.00
68	Sanitary Sewer, 18" DI	LF	75	\$200.00	\$15,000.00
69	Sanitary Sewer, 20" DI	LF	100	\$260.00	\$26,000.00
70	Drop Connection, 12" DI	VF	9	\$300.00	\$2,700.00
71	Drop Connection, 20" DI	VF	5	\$500.00	\$2,500.00
72	Sanitary Manhole, Type A, 48"	EA	5	\$3,000.00	\$15,000.00
73 *	Remove Manhole, Sanitary	EA	3	\$300.00	\$900.00
74	Sanitary Sewer Service Pipe, 6"	LF	2675	\$90.00	\$240,750.00
75	Sanitary Sewer Service Connections	EA	84	\$700.00	\$58,800.00
76	Sanitary Sewer Service Relocation #1	LS	1	\$8,000.00	\$8,000.00
77	8" Water Main Relocation 1	LS	1	\$7,000.00	\$7,000.00
78.	Water Service Relocation/New Service	EA	73	\$2,000.00	\$146,000.00
79	Storm Sewer, 10" PVC, SDR 35	LF	380	\$80.00	\$30,400.00
80	Storm Sewer, 10" PVC, in 18" Steel Casing, Augured	LF	68.5	\$275.00	\$18,837.50

7c

NO.	DESCRIPTION	ESTIMATED UNITS			AMOUNT
		UNIT	TOTAL	UNIT PRICE	TOTAL
81	Storm Sewer Cleanout, 10"	EA	3	\$1,500.00	\$4,500.00
82 *	Granular Surfacing Material	TON	200	\$30.00	\$6,000.00
83 *	Clearing and Grubbing	DI	1724	\$35.00	\$60,340.00
84 *	Tree Protection	LS	1	\$1,000.00	\$1,000.00
85 *	Tree Protection Fence	LF	1070	\$2.00	\$2,140.00
86 *	Sodding	SQ	964	\$50.00	\$48,200.00
87 *	Construction Staking	LS	1	\$40,000.00	\$40,000.00
88 *	Erosion Control	LS	1	\$3,000.00	\$3,000.00
89 *	Inlet Filter	EA	50	\$250.00	\$12,500.00
90 *	Silt Fence or Sock	LF	2000	\$2.00	\$4,000.00
91	Traffic Signal Modification	LS	1	\$2,000.00	\$2,000.00
92	Type 'B' Casting	EA	20	\$450.00	\$9,000.00
93	Install Chimney Seal on Existing Manhole	EA	20	\$750.00	\$15,000.00
94	Manhole Adjustment, Major	EA	20	\$1,500.00	\$30,000.00
95 *	Subgrade Core Out Excavation	CY	300	\$10.00	\$3,000.00
96	Subgrade Replacement	SY	1700	\$5.00	\$8,500.00
97	Fence Removal and Replacement	LF	45	\$50.00	\$2,250.00
98	Steel Sheet Piling	LS	1	\$12,000.00	\$12,000.00
99	Concrete Headwall	LS	1	\$15,000.00	\$15,000.00
100 *	Seed and Mulch	AC	0.3	\$4,000.00	\$1,200.00
101 *	Rip Rap, Class D	Ton	30	\$50.00	\$1,500.00

Prepared By: Roger Joanning

Checked By: \_\_\_\_\_

**TOTAL CONSTRUCTION COST**

\$4,923,217.00

\* Item does not have to be included in 4-year maintenance bond, but shall be covered by a 1-year maintenance bond.

\* Estimate Total= \$640,303.00