

DATE July 12, 2010

PUBLIC HEARING ON LOWER UNION PARK SEWER SEPARATION REGARDING:

1. APPROVING PLANS, SPECIFICATIONS, FORM OF CONTRACT DOCUMENTS, AND ENGINEER'S ESTIMATE; AND
  2. THE STATUS OF THE FUNDED ACTIVITIES UNDER IDED CONTRACT 08-DRI-033;
- ALSO RESOLUTION TO RECEIVE AND FILE BIDS; DESIGNATION OF LOWEST RESPONSIVE, RESPONSIBLE BIDDER AS VAN HAUEN & ASSOCIATES, INC., BRIAN TANCOS, PRESIDENT, \$4,337,374.40

WHEREAS, on June 14, 2010, under Roll Call No. 10-880, plans, specifications, form of contract documents, and Jurisdictional Engineer's estimate of construction cost were filed with the City Clerk, for the construction of the following improvement:

Lower Union Park Sewer Separation, 08-2010-008  
08-DRI-033

This improvement includes approximately 9,300 linear feet of 12-inch through 60-inch storm sewer pipe, 880 linear feet of 12-inch through 20-inch sanitary sewer pipe, 24,000 square yards of PCC pavement, 1,500 tons of 2-inch HMA overlay, 1,800 square yards of PCC driveway, 3,450 square yards of PCC sidewalk, storm and sanitary manholes, intakes, sanitary sewer service line, erosion control, tree removal and protection, sewer abandonment and other related items; all in accordance with the contract documents, including Plan File Nos. 517-050/121. This project is located along Thompson Avenue from East Ninth Street to York Street, on East 12th Street and on East 13th Street from Thompson Avenue to Mattern Avenue, on East Washington Avenue from Pennsylvania Avenue to East Ninth Street, on East Ninth Street from East Washington Avenue to Garfield Avenue, on Cleveland Avenue from East Ninth Street to East 13th Street, on Garfield Avenue from East Ninth Street to East 12th Street, on East 13th Street from East Washington Avenue south 1/2 block, on East 15th Street from Garfield Avenue to East University Avenue and on East 13th Street from Morton Avenue to East Sheridan Avenue; all in the City of Des Moines, Iowa

WHEREAS, notice of the hearing on the plans, specifications, form of contract documents, and Engineer's estimate of construction cost was published as required by law.

WHEREAS, on June 16, 2010, notice was also published of a hearing pursuant to the requirements of Section 508 of the Housing and Community Development Act of 1987, as amended. The purpose of the hearing is to discuss the status of funding for the proposed Lower Union Sewer Separation Project, Iowa Department of Economic Development Contract Number 08-DRI-033. This project includes approximately 9,300 linear feet of 12-inch through 60-inch storm sewer pipe, 880 linear feet of 12-inch through 20-inch sanitary sewer pipe, 24,000 square yards of PCC pavement, 1,500 tons of 2-inch HMA overlay, 1,800 square yards of PCC driveway, 3,450 square yards of PCC sidewalk, storm and sanitary manholes, intakes, sanitary sewer service line, erosion control, tree removal and protection, sewer abandonment and other related items; all in accordance with the contract documents, including Plan File Nos. 517-050/121. This project is located along Thompson Avenue from East Ninth Street to York Street, on East 12th Street and on East 13th Street from Thompson Avenue to Mattern Avenue, on East Washington Avenue from Pennsylvania Avenue to East Ninth Street, on East Ninth Street from East Washington Avenue to Garfield Avenue, on Cleveland Avenue from East Ninth Street to East 13th Street, on Garfield Avenue from East Ninth Street to East 12th Street, on East 13th Street from East Washington Avenue south 1/2 block, on East 15th Street from Garfield Avenue to East University Avenue and on East 13th Street from Morton Avenue to East Sheridan Avenue; all in the City of Des Moines, Iowa. The project is being funded in part through a Community Development Block Grant provided by the Iowa Department of Economic Development and Des Moines Storm Water Utility Funds, as detailed in the Council Communication.

DATE July 12, 2010

NOW, THEREFORE, BE IT RESOLVED BY THE CITY COUNCIL OF THE CITY OF DES MOINES, IOWA:

That the hearing regarding

- 1) the plans, specifications, form of contract documents, and Jurisdictional Engineer's estimate of construction cost for said improvement, and
- 2) on the status of funded activities under IDED Contract No. 08-DRI-033 including activities for the separation of storm and sanitary sewers in the Lower Union Park neighborhood,

is hereby closed; and that

- 1) said plans, specifications, form of contract documents, and Jurisdictional Engineer's estimate of construction cost are hereby approved as the plans, specifications, form of contract documents, and Jurisdictional Engineer's estimate of construction cost for said improvement, and
- 2) the project funding as detailed in the Council Communication is hereby approved.

BE IT FURTHER RESOLVED: That sealed bids for said improvement were submitted by the following bidders:

Van Hauen & Associates, Inc.	Grimes, IA
Reilly Construction Co., Inc.	Ossian, IA
McAninch Corporation	West Des Moines, IA
Corell Contractor, Inc.	West Des Moines, IA

which were received and opened at a public meeting presided over by the Jurisdictional Engineer in the City Council Chambers, 2nd Floor, City Hall, 400 Robert D. Ray Drive, Des Moines, Iowa at 11:00 a.m. on June 29, 2010. Said bids and the attached tabulation of bids for said improvement be and are hereby received and filed.

BE IT FURTHER RESOLVED: That the Jurisdictional Engineer has determined that the lowest responsive, responsible bid for the construction of said improvement was submitted by Van Hauen & Associates, Inc., Brian Tancos, President, 1205 SW 37th Street, Grimes, IA, 50111 in the amount of \$4,337,374.40, and said bid be and the same is hereby accepted.

BE IT FURTHER RESOLVED: That the bid security of the unsuccessful bidders be and is hereby authorized and directed to be returned.

DATE July 12, 2010

BE IT FURTHER RESOLVED: That the Jurisdictional Engineer is hereby directed to secure execution by the lowest responsible, responsive Bidder and its surety of the contract documents in the form heretofore approved by this Council; that the Jurisdictional Engineer is directed to thereafter present said contract documents to this Council for approval and authorization to the Mayor to sign; and that no contract shall be deemed to exist between the City of Des Moines and said Bidder until said contract has been executed by the Bidder, and shall have been approved by this Council and executed by the Mayor and attested to by the City Clerk.

(City Council Communication Number 10-430 attached.)

Moved by \_\_\_\_\_ to adopt.

FORM APPROVED:

FUNDS AVAILABLE



Kathleen Vanderpool  
Deputy City Attorney

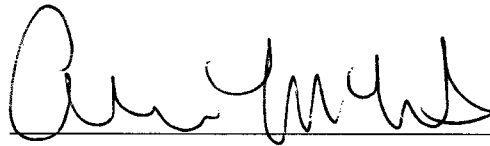

Allen McKinley  
Des Moines Finance Director

Funding Source: 2010-2011 CIP, Page Sanitary-7, CSS - Lower Union Park Sewer Separation Project, SAE126, Being: \$4,337,374.40 in HUD Disaster funds from the Iowa Department of Economic Development for 100% of construction costs associated with the Lower Union Park Sewer Separation with a \$5,000,000 maximum in Federal Jumpstart Infrastructure Assistance funds

COUNCIL ACTION	YEAS	NAYS	PASS	ABSENT
COWNIE				
COLEMAN				
GRIESS				
HENSLEY				
MAHAFFEY				
MEYER				
MOORE				
TOTAL				

MOTION CARRIED

APPROVED

\_\_\_\_\_  
Mayor

I, Diane Rauh, City Clerk of said City Council, hereby certify that at a meeting of the City Council, held on the above date, among other proceedings the above was adopted.

IN WITNESS WHEREOF, I have hereunto set my hand and affixed my seal the day and year first above written.

\_\_\_\_\_  
City Clerk

39

PROJECT LOCATION

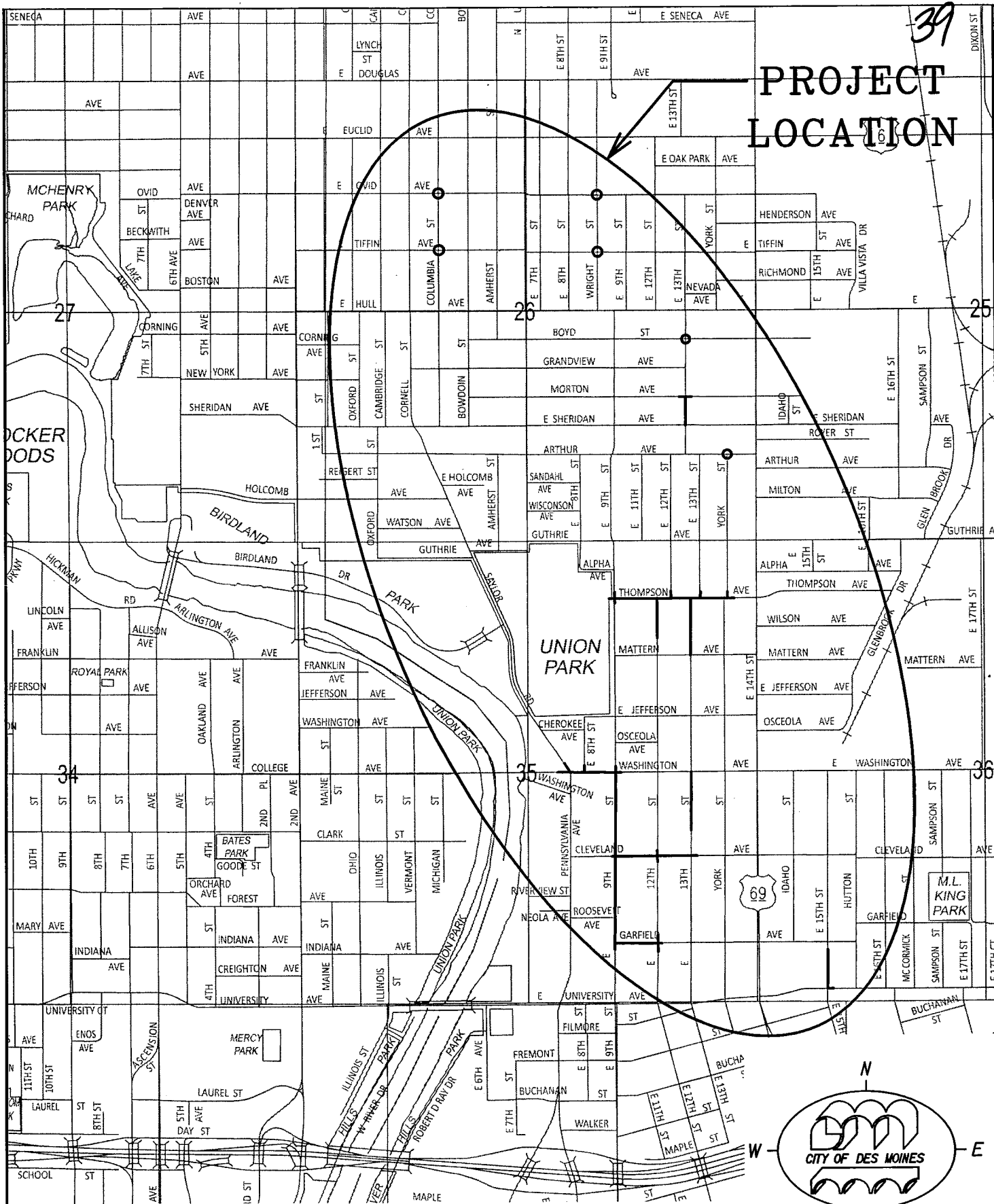

TR\ENG\Design\08\2010\008\Drawings\Loc\_Map\LOC\_MAP.DGN 15-APR-2010 11:16

LOWER UNION PARK  
 STORM SEWER IMPROVEMENTS  
 ACTIVITY ID 08-2010-008

TABULATED BY: *R. Joanning*  
CHECKED BY: *John F. McKee*  
APPROVED BY: *John F. McKee*

**CONTRACTOR'S BID TABULATION**  
**PROJECT: LOWER UNION PARK SEWER SEPARATION**

ESTIMATE

ITEM	DESCRIPTION	QUANTITY	UNIT PRICE		AMOUNT		UNIT PRICE	AMOUNT		UNIT PRICE	AMOUNT	
			PRICE	PRICE	AMOUNT	AMOUNT		PRICE	PRICE		AMOUNT	AMOUNT
1	Large Project Sign - IDED	1 LS	\$2,000.00	\$2,000.00	\$1,500.00	\$1,500.00	\$1,000.00	\$1,000.00	\$1,050.00	\$1,050.00	\$1,050.00	\$1,050.00
2	Mobilization	1 LS	\$112,578.00	\$112,578.00	\$95,000.00	\$95,000.00	\$50,000.00	\$50,000.00	\$249,497.00	\$249,497.00	\$249,497.00	\$249,497.00
3	Field Office and Staging Area	1 LS	\$30,000.00	\$30,000.00	\$89,594.00	\$89,594.00	\$29,500.00	\$29,500.00	\$34,700.00	\$34,700.00	\$34,700.00	\$34,700.00
4	Traffic Control	1 LS	\$30,000.00	\$30,000.00	\$50,000.00	\$50,000.00	\$40,800.00	\$40,800.00	\$42,850.00	\$42,850.00	\$42,850.00	\$42,850.00
5	Driveway, Alley, Sidewalk Removal/Disposition	5454 SY	\$8.00	\$43,632.00	\$7.00	\$38,178.00	\$7.00	\$38,178.00	\$7.00	\$38,178.00	\$7.00	\$38,178.00
6	Pavement Removal/Disposition	21221 SY	\$8.00	\$169,768.00	\$7.00	\$148,547.00	\$7.00	\$148,547.00	\$7.00	\$148,547.00	\$7.00	\$148,547.00
7	Subgrade Preparation	23980 SY	\$4.00	\$95,920.00	\$3.75	\$89,925.00	\$4.50	\$107,910.00	\$3.25	\$77,935.00	\$3.25	\$77,935.00
8	PCC Pavement, 8"	12877 SY	\$50.00	\$643,850.00	\$45.00	\$579,465.00	\$43.80	\$564,012.60	\$45.50	\$585,903.50	\$45.50	\$585,903.50
9	PCC Pavement, 9"	2118 SY	\$65.00	\$137,670.00	\$52.00	\$110,136.00	\$50.00	\$105,900.00	\$53.00	\$112,254.00	\$53.00	\$112,254.00
10	PCC Pavement, 8" Base, Integral Curb	6158 SY	\$45.00	\$277,110.00	\$45.00	\$277,110.00	\$46.90	\$288,810.20	\$46.50	\$286,347.00	\$46.50	\$286,347.00
11	PCC Curb and Gutter, 8", 3.0' Wide	15 LF	\$50.00	\$750.00	\$35.00	\$525.00	\$35.00	\$525.00	\$36.75	\$551.25	\$36.75	\$551.25
12	Milling for Resurfacing	7605 SY	\$2.00	\$15,210.00	\$4.00	\$30,420.00	\$2.50	\$19,012.50	\$4.50	\$34,222.50	\$4.50	\$34,222.50
13	HMA 1M S 1/2, 2" Thickness	1502 TON	\$75.00	\$112,650.00	\$75.00	\$112,650.00	\$90.00	\$135,180.00	\$107.00	\$161,410.00	\$107.00	\$161,410.00
14	PCC Alley, 7" Type C, 5'-10" Radius	192 SY	\$45.00	\$8,640.00	\$34.00	\$6,528.00	\$51.85	\$9,955.20	\$36.75	\$7,056.00	\$36.75	\$7,056.00
15	PCC Driveway, 6" Type A	1824 SY	\$40.00	\$72,960.00	\$32.00	\$58,368.00	\$28.43	\$51,856.32	\$34.00	\$62,016.00	\$34.00	\$62,016.00
16	PCC Sidewalk, 4"	3510 SY	\$35.00	\$122,850.00	\$27.00	\$94,770.00	\$26.80	\$94,068.00	\$29.00	\$101,790.00	\$29.00	\$101,790.00
17	Detectable Warnings	798 SF	\$45.00	\$35,910.00	\$33.00	\$26,334.00	\$20.75	\$16,558.50	\$35.00	\$27,930.00	\$35.00	\$27,930.00
18	Storm Sewer, 12" Class 3 RCP	321.5 LF	\$85.00	\$27,327.50	\$60.00	\$19,290.00	\$75.00	\$24,112.50	\$78.00	\$25,077.00	\$78.00	\$25,077.00
19	Storm Sewer, 15" Class 3 RCP	2061.9 LF	\$100.00	\$206,190.00	\$63.00	\$129,899.70	\$70.00	\$144,333.00	\$97.00	\$200,004.30	\$97.00	\$200,004.30
20	Storm Sewer, 18" Class 3 RCP	466.7 LF	\$100.00	\$46,670.00	\$74.00	\$34,535.80	\$75.00	\$35,002.50	\$84.00	\$39,202.80	\$84.00	\$39,202.80
21	Storm Sewer, 21" Class 3 RCP	478.5 LF	\$120.00	\$57,420.00	\$77.00	\$36,844.50	\$80.00	\$38,280.00	\$103.00	\$49,285.50	\$103.00	\$49,285.50
22	Storm Sewer, 24" Class 3 RCP	804.9 LF	\$130.00	\$104,637.00	\$94.00	\$75,660.60	\$85.00	\$68,416.50	\$164.00	\$132,003.60	\$164.00	\$132,003.60
23	Storm Sewer, 27" Class 3 RCP	786.4 LF	\$135.00	\$106,164.00	\$104.00	\$81,785.60	\$100.00	\$78,640.00	\$164.00	\$128,969.60	\$164.00	\$128,969.60
24	Storm Sewer, 30" Class 3 RCP	306.9 LF	\$140.00	\$42,966.00	\$121.00	\$37,134.90	\$110.00	\$33,759.00	\$172.00	\$52,786.80	\$172.00	\$52,786.80
25	Storm Sewer, 36" Class 3 RCP	852.4 LF	\$145.00	\$123,598.00	\$150.00	\$127,860.00	\$130.00	\$110,812.00	\$199.00	\$169,627.60	\$199.00	\$169,627.60
26	Storm Sewer, 36" Class 5 RCP	110 LF	\$200.00	\$22,000.00	\$226.00	\$24,860.00	\$175.00	\$19,250.00	\$224.00	\$24,640.00	\$224.00	\$24,640.00
27	Storm Sewer, 42" Class 3 RCP	911.1 LF	\$180.00	\$163,998.00	\$156.00	\$142,131.60	\$160.00	\$145,776.00	\$217.00	\$197,708.70	\$217.00	\$197,708.70
28	Storm Sewer, 42" Class 5 RCP	14.4 LF	\$280.00	\$4,032.00	\$314.00	\$4,521.60	\$210.00	\$3,024.00	\$248.00	\$3,571.20	\$248.00	\$3,571.20
29	Storm Sewer, 48" Class 3 RCP	494 LF	\$220.00	\$108,680.00	\$176.00	\$86,944.00	\$195.00	\$96,330.00	\$237.00	\$117,078.00	\$237.00	\$117,078.00
30	Storm Sewer, 48" Class 4 RCP	204.7 LF	\$270.00	\$55,269.00	\$212.00	\$43,396.40	\$215.00	\$44,010.50	\$257.00	\$52,607.90	\$257.00	\$52,607.90
31	Storm Sewer, 54" Class 4 RCP	179.6 LF	\$350.00	\$62,860.00	\$236.00	\$42,385.60	\$265.00	\$47,594.00	\$338.00	\$60,704.80	\$338.00	\$60,704.80
32	Storm Sewer, 60" Class 3 RCP	604.2 LF	\$450.00	\$271,890.00	\$254.00	\$153,466.80	\$275.00	\$166,155.00	\$345.00	\$208,449.00	\$345.00	\$208,449.00
33	Storm Sewer, 48" RCAP	535.1 LF	\$250.00	\$133,775.00	\$163.00	\$87,221.30	\$250.00	\$133,775.00	\$279.00	\$149,292.90	\$279.00	\$149,292.90
34	Storm Sewer, 42" Class 5 RCP, Jacked in Place	90 LF	\$650.00	\$58,500.00	\$847.00	\$76,230.00	\$900.00	\$81,000.00	\$794.00	\$71,460.00	\$794.00	\$71,460.00
35	Storm Sewer, 6' X 5' RCBC	10 LF	\$400.00	\$4,000.00	\$900.00	\$9,000.00	\$900.00	\$9,000.00	\$1,450.00	\$14,500.00	\$1,450.00	\$14,500.00
36	Storm Manhole, Type M-A, 48"	8 EA	\$3,000.00	\$24,000.00	\$2,975.00	\$23,800.00	\$5,000.00	\$40,000.00	\$3,723.00	\$29,784.00	\$3,723.00	\$29,784.00
37	Storm Manhole, Type M-A, 60"	3 EA	\$4,500.00	\$13,500.00	\$4,482.00	\$13,446.00	\$7,500.00	\$22,500.00	\$5,866.00	\$17,598.00	\$5,866.00	\$17,598.00
38	Storm Manhole, Type M-A, 84"	2 EA	\$8,500.00	\$17,000.00	\$7,500.00	\$15,000.00	\$20,000.00	\$40,000.00	\$16,965.00	\$33,930.00	\$16,965.00	\$33,930.00
39	Storm Manhole, Type M-C	14 EA	\$4,500.00	\$63,000.00	\$6,870.00	\$96,180.00	\$12,750.00	\$176,500.00	\$6,160.00	\$86,240.00	\$6,160.00	\$86,240.00
40	Storm Manhole, Type M-C (modified)	2 EA	\$4,500.00	\$9,000.00	\$6,915.00	\$13,830.00	\$13,500.00	\$27,000.00	\$5,415.00	\$10,830.00	\$5,415.00	\$10,830.00
41	Storm Manhole, Type M-D	6 EA	\$8,500.00	\$51,000.00	\$6,500.00	\$39,000.00	\$16,500.00	\$99,000.00	\$11,567.00	\$69,402.00	\$11,567.00	\$69,402.00

39

ITEM	DESCRIPTION	QUANTITY	UNIT		UNIT		UNIT		UNIT	
			PRICE	AMOUNT	PRICE	AMOUNT	PRICE	AMOUNT	PRICE	AMOUNT
42	Storm Manhole, Type M-E	1 EA	\$2,500.00	\$2,500.00	\$6,150.00	\$6,150.00	\$6,800.00	\$6,800.00	\$6,005.00	\$6,005.00
43	Special Structure 1	1 LS	\$15,000.00	\$15,000.00	\$25,000.00	\$25,000.00	\$20,000.00	\$20,000.00	\$15,800.00	\$15,800.00
44	Intake, Type M-A	13 EA	\$2,500.00	\$32,500.00	\$2,885.00	\$37,505.00	\$3,300.00	\$42,900.00	\$2,127.00	\$27,651.00
45	Intake, Type M-B	2 EA	\$2,500.00	\$5,000.00	\$2,895.00	\$5,790.00	\$3,500.00	\$7,000.00	\$3,538.00	\$7,076.00
46	Intake, Type M-D	15 EA	\$3,000.00	\$45,000.00	\$3,875.00	\$58,125.00	\$4,200.00	\$63,000.00	\$2,649.00	\$39,735.00
47	Intake, Type M-E	2 EA	\$6,000.00	\$12,000.00	\$5,842.00	\$11,684.00	\$5,000.00	\$10,000.00	\$4,142.00	\$8,284.00
48	Intake, Type M-F	19 EA	\$2,500.00	\$47,500.00	\$2,552.00	\$48,488.00	\$3,500.00	\$66,500.00	\$3,669.00	\$69,711.00
49	Intake, Type M-F (modified)	1 EA	\$2,750.00	\$2,750.00	\$2,635.00	\$2,635.00	\$7,500.00	\$7,500.00	\$9,142.00	\$9,142.00
50	Intake, Type M-I	10 EA	\$3,000.00	\$30,000.00	\$2,770.00	\$27,700.00	\$4,400.00	\$44,000.00	\$4,831.00	\$48,310.00
51	Intake, RA-41 w/ RA-42 Extension	2 EA	\$3,500.00	\$7,000.00	\$2,885.00	\$5,770.00	\$5,650.00	\$11,300.00	\$7,356.00	\$14,712.00
52	Intake, RA-43	3 EA	\$3,500.00	\$10,500.00	\$2,800.00	\$8,400.00	\$7,400.00	\$22,200.00	\$8,205.00	\$24,615.00
53	Manhole Removal, Storm	7 EA	\$600.00	\$4,200.00	\$500.00	\$3,500.00	\$600.00	\$4,200.00	\$538.00	\$3,766.00
54	Abandon Manhole	1 EA	\$500.00	\$500.00	\$250.00	\$250.00	\$700.00	\$700.00	\$695.00	\$695.00
55	Intake Removal	34 EA	\$600.00	\$20,400.00	\$500.00	\$17,000.00	\$600.00	\$20,400.00	\$538.00	\$18,292.00
56	Storm Sewer Service, 8"	3 EA	\$1,500.00	\$4,500.00	\$2,500.00	\$7,500.00	\$1,500.00	\$4,500.00	\$1,832.00	\$5,496.00
57	Remove Storm/Sanitary Pipe, less than or equal to 30"	1425 LF	\$10.00	\$14,250.00	\$20.00	\$28,500.00	\$15.00	\$21,375.00	\$45.00	\$64,125.00
58	Remove Storm/Sanitary Pipe, greater than 36"	30 LF	\$15.00	\$450.00	\$20.00	\$600.00	\$20.00	\$600.00	\$45.00	\$1,350.00
59	Standard Sewer Plug 8" -30"	45 EA	\$100.00	\$4,500.00	\$150.00	\$6,750.00	\$175.00	\$7,875.00	\$244.00	\$10,980.00
60	Standard Sewer Plug 36" or greater	9 EA	\$250.00	\$2,250.00	\$250.00	\$2,250.00	\$225.00	\$2,025.00	\$244.00	\$2,196.00
61	Abandon Storm/Sanitary Sewer in place with Flowable Mortar 12"-30"	225 LF	\$15.00	\$3,375.00	\$10.00	\$2,250.00	\$45.00	\$10,125.00	\$22.00	\$4,950.00
62	Abandon Storm/Sanitary Sewer in place with Flowable Mortar 36"	508 LF	\$20.00	\$10,160.00	\$15.00	\$7,620.00	\$65.00	\$33,020.00	\$29.00	\$14,732.00
63	Sanitary Sewer, 10" DI	30 LF	\$150.00	\$4,500.00	\$130.00	\$3,900.00	\$105.00	\$3,150.00	\$228.00	\$6,840.00
64	Sanitary Sewer, 12"	8 LF	\$150.00	\$1,200.00	\$218.00	\$1,744.00	\$78.00	\$624.00	\$138.00	\$1,104.00
65	Sanitary Sewer, 12" DI	150 LF	\$180.00	\$27,000.00	\$265.00	\$39,750.00	\$115.00	\$17,250.00	\$319.00	\$47,850.00
66	Sanitary Sewer, 15"	435 LF	\$150.00	\$65,250.00	\$95.00	\$41,325.00	\$85.00	\$36,975.00	\$94.00	\$40,890.00
67	Sanitary Sewer, 18"	83 LF	\$180.00	\$14,940.00	\$135.00	\$11,205.00	\$110.00	\$9,130.00	\$225.00	\$18,675.00
68	Sanitary Sewer, 18" DI	75 LF	\$200.00	\$15,000.00	\$335.00	\$25,125.00	\$145.00	\$10,875.00	\$336.00	\$25,200.00
69	Sanitary Sewer, 20" DI	100 LF	\$260.00	\$26,000.00	\$395.00	\$39,500.00	\$160.00	\$16,000.00	\$325.00	\$32,500.00
70	Drop Connection, 12" DI	9 VF	\$300.00	\$2,700.00	\$675.00	\$6,075.00	\$670.00	\$6,030.00	\$705.00	\$6,345.00
71	Drop Connection, 20" DI	5 VF	\$500.00	\$2,500.00	\$1,830.00	\$9,150.00	\$2,400.00	\$12,000.00	\$1,621.00	\$8,105.00
72	Sanitary Manhole, Type A, 48"	5 EA	\$3,000.00	\$15,000.00	\$2,765.00	\$13,825.00	\$5,800.00	\$29,000.00	\$3,888.00	\$19,440.00
73	Remove Manhole, Sanitary	3 EA	\$300.00	\$900.00	\$500.00	\$1,500.00	\$1,500.00	\$4,500.00	\$1,105.00	\$3,315.00
74	Sanitary Sewer Service Connections	2675 LF	\$90.00	\$240,750.00	\$60.00	\$160,500.00	\$65.00	\$173,875.00	\$81.00	\$216,675.00
75	Sanitary Sewer Service Relocation #1	84 EA	\$700.00	\$58,800.00	\$500.00	\$42,000.00	\$1,000.00	\$84,000.00	\$967.00	\$81,228.00
76	Sanitary Sewer Service Relocation #1	1 LS	\$8,000.00	\$8,000.00	\$6,000.00	\$6,000.00	\$5,000.00	\$5,000.00	\$6,020.00	\$6,020.00
77	8" Water Main Relocation 1	1 LS	\$7,000.00	\$7,000.00	\$15,000.00	\$15,000.00	\$10,000.00	\$10,000.00	\$20,100.00	\$20,100.00
78	Water Service Relocation/New Service	73 EA	\$2,000.00	\$146,000.00	\$2,030.00	\$148,190.00	\$2,500.00	\$182,500.00	\$2,270.00	\$165,710.00
79	Storm Sewer, 10" PVC, SDR 35	380 LF	\$80.00	\$30,400.00	\$57.00	\$21,660.00	\$33.50	\$12,730.00	\$83.00	\$31,540.00
80	Storm Sewer, 10" PVC, in 18" Steel Casing, Augured	68.5 LF	\$275.00	\$18,837.50	\$286.00	\$19,591.00	\$265.00	\$18,152.50	\$366.00	\$25,071.00
81	Storm Sewer Cleanout, 10"	3 EA	\$1,500.00	\$4,500.00	\$500.00	\$1,500.00	\$1,300.00	\$3,900.00	\$810.00	\$2,430.00
82	Granular Surfacing Material	200 TON	\$30.00	\$6,000.00	\$20.00	\$4,000.00	\$22.00	\$4,400.00	\$22.00	\$4,400.00
83	Clearing and Grubbing	1724 DI	\$35.00	\$60,340.00	\$17.00	\$29,308.00	\$23.50	\$40,514.00	\$18.00	\$31,032.00
84	Tree Protection	1 LS	\$1,000.00	\$1,000.00	\$1,000.00	\$1,000.00	\$9,500.00	\$9,500.00	\$998.00	\$998.00
85	Tree Protection Fence	1070 LF	\$2.00	\$2,140.00	\$2.00	\$2,140.00	\$1.80	\$1,926.00	\$2.00	\$2,140.00
86	Sodding	964 SQ	\$50.00	\$48,200.00	\$40.00	\$38,560.00	\$31.00	\$29,884.00	\$33.00	\$31,812.00
87	Construction Staking	1 LS	\$40,000.00	\$40,000.00	\$15,000.00	\$15,000.00	\$11,500.00	\$11,500.00	\$28,305.00	\$28,305.00
88	Erosion Control	1 LS	\$3,000.00	\$3,000.00	\$2,500.00	\$2,500.00	\$2,500.00	\$2,500.00	\$2,625.00	\$2,625.00
89	Inlet Filter	50 EA	\$250.00	\$12,500.00	\$44.00	\$2,200.00	\$45.00	\$2,250.00	\$48.00	\$2,400.00
90	Silt Fence or Sock	2000 LF	\$2.00	\$4,000.00	\$2.00	\$4,000.00	\$1.70	\$3,400.00	\$2.00	\$4,000.00
91	Traffic Signal Modification	1 LS	\$2,000.00	\$2,000.00	\$4,500.00	\$4,500.00	\$4,500.00	\$4,500.00	\$4,725.00	\$4,725.00
92	Type 'B' Casting	20 EA	\$450.00	\$9,000.00	\$650.00	\$13,000.00	\$700.00	\$14,000.00	\$849.00	\$16,980.00







ITEM	DESCRIPTION	QUANTITY	UNIT		UNIT	
			PRICE	AMOUNT	PRICE	AMOUNT
42	Storm Manhole, Type M-E	1 EA	\$2,500.00	\$2,500.00	\$4,000.00	\$4,000.00
43	Special Structure 1	1 LS	\$15,000.00	\$15,000.00	\$18,000.00	\$18,000.00
44	Intake, Type M-A	13 EA	\$2,500.00	\$32,500.00	\$2,270.00	\$29,510.00
45	Intake, Type M-B	2 EA	\$2,500.00	\$5,000.00	\$3,685.00	\$7,370.00
46	Intake, Type M-D	15 EA	\$3,000.00	\$45,000.00	\$3,375.00	\$50,625.00
47	Intake, Type M-E	2 EA	\$3,000.00	\$6,000.00	\$5,300.00	\$10,600.00
48	Intake, Type M-F	19 EA	\$2,500.00	\$47,500.00	\$4,500.00	\$85,500.00
49	Intake, Type M-F (modified)	1 EA	\$2,750.00	\$2,750.00	\$15,000.00	\$15,000.00
50	Intake, Type M-I	10 EA	\$3,000.00	\$30,000.00	\$5,400.00	\$54,000.00
51	Intake, RA-41 w/ RA-42 Extension	2 EA	\$3,500.00	\$7,000.00	\$5,300.00	\$10,600.00
52	Intake, RA-43	3 EA	\$3,500.00	\$10,500.00	\$7,200.00	\$21,600.00
53	Manhole Removal, Storm	7 EA	\$600.00	\$4,200.00	\$1,000.00	\$7,000.00
54	Abandon Manhole	1 EA	\$500.00	\$500.00	\$1,450.00	\$1,450.00
55	Intake Removal	34 EA	\$600.00	\$20,400.00	\$750.00	\$25,500.00
56	Storm Sewer Service, 8"	3 EA	\$1,500.00	\$4,500.00	\$1,800.00	\$5,400.00
57	Remove Storm/Sanitary Pipe, less than or equal to 30"	1425 LF	\$10.00	\$14,250.00	\$25.00	\$35,625.00
58	Remove Storm/Sanitary Pipe, greater than 36"	30 LF	\$15.00	\$450.00	\$50.00	\$1,500.00
59	Standard Sewer Plug 8" -30"	45 EA	\$100.00	\$4,500.00	\$285.00	\$12,825.00
60	Standard Sewer Plug 36" or greater	9 EA	\$250.00	\$2,250.00	\$600.00	\$5,400.00
61	Abandon Storm/Sanitary Sewer in place with Flowable Mortar 12"-30"	225 LF	\$15.00	\$3,375.00	\$54.00	\$12,150.00
62	Abandon Storm/Sanitary Sewer in place with Flowable Mortar 36"	508 LF	\$20.00	\$10,160.00	\$65.00	\$33,020.00
63	Sanitary Sewer, 10" DI	30 LF	\$150.00	\$4,500.00	\$332.00	\$9,960.00
64	Sanitary Sewer, 12"	8 LF	\$150.00	\$1,200.00	\$520.00	\$4,160.00
65	Sanitary Sewer, 12" DI	150 LF	\$180.00	\$27,000.00	\$505.00	\$75,750.00
66	Sanitary Sewer, 15"	435 LF	\$150.00	\$65,250.00	\$122.00	\$53,070.00
67	Sanitary Sewer, 18"	83 LF	\$180.00	\$14,940.00	\$250.00	\$20,750.00
68	Sanitary Sewer, 18" DI	75 LF	\$200.00	\$15,000.00	\$485.00	\$36,375.00
69	Sanitary Sewer, 20" DI	100 LF	\$260.00	\$26,000.00	\$490.00	\$49,000.00
70	Drop Connection, 12" DI	9 VF	\$300.00	\$2,700.00	\$665.00	\$5,985.00
71	Drop Connection, 20" DI	5 VF	\$500.00	\$2,500.00	\$2,320.00	\$11,600.00
72	Sanitary Manhole, Type A, 48"	5 EA	\$3,000.00	\$15,000.00	\$4,000.00	\$20,000.00
73	Remove Manhole, Sanitary	3 EA	\$300.00	\$900.00	\$1,500.00	\$4,500.00
74	Sanitary Sewer Service Pipe, 6"	2675 LF	\$90.00	\$240,750.00	\$87.50	\$234,062.50
75	Sanitary Sewer Service Connections	84 EA	\$700.00	\$58,800.00	\$1,120.00	\$94,080.00
76	Sanitary Sewer Service Relocation #1	1 LS	\$8,000.00	\$8,000.00	\$6,575.00	\$6,575.00
77	8" Water Main Relocation 1	1 LS	\$7,000.00	\$7,000.00	\$39,800.00	\$39,800.00
78	Water Service Relocation/New Service	73 EA	\$2,000.00	\$146,000.00	\$2,275.00	\$166,075.00
79	Storm Sewer, 10" PVC, SDR 35	380 LF	\$80.00	\$30,400.00	\$95.00	\$36,100.00
80	Storm Sewer, 10" PVC, in 18" Steel Casing, Augured	68.5 LF	\$275.00	\$18,837.50	\$625.00	\$42,812.50
81	Storm Sewer Cleanout, 10"	3 EA	\$1,500.00	\$4,500.00	\$725.00	\$2,175.00
82	Granular Surfacing Material	200 TON	\$30.00	\$6,000.00	\$22.00	\$4,400.00
83	Clearing and Grubbing	1724 DI	\$35.00	\$60,340.00	\$20.50	\$35,342.00
84	Tree Protection	1 LS	\$1,000.00	\$1,000.00	\$1,000.00	\$1,000.00
85	Tree Protection Fence	1070 LF	\$2.00	\$2,140.00	\$2.00	\$2,140.00
86	Sodding	964 SQ	\$50.00	\$48,200.00	\$32.50	\$31,330.00
87	Construction Staking	1 LS	\$40,000.00	\$40,000.00	\$28,300.00	\$28,300.00
88	Erosion Control	1 EA	\$3,000.00	\$3,000.00	\$2,625.00	\$2,625.00
89	Inlet Filter	50 EA	\$250.00	\$12,500.00	\$47.00	\$2,350.00
90	Silt Fence or Sock	2000 LF	\$2.00	\$4,000.00	\$1.80	\$3,600.00
91	Traffic Signal Modification	1 LS	\$2,000.00	\$2,000.00	\$4,725.00	\$4,725.00
92	Type 'B' Casting	20 EA	\$450.00	\$9,000.00	\$675.00	\$13,500.00

ITEM	DESCRIPTION	QUANTITY	UNIT PRICE	AMOUNT	UNIT PRICE	AMOUNT
93	Install Chimney Seal on Existing Manhole	20 EA	\$750.00	\$15,000.00	\$450.00	\$9,000.00
94	Manhole Adjustment, Major	20 EA	\$1,500.00	\$30,000.00	\$1,050.00	\$21,000.00
95	Subgrade Core Out Excavation	300 CY	\$10.00	\$3,000.00	\$15.00	\$4,500.00
96	Subgrade Replacement	1700 SY	\$5.00	\$8,500.00	\$9.75	\$16,575.00
97	Fence Removal and Replacement	45 LF	\$50.00	\$2,250.00	\$25.00	\$1,125.00
98	Steel Sheet Piling	1 LS	\$12,000.00	\$12,000.00	\$8,250.00	\$8,250.00
99	Concrete Headwall	1 LS	\$15,000.00	\$15,000.00	\$9,520.00	\$9,520.00
100	Seed and Mulch	0.3 AC	\$4,000.00	\$1,200.00	\$3,425.00	\$1,027.50
101	Rip Rap, Class D	30 Ton	\$50.00	\$1,500.00	\$53.00	\$1,590.00
TOTAL CONSTRUCTION COST				\$4,923,217.00		\$6,105,285.98
PERCENT OF ENGINEER'S ESTIMATE						+24.01%