

DATE July 13, 2009

PUBLIC HEARING, APPROVING PLANS, SPECIFICATIONS, FORM OF CONTRACT DOCUMENTS, AND ENGINEER'S ESTIMATE ON S.E. 14TH STREET WIDENING AT E. INDIANOLA AVENUE; RECEIVE AND FILE BIDS; AND DESIGNATION OF LOWEST RESPONSIVE, RESPONSIBLE BIDDER AS JASPER CONSTRUCTION SERVICES, INC., STEVEN J. RHOADS, PRESIDENT, \$292,358.75

WHEREAS, on June 8, 2009, under Roll Call No. 09-957, plans, specifications, form of contract documents, and Jurisdictional Engineer's estimate of construction cost were filed with the City Clerk, for the construction of the following improvement:

S.E. 14th Street Widening at E. Indianola Avenue, 06-2009-002 CS-TSF-1945(744)--85-77

The improvement includes construction of a second left turn lane by removal and replacement of curb and medians, pavement markings, and other incidental items; all in accordance with the City of Des Moines approved Urban Standard Specifications for Public Improvements and contract documents, including Plan File Nos. 497-001/043, located on S.E. 14th Street (US Highway 69) between E. Thornton Avenue and E. Indianola Avenue, Des Moines, Iowa

WHEREAS, notice of the hearing on the plans, specifications, form of contract documents, and Engineer's estimate of construction cost was published as required by law.

NOW, THEREFORE, BE IT RESOLVED BY THE CITY COUNCIL OF THE CITY OF DES MOINES, IOWA: That the hearing on the plans, specifications, form of contract documents, and Jurisdictional Engineer's estimate of construction cost for said improvement be closed; and that said plans, specifications, form of contract documents, and Jurisdictional Engineer's estimate of construction cost are hereby approved as the plans, specifications, form of contract documents, and Jurisdictional Engineer's estimate of construction cost for said improvement.

BE IT FURTHER RESOLVED: That sealed bids for said improvement were submitted by the following bidders:

- Jasper Construction Services, Inc.      Newton, IA
- Concrete Technologies, Inc.              Urbandale, IA
- Sternquist Construction Inc.            Indianola, IA
- Elder Corporation                            Des Moines, IA
- Grimes Asphalt & Paving Corp.          Grimes, IA
- T K Concrete Inc.                            Pella, IA
- Bid not read

DATE July 13, 2009

which were received and opened at a public meeting presided over by the Jurisdictional Engineer in the City Council Chambers, 2nd Floor, City Hall, 400 Robert D. Ray Drive, Des Moines, Iowa at 11:00 a.m. on June 30, 2009. Said bids and the attached tabulation of bids for said improvement be and are hereby received and filed.

BE IT FURTHER RESOLVED: That the Jurisdictional Engineer has determined that the lowest responsive, responsible bid for the construction of said improvement was submitted by Jasper Construction Services, Inc., Steven J. Rhoads, President, 928 N 19th Avenue East, Newton, IA, 50208 in the amount of \$292,358.75, and said bid be and the same is hereby accepted.

BE IT FURTHER RESOLVED: That the bid security of the unsuccessful bidders be and is hereby authorized and directed to be returned.

BE IT FURTHER RESOLVED: That the Jurisdictional Engineer is hereby directed to secure execution by the lowest responsible, responsive Bidder and its surety of the contract documents in the form heretofore approved by this Council; that the Jurisdictional Engineer is directed to thereafter present said contract documents to this Council for approval and authorization to the Mayor to sign; and that no contract shall be deemed to exist between the City of Des Moines and said Bidder until said contract has been executed by the Bidder, and shall have been approved by this Council and executed by the Mayor and attested to by the City Clerk.

(City Council Communication Number 09-457 attached.)

Moved by \_\_\_\_\_ to adopt.

FORM APPROVED:

FUNDS AVAILABLE

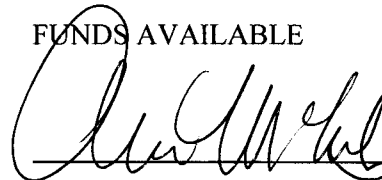
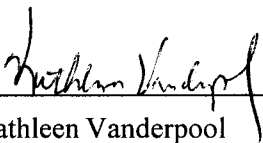

Kathleen Vanderpool  
Deputy City Attorney

Allen McKinley  
Des Moines Finance Director

Funding Source: 2009-2010 CIP, Page Street-14, East Indianola Avenue Widening - S.E. 14th to Army Post, STR213, Being:  
\$292,358.75 in Iowa DOT Traffic Safety Funds under IDOT Agreement No. 2009-TS-014 (Maximum \$500,000) for 100% construction contract costs only, which includes both 06-2009-002, S.E. 14th Street Widening at E. Indianola Avenue, agreement estimated at \$300,000 and 06-2009-003, E. Indianola Avenue Widening - S.E. 14th Street to S.E. 16th Court, agreement estimated at \$200,000

★ **Roll Call Number**

**Agenda Item Number**

68

DATE July 13, 2009

COUNCIL ACTION	YEAS	NAYS	PASS	ABSENT
COWNIE				
COLEMAN				
HENSLEY				
KIERNAN				
MAHAFFEY				
MEYER				
VLASSIS				
TOTAL				

MOTION CARRIED

APPROVED

\_\_\_\_\_  
Mayor

I, Diane Rauh, City Clerk of said City Council, hereby certify that at a meeting of the City Council, held on the above date, among other proceedings the above was adopted.

IN WITNESS WHEREOF, I have hereunto set my hand and affixed my seal the day and year first above written.

\_\_\_\_\_  
City Clerk

T:\ENG\Design\06-2009\0602\Drawings\Loc-Map\LOC\_MAP.DGN 21-APR-2009 16:03

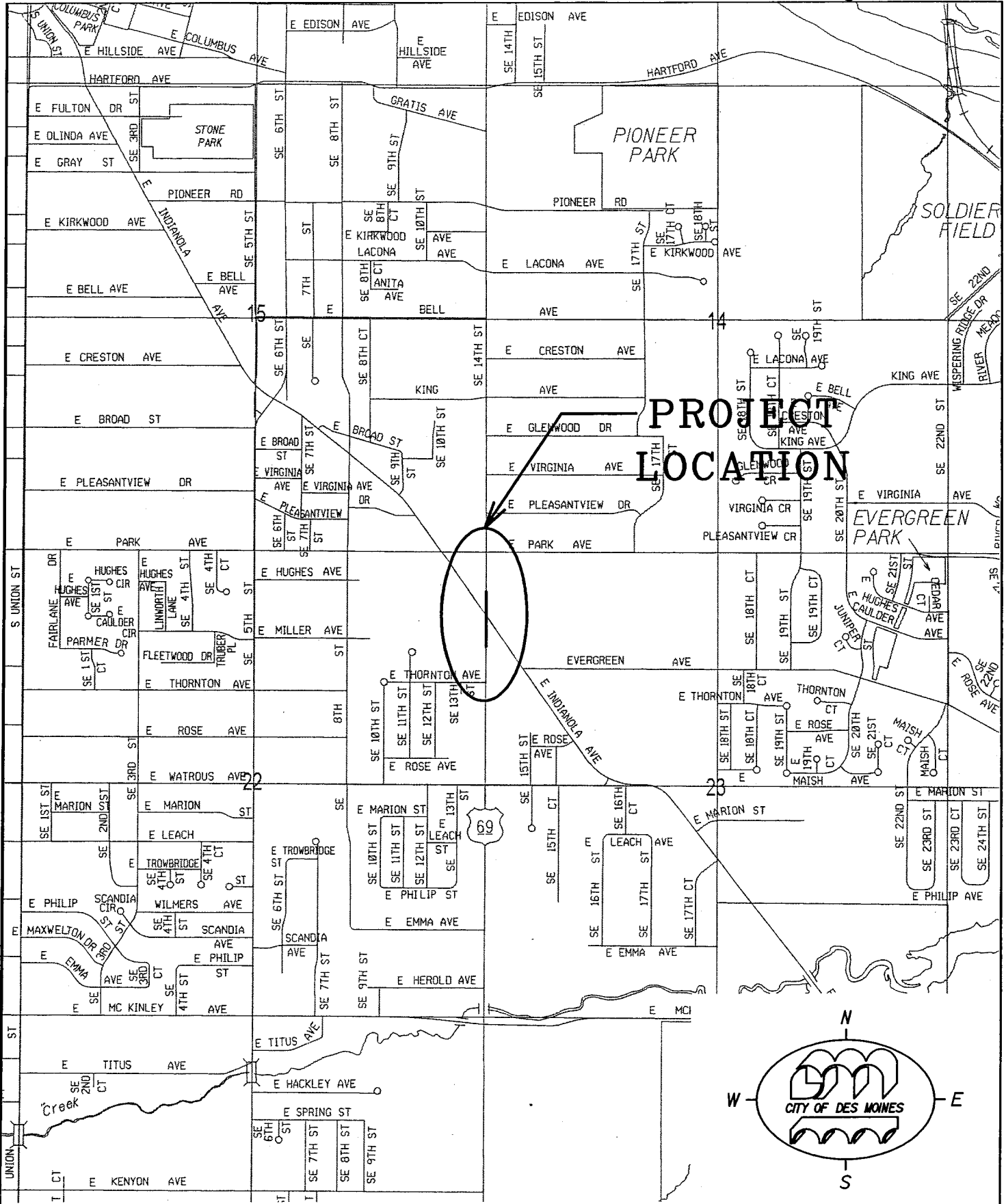

**PROJECT LOCATION**

**S.E. 14TH STREET (U.S. 69) WIDENING  
 AT E. INDIANOLA AVENUE  
 ACTIVITY I.D. 06-2009-002**

TABULATED BY: R. Joangings  
CHECKED BY: *[Signature]*  
APPROVED BY: *[Signature]*

CONTRACTOR'S BID TABULATION  
PROJECT: S.E. 14th STREET WIDENING AT E. INDIANOLA AVENUE

ESTIMATE

ITEM	DESCRIPTION	QUANTITY	UNIT		CONTRACTOR Jasper Construction Services, Inc.		CONTRACTOR Concrete Technologies, Inc.		CONTRACTOR Sternquist Construction	
			PRICE	AMOUNT	UNIT PRICE	AMOUNT	UNIT PRICE	AMOUNT	UNIT PRICE	AMOUNT
1	Clearing and Grubbing	12 UNIT	\$100.00	\$1,200.00	\$44.00	\$528.00	\$42.00	\$504.00	\$46.25	\$555.00
2	Topsoil, Strip, Salvage and Spread	125 CY	\$12.00	\$1,500.00	\$30.00	\$3,750.00	\$13.75	\$1,718.75	\$18.00	\$2,250.00
3	Special Compaction of Subgrade	7.25 STA	\$500.00	\$3,625.00	\$285.00	\$2,086.25	\$590.00	\$4,277.50	\$638.00	\$4,625.50
4	Modified Subbase	255 CY	\$30.00	\$7,650.00	\$38.50	\$9,817.50	\$41.00	\$10,455.00	\$50.75	\$12,941.25
5	Shoulder Finishing, Earth	5 STA	\$1,000.00	\$5,000.00	\$200.00	\$1,000.00	\$240.00	\$1,200.00	\$300.00	\$1,500.00
6	Excavation, Class 13, For Widening	665.00 CY	\$10.00	\$6,650.00	\$12.00	\$7,980.00	\$17.25	\$11,471.25	\$22.40	\$14,896.00
7	Median, Dowelled P.C. Concrete, 6 Inch	553 SY	\$40.00	\$22,120.00	\$46.00	\$25,438.00	\$42.00	\$23,226.00	\$52.00	\$28,756.00
8	Portland Cement Concrete Pavement Widening, 10 IN.	712 SY	\$55.00	\$39,180.00	\$65.00	\$46,280.00	\$62.85	\$44,749.20	\$66.00	\$46,992.00
9	Surfacing, Driveway	100 TON	\$15.00	\$1,500.00	\$27.00	\$2,700.00	\$21.00	\$2,100.00	\$20.00	\$2,000.00
10	Removal of Concrete Footings of Highway Signs	3 EACH	\$500.00	\$1,500.00	\$750.00	\$2,250.00	\$630.00	\$1,890.00	\$578.15	\$1,734.45
11	Subdrain, Longitudinal, 4 In. Dia.	681 LF	\$10.00	\$6,810.00	\$18.00	\$12,258.00	\$17.35	\$11,815.35	\$19.00	\$12,939.00
12	Subdrain Outlet, (RF-19C)	10 EACH	\$250.00	\$2,500.00	\$225.00	\$2,250.00	\$115.00	\$1,150.00	\$127.00	\$1,270.00
13	Intake, RA-41	2 EACH	\$4,000.00	\$8,000.00	\$4,300.00	\$8,600.00	\$4,760.00	\$9,520.00	\$5,240.00	\$10,480.00
14	Intake, RA-41, Modified	2 EACH	\$5,000.00	\$10,000.00	\$6,100.00	\$12,200.00	\$6,050.00	\$12,100.00	\$6,650.00	\$13,300.00
15	Intake Extension Unit, RA-42	5 EACH	\$2,500.00	\$12,500.00	\$2,100.00	\$10,500.00	\$2,440.00	\$12,200.00	\$2,682.00	\$13,410.00
16	Sewer pipe, 2000D Storm, 15 IN DIA	30 LF	\$60.00	\$1,800.00	\$40.00	\$1,200.00	\$140.00	\$4,200.00	\$150.00	\$4,500.00
17	Utility Access, Convert Intake to Concrete Grout	1 EACH	\$3,000.00	\$3,000.00	\$2,000.00	\$2,000.00	\$3,675.00	\$3,675.00	\$4,045.00	\$4,045.00
18	Removal of Pavement	1 CY	\$200.00	\$200.00	\$3,500.00	\$3,500.00	\$1,700.00	\$1,700.00	\$462.00	\$462.00
19	Removal of Intakes and Utility Accesses	622 SY	\$25.00	\$15,550.00	\$6.00	\$3,732.00	\$15.75	\$9,796.50	\$24.75	\$15,394.50
20	Removal of Sidewalk	250 SY	\$10.00	\$2,500.00	\$5.00	\$1,250.00	\$9.75	\$2,437.50	\$13.30	\$3,325.00
21	Sidewalk, P.C. Concrete, 4 IN	250 SY	\$30.00	\$7,500.00	\$35.00	\$8,750.00	\$27.85	\$6,962.50	\$29.00	\$7,250.00
22	Sidewalk, P.C. Concrete, 6 IN	15 SY	\$35.00	\$525.00	\$50.00	\$750.00	\$37.00	\$555.00	\$52.00	\$780.00
23	Detectable Warnings for Curb Ramps	40 SF	\$30.00	\$1,200.00	\$30.00	\$1,200.00	\$27.80	\$1,112.00	\$35.00	\$1,400.00
24	Driveway, P.C. Concrete, 7 IN	486 SY	\$50.00	\$24,300.00	\$45.00	\$21,870.00	\$48.50	\$23,571.00	\$40.00	\$19,440.00
25	Removal of Paved Driveway	653 SY	\$15.00	\$9,795.00	\$6.00	\$3,918.00	\$9.75	\$6,366.75	\$15.00	\$9,795.00
26	Safety Closure	5 EACH	\$100.00	\$500.00	\$110.00	\$550.00	\$105.00	\$525.00	\$115.00	\$575.00
27	Fence, Remove and Reinstall Chain Link, as per plan	250 LF	\$50.00	\$12,500.00	\$9.00	\$2,250.00	\$22.25	\$5,562.50	\$46.25	\$11,562.50
28	Painted Pavement Markings, Waterborne or Solvent-Based	14 STA	\$100.00	\$1,400.00	\$100.00	\$1,400.00	\$98.00	\$1,372.00	\$110.00	\$1,540.00

68

ITEM	DESCRIPTION	QUANTITY	UNIT PRICE	AMOUNT	UNIT PRICE	AMOUNT	UNIT PRICE	AMOUNT	UNIT PRICE	AMOUNT
30	Painted Pavement Markings, Highbuild Waterborne	75 STA	\$120.00	\$9,000.00	\$132.00	\$9,900.00	\$125.00	\$9,375.00	\$135.00	\$10,125.00
31	Permanent Tape Markings, Profiled Pavement Marking Tape	25 STA	\$400.00	\$10,000.00	\$319.00	\$7,975.00	\$300.00	\$7,500.00	\$335.00	\$8,375.00
32	Painted Symbols and Legends, Waterborne or Solvent-Based	8 EACH	\$125.00	\$1,000.00	\$88.00	\$704.00	\$83.00	\$664.00	\$92.50	\$740.00
33	Pre-Cut Symbols and Legends, Intersection Marking Tape	8 EACH	\$500.00	\$4,000.00	\$352.00	\$2,816.00	\$330.00	\$2,640.00	\$370.00	\$2,960.00
34	Pavement Markings Removed	14 STA	\$40.00	\$560.00	\$44.00	\$616.00	\$42.00	\$588.00	\$46.25	\$647.50
35	Symbols and Legends Removed	8 EACH	\$125.00	\$1,000.00	\$100.00	\$800.00	\$100.00	\$800.00	\$109.00	\$872.00
36	Grooves Cut For Pavement Markings	25 STA	\$40.00	\$1,000.00	\$86.00	\$1,650.00	\$62.00	\$1,550.00	\$69.00	\$1,725.00
37	Grooves Cut For Symbols and Legends	8 EACH	\$125.00	\$1,000.00	\$165.00	\$1,320.00	\$160.00	\$1,280.00	\$173.00	\$1,384.00
38	Traffic Control	1 LS	\$10,000.00	\$10,000.00	\$16,400.00	\$16,400.00	\$15,300.00	\$15,300.00	\$17,150.00	\$17,150.00
39	Mobilization	1 LS	\$20,000.00	\$20,000.00	\$17,500.00	\$17,500.00	\$29,700.00	\$29,700.00	\$4,400.00	\$4,400.00
40	Traffic Signalization Modifications	1 LS	\$17,800.00	\$17,800.00	\$23,850.00	\$23,850.00	\$22,325.00	\$22,325.00	\$25,000.00	\$25,000.00
41	Sodding	10 SQ	\$40.00	\$400.00	\$95.00	\$950.00	\$38.00	\$380.00	\$250.00	\$2,500.00
42	Shrubs	18 EACH	\$60.00	\$1,080.00	\$80.00	\$1,440.00	\$45.00	\$810.00	\$115.00	\$2,070.00
43	Tree	3 EACH	\$300.00	\$900.00	\$350.00	\$1,050.00	\$250.00	\$750.00	\$575.00	\$1,725.00
TOTAL CONSTRUCTION COST				\$291,825.00		\$292,358.75		\$313,024.80		\$330,859.70
PERCENT OF ENGINEER'S ESTIMATE						+0.18%		+7.26%		+13.38%
					Low					

TABULATED BY: R. JOANNINO  
CHECKED BY: *John F. McKee*  
APPROVED BY: *John F. McKee*

CONTRACTOR'S BID TABULATION  
PROJECT: S.E. 14th STREET WIDENING AT E. INDIANOLA AVENUE

ESTIMATE

ITEM	DESCRIPTION	QUANTITY	UNIT		CONTRACTOR Elder Corporation		CONTRACTOR Grimes Asphalt and Paving Corp.		CONTRACTOR TK Concrete Inc
			PRICE	AMOUNT	UNIT PRICE	AMOUNT	UNIT PRICE	AMOUNT	
1	Clearing and Grubbing	12 UNIT	\$100.00	\$1,200.00	\$175.00	\$2,100.00	\$263.00	\$3,156.00	
2	Topsoil, Strip, Salvage and Spread	125 CY	\$12.00	\$1,500.00	\$37.00	\$4,625.00	\$58.50	\$7,312.50	
3	Special Compaction of Subgrade	7.25 STA	\$500.00	\$3,625.00	\$2,200.00	\$15,950.00	\$985.00	\$7,141.25	Did Not Read Bid.
4	Modified Subbase	255 CY	\$30.00	\$7,650.00	\$60.50	\$15,427.50	\$51.00	\$13,005.00	Bidder Did Not Include Required Form.
5	Shoulder Finishing, Earth	5 STA	\$1,000.00	\$5,000.00	\$2,100.00	\$10,500.00	\$648.00	\$3,240.00	
6	Excavation, Class 13, For Widening	665.00 CY	\$10.00	\$6,650.00	\$28.50	\$18,952.50	\$17.35	\$11,537.75	
7	Median, Dowelled P.C. Concrete, 6 Inch	553 SY	\$40.00	\$22,120.00	\$45.00	\$24,885.00	\$60.00	\$33,180.00	
8	Portland Cement Concrete Pavement Widening, 10 IN.	712 SY	\$55.00	\$39,160.00	\$56.50	\$40,228.00	\$80.00	\$56,960.00	
9	Surfacing, Driveway	100 TON	\$15.00	\$1,500.00	\$41.00	\$4,100.00	\$20.40	\$2,040.00	
10	Removal of Concrete Footings of Highway Signs	3 EACH	\$500.00	\$1,500.00	\$1,400.00	\$4,200.00	\$1,040.00	\$3,120.00	
11	Subdrain, Longitudinal, 4 in. Dia.	681 LF	\$10.00	\$6,810.00	\$13.90	\$9,465.90	\$21.00	\$14,301.00	
12	Subdrain Outlet, (RF-19C)	10 EACH	\$250.00	\$2,500.00	\$360.00	\$3,600.00	\$78.00	\$780.00	
13	Intake, RA-41	2 EACH	\$4,000.00	\$8,000.00	\$6,300.00	\$12,600.00	\$5,000.00	\$10,000.00	
14	Intake, RA-41, Modified	2 EACH	\$5,000.00	\$10,000.00	\$7,300.00	\$14,600.00	\$6,000.00	\$12,000.00	
15	Intake Extension Unit, RA-42	5 EACH	\$2,500.00	\$12,500.00	\$3,400.00	\$17,000.00	\$3,000.00	\$15,000.00	
16	Sewer pipe, 2000D Storm, 15 IN DIA	30 LF	\$60.00	\$1,800.00	\$183.00	\$5,490.00	\$200.00	\$6,000.00	
17	Utility Access, Convert Intake to Concrete Grout	1 EACH	\$3,000.00	\$3,000.00	\$3,400.00	\$3,400.00	\$2,000.00	\$2,000.00	
18	Removal of Pavement	1 CY	\$200.00	\$200.00	\$380.00	\$380.00	\$600.00	\$600.00	
19	Removal of Intakes and Utility Accesses	622 SY	\$25.00	\$15,550.00	\$36.50	\$22,703.00	\$20.00	\$12,440.00	
20	Removal of Sidewalk	6 EACH	\$600.00	\$3,600.00	\$770.00	\$4,620.00	\$617.00	\$3,702.00	
21	Sidewalk, P.C. Concrete, 4 IN	250 SY	\$10.00	\$2,500.00	\$16.25	\$4,062.50	\$13.00	\$3,250.00	
22	Sidewalk, P.C. Concrete, 6 IN	250 SY	\$30.00	\$7,500.00	\$37.50	\$9,375.00	\$27.00	\$6,750.00	
23	Detectable Warnings for Curb Ramps	15 SY	\$35.00	\$525.00	\$30.50	\$457.50	\$42.50	\$637.50	
24	Driveway, P.C. Concrete, 7 IN	486 SY	\$50.00	\$24,300.00	\$50.50	\$24,543.00	\$48.00	\$23,328.00	
25	Removal of Paved Driveway	653 SY	\$15.00	\$9,795.00	\$12.85	\$8,391.05	\$10.00	\$6,530.00	
26	Safety Closure	5 EACH	\$100.00	\$500.00	\$106.00	\$530.00	\$105.00	\$525.00	
27	Fence, Remove and Reinstall Chain Link, as per plan	250 LF	\$50.00	\$12,500.00	\$7.10	\$1,775.00	\$50.00	\$12,500.00	
28	Painted Pavement Markings, Waterborne or Solvent-Based	14 STA	\$100.00	\$1,400.00	\$100.50	\$1,407.00	\$100.00	\$1,400.00	

88

ITEM	DESCRIPTION	QUANTITY	UNIT PRICE	AMOUNT	UNIT PRICE	AMOUNT	UNIT PRICE	AMOUNT	UNIT PRICE	AMOUNT
30	Painted Pavement Markings, Highbuild Waterborne	75 STA	\$120.00	\$9,000.00	\$127.00	\$9,525.00	\$126.00	\$9,450.00		
31	Permanent Tape Markings, Profiled Pavement Marking Tape	25 STA	\$400.00	\$10,000.00	\$310.00	\$7,750.00	\$304.50	\$7,612.50		
32	Painted Symbols and Legends, Waterborne or Solvent-Based	8 EACH	\$125.00	\$1,000.00	\$85.00	\$680.00	\$84.00	\$672.00		
33	Pre-Cut Symbols and Legends, Intersection Marking Tape	8 EACH	\$500.00	\$4,000.00	\$340.00	\$2,720.00	\$336.00	\$2,688.00		
34	Pavement Markings Removed	14 STA	\$40.00	\$560.00	\$42.50	\$595.00	\$42.00	\$588.00		
35	Symbols and Legends Removed	8 EACH	\$125.00	\$1,000.00	\$100.50	\$804.00	\$100.00	\$800.00		
36	Grooves Cut For Pavement Markings	25 STA	\$40.00	\$1,000.00	\$63.50	\$1,587.50	\$63.00	\$1,575.00		
37	Grooves Cut For Symbols and Legends	8 EACH	\$125.00	\$1,000.00	\$159.00	\$1,272.00	\$158.00	\$1,264.00		
38	Traffic Control	1 LS	\$10,000.00	\$10,000.00	\$12,000.00	\$12,000.00	\$13,125.00	\$13,125.00		
39	Mobilization	1 LS	\$20,000.00	\$20,000.00	\$12,228.54	\$12,228.54	\$37,000.00	\$37,000.00		
40	Traffic Signalization Modifications	1 LS	\$17,800.00	\$17,800.00	\$23,000.00	\$23,000.00	\$22,800.00	\$22,800.00		
41	Sodding	10 SQ	\$40.00	\$400.00	\$79.50	\$795.00	\$105.00	\$1,050.00		
42	Shrubs	18 EACH	\$60.00	\$1,080.00	\$47.50	\$855.00	\$53.00	\$954.00		
43	Tree	3 EACH	\$300.00	\$900.00	\$290.00	\$870.00	\$368.00	\$1,104.00		
TOTAL CONSTRUCTION COST				\$291,825.00		\$359,999.99		\$374,318.50		\$0.00
PERCENT OF ENGINEER'S ESTIMATE						+23.36%		+28.27%		-100.00%