

DATE July 13, 2009

ORDERING CONSTRUCTION OF
BELL AVENUE PAVING - DRUID HILL DRIVE EAST TO DEAD END
AND FIXING A DATE FOR RECEIVING OF BIDS ON JULY 28, 2009
AND PUBLIC HEARING ON AUGUST 10, 2009
ENGINEER'S ESTIMATE IS \$395,000.00

BE IT RESOLVED BY THE CITY COUNCIL OF THE CITY OF DES MOINES, IOWA: That the attached communication recommending construction of the following improvement and the method of financing; and also including the recommendation of the Des Moines City Engineer, as the Jurisdictional Engineer, submitting plans, specifications, form of contract documents, and Jurisdictional Engineer's estimate of cost for the construction of the following improvement:

Bell Avenue Paving - Druid Hill Drive East to Dead End, 06-2009-010

The improvement includes construction of street paving twenty-six (26) feet wide B/B with Portland Cement Concrete six (6) inches thick with integral curb, pavement removal, storm sewer, subdrains, water services, driveways, retaining walls, together with the necessary surface restoration on Bell Avenue from Druid Hill Drive east to Dead End, Activity ID 06-2009-010, Schedule No. 2009-01

be and the same are hereby approved and accepted. The estimated construction cost for said improvement is \$395,000.00. The proposed plans, specifications, and form of contract documents are available for public inspection in the City Engineer's Office.

BE IT FURTHER RESOLVED: That this Council hereby determines that it is necessary and advisable to construct said improvement in the manner set forth in the plans, specifications, and form of contract documents submitted by the Jurisdictional Engineer; and that payment for the cost of said improvement shall be paid from the funding source identified below.

BE IT FURTHER RESOLVED: That a public hearing on said plans, specifications, form of contract documents, and Jurisdictional Engineer's estimate of construction cost for said improvement be held in the City Council Chambers, 2nd Floor, City Hall, 400 Robert D. Ray Drive, Des Moines, Iowa, at 5:00 p.m. on August 10, 2009, at which time this Council will consider any objections offered thereto or to the making of said improvement.

BE IT FURTHER RESOLVED: That proposals will be received by the City of Des Moines, at the office of the City Clerk until 11:00 a.m. on July 28, 2009, for the construction of said improvement, and the taking of bids in the manner required by law. Proposals received will be opened at a public meeting presided over by the Jurisdictional Engineer in the City Council Chambers, 2nd Floor, City Hall, 400 Robert D. Ray Drive, Des Moines, Iowa, at 11:00 a.m. on July 28, 2009, after which the bids together with a bid tabulation and recommendation of the Jurisdictional Engineer will be presented to the City Council at its next meeting for action thereon.

★ **Roll Call Number**

Agenda Item Number

7 (E)

DATE July 13, 2009

BE IT FURTHER RESOLVED: That an appropriate Notice to Bidders and Notice of Public Hearing for said improvement be published in the Des Moines Register as provided and directed by Chapter 26 and/or 314, Code of Iowa.

(City Council Communication Number 09-470 attached.)

Moved by _____ to adopt.

FORM APPROVED:

FUNDS AVAILABLE

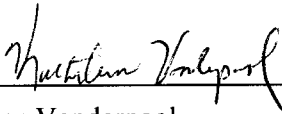

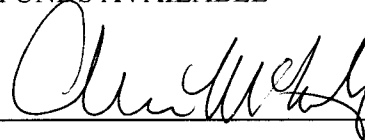

Kathleen Vanderpool
Deputy City Attorney

Allen McKinley
Des Moines Finance Director

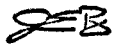
 Funding Source: 2009-2010 Approved, Page Street-6, City-wide Paving Program, STR013, Being: \$52,135.01 from Special Assessments against benefited property owners and \$342,864.99 in G. O. Bonds

COUNCIL ACTION	YEAS	NAYS	PASS	ABSENT
COWNIE				
COLEMAN				
HENSLEY				
KIERNAN				
MAHAFFEY				
MEYER				
VLASSIS				
TOTAL				

MOTION CARRIED APPROVED

Mayor

I, Diane Rauh, City Clerk of said City Council, hereby certify that at a meeting of the City Council, held on the above date, among other proceedings the above was adopted.

IN WITNESS WHEREOF, I have hereunto set my hand and affixed my seal the day and year first above written.

City Clerk

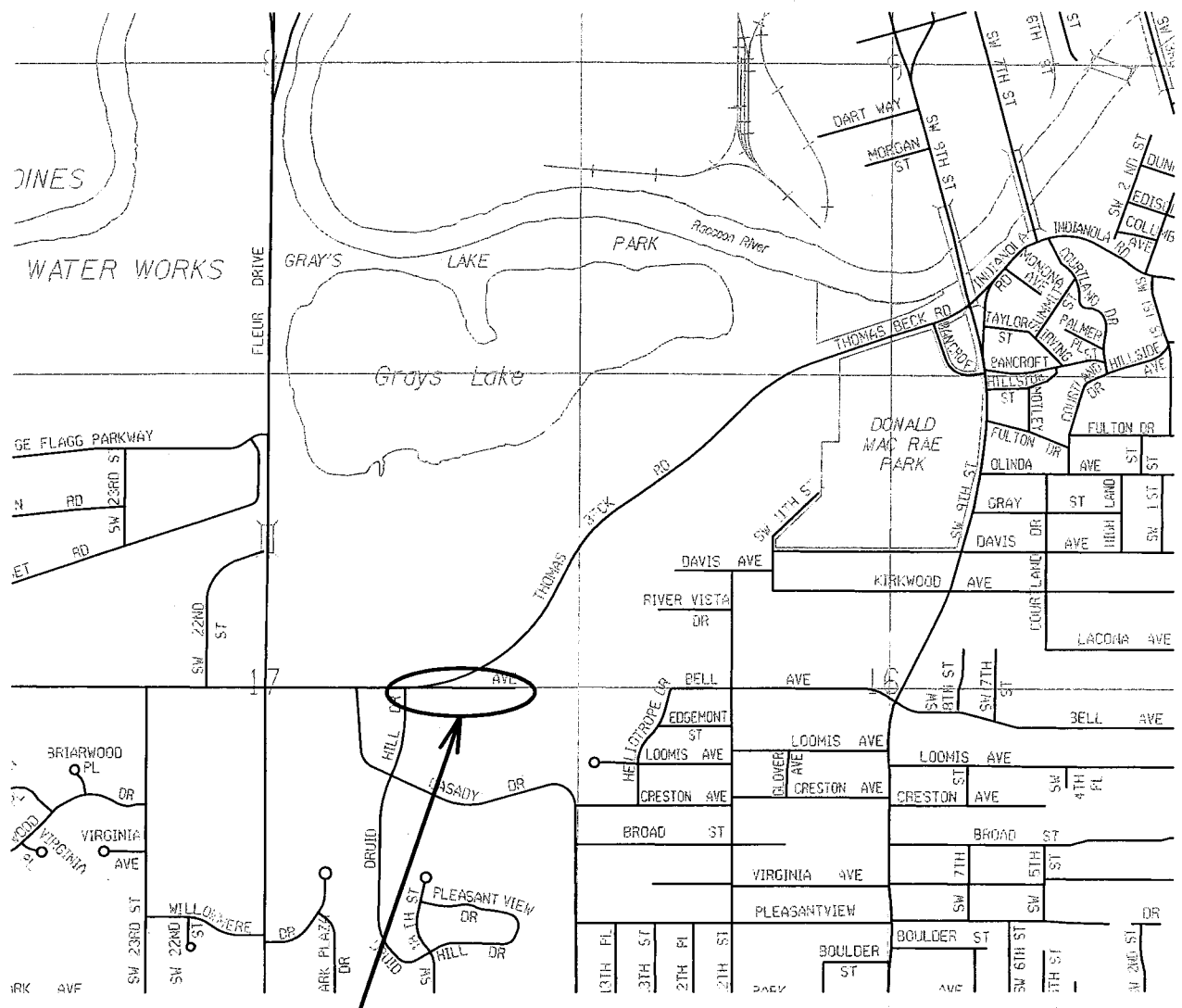

**PROJECT
LOCATION**

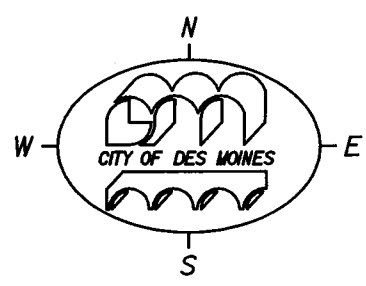

**BELL AVENUE PAVING
DRUID HILL DRIVE EAST TO DEAD END
ACTIVITY I.D. 06-2009-010**

7 (E)

CONSTRUCTION ESTIMATEDEPARTMENT OF ENGINEERING
CITY OF DES MOINES, IOWAActivity ID: 06-2009-010
IDOT PROJ NO.: None
DATE: 6/26/09**PROJECT: BELL AVENUE PAVING - DRUID HILL DRIVE EAST TO DEAD END**

NO.	DESCRIPTION	ESTIMATED UNITS			AMOUNT
		UNIT	TOTAL	UNIT PRICE	TOTAL
1	* Clearing, Tree	IN	45.0	\$50.00	\$2,250.00
2	Subgrade Preparation	SY	3460.0	\$3.00	\$10,380.00
3	Class 10 Excavation	CY	1825.0	\$20.00	\$36,500.00
4	Modified Subbase	TON	975.0	\$40.00	\$39,000.00
5	* Temporary Surfacing	TON	30.0	\$30.00	\$900.00
6	* Removal of Guardrail	LF	438.0	\$10.00	\$4,380.00
7	* Pavement Removal	SY	370.0	\$10.00	\$3,700.00
8	* Driveway Removal	SY	257.4	\$10.00	\$2,574.00
9	Full Width Pavement, PCC Section	SY	2870.0	\$40.00	\$114,800.00
10	Driveway, 6" PCC	SY	311.7	\$30.00	\$9,351.00
11	HMA Commercial Mix	TON	50.0	\$100.00	\$5,000.00
12	Revetment, Class D	TON	15.0	\$50.00	\$750.00
13	* Remove Existing Storm Sewer	LF	253.0	\$10.00	\$2,530.00
14	15" RCP, Class III Storm Sewer	LF	324.3	\$60.00	\$19,458.00
15	18" RCP, Class III Storm Sewer	LF	133.2	\$65.00	\$8,658.00
16	24" RCP, Class III Storm Sewer	LF	139.5	\$75.00	\$10,462.50
17	24" RCP Apron	EA	1.0	\$1,200.00	\$1,200.00
18	Intake, Type M-A	EA	7.0	\$3,000.00	\$21,000.00
19	Intake, Type M-B	EA	2.0	\$3,000.00	\$6,000.00
20	Intake, Type M-G	EA	2.0	\$4,500.00	\$9,000.00
21	M-A Manhole, Storm Sewer	EA	1.0	\$3,500.00	\$3,500.00

7(E)

NO.	DESCRIPTION	ESTIMATED UNITS			AMOUNT
		UNIT	TOTAL	UNIT PRICE	TOTAL
22	Subdrain	LF	930.0	\$25.00	\$23,250.00
23	Subdrain Outlet	EACH	4.0	\$200.00	\$800.00
24	Curb & Gutter Replacement	LF	87.0	\$40.00	\$3,480.00
25 *	Water Service Depth Check	EACH	3.0	\$250.00	\$750.00
26	Water Service Lowering	EACH	2.0	\$1,500.00	\$3,000.00
27	Water Service Lowered with New Copper	EACH	2.0	\$3,000.00	\$6,000.00
28	Relocate Water Service Stop Box	EACH	1.0	\$2,000.00	\$2,000.00
29	Adjust Water Service Stop Box	EACH	2.0	\$500.00	\$1,000.00
30	Lower Sanitary Sewer Service	LS	1.0	\$7,000.00	\$7,000.00
31 *	Wood Excelsior Mat	SQ	60.0	\$75.00	\$4,500.00
32 *	Seeding, Fertilizer, Mulching	ACRE	0.3	\$5,000.00	\$1,500.00
33 *	Sodding	SQ	100.0	\$50.00	\$5,000.00
34 *	Watering, Sod	MGAL	5.0	\$500.00	\$2,500.00
35 *	Traffic Control	LS	1.0	\$4,926.50	\$4,926.50
36	Road Closure, RE-3B	EACH	1.0	\$500.00	\$500.00
37	Cable Guardrail, RE-29C	LF	350.0	\$20.00	\$7,000.00
38	Cable Guardrail, End Anchorage, RE-29A	EACH	2.0	\$1,000.00	\$2,000.00
39 *	Compost Filter Tube	LF	1500.0	\$3.00	\$4,500.00
40 *	Removal of Compost Filter Tube	LF	1500.0	\$1.00	\$1,500.00
41	Retaining Wall Grading at 6710 SW 11th	LS	1.0	\$1,200.00	\$1,200.00
42	Retaining Wall Grading at 1000-1002 Bundy	LS	1.0	\$1,200.00	\$1,200.00
43	Modular Block Retaining Wall	SF	275.0	\$22.00	\$6,050.00
44	Remove Existing Retaining Wall and Replace with Modular Block	SF	575.0	\$25.00	\$14,375.00

Prepared By: David Kamp

Checked By: _____

TOTAL CONSTRUCTION COST **\$395,000.00**

* Item does not have to be included in 4-year maintenance bond, but shall be covered by a 1-year maintenance bond.

* Estimate Total= \$41,510.50