

★ Roll Call Number

Agenda Item Number

10B

DATE July 14, 2008

**ACCEPTING COMPLETED CONSTRUCTION AND APPROVING FINAL PAYMENT FOR SOUTHEAST RIDGE TRUNK SANITARY SEWER - PHASE 2A, S. J. LOUIS CONSTRUCTION, INC.**

BE IT RESOLVED BY THE CITY COUNCIL OF THE CITY OF DES MOINES, IOWA: That the attached report of the Jurisdictional Engineer, showing the cost of the construction of the Southeast Ridge Trunk Sanitary Sewer - Phase 2A, 07-2005-017, in accordance with the contract approved between S. J. Louis Construction, Inc., James L. Schueller, President, 3032 County Road 138, P.O. Box 399, Waite Park, MN 56387-0399, under Roll Call No. 05-3047, of December 19, 2005, and the City of Des Moines, and recommending the acceptance thereof, be and the same is hereby approved, and accepted, and

BE IT FURTHER RESOLVED: That \$3,285,482.01 is the total cost, of which \$3,113,271.14 has been paid the Contractor, and \$7,936.77 is now due and is hereby approved as final partial payment for the above project, the remaining balance of \$164,274.10 is to be paid at the end of thirty days, provided no claims or liens have been filed against said contract. In the event that at the end of said thirty (30) day period, claims are on file as herein provided, the City of Des Moines shall continue to retain from said unpaid funds, a sum not less than double the total amount of all claims on file, or the full Chapter 573 Code of Iowa retainage amount, whichever is lesser.

BE IT FURTHER RESOLVED: That the Engineering Department be and is hereby authorized and directed to notify all persons and firms with outstanding Chapter 573 claims against said project, that the project has been given final acceptance as completed by this City Council, that they have 60 days from such acceptance within which to initiate suit to collect on their claims, and that if suit is not commenced within that time, the City of Des Moines will be required to release the retainage which it is now holding.

BE IT FURTHER RESOLVED: That the City Manager be and is hereby authorized and directed to certify the Pollution Prevention Plan Inspection Summary and the NPDES Stormwater General Permit Notice of Discontinuation for the above referenced project on behalf of the City of Des Moines and submit said documents to the Iowa Department of Natural Resources.

BE IT FURTHER RESOLVED: That the Des Moines Finance Director be and is hereby authorized to release said retainage if suit is not filed as above provided.

Moved by \_\_\_\_\_ to adopt.

FORM APPROVED:

FUNDS AVAILABLE



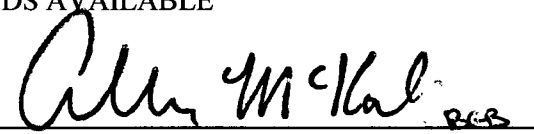

Kathleen Vanderpool  
Deputy City Attorney

Allen McKinley  
Des Moines Finance Director

JA Funding Source: 2008-2009 CIP, Page Sanitary-14, Southeast Ridge Trunk Sanitary Sewer, SAE120, Sanitary Sewer Funds

★ Roll Call Number

Agenda Item Number

10B

DATE July 14, 2008

COUNCIL ACTION	YEAS	NAYS	PASS	ABSENT
COWNIE				
COLEMAN				
HENSLEY				
KIERNAN				
MAHAFFEY				
MEYER				
VLASSIS				
TOTAL				

MOTION CARRIED

APPROVED

Mayor

I, Diane Rauh, City Clerk of said City Council, hereby certify that at a meeting of the City Council, held on the above date, among other proceedings the above was adopted.

IN WITNESS WHEREOF, I have hereunto set my hand and affixed my seal the day and year first above written.

City Clerk

10 B

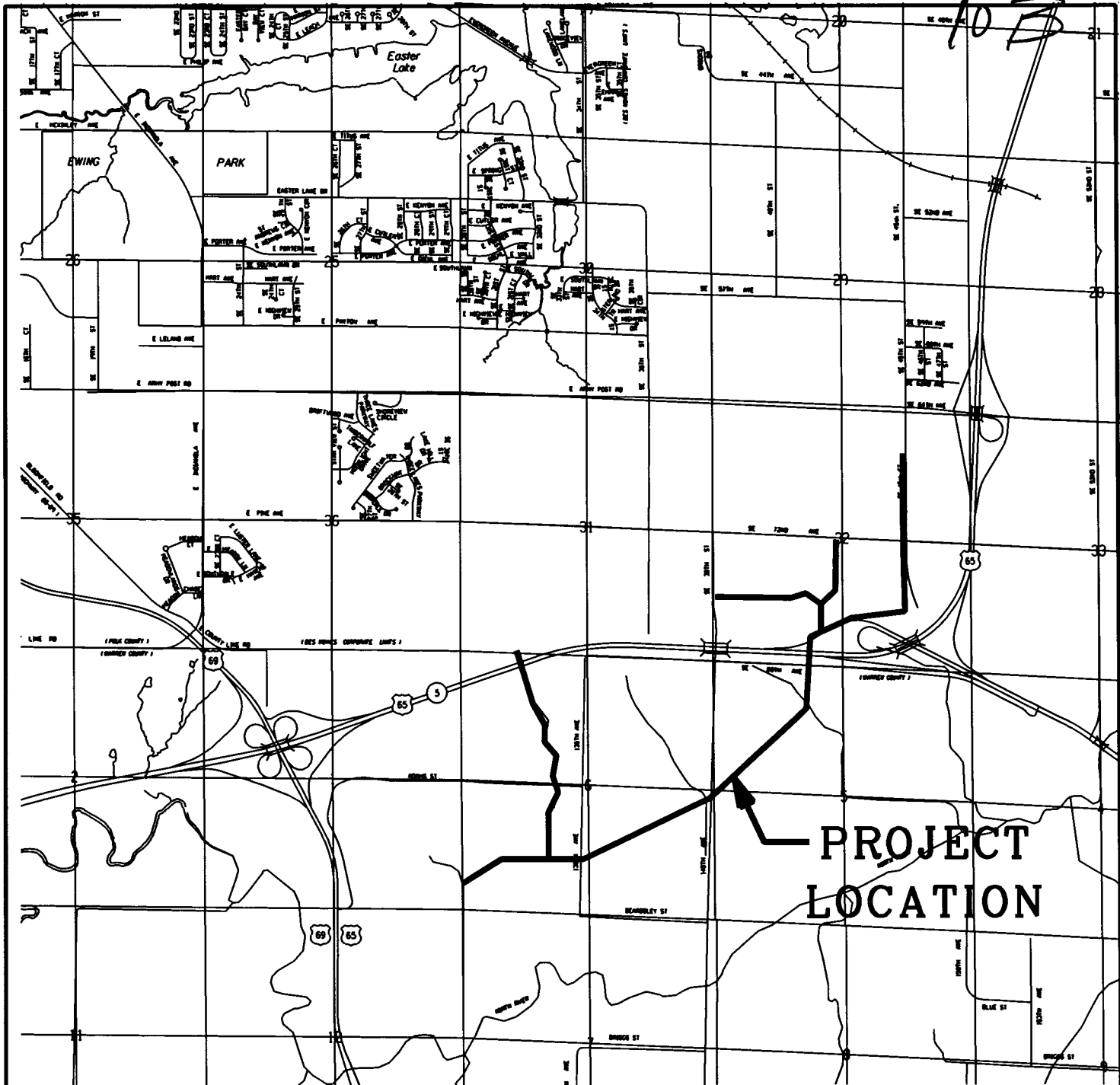

**PROJECT  
LOCATION**

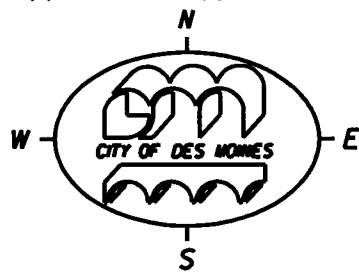

**S.E. RIDGE TRUNK SANITARY SEWER  
PHASE 2A  
ACTIVITY I.D. 07-2005-017**

sfie-dates

10B

# PROJECT SUMMARY

## SE Ridge Trunk Sanitary Sewer Ph 2A

### Activity ID 07-2005-017

On December 19, 2005, under Roll Call No. 05-3047, the City Council awarded the contract for the above improvement to S.J. Louis Construction, Inc., in the amount of \$3,499,000.00 to construct approximately 23,000 LF of gravity sanitary sewer ranging in size from 8-inch to 30-inch and other related items.

Tabulated below is a history of project change orders.

<u>Change Order No.</u>	<u>Description</u>	<u>Initiated By</u>	<u>Amount</u>
1	6/28/2007 Delete Trench Stabilization Rock and add Field Tile Installation to correct saturated soil conditions at and near the sewer trench.	Engineering	\$0.00
2	1/8/2008 Adjust contract quantities to match as-constructed quantities.	Engineering	(\$213,517.99)
<b>Original Contract Amount</b>			\$3,499,000.00
<b>Total Change Orders</b>			(\$213,517.99)
<b>Percent of Change Orders to Original Contract</b>			-6.10%
<b>Final Contract Amount</b>			\$3,285,482.01

10 B

July 14, 2008

**CERTIFICATION OF COMPLETION**

**AGENDA HEADING:**

Accepting completed construction and approving final payment for the Southeast Ridge Trunk Sanitary Sewer - Phase 2A, S. J. Louis Construction, Inc..

**SYNOPSIS:**

Approve the Jurisdictional Engineer's Certification of Completion, accept construction of said improvement, and authorize final payment to the contractor.

**FISCAL IMPACT:**

Amount: \$3,285,482.01 As-Built Contract Cost

Funding Source: 2008-2009 CIP, Page Sanitary-14, Southeast Ridge Trunk Sanitary Sewer, SAE120, Sanitary Sewer Funds

**CERTIFICATION OF COMPLETION:**

On December 19, 2005, under Roll Call No. 05-3047, the City Council awarded a contract to S. J. Louis Construction, Inc., James L. Schueller, President, 3032 County Road 138, P.O. Box 399, Waite Park, MN 56387-0399 for the construction of the following improvement:

Southeast Ridge Trunk Sanitary Sewer - Phase 2A, 07-2005-017

Construction of approximately 23,000 LF of sanitary sewer ranging in size from 8" to 30", including approximately 2,100 LF of tunneling and encasement, surface restoration and other related items, all in accordance with the contract documents including Plan File No. 458 - 114/148. This project is located in the vicinity of US Highway 65 and State Highway 5 at the south edge of Des Moines and east of US Highway 69

I hereby certify that the construction of said Southeast Ridge Trunk Sanitary Sewer - Phase 2A, Activity ID 07-2005-017, has been completed in substantial compliance with the terms of said contract, and I hereby recommend that the work be accepted. The work commenced on May 22, 2006, and was completed on July 1, 2008.



ENGINEERING DEPARTMENT  
CITY HALL  
400 ROBERT D. RAY DRIVE  
DES MOINES, IOWA 50309-1891  
(515) 283-4920  
FAX (515) 283-4112

ALL-AMERICA CITY  
1949, 1976, 1981  
2003

10.73

I further certify that \$3,285,482.01 is the total cost of said improvement, of which \$3,113,271.14 has been paid the Contractor and \$7,936.77 is now due and is hereby approved as final partial payment for the above project, the remaining balance of \$164,274.10 is to be paid at the end of thirty days, provided no claims or liens have been filed against said contract. In the event that at the end of said thirty (30) day period, claims are on file as herein provided, the City of Des Moines shall continue to retain from said unpaid funds, a sum not less than double the total amount of all claims on file, or the full Chapter 573 Code of Iowa retainage amount, whichever is lesser. The amount of completed work is shown on the attached Estimate of Construction Completed.



Jeb E. Brewer, P.E.  
Des Moines City Engineer



**ESTIMATE OF CONSTRUCTION COMPLETED**  
**FOR WORK DONE FROM 12/17/06 to 08/01/07**  
**PARTIAL PAYMENT NO. 6 & FINAL**

OWNER: City of Des Moines, Iowa

PROJECT: Southeast Ridge Trunk Sanitary Sewer - Phase 2A

CONTRACTOR: S.J. Louis Construction, Inc.

ACTIVITY ID 07-2005-017

DATE: November 26, 2007

LINE NO.	DESCRIPTION	UNIT	UNITS			UNIT PRICE	TOTAL AMOUNT
			ESTIMATED	AUTHORIZED	CONSTRUCTED TO DATE		
1	Traffic Control	LS	1.000	1.000	1.000	\$3,589.00	\$3,589.00
2	Construction Staking	LS	1.000	1.000	1.000	\$26,000.00	\$26,000.00
3	Cleaning and Grubbing	AC	4.400	4.400	4.400	\$7,900.00	\$34,760.00
4	Sanitary Sewer, 8"	LF	1,170.000	1,181.083	1,181.083	\$50.00	\$59,054.15
5	Sanitary Sewer, 12"	LF	2,916.000	2,911.724	2,911.724	\$60.00	\$174,703.44
6	Sanitary Sewer, 15"	LF	5,165.000	5,158.480	5,158.480	\$70.00	\$361,093.60
7	Sanitary Sewer, 21"	LF	1,985.000	1,986.904	1,986.904	\$80.00	\$158,952.32
8	Sanitary Sewer, 30"	LF	8,626.000	8,676.540	8,676.540	\$91.00	\$789,565.14
9	Sanitary Sewer, 8" D.I.	LF	120.000	117.442	117.442	\$55.00	\$6,459.30
10	Sanitary Sewer, 16" D.I.	LF	380.000	375.864	375.864	\$70.00	\$26,310.48
11	Sanitary Sewer, 20" D.I.	LF	498.000	491.829	491.829	\$85.00	\$41,805.47
12	Sanitary Sewer, 30" D.I.	LF	167.000	169.264	169.264	\$115.00	\$19,465.36
13	Tunneling, 24" Steel Casing & 8" Carrier Pipe	LF	570.000	570.000	570.000	\$320.00	\$182,400.00
14	Tunneling, 24" Steel Casing & 12" Carrier Pipe	LF	205.000	205.000	205.000	\$330.00	\$67,650.00
15	Tunneling, 30" Steel Casing & 15" Carrier Pipe	LF	105.000	105.000	105.000	\$540.00	\$56,700.00
16	Tunneling, 42" Steel Casing & 21" Carrier Pipe	LF	695.000	695.000	695.000	\$550.00	\$382,250.00
17	Tunneling, 42" Steel Casing & 30" Carrier Pipe	LF	220.000	220.000	220.000	\$580.00	\$127,600.00
18	Sanitary Sewer, 8" Creek Crossing	LF	60.000	60.000	60.000	\$590.00	\$35,400.00
19	Sanitary Sewer, 16" Creek Crossing	LF	130.000	130.000	130.000	\$670.00	\$87,100.00
20	Sanitary Sewer, 20" Creek Crossing	LF	60.000	60.000	60.000	\$700.00	\$42,000.00
21	Sanitary Sewer, 30" Creek Crossing	LF	90.000	90.000	90.000	\$870.00	\$78,300.00
22	Sanitary Manhole, 48" Type A	EA	40.000	40.000	40.000	\$2,800.00	\$112,000.00
23	Sanitary Manhole, 60" Type A	EA	25.000	25.000	25.000	\$3,700.00	\$92,500.00
24	Sanitary Manhole, 72" Type A	EA	1.000	1.000	1.000	\$6,600.00	\$6,600.00
25	Video Inspection	LF	23,162.000	23,214.000	23,214.000	\$2.00	\$46,428.00
26	Construction Fencing	LF	490.000	490.000	490.000	\$3.00	\$1,470.00
27	Trench Stabilization	TON	8,500.000	213.160	213.160	\$22.00	\$4,689.52
28	Granular Surfacing	TON	74.000	81.000	81.000	\$22.00	\$1,782.00
29	Rip Rap	TON	2,260.000	1,706.020	1,706.020	\$39.00	\$66,534.78
30	Field Fence Removal and Replacement	LF	2,400.000	3,951.000	3,951.000	\$6.00	\$23,706.00
31	Drain Tile Repair	LF	2,400.000	1,599.000	1,599.000	\$16.00	\$25,584.00
32	Erosion Control	LS	1.000	1.000	1.000	\$15,000.00	\$15,000.00
33	Silt Fence	LF	46,000.000	18,425.000	18,425.000	\$1.75	\$32,243.75
34	Seeding	AC	20.900	14.640	14.640	\$320.00	\$4,684.80
35	Mulching	AC	41.800	14.640	14.640	\$210.00	\$3,074.40
36	Dewatering	LS	1.000	1.000	1.000	\$42,312.00	\$42,312.00

10 B

PROJECT: Southeast Ridge Trunk Sanitary Sewer - Phase 2A  
 CONTRACTOR: S.J. Louis Construction, Inc.

ACTIVITY ID 07-2005-017  
 DATE: November 26, 2007

LINE NO.	DESCRIPTION	UNIT	UNITS		UNIT PRICE	TOTAL AMOUNT
			ESTIMATED	AUTHORIZED		
	<b>CHANGE ORDER ITEMS</b>					
101	Field tile installation	LF		4,056.000	\$10.00	\$40,560.00
201	Negotiated Settlement	LS		1.000	-3,136.750	(\$3,136.75)
202	Silt Fence, Price Adjustment	LF		18,425.000	\$0.45	\$8,291.25
	<b>TOTAL CONTRACT AMOUNT PLUS CHANGE ORDERS</b>		\$3,285,482.01			
	<b>THIS PARTIAL PAYMENT</b>		\$7,936.76			
	<b>TOTAL PARTIAL PAYMENTS</b>		\$3,121,207.90			
	<b>BALANCE</b>		\$164,274.11			
	Percent Complete	100%				
	<b>TOTAL</b>					\$3,285,482.01
	<b>RETAINAGE</b>					\$164,274.10
	<b>TOTAL LESS RETAINAGE</b>					\$3,121,207.90
	<b>LESS PREVIOUS PAYMENTS</b>					\$3,113,271.14
	<b>AMOUNT DUE</b>					\$7,936.76

PARTIAL PAYMENT NO. 6 & FINAL

031  
032

PREPARED BY: Chris Pederson  
 Snyder & Associates

CHECKED BY: Mark O'Connell  
 City of Des Moines

ACCEPTED BY: Ray Walsh  
 S.J. Louis Construction, Inc.

**SUMMARY TO-DATE**

CHANGE ORDERS NUMBER	DATE	AMOUNT
1	05/22/07	\$0.00
2	09/10/07	-\$213,517.99

**PARTIAL PAYMENTS**

PARTIAL PAYMENTS NUMBER	DATE	AMOUNT
1	06/29/06	\$1,100,237.85
2	08/24/06	\$798,019.61
3	10/31/06	\$1,012,988.23
4	12/18/06	\$139,772.17
5	09/06/07	\$62,253.28

10 B