

July 24, 2006

Date

An Ordinance entitled, "AN ORDINANCE to amend the Municipal Code of the City of Des Moines, Iowa, 2000, adopted by Ordinance No. 13,827, passed June 5, 2000, and amended by Ordinance No. 13,855 passed August 21, 2000, and Ordinance No. 13,972 passed July 23, 2001, and Ordinance No. 14,057 passed February 18, 2002, and Ordinance No. 14,404 passed January 10, 2005, and Ordinance No. 14,437 passed April 25, 2005, and Ordinance No. 14,458 passed June 6, 2005, and Ordinance No. 14,472 passed July 25, 2005, and Ordinance No. 14,566 passed June 5, 2006 by amending Sections 114-306.01, 114-1323, 114-2608, 114-3914 and 114-3933.03 thereof, relating to traffic and vehicle regulations",

presented.

Moved by \_\_\_\_\_ that this ordinance  
be considered and given first vote for passage.

(Council Communication No. 06-463)

FORM APPROVED:

(First of three required  
readings)

K. Massier  
Katharine Massier  
Assistant City Attorney

COUNCIL ACTION	YEAS	NAYS	PASS	ABSENT
COWNIE				
BROOKS				
COLEMAN				
HENSLEY				
MAHAFFEY				
KIERNAN				
VLASSIS				
TOTAL				

MOTION CARRIED

APPROVED

.....Mayor

## CERTIFICATE

I, DIANE RAUH, City Clerk of said City hereby certify that at a meeting of the City Council of said City of Des Moines, held on the above date, among other proceedings the above was adopted.

IN WITNESS WHEREOF, I have hereunto set my hand and affixed my seal the day and year first above written.

.....City Clerk

ORDINANCE NO. \_\_\_\_\_

AN ORDINANCE to amend the Municipal Code of the City of Des Moines, Iowa, 2000, adopted by Ordinance No. 13,827, passed June 5, 2000, and amended by Ordinance No. 13,855 passed August 21, 2000, and Ordinance No. 13,972 passed July 23, 2001, and Ordinance No. 14,057 passed February 18, 2002, and Ordinance No. 14,404 passed January 10, 2005, and Ordinance No. 14,437 passed April 25, 2005, and Ordinance No. 14,458 passed June 6, 2005, and Ordinance No. 14,472 passed July 25, 2005, and Ordinance No. 14,566 passed June 5, 2006 by amending Sections 114-306.01, 114-1323, 114-2608, 114-3914 and 114-3933.03 thereof, relating to traffic and vehicle regulations.

Be It Ordained by the City Council of the City of Des Moines, Iowa:

Section 1. That the Municipal Code of the City of Des Moines, Iowa, 2000, adopted by Ordinance No. 13,827, passed June 5, 2000, and amended by Ordinance No. 13,855 passed August 21, 2000, and Ordinance No. 13,972 passed July 23, 2001, and Ordinance No. 14,057 passed February 18, 2002, and Ordinance No. 14,404 passed January 10, 2005, and Ordinance No. 14,437 passed April 25, 2005, and Ordinance No. 14,458 passed June 6, 2005, and Ordinance No. 14,472 passed July 25, 2005, and Ordinance No. 14,566 passed June 5, 2006 is hereby amended by amending Section 114-306.01, 114-1323, 114-2608, 114-3914 and 114-3933.03 thereof, relating to traffic and vehicle regulations, as follows:

**Sec. 114-306.01. Traffic lanes allocated.**

No person shall operate a vehicle in violation of the signs erected or pavement markings installed giving notice of the allocation of lanes of the street designated in this section. The director of traffic and transportation shall cause necessary and appropriate signs to be posted or necessary pavement markings installed along the street designated as follows, informing the general public of the restrictions:

- (1) On Southeast First Street, from Southwest Water Street to ~~East Edison Avenue~~Indianola Road, one lane northbound, one lane southbound, and the center lane northbound and southbound left turn only.

- ~~(2) On Southeast First Street, from Southwest Water Street to Indianola Road, two lanes southbound and one lane northbound.~~
- (32) On Sixth Avenue, from Ascension Street to Euclid Avenue, two lanes northbound, two lanes southbound, and the center lane northbound and southbound left turn only.
- (43) On Southwest Ninth Street, from West Street to Wade Street, one lane northbound, one lane southbound, and the center lane northbound and southbound left turn only.
- (54) On Southwest Ninth Street, from a point 230 feet south of McKinley Avenue to a point 300 feet south thereof, two lanes northbound, two lanes southbound, and the center lane northbound and southbound left turn only.
- (65) On Easton Boulevard, from East Twenty-second Street to Avenue Frederick M. Hubbell, ~~two~~one lanes eastbound, and one lane westbound, and the center lane eastbound and westbound left turn only.
- (76) On Bell Avenue, from 200 feet east of Fleur Drive to 150 feet west of Druid Hill Drive, one lane eastbound, one lane westbound, and center lane eastbound and westbound left-turn only.
- (87) On Grand Avenue, from West Third Street to East Sixth Street, one lane eastbound and the remaining lanes westbound.
- (98) On Crocker Street, from Sixteenth Street to Nineteenth Street, two lanes westbound and one lane eastbound.
- (9) On Hickman road, from 400 feet west of Thirtieth Street to Fortieth Place, two lanes eastbound, two lanes westbound and the center lane eastbound and westbound left turn lane.
- ~~(10) On Martin Luther King Jr Parkway, from Woodland Avenue to Center Street, two lanes southbound and one lane northbound.~~
- (10) On Hickman Road, from a point 300 feet west of Beaver Avenue to Fifty-seventh Street, two lanes eastbound, two lanes westbound and the center lane eastbound and westbound left turn lane.
- (11) On University Avenue, from Twenty-fourth Street to ~~Thirty first Street~~650 feet west of Forty-eight Street, two lanes eastbound, two lanes westbound, and the center lane eastbound and westbound left turn only.
- (12) On Beaver Avenue, from Urbandale Avenue to a point 290 feet north of Madison Avenue, and from Shawnee Avenue to Aurora Avenue, one lane northbound, one lane southbound, and the center lane northbound and southbound left turn only.
- (13) On Lower Beaver road, from Douglas Avenue to Valdez Drive (west leg), on lane northbound, one lane southbound, and the center lane northbound and southbound left turn only.
- (14) On East Court Avenue, from a point 500 feet east of East Seventh Street to a point 300 feet west of East

Fourteenth Street, one lane eastbound, one lane westbound, and the center lane eastbound and westbound left turn only.

**Sec. 114-1323. Hickman Road.**

Hickman Road, from Sixth Avenue to ~~west city limits~~ Thirtieth Street, 35 miles per hour.

Hickman Road, from Thirtieth Street to Merle Hay Road, 30 miles per hour.

Hickman Road, from Merle Hay Road to west city limits, 35 miles per hour.

**Sec. 114-2608. Third Street--Watson Powell Jr Way to School Street.**

Third Street, on the west side, from Watson Powell Jr Way to Park Street, no parking any time.

Third Street, on the west side, from Park Street to a point 100 feet north thereof, no parking any time.

Third Street, on the west side, from a point 100 feet north of Park Street to a point ~~175~~140 feet north thereof, passenger loading and unloading only, 20 minute limit, 9:00 a.m. to 7:00 a.m.

Third Street, on the west side, from a point 100 feet north of Park Street to a point ~~175~~140 feet north thereof, no parking 7:00 a.m. to 9:00 a.m.

Third Street, on the west side, from a point 240 feet north of Park Street to a point 35 feet north thereof, taxicab stand.

Third Street, on the west side, from a point 275 feet north of Park Street to Center Street, no stopping or standing any time.

Third Street, on the west side, from Center Street to a point 570 feet south of Crocker Street, no stopping or standing any time.

Third Street, on the west side, from a point 110 feet south of Crocker Street to a point 460 feet south thereof, passenger loading and unloading only, 20 minute limit, 9:00 a.m. to 7:00 a.m.

Third Street, on the west side, from a point 110 feet south of Crocker Street to a point 460 feet south thereof, no parking 7:00 a.m. to 9:00 a.m.

Third Street, on the west side, from School Street to a point 110 feet south of Crocker Street, no parking any time.

Third Street, on the east side, from Watson Powell Jr Way to a point 65 feet north thereof, no parking any time.

Third Street, on the east side, from a point 65 feet north of Watson Powell Jr Way to a point 135 feet south of Center Street, no parking 7:00 a.m. to 9:00 a.m.

Third Street, on the east side, from Center Street to a point 135 feet south thereof, no parking any time.

Third Street, on the east side, from Center Street to a point 120 feet north thereof, no parking any time.

Third Street, on the east side, from a point 120 feet north of Center Street to a point 150 feet north thereof, passenger loading and unloading only, 20 minute limit, 9:00 a.m. to 7:00 a.m.

Third Street, on the east side, from a point 120 feet north of

Center Street to a point 150 feet north thereof, no parking 7:00 a.m. to 9:00 a.m.

Third Street, on the east side, from a point 270 feet north of Center Street to School Street, no parking any time.

**Sec. 114-3914. Grand Avenue--Fifth Avenue to Sixth Avenue.**

Grand Avenue, on the south side, from Fifth Avenue to a point 95 feet west thereof, two-hour meters, 8:00 a.m. to 6:00 p.m.

Grand Avenue, on the south side, from a point 180 feet west of Fifth Avenue to Sixth Avenue, two-hour meters, 8:00 a.m. to 6:00 p.m.

Grand Avenue, on the south side, parking meter G-512, two-hour meter, 8:00 a.m. to 6:00 p.m., is designated a handicapped parking space and is subject to the same prohibition as is found in subsection 114-616(a) of this chapter.

Grand Avenue, on the south side, parking meter G-520, two-hour meter, 8:00 a.m. to 6:00 p.m., is designated a handicapped parking space and is subject to the same prohibition as is found in subsection 114-616(a) of this chapter.

**Sec. 114-3933.03. Southwest Water Street--Vine Street to West Martin Luther King Jr Parkway.**

Southwest Water Street, on both sides, from Vine Street to Market Street, ten-hour meters, 8:00 a.m. to 6:00 p.m.

Southwest Water Street, on the west side, from a point 63 feet south of Market Street to a point 120 feet south thereof, four hour meters, 8:00 a.m. to 6:00 p.m.

Southwest Water Street, on the west side, from a point 243 feet south of Market Street to a point 31 feet north of Elm Street, four hour meters, 8:00 a.m. to 6:00 p.m.

Southwest Water Street, on the east side, from Market Street to ~~a point 50 feet north of Elm Street~~, ten-hour meters, 8:00 a.m. to 6:00 p.m.

Sec. 2. This ordinance shall be in full force and effect from and after its passage and publication as provided by law.

FORM APPROVED:

K. Massier  
Katharine Massier  
Assistant City Attorney

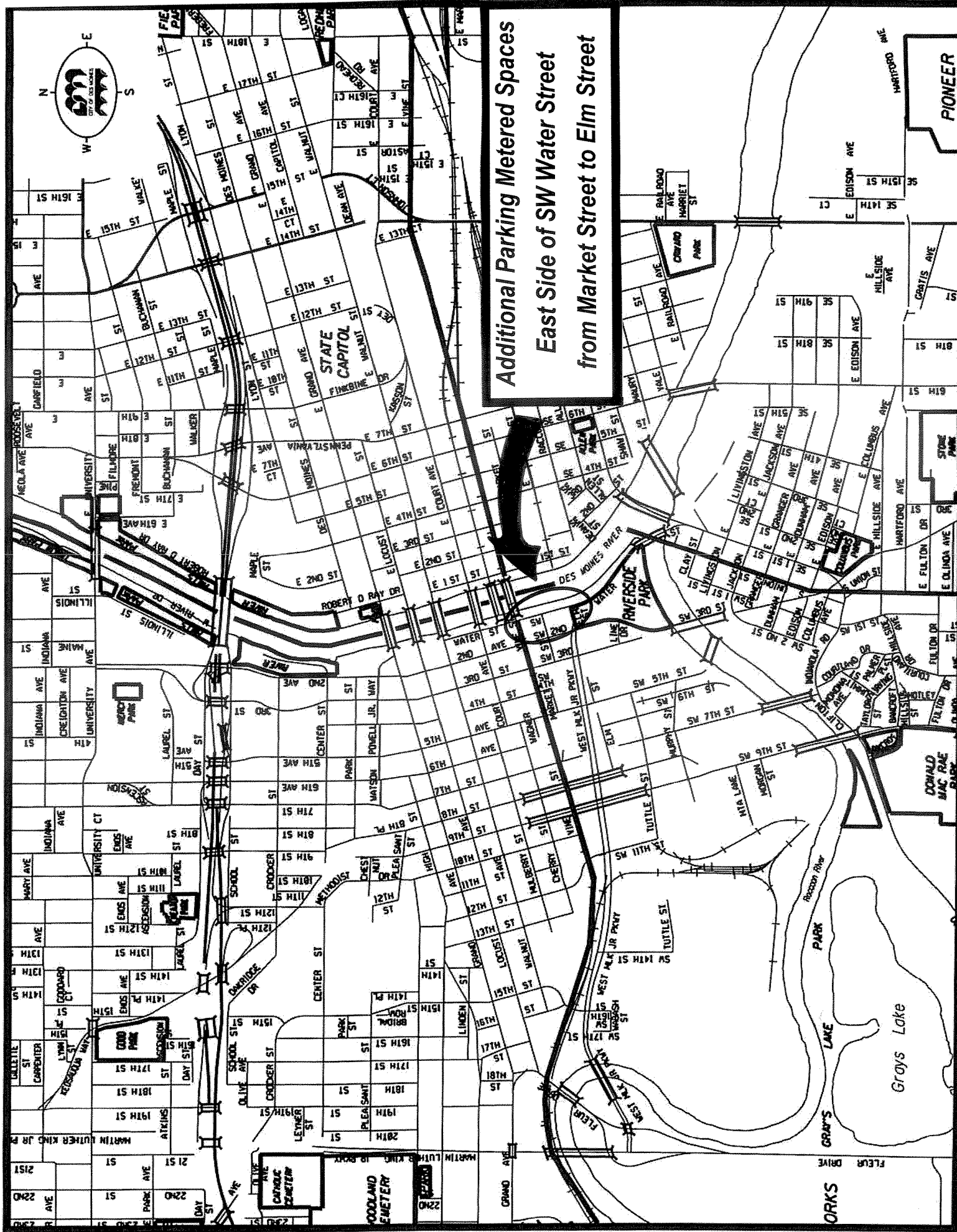

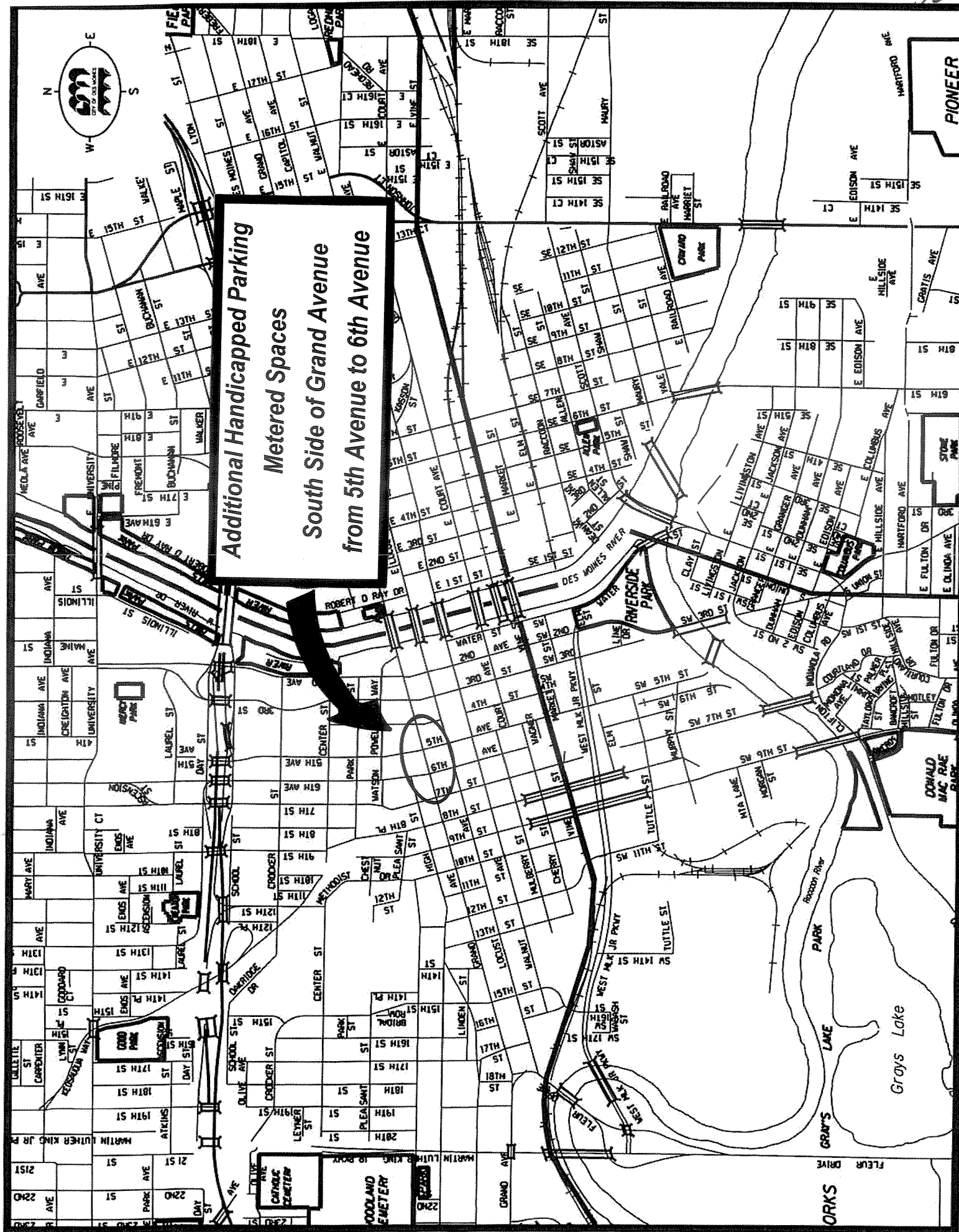



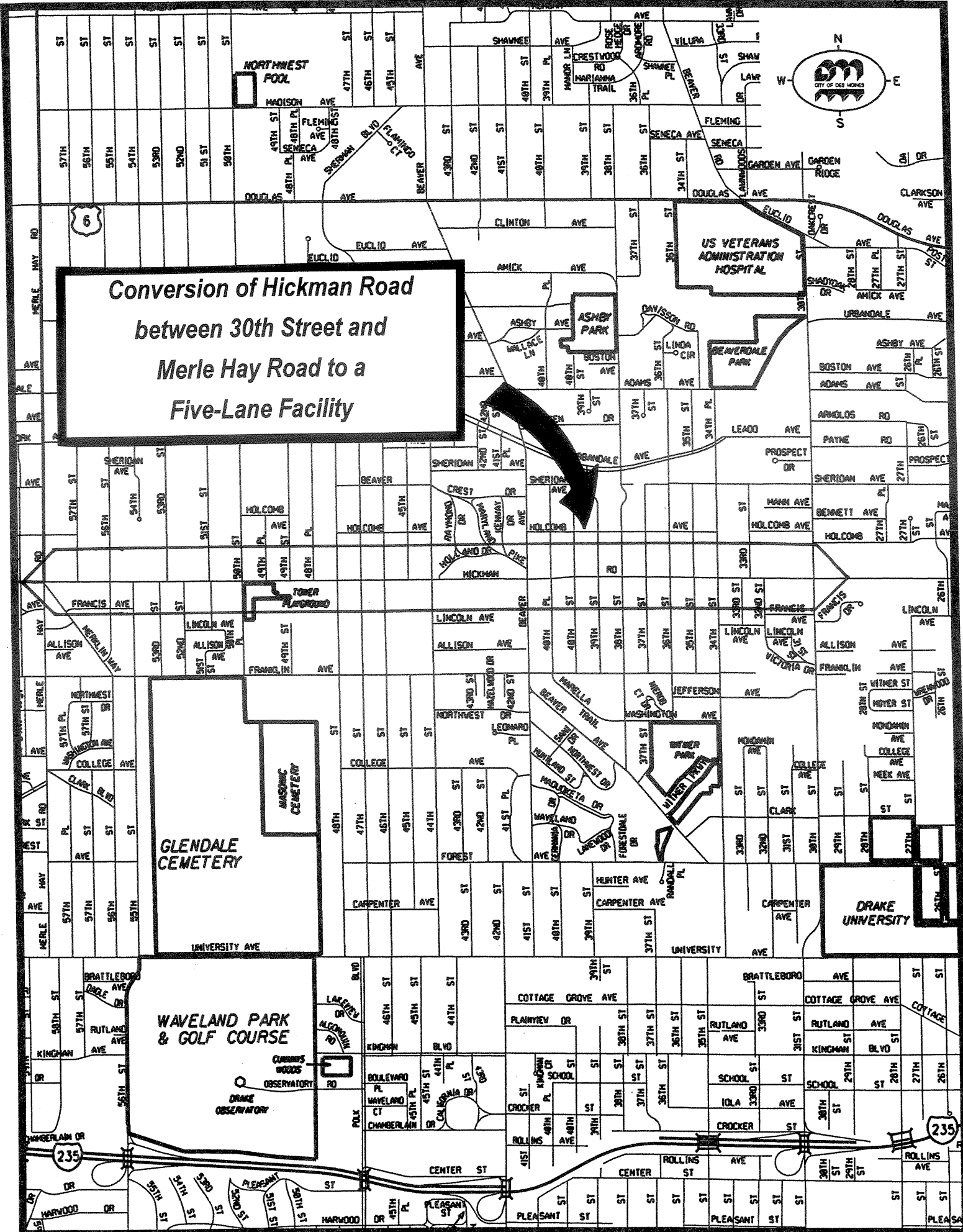

**Conversion of Hickman Road  
between 30th Street and  
Merle Hay Road to a  
Five-Lane Facility**

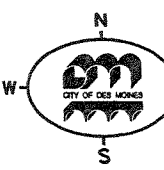
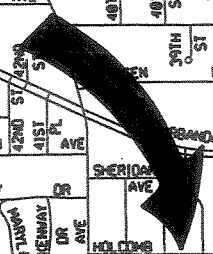

235



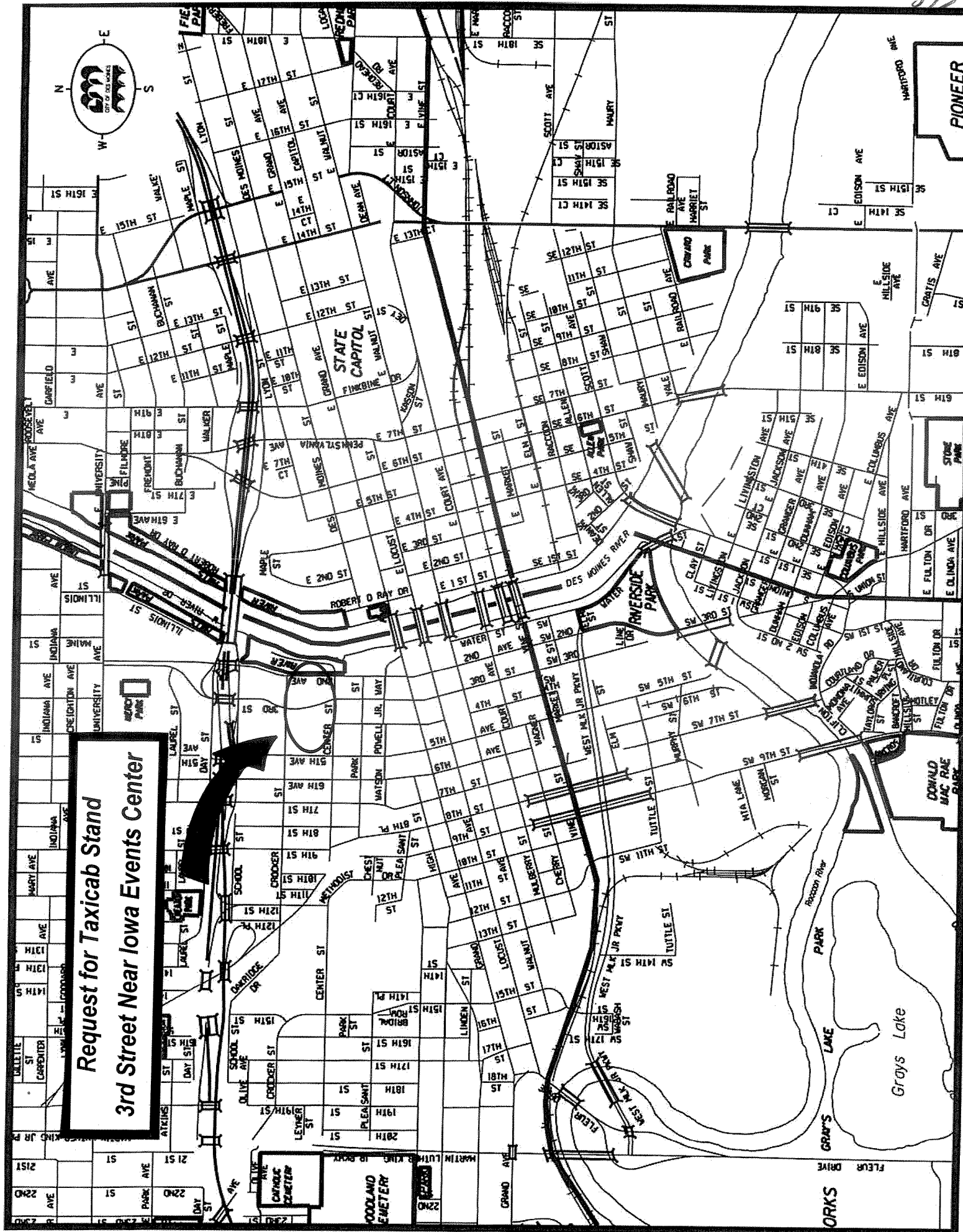

**Request for Taxicab Stand**  
**3rd Street Near Iowa Events Center**

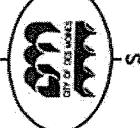

CITY OF DES MOINES