

DATE July 27, 2009

PUBLIC HEARING, APPROVING PLANS, SPECIFICATIONS, FORM OF CONTRACT DOCUMENTS, AND ENGINEER'S ESTIMATE ON MCKINLEY AVENUE DRAINAGE IMPROVEMENTS - S.W. 26TH/S.W. 31ST STREETS; RECEIVE AND FILE BIDS; AND DESIGNATION OF LOWEST RESPONSIVE, RESPONSIBLE BIDDER AS THE UNDERGROUND COMPANY, LTD., DUANE BURKHARDT, PRESIDENT, \$231,350.00

WHEREAS, on June 22, 2009, under Roll Call No. 09-1064, plans, specifications, form of contract documents, and Jurisdictional Engineer's estimate of construction cost were filed with the City Clerk, for the construction of the following improvement:

McKinley Avenue Drainage Improvements - S.W. 26th/S.W. 31st Streets, 08-2009-006

The improvement includes approximately 6800 CY of excavation, 267.5 LF of 18" storm sewer, 181.4 LF of 18" storm sewer augered-in-place, associated storm sewer manholes and intakes, PCC driveway removal and replacement, driveway culverts, sod, and miscellaneous associated work including clean up; all in accordance with the contract documents, including Plan File Nos. 483-119/123, located along the north side of the 2700 block of McKinley Avenue, Des Moines, Iowa

WHEREAS, notice of the hearing on the plans, specifications, form of contract documents, and Engineer's estimate of construction cost was published as required by law.

NOW, THEREFORE, BE IT RESOLVED BY THE CITY COUNCIL OF THE CITY OF DES MOINES, IOWA: That the hearing on the plans, specifications, form of contract documents, and Jurisdictional Engineer's estimate of construction cost for said improvement be closed; and that said plans, specifications, form of contract documents, and Jurisdictional Engineer's estimate of construction cost are hereby approved as the plans, specifications, form of contract documents, and Jurisdictional Engineer's estimate of construction cost for said improvement.

BE IT FURTHER RESOLVED: That sealed bids for said improvement were submitted by the following bidders:

- |                               |                     |
|-------------------------------|---------------------|
| The Underground Company, Ltd. | Carlisle, IA        |
| Elder Corporation             | Des Moines, IA      |
| Smith Seeding, Inc.           | Eldridge, IA        |
| Reilly Construction Co., Inc. | Ossian, IA          |
| McAninch Corporation          | West Des Moines, IA |
| Van Hauen & Associates, Inc.  | Grimes, IA          |
| T K Concrete Inc.             | Pella, IA           |
| C. A. C., Inc.                | Urbandale, IA       |

which were received and opened at a public meeting presided over by the Jurisdictional Engineer in the City Council Chambers, 2nd Floor, City Hall, 400 Robert D. Ray Drive, Des Moines, Iowa at 11:00 a.m. on July 14, 2009. Said bids and the attached tabulation of bids for said improvement be and are hereby received and filed.

★ **Roll Call Number**

Agenda Item Number

64A

DATE July 27, 2009

BE IT FURTHER RESOLVED: That the Jurisdictional Engineer has determined that the lowest responsive, responsible bid for the construction of said improvement was submitted by The Underground Company, Ltd., Duane Burkhardt, President, 12245 Dakota Street, Carlisle, IA, 50047 in the amount of \$231,350.00, and said bid be and the same is hereby accepted.

BE IT FURTHER RESOLVED: That the bid security of the unsuccessful bidders be and is hereby authorized and directed to be returned.

BE IT FURTHER RESOLVED: That the Jurisdictional Engineer is hereby directed to secure execution by the lowest responsible, responsive Bidder and its surety of the contract documents in the form heretofore approved by this Council; that the Jurisdictional Engineer is directed to thereafter present said contract documents to this Council for approval and authorization to the Mayor to sign; and that no contract shall be deemed to exist between the City of Des Moines and said Bidder until said contract has been executed by the Bidder, and shall have been approved by this Council and executed by the Mayor and attested to by the City Clerk.

(City Council Communication Number 09-536 attached.)

Moved by \_\_\_\_\_ to adopt.

FORM APPROVED:

FUNDS AVAILABLE

Kathleen Vanderpool by AD  
Kathleen Vanderpool  
Deputy City Attorney

Allen McKinley  
Allen McKinley  
Des Moines Finance Director

 Funding Source: 2009-2010 CIP, Page Storm-14, McKinley Avenue Drainage Improvements, STE083, Storm Water Utility Funds

COUNCIL ACTION	YEAS	NAYS	PASS	ABSENT
COWNIE				
COLEMAN				
HENSLEY				
KIERNAN				
MAHAFFEY				
MEYER				
VLASSIS				
TOTAL				

MOTION CARRIED

APPROVED

\_\_\_\_\_  
Mayor

I, Diane Rauh, City Clerk of said City Council, hereby certify that at a meeting of the City Council, held on the above date, among other proceedings the above was adopted.

IN WITNESS WHEREOF, I have hereunto set my hand and affixed my seal the day and year first above written.

\_\_\_\_\_  
City Clerk

64A

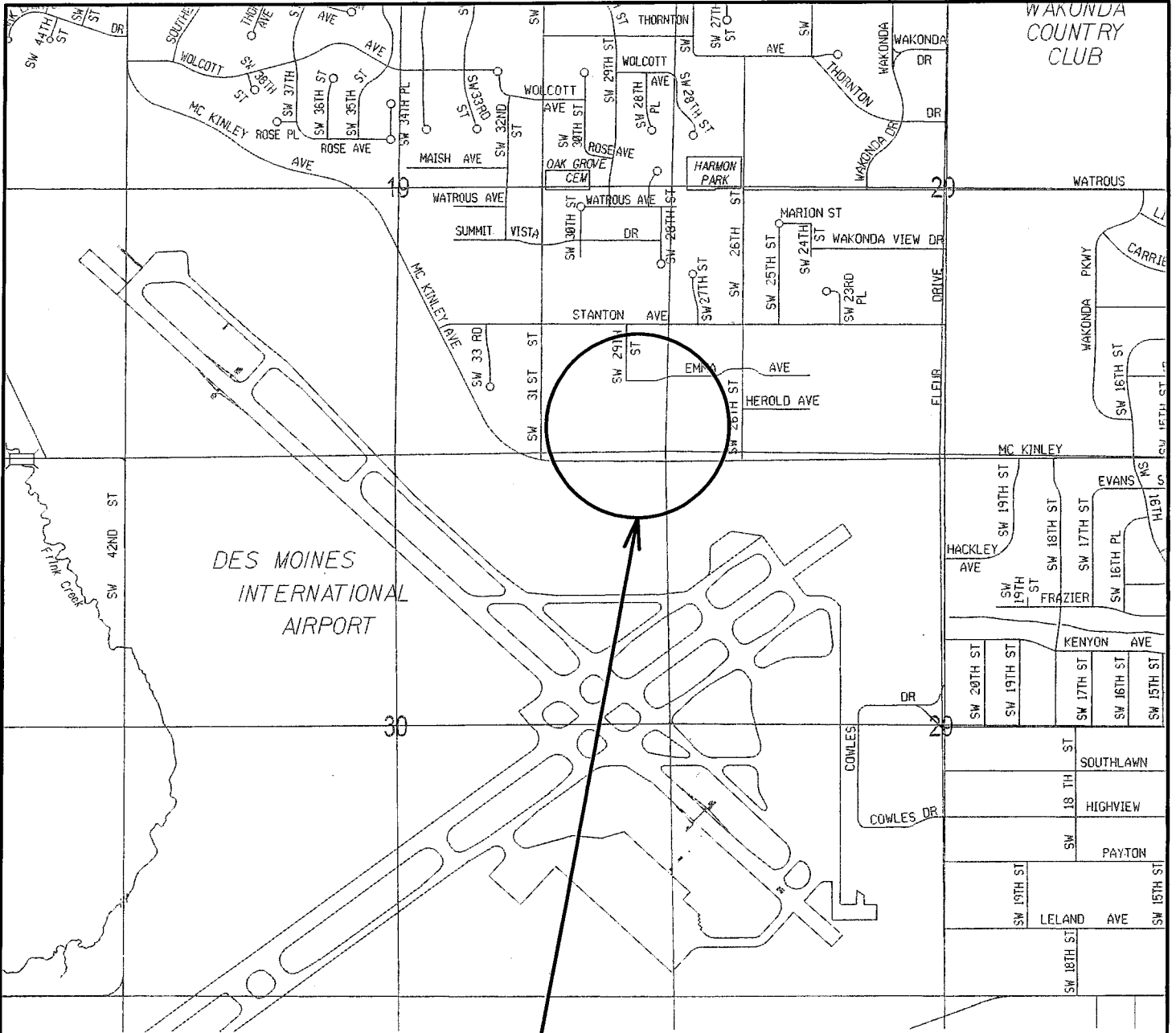

**PROJECT  
LOCATION**

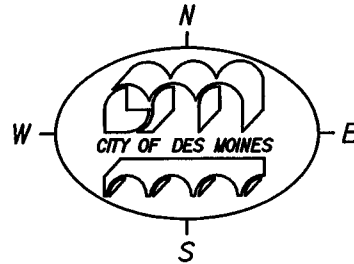

T:\ENG\Drawings\08-2009\006\Drawings\Loc\_Map\LOC\_MAP.DGN 09-JUN-2009 09:11

**MCKINLEY AVE DRAINAGE IMPROVEMENTS  
ACTIVITY I.D. 08-2009-006**

DEPARTMENT OF ENGINEERING  
CITY OF DES MOINES, IOWA

Activity I.D. 08-2009-006  
IDOT PROJ NO.: None  
BID DATE: 7/14/2009

TABULATED BY: C. Bouska  
CHECKED BY: *BKJ*  
APPROVED BY: *John F. McKee*

**CONTRACTOR'S BID TABULATION**  
PROJECT: McKinley Avenue Drainage Improvements

-----ESTIMATE-----

ITEM	DESCRIPTION	QUANTITY	UNIT PRICE	AMOUNT	THE UNDERGROUND COMPANY CARLISLE, IA	ELDER CORPORATION DES MOINES, IA	SMITH SEEDING GRIMES, IA
			PRICE	AMOUNT	BID SECURITY 10% BID BOND BID PRICE	BID SECURITY 10% BID BOND BID PRICE	BID SECURITY 10% BID BOND BID PRICE
1	CLEARING & GRUBBING	1.1 ACRE	\$2,000.00	\$2,200.00	\$100.00	\$650.00	\$550.00
2	TREE REMOVAL	450 DIAM-INCH	\$25.00	\$11,250.00	\$11.50	\$11.55	\$16.00
3	TOPSOIL, STRIP, SALVAGE, & SPREAD	1650 CY	\$8.00	\$13,200.00	\$7.88	\$5.25	\$13.25
4	EXCAVATION	6800 CY	\$12.00	\$81,600.00	\$8.00	\$9.75	\$7.50
5	DRIVEWAY REMOVAL	300 SY	\$20.00	\$6,000.00	\$10.00	\$8.35	\$17.00
6	STORM SEWER PIPE, 18"	267.5 LF	\$85.00	\$22,737.50	\$48.50	\$41.00	\$89.00
7	APRON CONCRETE, 18"	3 EACH	\$450.00	\$1,350.00	\$733.00	\$850.00	\$650.00
8	APRON GUARD, 18"	3 EACH	\$300.00	\$900.00	\$339.00	\$580.00	\$550.00
9	STORM SEWER AUGERED-IN-PLACE, 18"	181.4 LF	\$385.00	\$69,839.00	\$291.00	\$390.00	\$302.00
10	CULVERT, 24" RCP	80 LF	\$100.00	\$8,000.00	\$75.00	\$51.00	\$90.50
11	CULVERT, 30" RCP	44 LF	\$125.00	\$5,500.00	\$103.00	\$74.00	\$118.50
12	APRON CONCRETE, 24"	4 EACH	\$650.00	\$2,600.00	\$544.00	\$900.00	\$766.50
13	APRON CONCRETE, 30"	2 EACH	\$750.00	\$1,500.00	\$642.00	\$1,100.00	\$975.50
14	APRON GUARD, 24"	4 EACH	\$375.00	\$1,500.00	\$447.00	\$740.00	\$755.00
15	APRON GUARD, 30"	2 EACH	\$450.00	\$900.00	\$543.00	\$880.00	\$900.00
16	INTAKE, TYPE M-G, 8'x8'	1 EACH	\$6,000.00	\$6,000.00	\$4,838.00	\$6,700.00	\$7,068.50
17	INTAKE, TYPE M-G, 6'x6'	2 EACH	\$3,000.00	\$6,000.00	\$3,572.00	\$3,800.00	\$4,716.00
18	MANHOLE, TYPE M-A, 48"	1 EACH	\$2,500.00	\$2,500.00	\$3,093.00	\$2,600.00	\$2,777.00
19	CONNECTION TO EXISTING SYSTEM	1 EACH	\$750.00	\$750.00	\$2,850.00	\$1,800.00	\$1,190.00
20	PCC DRIVEWAY, 8", M-4	425 SY	\$50.00	\$21,250.00	\$46.00	\$47.50	\$60.00
21	SOD	500 SQ	\$45.00	\$22,500.00	\$34.00	\$30.50	\$17.50
22	MOBILIZATION	1 LS	\$10,000.00	\$10,000.00	\$4,774.85	\$10,000.00	\$9,000.00
23	TRAFFIC CONTROL	1 LS	\$5,000.00	\$5,000.00	\$3,800.00	\$2,400.00	\$5,075.20
24	STANDARD SEWER PLUG	1 EACH	\$300.00	\$300.00	\$510.00	\$330.00	\$449.00
25	UTILITY SUPPORTS	1 EACH	\$1,000.00	\$1,000.00	\$750.00	\$1,100.00	\$1,190.00
26	HYDRAULIC EXCAVATION OF FAA CABLE	35 LF	\$60.00	\$2,100.00	\$74.00	\$80.50	\$52.50
27	EROSION CONTROL	1 LS	\$7,000.00	\$7,000.00	\$2,920.00	\$4,700.00	\$6,831.00
TOTAL CONSTRUCTION COST				\$313,476.50	\$231,350.00	\$262,724.50	\$269,349.00
PERCENT OF ENGINEER'S ESTIMATE					-26.20%	-16.19%	-14.08%

64 A

TABULATED BY: C. Boujka  
CHECKED BY: *BKR*

APPROVED BY *John S. McKee*

**CONTRACTOR'S BID TABULATION**

PROJECT: McKinley Avenue Drainage Improvements

ESTIMATE

ITEM	DESCRIPTION	QUANTITY	UNIT PRICE	AMOUNT	REILLY CONSTRUCTION CO., INC. OSSIAN, IA	MCANINCH CORPORATION WEST DES MOINES, IA	VAN HAUEN & ASSOCIATES, INC. GRIMES, IA
					BID SECURITY 10% BID BOND BID PRICE	BID SECURITY 10% BID BOND BID PRICE	BID SECURITY \$34,650.00 BID BOND BID PRICE
			UNIT PRICE	AMOUNT	UNIT PRICE	UNIT PRICE	UNIT PRICE
1	CLEARING & GRUBBING	1.1 ACRE	\$2,000.00	\$2,200.00	\$1,750.00	\$650.00	\$700.00
2	TREE REMOVAL	450 DIAM-INCH	\$25.00	\$11,250.00	\$15.00	\$14.50	\$12.00
3	TOPSOIL, STRIP, SALVAGE, & SPREAD	1650 CY	\$8.00	\$13,200.00	\$5.50	\$6.30	\$6.00
4	EXCAVATION	6800 CY	\$12.00	\$81,600.00	\$8.25	\$8.82	\$10.00
5	DRIVEWAY REMOVAL	300 SY	\$20.00	\$6,000.00	\$15.00	\$7.45	\$8.50
6	STORM SEWER PIPE, 18"	267.5 LF	\$85.00	\$22,737.50	\$70.00	\$76.00	\$70.00
7	APRON CONCRETE, 18"	3 EACH	\$450.00	\$1,350.00	\$550.00	\$950.00	\$800.00
8	APRON GUARD, 18"	3 EACH	\$300.00	\$900.00	\$650.00	\$595.00	\$400.00
9	STORM SEWER AUGERED-IN-PLACE, 18"	181.4 LF	\$385.00	\$69,839.00	\$350.00	\$300.00	\$350.00
10	CULVERT, 24" RCP	80 LF	\$100.00	\$8,000.00	\$90.00	\$180.00	\$90.00
11	CULVERT, 30" RCP	44 LF	\$125.00	\$5,500.00	\$110.00	\$190.00	\$110.00
12	APRON CONCRETE, 24"	4 EACH	\$650.00	\$2,600.00	\$600.00	\$1,000.00	\$900.00
13	APRON CONCRETE, 30"	2 EACH	\$750.00	\$1,500.00	\$725.00	\$1,175.00	\$1,000.00
14	APRON GUARD, 24"	4 EACH	\$375.00	\$1,500.00	\$775.00	\$750.00	\$550.00
15	APRON GUARD, 30"	2 EACH	\$450.00	\$900.00	\$900.00	\$875.00	\$650.00
16	INTAKE, TYPE M-G, 8'x8'	1 EACH	\$6,000.00	\$6,000.00	\$8,500.00	\$8,450.00	\$7,000.00
17	INTAKE, TYPE M-G, 6'x6'	2 EACH	\$3,000.00	\$6,000.00	\$6,500.00	\$7,200.00	\$6,000.00
18	MANHOLE, TYPE M-A, 48"	1 EACH	\$2,500.00	\$2,500.00	\$3,000.00	\$2,425.00	\$2,000.00
19	CONNECTION TO EXISTING SYSTEM	1 EACH	\$750.00	\$750.00	\$1,500.00	\$3,950.00	\$2,500.00
20	PCC DRIVEWAY, 8", M-4	425 SY	\$50.00	\$21,250.00	\$60.00	\$55.10	\$75.00
21	SOD	500 SQ	\$45.00	\$22,500.00	\$47.50	\$45.00	\$37.00
22	MOBILIZATION	1 LS	\$10,000.00	\$10,000.00	\$4,000.00	\$4,345.00	\$8,475.00
23	TRAFFIC CONTROL	1 LS	\$5,000.00	\$5,000.00	\$2,400.00	\$2,250.00	\$2,500.00
24	STANDARD SEWER PLUG	1 EACH	\$300.00	\$300.00	\$400.00	\$300.00	\$150.00
25	UTILITY SUPPORTS	1 EACH	\$1,000.00	\$1,000.00	\$850.00	\$630.00	\$200.00
26	HYDRAULIC EXCAVATION OF FAA CABLE	35 LF	\$60.00	\$2,100.00	\$55.00	\$30.00	\$35.00
27	EROSION CONTROL	1 LS	\$7,000.00	\$7,000.00	\$5,000.00	\$3,500.00	\$3,000.00
				\$313,476.50	\$274,780.00	\$280,308.50	\$283,000.00
					-12.34%	-10.58%	-9.72%
TOTAL CONSTRUCTION COST							
PERCENT OF ENGINEER'S ESTIMATE							

TABULATED BY: C. Bouska  
CHECKED BY: B.R.R.

APPROVED BY: John F. Meeker

**CONTRACTOR'S BID TABULATION**  
PROJECT: McKinley Avenue Drainage Improvements

ESTIMATE

ITEM	DESCRIPTION	QUANTITY	UNIT PRICE	AMOUNT	UNIT PRICE	AMOUNT
1	CLEARING & GRUBBING	1.1 ACRE	\$2,000.00	\$2,200.00	\$2,500.00	\$2,750.00
2	TREE REMOVAL	450 DIAM-INCH	\$25.00	\$11,250.00	\$15.00	\$6,750.00
3	TOPSOIL, STRIP, SALVAGE, & SPREAD	1650 CY	\$8.00	\$13,200.00	\$6.50	\$10,725.00
4	EXCAVATION	6800 CY	\$12.00	\$81,600.00	\$10.50	\$71,400.00
5	DRIVEWAY REMOVAL	300 SY	\$20.00	\$6,000.00	\$15.00	\$4,500.00
6	STORM SEWER PIPE, 18"	267.5 LF	\$85.00	\$22,737.50	\$78.00	\$20,865.00
7	APRON CONCRETE, 18"	3 EACH	\$450.00	\$1,350.00	\$500.00	\$1,500.00
8	APRON GUARD, 18"	3 EACH	\$300.00	\$900.00	\$400.00	\$1,200.00
9	STORM SEWER AUGERED-IN-PLACE, 18"	181.4 LF	\$385.00	\$69,839.00	\$375.00	\$68,025.00
10	CULVERT, 24" RCP	80 LF	\$100.00	\$8,000.00	\$80.00	\$6,400.00
11	CULVERT, 30" RCP	44 LF	\$125.00	\$5,500.00	\$110.00	\$4,840.00
12	APRON CONCRETE, 24"	4 EACH	\$650.00	\$2,600.00	\$750.00	\$3,000.00
13	APRON CONCRETE, 30"	2 EACH	\$750.00	\$1,500.00	\$750.00	\$1,500.00
14	APRON GUARD, 24"	4 EACH	\$375.00	\$1,500.00	\$500.00	\$2,000.00
15	APRON GUARD, 30"	2 EACH	\$450.00	\$900.00	\$500.00	\$1,000.00
16	INTAKE, TYPE M-G, 8'x8'	1 EACH	\$6,000.00	\$6,000.00	\$6,750.00	\$6,750.00
17	INTAKE, TYPE M-G, 6'x6'	2 EACH	\$3,000.00	\$6,000.00	\$5,000.00	\$10,000.00
18	MANHOLE, TYPE M-A, 48"	1 EACH	\$2,500.00	\$2,500.00	\$3,250.00	\$3,250.00
19	CONNECTION TO EXISTING SYSTEM	1 EACH	\$750.00	\$750.00	\$1,000.00	\$1,000.00
20	PCC DRIVEWAY, 8", M-4	425 SY	\$50.00	\$21,250.00	\$47.00	\$19,975.00
21	SOD	500 SQ	\$45.00	\$22,500.00	\$35.00	\$17,500.00
22	MOBILIZATION	1 LS	\$10,000.00	\$10,000.00	\$10,000.00	\$10,000.00
23	TRAFFIC CONTROL	1 LS	\$5,000.00	\$5,000.00	\$3,500.00	\$3,500.00
24	STANDARD SEWER PLUG	1 EACH	\$300.00	\$300.00	\$750.00	\$750.00
25	UTILITY SUPPORTS	1 EACH	\$1,000.00	\$1,000.00	\$500.00	\$500.00
26	HYDRAULIC EXCAVATION OF FAA CABLE	35 LF	\$60.00	\$2,100.00	\$80.00	\$2,800.00
27	EROSION CONTROL	1 LS	\$7,000.00	\$7,000.00	\$8,500.00	\$8,500.00
				\$313,476.50		

TOTAL CONSTRUCTION COST  
PERCENT OF ENGINEER'S ESTIMATE

UNIT PRICE	AMOUNT	UNIT PRICE	AMOUNT
\$3,000.00	\$3,300.00	\$3,000.00	\$3,300.00
\$12.68	\$5,706.00	\$12.68	\$5,706.00
\$27.34	\$45,111.00	\$27.34	\$45,111.00
\$12.68	\$86,224.00	\$12.68	\$86,224.00
\$5.50	\$1,650.00	\$5.50	\$1,650.00
\$47.50	\$12,706.25	\$47.50	\$12,706.25
\$1,050.00	\$3,150.00	\$1,050.00	\$3,150.00
\$636.00	\$1,908.00	\$636.00	\$1,908.00
\$398.00	\$72,197.20	\$398.00	\$72,197.20
\$66.50	\$5,320.00	\$66.50	\$5,320.00
\$77.50	\$3,410.00	\$77.50	\$3,410.00
\$1,110.00	\$4,440.00	\$1,110.00	\$4,440.00
\$1,270.00	\$2,540.00	\$1,270.00	\$2,540.00
\$830.00	\$3,320.00	\$830.00	\$3,320.00
\$940.00	\$1,880.00	\$940.00	\$1,880.00
\$7,740.00	\$7,740.00	\$7,740.00	\$7,740.00
\$5,530.00	\$11,060.00	\$5,530.00	\$11,060.00
\$3,540.00	\$3,540.00	\$3,540.00	\$3,540.00
\$1,330.00	\$1,330.00	\$1,330.00	\$1,330.00
\$61.00	\$25,925.00	\$61.00	\$25,925.00
\$33.00	\$16,500.00	\$33.00	\$16,500.00
\$11,200.00	\$11,200.00	\$11,200.00	\$11,200.00
\$2,490.00	\$2,490.00	\$2,490.00	\$2,490.00
\$443.00	\$443.00	\$443.00	\$443.00
\$830.00	\$830.00	\$830.00	\$830.00
\$55.50	\$1,942.50	\$55.50	\$1,942.50
\$9,400.00	\$9,400.00	\$9,400.00	\$9,400.00
		\$345,262.95	\$345,262.95
		+10.14%	+10.14%

UNIT PRICE	AMOUNT	UNIT PRICE	AMOUNT
\$2,500.00	\$2,750.00	\$2,500.00	\$2,750.00
\$15.00	\$6,750.00	\$15.00	\$6,750.00
\$6.50	\$10,725.00	\$6.50	\$10,725.00
\$10.50	\$71,400.00	\$10.50	\$71,400.00
\$15.00	\$4,500.00	\$15.00	\$4,500.00
\$78.00	\$20,865.00	\$78.00	\$20,865.00
\$500.00	\$1,500.00	\$500.00	\$1,500.00
\$400.00	\$1,200.00	\$400.00	\$1,200.00
\$375.00	\$68,025.00	\$375.00	\$68,025.00
\$80.00	\$6,400.00	\$80.00	\$6,400.00
\$110.00	\$4,840.00	\$110.00	\$4,840.00
\$750.00	\$3,000.00	\$750.00	\$3,000.00
\$750.00	\$1,500.00	\$750.00	\$1,500.00
\$500.00	\$2,000.00	\$500.00	\$2,000.00
\$500.00	\$1,000.00	\$500.00	\$1,000.00
\$6,750.00	\$6,750.00	\$6,750.00	\$6,750.00
\$5,000.00	\$10,000.00	\$5,000.00	\$10,000.00
\$3,250.00	\$3,250.00	\$3,250.00	\$3,250.00
\$1,000.00	\$1,000.00	\$1,000.00	\$1,000.00
\$47.00	\$19,975.00	\$47.00	\$19,975.00
\$35.00	\$17,500.00	\$35.00	\$17,500.00
\$10,000.00	\$10,000.00	\$10,000.00	\$10,000.00
\$3,500.00	\$3,500.00	\$3,500.00	\$3,500.00
\$750.00	\$750.00	\$750.00	\$750.00
\$500.00	\$500.00	\$500.00	\$500.00
\$80.00	\$2,800.00	\$80.00	\$2,800.00
\$8,500.00	\$8,500.00	\$8,500.00	\$8,500.00
		\$290,980.00	\$290,980.00
		-7.18%	-7.18%

GA