

DATE August 7, 2006

PUBLIC HEARING, APPROVING PLANS, SPECIFICATIONS, FORM OF CONTRACT DOCUMENTS, AND ENGINEER'S ESTIMATE ON TWANA/BEL-AIRE STORM SEWER IMPROVEMENTS; RECEIVE AND FILE BIDS; AND DESIGNATION OF LOWEST RESPONSIBLE, RESPONSIVE BIDDER AS MCANINCH CORPORATION, DOUGLAS D. MCANINCH, PRESIDENT, \$993,543.00

WHEREAS, on July 10, 2006, under Roll Call No. 06-1302, plans, specifications, form of contract documents, and Jurisdictional Engineer's estimate of construction cost were filed with the City Clerk, for the construction of the following improvement:

Twana/Bel-Aire Storm Sewer Improvements, 08-2006-003

The improvement includes construction of a relief storm sewer totaling 1,752 linear feet of 12" through 54" reinforced concrete pipe, construction of an 8' x 6' reinforced concrete box culvert, and other incidental items; in accordance with the contract documents, including Plans File Nos. 463-061/076 in the general area east of Lower Beaver Road between Lindlavista Way and Valdez Drive, Des Moines, Iowa

WHEREAS, notice of the hearing on the plans, specifications, form of contract documents, and Engineer's estimate of construction cost was published as required by law.

NOW, THEREFORE, BE IT RESOLVED BY THE CITY COUNCIL OF THE CITY OF DES MOINES, IOWA: That the hearing on the plans, specifications, form of contract documents, and Jurisdictional Engineer's estimate of construction cost for said improvement be closed; and that said plans, specifications, form of contract documents, and Jurisdictional Engineer's estimate of construction cost are hereby approved as the plans, specifications, form of contract documents, and Jurisdictional Engineer's estimate of construction cost for said improvement.

BE IT FURTHER RESOLVED: That sealed bids for said improvement were submitted by the following bidders:

★ **Roll Call Number**

Agenda Item Number

52

DATE August 7, 2006

McAninch Corporation	West Des Moines, IA
Van Hauen & Associates, Inc.	Clive, IA
Holland Contracting Corp.	Forest City, IA
H & W Contracting LLC	Sioux Falls, SD
Eco-Tech Construction, LLC	Grimes, IA
Corell Contractor, Inc.	West Des Moines, IA
S. J. Louis Construction, Inc.	Waite Park, MN

which were received and opened at a public meeting presided over by the Jurisdictional Engineer in the City Council Chambers, 2nd Floor, City Hall, 400 Robert D. Ray Drive, Des Moines, Iowa at 11:00 a.m. on July 25, 2006. Said bids and the attached tabulation of bids for said improvement be and are hereby received and filed.

BE IT FURTHER RESOLVED: That the Jurisdictional Engineer has determined that the lowest responsible, responsive bid for the construction of said improvement was submitted by McAninch Corporation, Douglas D. McAninch, President, 6800 Lake Drive, Suite 125, West Des Moines, IA, 50266 in the amount of \$993,543.00, and said bid be and the same is hereby accepted.

BE IT FURTHER RESOLVED: That the bid security of the unsuccessful bidders be and is hereby authorized and directed to be returned.

DATE August 7, 2006

BE IT FURTHER RESOLVED: That the Jurisdictional Engineer is hereby directed to secure execution by the lowest responsible, responsive Bidder and its surety of the contract documents in the form heretofore approved by this Council; that the Jurisdictional Engineer is directed to thereafter present said contract documents to this Council for approval and authorization to the Mayor to sign; and that no contract shall be deemed to exist between the City of Des Moines and said Bidder until said contract has been executed by the Bidder, and shall have been approved by this Council and executed by the Mayor and attested to by the City Clerk.

(City Council Communication Number 06-500 attached.)

Moved by _____ to adopt.

FORM APPROVED:

FUNDS AVAILABLE

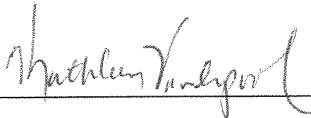
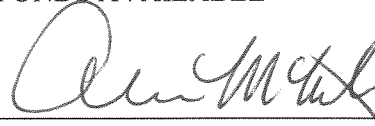
Kathleen Vanderpool
Deputy City Attorney

Allen McKinley
Des Moines Finance Director

Funding Source: 2006-2007 CIP, Page Storm-15, Twana/Bel-Aire Storm Sewer Improvements, STE079, Various Funding, Being: \$325,000 in Storm Water Utility Funds from STE079, \$150,000 developer contribution toward the cost of the relief storm sewer, and a transfer of \$518,543 in Storm Water Utility Funds from Closes Creek Watershed Improvements, STE068

JEB

COUNCIL ACTION	YEAS	NAYS	PASS	ABSENT
COWNIE				
BROOKS				
COLEMAN				
HENSLEY				
KIERNAN				
MAHAFFEY				
VCLASSIS				
TOTAL				

MOTION CARRIED APPROVED

Mayor

CERTIFICATE

I, DIANE RAUH, City Clerk of said City hereby certify that at a meeting of the City Council of said City of Des Moines, held on the above date, among other proceedings the above was adopted.

IN WITNESS WHEREOF, I have hereunto set my hand and affixed my seal the day and year first above written.

City Clerk

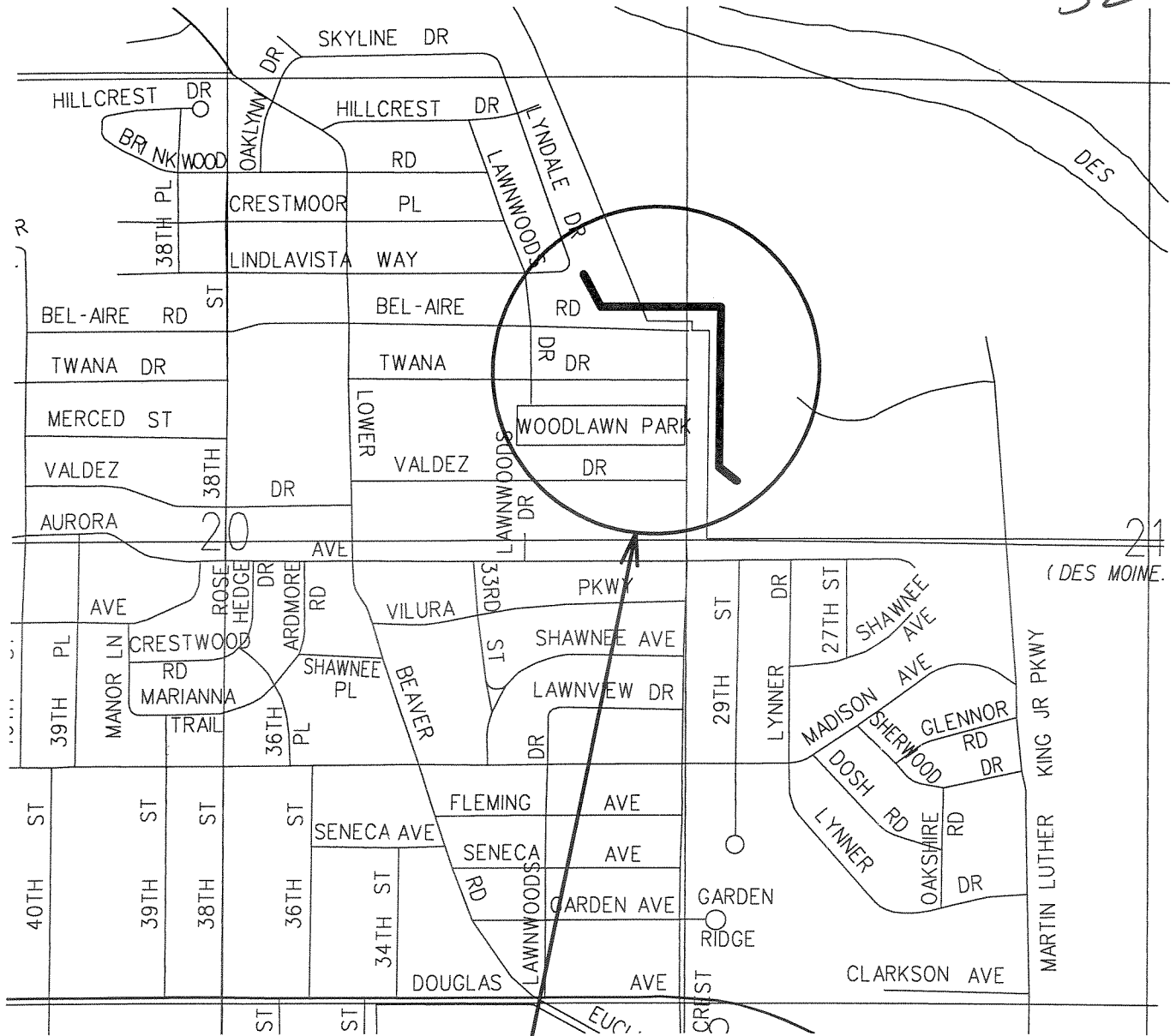

**PROJECT
LOCATION**

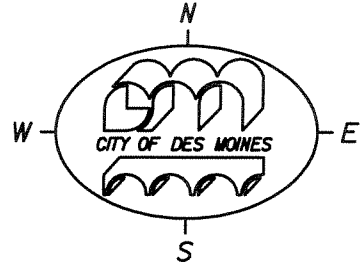

**TWANA/BEL-AIRE STORM
SEWER IMPROVEMENTS**

ACTIVITY I.D. 08-2006-003

BULATED BY: M. BECKER APPROVED BY: John F. McKee

CONTRACTOR'S BID TABULATION

PROJECT: Twana/Bel-Aire Storm Sewer Improvements

ESTIMATE

ITEM	DESCRIPTION	QUANTITY	UNIT PRICE		AMOUNT		UNIT PRICE	AMOUNT		UNIT PRICE	AMOUNT	
			PRICE	PRICE	AMOUNT	PRICE		AMOUNT	PRICE		AMOUNT	
1	Mobilization	1 LS	\$50,000.00		\$50,000.00		\$40,000.00		\$40,000.00		\$40,000.00	
2	Silt Fence	3250 LF	\$2.00		\$6,500.00		\$1.90		\$6,175.00		\$2.00	
3	Traffic Control	1 LS	\$2,000.00		\$2,000.00		\$2,450.00		\$2,450.00		\$2,500.00	
4	Clearing and Grubbing	1 LS	\$40,000.00		\$40,000.00		\$42,000.00		\$42,000.00		\$30,000.00	
5	Core Out Excavation	2000 CY	\$8.00		\$16,000.00		\$7.00		\$14,000.00		\$1.00	
6	Select Backfill	500 CY	\$10.00		\$5,000.00		\$15.00		\$7,500.00		\$1.00	
7	Strip, Salvage, Spread Topsoil	5400 CY	\$4.00		\$21,600.00		\$6.50		\$35,100.00		\$1.00	
8	Earthwork	1 LS	\$10,000.00		\$10,000.00		\$3,600.00		\$3,600.00		\$5,400.00	
9	Excavation, Class 12, Rock	500 CY	\$20.00		\$10,000.00		\$30.00		\$15,000.00		\$1.00	
10	Disposal, Rubble	3000 CY	\$20.00		\$60,000.00		\$16.00		\$48,000.00		\$1.00	
11	Pavement Removal	251 SY	\$7.00		\$1,757.00		\$10.00		\$2,510.00		\$5.00	
12	Drill and Dowel Pavement	17 LF	\$5.00		\$85.00		\$5.00		\$85.00		\$10.00	
13	Subgrade Preparation	11 SY	\$3.00		\$33.00		\$20.00		\$220.00		\$5.00	
14	Pavement, Roadway, Non-Reinforced PCC, Class C, 7"	7 SY	\$45.00		\$315.00		\$45.00		\$315.00		\$60.00	
15	Pavement, 6" PCC	227 SY	\$40.00		\$9,080.00		\$40.00		\$9,080.00		\$50.00	
16	Sidewalk, 4" PCC	156 SF	\$4.00		\$624.00		\$4.00		\$624.00		\$5.00	
17	Granular Surfacing, Temporary	100 TON	\$30.00		\$3,000.00		\$37.00		\$3,700.00		\$20.00	
18	Removal, Storm Sewer Pipe	223 LF	\$15.00		\$3,345.00		\$35.00		\$7,805.00		\$10.00	
19	Removal, Storm Sewer Structure	1 EA	\$750.00		\$750.00		\$750.00		\$750.00		\$500.00	
20	Sewer Abandonment	37 LF	\$50.00		\$1,850.00		\$35.00		\$1,295.00		\$30.00	
21	Trench Bottom Stabilization	1500 CY	\$25.00		\$37,500.00		\$15.00		\$22,500.00		\$1.00	
22	Granular Backfill	2000 CY	\$15.00		\$30,000.00		\$16,000.00		\$16,000.00		\$1.00	
23	Sewer, Storm, 12" RCP, Class III	6 LF	\$25.00		\$150.00		\$45.00		\$270.00		\$60.00	
24	Sewer, Storm, 15" RCP, Class III	30 LF	\$35.00		\$1,050.00		\$53.50		\$1,605.00		\$81.00	
25	Sewer, Storm, 36" RCP, Class III	6 LF	\$75.00		\$450.00		\$104.00		\$624.00		\$120.00	
26	Sewer, Storm, 54" RCP, Class III	308 LF	\$200.00		\$61,600.00		\$170.00		\$52,360.00		\$335.00	
27	Sewer, Storm, 54" RCP, Class IV	254 LF	\$280.00		\$71,120.00		\$210.00		\$53,340.00		\$415.00	
28	Sewer, Storm, 54" RCP, Class V	1148 LF	\$475.00		\$545,300.00		\$320.00		\$367,360.00		\$450.00	
29	Sewer, Storm, 8' x 6' RCB, Precast	56 LF	\$475.00		\$26,600.00		\$650.00		\$36,400.00		\$600.00	
30	Manhole, Storm, Type M-D	3 EA	\$20,000.00		\$60,000.00		\$7,700.00		\$23,100.00		\$2,500.00	
31	Manhole, Storm, Type M-D, Special	4 EA	\$30,000.00		\$120,000.00		\$14,000.00		\$56,000.00		\$2,750.00	
32	Manhole, Storm, Rehabilitation	1 EA	\$1,000.00		\$1,000.00		\$1,700.00		\$1,700.00		\$2,000.00	
33	Intake, Type M-I	1 EA	\$4,000.00		\$4,000.00		\$3,000.00		\$3,000.00		\$5,000.00	
34	Flared End Section, 36" RCP	1 EA	\$2,000.00		\$2,000.00		\$1,855.00		\$1,855.00		\$2,000.00	
35	Flared End Section, 54" RCP	1 EA	\$3,000.00		\$3,000.00		\$3,130.00		\$3,130.00		\$2,700.00	
36	Sloped End Section, 8' x 6' RCB, Precast, 3:1 Slope, 30° Skew	1 EA	\$10,000.00		\$10,000.00		\$9,630.00		\$9,630.00		\$7,000.00	
37	Sloped End Section, 8' x 6' RCB, Precast, 2:1 Slope	1 EA	\$5,500.00		\$5,500.00		\$6,700.00		\$6,700.00		\$4,500.00	
38	Sanitary Sewer Service Adjustment	90 LF	\$75.00		\$6,750.00		\$65.00		\$5,850.00		\$20.00	
39	Water Service Adjustment	90 LF	\$35.00		\$3,150.00		\$30.00		\$2,700.00		\$15.00	
40	Sewer Pipe Supports	5 EA	\$500.00		\$2,500.00		\$850.00		\$4,250.00		\$500.00	
41	Rip Rap, Class E	1350 TON	\$40.00		\$54,000.00		\$40.00		\$54,000.00		\$40.00	

52

ITEM	DESCRIPTION	QUANTITY	UNIT PRICE	AMOUNT	UNIT PRICE	AMOUNT	UNIT PRICE	AMOUNT	UNIT PRICE	AMOUNT
42	Temporary Erosion Mat	130 SY	\$2.00	\$260.00	\$2.70	\$351.00	\$6.00	\$780.00	\$2.00	\$260.00
43	Fence Removal	140 LF	\$4.00	\$560.00	\$3.00	\$420.00	\$5.00	\$700.00	\$3.00	\$420.00
44	Fence, Chain Link, 4'	58 LF	\$6.00	\$348.00	\$11.00	\$638.00	\$10.00	\$580.00	\$10.75	\$623.50
45	Fence, Wood, 6'	82 LF	\$15.00	\$1,230.00	\$21.00	\$1,722.00	\$20.00	\$1,640.00	\$21.00	\$1,722.00
46	Temporary Fence	41 LF	\$3.00	\$123.00	\$15.00	\$615.00	\$10.00	\$410.00	\$3.00	\$123.00
47	Sodding	207 SQ	\$35.00	\$7,245.00	\$40.00	\$8,280.00	\$40.00	\$8,280.00	\$35.00	\$7,245.00
48	Seeding, Fertilization - Lawn Mixture	1.32 AC	\$2,000.00	\$2,640.00	\$2,500.00	\$3,300.00	\$2,000.00	\$2,640.00	\$1,445.00	\$1,907.40
49	Temporary Seeding	3.62 AC	\$500.00	\$1,810.00	\$400.00	\$1,448.00	\$300.00	\$1,086.00	\$225.00	\$814.50
50	Mulching	9.88 AC	\$750.00	\$7,410.00	\$325.00	\$3,211.00	\$300.00	\$2,964.00	\$325.00	\$3,211.00
51	Erosion Control	1 LS	\$5,000.00	\$5,000.00	\$3,000.00	\$3,000.00	\$3,000.00	\$3,000.00	\$1,800.00	\$1,800.00
52	Project Sign "Large"	1 EA	\$1,000.00	\$1,000.00	\$975.00	\$975.00	\$1,000.00	\$1,000.00	\$1,000.00	\$1,000.00
53	Construction Survey	1 LS	\$10,000.00	\$10,000.00	\$7,000.00	\$7,000.00	\$4,000.00	\$4,000.00	\$3,400.00	\$3,400.00
				\$1,325,235.00		\$993,543.00		\$1,029,000.00		\$1,038,921.70
						-25.03%		-22.35%		-21.60%
					LOW					

TOTAL CONSTRUCTION COST
PERCENT OF ENGINEER'S ESTIMATE

APPROVED BY: *[Signature]* APPROVED BY: *John F. McKel*

CONTRACTOR'S BID TABULATION

PROJECT: Twana/Bel-Aire Storm Sewer Improvements

ESTIMATE

ITEM	DESCRIPTION	QUANTITY	UNIT PRICE		AMOUNT		UNIT PRICE	AMOUNT		UNIT PRICE	AMOUNT	
			PRICE	AMOUNT	PRICE	AMOUNT		PRICE	AMOUNT		PRICE	AMOUNT
1	Mobilization	1 LS	\$50,000.00	\$50,000.00	\$9,900.00	\$9,900.00	\$70,000.00	\$70,000.00	\$70,000.00	\$70,000.00	\$70,000.00	\$70,000.00
2	Silt Fence	3250 LF	\$2.00	\$6,500.00	\$2.10	\$6,825.00	\$2.05	\$6,662.50	\$2.05	\$6,662.50	\$2.05	\$6,662.50
3	Traffic Control	1 LS	\$2,000.00	\$2,000.00	\$2,450.00	\$2,450.00	\$3,850.00	\$3,850.00	\$3,850.00	\$3,850.00	\$3,850.00	\$3,850.00
4	Clearing and Grubbing	1 LS	\$40,000.00	\$40,000.00	\$45,600.00	\$45,600.00	\$43,450.00	\$43,450.00	\$43,450.00	\$43,450.00	\$43,450.00	\$43,450.00
5	Core Out Excavation	2000 CY	\$8.00	\$16,000.00	\$2.00	\$4,000.00	\$6.00	\$12,000.00	\$6.00	\$12,000.00	\$6.00	\$12,000.00
6	Select Backfill	500 CY	\$10.00	\$5,000.00	\$10.00	\$5,000.00	\$10.00	\$5,000.00	\$10.00	\$5,000.00	\$10.00	\$5,000.00
7	Strip, Salvage, Spread Topsoil	5400 CY	\$4.00	\$21,600.00	\$4.60	\$24,840.00	\$4.50	\$24,300.00	\$4.50	\$24,300.00	\$4.50	\$24,300.00
8	Earthwork	1 LS	\$10,000.00	\$10,000.00	\$8,500.00	\$8,500.00	\$17,250.00	\$17,250.00	\$17,250.00	\$17,250.00	\$17,250.00	\$17,250.00
9	Excavation, Class 12, Rock	500 CY	\$20.00	\$10,000.00	\$9.80	\$4,900.00	\$20.00	\$10,000.00	\$20.00	\$10,000.00	\$20.00	\$10,000.00
10	Disposal, Rubble	3000 CY	\$20.00	\$60,000.00	\$15.00	\$45,000.00	\$15.00	\$45,000.00	\$15.00	\$45,000.00	\$15.00	\$45,000.00
11	Pavement Removal	251 SY	\$7.00	\$1,757.00	\$7.00	\$1,757.00	\$10.00	\$2,510.00	\$10.00	\$2,510.00	\$10.00	\$2,510.00
12	Drill and Dowel Pavement	17 LF	\$5.00	\$85.00	\$5.30	\$90.10	\$10.00	\$170.00	\$10.00	\$170.00	\$10.00	\$170.00
13	Subgrade Preparation	11 SY	\$3.00	\$33.00	\$15.00	\$165.00	\$10.00	\$110.00	\$10.00	\$110.00	\$10.00	\$110.00
14	Pavement, Roadway, Non-Reinforced PCC, Class C, 7"	7 SY	\$45.00	\$315.00	\$525.00	\$3,675.00	\$100.00	\$700.00	\$100.00	\$700.00	\$100.00	\$700.00
15	Pavement, 6" PCC	227 SY	\$40.00	\$9,080.00	\$55.00	\$12,465.00	\$42.00	\$9,534.00	\$42.00	\$9,534.00	\$42.00	\$9,534.00
16	Sidewalk, 4" PCC	156 SF	\$4.00	\$624.00	\$4.00	\$624.00	\$4.00	\$624.00	\$4.00	\$624.00	\$4.00	\$624.00
17	Granular Surfacing, Temporary	100 TON	\$30.00	\$3,000.00	\$20.00	\$2,000.00	\$26.00	\$2,600.00	\$26.00	\$2,600.00	\$26.00	\$2,600.00
18	Removal, Storm Sewer Pipe	223 LF	\$15.00	\$3,345.00	\$15.00	\$3,345.00	\$40.00	\$8,920.00	\$40.00	\$8,920.00	\$40.00	\$8,920.00
19	Removal, Storm Sewer Structure	1 EA	\$750.00	\$750.00	\$1,000.00	\$1,000.00	\$720.00	\$720.00	\$720.00	\$720.00	\$720.00	
20	Sewer Abandonment	37 LF	\$50.00	\$1,850.00	\$45.00	\$1,665.00	\$135.00	\$4,995.00	\$135.00	\$4,995.00	\$135.00	\$4,995.00
21	Trench Bottom Stabilization	1500 CY	\$25.00	\$37,500.00	\$1.00	\$1,500.00	\$31.00	\$46,500.00	\$31.00	\$46,500.00	\$31.00	\$46,500.00
22	Granular Backfill	2000 CY	\$15.00	\$30,000.00	\$1.00	\$2,000.00	\$17.00	\$34,000.00	\$17.00	\$34,000.00	\$17.00	\$34,000.00
23	Sewer, Storm, 12" RCP, Class III	6 LF	\$25.00	\$150.00	\$660.00	\$3,960.00	\$255.00	\$1,530.00	\$255.00	\$1,530.00	\$255.00	\$1,530.00
24	Sewer, Storm, 15" RCP, Class III	30 LF	\$35.00	\$1,050.00	\$2,160.00	\$648.00	\$260.00	\$7,800.00	\$260.00	\$7,800.00	\$260.00	\$7,800.00
25	Sewer, Storm, 36" RCP, Class III	6 LF	\$75.00	\$450.00	\$138.00	\$828.00	\$300.00	\$1,800.00	\$300.00	\$1,800.00	\$300.00	\$1,800.00
26	Sewer, Storm, 54" RCP, Class III	308 LF	\$200.00	\$61,600.00	\$192.00	\$59,136.00	\$280.00	\$86,240.00	\$280.00	\$86,240.00	\$280.00	\$86,240.00
27	Sewer, Storm, 54" RCP, Class IV	254 LF	\$280.00	\$71,120.00	\$248.00	\$62,992.00	\$255.00	\$64,770.00	\$255.00	\$64,770.00	\$255.00	\$64,770.00
28	Sewer, Storm, 54" RCP, Class V	1148 LF	\$475.00	\$544,500.00	\$359.00	\$412,132.00	\$400.00	\$459,200.00	\$400.00	\$459,200.00	\$400.00	\$459,200.00
29	Sewer, Storm, 8' x 6' RCB, Precast	56 LF	\$475.00	\$26,600.00	\$765.00	\$42,840.00	\$790.00	\$44,240.00	\$790.00	\$44,240.00	\$790.00	\$44,240.00
30	Manhole, Storm, Type M-D	3 EA	\$20,000.00	\$60,000.00	\$36,000.00	\$108,000.00	\$20,000.00	\$60,000.00	\$20,000.00	\$60,000.00	\$20,000.00	\$60,000.00
31	Manhole, Storm, Type M-D, Special	4 EA	\$30,000.00	\$120,000.00	\$15,000.00	\$60,000.00	\$26,000.00	\$104,000.00	\$26,000.00	\$104,000.00	\$26,000.00	\$104,000.00
32	Manhole, Storm, Rehabilitation	1 EA	\$1,000.00	\$1,000.00	\$1,000.00	\$1,000.00	\$550.00	\$550.00	\$550.00	\$550.00	\$550.00	\$550.00
33	Intake, Type M-I	1 EA	\$4,000.00	\$4,000.00	\$5,700.00	\$5,700.00	\$6,500.00	\$6,500.00	\$6,500.00	\$6,500.00	\$6,500.00	\$6,500.00
34	Flared End Section, 36" RCP	1 EA	\$2,000.00	\$2,000.00	\$2,600.00	\$2,600.00	\$2,900.00	\$2,900.00	\$2,900.00	\$2,900.00	\$2,900.00	\$2,900.00
35	Flared End Section, 54" RCP	1 EA	\$3,000.00	\$3,000.00	\$4,650.00	\$4,650.00	\$3,600.00	\$3,600.00	\$3,600.00	\$3,600.00	\$3,600.00	\$3,600.00
36	Sloped End Section, 8' x 6' RCB, Precast, 3:1 Slope, 30° Skew	1 EA	\$10,000.00	\$10,000.00	\$9,000.00	\$9,000.00	\$11,350.00	\$11,350.00	\$11,350.00	\$11,350.00	\$11,350.00	\$11,350.00
37	Sloped End Section, 8' x 6' RCB, Precast, 2:1 Slope	1 EA	\$5,500.00	\$5,500.00	\$6,500.00	\$6,500.00	\$7,250.00	\$7,250.00	\$7,250.00	\$7,250.00	\$7,250.00	\$7,250.00
38	Sanitary Sewer Service Adjustment	90 LF	\$75.00	\$6,750.00	\$75.00	\$6,750.00	\$82.00	\$7,380.00	\$82.00	\$7,380.00	\$82.00	\$7,380.00
39	Water Service Adjustment	90 LF	\$35.00	\$3,150.00	\$65.00	\$5,850.00	\$42.00	\$3,780.00	\$42.00	\$3,780.00	\$42.00	\$3,780.00
40	Sewer Pipe Supports	5 EA	\$500.00	\$2,500.00	\$500.00	\$2,500.00	\$456.00	\$2,280.00	\$456.00	\$2,280.00	\$456.00	\$2,280.00
41	Rip Rap, Class E	1350 TON	\$40.00	\$54,000.00	\$50.00	\$67,500.00	\$35.00	\$47,250.00	\$35.00	\$47,250.00	\$35.00	\$47,250.00

52

<u>ITEM</u>	<u>DESCRIPTION</u>	<u>QUANTITY</u>	<u>UNIT PRICE</u>	<u>AMOUNT</u>	<u>UNIT PRICE</u>	<u>AMOUNT</u>	<u>UNIT PRICE</u>	<u>AMOUNT</u>	<u>UNIT PRICE</u>	<u>AMOUNT</u>
42	Temporary Erosion Mat	130 SY	\$2.00	\$260.00	\$3.20	\$416.00	\$2.90	\$377.00	\$6.00	\$780.00
43	Fence Removal	140 LF	\$4.00	\$560.00	\$3.00	\$420.00	\$3.30	\$462.00	\$3.30	\$462.00
44	Fence, Chain Link, 4'	58 LF	\$6.00	\$348.00	\$10.75	\$623.50	\$12.00	\$696.00	\$11.85	\$687.30
45	Fence, Wood, 6'	82 LF	\$15.00	\$1,230.00	\$21.00	\$1,722.00	\$23.00	\$1,886.00	\$23.10	\$1,894.20
46	Temporary Fence	41 LF	\$3.00	\$123.00	\$4.00	\$164.00	\$5.40	\$221.40	\$11.30	\$463.30
47	Sodding	207 SQ	\$35.00	\$7,245.00	\$29.50	\$6,106.50	\$38.00	\$7,866.00	\$38.50	\$7,969.50
48	Seeding, Fertilization - Lawn Mixture	1.32 AC	\$2,000.00	\$2,640.00	\$1,500.00	\$1,980.00	\$2,120.00	\$2,798.40	\$2,155.00	\$2,844.60
49	Temporary Seeding	3.62 AC	\$500.00	\$1,810.00	\$750.00	\$2,715.00	\$303.00	\$1,096.86	\$310.00	\$1,122.20
50	Mulching	9.88 AC	\$750.00	\$7,410.00	\$658.00	\$6,501.04	\$325.00	\$3,211.00	\$330.00	\$3,260.40
51	Erosion Control	1 LS	\$5,000.00	\$5,000.00	\$3,000.00	\$3,000.00	\$21,700.00	\$21,700.00	\$3,000.00	\$3,000.00
52	Project Sign "Large"	1 EA	\$1,000.00	\$1,000.00	\$975.00	\$975.00	\$1,030.00	\$1,030.00	\$1,100.00	\$1,100.00
53	Construction Survey	1 LS	\$10,000.00	\$10,000.00	\$6,000.00	\$6,000.00	\$6,500.00	\$6,500.00	\$5,390.00	\$5,390.00
				\$1,325,235.00		\$1,039,172.04		\$1,078,413.46		\$1,315,534.00
						-21.59%		-18.62%		-0.73%
TOTAL CONSTRUCTION COST										
PERCENT OF ENGINEER'S ESTIMATE										

APPROVED BY: [Signature] APPROVED BY: John S. McKee
CHECKED BY: [Signature]

CONTRACTOR'S BID TABULATION

PROJECT: Twana/Bel-Aire Storm Sewer Improvements

ESTIMATE

S.J. Louis Construction
Waite Park, MN

BID SECURITY
10% BID BOND
BID PRICE

ITEM	DESCRIPTION	QUANTITY	UNIT PRICE	AMOUNT	UNIT PRICE	AMOUNT
1	Mobilization	1 LS	\$50,000.00	\$50,000.00	\$39,570.00	\$39,570.00
2	Silt Fence	3250 LF	\$2.00	\$6,500.00	\$3.00	\$9,750.00
3	Traffic Control	1 LS	\$2,000.00	\$2,000.00	\$4,500.00	\$4,500.00
4	Clearing and Grubbing	1 LS	\$40,000.00	\$40,000.00	\$48,000.00	\$48,000.00
5	Core Out Excavation	2000 CY	\$8.00	\$16,000.00	\$14.00	\$28,000.00
6	Select Backfill	500 CY	\$10.00	\$5,000.00	\$30.00	\$15,000.00
7	Strip, Salvage, Spread Topsoil	5400 CY	\$4.00	\$21,600.00	\$4.00	\$21,600.00
8	Earthwork	1 LS	\$10,000.00	\$10,000.00	\$22,000.00	\$22,000.00
9	Excavation, Class 12, Rock	500 CY	\$20.00	\$10,000.00	\$110.00	\$55,000.00
10	Disposal, Rubble	3000 CY	\$20.00	\$60,000.00	\$29.00	\$87,000.00
11	Pavement Removal	251 SY	\$7.00	\$1,757.00	\$25.00	\$6,275.00
12	Drill and Dowel Pavement	17 LF	\$5.00	\$85.00	\$6.00	\$102.00
13	Subgrade Preparation	11 SY	\$3.00	\$33.00	\$10.00	\$110.00
14	Pavement, Roadway, Non-Reinforced PCC, Class C, 7"	7 SY	\$45.00	\$315.00	\$55.00	\$385.00
15	Pavement, 6" PCC	227 SY	\$40.00	\$9,080.00	\$50.00	\$11,350.00
16	Sidewalk, 4" PCC	156 SF	\$4.00	\$624.00	\$5.00	\$780.00
17	Granular Surfacing, Temporary	100 TON	\$30.00	\$3,000.00	\$40.00	\$4,000.00
18	Removal, Storm Sewer Pipe	223 LF	\$15.00	\$3,345.00	\$20.00	\$4,460.00
19	Removal, Storm Sewer Structure	1 EA	\$750.00	\$750.00	\$4,000.00	\$4,000.00
20	Sewer Abandonment	37 LF	\$50.00	\$1,850.00	\$20.00	\$740.00
21	Trench Bottom Stabilization	1500 CY	\$25.00	\$37,500.00	\$31.00	\$46,500.00
22	Granular Backfill	2000 CY	\$15.00	\$30,000.00	\$20.00	\$40,000.00
23	Sewer, Storm, 12" RCP, Class III	6 LF	\$25.00	\$150.00	\$65.00	\$390.00
24	Sewer, Storm, 15" RCP, Class III	30 LF	\$35.00	\$1,050.00	\$70.00	\$2,100.00
25	Sewer, Storm, 36" RCP, Class III	6 LF	\$75.00	\$450.00	\$140.00	\$840.00
26	Sewer, Storm, 54" RCP, Class III	308 LF	\$200.00	\$61,600.00	\$400.00	\$123,200.00
27	Sewer, Storm, 54" RCP, Class IV	254 LF	\$280.00	\$71,120.00	\$450.00	\$114,300.00
28	Sewer, Storm, 54" RCP, Class V	1148 LF	\$475.00	\$545,300.00	\$525.00	\$602,700.00
29	Sewer, Storm, 8' x 6' RCB, Precast	56 LF	\$475.00	\$26,600.00	\$600.00	\$33,600.00
30	Manhole, Storm, Type M-D	3 EA	\$20,000.00	\$60,000.00	\$20,000.00	\$60,000.00
31	Manhole, Storm, Type M-D, Special	4 EA	\$30,000.00	\$120,000.00	\$20,000.00	\$80,000.00
32	Manhole, Storm, Rehabilitation	1 EA	\$1,000.00	\$1,000.00	\$12,000.00	\$12,000.00
33	Intake, Type M-I	1 EA	\$4,000.00	\$4,000.00	\$13,000.00	\$13,000.00
34	Flared End Section, 36" RCP	1 EA	\$2,000.00	\$2,000.00	\$3,200.00	\$3,200.00
35	Flared End Section, 54" RCP	1 EA	\$3,000.00	\$3,000.00	\$5,500.00	\$5,500.00
36	Sloped End Section, 8' x 6' RCB, Precast, 3:1 Slope, 30° Skew	1 EA	\$10,000.00	\$10,000.00	\$13,500.00	\$13,500.00
37	Sloped End Section, 8' x 6' RCB, Precast, 2:1 Slope	1 EA	\$5,500.00	\$5,500.00	\$10,500.00	\$10,500.00
38	Sanitary Sewer Service Adjustment	90 LF	\$75.00	\$6,750.00	\$75.00	\$6,750.00
39	Water Service Adjustment	90 LF	\$35.00	\$3,150.00	\$90.00	\$8,100.00
40	Sewer Pipe Supports	5 EA	\$500.00	\$2,500.00	\$1,100.00	\$5,500.00
41	Rip Rap, Class E	1350 TON	\$40.00	\$54,000.00	\$50.00	\$67,500.00

52

<u>ITEM</u>	<u>DESCRIPTION</u>	<u>QUANTITY</u>	<u>UNIT PRICE</u>	<u>AMOUNT</u>	<u>UNIT PRICE</u>	<u>AMOUNT</u>
42	Temporary Erosion Mat	130 SY	\$2.00	\$260.00	\$4.00	\$520.00
43	Fence Removal	140 LF	\$4.00	\$560.00	\$4.00	\$560.00
44	Fence, Chain Link, 4'	58 LF	\$6.00	\$348.00	\$13.00	\$754.00
45	Fence, Wood, 6'	82 LF	\$15.00	\$1,230.00	\$26.00	\$2,132.00
46	Temporary Fence	41 LF	\$3.00	\$123.00	\$8.00	\$328.00
47	Sodding	207 SQ	\$35.00	\$7,245.00	\$50.00	\$10,350.00
48	Seeding, Fertilization - Lawn Mixture	1.32 AC	\$2,000.00	\$2,640.00	\$3,100.00	\$4,092.00
49	Temporary Seeding	3.62 AC	\$500.00	\$1,810.00	\$500.00	\$1,810.00
50	Mulching	9.88 AC	\$750.00	\$7,410.00	\$400.00	\$3,952.00
51	Erosion Control	1 LS	\$5,000.00	\$5,000.00	\$10,000.00	\$10,000.00
52	Project Sign "Large"	1 EA	\$1,000.00	\$1,000.00	\$1,300.00	\$1,300.00
53	Construction Survey	1 LS	\$10,000.00	\$10,000.00	\$7,400.00	\$7,400.00
				\$1,325,235.00		\$1,655,000.00
						+24.88%

TOTAL CONSTRUCTION COST
PERCENT OF ENGINEER'S ESTIMATE