

DATE August 7, 2006

ORDERING CONSTRUCTION OF  
LEETOWN CREEKWAY WOODEN BOX REPLACEMENT - PHASE 4  
AND FIXING A DATE FOR RECEIVING OF BIDS ON AUGUST 29, 2006  
AND PUBLIC HEARING ON SEPTEMBER 11, 2006  
ENGINEER'S ESTIMATE IS \$1,075,927.00

BE IT RESOLVED BY THE CITY COUNCIL OF THE CITY OF DES MOINES, IOWA: That the attached communication recommending construction of the following improvement and the method of financing; and also including the recommendation of the Des Moines City Engineer, as the Jurisdictional Engineer, submitting plans, specifications, form of contract documents, and Jurisdictional Engineer's estimate of cost for the construction of the following improvement:

Leetown Creekway Wooden Box Replacement - Phase 4, 08-2006-004

The improvement includes replacement of the existing timber box culvert with a reinforced concrete box culvert including all labor, material, and equipment necessary to replace approximately 827 linear feet of existing 7 ft. x 4.5 ft. timber box culvert with a 10 ft. x 4 ft. reinforced concrete box culvert, along with the necessary clearing and grubbing; traffic control; PCC street, driveway, and sidewalk removal and replacement; storm sewer, manhole, and intake removal and replacement; sanitary sewer and sewer service removal and replacement; sanitary sewer manhole construction; fence removal and replacement; residential house structural support investigation and installation; garage removal; construction survey; sod restoration; all in accordance with the contract documents including Plan File Nos. 464-141/157 from the existing reinforced concrete box culvert located south and west of the intersection of E. 27th Court and Kinsey Avenue, northwesterly along the existing timber box culvert line to the existing reinforced concrete box culvert located south and west of the intersection of E. 27th Street and Easton Boulevard, Des Moines, Iowa

be and the same are hereby approved and accepted. The estimated construction cost for said improvement is \$1,075,927.00. The proposed plans, specifications, and form of contract documents are available for public inspection in the City Engineer's Office.

BE IT FURTHER RESOLVED: That this Council hereby determines that it is necessary and advisable to construct said improvement in the manner set forth in the plans, specifications, and form of contract documents submitted by the Jurisdictional Engineer; and that payment for the cost of said improvement shall be paid from from the funding source identified below.

BE IT FURTHER RESOLVED: That a public hearing on said plans, specifications, form of contract documents, and Jurisdictional Engineer's estimate of construction cost for said improvement be held in the City Council Chambers, 2nd Floor, City Hall, 400 Robert D. Ray Drive, Des Moines, Iowa, at 5:00 p.m. on September 11, 2006, at which time this Council will consider any objections offered thereto or to the making of said improvement.

★ **Roll Call Number**

**Agenda Item Number**

7C

DATE August 7, 2006

BE IT FURTHER RESOLVED: That proposals will be received by the City of Des Moines, at the office of the City Clerk until 11:00 a.m. on August 29, 2006, for the construction of said improvement, and the taking of bids in the manner required by law. Proposals received will be opened at a public meeting presided over by the Jurisdictional Engineer in the City Council Chambers, 2nd Floor, City Hall, 400 Robert D. Ray Drive, Des Moines, Iowa, at 11:00 a.m. on August 29, 2006, after which the bids together with a bid tabulation and recommendation of the Jurisdictional Engineer will be presented to the City Council at its next meeting for action thereon.

BE IT FURTHER RESOLVED: That the City Clerk is further directed to publish a Public Notice of Storm Water Discharge in the Des Moines Register and The Business Record as required by the Iowa Department of Natural Resources.

BE IT FURTHER RESOLVED: That the City Manager be and is hereby authorized and directed to certify the "Notice of Intent for NPDES Coverage under General Permit No. 2 for Storm Water Discharges associated with Industrial Activity for Construction Activities" on behalf of the City of Des Moines and submit said document to the Iowa Department of Natural Resources with appropriate application and permit fees.

BE IT FURTHER RESOLVED: That an appropriate Notice to Bidders and Notice of Public Hearing for said improvement be published in the Des Moines Register as provided and directed by Chapter 384, Code of Iowa.

(City Council Communication Number 06-492 attached.)

Moved by \_\_\_\_\_ to adopt.

FORM APPROVED:

FUNDS AVAILABLE

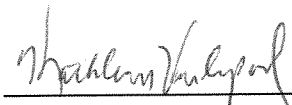
  
\_\_\_\_\_

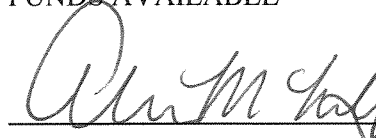
  
\_\_\_\_\_

Kathleen Vanderpool  
Deputy City Attorney

Allen McKinley  
Des Moines Finance Director

Funding Source: 2006-2007 CIP, Page Storm-13, Leetown Creekway - Wooden Box Replacement, STE064,  
Being:  
Storm Water Revenue Bonds to be issued

★ Roll Call Number

Agenda Item Number

7C

DATE August 7, 2006

REB

COUNCIL ACTION	YEAS	NAYS	PASS	ABSENT
COWNIE				
BROOKS				
COLEMAN				
HENSLEY				
KIERNAN				
MAHAFFEY				
VLASSIS				
TOTAL				
MOTION CARRIED	APPROVED			

**CERTIFICATE**

I, DIANE RAUH, City Clerk of said City hereby certify that at a meeting of the City Council of said City of Des Moines, held on the above date, among other proceedings the above was adopted.

IN WITNESS WHEREOF, I have hereunto set my hand and affixed my seal the day and year first above written.

\_\_\_\_\_  
Mayor

\_\_\_\_\_  
City Clerk

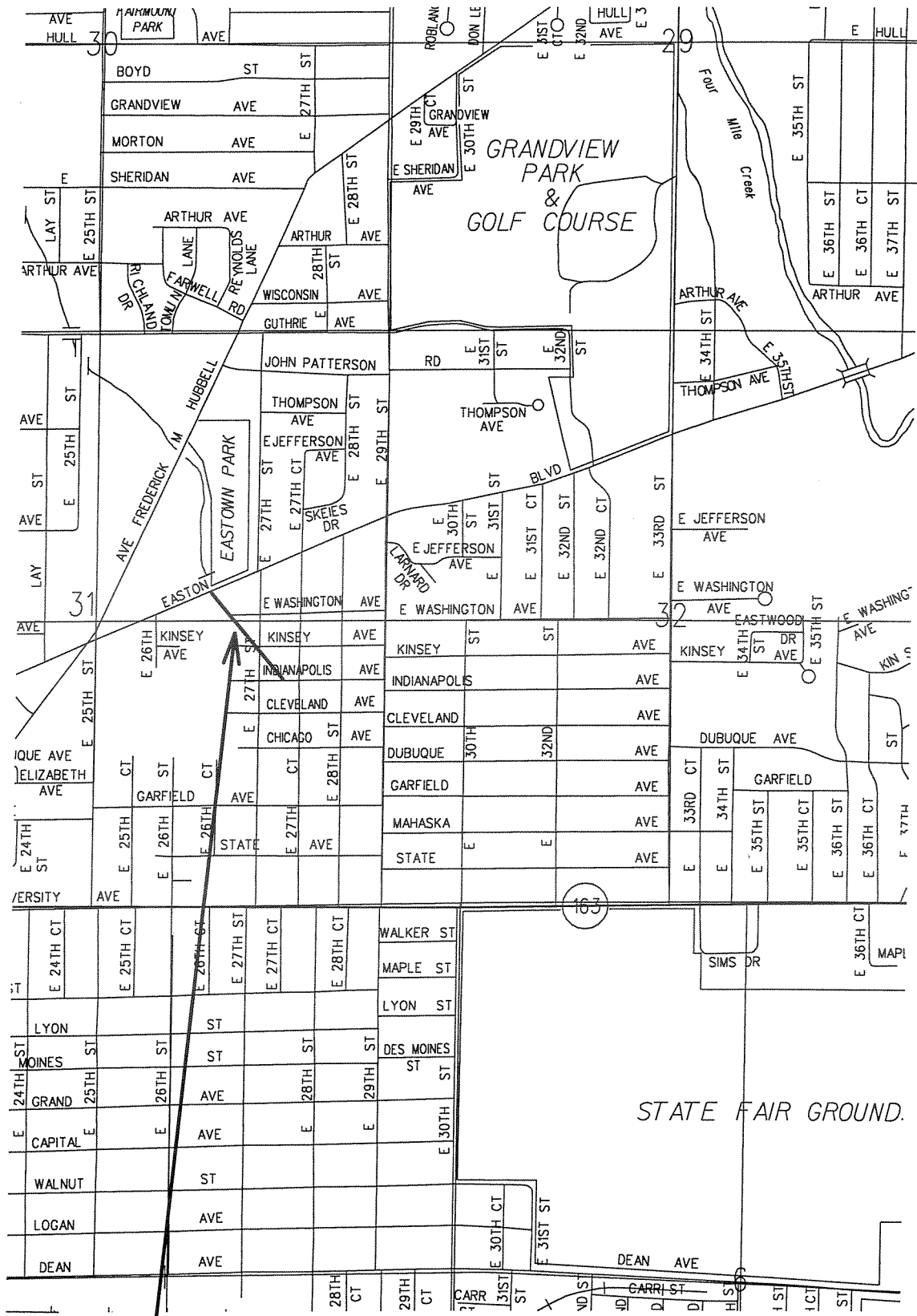

**PROPERTY  
LOCATION**

**LEETOWN CREEKWAY**

**WOODEN BOX REPLACEMENT - PHASE 4**

**ACTIVITY I.D. 08-2006-004**

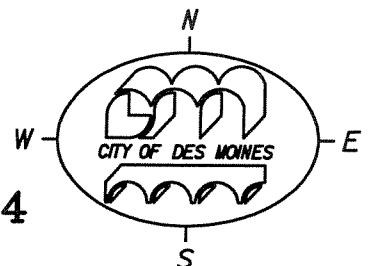

7c

# CONSTRUCTION ESTIMATE

DEPARTMENT OF ENGINEERING  
CITY OF DES MOINES, IOWA

Activity ID 08-2006-004  
8/29/2006

**PROJECT: Leetown Creekway Wooden Box Replacement - Phase 4, Kinsey Avenue to Easton Blvd.**

NO.	DESCRIPTION	ESTIMATED UNITS			AMOUNT
		UNIT	TOTAL	UNIT PRICE	TOTAL
1	* Mobilization	LS	1	\$50,000.00	\$50,000.00
2	* Clearing	Dia-in.	272	\$40.00	\$10,880.00
3	* Grubbing, Greater than 6" Dia.	Dia-in.	272	\$40.00	\$10,880.00
4	* Grubbing, Less than 6" Dia.	LS	1	\$5,000.00	\$5,000.00
5	* Core Out Excavation	CY	500	\$20.00	\$10,000.00
6	* Traffic Control	LS	1	\$8,000.00	\$8,000.00
7	* PCC Driveway Removal	SY	545	\$10.00	\$5,450.00
8	* Pavement Removal	SY	923	\$12.00	\$11,076.00
9	* PCC Sidewalk Removal	SY	110	\$8.00	\$880.00
10	Drill and Dowel Pavement	LF	403	\$12.00	\$4,836.00
11	Subgrade Preparation	SY	1080	\$5.00	\$5,400.00
12	Pavement, Non-Reinforced PCC Class C, 7"	SY	923	\$45.00	\$41,535.00
13	Pavement Reinforcing Steel	SY	653	\$10.00	\$6,530.00
14	Driveway, 6" PCC	SY	545	\$35.00	\$19,075.00
15	Sidewalk, 4" PCC	SY	110	\$30.00	\$3,300.00
16	Granular Surfacing, Class A Crushed Stone	Tons	140	\$14.00	\$1,960.00
17	* Removal of Existing Timber Box Culvert	LF	823	\$60.00	\$49,380.00
18	Trench Bottom Stabilization	CY	500	\$25.00	\$12,500.00
19	Granular Backfill	CY	500	\$25.00	\$12,500.00
20	* Removal, 8" Storm Sewer	LF	11	\$10.00	\$110.00
21	* Removal, 15" Storm Sewer	LF	137	\$10.00	\$1,370.00
22	* Removal, 24" Storm Sewer	LF	120	\$10.00	\$1,200.00
23	* Remove, Storm Sewer Intake	EA	4	\$500.00	\$2,000.00
24	* Remove, Storm Sewer Manhole	EA	4	\$500.00	\$2,000.00

NO.	DESCRIPTION	ESTIMATED UNITS			AMOUNT
		UNIT	TOTAL	UNIT PRICE	TOTAL
25	10' x 4' Reinforced Concrete Box Culvert	LF	827	\$650.00	\$537,550.00
26	Storm Sewer, PVC, 8"	LF	6	\$30.00	\$180.00
27	Storm Sewer, 2000D, 15"	LF	12	\$100.00	\$1,200.00
28	Storm Sewer, 2000D, 18"	LF	30	\$100.00	\$3,000.00
29	Storm Sewer, 2000D, 24"	LF	101	\$120.00	\$12,120.00
30	Storm Sewer, 2000D, 30"	LF	93	\$125.00	\$11,625.00
31	Storm Sewer Connection to RCB	EA	6	\$1,000.00	\$6,000.00
32 *	Box Culvert Connection Removal - E. 27th Court	LS	1	\$4,000.00	\$4,000.00
33 *	Box Culvert Connection Removal - Easton Blvd.	LS	1	\$4,000.00	\$4,000.00
34	Intake, Type M-C	EA	2	\$3,500.00	\$7,000.00
35	Intake, Type M-E	EA	2	\$4,000.00	\$8,000.00
36	Manhole, Type M-C	EA	2	\$4,500.00	\$9,000.00
37	Manhole, Modified M-E	EA	3	\$5,000.00	\$15,000.00
38	Modified "RCP Area" Intake	EA	2	\$2,500.00	\$5,000.00
39	Water Services	LF	170	\$30.00	\$5,100.00
40 *	Sanitary Sewer Removal	LF	33	\$25.00	\$825.00
41	Sanitary Sewer, 10" PVC	LF	127	\$100.00	\$12,700.00
42	Sewer Pipe Supports	EA	8	\$400.00	\$3,200.00
43	Manhole, Type I Sanitary Sewer	EA	2	\$3,000.00	\$6,000.00
44	Sanitary Sewer Service	LF	140	\$50.00	\$7,000.00
45	Fence Removal and Replacement	LF	550	\$20.00	\$11,000.00
46 *	Temporary Fence	LF	161	\$15.00	\$2,415.00
47 *	Sodding	SQ	533	\$50.00	\$26,650.00
48 *	Silt Fence (Install and Remove)	LF	200	\$5.00	\$1,000.00
49 *	Emergency Trench Connection	EA	10	\$1,000.00	\$10,000.00
50	Structural Support Investigation	LS	1	\$10,000.00	\$10,000.00
51	Structural Support Installation	EA	4	\$4,000.00	\$16,000.00
52	Water Main Lowering	EA	4	\$10,000.00	\$40,000.00

7c

NO.	DESCRIPTION	ESTIMATED UNITS			AMOUNT
		UNIT	TOTAL	UNIT PRICE	TOTAL
53	Erosion Control	LS	1	\$5,000.00	\$5,000.00
54 *	Project Sign	LS	1	\$1,000.00	\$1,000.00
55	Construction Survey	LS	1	\$15,000.00	\$15,000.00
56 *	Removal of Existing Garage	LS	1	\$3,500.00	\$3,500.00
<b>TOTAL CONSTRUCTION COST</b>					<b>\$1,075,927.00</b>

Prepared By: Gabe Nelson, Snyder & Assoc.

Checked By: \_\_\_\_\_

\* Item does not have to be included in 4-year maintenance bond, but shall be covered by a 1-year maintenance bond.

\* Estimate Total= \$221,616.00