

DATE November 9, 2009

ORDERING CONSTRUCTION OF  
ARMY POST ROAD WIDENING - S.W. 9TH STREET TO S.E. 5TH STREET  
AND FIXING A DATE FOR RECEIVING OF BIDS ON NOVEMBER 17, 2009  
AND PUBLIC HEARING ON DECEMBER 7, 2009  
ENGINEER'S ESTIMATE IS \$2,072,906.75

WHEREAS, this Council deems it advisable and necessary to construct the below referenced improvement, all in accordance with the plans and specifications, and has caused to be prepared plans, specifications, and form of contract, together with estimate of cost, which are now on file in the City Engineer's Office, 2nd Floor, City Hall, 400 Robert D. Ray Drive, Des Moines, Iowa 50309-1891, for public inspection for the construction of said improvements, and said plans, specifications and form of contract are deemed suitable for the making of said improvement, for which the State of Iowa Department of Transportation (IDOT) and the City of Des Moines, (CITY) have an agreement, previously approved by this Council, under which the IDOT has agreed to advertise, receive, open and tabulate sealed bids, and

WHEREAS, before said plans, specifications, form of contract, and estimated cost of the improvement may be approved, and contract for the construction of the improvement entered into, it is necessary to hold a public hearing.

BE IT RESOLVED BY THE CITY COUNCIL OF THE CITY OF DES MOINES, IOWA: That the attached communication recommending construction of the following improvement and the method of financing; and also including the recommendation of the Des Moines City Engineer, as the Jurisdictional Engineer, submitting plans, specifications, form of contract documents, and Jurisdictional Engineer's estimate of cost for the construction of the following improvement:

Army Post Road Widening - S.W. 9th Street to S.E. 5th Street, 06-2009-005

CS-TSF-1945(713)--85-77, CS-TSF-1945(731)--85-77, ESL-1945(758)--7S-77

The improvement includes the construction of a center two-way left-turn lane by the removal and replacement of curbs, placement of 9-inch Portland cement concrete pavement base widening with a 3-inch HMA overlay, median modifications, storm drainage, subdrain, subbase placement, driveways, sidewalks, traffic signal construction at S.E. 3rd Street, pavement markings, sodding and miscellaneous associated work including cleanup; all in accordance with the contract documents, including Plan File Nos. 507-001/126, located on Army Post Road between S.W. 9th Street and S.E. 5th Street, Des Moines, Iowa

be and the same are hereby approved and accepted. The estimated construction cost for said improvement is \$2,072,906.75. The proposed plans, specifications, and form of contract documents are available for public inspection in the City Engineer's Office.

BE IT FURTHER RESOLVED: That this Council hereby determines that it is necessary and advisable to construct said improvement in the manner set forth in the plans, specifications, and form of contract documents submitted by the Jurisdictional Engineer; and that payment for the cost of said improvement shall be paid from the funding source identified below.

★ **Roll Call Number**

**Agenda Item Number**

6B

DATE November 9, 2009

BE IT FURTHER RESOLVED: That a public hearing on said plans, specifications, form of contract documents, and Jurisdictional Engineer's estimate of construction cost for said improvement be held in the City Council Chambers, 2nd Floor, City Hall, 400 Robert D. Ray Drive, Des Moines, Iowa, at 5:00 p.m. on December 7, 2009, at which time this Council will consider any objections offered thereto or to the making of said improvement.

BE IT FURTHER RESOLVED: That proposals will be received by the Iowa Department of Transportation, for the construction of said improvements, and the taking of bids in the manner required by law. Proposals received will be opened and tabulated by the Iowa Department of Transportation on November 17, 2009, after which the bids together with a report and recommendation of the Chief Civil Engineer, will be presented to City Council at its next meeting for action thereon.

BE IT FURTHER RESOLVED: That an appropriate Notice to Bidders and Notice of Public Hearing for said improvement be published in the Des Moines Register as provided and directed by Chapter 26 and/or 314, Code of Iowa.

(City Council Communication Number 09-785 attached.)

Moved by \_\_\_\_\_ to adopt.

FORM APPROVED:

FUNDS AVAILABLE

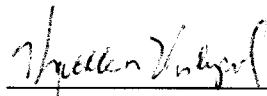
  
\_\_\_\_\_

  
\_\_\_\_\_

Kathleen Vanderpool  
Deputy City Attorney

Allen McKinley  
Des Moines Finance Director

-  Funding Source: 2009-2010 CIP, Page Street-5, Army Post Widening - SE 5th to SW 9th, STR229, Being:
- \$1,000,000 maximum in Federal Stimulus Funds under the American Recovery and Reinvestment Act of 2009 under agreement ESL-1945(758)--7S-77
  - \$500,000 maximum in Iowa DOT Traffic Safety Funds under agreement CS-TSF-1945(731)--85-77 for Army Post Road Widening from SW 9th Street to South Union Street
  - \$500,000 in Iowa DOT Traffic Safety Funds under agreement CS-TSF-1945(713)--85-77 for Army Post Road Widening from South Union Street to SE 5th Street
  - \$72,906.75 in G.O. Bonds from 2009-10 CIP, Page Street-4, Army Post Widening – S.E. 5th to S.W. 9th, STR229

**Roll Call Number**

★ .....

**Agenda Item Number**

6B

**Date** November 9, 2009

COUNCIL ACTION	YEAS	NAYS	PASS	ABSENT
COWNIE				
COLEMAN				
HENSLEY				
KIERNAN				
MAHAFFEY				
MEYER				
VLASSIS				
TOTAL				
MOTION CARRIED		APPROVED		

**CERTIFICATE**

I, DIANE RAUH, City Clerk of said City hereby certify that at a meeting of the City Council of said City of Des Moines, held on the above date, among other proceedings the above was adopted.

IN WITNESS WHEREOF, I have hereunto set my hand and affixed my seal the day and year first above written.

\_\_\_\_\_  
Mayor

\_\_\_\_\_  
City Clerk

6B

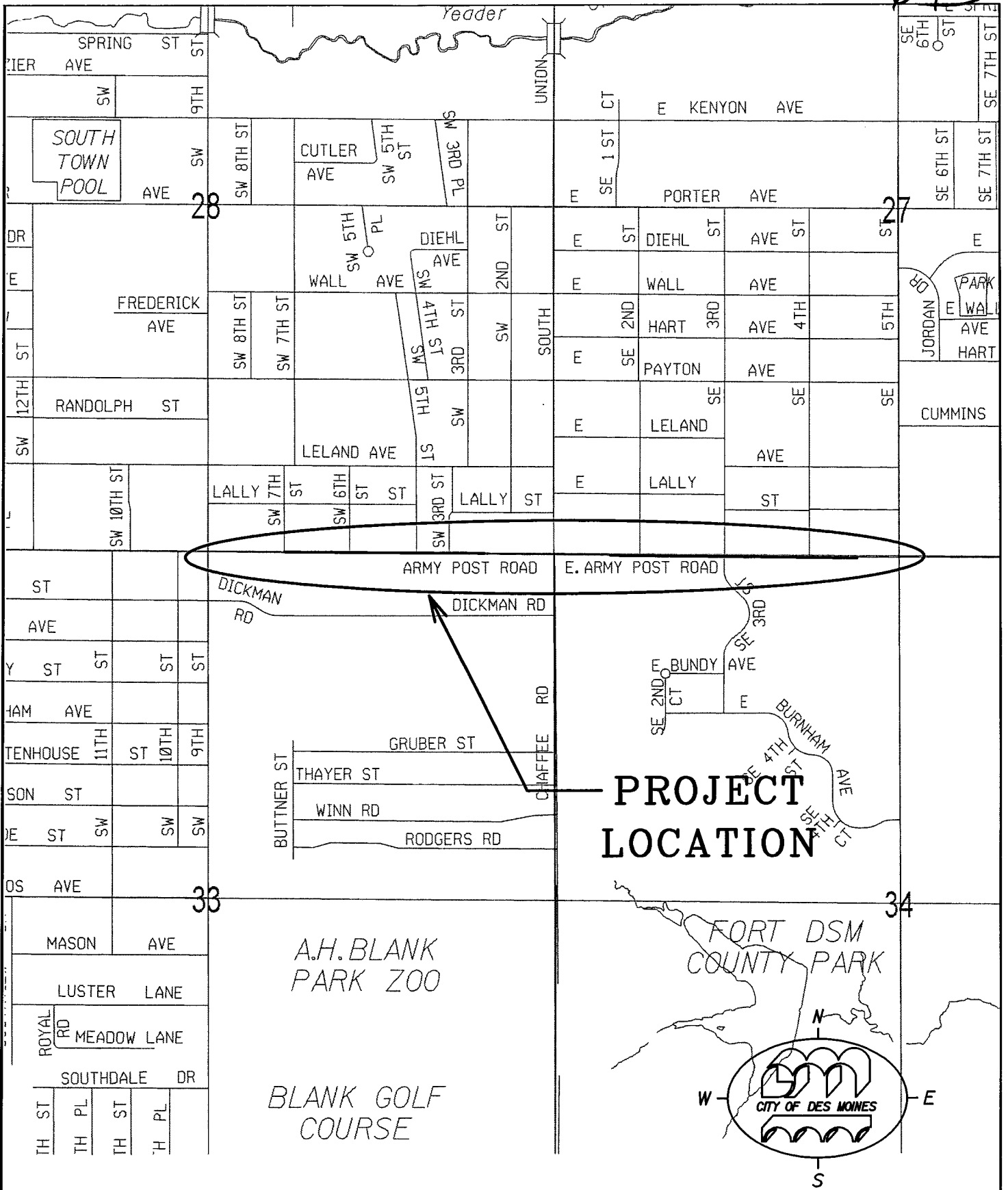

Tri-ENG\Design\166\2009\005\Drawings\Loc\_Map\LOC\_MAP.DGN 21-APR-2009 16:12

**ARMY POST ROAD WIDENING  
S.E. 5TH ST. to S.W. 9TH ST.  
ACTIVITY I.D. 06-2009-005**

6B

## CONSTRUCTION ESTIMATE

DEPARTMENT OF ENGINEERING  
CITY OF DES MOINES, IOWA

ACTIVITY ID 06-2009-005  
IDOT PROJ NO.: None  
DATE: 10/27/2009

### PROJECT: ARMY POST ROAD WIDENING - S.W. 9TH STREET TO S.E. 5TH STREET

NO.	DESCRIPTION	ESTIMATED UNITS			AMOUNT
		UNIT	TOTAL	UNIT PRICE	TOTAL
1	CLEARING AND GRUBBING	UNIT	15.4	\$80.00	\$1,232.00
2	TOPSOIL, STRIP, SALVAGE AND SPREAD	CY	800	\$25.00	\$20,000.00
3	SPECIAL COMPACTION OF SUBGRADE	STA	55.46	\$1,250.00	\$69,325.00
4	MODIFIED SUBBASE	CY	3,152.00	\$45.00	\$141,840.00
5	SHOULDER FINISHING, EARTH	STA	52.5	\$500.00	\$26,250.00
6	BASE, STANDARD OR SLIP FORM P.C. CONCRETE, 9 IN.	SY	7,058	\$55.00	\$388,190.00
7	CLEANING AND PREPARATION OF BASE	MILE	1.05	\$2,000.00	\$2,100.00
8	EXCAVATION, CLASS 13, FOR WIDENING	CY	11,406	\$15.00	\$171,090.00
9	RELOCATION OF MAIL BOXES	EACH	16.00	\$150.00	\$2,400.00
10	PAVEMENT SCARIFICATION	SY	3,730	\$5.00	\$18,650.00
11	STANDARD OR SLIP FORM PCC PAVEMENT, CLASS C, CLASS 3 DURABILITY, 7 In.	SY	508	\$52.00	\$26,416.00
12	MEDIAN, DOWELLED P.C. CONCRETE, AS PER PLAN	SY	258	\$85.00	\$21,930.00
13	PORTLAND CEMENT CONCRETE PAVEMENT SAMPLES	LS	1	\$2,000.00	\$2,000.00
14	HOT MIX ASPHALT MIXTURE (10,000,000 Esal), INTERM COURSE, 1/2 IN. MIX	TON	775	\$60.00	\$46,500.00
15	HOT MIX ASPHALT MIXTURE (10,000,000 Esal), SURFACE COURSE, 1/2 IN. MIX, NO SPCL FRIC REQ	TON	775	\$60.00	\$46,500.00
16	ASPHALT BINDER, PG 64-22	TON	90	\$450.00	\$40,500.00
17	SURFACING, DRIVEWAY	TON	375	\$25.00	\$9,375.00
18	MODULAR BLOCK RETAINING WALL	SF	800	\$25.00	\$20,000.00
19	MANHOLE, STORM SEWER, SW-401, 48"	EACH	8	\$4,000.00	\$32,000.00
20	MANHOLE, STORM SEWER, SW-401, 60"	EACH	2	\$5,000.00	\$10,000.00
21	INTAKE, SW-505	EACH	15	\$4,000.00	\$60,000.00

NO.	DESCRIPTION	ESTIMATED UNITS			AMOUNT
		UNIT	TOTAL	UNIT PRICE	TOTAL
22	INTAKE, SW-506	EACH	1	\$5,000.00	\$5,000.00
23	INTAKE, SW-511	EACH	4	\$6,000.00	\$24,000.00
24	MANHOLE ADJUSTMENT, MAJOR	EACH	2	\$3,000.00	\$6,000.00
25	SUBDRAIN, LONGITUDINAL, 4 IN. DIA	LF	4,574	\$18.00	\$82,332.00
26	SUBDRAIN OUTLET (RF-19C)	EACH	25	\$125.00	\$3,125.00
27	STORM SWR G-MAIN, TRENCHED, RCP 2000D, 15"	LF	257	\$100.00	\$25,700.00
28	STORM SWR G-MAIN, TRENCHED, RCP 2000D, 24"	LF	1,000	\$120.00	\$120,000.00
29	REMOVE STORM SEWER PIPE LESS THAN OR EQUAL TO 36 IN.	LF	296	\$30.00	\$8,880.00
30	REMOVAL OF PAVEMENT	SY	2,831	\$10.00	\$28,310.00
31	REMOVAL OF INTAKES AND UTILITY ACCESSES	EACH	26	\$600.00	\$15,600.00
32	REMOVAL OF SIDEWALK	SY	1,978	\$5.00	\$9,890.00
33	SIDEWALK, P.C. CONCRETE, 4 IN.	SY	2,622	\$33.00	\$86,526.00
34	SIDEWALK, P.C. CONCRETE, 6 IN.	SY	75	\$45.00	\$3,375.00
35	DETECTABLE WARNINGS FOR CURB RAMPS	SF	200	\$25.00	\$5,000.00
36	CURB AND GUTTER, PCC, 2.5'	LF	34	\$40.00	\$1,360.00
37	DRIVEWAY, P.C. CONCRETE, 7 IN.	SY	749	\$55.00	\$41,195.00
38	REMOVAL OF PAVED DRIVEWAY	SY	959	\$8.00	\$7,672.00
39	SAFETY CLOSURE	EACH	12	\$100.00	\$1,200.00
40	FENCE, REMOVE AND REINSTALL CHAIN LINK	LF	1,660	\$20.00	\$33,200.00
41	GATE	EACH	1	\$1,000.00	\$1,000.00
42	TRAFFIC SIGNALIZATION	LS	1	\$160,000.00	\$160,000.00
43	PAINTED PAV MARK, WATERBORNE OR SOLVENT-BASED	STA	62.20	\$25.00	\$1,555.00
44	PERM TAPE MARK, PROFILED PAVEMENT MARKING TAPE	STA	98.80	\$350.00	\$34,580.00
45	PERM TAPE MARK, INTERSECTION MARKING TAPE	STA	13.35	\$300.00	\$4,005.00
46	PRE-CUT SYMBOL AND LEGEND, INTERSECTION MARKING TAPE	EACH	24	\$400.00	\$9,600.00
47	PAVEMENT MARKINGS REMOVED	STA	140	\$20.00	\$2,800.00
48	GROOVE CUT - PAVEMENT MARKING	STA	112.15	\$25.00	\$2,803.75
49	GROOVE CUT - SYMBOL AND LEGEND	EACH	24	\$100.00	\$2,400.00

6B

NO.	DESCRIPTION	ESTIMATED UNITS			AMOUNT
		UNIT	TOTAL	UNIT PRICE	TOTAL
50	TRAFFIC CONTROL	LS	1	\$15,000.00	\$15,000.00
51	MOBILIZATION	LS	1	\$100,000.00	\$100,000.00
52	ADJUST WATER SERVICE STOP BOX	EACH	5	\$500.00	\$2,500.00
53	CASTING, SW-601, TYPE B	EACH	1	\$500.00	\$500.00
54	CASTING, SW-602, TYPE F	EACH	1	\$500.00	\$500.00
55	CHECK DEPTH OF WATER SERVICE	EACH	4	\$350.00	\$1,400.00
56	DISCONNECT WATER SERVICE	EACH	2	\$350.00	\$700.00
57	LOWER WATER SERVICE WITH COPPER	EACH	4	\$1,000.00	\$4,000.00
58	RELOCATE FIRE HYDRANT	EACH	1	\$1,000.00	\$1,000.00
59	REMOVAL OF FIRE HYDRANT	EACH	1	\$500.00	\$500.00
60	SANITARY SEWER CLEANOUT	EACH	1	\$600.00	\$600.00
61	SODDING	SQ	1,100	\$35.00	\$38,500.00
62	WATERING FOR SOD, SPECIAL DITCH CONTROL, OR SLOPE PROTECTION	MGAL	660	\$30.00	\$19,800.00
63	MOBILIZATION FOR WATERING	EACH	10	\$350.00	\$3,500.00
64	SILT FENCE FOR DITCH CHECKS	LF	200	\$4.00	\$800.00
65	REMOVAL OF SILT FENCE FOR DITCH CHECKS	LF	200	\$1.00	\$200.00
Prepared By: Roger Joanning					
Checked By: _____					
<b>TOTAL CONSTRUCTION COST</b>					<b>\$2,072,906.75</b>