

33

Date.....December 22, 2008.....

APPROVING AMENDMENT TO SCHEMATIC PLAN FOR JOHN AND MARY PAPPAGJOHN SCULPTURE PARK

WHEREAS, on March 24, 2008, by Roll Call No. 08-533, the City Council approved the John and Mary Pappajohn Sculpture Park Agreement with the Edmundson Art Foundation, Inc. ("Des Moines Art Center") for the development of the John and Mary Pappajohn Sculpture Park ("the Agreement"); and

WHEREAS, on March 24, 2008, by Roll Call No. 08-532, the City Council approved the Schematic Plan for the John and Mary Pappajohn Sculpture Park ("Sculpture Park"), which designates 17 sculptures and the location of each sculpture; and

WHEREAS, John and Mary Pappajohn desire to donate an additional 7 sculptures to the Des Moines Art Center and to replace one of the sculptures in the original Schematic Plan, which brings the sculpture collection to 24 pieces in total and requires some changes to the Schematic Plan; and

WHEREAS, section II.B of the Agreement establishes a Sculpture Committee, composed of John and Mary Pappajohn, or their designee, and one representative each from the Des Moines Art Center and the City; and

WHEREAS, the Sculpture Committee is charged with selecting sculptures for the Sculpture Park, approving the Supplemental Security Plan, and approving any amendment to the Schematic Plan; and

WHEREAS, the Sculpture Committee has approved the additional sculptures and the revised schematic Plan; and

WHEREAS, any material change to the Schematic Plan must also be approved by the City Council; and

WHEREAS, on November 25, 2008, by Board Action 08-10, the Park and Recreation Board approved the then current proposed amendment to the Schematic Plan, which at that time did not include the Butterfield sculpture.

NOW, THEREFORE, BE IT RESOLVED by the City Council of the City of Des Moines, Iowa, that the amended Schematic Plan including 24 sculptures for the Mary Pappajohn Sculpture Park be and is hereby approved.

(Council Communication No. 08- ) Moved by \_\_\_\_\_ to adopt.

APPROVED AS TO FORM:

*Ann DiDonato*  
Ann DiDonato, Assistant City Attorney

COUNCIL ACTION	YEAS	NAYS	PASS	ABSENT
COWNIE				
COLEMAN				
HENSLEY				
KIERNAN				
MAHAFFEY				
MEYER				
VLASSIS				
TOTAL				

MOTION CARRIED APPROVED

.....  
Mayor

**CERTIFICATE**

**I, DIANE RAUH, City Clerk of said City hereby certify that at a meeting of the City Council of said City of Des Moines, held on the above date, among other proceedings the above was adopted.**

**IN WITNESS WHEREOF, I have hereunto set my hand and affixed my seal the day and year first above written.**

\_\_\_\_\_  
City Clerk

Project Name: JOHN and MARY PAPPALONN SCULPTURE PARK



CITY OF DES MOINES  
400 ROBERT CLAY DRIVE  
DES MOINES, IA 50309

DESIGN ARCHITECT  
MARKET AND LAMAR DESIGN ARCHITECTS, LLP  
200 MARKET STREET  
DES MOINES, IA 50309  
Tel: (515) 281-5000 Fax: (515) 281-5016

LANDSCAPE ARCHITECTURE & LANDSCAPE DESIGN  
3000 PARKWAY BLVD  
DES MOINES, IOWA 50309  
Tel: (515) 281-3141 Fax: (515) 281-4011

GENERAL CONTRACTOR  
DUNN & SMITH ENGINEERS  
2000 MARKET STREET  
DES MOINES, IOWA 50309  
Tel: (515) 271-3000 Fax: (515) 271-3020

ADDITIONAL LOCAL CONTRACTORS  
3000 PARKWAY BLVD  
DES MOINES, IOWA 50309  
Tel: (515) 281-3141 Fax: (515) 281-4011

No.	Description
1.	11/2/2008 3RD DOCUMENTS

DATE: 08/01/08  
SCALE: AS NOTED  
PROJECT NO: 2007017000  
DRAWING NO: SCULPTURE LAYOUT PLAN

ACTIVITY ID# 11-0000-011  
L-301  
PLAN FILE NO. 47487

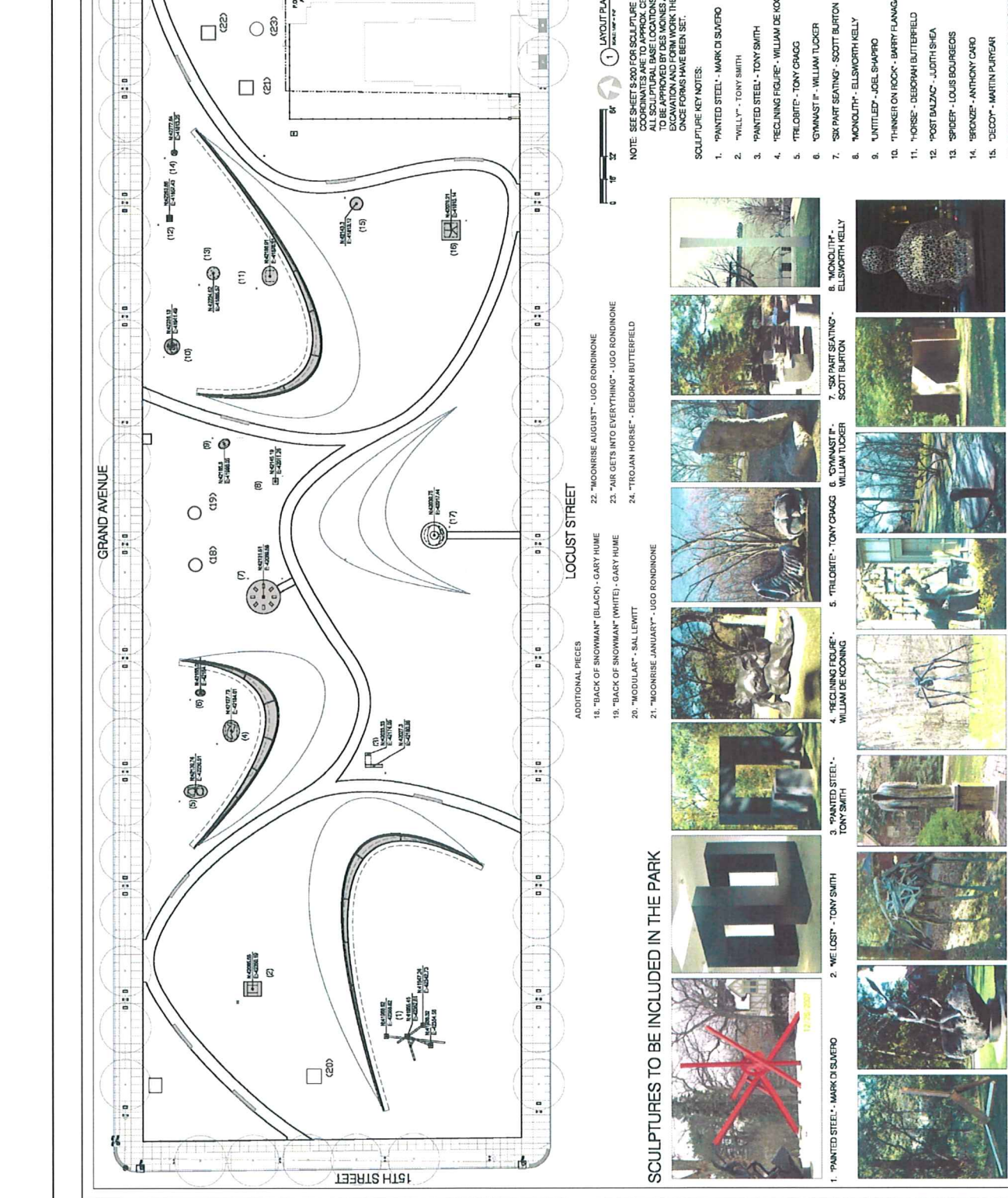

15TH STREET

13TH STREET

GRAND AVENUE

LOCUST STREET

ADDITIONAL PIECES

- 18. "BACK OF SNOWMAN" (BLACK) - GARY HUME
- 19. "BACK OF SNOWMAN" (WHITE) - GARY HUME
- 20. "MODULAR" - SAL LEWITT
- 21. "MOONRISE JANUARY" - UGO RONDIKONE
- 22. "MOONRISE AUGUST" - UGO RONDIKONE
- 23. "AIR GETS INTO EVERYTHING" - UGO RONDIKONE
- 24. "TROJAN HORSE" - DEBORAH BUTTERFIELD

SCULPTURES TO BE INCLUDED IN THE PARK

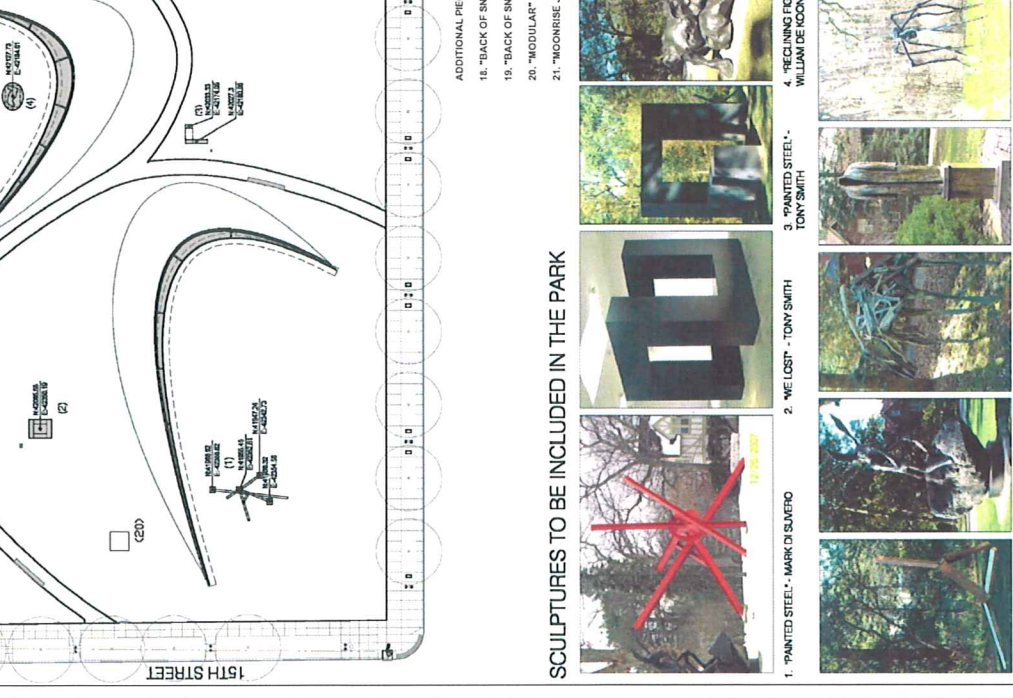

- 1. "PAINTED STEEL" - MARK DI SILVERO
- 2. "WE LOST" - TONY SMITH
- 3. "PAINTED STEEL" - TONY SMITH
- 4. "RECLINING FIGURE" - WILLIAM DE KOONING
- 5. "TRICORITE" - TONY CRAIG
- 6. "GYMNAST II" - WILLIAM TUCKER
- 7. "SKY PART SEATING" - SCOTT BURTON
- 8. "MONOLITH" - ELLSWORTH KELLY
- 9. "JANTILED" - JOEL SHAPIRO
- 10. "THINKER ON ROCK" - BARRY FLANNAGAN
- 11. "HORSE" - DEBORAH BUTTERFIELD
- 12. "POST BALZAC" - JUDITH SHEA
- 13. "SPIDER" - LOUIS BOURGEOIS
- 14. "BRONZE" - ANTHONY CARO
- 15. "DECOY" - MARTIN PURYEAR
- 16. "WEATHERING STEEL" - RICHARD SERRA
- 17. "NOMAD" - JAUME PLENSA

NOTE: SEE SHEET S-200 FOR SCULPTURE BASE DETAILS. COORDINATES ARE TO APPROX. CENTER OF ALL BASES. ALL SCULPTURAL BASE LOCATIONS AND ORIENTATIONS ARE TO BE VERIFIED BY FIELD SURVEY AND PHOTO DOCUMENTATION AND FIELDWORK THEN APPROVED AGAIN ONCE FORMS HAVE BEEN SET.

SCULPTURE KEY NOTES:

- 1. "PAINTED STEEL" - MARK DI SILVERO
- 2. "WILLY" - TONY SMITH
- 3. "PAINTED STEEL" - TONY SMITH
- 4. "RECLINING FIGURE" - WILLIAM DE KOONING
- 5. "TRICORITE" - TONY CRAIG
- 6. "GYMNAST II" - WILLIAM TUCKER
- 7. "SKY PART SEATING" - SCOTT BURTON
- 8. "MONOLITH" - ELLSWORTH KELLY
- 9. "JANTILED" - JOEL SHAPIRO
- 10. "THINKER ON ROCK" - BARRY FLANNAGAN
- 11. "HORSE" - DEBORAH BUTTERFIELD
- 12. "POST BALZAC" - JUDITH SHEA
- 13. "SPIDER" - LOUIS BOURGEOIS
- 14. "BRONZE" - ANTHONY CARO
- 15. "DECOY" - MARTIN PURYEAR
- 16. "WEATHERING STEEL" - RICHARD SERRA
- 17. "NOMAD" - JAUME PLENSA

SCALE: 1" = 32'

1 LAYOUT PLAN

DATE: 08/01/08

SCALE: AS NOTED

PROJECT NO: 2007017000

DRAWING NO: SCULPTURE LAYOUT PLAN

ACTIVITY ID# 11-0000-011

L-301

PLAN FILE NO. 47487

DATE: 08/01/08

SCALE: AS NOTED

PROJECT NO: 2007017000

DRAWING NO: SCULPTURE LAYOUT PLAN

ACTIVITY ID# 11-0000-011

L-301

PLAN FILE NO. 47487