



DATE March 14, 2011

PUBLIC HEARING, APPROVING PLANS, SPECIFICATIONS, FORM OF CONTRACT DOCUMENTS, AND ENGINEER'S ESTIMATE ON MCKINLEY AVENUE WIDENING AT SOUTH UNION STREET; RECEIVE AND FILE BIDS; AND DESIGNATION OF LOWEST RESPONSIVE, RESPONSIBLE BIDDER AS REILLY CONSTRUCTION CO., INC., CHRIS R. REILLY, PRESIDENT, \$1,107,288.20

WHEREAS, on February 14, 2011, under Roll Call No. 11-0166, plans, specifications, form of contract documents, and Jurisdictional Engineer's estimate of construction cost were filed with the City Clerk, for the construction of the following improvement:

McKinley Avenue Widening at South Union Street, 06-2008-009

The improvement includes the widening and reconstruction of McKinley Avenue at South Union Street with 10-inch thick full-depth Portland Cement Concrete; together with pavement removal, excavation, water main construction, storm drainage, subdrain, subbase placement, driveways, sidewalks, sodding, and miscellaneous associated work including cleanup; in accordance with the contract documents, including Plan File Nos. 521-094/177, on McKinley Avenue at South Union Street

WHEREAS, notice of the hearing on the plans, specifications, form of contract documents, and Engineer's estimate of construction cost was published as required by law.

NOW, THEREFORE, BE IT RESOLVED BY THE CITY COUNCIL OF THE CITY OF DES MOINES, IOWA: That the hearing on the plans, specifications, form of contract documents, and Jurisdictional Engineer's estimate of construction cost for said improvement be closed; and that said plans, specifications, form of contract documents, and Jurisdictional Engineer's estimate of construction cost are hereby approved as the plans, specifications, form of contract documents, and Jurisdictional Engineer's estimate of construction cost for said improvement.

BE IT FURTHER RESOLVED: That sealed bids for said improvement were submitted by the following bidders:

- |                               |                     |
|-------------------------------|---------------------|
| Reilly Construction Co., Inc. | Ossian, IA          |
| Grimes Asphalt & Paving Corp. | Grimes, IA          |
| Elder Corporation             | Des Moines, IA      |
| McAninch Corporation          | Des Moines, IA      |
| Corell Contractor, Inc.       | West Des Moines, IA |
| Concrete Technologies, Inc.   | Urbandale, IA       |

which were received and opened at a public meeting presided over by the Jurisdictional Engineer in the City Council Chambers, 2nd Floor, City Hall, 400 Robert D. Ray Drive, Des Moines, Iowa at 11:00 a.m. on March 1, 2011. Said bids and the attached tabulation of bids for said improvement be and are hereby received and filed.



**Roll Call Number**

**Agenda Item Number**

42

DATE March 14, 2011

BE IT FURTHER RESOLVED: That the Jurisdictional Engineer has determined that the lowest responsive, responsible bid for the construction of said improvement was submitted by Reilly Construction Co., Inc., Chris R. Reilly, President, 110 E. Main Street, PO Box 99, Ossian, IA, 52161 in the amount of \$1,107,288.20, and said bid be and the same is hereby accepted.

BE IT FURTHER RESOLVED: That the bid security of the unsuccessful bidders be and is hereby authorized and directed to be returned.

BE IT FURTHER RESOLVED: That the Jurisdictional Engineer is hereby directed to secure execution by the lowest responsible, responsive Bidder and its surety of the contract documents in the form heretofore approved by this Council; that the Jurisdictional Engineer is directed to thereafter present said contract documents to this Council for approval and authorization to the Mayor to sign; and that no contract shall be deemed to exist between the City of Des Moines and said Bidder until said contract has been executed by the Bidder, and shall have been approved by this Council and executed by the Mayor and attested to by the City Clerk.

(City Council Communication Number 11-156 attached.)

Moved by \_\_\_\_\_ to adopt.

FORM APPROVED:

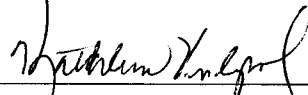
  
Kathleen Vanderpool  
Deputy City Attorney

FUNDS AVAILABLE

  
Scott E. Sanders  
Des Moines Finance Director

 Funding Source: 2010-2011 CIP, Page STR-29, McKinley Avenue Widening - Fleur Drive to E. Indianola Avenue, STR212, Being: \$125,988 from Des Moines Water Works for water main construction, with the remaining \$981,300.20 in G. O. Bonds

COUNCIL ACTION	YEAS	NAYS	PASS	ABSENT
COWNIE				
COLEMAN				
GRIESS				
HENSLEY				
MAHAFFEY				
MEYER				
MOORE				
TOTAL				

MOTION CARRIED APPROVED

Mayor

I, Diane Rauh, City Clerk of said City Council, hereby certify that at a meeting of the City Council, held on the above date, among other proceedings the above was adopted.

IN WITNESS WHEREOF, I have hereunto set my hand and affixed my seal the day and year first above written.

City Clerk

T:\ENG\Design\06-2008\009\Drawings\Loc\_Map\LOC\_MAP.DGN 12-JAN-2011 10:55

42

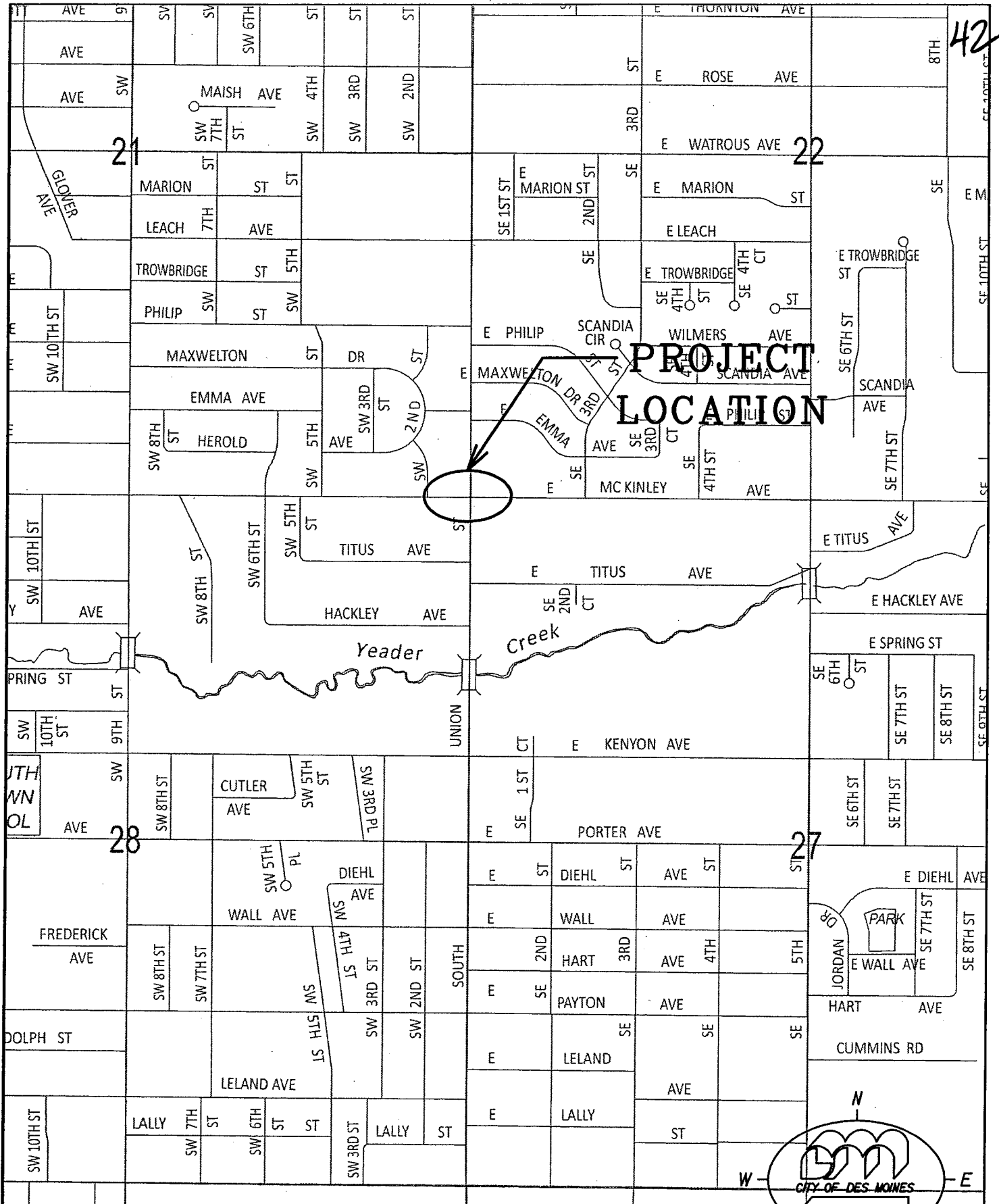

**MC KINLEY AVENUE @ SOUTH UNION  
ACTIVITY I.D. 06-2008-009**

TABULATED BY: R. Joanning  
CHECKED BY: *R. De Groot*  
APPROVED BY: *R. De Groot*

**CONTRACTOR'S BID TABULATION**  
**PROJECT: MCKINLEY AVE. WIDENING AT SOUTH UNION STREET**

**ESTIMATE**

ITEM	DESCRIPTION	QUANTITY	UNIT PRICE		AMOUNT		BID PRICE		BID PRICE		BID PRICE	
			PRICE	AMOUNT	PRICE	AMOUNT	UNIT PRICE	AMOUNT	UNIT PRICE	AMOUNT	UNIT PRICE	AMOUNT
1	Mobilization	1 LS	\$70,000.00	\$70,000.00	\$35,000.00	\$35,000.00	\$750.00	\$750.00	\$95,000.00	\$95,000.00	\$51,000.00	\$51,000.00
2	Cleaning, Tree	260 IN	\$35.00	\$9,100.00	\$30.00	\$7,800.00	\$17.00	\$4,420.00	\$17.00	\$4,420.00	\$16.00	\$4,160.00
3	Grubbing, Stump	518 IN	\$15.00	\$7,770.00	\$15,000.00	\$7,770.00	\$4.00	\$2,072.00	\$4.00	\$2,072.00	\$4.70	\$2,434.60
4	Clearing, Tree	0.28 ACRE	\$25,000.00	\$7,000.00	\$15,000.00	\$4,200.00	\$8.00	\$1,260.00	\$4,500.00	\$1,260.00	\$4,100.00	\$1,148.00
5	Stripping, Salvaging and Spread Topsoil	1600 CY	\$10.00	\$16,000.00	\$8.00	\$12,800.00	\$6.00	\$9,600.00	\$8.00	\$12,800.00	\$12.25	\$19,600.00
6	Excavation, Class 13	17280 CY	\$7.00	\$120,960.00	\$5.75	\$99,360.00	\$750.00	\$750.00	\$6.00	\$103,680.00	\$8.30	\$143,424.00
7	Tree Wall Removal	1 LS	\$500.00	\$500.00	\$1,500.00	\$1,500.00	\$790.00	\$790.00	\$1,500.00	\$1,500.00	\$2,500.00	\$2,500.00
8	Limestone Wall Removal	1 LS	\$2,000.00	\$2,000.00	\$1,500.00	\$1,500.00	\$5.00	\$19,110.00	\$5.00	\$19,500.00	\$5.25	\$20,475.00
9	Pavement Removal	3900 SY	\$6.00	\$31,200.00	\$4.90	\$19,110.00	\$4.90	\$19,110.00	\$5.00	\$19,500.00	\$7.05	\$10,927.50
10	Driveway Removal	1550 SY	\$7.00	\$10,850.00	\$4.90	\$7,595.00	\$5.00	\$7,750.00	\$5.00	\$7,750.00	\$5.95	\$5,087.25
11	Sidewalk Removal	855 SY	\$6.00	\$5,130.00	\$4.90	\$4,189.50	\$2.00	\$13,880.00	\$2.00	\$13,880.00	\$2.70	\$18,738.00
12	Subgrade Preparation	6940 SY	\$2.00	\$13,880.00	\$1.75	\$12,145.00	\$37.00	\$82,250.00	\$39.00	\$91,650.00	\$43.50	\$102,225.00
13	Modified Subbase	2350 CY	\$35.00	\$82,250.00	\$37.00	\$86,950.00	\$55.00	\$130,250.00	\$58.00	\$136,660.00	\$62.00	\$146,660.00
14	Sanitary Sewer, 8"	193 LF	\$40.00	\$7,720.00	\$38.00	\$7,384.00	\$11.00	\$33,715.00	\$10.00	\$30,650.00	\$8.65	\$26,512.25
15	Sewer Service Relocation	3 EACH	\$2,500.00	\$7,500.00	\$300.00	\$900.00	\$200.00	\$1,200.00	\$370.00	\$2,220.00	\$320.00	\$1,920.00
16	Storm Sewer, 15" RCP	259 LF	\$60.00	\$15,540.00	\$11.00	\$33,715.00	\$900.00	\$900.00	\$950.00	\$950.00	\$700.00	\$700.00
17	Subdrain, Longitudinal, 4"	3065 LF	\$350.00	\$1,082,750.00	\$200.00	\$612,000.00	\$900.00	\$900.00	\$950.00	\$950.00	\$700.00	\$700.00
18	Subdrain, Outlet, 6"	6 EACH	\$500.00	\$3,000.00	\$300.00	\$1,800.00	\$200.00	\$1,200.00	\$370.00	\$2,220.00	\$320.00	\$1,920.00
19	Water Service Check Depth	1 EACH	\$500.00	\$500.00	\$900.00	\$900.00	\$200.00	\$1,200.00	\$370.00	\$2,220.00	\$320.00	\$1,920.00
20	Water Service Lowered with New Copper	4 EACH	\$2,500.00	\$10,000.00	\$1,500.00	\$6,000.00	\$900.00	\$3,600.00	\$1,500.00	\$6,000.00	\$1,900.00	\$7,600.00
21	Manhole, Sanitary, Type A	1 EACH	\$3,500.00	\$3,500.00	\$4,000.00	\$4,000.00	\$4,000.00	\$4,000.00	\$4,200.00	\$4,200.00	\$3,400.00	\$3,400.00
22	Manhole, Major Adjustment	4 EACH	\$2,000.00	\$8,000.00	\$1,500.00	\$6,000.00	\$600.00	\$2,400.00	\$850.00	\$3,400.00	\$650.00	\$2,520.00
23	Chimney Seal	4 EACH	\$750.00	\$3,000.00	\$600.00	\$2,400.00	\$15.00	\$60.00	\$16.00	\$64.00	\$20.50	\$82.00
24	Sewer, Removal	110 LF	\$15.00	\$1,650.00	\$15.00	\$1,650.00	\$15.00	\$1,650.00	\$16.00	\$1,760.00	\$20.50	\$2,255.00
25	Intake, Type M-D	1 EACH	\$3,500.00	\$3,500.00	\$4,000.00	\$4,000.00	\$4,000.00	\$4,000.00	\$4,200.00	\$4,200.00	\$4,900.00	\$4,900.00
26	Intake, Type M-E	1 EACH	\$4,500.00	\$4,500.00	\$5,500.00	\$5,500.00	\$5,500.00	\$5,500.00	\$5,800.00	\$5,800.00	\$6,400.00	\$6,400.00
27	Type B Casting	4 EACH	\$450.00	\$1,800.00	\$400.00	\$1,600.00	\$400.00	\$1,600.00	\$400.00	\$1,600.00	\$720.00	\$2,880.00
28	PCC Pavement, C I C I 3, 8"	305 SY	\$45.00	\$13,725.00	\$40.00	\$12,200.00	\$40.00	\$12,200.00	\$40.00	\$12,200.00	\$43.50	\$13,267.50
29	PCC Pavement, C I C I 3, 10"	6000 SY	\$60.00	\$360,000.00	\$47.00	\$282,000.00	\$47.00	\$282,000.00	\$47.00	\$282,000.00	\$47.00	\$282,000.00
30	Curb and Gutter, Remove and Replace, PCC, 24"	60 LF	\$35.00	\$2,100.00	\$30.00	\$1,800.00	\$30.00	\$1,800.00	\$32.00	\$1,920.00	\$25.50	\$1,530.00
31	Driveway Surfacing, HMA Millings	500 TON	\$15.00	\$7,500.00	\$16.00	\$8,000.00	\$16.00	\$8,000.00	\$16.00	\$8,000.00	\$28.25	\$14,125.00
32	Driveway, PCC, 7"	1500 SY	\$35.00	\$52,500.00	\$32.00	\$48,000.00	\$34.00	\$51,000.00	\$34.00	\$51,000.00	\$29.50	\$44,250.00
33	Sidewalk, PCC, 4"	1400 SY	\$30.00	\$42,000.00	\$25.00	\$35,000.00	\$25.00	\$35,000.00	\$26.00	\$36,400.00	\$24.50	\$34,300.00
34	Handicapped Ramps, W/Truncated Domes	48 SY	\$75.00	\$3,600.00	\$72.00	\$3,456.00	\$62.70	\$3,197.70	\$76.00	\$3,648.00	\$62.50	\$3,000.00
35	Painted Pavement Markings	51 STA	\$50.00	\$2,550.00	\$62.70	\$3,197.70	\$80.00	\$800.00	\$66.00	\$3,366.00	\$64.00	\$3,264.00
36	Painted Symbol and Legend	10 EACH	\$100.00	\$1,000.00	\$80.00	\$800.00	\$80.00	\$800.00	\$84.00	\$840.00	\$81.50	\$815.00
37	Sodding	900 SQ	\$30.00	\$27,000.00	\$31.00	\$27,900.00	\$25.00	\$22,500.00	\$26.00	\$23,400.00	\$32.00	\$28,800.00
38	Watering, Sod	540 MGAL	\$30.00	\$16,200.00	\$12.00	\$6,480.00	\$12.00	\$6,480.00	\$10.00	\$5,400.00	\$9.60	\$5,184.00
39	Traffic Control	1 LS	\$10,000.00	\$10,000.00	\$3,500.00	\$3,500.00	\$3,500.00	\$3,500.00	\$3,700.00	\$3,700.00	\$4,100.00	\$4,100.00
40	Traffic Signalization	1 LS	\$110,000.00	\$110,000.00	\$110,000.00	\$110,000.00	\$110,000.00	\$110,000.00	\$120,200.00	\$120,200.00	\$109,000.00	\$109,000.00
41	Project Sign Small - Standard	1 EACH	\$500.00	\$500.00	\$175.00	\$175.00	\$175.00	\$175.00	\$180.00	\$180.00	\$203.00	\$203.00

42

42

ITEM	DESCRIPTION	QUANTITY	UNIT PRICE	AMOUNT	UNIT PRICE	AMOUNT	UNIT PRICE	AMOUNT	UNIT PRICE	AMOUNT
42	Inlet Filter, Type 1	2 EACH	\$100.00	\$200.00	\$250.00	\$500.00	\$260.00	\$520.00	\$113.50	\$227.00
43	Silt Fence	2000 LF	\$2.00	\$4,000.00	\$1.65	\$3,300.00	\$2.00	\$4,000.00	\$1.80	\$3,600.00
44	Mulching	1 Acre	\$800.00	\$800.00	\$400.00	\$400.00	\$420.00	\$420.00	\$1,200.00	\$1,200.00
45	Erosion Control	1 LS	\$3,000.00	\$3,000.00	\$2,000.00	\$2,000.00	\$5,200.00	\$5,200.00	\$2,300.00	\$2,300.00
46	Remove & Relocate Chain Link Fence	140 LF	\$30.00	\$4,200.00	\$15.00	\$2,100.00	\$20.00	\$2,800.00	\$19.25	\$2,695.00
47	Modular Wall	1900 SF	\$35.00	\$66,500.00	\$16.00	\$30,400.00	\$11.00	\$20,900.00	\$11.20	\$21,280.00
48	PCC Footing for Modular Wall	2 EACH	\$2,000.00	\$4,000.00	\$2,600.00	\$5,200.00	\$2,700.00	\$5,400.00	\$2,700.00	\$5,400.00
49	Tree Well	3 EACH	\$1,000.00	\$3,000.00	\$1,000.00	\$3,000.00	\$1,000.00	\$3,000.00	\$1,100.00	\$3,300.00
50	Water Main, 12" Dia. PVC	821 LF	\$70.00	\$57,470.00	\$35.00	\$28,735.00	\$37.00	\$30,377.00	\$37.00	\$30,377.00
51	Water Main, 8" Dia. PVC	578 LF	\$50.00	\$28,800.00	\$28.00	\$16,128.00	\$29.00	\$16,704.00	\$31.00	\$17,856.00
52	12" Gate Valve and Valve Box	3 EACH	\$4,000.00	\$12,000.00	\$1,600.00	\$4,800.00	\$1,700.00	\$5,100.00	\$2,200.00	\$6,600.00
53	8" Gate Valve and Valve Box	5 EACH	\$2,000.00	\$10,000.00	\$1,050.00	\$5,250.00	\$1,100.00	\$5,500.00	\$1,300.00	\$6,500.00
54	8" Bends	5 EACH	\$900.00	\$4,500.00	\$475.00	\$2,375.00	\$500.00	\$2,500.00	\$380.00	\$1,900.00
55	12" x 12" Tee	2 EACH	\$2,750.00	\$5,500.00	\$775.00	\$1,550.00	\$800.00	\$1,600.00	\$830.00	\$1,660.00
56	12" x 8" Tee	1 EACH	\$2,500.00	\$2,500.00	\$675.00	\$675.00	\$700.00	\$700.00	\$760.00	\$760.00
57	12" x 8" Reducer	2 EACH	\$1,000.00	\$2,000.00	\$375.00	\$750.00	\$400.00	\$800.00	\$330.00	\$660.00
58	12" Solid Sleeve	1 EACH	\$400.00	\$400.00	\$425.00	\$425.00	\$450.00	\$450.00	\$690.00	\$690.00
59	8" Solid Sleeve	3 EACH	\$300.00	\$900.00	\$325.00	\$975.00	\$340.00	\$1,020.00	\$560.00	\$1,680.00
60	8" Cap or Plug	1 EACH	\$90.00	\$90.00	\$375.00	\$375.00	\$400.00	\$400.00	\$380.00	\$380.00
61	12" Cap or Plug	2 EACH	\$100.00	\$200.00	\$475.00	\$950.00	\$500.00	\$1,000.00	\$560.00	\$1,120.00
62	Fire Hydrant Assembly	4 EACH	\$3,500.00	\$14,000.00	\$3,500.00	\$14,000.00	\$3,700.00	\$14,800.00	\$4,300.00	\$17,200.00
63	1" Water Service Line with New Stop Box, Same Side	12 EACH	\$1,200.00	\$14,400.00	\$1,275.00	\$15,300.00	\$1,300.00	\$15,600.00	\$1,300.00	\$15,600.00
64	1" Water Service Line with New Stop Box, Opposite Side	6 EACH	\$3,000.00	\$18,000.00	\$2,500.00	\$15,000.00	\$2,600.00	\$15,600.00	\$3,200.00	\$19,200.00
65	2" Water Service Line with New Stop Box, Same Side	1 EACH	\$3,000.00	\$3,000.00	\$2,750.00	\$2,750.00	\$2,800.00	\$2,800.00	\$2,100.00	\$2,100.00
66	2" Water Service Line with New Stop Box, Opposite Side	1 EACH	\$4,000.00	\$4,000.00	\$3,750.00	\$3,750.00	\$4,000.00	\$4,000.00	\$5,400.00	\$5,400.00
67	1" Water Service Line with New Stop Box & Meter Pit, Same Side	2 EACH	\$4,500.00	\$9,000.00	\$5,050.00	\$10,100.00	\$5,300.00	\$10,600.00	\$4,300.00	\$8,600.00
68	Foundation Rock	75 TON	\$25.00	\$1,875.00	\$28.00	\$2,100.00	\$29.00	\$2,175.00	\$31.50	\$2,362.50
TOTAL CONSTRUCTION COST				\$1,339,610.00		\$1,107,288.20		\$1,177,631.00		\$1,206,254.60
PERCENT OF ENGINEER'S ESTIMATE						-17.34%		-12.09%		-9.95%
						Low				

TABULATED BY: R. Joanning  
CHECKED BY: *[Signature]*  
APPROVED BY: *[Signature]*

**CONTRACTOR'S BID TABULATION**  
PROJECT: MCKINLEY AVE. WIDENING AT SOUTH UNION STREET

ESTIMATE

ITEM	DESCRIPTION	QUANTITY	UNIT	AMOUNT		BID PRICE		UNIT	BID PRICE		UNIT	AMOUNT	
				PRICE	AMOUNT	PRICE	AMOUNT		PRICE	AMOUNT		PRICE	AMOUNT
1	Mobilization	1	LS	\$70,000.00	\$70,000.00	\$49,125.00	\$49,125.00	\$39,100.00	\$39,100.00	\$97,000.00	\$97,000.00	\$39,100.00	\$39,100.00
2	Clearing, Tree	260	IN	\$35.00	\$9,100.00	\$15.75	\$4,095.00	\$17.35	\$4,511.00	\$16.00	\$4,160.00	\$17.35	\$4,511.00
3	Grubbing, Stump	518	IN	\$15.00	\$7,770.00	\$3.50	\$1,813.00	\$11.50	\$5,957.00	\$3.75	\$1,942.50	\$11.50	\$5,957.00
4	Clearing, Tree	0.28	ACRE	\$25,000.00	\$7,000.00	\$4,000.00	\$1,120.00	\$4,400.00	\$1,232.00	\$4,080.00	\$1,142.40	\$4,400.00	\$1,232.00
5	Stripping, Salvaging and Spread Topsoil	1600	CY	\$10.00	\$16,000.00	\$13.00	\$20,800.00	\$12.00	\$19,200.00	\$2.75	\$4,400.00	\$12.00	\$19,200.00
6	Excavation, Class 13	17280	CY	\$7.00	\$120,960.00	\$5.60	\$96,768.00	\$13.00	\$224,640.00	\$7.15	\$123,552.00	\$13.00	\$224,640.00
7	Tree Well Removal	1	LS	\$500.00	\$500.00	\$210.00	\$210.00	\$1,800.00	\$1,800.00	\$1,020.00	\$1,020.00	\$1,800.00	\$1,800.00
8	Limestone Wall Removal	1	LS	\$2,000.00	\$2,000.00	\$1,500.00	\$1,500.00	\$3,050.00	\$3,050.00	\$1,225.00	\$1,225.00	\$3,050.00	\$3,050.00
9	Pavement Removal	3900	SY	\$8.00	\$31,200.00	\$7.20	\$28,080.00	\$8.00	\$31,200.00	\$9.25	\$36,075.00	\$8.00	\$31,200.00
10	Driveway Removal	1550	SY	\$7.00	\$10,850.00	\$6.60	\$10,230.00	\$8.00	\$12,400.00	\$7.15	\$11,082.50	\$8.00	\$12,400.00
11	Sidewalk Removal	855	SY	\$6.00	\$5,130.00	\$5.50	\$4,702.50	\$5.40	\$4,617.00	\$7.15	\$6,113.25	\$5.40	\$4,617.00
12	Subgrade Preparation	6940	SY	\$2.00	\$13,880.00	\$2.50	\$17,350.00	\$4.30	\$29,842.00	\$2.80	\$19,432.00	\$4.30	\$29,842.00
13	Modified Subbase	2350	CY	\$35.00	\$82,250.00	\$44.50	\$104,575.00	\$39.00	\$91,650.00	\$35.75	\$84,012.50	\$39.00	\$91,650.00
14	Sanitary Sewer, 8"	193	LF	\$40.00	\$7,720.00	\$86.00	\$16,596.00	\$70.00	\$13,510.00	\$71.50	\$13,799.50	\$70.00	\$13,510.00
15	Sewer Service Relocation	3	EACH	\$2,500.00	\$7,500.00	\$105.00	\$315.00	\$55.00	\$165.00	\$56.00	\$168.00	\$55.00	\$165.00
16	Storm Sewer, 15" RCP	259	LF	\$60.00	\$15,540.00	\$105.00	\$27,195.00	\$27.00	\$7,005.00	\$27.00	\$7,005.00	\$27.00	\$7,005.00
17	Subdrain, Longitudinal, 4"	3065	LF	\$10.00	\$30,650.00	\$13.00	\$39,845.00	\$9.75	\$29,883.75	\$11.25	\$34,481.25	\$9.75	\$29,883.75
18	Subdrain, Outlet, 6"	6	EACH	\$350.00	\$2,100.00	\$376.00	\$2,256.00	\$360.00	\$2,160.00	\$410.00	\$2,460.00	\$360.00	\$2,160.00
19	Water Service Check Depth	1	EACH	\$500.00	\$500.00	\$653.00	\$653.00	\$3,150.00	\$3,150.00	\$510.00	\$510.00	\$3,150.00	\$3,150.00
20	Water Service Lowered with New Copper	4	EACH	\$2,500.00	\$10,000.00	\$1,325.00	\$5,300.00	\$1,900.00	\$7,600.00	\$2,040.00	\$8,160.00	\$1,900.00	\$7,600.00
21	Manhole, Sanitary, Type A	1	EACH	\$3,500.00	\$3,500.00	\$3,349.00	\$3,349.00	\$2,850.00	\$2,850.00	\$3,570.00	\$3,570.00	\$2,850.00	\$2,850.00
22	Manhole, Major Adjustment	4	EACH	\$2,000.00	\$8,000.00	\$1,235.00	\$4,940.00	\$1,325.00	\$5,300.00	\$1,735.00	\$6,940.00	\$1,325.00	\$5,300.00
23	Chimney Seal	4	EACH	\$750.00	\$3,000.00	\$315.00	\$1,260.00	\$700.00	\$2,800.00	\$1,020.00	\$4,080.00	\$700.00	\$2,800.00
24	Sewer, Removal	110	LF	\$15.00	\$1,650.00	\$22.00	\$2,420.00	\$23.50	\$2,585.00	\$20.50	\$2,255.00	\$23.50	\$2,585.00
25	Intake, Type M-D	1	EACH	\$3,500.00	\$3,500.00	\$4,686.00	\$4,686.00	\$4,500.00	\$4,500.00	\$4,080.00	\$4,080.00	\$4,500.00	\$4,500.00
26	Intake, Type M-E	1	EACH	\$4,500.00	\$4,500.00	\$6,262.00	\$6,262.00	\$5,325.00	\$5,325.00	\$4,080.00	\$4,080.00	\$5,325.00	\$5,325.00
27	Type B Casting	4	EACH	\$450.00	\$1,800.00	\$540.00	\$2,160.00	\$590.00	\$2,360.00	\$410.00	\$1,640.00	\$590.00	\$2,360.00
28	PCC Pavement, C I C I 3, 8"	305	SY	\$45.00	\$13,725.00	\$42.50	\$12,962.50	\$43.60	\$13,298.00	\$49.75	\$15,173.75	\$43.60	\$13,298.00
29	PCC Pavement, C I C I 3, 10"	6000	SY	\$50.00	\$300,000.00	\$46.00	\$276,000.00	\$47.15	\$282,900.00	\$54.00	\$324,000.00	\$47.15	\$282,900.00
30	Curb and Gutter, Remove and Replace, PCC, 24"	60	LF	\$35.00	\$2,100.00	\$30.00	\$1,800.00	\$42.75	\$2,565.00	\$46.55	\$2,793.00	\$42.75	\$2,565.00
31	Driveway Surfacing, HMA Millings	500	TON	\$15.00	\$7,500.00	\$15.00	\$7,500.00	\$36.50	\$18,250.00	\$29.00	\$14,500.00	\$36.50	\$18,250.00
32	Driveway, PCC, 7"	1500	SY	\$35.00	\$52,500.00	\$32.00	\$48,000.00	\$33.00	\$49,500.00	\$35.00	\$52,500.00	\$33.00	\$49,500.00
33	Sidewalk, PCC, 4"	1400	SY	\$30.00	\$42,000.00	\$25.00	\$35,000.00	\$25.75	\$36,050.00	\$29.00	\$40,600.00	\$25.75	\$36,050.00
34	Handicapped Ramps, W/Truncated Domes	48	SY	\$75.00	\$3,600.00	\$72.00	\$3,456.00	\$74.15	\$3,559.20	\$205.00	\$9,840.00	\$74.15	\$3,559.20
35	Painted Pavement Markings	51	STA	\$50.00	\$2,550.00	\$62.70	\$3,197.70	\$64.25	\$3,276.75	\$64.00	\$3,264.00	\$64.25	\$3,276.75
36	Painted Symbol and Legend	10	EACH	\$100.00	\$1,000.00	\$80.00	\$800.00	\$82.00	\$820.00	\$81.50	\$815.00	\$82.00	\$820.00
37	Sodding	900	SQ	\$30.00	\$27,000.00	\$31.00	\$27,900.00	\$32.55	\$29,295.00	\$33.50	\$30,150.00	\$32.55	\$29,295.00
38	Watering, Sod	540	M GAL	\$30.00	\$16,200.00	\$9.30	\$5,022.00	\$9.75	\$5,265.00	\$10.25	\$5,535.00	\$9.75	\$5,265.00
39	Traffic Control	1	LS	\$10,000.00	\$10,000.00	\$3,500.00	\$3,500.00	\$3,675.00	\$3,675.00	\$9,945.00	\$9,945.00	\$3,675.00	\$3,675.00
40	Traffic Signalization	1	LS	\$110,000.00	\$110,000.00	\$107,286.37	\$107,286.37	\$110,000.00	\$110,000.00	\$109,500.00	\$109,500.00	\$110,000.00	\$110,000.00
41	Project Sign Small - Standard	1	EACH	\$500.00	\$500.00	\$175.00	\$175.00	\$192.50	\$192.50	\$205.00	\$205.00	\$192.50	\$192.50

42

ITEM	DESCRIPTION	QUANTITY	UNIT PRICE		AMOUNT		UNIT PRICE		AMOUNT	
			PRICE	AMOUNT	PRICE	AMOUNT	PRICE	AMOUNT		
42	Inlet Filter, Type 1	2 EACH	\$100.00	\$200.00	\$75.00	\$150.00	\$76.85	\$153.70	\$81.50	\$163.00
43	Silt Fence	2000 LF	\$2.00	\$4,000.00	\$1.75	\$3,500.00	\$1.80	\$3,600.00	\$1.75	\$3,500.00
44	Mulching	1 Acre	\$800.00	\$800.00	\$1,200.00	\$1,200.00	\$1,230.00	\$1,230.00	\$510.00	\$510.00
45	Erosion Control	1 LS	\$3,000.00	\$3,000.00	\$2,200.00	\$2,200.00	\$3,505.00	\$3,505.00	\$3,060.00	\$3,060.00
46	Remove & Relocate Chain Link Fence	140 LF	\$30.00	\$4,200.00	\$15.00	\$2,100.00	\$16.50	\$2,310.00	\$7.85	\$1,099.00
47	Modular Wall	1900 SF	\$35.00	\$66,500.00	\$11.00	\$20,900.00	\$11.30	\$21,470.00	\$18.25	\$34,675.00
48	PCC Footing for Modular Wall	2 EACH	\$2,000.00	\$4,000.00	\$2,600.00	\$5,200.00	\$2,665.00	\$5,330.00	\$3,340.00	\$6,680.00
49	Tree Well	3 EACH	\$1,000.00	\$3,000.00	\$1,000.00	\$3,000.00	\$1,640.00	\$4,920.00	\$2,450.00	\$7,350.00
50	Water Main, 12" Dia. PVC	821 LF	\$70.00	\$57,470.00	\$70.00	\$57,470.00	\$36.50	\$29,966.50	\$61.25	\$50,286.25
51	Water Main, 8" Dia. PVC	576 LF	\$50.00	\$28,800.00	\$77.00	\$44,362.00	\$28.70	\$16,531.20	\$56.15	\$32,342.40
52	12" Gate Valve and Valve Box	3 EACH	\$4,000.00	\$12,000.00	\$1,836.00	\$5,508.00	\$1,992.00	\$5,976.00	\$3,570.00	\$10,710.00
53	8" Gate Valve and Valve Box	5 EACH	\$2,000.00	\$10,000.00	\$1,086.00	\$5,430.00	\$1,282.00	\$6,410.00	\$1,530.00	\$7,650.00
54	8" Bends	5 EACH	\$900.00	\$4,500.00	\$303.00	\$1,515.00	\$328.00	\$1,640.00	\$1,020.00	\$5,100.00
55	12" x 12" Tee	2 EACH	\$2,750.00	\$5,500.00	\$585.00	\$1,170.00	\$830.00	\$1,660.00	\$3,060.00	\$6,120.00
56	12" x 8" Tee	1 EACH	\$2,500.00	\$2,500.00	\$508.00	\$508.00	\$915.00	\$915.00	\$2,550.00	\$2,550.00
57	12" x 8" Reducer	2 EACH	\$1,000.00	\$2,000.00	\$535.00	\$1,070.00	\$390.00	\$780.00	\$1,530.00	\$3,060.00
58	12" Solid Sleeve	1 EACH	\$400.00	\$400.00	\$419.00	\$419.00	\$584.00	\$584.00	\$510.00	\$510.00
59	8" Solid Sleeve	3 EACH	\$300.00	\$900.00	\$542.00	\$1,626.00	\$355.00	\$1,065.00	\$510.00	\$1,530.00
60	8" Cap or Plug	1 EACH	\$90.00	\$90.00	\$451.00	\$451.00	\$295.00	\$295.00	\$205.00	\$205.00
61	12" Cap or Plug	2 EACH	\$100.00	\$200.00	\$501.00	\$1,002.00	\$334.00	\$668.00	\$205.00	\$410.00
62	Fire Hydrant Assembly	4 EACH	\$3,500.00	\$14,000.00	\$3,631.00	\$14,524.00	\$3,700.00	\$14,800.00	\$4,080.00	\$16,320.00
63	1" Water Service Line with New Stop Box, Same Side	12 EACH	\$1,200.00	\$14,400.00	\$1,490.00	\$17,880.00	\$1,430.00	\$17,160.00	\$1,530.00	\$18,360.00
64	1" Water Service Line with New Stop Box, Opposite Side	6 EACH	\$3,000.00	\$18,000.00	\$2,914.00	\$17,484.00	\$3,250.00	\$19,500.00	\$3,570.00	\$21,420.00
65	2" Water Service Line with New Stop Box, Same Side	1 EACH	\$3,000.00	\$3,000.00	\$2,748.00	\$2,748.00	\$2,910.00	\$2,910.00	\$3,060.00	\$3,060.00
66	2" Water Service Line with New Stop Box, Opposite Side	1 EACH	\$4,000.00	\$4,000.00	\$4,469.00	\$4,469.00	\$4,870.00	\$4,870.00	\$3,060.00	\$3,060.00
67	1" Water Service Line with New Stop Box & Meter Pit, Same Side	2 EACH	\$4,500.00	\$9,000.00	\$7,995.00	\$15,990.00	\$3,735.00	\$7,470.00	\$1,530.00	\$3,060.00
68	Foundation Rock	75 TON	\$25.00	\$1,875.00	\$25.00	\$1,875.00	\$37.15	\$2,786.25	\$30.50	\$2,287.50
				\$1,339,610.00		\$1,230,758.07		\$1,310,719.85		\$1,360,205.80
										+1.54%
										-2.16%
										-8.13%
TOTAL CONSTRUCTION COST				\$1,339,610.00		\$1,230,758.07		\$1,310,719.85		\$1,360,205.80
PERCENT OF ENGINEER'S ESTIMATE										+1.54%