

DATE April 11, 2011

**ACCEPTING COMPLETED CONSTRUCTION AND APPROVING FINAL PAYMENT FOR 2009 SEWER REPAIR CONTRACT 1, VAN HAUEN & ASSOCIATES, INC.**

BE IT RESOLVED BY THE CITY COUNCIL OF THE CITY OF DES MOINES, IOWA: That the attached report of the Jurisdictional Engineer, showing the cost of the construction of the 2009 Sewer Repair Contract 1, 08-2009-021, in accordance with the contract approved between Van Hauen & Associates, Inc., Brian Tancos, President, 1205 SW 37th Street, Grimes, IA 50111, under Roll Call No. 09-1501, of August 10, 2009, and the City of Des Moines, and recommending the acceptance thereof, be and the same is hereby approved, and accepted, and

BE IT FURTHER RESOLVED: That \$1,101,507.69 is the total cost, of which \$1,044,722.31 has been paid the Contractor, and \$1,710.00 is now due and is hereby approved as final partial payment for the above project, the remaining balance of \$55,075.38 is to be paid at the end of thirty days, with funds retained for unresolved claims on file in accordance with Iowa Code Chapter 573.

BE IT FURTHER RESOLVED: That the Des Moines Finance Director be and is hereby authorized to release said retainage if suit is not filed as above provided.

Moved by \_\_\_\_\_ to adopt.

FORM APPROVED:

\_\_\_\_\_  
Kathleen Vanderpool  
Deputy City Attorney

FUNDS AVAILABLE

\_\_\_\_\_  
Scott E. Sanders  
Des Moines Finance Director

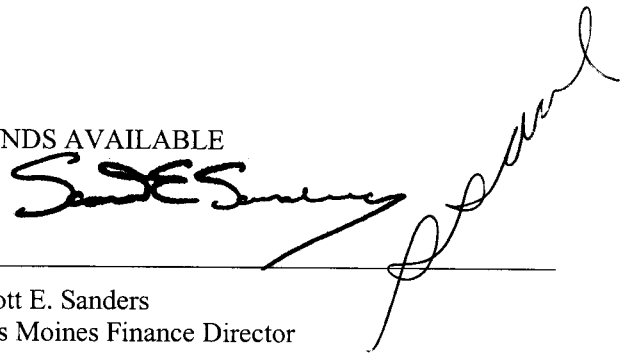

- JB* Funding Source: 2011-2012 CIP, Page Storm-4, City-wide Storm Water Utility Projects, STE057, Being: This project is repair of infrastructure damaged during the 2008 Iowa Disaster and is partially eligible under Disaster Number: FEMA-1763-DR-IA which is the Disaster Declaration for Public Assistance. Funding is as follows:
- \$210,773.49 in Sanitary Sewer Funds from City-wide Sanitary Sewers, Page Sanitary-7, SAE054, for all sanitary sewer repairs,
  - \$271,066 in FEMA eligible construction cost from 2011-2012 Operating Budget, 2008 Storms Mitigation/Recovery, OPR178, being 90% FEMA (\$243,959.40) and 10% Iowa State Emergency Funds (\$27,106.60),
  - the remaining \$619,668.20 in Storm Water Utility Funds from City-wide Storm Sewers, Page Storm-4, STE057.

Disaster Number: FEMA-1763-DR-IA



**Roll Call Number**

**Agenda Item Number**

14

DATE April 11, 2011

COUNCIL ACTION	YEAS	NAYS	PASS	ABSENT
COWNIE				
COLEMAN				
GRIESS				
HENSLEY				
MAHAFFEY				
MEYER				
MOORE				
TOTAL				
MOTION CARRIED			APPROVED	
_____ Mayor				

**CERTIFICATE**

I, DIANE RAUH, City Clerk of said City hereby certify that at a meeting of the City Council of said City of Des Moines, held on the above date, among other proceedings the above was adopted.

IN WITNESS WHEREOF, I have hereunto set my hand and affixed my seal the day and year first above written.

\_\_\_\_\_  
City Clerk

14

2162 16TH STREET

2400 HICKMAN

1543 17TH STREET

3900 MAQUOKETA DRIVE

BROADLAWN'S HOSPITAL

DRAKE UNIVERSITY

EVELYN DAVIS PARK

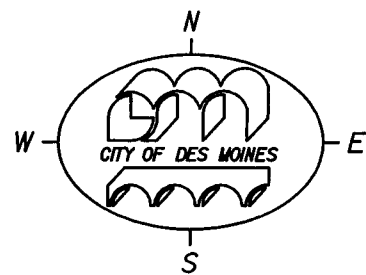

2009 SEWER REPAIR CONTRACT 1  
 ACTIVITY I.D. 08-2009-021  
 PAGE 1 OF 4

Tr\ENGG\Design\08\2009\021\Drawings\Loc\_Map\LOC\_Map.DGN 06-JUL-2009 10:14

14

1500 TUTTLE STREET

3700 RIVER OAKS DRIVE

620 GLENVIEW DRIVE

TR\ENGL\Design\08\2009\021\Drawings\Loc\_Map\LOC\_MAP 2.DGN 06-JUL-2009 16:15

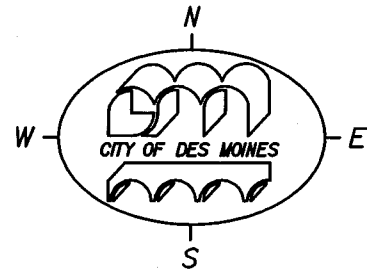
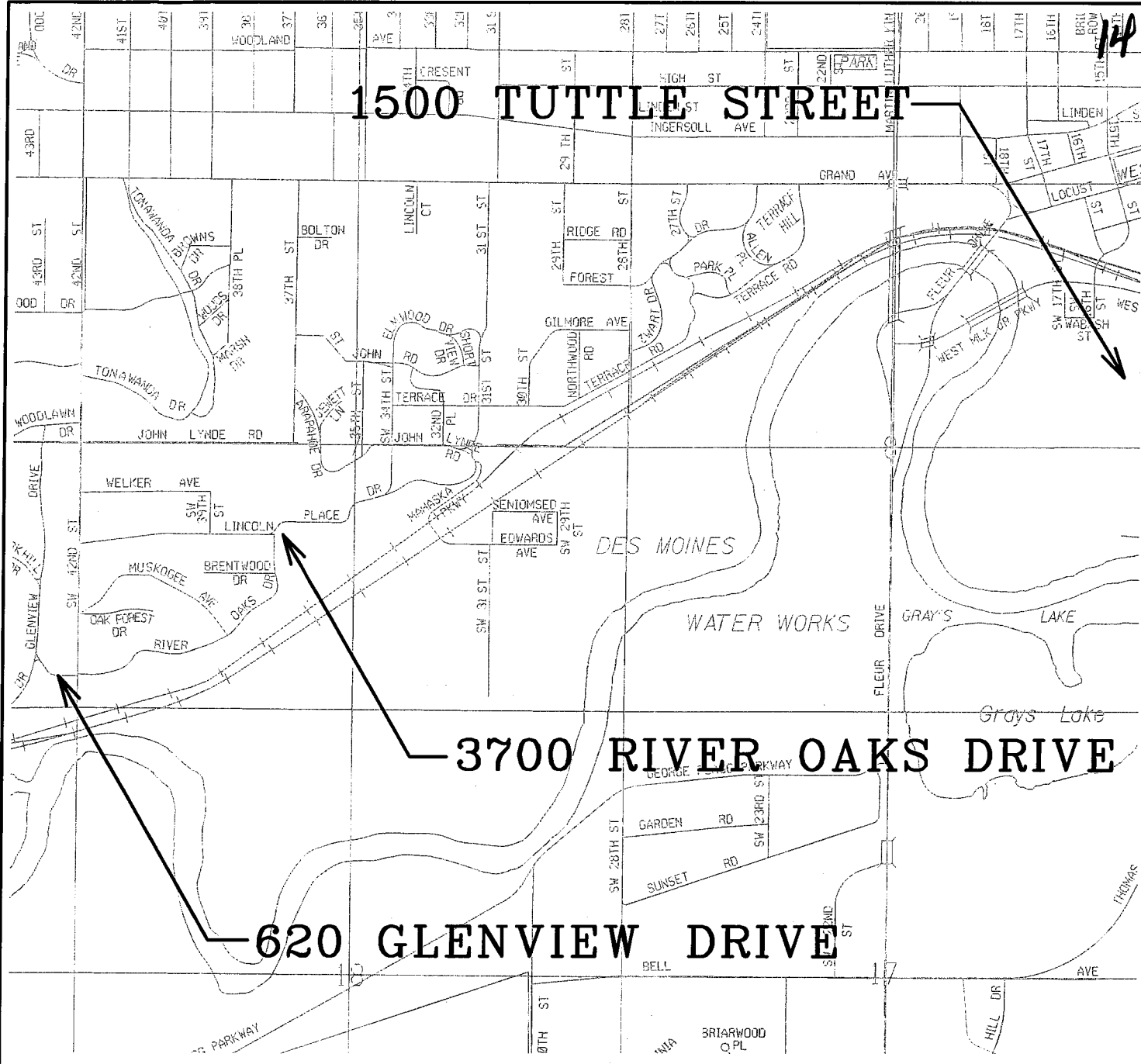

2009 SEWER REPAIR CONTRACT 1  
 ACTIVITY I.D. 08-2009-021  
 PAGE 2 OF 4

3224 SE 4TH COURT

822 E MCKINLEY AVENUE

Tr:\ENG\Design\08\2009\021\Drawings\Loc\_Map\Map 3.DGN 06-JUL-2009 10:15

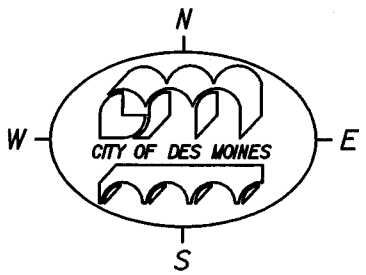
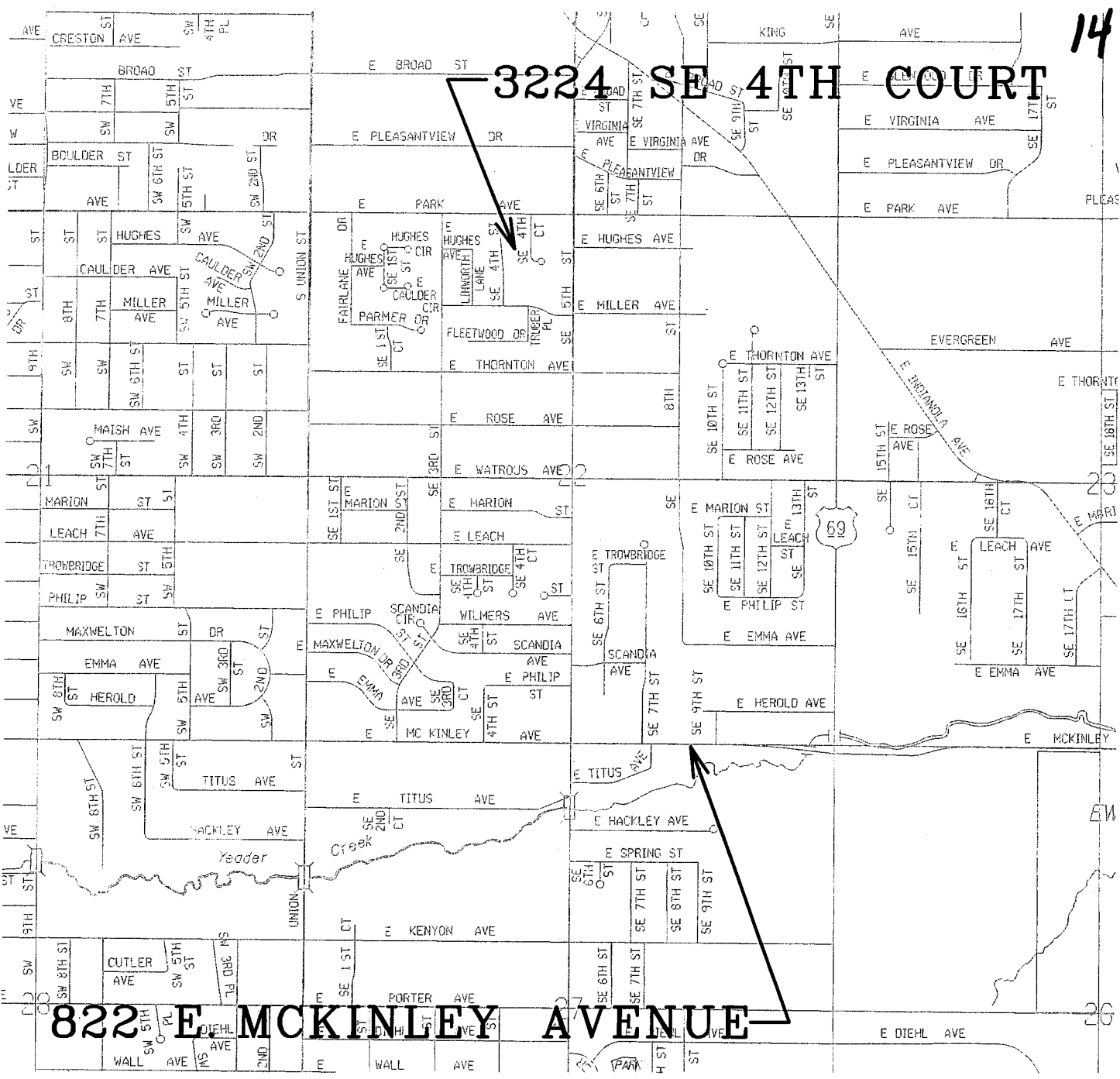

**2009 SEWER REPAIR CONTRACT 1**  
**ACTIVITY I.D. 08-2009-021**  
**PAGE 3 OF 4**

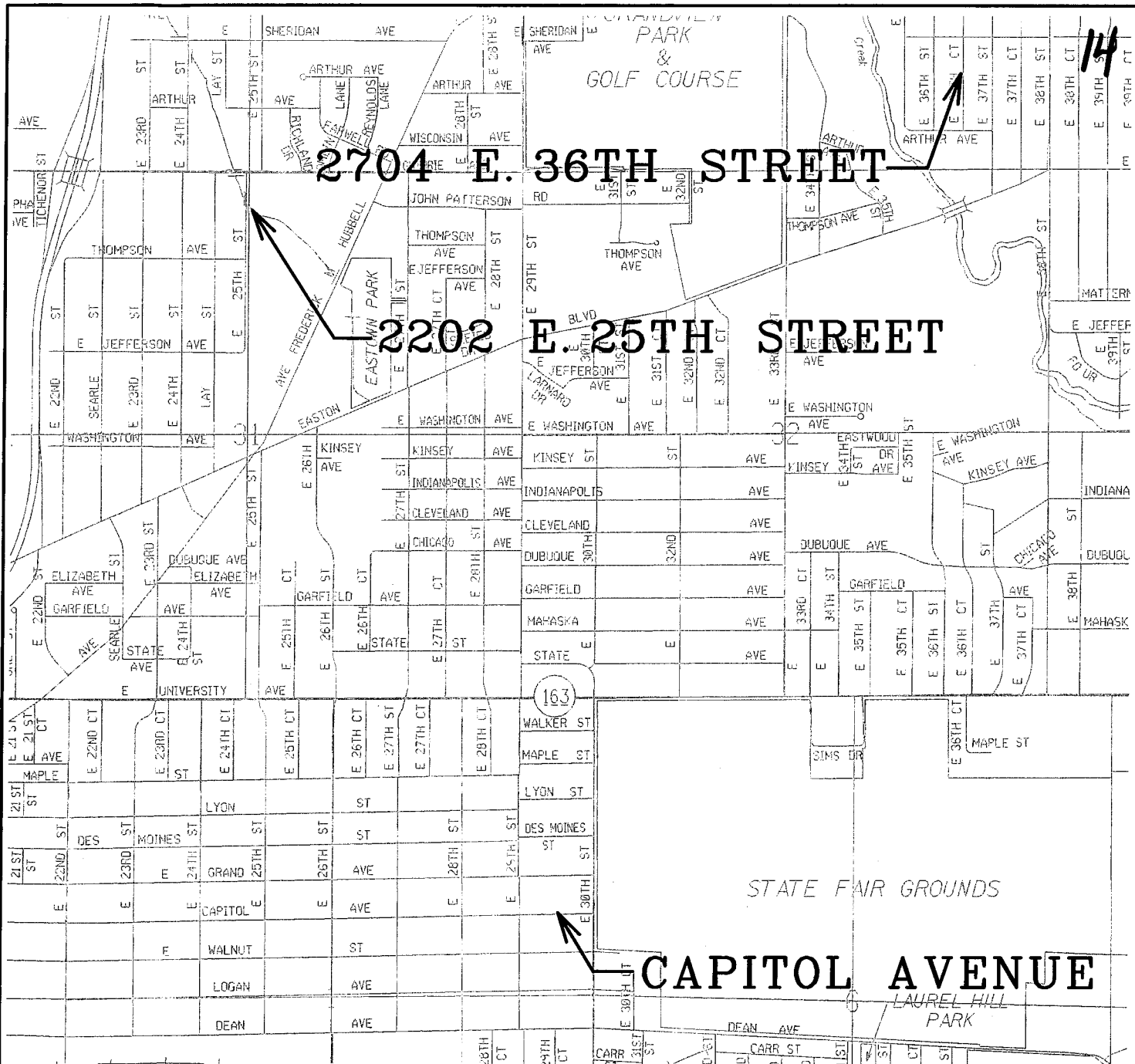

14

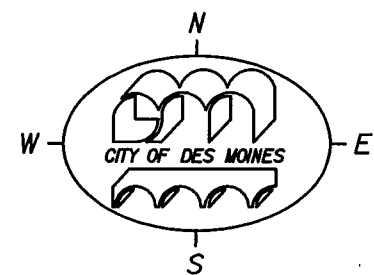

**2009 SEWER REPAIR CONTRACT 1**  
**ACTIVITY I.D. 08-2009-021**  
**PAGE 4 OF 4**

# PROJECT SUMMARY

## 2009 Sewer Repair Contract 1 Activity ID 08-2009-021

On August 10, 2009 under Roll Call No. 09-1500 the City Council awarded the contract for the above improvement to Van Hauen & Associates, Inc. in the amount of \$967,091.80 for construction of storm sewers, manholes, intakes, gabion basket walls, cable concrete overflows, restoration of pavement & landscaping, and other incidental items.

Tabulated below is a history of project change orders.

<u>Change Order No.</u>	<u>Description</u>	<u>Initiated By</u>	<u>Amount</u>
1	10/26/2009 Rebuild manhole to tie in 24" RCP on 16th St and replace air release valve.	Engineering	\$10,225.00
2	10/29/2009 Sewer Repair in front of 2911 Capitol Avenue	User	\$18,442.25
3	11/3/2009 Street patch and replacement of driveway at Capitol Avenue location.	User	\$16,359.50
4	11/16/2009 Repair clay tile @ Sta. 15+95 & relocate water service @ 2927 Capitol Ave	User	\$21,052.25
5	11/19/2009 Grading at Glenview Avenue, repair sink hole at 2919 Capitol Avenue, and install detour sign at 26th St & Hickman Rd.	User	\$17,563.90
6	11/30/2009 Install footing drain collector @ 411 E. Marion Street.	User	\$15,090.00
7	12/7/2009 Repair sanitary sewer drop connection at manhole in intersection of SE 8th Street & Park Avenue.	User	\$21,291.97

<u>Change Order No.</u>	<u>Description</u>	<u>Initiated By</u>	<u>Amount</u>
8	12/21/2009 Street Patch @ SE 8th Street & Park Avenue and repair of storm sewer joint downstream of structure BPF143	User	\$9,971.32
9	1/19/2010 Addition of 3" Clean Stabilization Stone for under culvert at River Oaks location and change in material used for street patch at 27th Street location.	Contractor	\$4,906.25
10	5/13/2010 Creek Realignment east of SW 9th Street between County Line Road and US Highway 5.	Engineering	\$8,746.00
11	7/8/2010 Regrade around area intake and move broken concrete from creek bottom at River Oaks Drive location & curb grinding at Capitol Avenue location.	User	\$2,840.00
12	12/6/2010 Adjust contract quantities to as-built quantities, sodding and restoration repairs, and sinkhole repairs along the Des Moines River @ Principal Park.	Engineering	(\$13,872.55)
13	3/14/2011 Additional 3 LF of installed length of 6' x 6' RCB at River Oaks Drive location.	Engineering	\$1,800.00
<b>Original Contract Amount</b>			\$967,091.80
<b>Total Change Orders</b>			\$134,415.89
<b>Percent of Change Orders to Original Contract</b>			13.90%
<b>Final Contract Amount</b>			\$1,101,507.69



April 11, 2011

**CERTIFICATION OF COMPLETION**

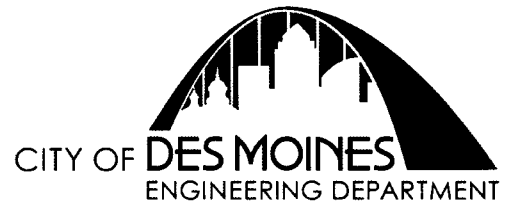

**AGENDA HEADING:**

Accepting completed construction and approving final payment for the 2009 Sewer Repair Contract 1, Van Hauen & Associates, Inc..

**SYNOPSIS:**

Approve the Jurisdictional Engineer's Certification of Completion, accept construction of said improvement, and authorize final payment to the contractor.

**FISCAL IMPACT:**

Amount: \$1,101,507.69 As-Built Contract Cost

Funding Source: 2011-2012 CIP, Page Storm-4, City-wide Storm Water Utility Projects, STE057, Being: This project is repair of infrastructure damaged during the 2008 Iowa Disaster and is partially eligible under Disaster Number: FEMA-1763-DR-IA which is the Disaster Declaration for Public Assistance. Funding is as follows:

- \$210,773.49 in Sanitary Sewer Funds from City-wide Sanitary Sewers, Page Sanitary-7, SAE054, for all sanitary sewer repairs,
- \$271,066 in FEMA eligible construction cost from 2011-2012 Operating Budget, 2008 Storms Mitigation/Recovery, OPR178, being 90% FEMA (\$243,959.40) and 10% Iowa State Emergency Funds (\$27,106.60),
- the remaining \$619,668.20 in Storm Water Utility Funds from City-wide Storm Sewers, Page Storm-4, STE057.

**CERTIFICATION OF COMPLETION:**

On August 10, 2009, under Roll Call No. 09-1501, the City Council awarded a contract to Van Hauen & Associates, Inc., Brian Tancos, President, 1205 SW 37th Street, Grimes, IA 50111 for the construction of the following improvement:

2009 Sewer Repair Contract 1, 08-2009-021

The improvement includes construction of new storm and sanitary sewers to repair deteriorated infrastructure at 12 various locations in Des Moines, Iowa, being: 620 Glenview Drive, 3700 River Oaks Drive, 2400 Hickman Road, 2162 16th Street, 3900 Maquoketa Drive, 1543 27th Street, 1500 Tuttle Street, 3224 SE 4th Court, 822 E. McKinley Avenue, 2202 E. 25th Street, 2704 E. 36th Street, and 2927 Capitol Avenue. Most of these locations were damaged during the Floods of 2008 and include partial FEMA funding. This contract includes construction of sanitary sewers, storm sewers, manholes, intakes, gabion basket walls, cable concrete overflows, restoration of pavement & landscaping, and other incidental items; in accordance with the contract documents including Plan File Nos. 493-113/174

I hereby certify that the construction of said 2009 Sewer Repair Contract 1, Activity ID 08-2009-021, has been completed in substantial compliance with the terms of said contract, and I hereby recommend that the work be accepted. The work commenced on August 24, 2009, and was completed on April 1, 2011.

I further certify that \$1,101,507.69 is the total cost of said improvement, of which \$1,044,722.31 has been paid the Contractor and \$1,710.00 is now due and is hereby approved as final partial payment for the above project, the remaining balance of \$55,075.38 is to be paid at the end of thirty days, with funds retained for unresolved claims on file in accordance with Iowa Code Chapter 573. The amount of completed work is shown on the attached Estimate of Construction Completed.

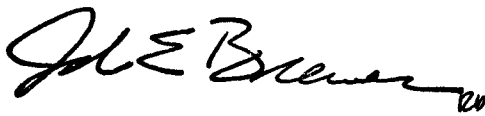
A handwritten signature in black ink that reads "Jeb E. Brewer" followed by a flourish and the year "20".

Jeb E. Brewer, P.E.  
Des Moines City Engineer

ENGINEERING DEPARTMENT  
CITY OF DES MOINES, IOWA



**ESTIMATE OF CONSTRUCTION COMPLETED**  
FOR WORK DONE FROM 12/04/10 to 03/11/11  
**FINAL PAYMENT (PARTIAL PAYMENT NO. 11)**

**PROJECT: 2009 SEWER REPAIR CONTRACT 1**  
**CONTRACTOR: VAN HAUEN & ASSOCIATES**

**Activity ID: 08-2009-021**  
**Date: 03/17/11**

LINE NO.	DESCRIPTION	UNIT	UNITS				TOTAL AMOUNT
			ESTIMATED	AUTHORIZED	CONSTRUCTED TO DATE	UNIT PRICE	
1.01	Mobilization	LS	1.000	1.000	1.000	\$15,000.00	\$15,000.00
1.02	Construction Survey	LS	1.000	1.000	1.000	\$2,500.00	\$2,500.00
1.03	Erosion Control	LS	1.000	1.000	1.000	\$2,500.00	\$2,500.00
1.04	Traffic Control	LS	1.000	1.000	1.000	\$2,000.00	\$2,000.00
1.05	Project Sign "Small"	EACH	1.000	1.000	1.000	\$100.00	\$100.00
1.06	Clearing and Grubbing	ACRE	0.250	0.250	0.250	\$5,500.00	\$1,375.00
1.07	Topsoil, Strip, Salvage & Re-spread	CY	50.000	50.000	50.000	\$30.00	\$1,500.00
1.08	Class 10 Excavation, Roadway and Borrow	CY	500.000	500.000	500.000	\$15.00	\$7,500.00
1.09	Subgrade Preparation, 12" Depth	SY	500.000	228.260	228.260	\$5.00	\$1,141.30
1.10	Storm Sewer, 6"x6" RCB	LF	115.000	118.000	118.000	\$600.00	\$70,800.00
1.11	Storm Sewer, 6"x6' Flared Wing Headwall	EACH	1.000	1.000	1.000	\$28,000.00	\$28,000.00
1.12	Storm Sewer, 30" RCP, Class III	LF	80.000	22.000	22.000	\$100.00	\$2,200.00
1.13	Storm Sewer, 18" RCP, Class III	LF	30.000	18.000	18.000	\$60.00	\$1,080.00
1.14	Storm Sewer, Removal, 4'x7' RCB	LF	115.000	115.000	115.000	\$90.00	\$10,350.00
1.15	Storm Sewer, Removal, 30" RCP	LF	80.000	80.000	80.000	\$8.00	\$640.00
1.16	Storm Sewer, Removal, 18" RCP	LF	30.000	30.000	30.000	\$7.00	\$210.00
1.17	Storm Intake, Custom 8'x8'	EACH	1.000	1.000	1.000	\$32,000.00	\$32,000.00
1.18	Storm Intake, Type M-F (modified)	EACH	2.000	2.000	2.000	\$5,000.00	\$10,000.00
1.19	Storm Manhole, 60" M-A	EACH	1.000	1.000	1.000	\$5,000.00	\$5,000.00
1.20	Intake Removal	EACH	3.000	3.000	3.000	\$500.00	\$1,500.00
1.21	Pavement, 8" HMA, w/Integral PCC Curb & Gutter	SY	500.000	173.700	173.700	\$57.00	\$9,900.90
1.22	Pavement, Driveway, 6" HMA	SY	120.000	79.440	79.440	\$45.00	\$3,574.80
1.23	Pavement Removal	SY	500.000	266.310	266.310	\$7.00	\$1,864.17
1.24	Driveway Pavement, Removal	SY	120.000	79.440	79.440	\$5.00	\$397.20
1.25	Sodding	SQ	41.000	85.000	85.000	\$65.00	\$5,525.00
1.26	Pneumatic Seeding: Seeding, Fertilization and Mulching	SQ	90.000	33.000	33.000	\$45.00	\$1,485.00
1.27	Articulated Concrete Block	SF	3,500.000	2,033.000	2,033.000	\$10.00	\$20,330.00
1.28	Rip Rap, Class D	TON	250.000	164.210	164.210	\$45.00	\$7,389.45
1.29	Temporary Erosion Matting	SY	125.000	0.000	0.000	\$2.00	\$0.00

14

LINE NO.	DESCRIPTION	UNIT	UNITS			TOTAL AMOUNT
			ESTIMATED	AUTHORIZED	CONSTRUCTED TO DATE	
1.30	Shrub Plantings	EACH	60.000	60.000	60.000	\$1,500.00
2.01	Mobilization	LS	1.000	1.000	1.000	\$5,000.00
2.02	Construction Survey	LS	1.000	1.000	1.000	\$2,000.00
2.03	Erosion Control	LS	1.000	1.000	1.000	\$2,000.00
2.04	Traffic Control	LS	1.000	1.000	1.000	\$2,000.00
2.05	Project Sign "Small"	EACH	1.000	1.000	1.000	\$100.00
2.06	Clearing and Grubbing	ACRE	0.100	0.100	0.100	\$60,000.00
2.07	Topsoil Strip, Salvage, and Respread	CY	75.000	75.000	75.000	\$25.00
2.08	Class 10 Excavation, Roadway and Borrow	CY	350.000	350.000	350.000	\$15.00
2.09	Storm Sewer, 4'x5' RCB	LF	10.000	11.500	11.500	\$1,200.00
2.10	Storm Sewer, 4'x5' Wingwall	EACH	1.000	1.000	1.000	\$18,000.00
2.11	Storm Sewer Removal, 4'x5' RCB	LF	2.000	2.000	2.000	\$500.00
2.12	Storm Sewer Removal, 4'x5' Flared Wing Headwall	EACH	1.000	1.000	1.000	\$4,000.00
2.13	Connect to Existing Culvert	LS	1.000	1.000	1.000	\$3,500.00
2.14	Partial Curb Removal, PCC	LS	1.000	1.000	1.000	\$500.00
2.15	Sodding	SQ	5.000	8.820	8.820	\$65.00
2.16	Pneumatic Seeding: Seeding, Fertilization and Mulching	SQ	20.000	5.220	5.220	\$45.00
2.17	Articulated Concrete Block	SF	580.000	608.000	608.000	\$10.00
2.18	Rip Rap, Class B	TON	50.000	49.180	49.180	\$55.00
2.19	Rip Rap, Class D	TON	250.000	392.960	392.960	\$45.00
2.20	Shrub Plantings	EACH	90.000	32.000	32.000	\$25.00
2.21	Sheet Pile Wall Removal	LS	1.000	1.000	1.000	\$3,500.00
3.01	Mobilization	LS	1.000	1.000	1.000	\$5,000.00
3.02	Construction Survey	LS	1.000	1.000	1.000	\$2,500.00
3.03	Erosion Control	LS	1.000	1.000	1.000	\$1,500.00
3.04	Traffic Control	LS	1.000	1.000	1.000	\$2,000.00
3.05	Project Sign "Small"	EACH	1.000	1.000	1.000	\$100.00
3.06	Clearing and Grubbing	ACRE	0.350	0.350	0.350	\$5,000.00
3.07	Topsoil Strip, Salvage, and Respread	CY	100.000	100.000	100.000	\$25.00
3.08	Class 10 Excavation, Roadway and Borrow	CY	395.000	395.000	395.000	\$15.00
3.09	Storm Sewer, 4'x5' RCB	LF	25.000	25.000	25.000	\$800.00
3.10	Storm Sewer, 18" RCP, Class III	LF	10.000	11.000	11.000	\$65.00
3.11	Storm Sewer, 4'x5' Flared Wing Headwall	EACH	1.000	1.000	1.000	\$18,000.00
3.12	Sodding	SQ	15.000	14.040	14.040	\$65.00
3.13	Pneumatic Seeding: Seeding, Fertilization and Mulching	SQ	125.000	46.360	46.360	\$45.00
3.14	Fence, 4', Chain Link, Remove and Replace	LF	70.000	89.000	89.000	\$18.00
3.15	Rip Rap, Class D	TON	480.000	291.920	291.920	\$45.00
3.16	Gabions, Wall, PVC Coated	CY	115.000	158.000	158.000	\$100.00

LINE NO.	DESCRIPTION	UNIT	UNITS			TOTAL AMOUNT
			ESTIMATED	AUTHORIZED	CONSTRUCTED TO DATE	
4.01	Mobilization	LS	1.000	1.000	1.000	\$5,000.00
4.02	Traffic Control	LS	2.000	2.000	2.000	\$2,500.00
4.03	Construction Survey	LS	1.000	1.000	1.000	\$1,500.00
4.04	Erosion Control	LS	1.000	1.000	1.000	\$2,500.00
4.05	Project Sign "Small"	EACH	1.000	1.000	1.000	\$100.00
4.06	Clearing and Grubbing	ACRE	0.120	0.120	0.120	\$45,000.00
4.07	Topsoil Strip, Salvage, and Respread	CY	55.000	55.000	55.000	\$25.00
4.08	Class 10 Excavation, Roadway and Borrow	CY	100.000	100.000	100.000	\$15.00
4.09	Subgrade Preparation, 6" Depth	SY	10.000	14.530	14.530	\$3.00
4.10	Storm Sewer, 24" RCP Class III	LF	41.000	41.000	41.000	\$100.00
4.11	Storm Sewer Removal, 12" CMP	LF	43.000	43.000	43.000	\$5.00
4.12	Connect to Existing Manhole	LS	1.000	1.000	1.000	\$1,000.00
4.13	Storm Intake, Type M-F Modified	EACH	1.000	1.000	1.000	\$9,000.00
4.14	Intake Removal	EACH	1.000	1.000	1.000	\$500.00
4.15	Roadway Pavement, 8" PCC	SY	6.000	14.530	14.530	\$150.00
4.16	Roadway Pavement Removal, PCC with HMA Overlay	SY	6.000	14.530	14.530	\$2,179.50
4.17	Pneumatic Seeding: Seeding, Fertilization and Mulching	SQ	44.000	34.600	34.600	\$1,557.00
4.18	Articulated Concrete Block	SF	896.000	864.000	864.000	\$8,640.00
4.19	Cut and Cap Abandoned Gas Main	LS	1.000	1.000	1.000	\$500.00
4.20	Special Wood Fence (5 bar), Remove and Replace	LF	15.000	15.000	15.000	\$35.00
4.21	Special Wood Fence (1 bar), Remove and Replace	LF	105.000	101.000	101.000	\$15.00
4.22	Temporary Erosion Matting	SY	135.000	0.000	0.000	\$2.00
4.23	Shrub Plantings	EACH	84.000	84.000	84.000	\$25.00
4.24	Rip Rap, Class D	TON	100.000	102.210	102.210	\$4,599.45
5.01	Mobilization	LS	1.000	1.000	1.000	\$10,000.00
5.02	Construction Survey	LS	1.000	1.000	1.000	\$2,000.00
5.03	Erosion Control	LS	1.000	1.000	1.000	\$1,500.00
5.04	Traffic Control	LS	1.000	1.000	1.000	\$2,000.00
5.05	Project Sign "Small"	EACH	1.000	1.000	1.000	\$100.00
5.06	Clearing and Grubbing	ACRE	0.100	0.100	0.100	\$35,000.00
5.07	Topsoil Strip, Salvage, and Respread	CY	70.000	70.000	70.000	\$1,750.00
5.08	Sodding	SQ	20.000	25.100	25.100	\$1,631.50
5.09	Pneumatic Seeding: Seeding, Fertilization and Mulching	SQ	6.000	0.000	0.000	\$45.00
5.10	Red-Osier (Cornus Sericea) live stakes	EACH	40.000	40.000	40.000	\$2,000.00
5.11	Gabion Plantings, furnished and installed	LF	60.000	54.000	54.000	\$1,080.00
5.12	Fence, 4', Chain Link	LF	150.000	150.000	150.000	\$2,250.00
5.13	Wooden Fence, Remove and Replace, Special	LF	15.000	0.000	0.000	\$30.00
5.14	Rip Rap, Class B	TON	81.000	30.480	30.480	\$1,676.40

LINE NO.	DESCRIPTION	UNIT	UNITS				TOTAL AMOUNT
			ESTIMATED	AUTHORIZED	CONSTRUCTED TO DATE	UNIT PRICE	
5.15	Rip Rap, Class D	TON	73.440	30.090	30.090	\$45.00	\$1,354.05
5.16	Gabions, Wall, removal	LS	1.000	1.000	1.000	\$1,000.00	\$1,000.00
5.17	Gabions, Wall, PVC Coated	CY	207.000	207.000	207.000	\$120.00	\$24,840.00
5.18	Gabions, Mattress, PVC Coated, 1' thick	CY	34.000	34.000	34.000	\$120.00	\$4,080.00
6.01	Mobilization	LS	1.000	1.000	1.000	\$5,000.00	\$5,000.00
6.02	Construction Survey	LS	1.000	1.000	1.000	\$1,000.00	\$1,000.00
6.03	Erosion Control	LS	1.000	1.000	1.000	\$1,000.00	\$1,000.00
6.04	Traffic Control	LS	1.000	1.000	1.000	\$2,000.00	\$2,000.00
6.05	Project Sign "Small"	EACH	1.000	1.000	1.000	\$100.00	\$100.00
6.06	Clearing and Grubbing	ACRE	0.100	0.100	0.100	\$45,000.00	\$4,500.00
6.07	Topsoil Strip, Salvage, and Respread	CY	80.000	80.000	80.000	\$25.00	\$2,000.00
6.08	Class 10 Excavation, Roadway and Borrow	CY	1,500.000	1,500.000	1,500.000	\$15.00	\$22,500.00
6.09	Storm Sewer, 18" RCP, Class III	LF	60.000	60.000	60.000	\$80.00	\$4,800.00
6.10	Storm Sewer Removal, 12" VCP	LF	20.000	20.000	20.000	\$8.00	\$160.00
6.11	Storm Sewer Removal, 15" RCP	LF	40.000	40.000	40.000	\$8.00	\$320.00
6.12	Storm Intake, Type M-F Modified	EACH	1.000	1.000	1.000	\$5,000.00	\$5,000.00
6.13	Storm Intake, 5'x5', Type M-G	EACH	1.000	1.000	1.000	\$5,500.00	\$5,500.00
6.14	Roadway Pavement, 8" HMA	SY	15.000	0.000	0.000	\$60.00	\$0.00
6.15	Sidewalk Pavement, 4" PCC	SY	17.000	28.220	28.220	\$40.00	\$1,128.80
6.16	Sidewalk Pavement, 4" PCC w/Integral Sloped Curb	SY	90.000	61.940	61.940	\$50.00	\$3,097.00
6.17	Roadway Pavement Removal, HMA	SY	15.000	12.600	12.600	\$15.00	\$189.00
6.18	Sidewalk Pavement Removal, PCC	SY	88.000	77.780	77.780	\$10.00	\$777.80
6.19	Sodding	SQ	38.000	52.743	52.743	\$65.00	\$3,428.30
6.20	Pneumatic Seeding, Seeding, Fertilization and Mulching	SQ	22.000	14.140	14.140	\$45.00	\$636.30
6.21	Turf Reinforcement Mat	SY	230.000	157.110	157.110	\$8.00	\$1,256.88
6.22	Chain Link Fence, 9 ft High, PVC Coated, Black	LF	30.000	0.000	0.000	\$35.00	\$0.00
7.01	1500 Tuttle Street	LS	1.000	1.000	1.000	\$69,000.00	\$69,000.00
7.02	3224 SE 4th Court	LS	1.000	1.000	1.000	\$13,000.00	\$13,000.00
7.03	822 East McKinley Avenue	LS	1.000	1.000	1.000	\$67,000.00	\$67,000.00
7.04	2400 Hickman Road	LS	1.000	1.000	1.000	\$16,000.00	\$16,000.00
7.05	3900 Maquoketa Drive	LS	1.000	1.000	1.000	\$40,000.00	\$40,000.00
7.06	2927 Capitol Avenue	LS	1.000	1.000	1.000	\$85,000.00	\$85,000.00
4.25	Rebuild Manhole at 16th Street	LS	1.000	1.000	1.000	\$2,600.00	\$2,600.00
8.01	Replace Air Release Valve	LS	1.000	1.000	1.000	\$7,625.00	\$7,625.00
7.07	Sewer Repair in front of 2911 Capitol Avenue	LS	1.000	1.000	1.000	\$18,442.25	\$18,442.25
7.08	Street Patch in front of 2911 Capitol Avenue	LS	1.000	1.000	1.000	\$10,973.50	\$10,973.50
7.09	Replace Hotel Driveway	LS	1.000	1.000	1.000	\$5,386.00	\$5,386.00
7.10	Repair Clay Tile Line at Sta. 15+95	LS	1.000	1.000	1.000	\$19,080.50	\$19,080.50

LINE NO.	DESCRIPTION	UNIT	UNITS			TOTAL AMOUNT
			ESTIMATED	AUTHORIZED	CONSTRUCTED TO DATE	
7.11	Relocate Water Service at 2927 Capitol Avenue	LS		1.000	1.000	\$1,971.75
2.22	Excavate and Grade Drainage Ditch at Glenview	LS		1.000	1.000	\$6,900.00
7.12	Repair Sink Hole at 2919 Capitol Avenue	LS		1.000	1.000	\$10,546.20
7.13	Install Detour Sign at 26th St & Hickman Rd	LS		1.000	1.000	\$117.70
8.02	Footing Drain Collector @ 411 E. Marion St.	LS		1.000	1.000	\$15,090.00
8.03	Repair Sanitary Sewer Drop Connection	LS		1.000	1.000	\$21,291.97
8.04	Street Patch @ SE 8th Street & Park Avenue	LS		1.000	1.000	\$9,126.32
8.05	Repair Storm Sewer Joint Downstream of BPF143	LS		1.000	1.000	\$845.00
1.31	3" Clean Stabilization Stone	TON		156.650	156.650	\$25.00
6.23	Roadway Pavement, 8" PCC	SY		12.600	12.600	\$150.00
8.06	Creek Realignment @ SW 9th Street	LS		1.000	1.000	\$8,746.00
1.32	Regrade Around Area Intake	LS		1.000	1.000	\$90.00
1.33	Move Broken Concrete from Creek Bottom	LS		1.000	1.000	\$2,500.00
7.14	Curb Grinding	LS		1.000	1.000	\$250.00
1.34	Repair Sod and Erosion at 3717 Lincoln Place Dr	LS		1.000	1.000	\$3,855.00
8.07	Place Sod Along 13th Street @ Chautauqua Pkwy	LS		1.000	1.000	\$2,935.00
8.08	Repair Sod and Seed @ SW 9th Street	LS		1.000	1.000	\$1,240.00
8.09	Install Berm - SW Corner of 29th St & Forest Dr	LS		1.000	1.000	\$790.00
8.10	Repair of Overflow Pipe and Sinkhole	LS		1.000	1.000	\$21,080.00
8.11	Repair of Grit Structure and Sinkhole	LS		1.000	1.000	\$12,548.00

LINE NO.	DESCRIPTION	UNIT	UNITS		CONSTRUCTED TO DATE	UNIT PRICE	TOTAL AMOUNT
			ESTIMATED	AUTHORIZED			
	TOTAL CONTRACT AMOUNT PLUS CHANGE ORDERS		\$1,101,507.69				
	PARTIAL PAYMENT #1		\$179,643.92				
	PARTIAL PAYMENT #2		\$332,028.84				
	PARTIAL PAYMENT #3		\$242,359.30				
	PARTIAL PAYMENT #4		\$159,669.23				
	PARTIAL PAYMENT #5		\$14,988.69				
	PARTIAL PAYMENT #6		\$13,395.00				
	PARTIAL PAYMENT #7		\$30,484.54				
	PARTIAL PAYMENT #8		\$18,615.82				
	PARTIAL PAYMENT #9		\$9,057.02				
	PARTIAL PAYMENT #10		\$44,479.95				
	THIS PARTIAL PAYMENT		\$1,710.00				
	TOTAL PARTIAL PAYMENTS		\$1,046,432.31				
	BALANCE		\$55,075.38				
	TOTAL						\$1,101,507.69
	RETAINAGE						\$55,075.38
	TOTAL LESS RETAINAGE						\$1,046,432.31
	LESS PREVIOUS PAYMENT						\$1,044,722.31
	AMOUNT DUE						\$1,710.00

FINAL PAYMENT (PARTIAL PAYMENT NO. 11)

PREPARED BY: *Jacob L. Carter*  
 CHECKED BY: *Yang G. Decker*