



9A

DATE June 13, 2011

ORDERING CONSTRUCTION OF  
TONAWANDA DRIVE RAVINE IMPROVEMENTS  
AND FIXING A DATE FOR RECEIVING OF BIDS ON JUNE 28, 2011  
AND PUBLIC HEARING ON JULY 11, 2011  
ENGINEER'S ESTIMATE IS \$2,268,000.00

BE IT RESOLVED BY THE CITY COUNCIL OF THE CITY OF DES MOINES, IOWA: That the attached communication recommending construction of the following improvement and the method of financing; and also including the recommendation of the Des Moines City Engineer, as the Engineer, submitting plans, specifications, form of contract documents, and Engineer's estimate of cost for the construction of the following improvement:

Tonawanda Drive Ravine Improvements, 08-2011-002

I-JOBS #495

The improvement includes the stabilization of stream banks, construction of storm sewer, intakes, manholes, water mains, and curb and gutter, scarification and HMA overlay, seeding, sodding, and other incidental items; in accordance with the contract documents, including Plan File Nos. 532-150/214, located on Tonawanda Drive south of Grand Avenue, Des Moines Iowa

be and the same are hereby approved and accepted. The estimated construction cost for said improvement is \$2,268,000.00. The proposed plans, specifications, and form of contract documents are available for public inspection in the Des Moines City Engineer's Office.

BE IT FURTHER RESOLVED: That this Council hereby determines that it is necessary and advisable to construct said improvement in the manner set forth in the plans, specifications, and form of contract documents submitted by the Engineer; and that payment for the cost of said improvement shall be paid from the funding source identified below.

BE IT FURTHER RESOLVED: That a public hearing on said plans, specifications, form of contract documents, and Engineer's estimate of construction cost for said improvement be held in the City Council Chambers, 2nd Floor, City Hall, 400 Robert D. Ray Drive, Des Moines, Iowa, at 5:00 p.m. on July 11, 2011, at which time this Council will consider any objections offered thereto or to the making of said improvement.

BE IT FURTHER RESOLVED: That proposals will be received by the City of Des Moines, at the office of the Des Moines City Clerk until 11:00 a.m. on June 28, 2011, for the construction of said improvement, and the taking of bids in the manner required by law. Proposals received will be opened at a public meeting presided over by the Engineer in the City Council Chambers, 2nd Floor, City Hall, 400 Robert D. Ray Drive, Des Moines, Iowa, at 11:00 a.m. on June 28, 2011, after which the bids together with a bid tabulation and recommendation of the Engineer will be presented to the City Council at its next meeting for action thereon.

BE IT FURTHER RESOLVED: That the City Clerk is further directed to publish a Public Notice of Storm Water Discharge in the Des Moines Register and The Business Record as required by the Iowa Department of Natural Resources.



**Roll Call Number**

**Agenda Item Number**

9A

DATE June 13, 2011

BE IT FURTHER RESOLVED: That the City Manager be and is hereby authorized and directed to certify the "Notice of Intent for NPDES Coverage under General Permit No. 2 for Storm Water Discharges associated with Industrial Activity for Construction Activities" on behalf of the City of Des Moines and submit said document to the Iowa Department of Natural Resources with appropriate application and permit fees.

BE IT FURTHER RESOLVED: That an appropriate Notice to Bidders and Notice of Public Hearing for said improvement be published in the Des Moines Register as provided and directed by Chapter 26 and/or 314, Code of Iowa.

(City Council Communication Number 11-375 attached.)

Moved by \_\_\_\_\_ to adopt.

**FORM APPROVED:**

**FUNDS AVAILABLE**

Kathleen Vanderpool  
Deputy City Attorney

Scott E. Sanders  
Des Moines Finance Director

Funding Source: 2011-2012 CIP, Page Storm-17, Tonawanda Ravines, STE082, Being: \$748,036.10 Storm Water Utility Funds; \$700,000.00 in I-JOBS II Targeted Disaster Relief Grant funds (\$700,000 maximum); \$202,514 from STR003, Asphaltic Paving Restoration Program, Page Street-5 for Tonawanda Drive resurfacing; \$98,423 from SAE054, City-wide Sanitary Sewers, Page Sanitary-7 for sanitary sewer protection; \$119,026.90 from Des Moines Water Works; with a transfer of \$400,000 of Storm Water Utility Funds from Hamilton Drainage Area Improvements, STE133, Page Storm-11

COUNCIL ACTION	YEAS	NAYS	PASS	ABSENT
COWNIE				
COLEMAN				
GRIESS				
HENSLEY				
MAHAFFEY				
MEYER				
MOORE				
TOTAL				

**CERTIFICATE**

I, DIANE RAUH, City Clerk of said City hereby certify that at a meeting of the City Council of said City of Des Moines, held on the above date, among other proceedings the above was adopted.

IN WITNESS WHEREOF, I have hereunto set my hand and affixed my seal the day and year first above written.

\_\_\_\_\_  
Mayor

\_\_\_\_\_  
City Clerk

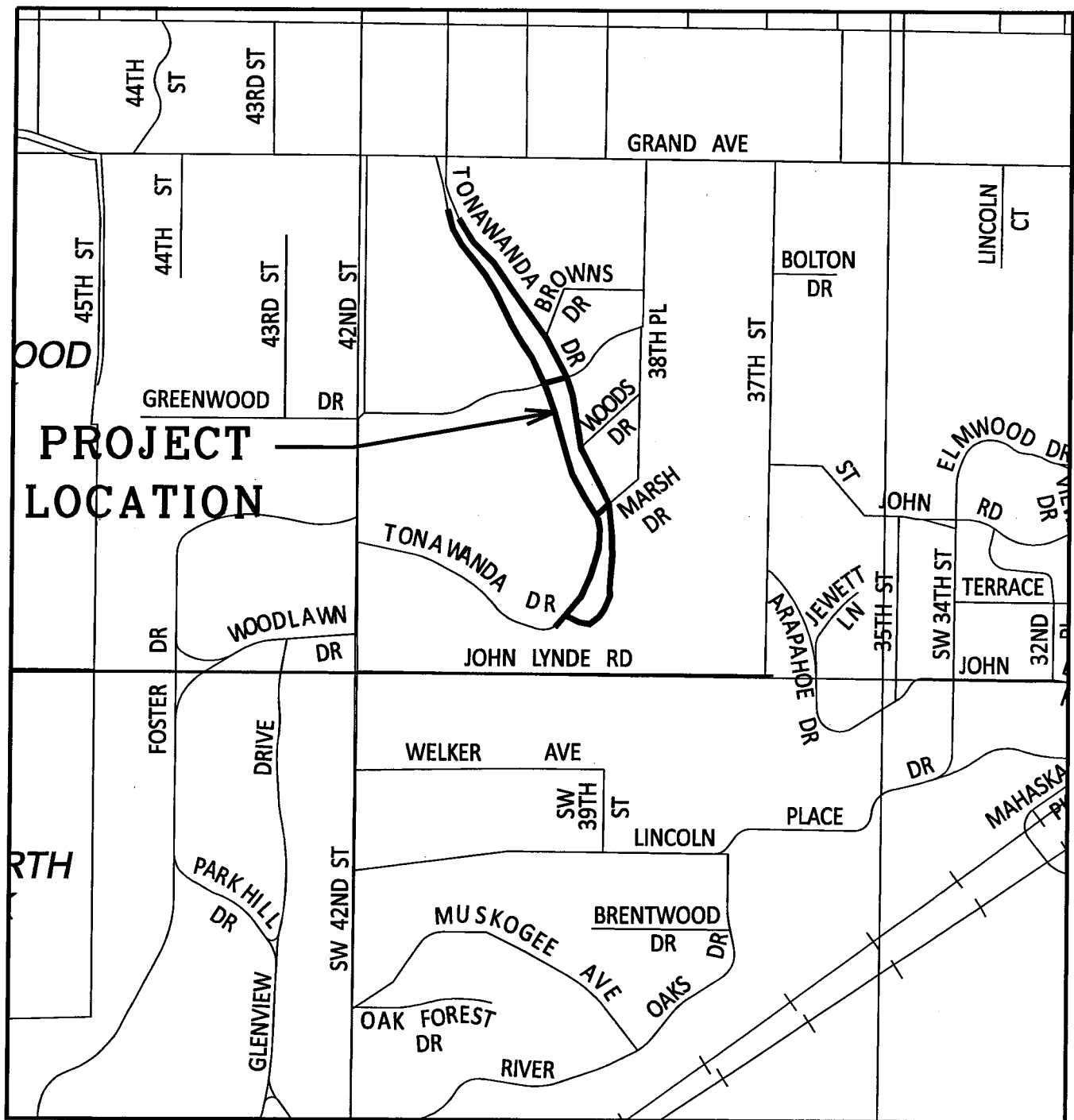

sf/le-dates

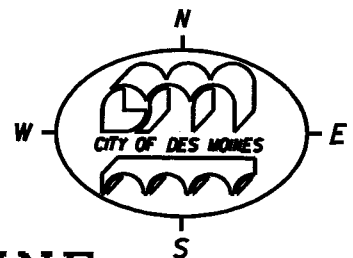

**TONAWANDA DRIVE RAVINE  
IMPROVEMENTS  
ACTIVITY I.D. 08-2011-002**

9A

# CONSTRUCTION ESTIMATE

DEPARTMENT OF ENGINEERING  
CITY OF DES MOINES, IOWA

Activity ID 08-2011-002  
Date: 05/27/11

## PROJECT: TONAWANDA DRIVE RAVINE IMPROVEMENTS

NO.	DESCRIPTION	ESTIMATED UNITS			AMOUNT
		UNIT	TOTAL	UNIT PRICE	TOTAL
<b>DIVISION 1 -GENERAL</b>					
1.1	* MOBILIZATION	LS	1	\$130,000.00	\$130,000.00
1.2	* CONSTRUCTION SURVEY	LS	1	\$18,000.00	\$18,000.00
1.3	* PROJECT SIGN LARGE - STANDARD	EA	1	\$1,456.00	\$1,456.00
1.4	* INTERPRETIVE SIGNS	EA	1	\$4,000.00	\$4,000.00
1.5	* EROSION CONTROL	LS	1	\$3,000.00	\$3,000.00
<b>DIVISION 2 -EARTHWORK</b>					
2.1	* CLEARING AND GRUBBING	LS	1	\$75,000.00	\$75,000.00
2.2	* COMPOST AMENDED TOPSOIL	CY	937	\$58.00	\$54,346.00
2.3	* CLASS 10 EXCAVATION	CY	1050	\$80.00	\$84,000.00
2.4	* SPECIAL FILL	CY	65	\$30.00	\$1,950.00
2.5	* SUBGRADE PREPARATION	SY	3922	\$7.50	\$29,415.00
2.6	* SUBGRADE TREATMENT, GEOTEXTILE	SY	2882	\$4.00	\$11,528.00
2.7	* GRANULAR SUBBASE, TYPE A	SY	3922	\$7.50	\$29,415.00
2.8	* REMOVAL OF GABIONS	CY	21	\$160.00	\$3,360.00
2.9	* REMOVE AND REPLACE RIPRAP	SY	141	\$35.00	\$4,935.00
2.10	* MISCELLANEOUS REMOVALS	LS	1	\$4,000.00	\$4,000.00
<b>DIVISION 4 -SEWERS &amp; DRAINS</b>					
4.1	* FILLING AND CAPPING OF KNOWN PIPES, VCP, 18 IN.	LF	65	\$26.00	\$1,690.00
4.2	* REMOVE AND REPLACE SANITARY SEWER, D.I.P., 12 IN.	LF	40	\$260.00	\$10,400.00
4.3	* REMOVAL OF STORM SEWER, PVC, 8 IN. AND VCP, 8 IN.	LF	65	\$30.00	\$1,950.00
4.4	* REMOVAL OF STORM SEWER, VCP, 10 IN.	LF	76	\$30.00	\$2,280.00
4.5	* REMOVAL OF STORM SEWER, VCP, 12 IN.	LF	8	\$30.00	\$240.00
4.6	* REMOVAL OF STORM SEWER, RCP, 15 IN.	LF	18	\$30.00	\$540.00

NO.	DESCRIPTION	ESTIMATED UNITS			AMOUNT
		UNIT	TOTAL	UNIT PRICE	TOTAL
4.7	* REMOVAL OF STORM SEWER, VCP, 18 IN.	LF	20	\$30.00	\$600.00
4.8	* REMOVAL OF STORM SEWER, RCP, 30 IN.	LF	82	\$30.00	\$2,460.00
4.9	* REMOVAL OF STORM SEWER, RCP, 42 IN.	LF	67	\$30.00	\$2,010.00
4.10	STORM SEWER PIPE, TRENCHED, 2000D (CLASS III), RCP, 15 IN.	LF	1083	\$110.00	\$119,130.00
4.11	STORM SEWER PIPE, TRENCHED, 2000D (CLASS III), RCP, 18 IN.	LF	16	\$150.00	\$2,400.00
4.12	STORM SEWER PIPE, TRENCHED, 2000D (CLASS III), RCP, 24 IN.	LF	120	\$120.00	\$14,400.00
4.13	STORM SEWER PIPE, TRENCHED, 2000D (CLASS III), RCP, 30 IN.	LF	12	\$210.00	\$2,520.00
4.14	STORM SEWER PIPE, TRENCHED, 2000D (CLASS III), RCP, 60 IN.	LF	68	\$340.00	\$23,120.00
4.15	STORM SEWER PIPE, TRENCHED, 2000D (CLASS III), RCP, 72 IN.	LF	70	\$550.00	\$38,500.00
4.16	STORM SEWER APRON, 2000 (CLASS III) RCP, 15 IN.	EA	17	\$1,200.00	\$20,400.00
4.17	STORM SEWER APRON, 2000 (CLASS III) RCP, 24 IN.	EA	1	\$1,460.00	\$1,460.00
4.18	STORM SEWER APRON, 2000 (CLASS III) RCP, 30 IN.	EA	1	\$1,550.00	\$1,550.00
4.19	STORM SEWER APRON, 2000 (CLASS III) RCP, 60 IN.	EA	2	\$2,300.00	\$4,600.00
4.20	STORM SEWER APRON, 2000 (CLASS III) RCP, 72 IN.	EA	2	\$5,750.00	\$11,500.00
4.21	SUBDRAIN, TYPE 1, CORRUGATED PVC, 6 IN.	LF	60	\$27.00	\$1,620.00
4.22	SUBDRAIN CLEANOUT, TYPE 1	EA	1	\$300.00	\$300.00
4.23	CMP SUBDRAIN OUTLET AND SUBDRAIN CONNECTIONS	EA	1	\$350.00	\$350.00
<b>DIVISION 5 - WATER MAINS AND APPURTENANCES</b>					
5.1	PREPARE EXCAVATION FOR TAPPING SLEEVE AND VALVE	LS	1	\$5,500.00	\$5,500.00
5.2	* FOUNDATION ROCK	TON	30	\$20.00	\$600.00
5.3	WATER MAIN, 8 IN. C-900 PVC PIPE, TRENCHED	LF	93	\$235.00	\$21,855.00
5.4	WATER MAIN, 8 IN. DIA., BEND	EA	5	\$340.00	\$1,700.00
5.5	WATER MAIN, 8 IN. DIA. CAP/PLUG	EA	1	\$575.00	\$575.00
5.6	FIRE HYDRANT ASSEMBLY	EA	1	\$3,800.00	\$3,800.00
5.7	WATER MAIN, 8 IN. DIAMETER RELOCATION 1	LS	1	\$8,500.00	\$8,500.00
5.8	WATER MAIN, 8 IN. DIAMETER RELOCATION 2	LS	1	\$8,500.00	\$8,500.00
5.9	WATER MAIN, 8 IN. DIAMETER RELOCATION 3	LS	1	\$8,500.00	\$8,500.00
5.10	WATER MAIN, 8 IN. DIAMETER RELOCATION 4	LS	1	\$14,000.00	\$14,000.00

9A

NO.	DESCRIPTION	ESTIMATED UNITS			AMOUNT
		UNIT	TOTAL	UNIT PRICE	TOTAL
5.11	WATER MAIN, 8 IN. DIAMETER RELOCATION 5	LS	1	\$14,500.00	\$14,500.00
5.12	WATER MAIN, 8 IN. DIAMETER RELOCATION 6	LS	1	\$8,500.00	\$8,500.00
5.13	WATER MAIN, 8 IN. DIAMETER RELOCATION 7	LS	1	\$8,500.00	\$8,500.00
5.14	WATER MAIN, 8 IN. DIAMETER RELOCATION 8	LS	1	\$8,500.00	\$8,500.00
5.15	NEW 1 IN. WATER SERVICE, OPPOSITE SIDE OF RAVINE	LS	1	\$7,100.00	\$7,100.00
5.16	NEW 1 IN. WATER SERVICE, SAME SIDE OF RAVINE	LS	1	\$2,150.00	\$2,150.00
	<b>DIVISION 6 -STRUCTURES FOR SANITARY &amp; STORM</b>				
6.1	MANHOLE, M-A	EA	12	\$3,300.00	\$39,600.00
6.2	INTAKE, TYPE M-A	EA	20	\$2,600.00	\$52,000.00
6.3	INTAKE, TYPE M-C	EA	2	\$4,000.00	\$8,000.00
6.4	INTAKE, TYPE M-D	EA	22	\$4,100.00	\$90,200.00
6.5	INTAKE, TYPE M-E	EA	1	\$6,800.00	\$6,800.00
6.6	INTAKE, TYPE M-I MODIFIED	EA	1	\$5,900.00	\$5,900.00
6.7	CONNECTION TO EXISTING PIPE	EA	5	\$1,000.00	\$5,000.00
6.8	CONNECTION TO EXISTING INTAKE OR MANHOLE STRUCTURE	EA	1	\$1,700.00	\$1,700.00
6.9 *	REMOVAL OF INTAKES AND MANHOLES	EA	7	\$750.00	\$5,250.00
6.10	MANHOLE ADJUSTMENT, MAJOR TYPE 1	EA	3	\$1,300.00	\$3,900.00
6.11	MANHOLE ADJUSTMENT, MINOR TYPE 2	EA	11	\$1,600.00	\$17,600.00
	<b>DIVISION 7 -STREETS &amp; RELATED WORK</b>				
7.1 *	REMOVAL OF SIDEWALK	SY	155	\$8.00	\$1,240.00
7.2	SIDEWALK, P.C. CONCRETE, 6 IN.	SY	2	\$46.00	\$92.00
7.3	SIDEWALK, P.C. CONCRETE, CLASS A, 6 IN.	SY	152	\$51.00	\$7,752.00
7.4	DETECTABLE WARNING, TRUNCATED DOMES	SF	56	\$35.00	\$1,960.00
7.5	CURB AND GUTTER, P.C. CONCRETE, TYPE 1	LF	4930	\$22.00	\$108,460.00
7.6	CURB AND GUTTER, P.C. CONCRETE, TYPE 2	LF	34	\$24.00	\$816.00
7.7	CURB AND GUTTER, P.C. CONCRETE, TYPE 3	LF	198	\$62.00	\$12,276.00
7.8 *	PAVEMENT REMOVAL, PCC AND ACC	SY	2682	\$16.00	\$42,912.00
7.9	BASE PAVEMENT, P.C., CONCRETE, 7 IN.	SY	919	\$50.00	\$45,950.00

9A

NO.	DESCRIPTION	ESTIMATED UNITS			AMOUNT
		UNIT	TOTAL	UNIT PRICE	TOTAL
7.10	BASE PAVEMENT, P.C., CONCRETE, 7 IN., REINFORCED	SY	122	\$60.00	\$7,320.00
7.11 *	PAVEMENT SCARIFICATION/MILLING FOR RESURFACING	SY	8169	\$6.00	\$49,014.00
7.12	HMA (1M ESAL) INTERMEDIATE AND SURFACE COURSE, 1/2 IN MIX	TON	1535	\$100.00	\$153,500.00
7.13 *	GRANULAR SURFACING, TEMPORARY ROADWAY,	TON	400	\$30.00	\$12,000.00
	<b>DIVISION 8 -TRAFFIC SIGNALIZATION/TRAFFIC CONTROL</b>				
8.1 *	TRAFFIC CONTROL	LS	1	\$19,500.00	\$19,500.00
8.2 *	FLAGGERS	DAY	40	\$450.00	\$18,000.00
	<b>DIVISION 9 -SITE WORK &amp; LANDSCAPING</b>				
9.1 *	SPECIAL VEGETATION REMOVAL	SY	1060	\$8.00	\$8,480.00
9.2 *	SODDING	SQ	55	\$62.00	\$3,410.00
9.3 *	SEEDING, TYPE 1	SQ	255	\$25.00	\$6,375.00
9.4 *	SEEDING, TYPE 2	SQ	272	\$25.00	\$6,800.00
9.5 *	TREES	EA	50	\$240.00	\$12,000.00
9.6 *	SHRUBS	EA	60	\$50.00	\$3,000.00
9.7 *	PLUGS	EA	845	\$10.00	\$8,450.00
9.8 *	LIVE STAKES	EA	3243	\$19.00	\$61,617.00
9.9 *	TREE PROTECTION	LS	1	\$6,000.00	\$6,000.00
9.10 *	TREE PROTECTION FENCE	LF	2000	\$2.50	\$5,000.00
9.11 *	REVTMENT FOR BANK STABILIZATION, CLASS A (TYPE 1)	TON	2371	\$81.00	\$192,051.00
9.12 *	REVTMENT FOR BANK STABILIZATION, CLASS D (TYPE 2)	TON	723	\$85.00	\$61,455.00
9.13	COIR LOG (WATTLE) FOR BANK STABILIZATION (TYPE 1)	LF	1185	\$16.00	\$18,960.00
9.14	VGSS FOR BANK STABILIZATION (TYPE 2)	SY	269	\$120.00	\$32,280.00
9.15 *	RECP FOR BANK STABILIZATION (TYPE 1 & 2)	SY	2895	\$3.00	\$8,685.00
9.16 *	FILTER SOCKS, (size), INSTALLATION AND REMOVAL	LF	490	\$2.50	\$1,225.00
9.17 *	SILT FENCE	LF	1000	\$2.50	\$2,500.00
9.18 *	REMOVAL OF SILT FENCE	LF	1000	\$1.00	\$1,000.00
9.19 *	INLET PROTECTION DEVICE	EA	46	\$125.00	\$5,750.00
9.20	ROCK CROSS VANE STRUCTURE	EA	7	\$13,500.00	\$94,500.00

9A

NO.	DESCRIPTION	ESTIMATED UNITS			AMOUNT
		UNIT	TOTAL	UNIT PRICE	TOTAL
9.21 *	ROCK OUTLET PROTECTION, CLASS A RIPRAP	TON	855	\$75.00	\$64,125.00
9.22 *	ROCK OUTLET PROTECTION, CLASS B RIPRAP	TON	1091	\$72.00	\$78,552.00
9.23 *	ROCK OUTLET PROTECTION, CLASS D RIPRAP	TON	375	\$70.00	\$26,250.00
9.24 *	EROSION STONE	TON	4	\$72.00	\$288.00
9.25 *	STABILIZED CONSTRUCTION ENTRANCE	TON	50	\$26.00	\$1,300.00
Prepared By: Zach Erickson per HDR Consultants					
Checked By: _____					
<b>TOTAL CONSTRUCTION COST</b>					<b>\$2,268,000.00</b>

\* Item does not have to be included in 4-year maintenance bond, but shall be covered by a 1-year maintenance bond.

\* Estimate Total= \$1,189,404.00