



DATE June 27, 2011

PUBLIC HEARING, APPROVING PLANS, SPECIFICATIONS, FORM OF CONTRACT DOCUMENTS, AND ENGINEER'S ESTIMATE ON BLANK PARK ZOO ENTRANCE IMPROVEMENTS; RECEIVE AND FILE BIDS; AND DESIGNATION OF LOWEST RESPONSIVE, RESPONSIBLE BIDDER AS LARSON & LARSON CONSTRUCTION LLC, JEFFREY C. LARSON, PRESIDENT, \$1,889,870.93

WHEREAS, on May 23, 2011, under Roll Call No. 11-0869, plans, specifications, form of contract documents, and Engineer's estimate of construction cost were filed with the City Clerk, for the construction of the following improvement:

Blank Park Zoo Entrance Improvements, 11-2011-001
RM-1945(780)--9D-77

The improvement includes street paving twenty-six (26) feet wide B/B with Portland Cement Concrete seven (7) inches thick with integral curb, sidewalks, water main, storm sewer, subdrain, retaining walls, landscaping, and surface restoration. Also included in the project is playground areas, shelter building with restrooms, decorative arch signs, water features, and street lighting together with other incidental items; all in accordance with the contract documents, including Plan File Nos. 532-024/071, at the Blank Park Zoo, 7401 S.W. 9th Street, in an area north of the existing parking lot to the intersection at Rittenhouse Street and SW 9th Street, Des Moines, Iowa

WHEREAS, notice of the hearing on the plans, specifications, form of contract documents, and Engineer's estimate of construction cost was published as required by law.

Whereas, during review and evaluation of the proposals the City Engineer discovered that the apparent lowest bidder, Larson & Larson Construction LLC, the unit price listed for Bid Item No. 12 did not result in the amount listed in the total amount for Bid Item No. 12; and

Whereas, the City Engineer is able to ascertain from the Total Construction Cost and the correct amount listed in the total amount for Bid Item No. 12, that the bidders intent in the proposal was the dollar amount indicated in the total bid price; since the listed unit price was one hundred times greater than the resulting unit price utilizing the total amount for Bid Item No. 12, and this resulting unit price and total amount for this bid item is comparable to the other bidders unit prices and total amounts for this Bid Item No. 12; and

Whereas, the Supplemental Specifications provide, "In the case of discrepancy, the unit price shall govern; except in the case of an obvious, serious, clerical error where the City Engineer is able to determine the bidder's intent from the proposal; in which case, the Des Moines City Council may waive irregularities that are in best interest of the City of Des Moines, as long as the integrity of the bid process can be maintained."; and

Whereas, the City Engineer recommends that the City Council waive this as a minor irregularity and accepts the bid from Larson & Larson Construction LLC in the amount of \$1,889,870.93.



Roll Call Number

Agenda Item Number

54

DATE June 27, 2011

NOW, THEREFORE, BE IT RESOLVED BY THE CITY COUNCIL OF THE CITY OF DES MOINES, IOWA: That the hearing on the plans, specifications, form of contract documents, and Engineer's estimate of construction cost for said improvement be closed; and that said plans, specifications, form of contract documents, and Engineer's estimate of construction cost are hereby approved as the plans, specifications, form of contract documents, and Engineer's estimate of construction cost for said improvement.

BE IT FURTHER RESOLVED: That the City Council concurs in the recommendation of the Engineering Department and the Legal Department regarding the bid submitted by Larson & Larson Construction LLC, waives said minor irregularity, and hereby receives the bid submitted by Larson & Larson Construction LLC.

BE IT FURTHER RESOLVED: That sealed bids for said improvement were submitted by the following bidders:

- | | |
|----------------------------------|---------------------|
| Larson & Larson Construction LLC | Urbandale, IA |
| Corell Contractor, Inc. | West Des Moines, IA |
| Elder Corporation | Des Moines, IA |

which were received and opened at a public meeting presided over by the Engineer in the City Council Chambers, 2nd Floor, City Hall, 400 Robert D. Ray Drive, Des Moines, Iowa at 11:00 a.m. on June 14, 2011. Said bids and the attached tabulation of bids for said improvement be and are hereby received and filed.

BE IT FURTHER RESOLVED: That the Des Moines City Engineer, as the Engineer, has determined that the lowest responsive, responsible bid for the construction of said improvement was submitted by Larson & Larson Construction LLC, Jeffrey C. Larson, President, 10703 Justin Drive, Urbandale, IA, 50322 in the amount of \$1,889,870.93, and said bid be and the same is hereby accepted.

BE IT FURTHER RESOLVED: That the bid security of the unsuccessful bidders be and is hereby authorized and directed to be returned.



Roll Call Number

Agenda Item Number

54

DATE June 27, 2011

BE IT FURTHER RESOLVED: That the Engineer is hereby directed to secure execution by the lowest responsible, responsive Bidder and its surety of the contract documents in the form heretofore approved by this Council; that the Engineer is directed to thereafter present said contract documents to this Council for approval and authorization to the Mayor to sign; and that no contract shall be deemed to exist between the City of Des Moines and said Bidder until said contract has been executed by the Bidder, and shall have been approved by this Council and executed by the Mayor and attested to by the City Clerk.

(City Council Communication Number 11-414 attached.)

Moved by _____ to adopt.

FORM APPROVED:

FUNDS AVAILABLE

Kathleen Vanderpool by AD
Kathleen Vanderpool
Deputy City Attorney

Scott E. Sanders
Scott E. Sanders
Des Moines Finance Director

SEB Funding Source: 2011-2012 CIP, Page Parks-5, Blank Park Zoo Entrance, PKS174, Being: IDOT - RISE RM-1945(780)--9D-77 \$372,749.71 (50% of construction cost up to grant maximum of \$449,725), RIIF Funding from Iowa Department of Corrections \$946,088.39 (\$573,338.68 plus \$372,749.71 match to RISE Grant, with maximum funding of \$1,000,000), and the remaining \$571,032.83, Blank Park Zoo Foundation

COUNCIL ACTION	YEAS	NAYS	PASS	ABSENT
COWNIE				
COLEMAN				
GRIESS				
HENSLEY				
MAHAFFEY				
MEYER				
MOORE				
TOTAL				

MOTION CARRIED APPROVED

Mayor

I, Diane Rauh, City Clerk of said City Council, hereby certify that at a meeting of the City Council, held on the above date, among other proceedings the above was adopted.

IN WITNESS WHEREOF, I have hereunto set my hand and affixed my seal the day and year first above written.

City Clerk

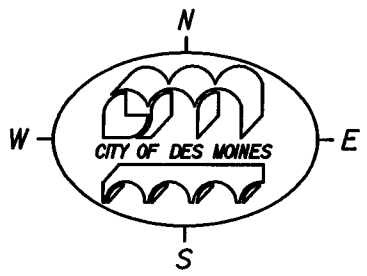
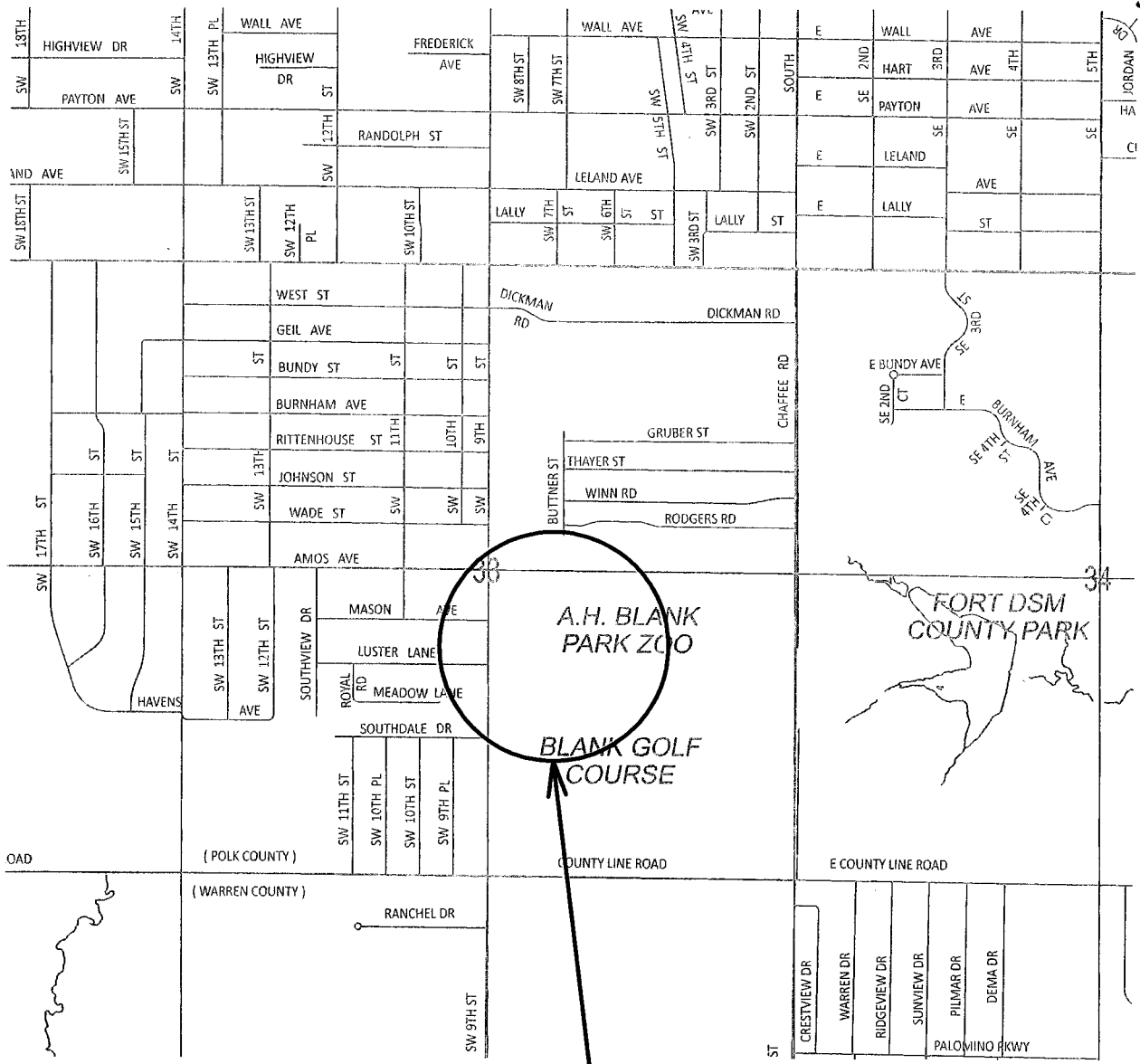

**PROJECT
LOCATION**

**BLANK PARK ZOO
ENTRANCE IMPROVEMENTS**

ACTIVITY I.D. 11-2011-001

TABULATED BY: D. Kamp
CHECKED BY: R. De Groot
APPROVED BY: R. De Groot

CONTRACTOR'S BID TABULATION
PROJECT: BLANK PARK ZOO ENTRANCE IMPROVEMENTS

-----ESTIMATE-----

ITEM	DESCRIPTION	QUANTITY	UNIT PRICE		AMOUNT		Larson & Larson Construction LLC Des Moines, Iowa		Corell Contractor, Inc West Des Moines, Iowa		Elder Corporation Des Moines, Iowa	
			UNIT	PRICE	AMOUNT	UNIT	PRICE	AMOUNT	UNIT	PRICE	AMOUNT	UNIT
1	Clearing and Grubbing	7.79 AC	\$1,800.00	\$2,590.39	\$14,022.00	\$2,400.00	\$18,696.00	\$2,500.00	\$19,475.00			
2	Topsoil, On-Site	7709 CY	\$6.00	\$3,000.00	\$46,254.00	\$7.50	\$57,817.50	\$8.00	\$61,872.00			
3	Excavation, Class 10	21606 CY	\$8.00	\$172,848.00	\$172,848.00	\$6.50	\$140,439.00	\$4.00	\$86,424.00			
4	Subgrade Preparation	6202 SY	\$3.00	\$18,606.00	\$18,606.00	\$3.25	\$20,156.50	\$3.00	\$18,606.00			
5	Subbase, Modified Backfill	6202 SY	\$10.00	\$62,020.00	\$62,020.00	\$6.25	\$38,762.50	\$7.80	\$48,375.60			
6	Compaction Testing	1 LS	\$3,000.00	\$3,000.00	\$3,000.00	\$2,600.00	\$2,600.00	\$3,000.00	\$3,000.00			
7	Sanitary Sewer Gravity Main, 4" Dia.	24 LF	\$38.00	\$912.00	\$912.00	\$135.00	\$3,240.00	\$135.00	\$3,240.00			
8	Sanitary Sewer Force Main, 2" Dia.	250 LF	\$30.00	\$7,500.00	\$7,500.00	\$33.50	\$8,375.00	\$22.00	\$5,500.00			
9	Storm Sewer, Trenched, PVC, 4"	142 LF	\$30.00	\$4,260.00	\$4,260.00	\$50.00	\$7,100.00	\$29.00	\$4,118.00			
10	Storm Sewer, Trenched, RCP, 15"	740 LF	\$40.00	\$29,600.00	\$29,600.00	\$56.00	\$41,440.00	\$43.00	\$31,820.00			
11	Storm Sewer, Trenched, RCP, 18"	222 LF	\$55.00	\$12,210.00	\$12,210.00	\$55.00	\$12,210.00	\$46.00	\$10,212.00			
12	Storm Sewer, Trenched, RCP, 24"	160 LF	\$65.00	\$10,400.00	\$10,400.00	\$94.44	\$15,110.40	\$54.00	\$8,640.00			
13	Removal of Storm Sewer, 6"	31 LF	\$10.00	\$310.00	\$310.00	\$19.00	\$589.00	\$13.00	\$403.00			
14	Removal of Storm Sewer, 10"	200 LF	\$10.00	\$2,000.00	\$2,000.00	\$18.50	\$3,700.00	\$13.00	\$2,600.00			
15	Removal of Storm Sewer, 12"	122 LF	\$10.00	\$1,220.00	\$1,220.00	\$22.50	\$2,745.00	\$18.00	\$2,196.00			
16	Pipe Apron, RCP, 15"	3 EA	\$1,300.00	\$3,900.00	\$3,900.00	\$1,565.00	\$4,695.00	\$1,600.00	\$4,800.00			
17	Pipe Apron, RCP, 18" (Relocate)	1 EA	\$1,400.00	\$1,400.00	\$1,400.00	\$1,225.00	\$1,225.00	\$810.00	\$810.00			
18	Pipe Apron, RCP, 24"	1 EA	\$1,600.00	\$1,600.00	\$1,600.00	\$1,895.00	\$1,895.00	\$1,700.00	\$1,700.00			
19	Subdrain, Corrugated PVC, 6"	2579 LF	\$15.00	\$38,685.00	\$38,685.00	\$15.00	\$38,685.00	\$16.00	\$41,264.00			
20	Subdrain Cleanout, Type A-1, 6"	5 EA	\$400.00	\$2,000.00	\$2,000.00	\$400.00	\$2,000.00	\$370.00	\$1,850.00			
21	Subdrain Outlet and Connections, Intake and Manhole, 6"	20 EA	\$300.00	\$6,000.00	\$6,000.00	\$450.00	\$9,000.00	\$340.00	\$6,800.00			
22	Water Main, 8" Dia. (Lowered)	88 LF	\$50.00	\$4,400.00	\$4,400.00	\$215.50	\$18,964.00	\$110.00	\$9,680.00			
23	Water Service, 2" Dia.	242 LF	\$20.00	\$4,840.00	\$4,840.00	\$53.48	\$12,942.16	\$50.00	\$12,100.00			
24	Relocate Existing Drinking Fountain	1 EA	\$500.00	\$500.00	\$500.00	\$7,987.47	\$7,987.47	\$3,300.00	\$3,300.00			
25	Manhole, SW-301, 48" (Sanitary Sewer)	1 EA	\$3,000.00	\$3,000.00	\$3,000.00	\$2,255.15	\$2,255.15	\$2,800.00	\$2,800.00			
26	Manhole, SW-401, 48" (Storm Sewer)	4 EA	\$2,500.00	\$10,000.00	\$10,000.00	\$2,700.00	\$10,800.00	\$2,500.00	\$10,000.00			
27	Intake, SW-501, Single Grate	7 EA	\$2,500.00	\$17,500.00	\$17,500.00	\$2,250.00	\$15,750.00	\$3,000.00	\$21,000.00			
28	Intake, SW-503, Single Grate Combination Manhole	2 EA	\$5,000.00	\$10,000.00	\$10,000.00	\$6,087.32	\$12,174.64	\$5,500.00	\$11,000.00			
29	Intake, SW-505, Double Grate	1 EA	\$4,000.00	\$4,000.00	\$4,000.00	\$3,588.67	\$3,588.67	\$5,400.00	\$5,400.00			
30	Intake, SW-506, Double Grate Combination Manhole	1 EA	\$6,500.00	\$6,500.00	\$6,500.00	\$5,973.54	\$5,973.54	\$7,800.00	\$7,800.00			
31	Intake, SW-511, Rectangular Area	1 EA	\$3,500.00	\$3,500.00	\$3,500.00	\$2,081.07	\$2,081.07	\$3,700.00	\$3,700.00			
32	Intake, SW-513, Open-Sided Area	1 EA	\$4,000.00	\$4,000.00	\$4,000.00	\$3,124.44	\$3,124.44	\$4,700.00	\$4,700.00			
33	Manhole Adjustment (Sanitary Sewer)	1 EA	\$500.00	\$500.00	\$500.00	\$1,092.30	\$1,092.30	\$1,500.00	\$1,500.00			
34	Removal Storm Manhole	1 EA	\$500.00	\$500.00	\$500.00	\$802.16	\$802.16	\$650.00	\$650.00			
35	Removal Intake	1 EA	\$500.00	\$500.00	\$500.00	\$802.16	\$802.16	\$650.00	\$650.00			
36	Pavement, 6" P.C.C.	451 SY	\$35.00	\$15,785.00	\$15,785.00	\$32.80	\$14,792.80	\$32.50	\$14,657.50			
37	Pavement, 7" P.C.C.	4595 SY	\$38.00	\$174,610.00	\$174,610.00	\$32.30	\$148,418.50	\$32.00	\$147,040.00			
38	Pavement, 8" P.C.C.	454 SY	\$40.00	\$18,160.00	\$18,160.00	\$46.15	\$20,952.10	\$46.00	\$20,884.00			
39	P.C.C. Pavement Samples and Testing	1 LS	\$2,000.00	\$2,000.00	\$2,000.00	\$1,335.00	\$1,335.00	\$2,900.00	\$2,900.00			
40	Pavement Removal	1554 SY	\$6.00	\$9,324.00	\$9,324.00	\$13.00	\$20,202.00	\$9.00	\$13,986.00			
41	Removal of Sidewalk	165 SY	\$6.00	\$990.00	\$990.00	\$7.00	\$1,155.00	\$5.00	\$825.00			
42	Recreational Trail, 5" P.C.C.	899 SY	\$32.00	\$28,768.00	\$28,768.00	\$34.60	\$31,105.40	\$27.00	\$24,273.00			

54

ITEM	DESCRIPTION	QUANTITY	UNIT PRICE	AMOUNT	UNIT PRICE	AMOUNT	UNIT PRICE	AMOUNT
43	Sidewalk, 4" P.C.C.	286 SY	\$27.00	\$7,722.00	\$30.72	\$8,785.92	\$31.70	\$9,066.20
44	Sidewalk, 5" P.C.C.	744 SY	\$32.00	\$23,808.00	\$33.40	\$24,952.00	\$37.60	\$27,979.20
45	Detectable Warning Panel	118 SF	\$40.00	\$4,720.00	\$36.41	\$4,296.38	\$37.60	\$4,436.80
46	Conventional Seeding, Seeding, Fertilizing and Mulching, Turf Grass	4.9 AC	\$3,000.00	\$14,700.00	\$2,104.96	\$10,314.30	\$1,575.00	\$7,717.50
47	Conventional Seeding, Seeding, Fertilizing and Mulching, Native Grasses/Wildfl	1.2 AC	\$3,500.00	\$4,200.00	\$1,843.26	\$2,211.91	\$7,035.00	\$8,442.00
48	Plants, Deciduous Overstory Trees	21 EA	\$350.00	\$7,350.00	\$232.11	\$4,874.31	\$226.00	\$4,766.00
49	Plants, Deciduous Ornamental Trees	47 EA	\$275.00	\$12,975.00	\$180.91	\$8,502.67	\$184.00	\$8,608.00
50	Plants, Coniferous Trees	49 EA	\$250.00	\$12,250.00	\$188.88	\$9,255.12	\$168.00	\$8,232.00
51	Plants, Ornamental Grasses	465 EA	\$35.00	\$16,275.00	\$5,821.80	\$13.52	\$6,281.80	\$6,045.00
52	Plants, Shrubs	215 EA	\$60.00	\$12,900.00	\$30.72	\$6,604.80	\$32.00	\$6,880.00
53	Plants, Perennials	314 EA	\$20.00	\$6,280.00	\$13.65	\$4,286.10	\$8.50	\$2,669.00
54	Tree Protection	1 LS	\$1,000.00	\$1,000.00	\$967.14	\$967.14	\$315.00	\$315.00
55	Tree Protection Fencing	1850 LF	\$2.00	\$3,700.00	\$1.82	\$3,367.00	\$2.75	\$5,087.50
56	Mulch, Shredded Hard Wood	17800 SF	\$0.50	\$8,900.00	\$0.23	\$4,094.00	\$0.50	\$8,900.00
57	Metal Edging	675 LF	\$5.00	\$3,375.00	\$4.55	\$3,071.25	\$4.50	\$3,037.50
58	Storm Water Pollution Prevention	1 LS	\$4,000.00	\$4,000.00	\$1,422.27	\$1,422.27	\$3,200.00	\$3,200.00
59	Erosion Control Mulching, Conventional Mulch	7.24 AC	\$1,000.00	\$7,240.00	\$396.24	\$2,883.26	\$420.00	\$3,040.80
60	Turf Reinforcement Mat (TRM)	659 SY	\$15.00	\$9,885.00	\$10.87	\$7,163.33	\$12.00	\$7,908.00
61	Filter Sock, Installation, Maintenance and Removal	32 LF	\$4.00	\$128.00	\$4.55	\$145.60	\$3.15	\$100.80
62	Sediment Basin Outlet, Installation, Maintenance and Removal	2 EA	\$2,000.00	\$4,000.00	\$766.89	\$1,533.78	\$1,800.00	\$3,600.00
63	Silt Fence, Installation, Maintenance and Removal	3742 LF	\$3.00	\$11,226.00	\$1.82	\$6,810.44	\$2.00	\$7,484.00
64	Stabilized Construction Entrance	105 TON	\$20.00	\$2,100.00	\$24.35	\$2,556.75	\$39.50	\$4,147.50
65	Inlet Protection Device, Installation, Maintenance and Removal	11 EA	\$250.00	\$2,750.00	\$68.27	\$750.97	\$42.00	\$462.00
66	Outlet Protection, ScourStop	208 SF	\$30.00	\$6,240.00	\$18.21	\$3,787.68	\$17.35	\$3,608.80
67	Concrete Washout Pit	3 EA	\$750.00	\$2,250.00	\$909.30	\$2,727.90	\$735.00	\$2,205.00
68	Fence, Chain Link with Security Top, 120" Height (Type 1)	725 LF	\$30.00	\$21,750.00	\$45.23	\$32,791.75	\$23.30	\$16,892.50
69	Fence, Chain Link, 96" Height (Type 2)	1677 LF	\$20.00	\$33,540.00	\$20.18	\$33,841.86	\$18.65	\$31,276.05
70	Fence, Chain Link, 42" Height (Type 3)	117 LF	\$15.00	\$1,755.00	\$32.00	\$3,744.00	\$29.50	\$3,451.50
71	Remove Existing Fence	1311 LF	\$2.50	\$3,277.50	\$2.73	\$3,579.03	\$2.50	\$3,277.50
72	Gate, 30' Double Swing Chain Link With Security Top, 120" Height (Type 1)	1 EA	\$2,500.00	\$2,500.00	\$1,223.01	\$1,223.01	\$1,130.00	\$1,130.00
73	Gate, 12' Double Swing Chain Link With Security Top, 120" Height (Type 1)	1 EA	\$1,500.00	\$1,500.00	\$761.64	\$761.64	\$704.00	\$704.00
74	Gate, 30' Double Swing Chain Link, 96" Height (Type 2)	1 EA	\$1,800.00	\$1,800.00	\$1,045.70	\$1,045.70	\$966.00	\$940.00
75	Gate, 12' Double Swing Chain Link, 96" Height (Type 2)	1 EA	\$1,200.00	\$1,200.00	\$676.29	\$676.29	\$625.00	\$610.00
76	Gate, 7' Single Swing Chain Link, 96" Height (Type 2)	1 EA	\$800.00	\$800.00	\$346.67	\$346.67	\$320.00	\$320.00
77	Gate, 54' Rolling Chain Link, 96" Height	1 EA	\$10,000.00	\$10,000.00	\$3,125.71	\$3,125.71	\$2,888.00	\$2,888.00
78	Retaining Wall, Modular Block	805 SF	\$25.00	\$20,125.00	\$19.89	\$16,011.45	\$20.00	\$16,100.00
79	Steps, P.C.C.	150 SF	\$35.00	\$5,250.00	\$26.52	\$3,978.00	\$52.50	\$7,875.00
80	Handrail (Ramp)	218 LF	\$50.00	\$10,900.00	\$34.10	\$7,433.80	\$79.00	\$17,222.00
81	Building Demolition (Existing Restrooms/Fountain/Playground)	1 LS	\$5,000.00	\$5,000.00	\$11,367.91	\$11,367.91	\$8,000.00	\$8,000.00
82	Traffic Control	1 LS	\$8,000.00	\$8,000.00	\$3,592.26	\$3,592.26	\$3,800.00	\$3,800.00
83	Traffic Signs (Relocate)	2 EA	\$200.00	\$400.00	\$682.08	\$682.08	\$205.00	\$410.00
84	Traffic Signs	5 EA	\$500.00	\$2,500.00	\$1,140.65	\$1,140.65	\$236.00	\$1,180.00
85	Painted Pavement Markings	32.21 STA	\$150.00	\$4,831.50	\$7,066.87	\$7,066.87	\$203.00	\$6,538.63
86	Painted Pavement Symbols	5 EA	\$250.00	\$1,250.00	\$250.09	\$1,250.45	\$231.00	\$1,155.00
87	Waterfall System	1 LS	\$25,000.00	\$25,000.00	\$79,650.97	\$79,650.97	\$58,810.00	\$58,810.00
88	Stone, Winnebago Stone	82 TON	\$540.00	\$44,280.00	\$484.62	\$39,738.84	\$436.00	\$35,752.00
89	Stone, Lannon Stone	118 TON	\$260.00	\$30,680.00	\$353.49	\$41,711.82	\$318.00	\$37,524.00
90	PVC Duct, Trenched, 24" Depth	1850 LF	\$10.00	\$18,500.00	\$18.76	\$34,706.00	\$16.50	\$30,525.00
91	Handhole, Electrical	11 EA	\$250.00	\$2,750.00	\$776.54	\$8,541.94	\$680.00	\$7,480.00
92	Entry Lights	3 EA	\$6,000.00	\$18,000.00	\$23,832.07	\$23,832.07	\$20,900.00	\$20,900.00
93	Roadway Light	6 EA	\$3,150.00	\$18,900.00	\$5,212.27	\$31,273.62	\$4,571.00	\$27,426.00
94	Pedestrian Light	2 EA	\$2,700.00	\$5,400.00	\$4,293.19	\$8,586.38	\$3,765.00	\$7,530.00

ITEM	DESCRIPTION	QUANTITY	UNIT		UNIT		UNIT		UNIT		UNIT	
			PRICE	AMOUNT	PRICE	AMOUNT	PRICE	AMOUNT	PRICE	AMOUNT	PRICE	AMOUNT
95	Pond Feature Light	5 EA	\$1,500.00	\$7,500.00	\$570.15	\$2,850.75	\$462.00	\$2,310.00	\$460.00	\$2,300.00		
96	Light Pole Bases & Installation	13 EA	\$1,750.00	\$22,750.00	\$944.16	\$12,274.08	\$828.00	\$10,764.00	\$840.00	\$10,920.00		
97	Light Controller Box	1 EA	\$2,000.00	\$2,000.00	\$171.04	\$171.04	\$150.00	\$150.00	\$155.00	\$155.00		
98	Relocation of Light Pole	2 EA	\$1,000.00	\$2,000.00	\$1,670.53	\$3,341.06	\$1,465.00	\$2,930.00	\$1,900.00	\$3,800.00		
99	Entrance Sign (Archway)	1 LS	\$225,000.00	\$225,000.00	\$171,795.22	\$171,795.22	\$189,625.00	\$189,625.00	\$202,000.00	\$202,000.00		
100	Relocation of Blank Park Zoo Entrance Sign	1 LS	\$2,500.00	\$2,500.00	\$13,563.71	\$13,563.71	\$12,813.00	\$12,813.00	\$7,800.00	\$7,800.00		
101	Picnic Shelter/Restroom	1 LS	\$275,000.00	\$275,000.00	\$343,575.60	\$343,575.60	\$481,750.00	\$481,750.00	\$375,000.00	\$375,000.00		
102	Play Area, Play Structures	1 LS	\$22,338.00	\$22,338.00	\$24,676.63	\$24,676.63	\$22,715.00	\$22,715.00	\$22,000.00	\$22,000.00		
103	Play Area, Engineered Wood Fiber Surface	82 CY	\$35.00	\$2,870.00	\$59.50	\$4,879.00	\$36.00	\$2,952.00	\$22,800.00	\$228,600.00		
104	Play Area, PCC Curb Edge	175 LF	\$12.00	\$2,100.00	\$25.44	\$4,452.00	\$40.00	\$7,000.00	\$50.00	\$8,750.00		
105	Play Area, Under Drain	1 LS	\$2,000.00	\$2,000.00	\$2,851.68	\$2,851.68	\$4,400.00	\$4,400.00	\$3,400.00	\$3,400.00		
106	Construction Survey	1 LS	\$10,000.00	\$10,000.00	\$11,275.53	\$11,275.53	\$9,800.00	\$9,800.00	\$8,100.00	\$8,100.00		
107	Mobilization	1 LS	\$24,055.00	\$24,055.00	\$55,000.00	\$55,000.00	\$58,000.00	\$58,000.00	\$104,326.80	\$104,326.80		
TOTAL CONSTRUCTION COST				\$1,850,000.00		\$1,889,870.93		\$2,098,440.48		\$2,213,997.00		
PERCENT OF ENGINEER'S ESTIMATE						+2.18%		+13.43%		+19.68%		

Low