

DATE October 24, 2011

ORDERING CONSTRUCTION OF
2011 SEWER REPAIR - CONTRACT 1
AND FIXING A DATE FOR RECEIVING OF BIDS ON NOVEMBER 8, 2011
AND PUBLIC HEARING ON NOVEMBER 21, 2011
ENGINEER'S ESTIMATE IS \$935,000.00

BE IT RESOLVED BY THE CITY COUNCIL OF THE CITY OF DES MOINES, IOWA: That the attached communication recommending construction of the following improvement and the method of financing; and also including the recommendation of the Des Moines City Engineer, as the Engineer, submitting plans, specifications, form of contract documents, and Engineer's estimate of cost for the construction of the following improvement:

2011 Sewer Repair - Contract 1, 08-2011-009

The improvement includes repair of storm and sanitary sewers, protection of sanitary sewers, installation of manholes, installation of sheet pile & rip rap, grading, restoration of pavement and landscaping, and other incidental items; all work in accordance with the contract documents including Plan File Nos. 535-069/097 at the following locations: 3500 E. Watrous Avenue, 7700 S.E. 14th Street, 228 E. Pleasant View Drive, 4600 E. Spring Street, 3021 Timber Hill Court, 1600 24th Place, and Greenwood Terrace, Des Moines, Iowa

be and the same are hereby approved and accepted. The estimated construction cost for said improvement is \$935,000.00. The proposed plans, specifications, and form of contract documents are available for public inspection in the Des Moines City Engineer's Office.

BE IT FURTHER RESOLVED: That this Council hereby determines that it is necessary and advisable to construct said improvement in the manner set forth in the plans, specifications, and form of contract documents submitted by the Engineer; and that payment for the cost of said improvement shall be paid from the funding source identified below.

BE IT FURTHER RESOLVED: That a public hearing on said plans, specifications, form of contract documents, and Engineer's estimate of construction cost for said improvement be held in the City Council Chambers, 2nd Floor, City Hall, 400 Robert D. Ray Drive, Des Moines, Iowa, at 5:00 p.m. on November 21, 2011, at which time this Council will consider any objections offered thereto or to the making of said improvement.

BE IT FURTHER RESOLVED: That proposals will be received by the City of Des Moines, at the office of the Des Moines City Clerk until 11:00 a.m. on November 8, 2011, for the construction of said improvement, and the taking of bids in the manner required by law. Proposals received will be opened at a public meeting presided over by the Engineer in the City Council Chambers, 2nd Floor, City Hall, 400 Robert D. Ray Drive, Des Moines, Iowa, at 11:00 a.m. on November 8, 2011, after which the bids together with a bid tabulation and recommendation of the Engineer will be presented to the City Council at its next meeting for action thereon.

★ **Roll Call Number**

Agenda Item Number

8

DATE October 24, 2011

BE IT FURTHER RESOLVED: That an appropriate Notice to Bidders and Notice of Public Hearing for said improvement be published in the Des Moines Register as provided and directed by Chapter 26 and/or 314, Code of Iowa.

(City Council Communication Number 11-649 attached.)

Moved by _____ to adopt.

FORM APPROVED:

FUNDS AVAILABLE

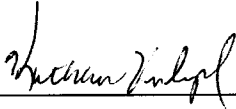

Kathleen Vanderpool
Deputy City Attorney

Scott E. Sanders
Des Moines Finance Director

Funding Source: 2011-2012 CIP, Page Storm - 4, City-wide Storm Water Utility Projects, STE057, Storm Water Utility Funds, Being: *EFB* \$154,403.00 in FEMA funding; \$290,861.00 in City-wide Storm Water Utility Projects; and the remaining \$489,736.00 in Sanitary Sewer Funds from SAE054, City-wide Sanitary Sewers.

COUNCIL ACTION	YEAS	NAYS	PASS	ABSENT
COWNIE				
COLEMAN				
GRIESS				
HENSLEY				
MAHAFFEY				
MEYER				
MOORE				
TOTAL				

MOTION CARRIED

APPROVED

Mayor

I, Diane Rauh, City Clerk of said City Council, hereby certify that at a meeting of the City Council, held on the above date, among other proceedings the above was adopted.

IN WITNESS WHEREOF, I have hereunto set my hand and affixed my seal the day and year first above written.

City Clerk

8

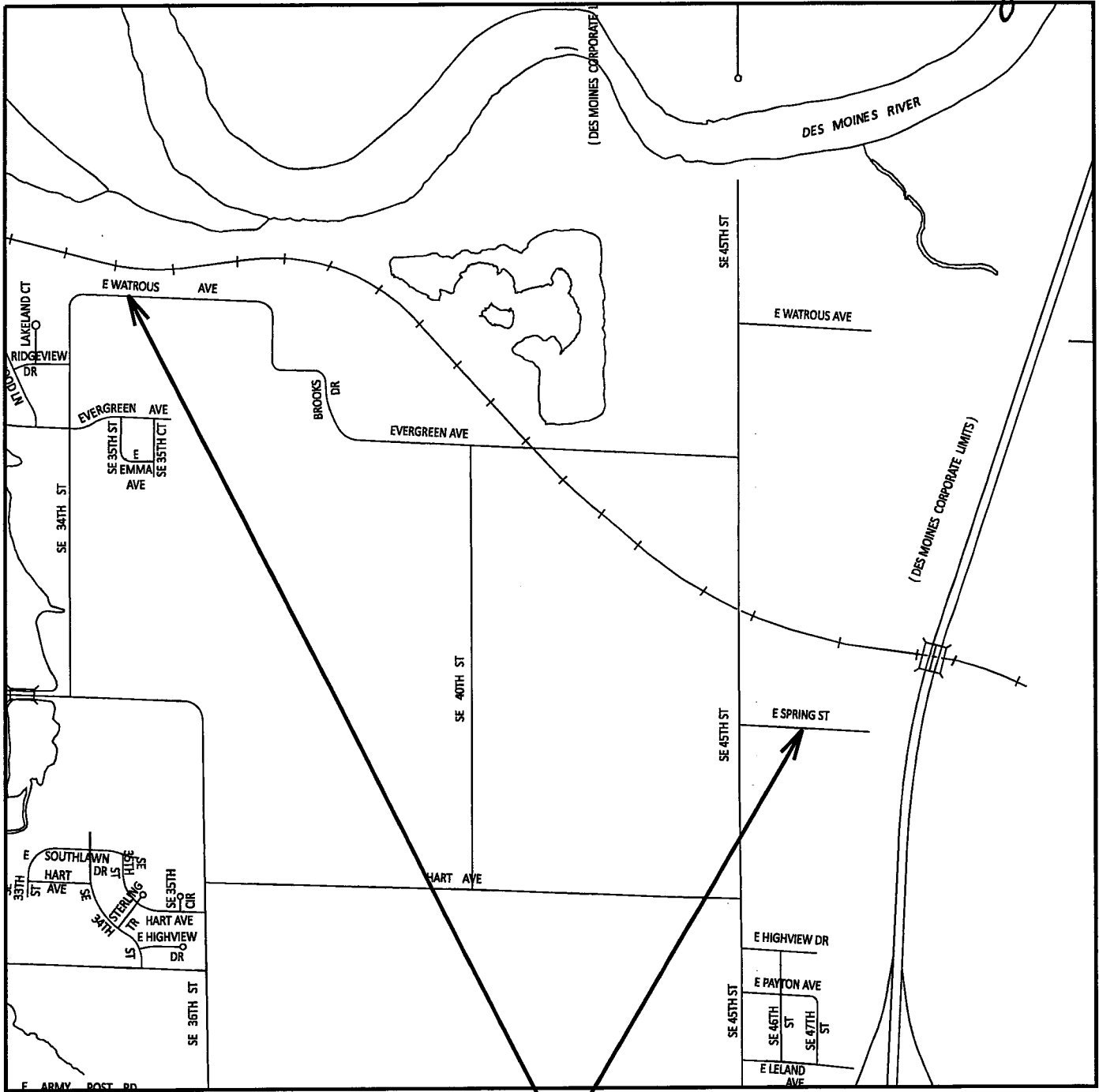

**PROJECT
LOCATIONS**

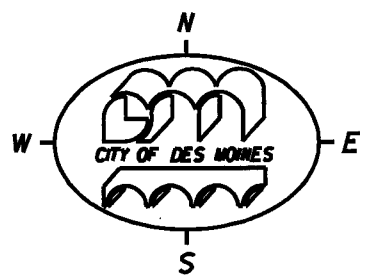

**2011 SEWER REPAIR - CONTRACT 1
ACTIVITY ID 08-2011-009
PAGE 1 OF 3**

8

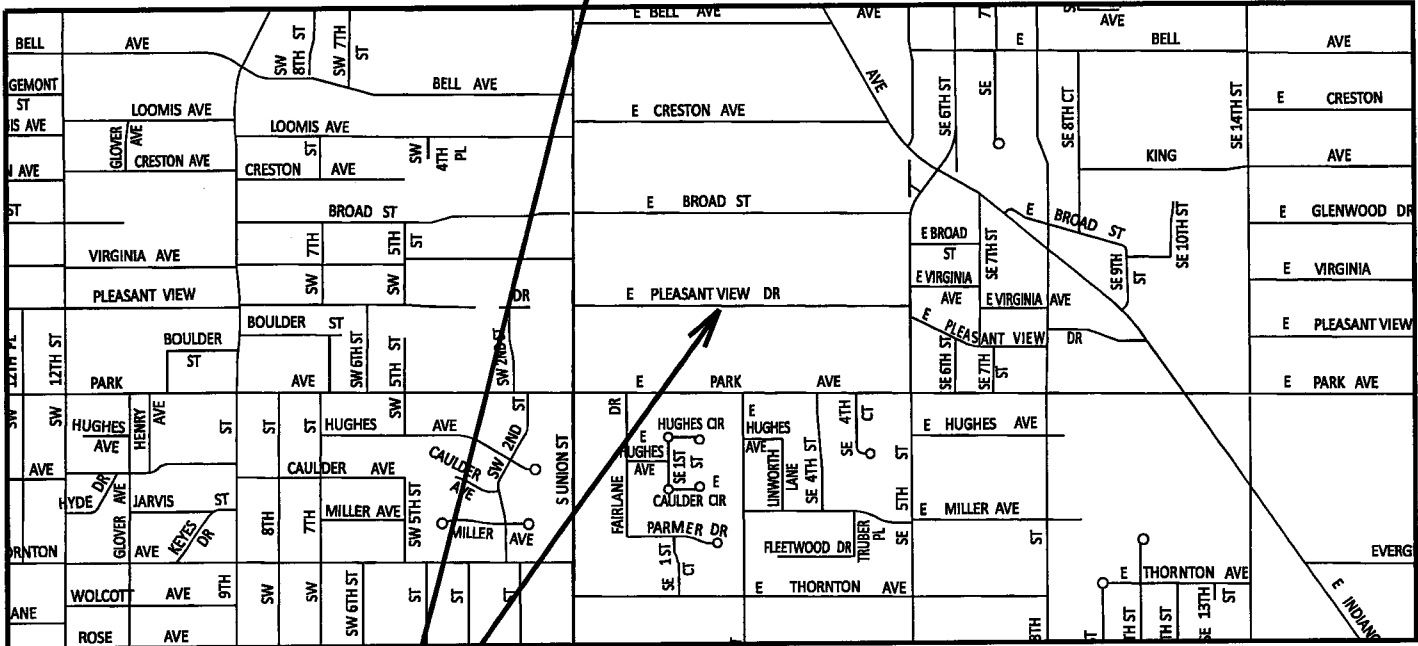
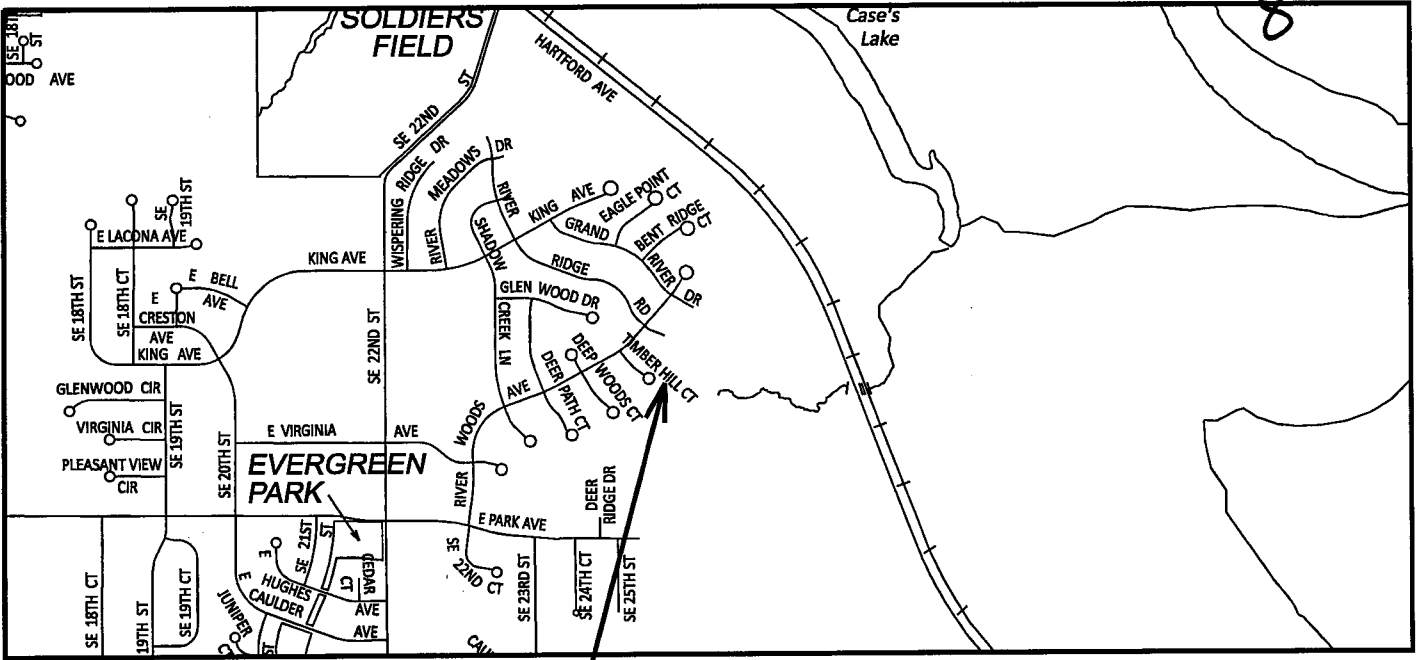

PROJECT LOCATIONS

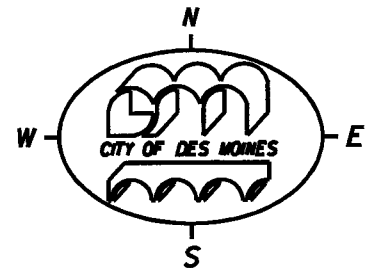

2011 SEWER REPAIR - CONTRACT 1
ACTIVITY ID 08-2011-009

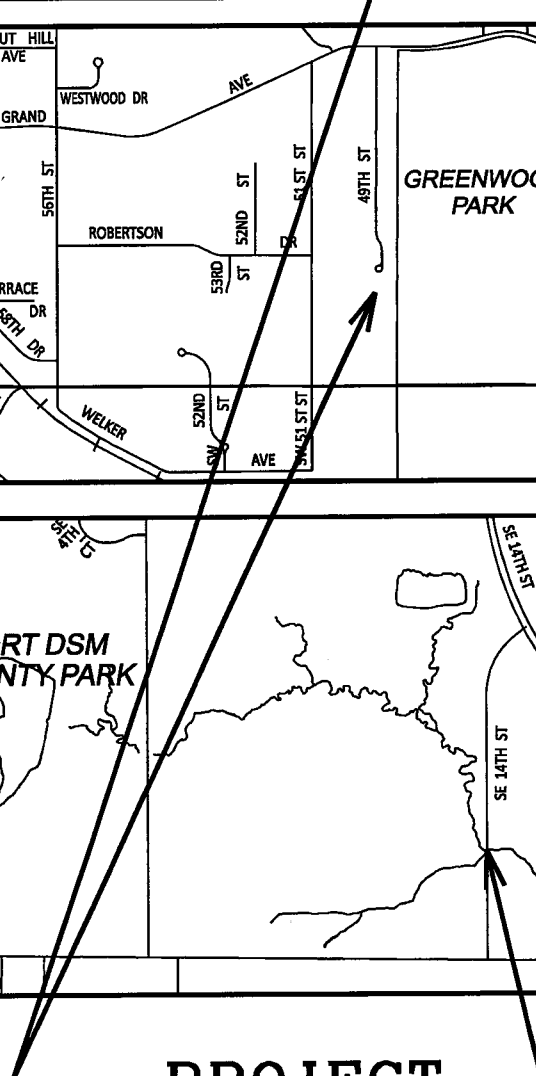
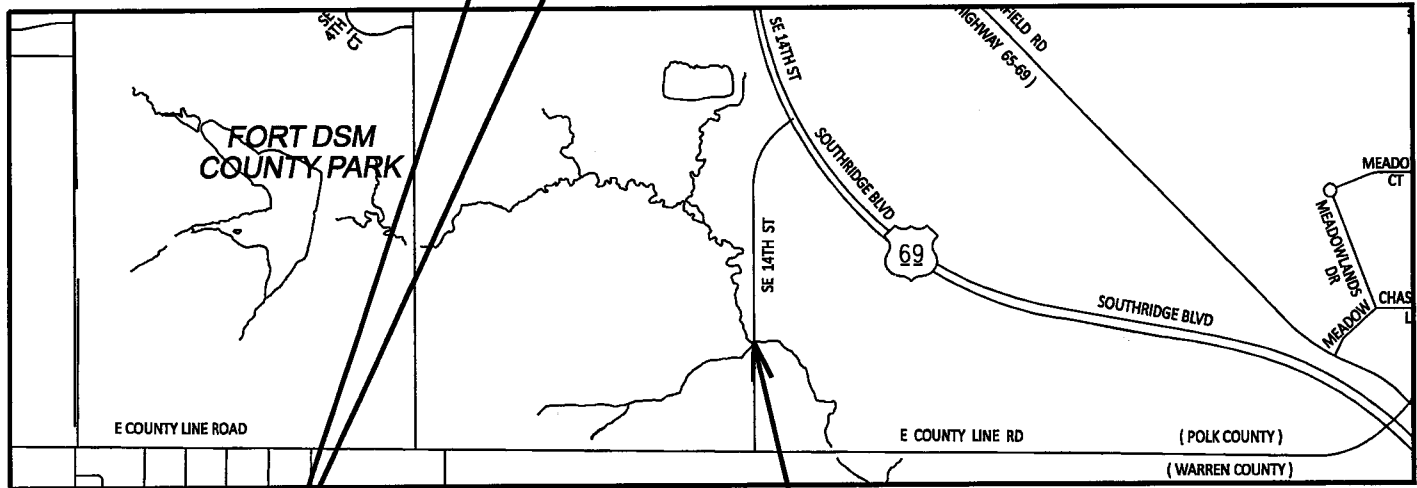
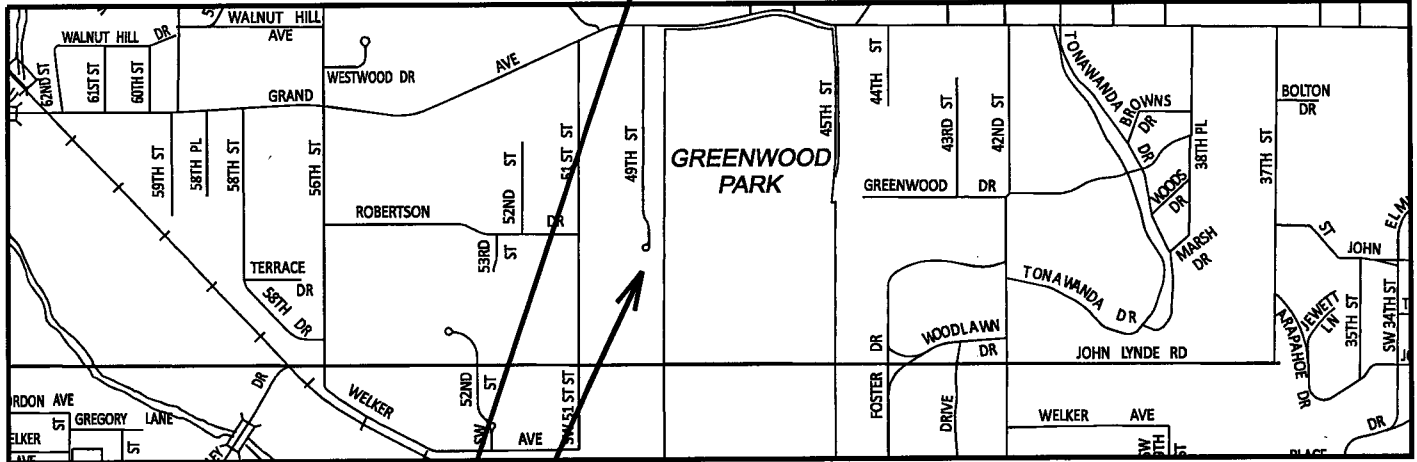
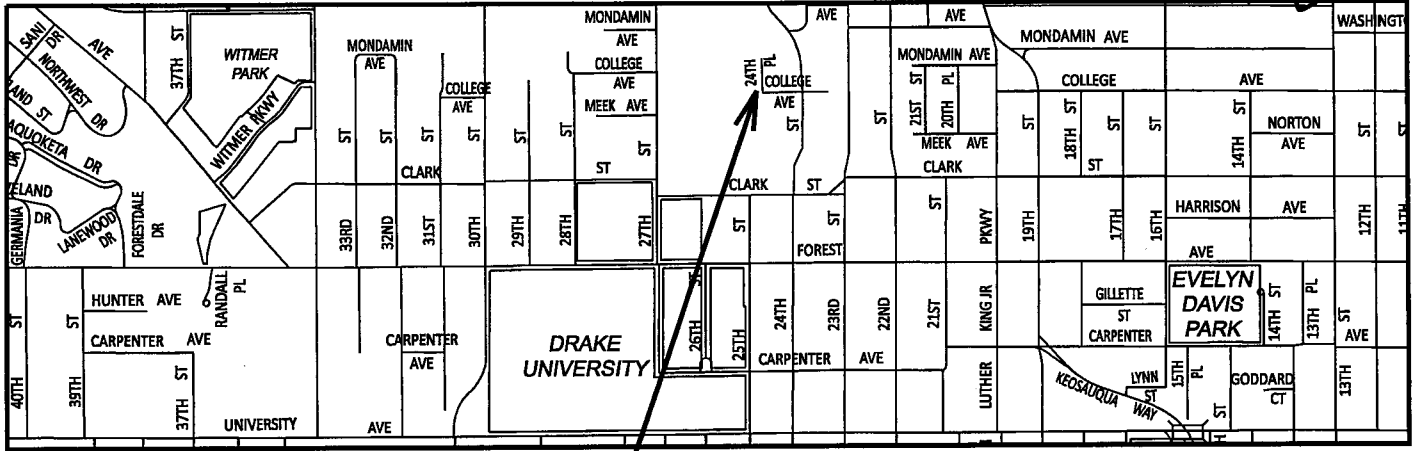

**PROJECT
LOCATIONS**

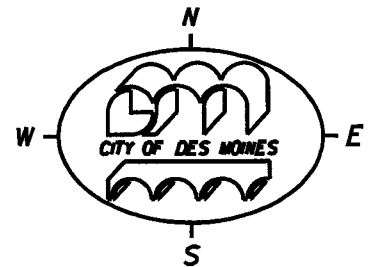

8

CONSTRUCTION ESTIMATE

DEPARTMENT OF ENGINEERING
CITY OF DES MOINES, IOWA

Activity ID 08-2011-009
Date: 10/07/2011

PROJECT: 2011 SEWER REPAIR - CONTRACT 1

NO.	DESCRIPTION	ESTIMATED UNITS			AMOUNT
		UNIT	TOTAL	UNIT PRICE	TOTAL
	PROJECT 1 - 3500 E. WATROUS AVENUE				
1.01	* CONSTRUCTION SURVEY	LS	1	\$4,000.00	\$4,000.00
1.02	* MOBILIZATION	LS	1	\$9,000.00	\$9,000.00
1.03	* CLEARING & GRUBBING	AC	0.52	\$25,000.00	\$13,000.00
1.04	* TOPSOIL, OFFSITE (FURNISH & PLACE)	CY	725	\$15.00	\$10,875.00
1.05	* EXCAVATION, CLASS 10, ROADWAY & BORROW (FURNISH & PLACE)	CY	2005	\$9.00	\$18,045.00
1.06	* SITE REMOVALS, AS PER PLAN	LS	1	\$5,000.00	\$5,000.00
1.07	* REMOVAL OF PAVEMENT	SY	370	\$9.00	\$3,330.00
1.08	* SPECIAL BACKFILL	CY	70	\$35.00	\$2,450.00
1.09	* SHLD CONSTRUCTION, EARTH	LF	300	\$12.00	\$3,600.00
1.10	* TRENCH FOUNDATION	TON	16	\$30.00	\$480.00
1.11	STORM SEWER, TRENCHED, RCP, CLASS III, 15 IN.	LF	47	\$75.00	\$3,525.00
1.12	STORM SEWER, TRENCHED, RCP, CLASS III, 48 IN.	LF	40	\$200.00	\$8,000.00
1.13	STORM SEWER, TRENCHED, RCP, CLASS III, 54 IN.	LF	28	\$250.00	\$7,000.00
1.14	* REMOVAL OF STORM SEWER GREATER THAN 36 IN.	LF	26	\$50.00	\$1,300.00
1.15	PIPE APRON, CONCRETE, 15 IN.	EA	1	\$1,100.00	\$1,100.00
1.16	PIPE APRON, CONCRETE, 48 IN.	EA	1	\$2,500.00	\$2,500.00
1.17	PIPE APRON, CONCRETE, 54 IN.	EA	1	\$3,000.00	\$3,000.00
1.18	* PREPARATION EXCAVATION FOR TAPPING SLEEVE AND VALVE	LS	1	\$2,500.00	\$2,500.00
1.19	WATER MAIN, TRENCHED, RESTRAINED JOINT, PVC C900, DR18, 8 IN.	LF	100	\$65.00	\$6,500.00
1.20	WATER MAIN, 8 IN., BEND	EA	3	\$500.00	\$1,500.00
1.21	WATER MAIN, 8 IN., CAP	EA	1	\$250.00	\$250.00
1.22	WATER MAIN, 8-IN., SOLID SLEEVE	EA	1	\$300.00	\$300.00
1.23	* REMOVAL OF WATER MAIN, 8 IN., PVC	LF	72	\$15.00	\$1,080.00

8

NO.	DESCRIPTION	ESTIMATED UNITS			AMOUNT
		UNIT	TOTAL	UNIT PRICE	TOTAL
1.24	MANHOLE, STORM SEWER, SW-401, 96 IN.	EA	1	\$10,000.00	\$10,000.00
1.25	HMA PAVEMENT, 6 IN., 1M ESAL, PG 64-22	SY	370	\$45.00	\$16,650.00
1.26	PAVED SHOULDER, HMA 6 IN.	SY	131	\$60.00	\$7,860.00
1.27 *	DRIVEWAY, GRANULAR	TON	17	\$35.00	\$595.00
1.28 *	TRAFFIC CONTROL	LS	1	\$7,500.00	\$7,500.00
1.29 *	CONVENTIONAL SEEDING, TYPE 2 (PERMANENT COOL-SEASON MIXTURE)	AC	0.56	\$5,400.00	\$3,024.00
1.30 *	CONVENTIONAL SEEDING, TYPE 5 (RURAL TEMPORARY EROSION CONTROL MIXTURE)	AC	0.6	\$3,400.00	\$2,040.00
1.31 *	HYDRAULIC SEEDING, FERTILIZING & MULCHING, TYPE 1 (PERMANENT LAWN MIXTURE)	SF	1310	\$0.50	\$655.00
1.32 *	TEMPORARY ROLLED EROSION CONTROL PRODUCTS (RECP)	SY	1462	\$2.00	\$2,924.00
1.33 *	EROSION CONTROL MULCHING, CONVENTIONAL MULCHING	AC	0.6	\$800.00	\$480.00
1.34 *	CHECK DAM, ROCK, INSTALLATION	EA	3	\$1,000.00	\$3,000.00
1.35 *	CHECK DAM, ROCK, CLEAN-OUT	EA	3	\$500.00	\$1,500.00
1.36 *	CHECK DAM, ROCK, REMOVAL	EA	3	\$800.00	\$2,400.00
1.37 *	SILT FENCE, INSTALLATION	LF	750	\$3.00	\$2,250.00
1.38 *	SILT FENCE, REMOVAL OF SEDIMENT	LF	750	\$1.00	\$750.00
1.39 *	SILT FENCE, REMOVAL OF DEVICE	LF	750	\$2.00	\$1,500.00
1.40 *	REVTMENT FOR OUTLET PROTECTION, CLASS E, W/ FABRIC	TON	140	\$45.00	\$6,300.00
1.41	PAINTED PAVEMENT MARKING, WATERBORNE OR SOLVENT-BASED	STA	5.1	\$80.00	\$408.00
1.42 *	TREE PROTECTION PLAN	LS	1	\$1,500.00	\$1,500.00
1.43 *	TREE PROTECTION FENCE	LF	500	\$3.00	\$1,500.00
1.44 *	PROJECT SIGN SMALL-STANDARD	EA	1	\$500.00	\$500.00
	PROJECT 2 - 7700 SE 14TH STREET				
2.01 *	CONSTRUCTION SURVEY	LS	1	\$2,500.00	\$2,500.00
2.02 *	MOBILIZATION	LS	1	\$3,000.00	\$3,000.00
2.03 *	CLEARING & GRUBBING	AC	0.1	\$25,000.00	\$2,500.00
2.04 *	TOPSOIL, OFFSITE (FURNISH & PLACE)	CY	62	\$21.00	\$1,302.00
2.05 *	MISCELLANEOUS FLOWABLE MORTAR	CY	30	\$150.00	\$4,500.00
2.06	REMOVE & REINSTALL CONCRETE PIPE APRON GREATER THAN 36 IN.	EA	1	\$1,500.00	\$1,500.00

NO.	DESCRIPTION	ESTIMATED UNITS			AMOUNT
		UNIT	TOTAL	UNIT PRICE	TOTAL
2.07	* DRIVEWAY, GRANULAR	TON	45	\$35.00	\$1,575.00
2.08	* TRAFFIC CONTROL	LS	1	\$1,500.00	\$1,500.00
2.09	* CONVENTIONAL SEEDING, TYPE 2 (PERMANENT COOL-SEASON MIXTURE)	AC	0.01	\$50,000.00	\$500.00
2.10	* CONVENTIONAL SEEDING, TYPE 5 (RURAL TEMPORARY EROSION CONTROL MIXTURE)	AC	0.05	\$5,000.00	\$250.00
2.11	* HYDRAULIC SEEDING, FERTILIZING & MULCHING, TYPE 1 (PERMANENT LAWN MIXTURE)	SF	1750	\$0.50	\$875.00
2.12	* TEMPORARY ROLLED EROSION CONTROL PRODUCTS (RECP)	SY	100	\$2.00	\$200.00
2.13	* EROSION CONTROL MULCHING, CONVENTIONAL MULCHING	AC	0.05	\$2,000.00	\$100.00
2.14	* SILT FENCE, INSTALLATION	LF	150	\$3.00	\$450.00
2.15	* SILT FENCE, REMOVAL OF SEDIMENT	LF	150	\$1.00	\$150.00
2.16	* SILT FENCE, REMOVAL OF DEVICE	LF	150	\$2.00	\$300.00
2.17	* REVETMENT FOR BANK STABILIZATION, CLASS E, W/ FABRIC	TON	275	\$45.00	\$12,375.00
2.18	* TREE PROTECTION PLAN	LS	1	\$1,000.00	\$1,000.00
2.19	* TREE PROTECTION FENCE	LF	150	\$3.00	\$450.00
2.20	* PROJECT SIGN SMALL-STANDARD	EA	1	\$500.00	\$500.00
2.21	STEEL SHEET PILE	SF	720	\$40.00	\$28,800.00
PROJECT 3 - 228 E. PLEASANT VIEW DRIVE					
3.01	* MOBILIZATION	LS	1	\$2,500.00	\$2,500.00
3.02	* TOPSOIL, OFFSITE (FURNISH & PLACE)	CY	125	\$21.00	\$2,625.00
3.03	* SITE REMOVALS, AS PER PLAN	LS	1	\$500.00	\$500.00
3.04	* MISCELLANEOUS FLOWABLE MORTAR	CY	20	\$150.00	\$3,000.00
3.05	* SEWAGE BYPASSING	LS	1	\$1,000.00	\$1,000.00
3.06	* TRAFFIC CONTROL	LS	1	\$2,500.00	\$2,500.00
3.07	* HYDRAULIC SEEDING, FERTILIZING & MULCHING, TYPE 1 (PERMANENT LAWN MIXTURE)	SF	4500	\$0.50	\$2,250.00
3.08	* REMOVE & REINSTALL WOOD FENCE	LF	33	\$50.00	\$1,650.00
3.09	* PROJECT SIGN SMALL-STANDARD	EA	1	\$500.00	\$500.00
3.10	SHALLOW DEPTH CONCRETE OVERLAY	SF	335	\$25.00	\$8,375.00
3.11	SHALLOW DEPTH CONCRETE REPAIR	SF	200	\$40.00	\$8,000.00
3.12	DEEP CONCRETE REPAIR	SF	120	\$50.00	\$6,000.00

8

NO.	DESCRIPTION	ESTIMATED UNITS			AMOUNT
		UNIT	TOTAL	UNIT PRICE	TOTAL
3.13	DEEP RECONSTRUCTION REPAIR	SF	65	\$65.00	\$4,225.00
3.14	HEADWALL ANCHORS	EA	6	\$2,500.00	\$15,000.00
	PROJECT 4 - 4600 E. SPRING STREET				
4.01 *	CONSTRUCTION SURVEY	LS	1	\$3,500.00	\$3,500.00
4.02 *	MOBILIZATION	LS	1	\$6,000.00	\$6,000.00
4.03 *	CLEARING & GRUBBING	AC	0.35	\$25,000.00	\$8,750.00
4.04 *	TOPSOIL, OFFSITE (FURNISH & PLACE)	CY	390	\$15.00	\$5,850.00
4.05 *	EXCAVATION, CLASS 10, ROADWAY & BORROW (FURNISH & PLACE)	CY	310	\$9.00	\$2,790.00
4.06 *	REMOVAL OF PAVEMENT	SY	235	\$9.00	\$2,115.00
4.07 *	SPECIAL BACKFILL	CY	46	\$35.00	\$1,610.00
4.08 *	SHLD CONSTRUCTION, EARTH	LF	200	\$12.00	\$2,400.00
4.09 *	MISCELLANEOUS FLOWABLE MORTAR	CY	5	\$150.00	\$750.00
4.10	STORM SEWER, TRENCHED, RCP, CLASS III, 24 IN.	LF	81	\$100.00	\$8,100.00
4.11	STORM SEWER, TRENCHED, RCP, CLASS III, 36 IN.	LF	40	\$150.00	\$6,000.00
4.12 *	REMOVAL OF STORM SEWER LESS THAN OR EQUAL TO 36 IN.	LF	110	\$25.00	\$2,750.00
4.13	PIPE APRON, CONCRETE, 24 IN.	EA	1	\$1,500.00	\$1,500.00
4.14	PIPE APRON, CONCRETE, 36 IN.	EA	1	\$2,000.00	\$2,000.00
4.15	SUBDRAIN, PVC, CASE D, 6 IN.	LF	300	\$20.00	\$6,000.00
4.16	SUBDRAIN CLEANOUT, TYPE A-1	EA	6	\$500.00	\$3,000.00
4.17	SUBDRAIN OUTLET	EA	2	\$500.00	\$1,000.00
4.18	MANHOLE, STORM SEWER, SW-401, 60 IN.	EA	1	\$5,000.00	\$5,000.00
4.19	HMA PAVEMENT, 6 IN., 1M ESAL, PG 64-22	SY	235	\$45.00	\$10,575.00
4.20 *	TRAFFIC CONTROL	LS	1	\$5,000.00	\$5,000.00
4.21 *	CONVENTIONAL SEEDING, TYPE 2 (PERMANENT COOL-SEASON MIXTURE)	AC	0.32	\$12,500.00	\$4,000.00
4.22 *	CONVENTIONAL SEEDING, TYPE 5 (RURAL TEMPORARY EROSION CONTROL MIXTURE)	AC	0.32	\$9,500.00	\$3,040.00
4.23 *	TEMPORARY ROLLED EROSION CONTROL PRODUCTS (RECP)	SY	1160	\$2.00	\$2,320.00
4.24 *	EROSION CONTROL MULCHING, CONVENTIONAL MULCHING	AC	0.32	\$800.00	\$256.00
4.25 *	CHECK DAM, ROCK, INSTALLATION	EA	3	\$1,000.00	\$3,000.00

8

NO.	DESCRIPTION	ESTIMATED UNITS			AMOUNT
		UNIT	TOTAL	UNIT PRICE	TOTAL
4.26	* CHECK DAM, ROCK, CLEAN-OUT	EA	3	\$500.00	\$1,500.00
4.27	* CHECK DAM, ROCK, REMOVAL	EA	3	\$800.00	\$2,400.00
4.28	* SILT FENCE, INSTALLATION	LF	500	\$3.00	\$1,500.00
4.29	* SILT FENCE, REMOVAL OF SEDIMENT	LF	500	\$1.00	\$500.00
4.30	* SILT FENCE, REMOVAL OF DEVICE	LF	500	\$2.00	\$1,000.00
4.31	* REVETMENT FOR OUTLET PROTECTION, CLASS E, W/ FABRIC	TON	81	\$45.00	\$3,645.00
4.32	* REMOVE & REINSTALL FIELD FENCE	LF	125	\$10.00	\$1,250.00
4.33	* TEMPORARY GRANULAR SURFACING	TON	84	\$35.00	\$2,940.00
4.34	* TREE PROTECTION PLAN	LS	1	\$1,500.00	\$1,500.00
4.35	* TREE PROTECTION FENCE	LF	250	\$3.00	\$750.00
4.36	* PROJECT SIGN SMALL-STANDARD	EA	1	\$500.00	\$500.00
	PROJECT 5 - 3021 TIMBER HILL COURT				
5.01	* CONSTRUCTION SURVEY	LS	1	\$2,000.00	\$2,000.00
5.02	* MOBILIZATION	LS	1	\$8,500.00	\$8,500.00
5.03	* CLEARING & GRUBBING	AC	0.38	\$25,000.00	\$9,500.00
5.04	* TOPSOIL, OFFSITE (FURNISH & PLACE)	CY	305	\$15.00	\$4,575.00
5.05	* EXCAVATION, CLASS 10, ROADWAY & BORROW (FURNISH & PLACE)	CY	560	\$9.00	\$5,040.00
5.06	* SITE REMOVALS, AS PER PLAN	LS	1	\$1,500.00	\$1,500.00
5.07	SANITARY SEWER STREAM CROSSING ENCASEMENT	LS	1	\$80,000.00	\$80,000.00
5.08	* CONVENTIONAL SEEDING, TYPE 2 (PERMANENT COOL- SEASON MIXTURE)	AC	0.2	\$20,000.00	\$4,000.00
5.09	* CONVENTIONAL SEEDING, TYPE 5 (RURAL TEMPORARY EROSION CONTROL MIXTURE)	AC	0.25	\$12,000.00	\$3,000.00
5.10	* HYDRAULIC SEEDING, FERTILIZING & MULCHING, TYPE 1 (PERMANENT LAWN MIXTURE)	SF	1800	\$0.50	\$900.00
5.11	* TEMPORARY ROLLED EROSION CONTROL PRODUCTS (RECP)	SY	325	\$2.00	\$650.00
5.12	* EROSION CONTROL MULCHING, CONVENTIONAL MULCHING	AC	0.25	\$800.00	\$200.00
5.13	* SILT FENCE, INSTALLATION	LF	600	\$3.00	\$1,800.00
5.14	* SILT FENCE, REMOVAL OF SEDIMENT	LF	600	\$1.00	\$600.00
5.15	* SILT FENCE, REMOVAL OF DEVICE	LF	600	\$2.00	\$1,200.00
5.16	* STABILIZED CONSTRUCTION ENTRANCE	TON	65	\$40.00	\$2,600.00

8

NO.	DESCRIPTION	ESTIMATED UNITS			AMOUNT
		UNIT	TOTAL	UNIT PRICE	TOTAL
5.17	* REVETMENT FOR BANK STABILIZATION, CLASS E, W/ FABRIC	TON	775	\$45.00	\$34,875.00
5.18	* SCOUR STOP REVETMENT, OUTLET PROTECTION	SY	25	\$3.00	\$75.00
5.19	* CONSTRUCTION ACCESS & STAGING	LS	1	\$5,000.00	\$5,000.00
5.20	* TREE PROTECTION PLAN	LS	1	\$1,500.00	\$1,500.00
5.21	* TREE PROTECTION FENCE	LF	1000	\$3.00	\$3,000.00
5.22	* PROJECT SIGN SMALL-STANDARD	EA	1	\$500.00	\$500.00
	PROJECT 8 - 1600 24TH PLACE				
8.01	* CONSTRUCTION SURVEY	LS	1	\$2,000.00	\$2,000.00
8.02	* MOBILIZATION	LS	1	\$4,500.00	\$4,500.00
8.03	* CLEARING & GRUBBING	AC	0.3	\$25,000.00	\$7,500.00
8.04	* TOPSOIL, OFFSITE (FURNISH & PLACE)	CY	365	\$21.00	\$7,665.00
8.05	* EXCAVATION, CLASS 10, ROADWAY & BORROW (FURNISH & PLACE)	CY	680	\$12.00	\$8,160.00
8.06	* SITE REMOVALS, AS PER PLAN	LS	1	\$1,000.00	\$1,000.00
8.07	* REMOVAL OF PAVED DRIVEWAY	SY	86	\$8.00	\$688.00
8.08	* TRENCH FOUNDATION	TON	32	\$30.00	\$960.00
8.09	* STABILIZATION MATERIAL	TON	30	\$30.00	\$900.00
8.10	STORM SEWER, TRENCHED, RCP, CLASS III, 24 IN.	LF	50	\$100.00	\$5,000.00
8.11	STORM SEWER, TRENCHED, RCP, CLASS III, 30 IN.	LF	32	\$125.00	\$4,000.00
8.12	* REMOVAL OF STORM SEWER LESS THAN OR EQUAL TO 36 IN.	LF	14	\$25.00	\$350.00
8.13	PIPE APRON, CONCRETE, 30 IN.	EA	1	\$1,750.00	\$1,750.00
8.14	MANHOLE, STORM SEWER, SW-401, 48 IN.	EA	1	\$3,500.00	\$3,500.00
8.15	MANHOLE, STORM SEWER, SW-401, 60 IN.	EA	1	\$5,000.00	\$5,000.00
8.16	DRIVEWAY, PAVED, PCC, 6 IN.	SY	86	\$40.00	\$3,440.00
8.17	* TRAFFIC CONTROL	LS	1	\$1,500.00	\$1,500.00
8.18	* CONVENTIONAL SEEDING, TYPE 2 (PERMANENT COOL-SEASON MIXTURE)	AC	0.18	\$22,000.00	\$3,960.00
8.19	* CONVENTIONAL SEEDING, TYPE 5 (RURAL TEMPORARY EROSION CONTROL MIXTURE)	AC	0.3	\$10,000.00	\$3,000.00
8.20	* HYDRAULIC SEEDING, FERTILIZING & MULCHING, TYPE 1 (PERMANENT LAWN MIXTURE)	SF	5250	\$0.50	\$2,625.00
8.21	* TEMPORARY ROLLED EROSION CONTROL PRODUCTS (RECP)	SY	315	\$2.00	\$630.00

8

NO.	DESCRIPTION	ESTIMATED UNITS			AMOUNT
		UNIT	TOTAL	UNIT PRICE	TOTAL
8.22 *	EROSION CONTROL MULCHING, CONVENTIONAL MULCHING	AC	0.3	\$800.00	\$240.00
8.23 *	CHECK DAM, ROCK, INSTALLATION	EA	1	\$1,000.00	\$1,000.00
8.24 *	CHECK DAM, ROCK, CLEAN-OUT	EA	1	\$500.00	\$500.00
8.25 *	CHECK DAM, ROCK, REMOVAL	EA	1	\$800.00	\$800.00
8.26 *	SILT FENCE, INSTALLATION	LF	350	\$3.00	\$1,050.00
8.27 *	SILT FENCE, REMOVAL OF SEDIMENT	LF	350	\$1.00	\$350.00
8.28 *	SILT FENCE, REMOVAL OF DEVICE	LF	350	\$2.00	\$700.00
8.29 *	REVTMENT FOR OUTLET PROTECTION, CLASS E, W/ FABRIC	TON	100	\$45.00	\$4,500.00
8.30 *	CONSTRUCTION ACCESS & STAGING	LS	1	\$5,000.00	\$5,000.00
8.31 *	TREE PROTECTION PLAN	LS	1	\$1,500.00	\$1,500.00
8.32 *	TREE PROTECTION FENCE	LF	500	\$3.00	\$1,500.00
8.33 *	PROJECT SIGN SMALL-STANDARD	EA	1	\$500.00	\$500.00
	PROJECT 15 - GREENWOOD TERRACE				
15.01 *	CONSTRUCTION SURVEY	LS	1	\$4,000.00	\$4,000.00
15.02 *	MOBILIZATION	LS	1	\$13,008.00	\$13,008.00
15.03 *	CLEARING & GRUBBING	AC	0.35	\$25,000.00	\$8,750.00
15.04 *	TOPSOIL, OFFSITE (FURNISH & PLACE)	CY	365	\$15.00	\$5,475.00
15.05 *	EXCAVATION, CLASS 10, ROADWAY & BORROW (FURNISH & PLACE)	CY	250	\$9.00	\$2,250.00
15.06 *	SITE REMOVALS, AS PER PLAN	LS	1	\$2,000.00	\$2,000.00
15.07	SANITARY SEWER GRAVITY MAIN, TRENCHED, 8 IN.	LF	154	\$150.00	\$23,100.00
15.08	SANITARY SEWER SERVICE STUB WITH RISER, PVC, 4 IN.	LF	116	\$50.00	\$5,800.00
15.09 *	REMOVAL OF SANITARY SEWER EQUAL TO OR LESS THAN 36 IN.	LF	154	\$25.00	\$3,850.00
15.10	STORM SEWER, TRENCHED, RCP, CLASS III, 15 IN.	LF	28	\$75.00	\$2,100.00
15.11 *	REMOVAL OF STORM SEWER LESS THAN OR EQUAL TO 36 IN.	LF	28	\$25.00	\$700.00
15.12	REMOVE & REINSTALL CONCRETE PIPE APRON LESS THAN OR EQUAL TO 36 IN.	EA	1	\$500.00	\$500.00
15.13	PIPE APRON, CONCRETE, 15 IN.	EA	1	\$1,100.00	\$1,100.00
15.14	SANITARY SEWER STREAM CROSSING ENCASEMENT	LS	1	\$115,000.00	\$115,000.00
15.15 *	SEWAGE BYPASSING	LS	1	\$2,000.00	\$2,000.00

8

NO.	DESCRIPTION	ESTIMATED UNITS			AMOUNT
		UNIT	TOTAL	UNIT PRICE	TOTAL
15.16	MANHOLE, SANITARY SEWER, SW-301, 48 IN.	EA	1	\$5,000.00	\$5,000.00
15.17	MANHOLE, STORM SEWER, SW-401, 48 IN.	EA	1	\$3,500.00	\$3,500.00
15.18 *	REMOVE MANHOLE	EA	1	\$500.00	\$500.00
15.19 *	CONVENTIONAL SEEDING, TYPE 2 (PERMANENT COOL-SEASON MIXTURE)	AC	0.2	\$20,000.00	\$4,000.00
15.20 *	CONVENTIONAL SEEDING, TYPE 5 (RURAL TEMPORARY EROSION CONTROL MIXTURE)	AC	0.3	\$10,000.00	\$3,000.00
15.21 *	HYDRAULIC SEEDING, FERTILIZING & MULCHING, TYPE 1 (PERMANENT LAWN MIXTURE)	SF	4000	\$0.50	\$2,000.00
15.22 *	TEMPORARY ROLLED EROSION CONTROL PRODUCTS (RECP)	SY	165	\$2.00	\$330.00
15.23 *	EROSION CONTROL MULCHING, CONVENTIONAL MULCHING	AC	0.3	\$800.00	\$240.00
15.24 *	CHECK DAM, ROCK, INSTALLATION	EA	2	\$1,000.00	\$2,000.00
15.25 *	CHECK DAM, ROCK, CLEAN-OUT	EA	2	\$500.00	\$1,000.00
15.26 *	CHECK DAM, ROCK, REMOVAL	EA	2	\$800.00	\$1,600.00
15.27 *	SILT FENCE, INSTALLATION	LF	500	\$3.00	\$1,500.00
15.28 *	SILT FENCE, REMOVAL OF SEDIMENT	LF	500	\$1.00	\$500.00
15.29 *	SILT FENCE, REMOVAL OF DEVICE	LF	500	\$2.00	\$1,000.00
15.30 *	STABILIZED CONSTRUCTION ENTRANCE	TON	65	\$40.00	\$2,600.00
15.31 *	REVTMENT FOR BANK STABILIZATION, CLASS E, W/ FABRIC	TON	700	\$45.00	\$31,500.00
15.32 *	REVTMENT FOR OUTLET PROTECTION, CLASS E, W/ FABRIC	TON	40	\$45.00	\$1,800.00
15.33 *	CONSTRUCTION ACCESS & STAGING	LS	1	\$5,000.00	\$5,000.00
15.34 *	TREE PROTECTION PLAN	LS	1	\$1,500.00	\$1,500.00
15.35 *	TREE PROTECTION FENCE	LF	200	\$3.00	\$600.00
15.36 *	PROJECT SIGN SMALL-STANDARD	EA	1	\$500.00	\$500.00

Prepared By: Zach Erickson per Foth Infrastructure and Environment, LLC

Checked By: 

TOTAL CONSTRUCTION COST \$935,000.00

* Item does not have to be included in 4-year maintenance bond, but shall be covered by a 1-year maintenance bond.

* Estimate Total= \$492,542.00