

★ **Roll Call Number**

Agenda Item Number

44

Date February 13, 2012

An Ordinance entitled, "AN ORDINANCE to amend the Municipal Code of the City of Des Moines, Iowa, 2000, adopted by Ordinance No. 13,827, passed June 5, 2000, as heretofore amended, by amending Sections 114-361.02, 114-2630, 114-2631, 114-3248, 114-3331, 114-3422, 114-3761.03, 114-3874, 114-3894, 114-3900, 114-3914, 114-3924, 114-4012 and 114-4041.03, relating to traffic and vehicle regulations",

which was considered and voted upon for the first time under Roll Call No. 12- 0055 of January 9, 2012, and considered and voted upon for the second time under Roll Call No. 12- 0104 of January 23, 2012, again presented.

Moved by _____ that this ordinance do now pass.

ORDINANCE NO. _____

COUNCIL ACTION	YEAS	NAYS	PASS	ABSENT
COWNIE				
COLEMAN				
GRIESS				
HENSLEY				
MAHAFFEY				
MEYER				
MOORE				
TOTAL				

MOTION CARRIED

APPROVED

Mayor

CERTIFICATE

I, DIANE RAUH, City Clerk of said City hereby certify that at a meeting of the City Council of said City of Des Moines, held on the above date, among other proceedings the above was adopted.

IN WITNESS WHEREOF, I have hereunto set my hand and affixed my seal the day and year first above written.

City Clerk

 <p style="text-align: center;">Council Communication Office of the City Manager</p>	Date: January 9, 2012
	Agenda Item No. 36
	Roll Call No. [12-0055]
	Communication No. <u>Council</u> <u>Communication: 12-004</u>
Submitted by: Jeb E. Brewer, P.E. City Engineer	

AGENDA HEADING:

Amending Chapter 114 of the Municipal Code regarding traffic regulation changes as follows:

- A. Ten-hour Parking Meters on the South Side of Grand Avenue West of 13th Street.
- B. Removal of Special School Loading and Unloading Restrictions on 5th Avenue from Grand Avenue to Locust Street.
- C. Parking Citations for Illegal Off-Street Parking.
- D. Extension of Existing Loading Zone—South Side of 400 Block of Watson Powell Jr. Way.
- E. Parking Restriction Due to Intersection Improvements--North Side of Hull Avenue East of E 14th Street.
- F. Adjustments to the Loading and Unloading Times Adjacent to Walnut Street School—On the West Side of 9th Street and the East Side of 10th Street North of Walnut Street to Locust Street.

SYNOPSIS:

Recommend approval of the staff recommendations, including first reading of the Ordinance regarding the traffic regulation changes.

FISCAL IMPACT:

Amount: Minor costs for signing modifications.

Funding Source: 2011-2012 Operating Budget, Engineering Department Traffic & Transportation - Sign Installation and Maintenance, SP360, ENG100413, Page 98.

ADDITIONAL INFORMATION:

- A. Requests were received in the past six months to examine parking meters on the south side of Grand Avenue in the Western Gateway to accommodate area users that wanted more time to enjoy the sculpture park, library and area businesses. These users stated that they often found four hours was not enough time. The requested changes below will accommodate these requests.

Sec. 114-4012. Grand Avenue--Thirteenth Street to Fifteenth Street.

~~Grand Avenue, on the south side, from a point 20 feet west of Thirteenth Street to a point 33 feet west of Fifteenth Street, four hour meters, 8:00 a.m. to 6:00 p.m.~~

Grand Avenue, on the south side, from a point 300 feet west of Thirteenth Street to a point 70 feet west thereof, ten-hour meters, 8:00 a.m. to 6:00 p.m.; meter G-1324 and G-1326 are designated as handicapped parking spaces and are subject to the same prohibitions as are found in subsection 114-616(a) of this chapter.

Grand Avenue, on the south side, from a point 20 feet west of Thirteenth Street to a point 824 ft west thereof, ten-hour meters, 8:00 a.m. to 6:00 p.m.

B. With the departure of the downtown school in the vicinity of 5th Avenue and Grand Avenue, there is no longer a need for special school loading and unloading restrictions on 5th Avenue from Grand Avenue to Locust Street. These requested ordinance changes will remove the special school loading and unloading restrictions that were in place to meet the needs of the downtown school, and will return the parking restrictions in these areas to ones compatible with the use of that area.

Sec. 114-3422. Locust Street—Fourth Street to Fifth Avenue.

~~Locust Street, on the south side, from Fourth Street to a point 180 feet west thereof, school passenger loading and unloading, 7:00 a.m. to 9:00 a.m. and 3:00 p.m. to 6:00 p.m., Monday through Friday and 2:00 p.m. to 3:00 p.m., Wednesday, 20 minutes only.~~

Sec. 114-3924. Locust Street—Fourth Street to Fifth Avenue.

~~Locust Street, on the south side, from Fourth Street to a point 180 feet west thereof, two-hour meters, 8:00 9:00 a.m. to 6:00 3:00 p.m., Monday, Tuesday, Thursday and Friday and 9:00 a.m. to 2:00 p.m. on Wednesday.~~

Sec. 114-3248. Grand Avenue—Fifth Avenue to Sixth Avenue.

~~Grand Avenue, on the south side, from Fifth Avenue to Sixth Avenue, school passenger loading and unloading, 7:00 a.m. to 9:00 a.m. and 3:00 p.m. to 6:00 p.m., Monday through Friday and 2:00 p.m. to 3:00 p.m., Wednesday, 20 minutes only.~~

Sec. 114-3914. Grand Avenue—Fifth Avenue to Sixth Avenue.

~~Grand Avenue, on the south side, from Fifth Avenue to Sixth Avenue, two-hour meters, 8:00 9:00 a.m. to 6:00 3:00 p.m., Monday, Tuesday, Thursday and Friday and 9:00 a.m. to 2:00 p.m. on Wednesday.~~

Sec. 114-2630. Fifth Avenue—Walnut Street to Locust Street.

~~Fifth Avenue, on the west side, from Walnut Street to a point 130 feet north thereof, school passenger loading and unloading, 7:00 a.m. to 9:00 a.m. and 3:00 p.m. to 5:00 p.m., Monday through Friday, and 2:00 p.m. to 3:00 p.m., Wednesday, 20 minutes only.~~

~~Fifth Avenue, on the west side, from a point 105 feet north of Walnut Street to a point 25 feet north thereof, school passenger loading and unloading, 7:00 a.m. to 9:00 a.m. and 3:00 p.m. to 5:00 p.m., Monday, Tuesday, Thursday and Friday, and 2:00 p.m. to 3:00 p.m., Wednesday, 20 minutes only, no parking at all other times.~~

~~Fifth Avenue, on the west side, from a point 240 feet north of Walnut Street to Locust Street, no parking 7:00 a.m. to 9:00 a.m. school passenger loading and unloading, 7:00 a.m. to 9:00 a.m. and 3:00 p.m. to 5:00 p.m., Monday through Friday and 2:00 p.m. to 3:00 p.m., Wednesday, 20 minutes only.~~

Sec. 114-3874. Fifth Avenue—Walnut Street to Locust Street.

~~Fifth Avenue, on the west side, from Walnut Street to a point 130 feet north thereof, two-hour meters, 8:00 9:00 a.m. to 3:00 p.m. and 5:00 p.m. and 6:00 p.m., Monday, Tuesday, Thursday and Friday and 9:00 a.m. to 2:00 p.m. and 5:00 p.m. to 6:00 p.m., on Wednesday.~~

~~Fifth Avenue, on the west side, from a point 240 feet north of Walnut Street to Locust Street, two-hour meters, 8:00 9:00 a.m. to 3:00 p.m. and 5:00 p.m. to 6:00 p.m., Monday, Tuesday, Thursday and Friday and 9:00 a.m. to 2:00 p.m. and 5:00 p.m. to 6:00 p.m. on Wednesday.~~

Sec. 114-2631. Fifth Avenue—Locust Street to Grand Avenue.

~~Fifth Avenue, on the west side, from Locust Street to Grand Avenue, no parking any time. school passenger loading and unloading, 7:00 a.m. to 9:00 a.m. and 3:00 p.m. to 6:00 p.m., Monday through Friday and 2:00 p.m. to 3:00 p.m., Wednesday, 20 minutes only; no parking at all other times; loading zone, 9:00 a.m. to 3:00 p.m., Monday through Friday and 9:00 a.m. to 2:00 p.m., Wednesday.~~

C. A parking citation received in an off-street parking facility for illegal parking was recently appealed because parking enforcement officers are not given a choice of action when dealing with an illegally parked off-street vehicle. The Municipal Code, in 114-316.02 (a) indicates that the only allowable action in an off-street situation is impounding the vehicle. The downtown parking enforcement unit will often impound a vehicle when it is owned by a habitual violator. Parking enforcement needs the option of writing an illegal parking citation in these situations so that the habitual violations can be documented, as they are able to do in similar on-street situations. The change to the wording below would allow illegal parking citations to be written in these off-street parking areas.

Sec. 114-361.02. Illegal off-street parking.

(a) No person shall drive, stop, stand or park a vehicle onto or upon privately owned property or an area developed as an off-street parking facility, without the consent of the owner, lessee or person in charge of the privately owned property or facility. If a parking permit is issued by the property owner to the lessee, it must be displayed. A violation of this section shall place such vehicle in the status of an illegally parked vehicle and, upon complaint of the owner, lessee or person in charge of the privately owned property or facility, the vehicle may be dealt with pursuant to section 114-485.01 and/or 114-485.11 of this chapter.

D. As part of Roll Call Number 11-1637, the City has agreed to extend an existing loading zone on the south side of the 400 block of Watson Powell Jr. Way by three parking spaces. The changes below will accomplish this and relocate an existing handicapped parking meter that was located in this area.

Sec. 114-4041.03. Watson Powell Jr. Way--Fourth Street to Fifth Avenue.

Watson Powell Jr. Way, on the south side, from a point 30 feet west of Fourth Street to a point 95 feet west thereof, four hour meters, ~~9:00~~ 8:00 a.m. to 4:00 p.m.

Watson Powell Jr. Way, on the south side, from a point ~~175 feet west of Fourth Street~~ 208 feet east of Fifth Avenue to a point ~~90~~ 23 feet ~~west~~ east thereof, ~~hour~~ four hour meters, ~~9:00~~ 8:00 a.m. to 4:00 p.m.

Watson Powell Jr. Way, on the south side, parking meters WP-400 and WP-410 408, four-hour meters, ~~9:00~~ 8:00 a.m. to 4:00 p.m., are designated as handicapped parking spaces and are subject to the same prohibition as is found in subsection 114-616(a) of this chapter.

Sec. 114-3761.03. Watson Powell Jr. Way--Fourth Street to Fifth Avenue.

Watson Powell Jr. Way, on the south side, from ~~Watson Powell Jr. Way~~ 4th Street to a point 30 feet west thereof, no parking any time.

Watson Powell Jr. Way, on the south side, from a point ~~265 feet west of Fourth Street~~ to a point ~~45 feet west thereof, commercial~~ 101 feet east of Fifth Avenue to a point 107 feet east thereof, loading zone 8:00 a.m. to 4:00 p.m.

E. This parking restriction revision is due to intersection widening and intersection improvements at E 14th Street and Hull Avenue to allow for a smooth safe transition entering and exiting the intersection from the east side. The following revision to the Municipal Code will place this parking restriction into effect.

Sec. 114-3331. Hull Avenue—East Fourteenth Street to east city limits.

Hull Avenue, on the north side, from East Fourteenth Street to a point ~~50~~ 285 feet east thereof, no parking any time.

F. In cooperation with Craig Leager, Principal of the Walnut Street School, the Traffic and Transportation Division has surveyed the areas on 9th Street and 10th Streets, from Locust Street to Walnut Streets and adjusted the loading and unloading times to meet the current times needed by the Walnut Street School, including their early-out times on Wednesdays. The recommended changes have been listed below. These changes will increase the length of the most active drop-off and pick-up area, on 9th Street and also implement the early out times, on 9th Street and 10th Street, which had not been reflected on the parking restriction signs posted in this area.

Sec. 114-3894. Ninth Street--Walnut Street to Locust Street.

Ninth Street, on the west side, from a point 90 feet north of Walnut Street to Locust Street, ~~two-hour meters, 8:00 a.m. to 6:00 p.m., except from a point 90 feet north of Walnut Street to a point 80 feet north thereof, two-hour meters, 9:00 a.m. to 3:00 p.m., Monday, Tuesday, Thursday and Friday and 9:00 a.m. to 1:00 p.m. and 3:00 p.m. to 4:00 p.m. on Wednesday, school days. An authorized school placard is required to identify vehicles dropping off and picking up during restricted hours. Twenty minute limit for all school loading & unloading.~~

Sec. 114-3900. Tenth Street--Walnut Street to Locust Street.

44

Tenth Street, on the east side, from a point 185 feet north of Walnut Street to Locust Street, four-hour meters, 8:00 a.m. to 4:00 p.m., school loading and unloading weekdays from 7:00 a.m. to 9:00 a.m. and 3:00 p.m. to 4:00 p.m., except on Wednesday, from 1:00 p.m. to 3:00 p.m. when school early-out loading and unloading is allowed. An authorized school placard is required to identify vehicles dropping off and picking up during these restricted hours. Twenty minute limit for all school loading & unloading.

PREVIOUS COUNCIL ACTION(S): NONE

BOARD/COMMISSION ACTION(S): NONE

ANTICIPATED ACTIONS AND FUTURE COMMITMENTS: NONE

For more information on this and other agenda items, please call the City Clerk's Office at 515-283-4209 or visit the Clerk's Office on the second floor of City Hall, 400 Robert D. Ray Drive. Council agendas are available to the public at the City Clerk's Office on Thursday afternoon preceding Monday's Council meeting. Citizens can also request to receive meeting notices and agendas by email by calling the Clerk's Office or sending their request via email to cityclerk@dmgov.org.

~~12-0055~~ 36
12-0104
44

ORDINANCE NO. _____

AN ORDINANCE to amend the Municipal Code of the City of Des Moines, Iowa, 2000, adopted by Ordinance No. 13,827, passed June 5, 2000, as heretofore amended, by amending Sections 114-361.02, 114-2630, 114-2631, 114-3248, 114-3331, 114-3422, 114-3761.03, 114-3874, 114-3894, 114-3900, 114-3914, 114-3924, 114-4012 and 114-4041.03, relating to traffic and vehicle regulations.

Be It Ordained by the City Council of the City of Des Moines, Iowa:

Section 1. That the Municipal Code of the City of Des Moines, Iowa, 2000, adopted by Ordinance No. 13,827, passed June 5, 2000, as heretofore amended, is hereby amended by amending Sections 114-361.02, 114-2630, 114-2631, 114-3248, 114-3331, 114-3422, 114-3761.03, 114-3874, 114-3894, 114-3900, 114-3914, 114-3924, 114-4012 and 114-4041.03 relating to traffic and vehicle regulations, as follows:

Sec. 114-361.02. Illegal off-street parking.

- (a) No person shall drive, stop, stand, or park a vehicle onto or upon privately owned property or an area developed as an off-street parking facility, without the consent of the owner, lessee or person in charge of the privately owned property or facility. If a parking permit is issued by the property owner to the lessee, it must be displayed. A violation of this section shall place such vehicle in the status of an illegally parked vehicle and, upon complaint of the owner, lessee or person in charge of the privately owned property or facility, the vehicle may be dealt with pursuant to section 114-485.01 and/or 114-485.11 of this chapter.
- (b) No person shall park a vehicle in violation of the front yard parking provisions in subsection 134-1377(m) of this Code.
- (c) No person shall park a vehicle a vehicle in violation of the site plan parking provisions in subsection 82-219(b) of this Code.
- (d) A person who violates any provisions of this section shall pay a fine of \$40.00.

Sec. 114-2630. Fifth Avenue--Walnut Street to Locust Street.

Fifth Avenue, southbound, on the east side (median) from Walnut Street to Locust Street, no parking 7:00 a.m. to 9:00 a.m. and 4:00 p.m. to 6:00 p.m.

~~Fifth Avenue, on the west side, from Walnut Street to a point 130 feet north thereof, school passenger loading and unloading, 7:00 a.m. to 9:00 a.m. and 3:00 p.m. to 5:00 p.m., Monday through Friday and 2:00 p.m. to 3:00 p.m., Wednesday, 20 minutes only.~~

~~Fifth Avenue, on the west side, from a point 105 feet north of Walnut Street to a point 25 feet north thereof, school passenger loading and unloading, 7:00 a.m. to 9:00 a.m. and 3:00 p.m. to 5:00 p.m., Monday, Tuesday, Thursday and Friday, and 2:00 p.m. to 3:00 p.m., Wednesday, 20 minutes only, no parking at all other times.~~

Fifth Avenue, on the west side, from a point 130 feet north of Walnut Street to a point 25 feet north thereof, commercial loading zone, 8:00 a.m. to 6:00 p.m.

Fifth Avenue, on the west side, from a point 155 feet north of Walnut Street to a point 85 feet north thereof, no parking any time.

~~Fifth Avenue, on the west side, from a point 240 feet north of Walnut Street to Locust Street, no parking 7:00 a.m. to 9:00 a.m. school passenger loading and unloading, 7:00 a.m. to 9:00 a.m. and 3:00 p.m. to 5:00 p.m., Monday through Friday and 2:00 p.m. to 3:00 p.m., Wednesday, 20 minutes only.~~

Fifth Avenue, on the east side, from Walnut Street to a point 125 feet north thereof, loading zone.

Fifth Avenue, on the east side, from a point 125 feet north of Walnut Street to Locust Street, no parking any time.

Sec. 114-2631. Fifth Avenue--Locust Street to Grand Avenue.

Fifth Avenue, on the east side, from Locust Street to Grand Avenue, no parking any time.

~~Fifth Avenue, on the west side, from Locust Street to Grand Avenue, no parking any time. school passenger loading and unloading, 7:00 a.m. to 9:00 a.m. and 3:00 p.m. to 6:00 p.m., Monday through Friday and 2:00 p.m. to 3:00 p.m., Wednesday, 20 minutes only; no parking at all other times; loading zone, 9:00 a.m. to 3:00 p.m., Monday through Friday and 9:00 a.m. to 2:00 p.m., Wednesday.~~

Sec. 114-3248. Grand Avenue--Fifth Avenue to Sixth Avenue.

Grand Avenue, on the north side, from Fifth Avenue to a point 150 feet west thereof, passenger loading zone.

Grand Avenue, on the north side, from Fifth Avenue to a point 150 feet west thereof, no parking 7:00 a.m. to 9:00 a.m.

Grand Avenue, on the north side, from Fifth Avenue to a point 150 feet west thereof, no parking 4:00 p.m. to 6:00 p.m.

Grand Avenue, on the north side, from a point 150 feet west of Fifth Avenue to Sixth Avenue, no parking any time.

~~Grand Avenue, on the south side, from Fifth Avenue to Sixth Avenue, school passenger loading and unloading, 7:00 a.m. to 9:00 a.m. and 3:00 p.m. to 6:00 p.m., Monday through Friday and 2:00 p.m. to 3:00 p.m., Wednesday, 20 minutes only.~~

Sec. 114-3331. Hull Avenue--East Fourteenth Street to east city limits.

Hull Avenue, on the north side, from a point 250 feet east of Sampson Street to a point 100 feet east of Delaware Avenue, no parking any time.

Hull Avenue, on the north side, from Delaware Avenue to a point 600 feet west thereof, no parking any time.

Hull Avenue, on the north side, from East Thirty-ninth Court to East Fortieth Court, no parking 10:00 p.m. to 7:00 a.m.

Hull Avenue, on the north side, from East Fourteenth Street to a point ~~50~~ 285 feet east thereof, no parking any time.

Hull Avenue, on the south side, from East Fourteenth Street to a point 250 feet west of East Twenty-fourth Street, no parking any time.

Hull Avenue, on the south side, from East Twenty-fourth Street to a point 250 feet west thereof, no stopping or standing.

Hull Avenue, on the north side, from East Twenty-fourth Street to a point 50 feet east thereof, no parking any time.

Hull Avenue, on the south side, from East Twenty-fourth Street to East Twenty-ninth Street, no parking any time.

Hull Avenue, on the north side, from East Twenty-fifth Street to a point 75 feet west thereof, no parking any time.

Hull Avenue, on the south side, from a point 50 feet west of East Twenty-sixth Street to a point 50 feet east of East Twenty-sixth Street, no parking any time.

Hull Avenue, on the south side, from East Thirty-second Street to East Thirty-second Court, no parking any time.

Hull Avenue, on the north side, from East Thirty-fifth Street to East Thirty-eighth Street, no parking any time.

Hull Avenue, on the south side, from East Thirty-eighth Street to East Fortieth Court, no parking any time.

Hull Avenue, on the north side, from East Fortieth Court to East Forty-second Street, no parking any time.

Hull Avenue, on the south side, from East Forty-second Street to a point 100 feet west thereof, no parking any time.

Hull Avenue, on the north side, from East Forty-second Street to a point 70 feet east thereof, no parking any time.

Hull Avenue, on the south side, from East Forty-second Street to a point 590 feet east thereof, no parking any time.

Sec. 114-3422. Locust Street--Fourth Street to Fifth Avenue.

~~Locust Street, on the south side, from Fourth Street to a point 180 feet west thereof, school passenger loading and unloading, 7:00 a.m. to 9:00 a.m. and 3:00 p.m. to 6:00 p.m. Monday through Friday and 2:00 p.m. to 3:00 p.m., Wednesday, 20 minutes only.~~

Locust Street, on the south side, from a point 180 feet west of Fourth Street to Fifth Avenue, no parking any time.

Locust Street, on the north side, from a point 25 feet west of Fourth Street to a point 60 feet east of Fifth Avenue, no parking 7:00 a.m. to 9:00 a.m.

Locust Street, on the north side, from Fourth Street to a point 25 feet west thereof, no parking any time.

Locust Street, on the north side, from a point 25 feet west of Fourth Street to a point 85 feet west thereof, loading zone 9:00 a.m. to 7:00 a.m. the following day.

Locust Street, on the north side, from a point 110 feet west of Fourth Street to a point 80 feet west thereof, taxicab stand 9:00 a.m. to 7:00 a.m. the following day.

Locust Street, on the north side, from Fifth Avenue, to a point 60 feet east thereof, no parking any time.

Sec. 114-3761.03. Watson Powell Jr Way--Fourth Street to Fifth Avenue.

~~Watson Powell Jr Way, on the south side, from Watson Powell Jr Way Fourth Street to a point 30 feet west thereof, no parking any time.~~

Watson Powell Jr Way, on the south side, from Fourth Street to Fifth Avenue, no parking 4:00 p.m. to 6:00 p.m.

Watson Powell Jr Way, on the south side, from a point 125 feet west of Fourth Street to a point 50 feet west thereof, commercial loading zone.

~~Watson Powell Jr Way, on the south side, from a point 101 feet east of Fifth Avenue to a point 107 feet east thereof, loading zone, 8:00 a.m. to 4:00 p.m. 265 feet west of Fourth Street to a point 45 feet west thereof, commercial loading zone.~~

Watson Powell Jr Way, on the south side, from a point 310 feet west of Fourth Street to Fifth Avenue, no parking any time.

Sec. 114-3874. Fifth Avenue--Walnut Street to Locust Street.

~~Fifth Avenue, on the west side, from Walnut Street to a point 130 feet north thereof, two-hour meters, 8:00 a.m. to 6:00 p.m. 9:00 a.m. to 3:00 p.m. and 5:00 p.m. and 6:00 p.m., Monday, Tuesday, Thursday and Friday and 9:00 a.m. to 2:00 p.m. and 5:00 p.m. to 6:00 p.m., on Wednesday.~~

Fifth Avenue, on the west side, from a point 240 feet north of Walnut Street to Locust Street, two-hour meters, 8:00 a.m. to 6:00 p.m. ~~9:00 a.m. to 3:00 p.m. and 5:00 p.m. to 6:00 p.m., Monday, Tuesday, Thursday and Friday and 9:00 a.m. to 2:00 p.m. and 5:00 p.m. to 6:00 p.m. on Wednesday.~~

Sec. 114-3894. Ninth Street--Walnut Street to Locust Street.

Ninth Street, on the east side, from Walnut Street to Locust Street, two-hour meters, 9:00 a.m. to 4:00 p.m.

Ninth Street, on the west side, from a point 90 feet north of Walnut Street to Locust Street, two-hour meters, 9:00 a.m. to 3:00 p.m., Monday, Tuesday, Thursday and Friday and 9:00 a.m. to 1:00 p.m. and 3:00 p.m. to 4:00 p.m. on Wednesday, school days. An authorized school placard is required to identify vehicles dropping off and picking up during restricted hours. Twenty-minute limit for all school loading and unloading. ~~8:00 a.m. to 6:00 p.m., except from a point 90 feet north of Walnut Street to a point 80 feet north thereof, two hour meters, 9:00 a.m. to 3:00 p.m. school days.~~

Sec. 114-3900. Tenth Street--Walnut Street to Locust Street.

Tenth Street, on the west side, from a point 30 feet south of Locust Street to a point 158 feet north of Walnut Street, four-hour meters, 8:00 a.m. to 6:00 p.m.

Tenth Street, on the west side, from a point 28 feet north of Walnut Street to a point 130 feet north thereof, four-hour meters, 9:00 a.m. to 6:00 p.m.

Tenth Street, on the east side, from a point 185 feet north of Walnut Street to Locust Street, four-hour meters, 8:00 a.m. to 4:00 p.m., school loading and unloading weekdays from 7:00 a.m. to 9:00 a.m. and 3:00 p.m. to 4:00 p.m., except on Wednesday, from 1:00 p.m. to 3:00 p.m. when school early-out loading and unloading is allowed. An authorized school placard is required to identify vehicles dropping off and picking up during these restricted hours. Twenty-minute limit for all school loading and unloading.

Tenth Street, on the east side, from Walnut Street to a point 185 feet north thereof, two-hour meters, 9:00 a.m. to 3:00 p.m.

Sec. 114-3914. Grand Avenue--Fifth Avenue to Sixth Avenue.

Grand Avenue, on the south side, from Fifth Avenue to Sixth Avenue, two-hour meters, 8:00 a.m. to 6:00 p.m. ~~9:00 a.m. to 3:00 p.m., Monday, Tuesday, Thursday and Friday and 9:00 a.m. to 2:00 p.m. on Wednesday.~~

Grand Avenue on the south side, parking meter G-510, two-hour meter, 8:00 a.m. to 6:00 p.m., is designated a handicapped parking space and is subject to the same prohibition as is found in subsection 114-616(a) of this chapter.

Grand Avenue, on the south side, parking meter G-512, two-hour meter, 8:00 a.m. to 6:00 p.m., is designated a handicapped parking space and is subject to the same prohibition as is found in subsection 114-616(a) of this chapter.

Grand Avenue, on the south side, parking meter G-520, two-hour meter, 8:00 a.m. to 6:00 p.m., is designated a handicapped parking space and is subject to the same prohibition as is found in subsection 114-616(a) of this chapter.

Sec. 114-3924. Locust Street--Fourth Street to Fifth Avenue.

Locust Street, on the south side, from Fourth Street to a point 180 feet west thereof, two-hour meters, 8:00 a.m. to 6:00 p.m. ~~9:00 a.m. to 3:00 p.m., Monday, Tuesday, Thursday and Friday and 9:00 a.m. to 2:00 p.m. on Wednesday.~~

Locust Street, on the north side, from a point 190 feet west of Fourth Street to a point 60 feet west thereof, two-hour meters, 9:00 a.m. to 6:00 p.m.

Sec. 114-4012. Grand Avenue--Thirteenth Street to Fifteenth Street.

Grand Avenue, on the south side, from a point 20 feet west of Thirteenth Street to a point 33 feet west of Fifteenth Street, four-hour meters, 8:00 a.m. to 6:00 p.m.

Grand Avenue, on the north side, from a point ten feet west of Fourteenth Street to a point 235 feet west thereof, four-hour meters, 8:00 a.m. to 4:00 p.m.

Grand Avenue, on the north side, from a point 98 feet east of Fifteenth Street to a point 22 feet east thereof, four-hour meters, 8:00 a.m. to 4:00 p.m.

Grand Avenue, on the south side, from a point 96 feet west of Thirteenth Street to a point 33 feet west of Fifteenth Street, four-hour meters, 8:00 a.m. to 6:00 p.m.

Grand Avenue, on the south side, from a point 300 feet west of Thirteenth Street to a point 70 feet west thereof, ten-hour meters, 8:00 a.m. to 6:00 p.m.; meter G-1324 and G-1326 are designated as handicapped parking spaces and are subject to the same prohibitions as are found in subsection 114-616(a) of this chapter.

Grand Avenue, on the south side, from a point 20 feet west of Thirteenth Street to a point 824 feet west thereof, ten-hour meters, 8:00 a.m. to 6:00 p.m.

Sec. 114-4041.03. Watson Powell Jr Way--Fourth Street to Fifth Avenue.

Watson Powell Jr Way, on the south side, from a point 30 feet west of Fourth Street to a point 125 95 feet west thereof, four hour meters, ~~9:00~~8:00 a.m. to 4:00 p.m.

~~12-0055~~
12-0104

36
~~31~~
44

Watson Powell Jr Way, on the south side, from a point ~~175 feet~~
~~west of Fourth Street~~ 208 feet east of Fifth Avenue to a point ~~90~~
23 feet west east thereof, ~~hour~~ four hour meters, ~~9:00~~8:00 a.m. to
4:00 p.m.

Watson Powell Jr Way, on the north side, from Fourth Street to
Fifth Avenue, four hour meters, 8:00 a.m. to 6:00 p.m.

Watson Powell Jr Way, on the south side, parking meters WP-400
and ~~WP-410~~ WP-408, four-hour meters, ~~9:00~~8:00 a.m. to 4:00 p.m.,
are designated as handicapped parking spaces and are subject to the
same prohibition as is found in subsection 114-616(a) of this
chapter.

Section 2. This ordinance shall be in full force and effect
from and after its passage and publication as provided by law.

FORM APPROVED:

K. Massier
Katharine Massier
Assistant City Attorney

31 36 44

AN ORDINANCE to amend the Municipal Code of the City of Des Moines, Iowa, 2000, adopted by Ordinance No. 13,827, passed June 5, 2000, as heretofore amended, by amending Chapter 114 Traffic & Vehicle Regulations as summarized below. The complete text of the ordinance is available in the City of Des Moines City Clerk's Office, 400 Robert D. Ray Drive, Des Moines, Iowa, or on the City of Des Moines' website at www.dmgov.org.

DES MOINES TRAFFIC REGULATION CHANGES

Amending Chapter 114 of the Municipal Code regarding traffic regulation changes as follows:

- A. Ten-hour Parking Meters on the South Side of Grand Avenue West of 13th Street.
- B. Removal of Special School Loading and Unloading Restrictions on 5th Avenue from Grand Avenue to Locust Street.
- C. Parking Citations for Illegal Off-Street Parking.
- D. Extension of Existing Loading Zone—South Side of 400 Block of Watson Powell Jr. Way.
- E. Parking Restriction Due to Intersection Improvements--North Side of Hull Avenue East of E 14th Street.
- F. Adjustments to the Loading and Unloading Times Adjacent to Walnut Street School—On the West Side of 9th Street and the East Side of 10th Street North of Walnut Street to Locust Street.

FORM APPROVED:

Katharine Massier, Assistant City Attorney

T.M. Franklin Cownie, Mayor

Attest:

I, Diane Rauh, City Clerk of the City of Des Moines, Iowa, hereby certify that the above and foregoing is a summary of Ordinance No. _____, passed by the City Council of said City on _____, signed by the Mayor on _____, and published as provided by law in the Business Record on _____. Authorized by Publication Order No. _____.

Diane Rauh, City Clerk

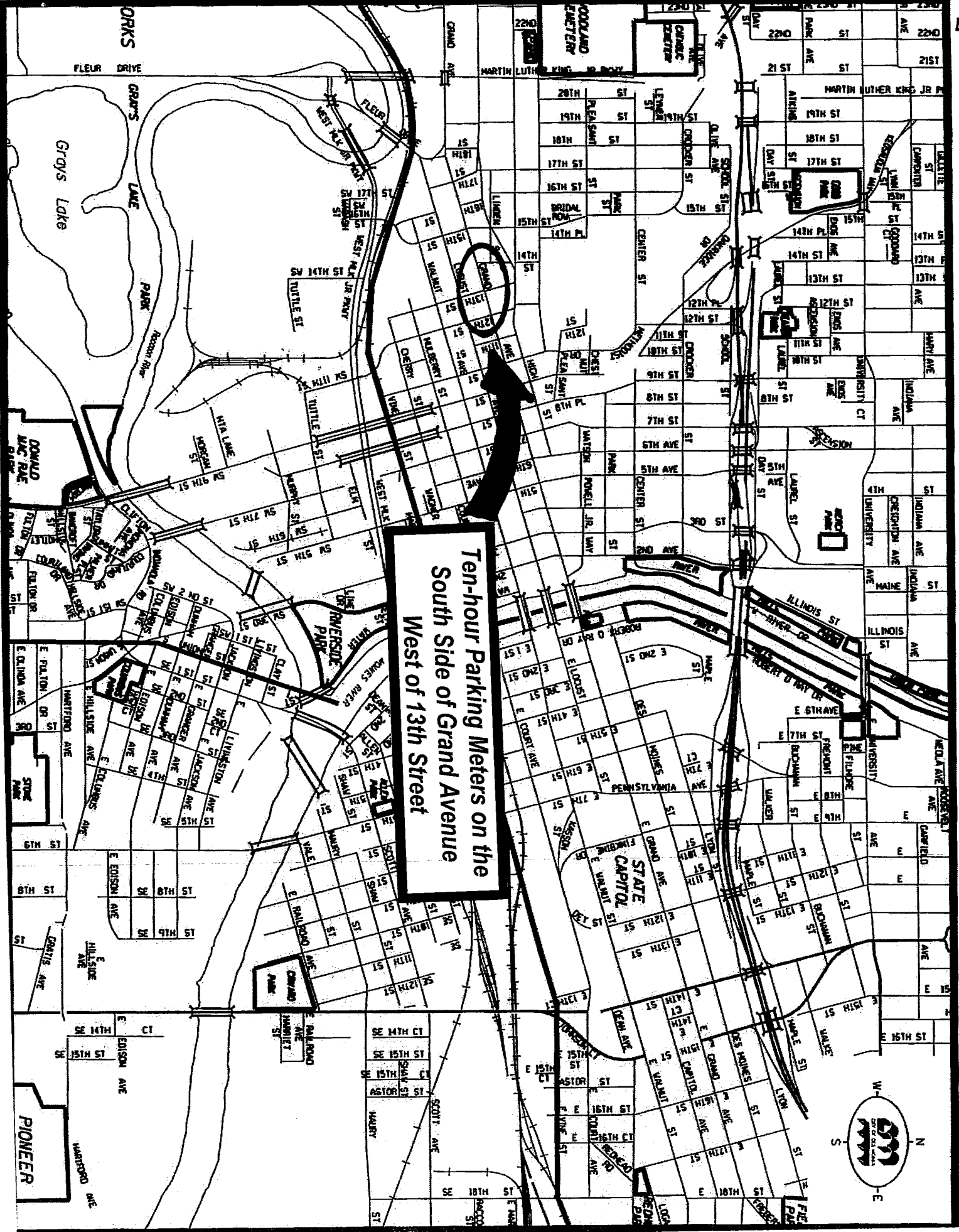

Ten-hour Parking Meters on the
South Side of Grand Avenue
West of 13th Street

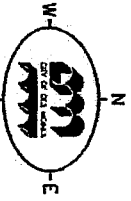

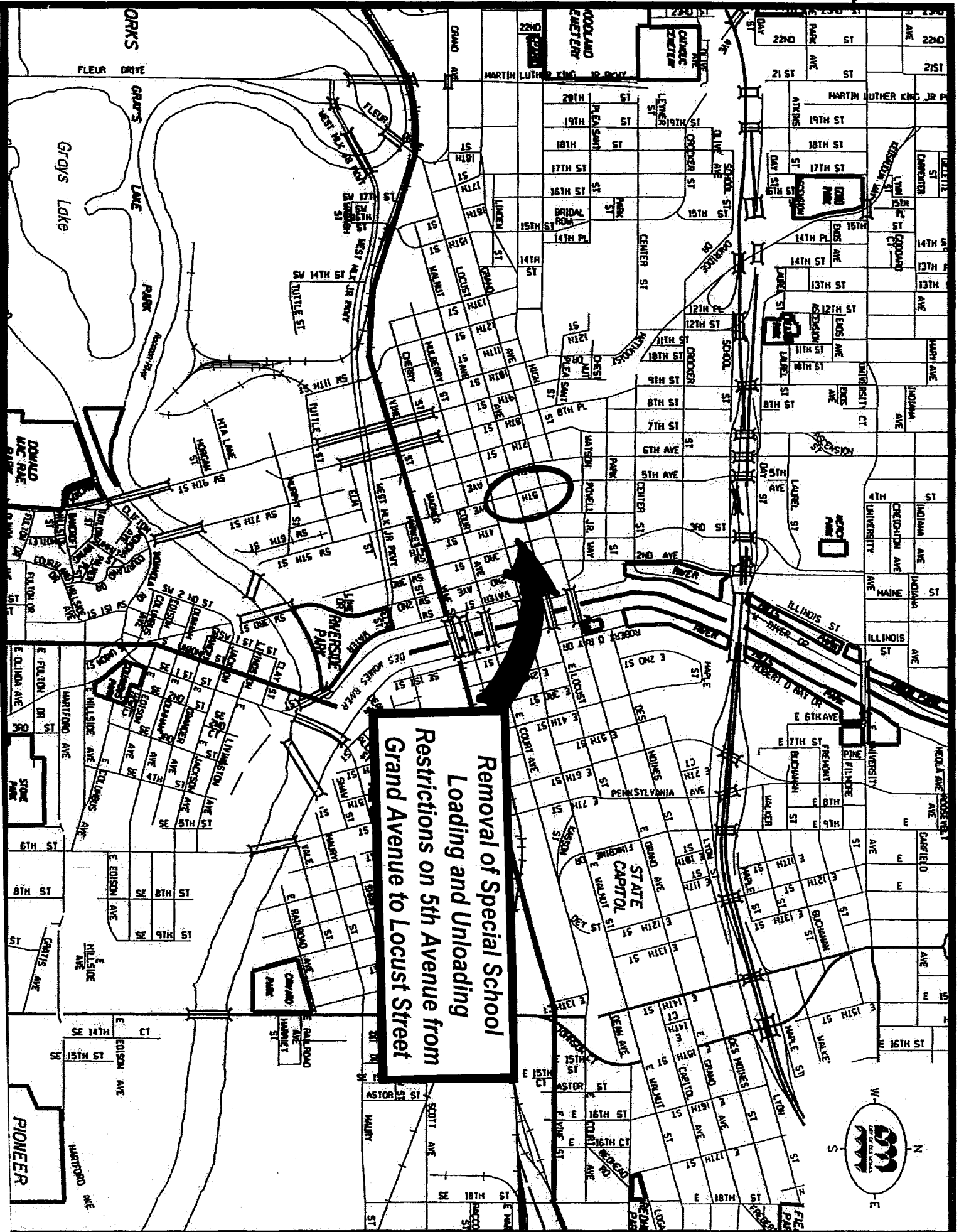

**Removal of Special School
Loading and Unloading
Restrictions on 5th Avenue from
Grand Avenue to Locust Street**

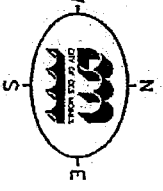

12-0104
12-6055 363D

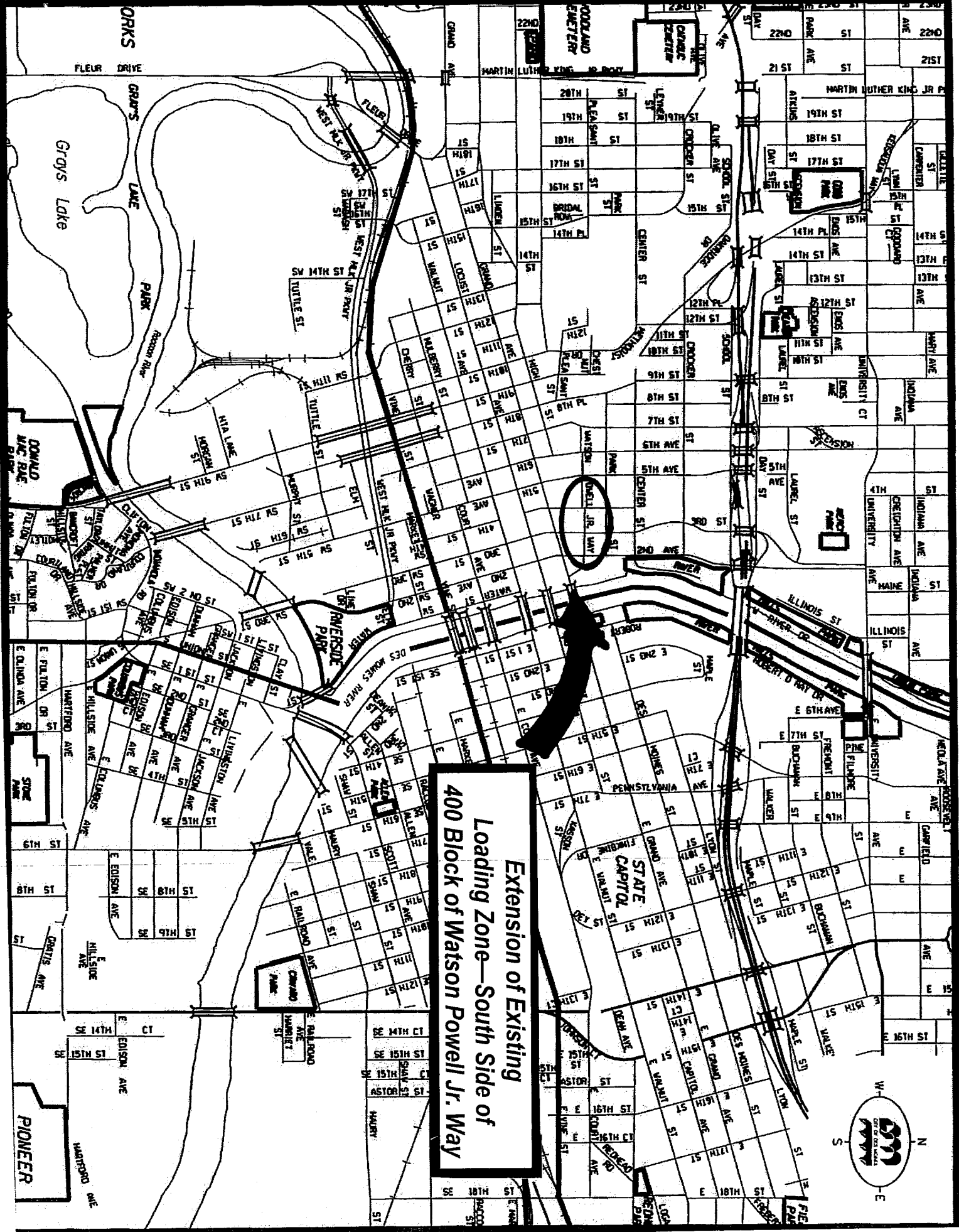

**Extension of Existing
Loading Zone—South Side of
400 Block of Watson Powell Jr. Way**

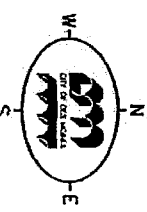

3631E

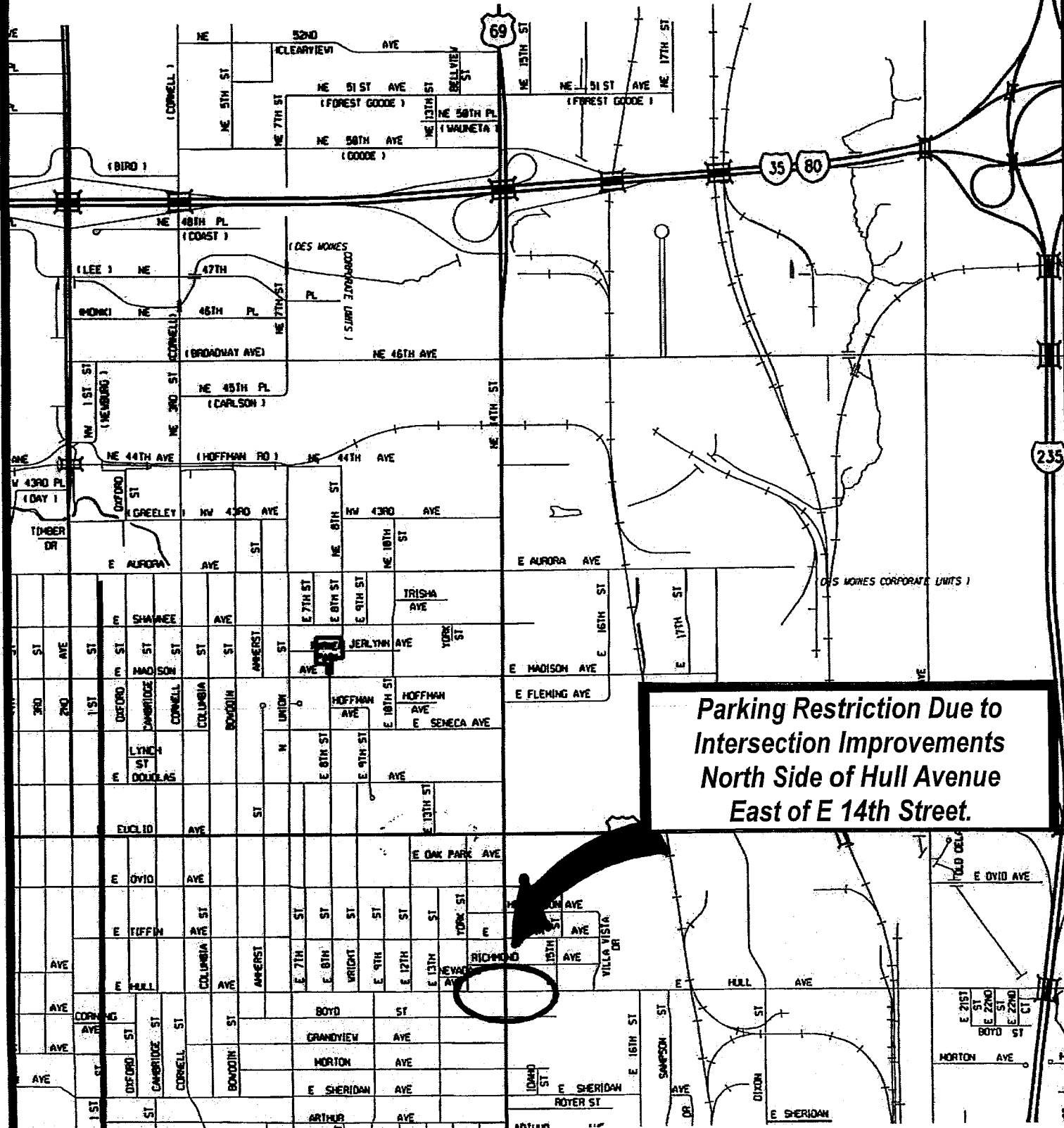
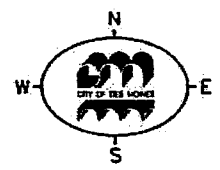

Parking Restriction Due to Intersection Improvements North Side of Hull Avenue East of E 14th Street.

12-0104
12-0055 363/F

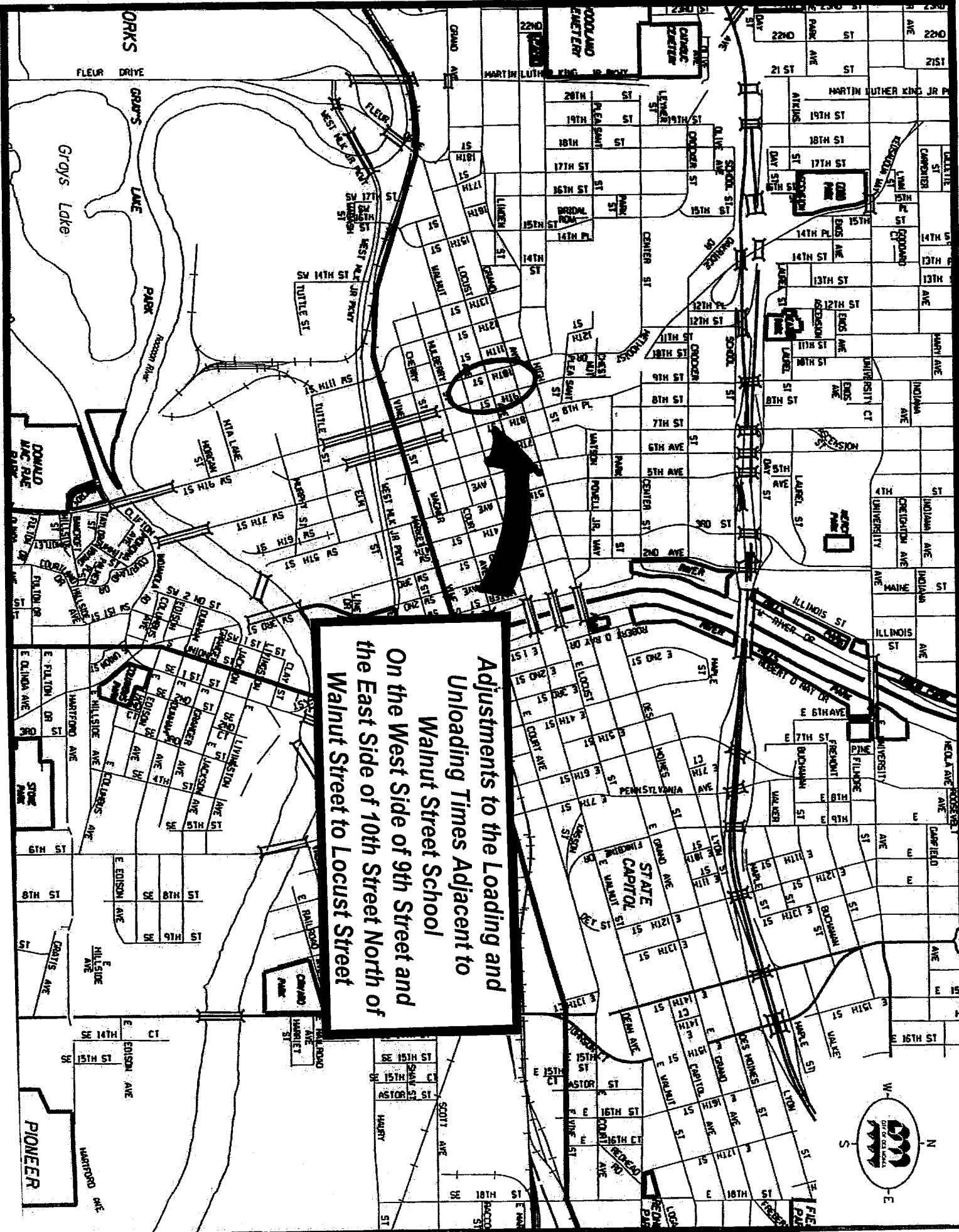

Adjustments to the Loading and Unloading Times Adjacent to Walnut Street School
On the West Side of 9th Street and the East Side of 10th Street North of Walnut Street to Locust Street

