

DATE August 13, 2012

ORDERING CONSTRUCTION OF
EASTER LAKE DRIVE BRIDGE OVER EASTER LAKE REHABILITATION
AND FIXING A DATE FOR RECEIVING OF BIDS ON AUGUST 21, 2012
AND PUBLIC HEARING ON SEPTEMBER 10, 2012
ENGINEER'S ESTIMATE IS \$612,882.00

WHEREAS, this Council deems it advisable and necessary to construct the below referenced improvement, all in accordance with the plans and specifications, and has caused to be prepared plans, specifications, and form of contract, together with estimate of cost, which are now on file in the City Engineer's Office, 2nd Floor, City Hall, 400 Robert D. Ray Drive, Des Moines, Iowa 50309-1891, for public inspection for the construction of said improvements, and said plans, specifications and form of contract are deemed suitable for the making of said improvement, for which the State of Iowa Department of Transportation (IDOT) and the City of Des Moines, (CITY) have an agreement, previously approved by this Council, under which the IDOT has agreed to advertise, receive, open and tabulate sealed bids, and

WHEREAS, before said plans, specifications, form of contract, and estimated cost of the improvement may be approved, and contract for the construction of the improvement entered into, it is necessary to hold a public hearing.

BE IT RESOLVED BY THE CITY COUNCIL OF THE CITY OF DES MOINES, IOWA: That the attached communication recommending construction of the following improvement and the method of financing; and also including the recommendation of the Des Moines City Engineer, as the Engineer, submitting plans, specifications, form of contract documents, and Engineer's estimate of cost for the construction of the following improvement:

Easter Lake Drive Bridge over Easter Lake Rehabilitation, 12-2009-001
STP-U-1945(777)--70-77

The improvement includes rehabilitation and widening of the existing bridge superstructure and substructure including clearing and grubbing, Class 10 excavation for roadway and channel, topsoil furnish and spread, shoulder finishing, bridge approach pavement, removals, excavation Class 20 and 21, structural concrete, bridge deck overlay, colored concrete sealer, epoxy reinforcing steel, longitudinal grooving, deck repair, aesthetic barrier rail, steel pedestrian handrails, steel piling, concrete pile encasements, engineering fabric and revetment, sidewalk, traffic control and flaggers, construction survey, pavement markings, erosion control, seeding and fertilizing, and mobilization; all in accordance with the contract documents including Plan File Nos. 546-001/033, located on Easter Lake Drive over Easter Lake between S.E. 32nd Street and S.E. 34th Street, Des Moines, Iowa

be and the same are hereby approved and accepted. The estimated construction cost for said improvement is \$612,882.00. The proposed plans, specifications, and form of contract documents are available for public inspection in the Des Moines City Engineer's Office.



Roll Call Number

Agenda Item Number

5C

DATE August 13, 2012

BE IT FURTHER RESOLVED: That this Council hereby determines that it is necessary and advisable to construct said improvement in the manner set forth in the plans, specifications, and form of contract documents submitted by the Engineer; and that payment for the cost of said improvement shall be paid from the funding source identified below.

BE IT FURTHER RESOLVED: That a public hearing on said plans, specifications, form of contract documents, and Engineer's estimate of construction cost for said improvement be held in the City Council Chambers, 2nd Floor, City Hall, 400 Robert D. Ray Drive, Des Moines, Iowa, at 5:00 p.m. on September 10, 2012, at which time this Council will consider any objections offered thereto or to the making of said improvement.

BE IT FURTHER RESOLVED: That proposals will be received by the Iowa Department of Transportation, for the construction of said improvements, and the taking of bids in the manner required by law. Proposals received will be opened and tabulated by the Iowa Department of Transportation on August 21, 2012, after which the bids together with a report and recommendation of the Chief Civil Engineer, will be presented to City Council at its next meeting for action thereon.

BE IT FURTHER RESOLVED: That an appropriate Notice to Bidders and Notice of Public Hearing for said improvement be published in the Des Moines Register as provided and directed by Chapter 26 and/or 314, Code of Iowa.

(City Council Communication Number 12-425 attached.)

Moved by _____ to adopt.

FORM APPROVED:

FUNDS AVAILABLE

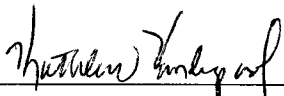

Kathleen Vanderpool
Deputy City Attorney

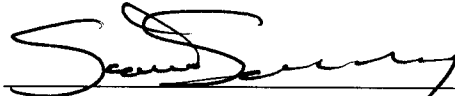

Scott E. Sanders
Des Moines Finance Director



Funding Source: 2012-2013 CIP, Page Bridge - 8, Easter Lake Drive over Branch of Easter Lake, BRV041, Being: \$245,000 in Federal Surface Transportation Program (STP) funds being 80% eligible construction costs only (Max \$245,000); \$43,065 - Des Moines Water Works; \$194,817 from BRV041, of which includes \$50,000 in Gaming Monies; with a transfer of \$130,000 of G.O. Bonds from City-wide Bridges, Page Bridge-5, BRV003.



Roll Call Number

Agenda Item Number

50

DATE August 13, 2012

COUNCIL ACTION	YEAS	NAYS	PASS	ABSENT
COWNIE				
COLEMAN				
GRIESS				
HENSLEY				
MAHAFFEY				
MEYER				
MOORE				
TOTAL				

MOTION CARRIED

APPROVED

Mayor

CERTIFICATE

I, DIANE RAUH, City Clerk of said City hereby certify that at a meeting of the City Council of said City of Des Moines, held on the above date, among other proceedings the above was adopted.

IN WITNESS WHEREOF, I have hereunto set my hand and affixed my seal the day and year first above written.

City Clerk

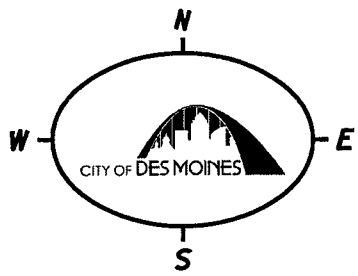
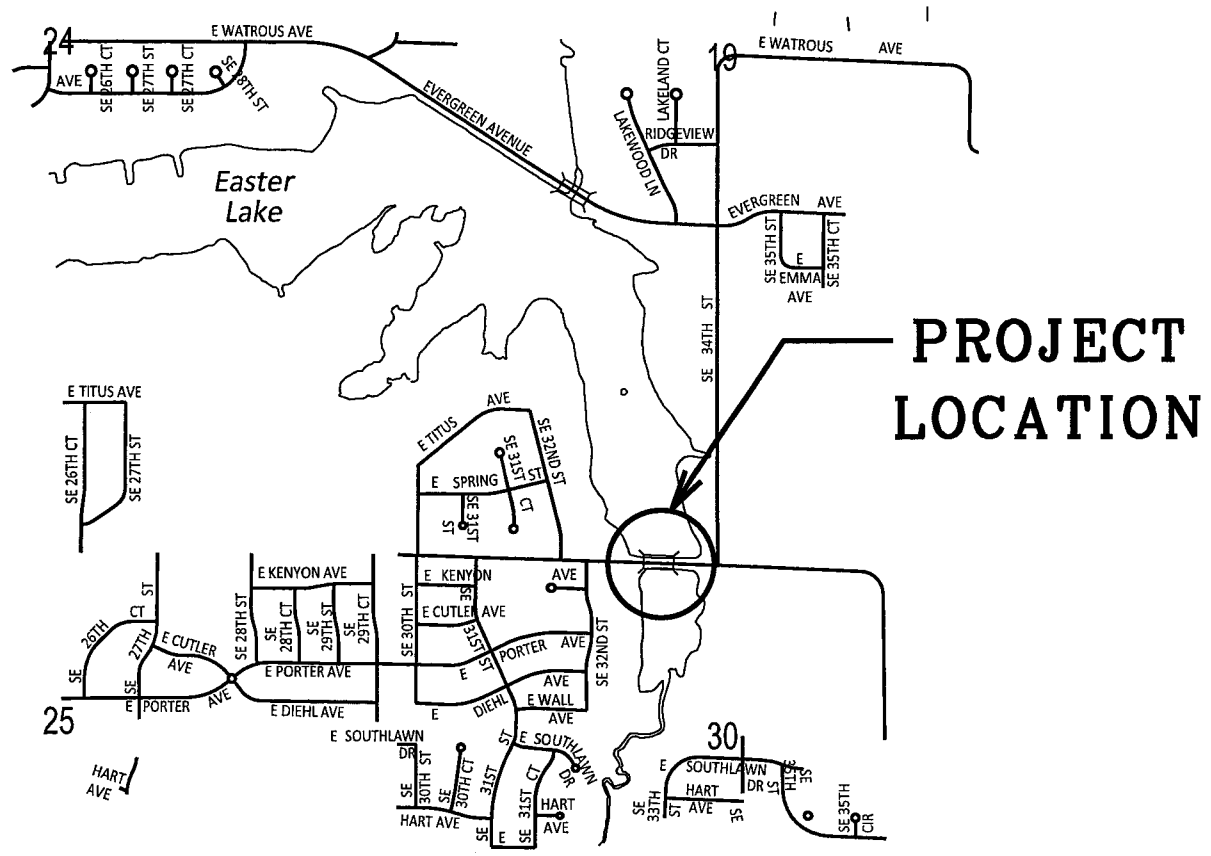

EASTER LAKE DRIVE BRIDGE OVER EASTER LAKE REHABILITATION ACTIVITY I.D. 12-2009-001

50

CALHOUN-BURNS AND ASSOCIATES
WEST DES MOINES, IOWA

05/24/12

OPINION OF PROBABLE CONSTRUCTION COSTS

CITY OF DES MOINES
PROJECT NO. STP-U-1945(777)-70-77
CB&A NO. 2009227

BRIDGE - REHABILITATION
75'-0 X 28'-0 CONTINUOUS CONCRETE SLAB
BRIDGE WIDENING TO 32'-0 ROADWAY WITH 12'-7 RECREATIONAL TRAIL

ESTIMATED QUANTITIES - DIVISION I (BRIDGE AND APPROACHES)						
REF. NO.	CODE NO.	ITEM	UNIT	QUANTITY	PRICE	TOTAL
1	2101-0850001	CLEARING AND GRUBBING	ACRE	0.05	\$10,000.00	\$500.00
2	2102-2710070	EXCAVATION, CLASS 10, ROADWAY AND BORROW	CY	425	\$15.00	\$6,375.00
3	2104-2710020	EXCAVATION, CLASS 10, CHANNEL	CY	200	\$10.00	\$2,000.00
4	2105-8425005	TOPSOIL, FURNISH AND SPREAD	CY	75	\$20.00	\$1,500.00
5	2123-7450020	SHOULDER FINISHING, EARTH	STA	2.4	\$450.00	\$1,080.00
6	2301-0695550	BRIDGE APPROACH PAVEMENT, AS PER PLAN	SY	151.4	\$155.00	\$23,467.00
7	2401-6750001	REMOVALS, AS PER PLAN	LS	1	\$40,000.00	\$40,000.00
8	2402-2720000	EXCAVATION, CLASS 20	CY	72	\$60.00	\$4,320.00
9	2402-2721000	EXCAVATION, CLASS 21	CY	20	\$150.00	\$3,000.00
10	2403-0100010	STRUCTURAL CONCRETE (BRIDGE)	CY	102.2	\$850.00	\$86,870.00
11	2403-7302000	COLOR SEALER COATING FOR STRUCTURAL CONCRETE	SY	195	\$55.00	\$4,725.00
12	2404-7775005	REINFORCING STEEL, EPOXY COATED	LB	24,145	\$0.90	\$21,730.50
13	2412-0000100	LONGITUDINAL GROOVING IN CONCRETE	SY	375.9	\$4.00	\$1,503.60
14	2413-0688075	DECK REPAIR, CLASS B	SY	3.4	\$500.00	\$1,700.00
15	2413-0698081	DECK REPAIR, CLASS A, SPECIAL	SY	53.3	\$200.00	\$10,660.00
16	2414-8424119	CONCRETE BARRIER RAILING, AESTHETIC	LF	181.3	\$120.00	\$21,756.00
17	2414-8445100	STRUCTURAL STEEL PEDESTRIAN HAND RAILING, 4'-6 HEIGHT	LF	89.67	\$140.00	\$12,553.80
18	2414-8445100	STRUCTURAL STEEL PEDESTRIAN HAND RAILING, 10' HEIGHT	LF	152.5	\$95.00	\$14,487.50
19	2501-0201057	PILES, STEEL, HP 10 X 57 (16 @ 50')	LF	800	\$37.00	\$29,600.00
20	2501-5476057	CONCRETE ENCASEMENT OF STEEL H PILES, HP 10 X 57 (P10A TYPE 3) (8 @ 12')	LF	96	\$100.00	\$9,600.00
21	2507-3250005	ENGINEERING FABRIC	SY	350	\$3.00	\$1,050.00
22	2507-8800061	REVTMENT, CLASS E	TON	180	\$45.00	\$8,100.00
23	2507-8875002	REVTMENT, REMOVE AND REPLACE	CY	30	\$35.00	\$1,050.00
24	2510-8745850	REMOVAL OF PAVEMENT	SY	106.6	\$16.00	\$1,705.60
25	2511-7528006	SIDEWALK, P.C. CONCRETE, 6 IN.	SY	55.4	\$55.00	\$3,047.00
26	2518-6010000	SAFETY CLOSURE	EACH	2	\$250.00	\$500.00
27	2528-8285000	CONSTRUCTION SURVEY	LS	1	\$8,000.00	\$8,000.00
28	2527-9263109	PAINTED PAVEMENT MARKING, WATERBORNE OR SOLVENT-BASED	STA	4.88	\$50.00	\$234.00
29	2528-8445110	TRAFFIC CONTROL	LS	1	\$25,000.00	\$25,000.00
30	2528-8445113	FLAGGERS	EACH	6	\$310.00	\$1,860.00
31	2593-4980005	MOBILIZATION	LS	1	\$45,000.00	\$45,000.00
32	2599-9999009	ELECTRICAL CONDUIT, HDPE SCH. 40, DIRECTIONAL BORE 6 IN. DIA. WITH PULL STRINK	LF	380	\$110.00	\$41,800.00
33	2599-9999009	ELECTRICAL CONDUIT, HDPE SCH. 40, DIRECTIONAL BORE 4 IN. DIA. WITH PULL STRINK	LF	370	\$105.00	\$38,850.00
34	2599-9999009	ELECTRICAL CONDUIT, HDPE SCH. 40, DIRECTIONAL BORE 2 IN. DIA. WITH PULL STRINK	LF	370	\$100.00	\$37,000.00
35	2599-9999012	WATERING FOR SEEDING	MGAL	189	\$70.00	\$12,810.00
36	2601-2634150	MULCHING, WOOD CELLULOSE FIBER	ACRE	0.9	\$1,800.00	\$980.00
37	2601-2636044	SEEDING AND FERTILIZING (URBAN)	ACRE	0.6	\$1,600.00	\$960.00
38	2602-0000020	SILT FENCE	LF	250	\$3.00	\$750.00
39	2602-0000101	MAINTENANCE OF SILT FENCE OR SILT FENCE FOR DITCH CHECK	LF	250	\$2.00	\$500.00
40	2602-0000212	FLOATING SILT CURTAIN (HANGING)	LF	350	\$30.00	\$10,500.00
41A	2413-0698041	DECK OVER-DEPTH OVERLAY (CLASS O PCC)	SY	272.8	\$115.00	\$31,349.00
41B	2413-0698051	DECK OVER-DEPTH OVERLAY (CLASS HPC-O PCC)	SY	272.8	\$120.00	\$32,712.00
BRIDGE AND APPROACHES (OPTION 41A)						\$568,454.00
BRIDGE AND APPROACHES (OPTION 41B)						\$569,817.00

ESTIMATED QUANTITIES - DIVISION II (RELOCATED WATERMAIN)						
REF. NO.	CODE NO.	ITEM	UNIT	QUANTITY	PRICE	TOTAL
42	2554-0114008	WATER MAIN, TRENCHED, POLYVINYL CHLORIDE PIPE (PVC), 8 IN.	LF	5	\$35.00	\$175.00
43	2554-0124012	WATER MAIN, TRENCHLESS, POLYVINYL CHLORIDE PIPE (PVC), 12 IN.	LF	400	\$86.00	\$34,400.00
44	2554-0203000	FITTINGS BY WEIGHT, DUCTILE IRON	LB	466	\$15.00	\$6,990.00
45	2599-9999005	PREPARE EXCAVATION FOR TAPPING SLEEVE	EACH	1	\$1,500.00	\$1,500.00
RELOCATED WATERMAIN						\$43,065.00
TOTAL (OPTION 41A)						\$611,519.00
TOTAL (OPTION 41B)						\$612,982.00

ENGINEER'S OPINIONS OF PROBABLE CONSTRUCTION COST ARE MADE ON THE BASIS OF ENGINEER'S EXPERIENCE AND QUALIFICATIONS AND REPRESENT ENGINEER'S BEST JUDGMENT AS AN EXPERIENCED AND QUALIFIED PROFESSIONAL GENERALLY FAMILIAR WITH THE CONSTRUCTION INDUSTRY. HOWEVER, SINCE ENGINEER HAS NO CONTROL OVER THE COST OF LABOR, MATERIALS, EQUIPMENT, OR SERVICES FURNISHED BY OTHERS, OR OVER CONTRACTORS' METHODS OF DETERMINING PRICES, OR OVER COMPETITIVE BIDDING OR MARKET CONDITIONS, ENGINEER CANNOT AND DOES NOT GUARANTEE THAT PROPOSALS, BIDS, OR ACTUAL CONSTRUCTION COST WILL NOT VARY FROM OPINIONS OF PROBABLE CONSTRUCTION COST PREPARED BY ENGINEER.