

DATE September 10, 2012

PUBLIC HEARING, APPROVING PLANS, SPECIFICATIONS, FORM OF CONTRACT DOCUMENTS, AND ENGINEER'S ESTIMATE ON EASTER LAKE DRIVE BRIDGE OVER EASTER LAKE REHABILITATION; RECEIVE AND FILE BIDS; AND DESIGNATION OF LOWEST RESPONSIVE, RESPONSIBLE BIDDER AS HERBERGER CONSTRUCTION CO., INC., DEAN HERBERGER, PRESIDENT, \$532,890.39

WHEREAS, on August 13, 2012, under Roll Call No. 12-1228, plans, specifications, form of contract documents, and Engineer's estimate of construction cost were filed with the City Clerk, for the construction of the following improvement:

Easter Lake Drive Bridge over Easter Lake Rehabilitation, 12-2009-001  
STP-U-1945(777)--70-77

The improvement includes rehabilitation and widening of the existing bridge superstructure and substructure including clearing and grubbing, Class 10 excavation for roadway and channel, topsoil furnish and spread, shoulder finishing, bridge approach pavement, removals, excavation Class 20 and 21, structural concrete, bridge deck overlay, colored concrete sealer, epoxy reinforcing steel, longitudinal grooving, deck repair, aesthetic barrier rail, steel pedestrian handrails, steel piling, concrete pile encasements, engineering fabric and revetment, sidewalk, traffic control and flaggers, construction survey, pavement markings, erosion control, seeding and fertilizing, and mobilization; all in accordance with the contract documents including Plan File Nos. 546-001/033, located on Easter Lake Drive over Easter Lake between S.E. 32nd Street and S.E. 34th Street, Des Moines, Iowa

WHEREAS, notice of the hearing on the plans, specifications, form of contract documents, and Engineer's estimate of construction cost was published as required by law.

NOW, THEREFORE, BE IT RESOLVED BY THE CITY COUNCIL OF THE CITY OF DES MOINES, IOWA: That the hearing on the plans, specifications, form of contract documents, and Engineer's estimate of construction cost for said improvement be closed; and that said plans, specifications, form of contract documents, and Engineer's estimate of construction cost are hereby approved as the plans, specifications, form of contract documents, and Engineer's estimate of construction cost for said improvement.

BE IT FURTHER RESOLVED: That sealed bids for said improvement were submitted by the following bidders:

- |                                  |                |
|----------------------------------|----------------|
| Herberger Construction Co., Inc. | Indianola, IA  |
| Jensen Construction Company      | Des Moines, IA |
| Cramer and Associates, Inc.      | Grimes, IA     |

DATE September 10, 2012

which in accordance with a previously approved Iowa DOT Agreement, were received and opened by the Iowa DOT on August 21, 2012. The attached tabulation of bids by the Iowa DOT for said improvement be and is hereby accepted, received, and filed.

BE IT FURTHER RESOLVED: That the Des Moines City Engineer, as the Engineer, has determined that the lowest responsive, responsible bid for the construction of said improvement was submitted by Herberger Construction Co., Inc., Dean Herberger, President, 2508 West 2nd Avenue, P.O. Box 326, Indianola, IA, 50125 in the amount of \$532,890.39, and said bid be and the same is hereby accepted.

BE IT FURTHER RESOLVED: That the Engineer is hereby directed to secure execution by the lowest responsible, responsive Bidder and its surety of the contract documents in the form heretofore approved by this Council; that the Engineer is directed to thereafter present said contract documents to this Council for approval and authorization to the Mayor to sign; and that no contract shall be deemed to exist between the City of Des Moines and said Bidder until said contract has been executed by the Bidder, and shall have been approved by this Council and executed by the Mayor and attested to by the City Clerk.

(City Council Communication Number 12-483 attached.)

Moved by \_\_\_\_\_ to adopt.

FORM APPROVED:

FUNDS AVAILABLE

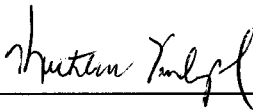

Kathleen Vanderpool  
Deputy City Attorney

Scott E. Sanders  
Des Moines Finance Director

Funding Source: 2012-2013 CIP, Page Bridge - 8, Easter Lake Drive over Branch of Easter Lake, BRV041, Being:

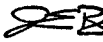
 \$245,000 in Federal Surface Transportation Program (STP) funds being 80% eligible construction costs only (Max \$245,000); \$65,632.80 - Des Moines Water Works; \$172,257.59 from BRV041, of which includes \$50,000 in Gaming Monies; with a transfer of \$50,000 G.O. Bonds from City-wide Bridges, Page Bridge-5, BRV003.

★ **Roll Call Number**

**Agenda Item Number**

39

DATE September 10, 2012

COUNCIL ACTION	YEAS	NAYS	PASS	ABSENT
COWNIE				
COLEMAN				
GRIESS				
HENSLEY				
MAHAFFEY				
MEYER				
MOORE				
<b>TOTAL</b>				

MOTION CARRIED APPROVED

\_\_\_\_\_  
Mayor

I, Diane Rauh, City Clerk of said City Council, hereby certify that at a meeting of the City Council, held on the above date, among other proceedings the above was adopted.

IN WITNESS WHEREOF, I have hereunto set my hand and affixed my seal the day and year first above written.

\_\_\_\_\_  
City Clerk

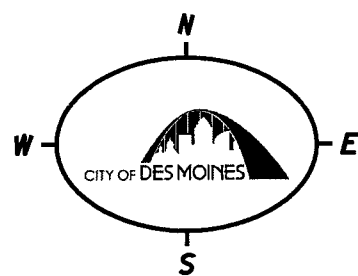
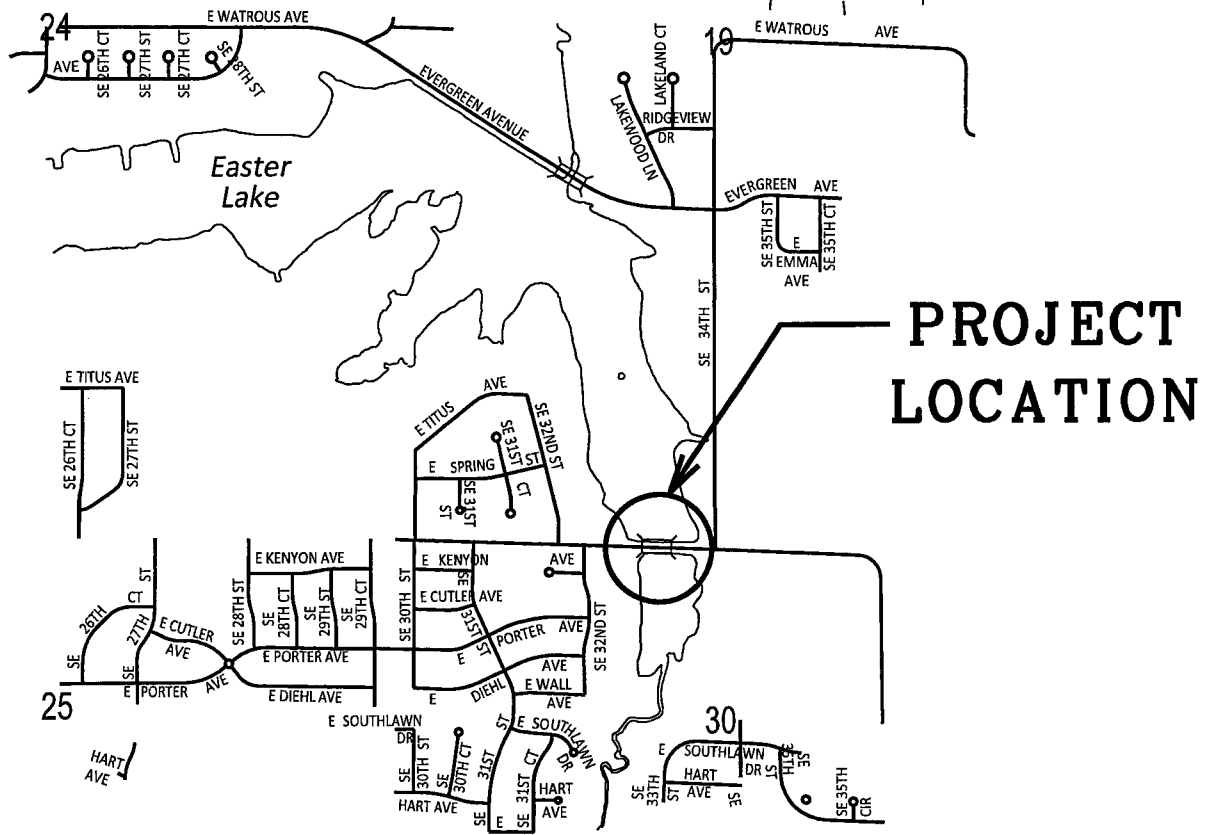

# EASTER LAKE DRIVE BRIDGE OVER EASTER LAKE REHABILITATION ACTIVITY I.D. 12-2009-001

IOWA DEPARTMENT OF TRANSPORTATION  
TABULATION OF CONSTRUCTION AND MATERIAL BIDS

Run Date: 08/24/12  
Page: 010 5

Primary County: POLK

Contract ID: 77-1945-777

Bid Order: 010  
Letting Date: 08/21/12 10:00 A.M.

LINE NO / ITEM CODE / ALT ITEM DESCRIPTION	QUANTITY	( 1 ) HE420 HERBERGER CONSTR. CO., INC.	( 2 ) JE200 JENSEN CONSTRUCTION CO.	( 3 ) CR120 CRAMER AND ASSOC., INC.
		UNIT PRICE	UNIT PRICE	UNIT PRICE
		AMOUNT	AMOUNT	AMOUNT
0470 2602-0010010 MOBILIZATIONS, EROSION CONTROL	1.000 EACH	500.00000	500.00000	500.00000
0480 2602-0010020 MOBILIZATIONS, EMERGENCY EROSION CONTROL	1.000 EACH	1000.00000	1000.00000	1000.00000
SECTION TOTALS		\$ 1,500.00	\$ 1,500.00	\$ 1,500.00
CONTRACT TOTALS		\$ 532,890.39	\$ 645,535.90	\$ 696,546.39



IOWA DEPARTMENT OF TRANSPORTATION  
TABULATION OF CONSTRUCTION AND MATERIAL BIDS

Primary County: POLK

Contract ID: 77-1945-777

Bid Order: 010  
Letting Date: 08/21/12 10:00 A.M.

LINE NO / ITEM CODE / ALT ITEM DESCRIPTION	QUANTITY	( 1 ) HE420 HERBERGER CONSTR. CO., INC.		( 2 ) JE200 JENSEN CONSTRUCTION CO.		( 3 ) CR120 CRAMER AND ASSOC., INC.	
		UNIT PRICE	AMOUNT	UNIT PRICE	AMOUNT	UNIT PRICE	AMOUNT
0360 2601-2634150 MULCHING, WOOD CELLULOSE FIBER	0.600 ACRE	2500.00000	1500.00	2490.00000	1494.00	2490.00000	1494.00
0370 2601-2636044 SEEDING AND FERTILIZING (URBAN)	0.600 ACRE	1900.00000	1140.00	1820.00000	1092.00	1820.00000	1092.00
0380 2602-0000020 SILT FENCE	250.000 LF	2.50000	625.00	2.50000	625.00	2.50000	625.00
0390 2602-0000101 MAINTENANCE OF SILT FENCE OR SILT FENCE FOR DITCH CHECK	250.000 LF	1.50000	375.00	1.50000	375.00	1.50000	375.00
0400 2602-0000212 FLOATING SILT CURTAIN (HANGING)	350.000 LF	30.00000	10500.00	29.00000	10150.00	29.00000	10150.00
SECTION TOTALS		\$	432,500.39	\$	566,484.90	\$	601,612.39
SECTION 0002 ALTERNATE 'AA' OPTION 1: CLASS O PCC BID THIS SECTION IF ALTERNATE 'AA' OPTION 1 IS CHOSEN							
0410 2413-0698041 DECK OVER-DEPTH OVERLAY (CLASS O PCC)	272.600 SY						
SECTION TOTALS		\$		\$		\$	
SECTION 0003 ALTERNATE 'AA' OPTION 2: CLASS HPC-O PCC BID THIS SECTION IF ALTERNATE 'AA' OPTION 2 IS CHOSEN							
0420 2413-0698051 DECK OVER-DEPTH OVERLAY (CLASS HPC-O PCC)	272.600 SY	122.00000	33257.20	55.00000	14993.00	115.00000	31349.00
SECTION TOTALS		\$	33,257.20	\$	14,993.00	\$	31,349.00
SECTION 0004 WATERMAIN ITEMS NON-PARTICIPATING							
0430 2554-0114008 WATER MAIN, TRENCHED, POLYVINYL CHLORIDE PIPE (PVC), 8 IN.	5.000 LF	127.00000	635.00	120.00000	600.00	120.00000	600.00
0440 2554-0124012 WATER MAIN, TRENCHLESS, POLYVINYL CHLORIDE PIPE (PVC), 12 IN.	400.000 LF	141.00000	56400.00	134.00000	53600.00	133.40000	53360.00
0450 2554-0203000 FITTINGS BY WEIGHT, DUCTILE IRON	466.000 LB	13.30000	6197.80	13.00000	6058.00	12.50000	5825.00
0460 2599-9999005 (EACH ITEM) PREPARE EXCAVATION FOR TAPPING SLEEVE	1.000 EACH	2400.00000	2400.00	2300.00000	2300.00	2300.00000	2300.00
SECTION TOTALS		\$	65,632.80	\$	62,558.00	\$	62,085.00
SECTION 0005 MOBILIZATION FOR EROSION CONTROL FOR THE CONTRACT							

IOWA DEPARTMENT OF TRANSPORTATION  
TABULATION OF CONSTRUCTION AND MATERIAL BIDS

Run Date: 08/24/12  
Page: 010 3

Contract ID: 77-1945-777

Primary County: POLK

Bid Order: 010  
Letting Date: 08/21/12 10:00 A.M.

LINE NO / ITEM CODE / ALT ITEM DESCRIPTION	QUANTITY	( 1 ) HE420 HERBERGER CONSTR. CO., INC.		( 2 ) JE200 JENSEN CONSTRUCTION CO.		( 3 ) CR120 CRAMER AND ASSOC., INC.	
		UNIT PRICE	AMOUNT	UNIT PRICE	AMOUNT	UNIT PRICE	AMOUNT
0190 2501-0201057 PILES, STEEL, HP 10 X 57	800.000 LF	43.00000	34400.00	50.00000	40000.00	45.00000	36000.00
0200 2501-5476057 CONCRETE ENCASUREMENT OF STEEL H PILES, HP 10 X 57 (PI0A TYPE 3)	96.000 LF	83.00000	7968.00	140.00000	13440.00	1100.00000	105600.00
0210 2507-3250005 ENGINEERING FABRIC	350.000 SY	2.75000	962.50	2.75000	962.50	5.00000	1750.00
0220 2507-6800061 REVTMENT, CLASS E	180.000 TON	50.00000	9000.00	45.00000	8100.00	40.00000	7200.00
0230 2507-6875002 REVTMENT, REMOVE AND REPLACE	30.000 CY	40.00000	1200.00	35.00000	1050.00	35.00000	1050.00
0240 2510-6745850 REMOVAL OF PAVEMENT	106.600 SY	24.75000	2638.35	20.00000	2132.00	20.00000	2132.00
0250 2511-7526006 SIDEWALK, P.C. CONCRETE, 6 IN.	55.400 SY	127.00000	7035.80	120.00000	6648.00	140.00000	7756.00
0260 2518-6910000 SAFETY CLOSURE	2.000 EACH	125.00000	250.00	100.00000	200.00	100.00000	200.00
0270 2526-8285000 CONSTRUCTION SURVEY	LUMP	2000.00000	2000.00	6350.00000	6350.00	7000.00000	7000.00
0280 2527-9263109 PAINTED PAVEMENT MARKING, WATERBORNE OR SOLVENT-BASED	4.680 STA	160.00000	748.80	150.00000	702.00	150.00000	702.00
0290 2528-8445110 TRAFFIC CONTROL	LUMP	6200.00000	6200.00	15000.00000	15000.00	7000.00000	7000.00
0300 2528-8445113 FLAGGERS	6.000 EACH	325.00000	1950.00	325.00000	1950.00	325.00000	1950.00
0310 2533-4980005 MOBILIZATION	LUMP	39500.00000	39500.00	60000.00000	60000.00	60000.00000	60000.00
0320 2599-9999009 ( 'LINEAR FEET' ITEM) ELECTRICAL CONDUIT	370.000 LF	19.10000	7067.00	18.00000	6660.00	18.00000	6660.00
HDPE SCH 40, DIRECT.							
0330 2599-9999009 ( 'LINEAR FEET' ITEM) ELECTRICAL CONDUIT	370.000 LF	21.00000	7770.00	20.00000	7400.00	19.80000	7326.00
HDPE SCH 40, DIRECT.							
0340 2599-9999009 ( 'LINEAR FEET' ITEM) ELECTRICAL CONDUIT	380.000 LF	35.25000	13395.00	34.00000	12920.00	33.20000	12616.00
HDPE SCH 40, DIRECT.							
0350 2599-9999012 ( 'THOUSANDS OF GALLONS' ITEM) WATERING FOR SEEDING	183.000 MGAL	31.80000	5819.40	30.00000	5490.00	30.00000	5490.00

39

IOWA DEPARTMENT OF TRANSPORTATION  
TABULATION OF CONSTRUCTION AND MATERIAL BIDS

Run Date: 08/24/12  
Page: 010 2

Bid Order: 010  
Letting Date: 08/21/12 10:00 A.M.

Contract ID: 77-1945-777

Primary County: POLK

LINE NO / ITEM CODE / ALT ITEM DESCRIPTION	QUANTITY	( 1 ) HE420 HERBERGER CONSTR. CO., INC.	UNIT PRICE	AMOUNT	( 2 ) JE200 JENSEN CONSTRUCTION CO.	UNIT PRICE	AMOUNT	( 3 ) CR120 CRAMER AND ASSOC., INC.	UNIT PRICE	AMOUNT
SECTION 0001 ITEMS FOR REPAIRS TO A 75'-0 X 28'-0 CCS BRIDGE WIDEN TO 32' RDWY W/ 12'-7 RECREATIONAL TRAIL										
0010 2101-0850001 CLEARING AND GRUBBING	0.050 ACRE	5300.00	106000.00000	5300.00	100000.00000	100000.00000	5000.00	100000.00000	5000.00	5000.00
0020 2102-2710070 EXCAVATION, CLASS 10, ROADWAY AND BORRO	425.000 CY	13515.00	31.80000	13515.00	30.00000	30.00000	12750.00	30.00000	12750.00	12750.00
0030 2104-2710020 EXCAVATION, CLASS 10, CHANNEL	200.000 CY	4250.00	21.25000	4250.00	20.00000	20.00000	4000.00	20.00000	4000.00	4000.00
0040 2105-8425005 TOPSOIL, FURNISH AND SPREAD	75.000 CY	5550.00	74.00000	5550.00	70.00000	70.00000	5250.00	70.00000	5250.00	5250.00
0050 2123-7450020 SHOULDER FINISHING, EARTH	2.400 STA	2280.00	950.00000	2280.00	900.00000	900.00000	2160.00	900.00000	2160.00	2160.00
0060 2301-0685550 BRIDGE APPROACH PAVEMENT, AS PER PLAN	151.400 SY	26192.20	173.00000	26192.20	165.00000	165.00000	24981.00	180.00000	27252.00	27252.00
0070 2401-6750001 REMOVALS, AS PER PLAN	LUMP	55000.00	55000.00000	55000.00	39200.00000	39200.00000	39200.00	33000.00000	33000.00	33000.00
0080 2402-2720000 EXCAVATION, CLASS 20	72.000 CY	1854.00	25.75000	1854.00	25.00000	25.00000	1800.00	20.00000	1440.00	1440.00
0090 2402-2721000 EXCAVATION, CLASS 21	20.000 CY	10000.00	500.00000	10000.00	2000.00000	2000.00000	40000.00	50.00000	1000.00	1000.00
0100 2403-0100010 STRUCTURAL CONCRETE (BRIDGE)	102.200 CY	61320.00	600.00000	61320.00	1400.00000	1400.00000	143080.00	1250.00000	127750.00	127750.00
0110 2403-7302000 COLORED SEALER COATING FOR STRUCTURAL CONCRETE	135.000 SY	3780.00	28.00000	3780.00	41.00000	41.00000	5535.00	72.00000	9720.00	9720.00
0120 2404-7775005 REINFORCING STEEL, EPOXY COATED	24145.000 LB	30181.25	1.25000	30181.25	1.15000	1.15000	27766.75	1.50000	36217.50	36217.50
0130 2412-0000100 LONGITUDINAL GROOVING IN CONCRETE	375.900 SY	3187.63	8.48000	3187.63	5.50000	5.50000	2067.45	5.15000	1935.89	1935.89
0140 2413-0698075 DECK REPAIR, CLASS B	3.400 SY	1190.00	350.00000	1190.00	225.00000	225.00000	765.00	330.00000	1122.00	1122.00
0150 2413-0698081 DECK REPAIR, CLASS A, SPECIAL	53.300 SY	11299.60	212.00000	11299.60	125.00000	125.00000	6662.50	200.00000	10660.00	10660.00
0160 2414-6424119 CONCRETE BARRIER RAILING, AESTHETIC	181.300 LF	20668.20	114.00000	20668.20	135.00000	135.00000	24475.50	125.00000	22662.50	22662.50
0170 2414-6445100 STRUCTURAL STEEL PEDESTRIAN HAND RAILING 10 IN. HEIGHT	152.500 LF	6100.00	40.00000	6100.00	55.00000	55.00000	8387.50	43.00000	6557.50	6557.50
0180 2414-6445100 STRUCTURAL STEEL PEDESTRIAN HAND RAILING 4'-6 HEIGHT	89.670 LF	8787.66	98.00000	8787.66	110.00000	110.00000	9863.70	100.00000	8967.00	8967.00



IOWA DEPARTMENT OF TRANSPORTATION  
 VENDOR RANKING

Run Date: 08/24/12  
 Page: 010 1

Primary County: POLK  
 No Established DBE Goal

Bid Order: 010 Contract ID: 77-1945-777  
 Letting Date: 120821 10:00 A.M.  
 Letting Status: AWARD RECOMMENDED to HERBERGER CONSTR. CO., INC.  
 Contract Period: 110 WORK DAYS Late Start Date: 10/15/12

Project: STP-U-1945(777) --70-77  
 Work Type: BRIDGE REHABILITATION Prj Awd Amt: \$532,890.39  
 County: POLK  
 Route: EASTER LAKE DRIVE  
 Location: IN THE CITY OF DES MOINES  
 OVER BRANCH OF EASTER LAKE

RANK	VENDOR NO./NAME	TOTAL BID	% OVER LOW BID
1	HE420 HERBERGER CONSTRUCTION CO., INC.	\$ 532,890.39	100.00 %
2	JE200 JENSEN CONSTRUCTION CO.	\$ 645,535.90	121.13 %
3	CR120 CRAMER AND ASSOC., INC.	\$ 696,546.39	130.71 %