

DATE November 5, 2012

ACCEPTING COMPLETED CONSTRUCTION AND APPROVING FINAL PAYMENT FOR BLANK PARK ZOO ENTRANCE IMPROVEMENTS, LARSON & LARSON CONSTRUCTION LLC

BE IT RESOLVED BY THE CITY COUNCIL OF THE CITY OF DES MOINES, IOWA: That the attached report of the Des Moines City Engineer, showing the cost of the construction of the Blank Park Zoo Entrance Improvements, 11-2011-001, in accordance with the contract approved between Larson & Larson Construction LLC, Jeffrey C. Larson, President, 10703 Justin Drive, Urbandale, IA 50322, under Roll Call No. 11-1159, of June 27, 2011, and the City of Des Moines, and recommending the acceptance thereof, be and the same is hereby approved, and accepted, and

BE IT FURTHER RESOLVED: That \$1,922,709.30 is the total construction cost of which \$1,826,573.83 has been paid to the Contractor, with a final partial payment of \$0.00 to be paid now, and the remaining balance of \$96,135.47 be paid at the end of thirty days, provided no claims or liens have been filed against said project, and provided that a release of this payment has been approved by the Iowa Department of Transportation through the Department of Engineering for the City of Des Moines, Iowa. Said Engineering Department shall not release this payment until all project audits have been completed, and any monetary penalties resulting from audit deficiencies shall be deducted from said balance of \$96,135.47 before being released to the Contractor.

BE IT FURTHER RESOLVED: That the City Manager be and is hereby authorized and directed to certify the Pollution Prevention Plan Inspection Summary and the NPDES Stormwater General Permit Notice of Discontinuation for the above referenced project on behalf of the City of Des Moines and submit said documents to the Iowa Department of Natural Resources.

BE IT FURTHER RESOLVED: That the Des Moines Finance Director be and is hereby authorized to release said retainage if suit is not filed as above provided.

Moved by _____ to adopt.

FORM APPROVED:

FUNDS AVAILABLE

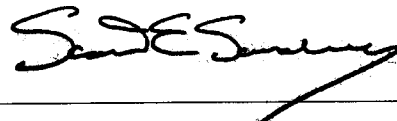
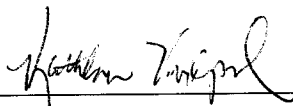

Kathleen Vanderpool
Deputy City Attorney

Scott E. Sanders
Des Moines Finance Director

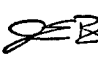

 Funding Source: 2012-2013 CIP, Page Parks - 5, Blank Park Zoo Entrance, PKS174, Being: IDOT - RISE RM-1945(780)--9D-77, \$395,936.79 (50% of construction cost up to grant maximum of \$449,725); RIFF Funding from Iowa Department of Corrections, \$999,964.44 (\$604,027.65 plus \$395,936.79 match to RISE Grant, with maximum funding of \$1,000,000), and the remaining \$526,808.07, Blank Park Zoo Foundation RM-1945(780)--9D-77

★ Roll Call Number

Agenda Item Number

13

DATE November 5, 2012

COUNCIL ACTION	YEAS	NAYS	PASS	ABSENT
COWNIE				
COLEMAN				
GRIESS				
HENSLEY				
MAHAFFEY				
MEYER				
MOORE				
TOTAL				
MOTION CARRIED				APPROVED

CERTIFICATE

I, DIANE RAUH, City Clerk of said City hereby certify that at a meeting of the City Council of said City of Des Moines, held on the above date, among other proceedings the above was adopted.

IN WITNESS WHEREOF, I have hereunto set my hand and affixed my seal the day and year first above written.

Mayor

City Clerk

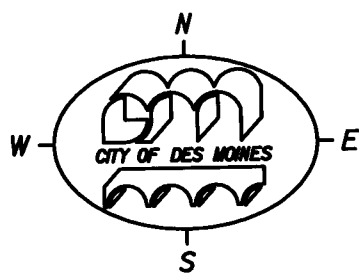
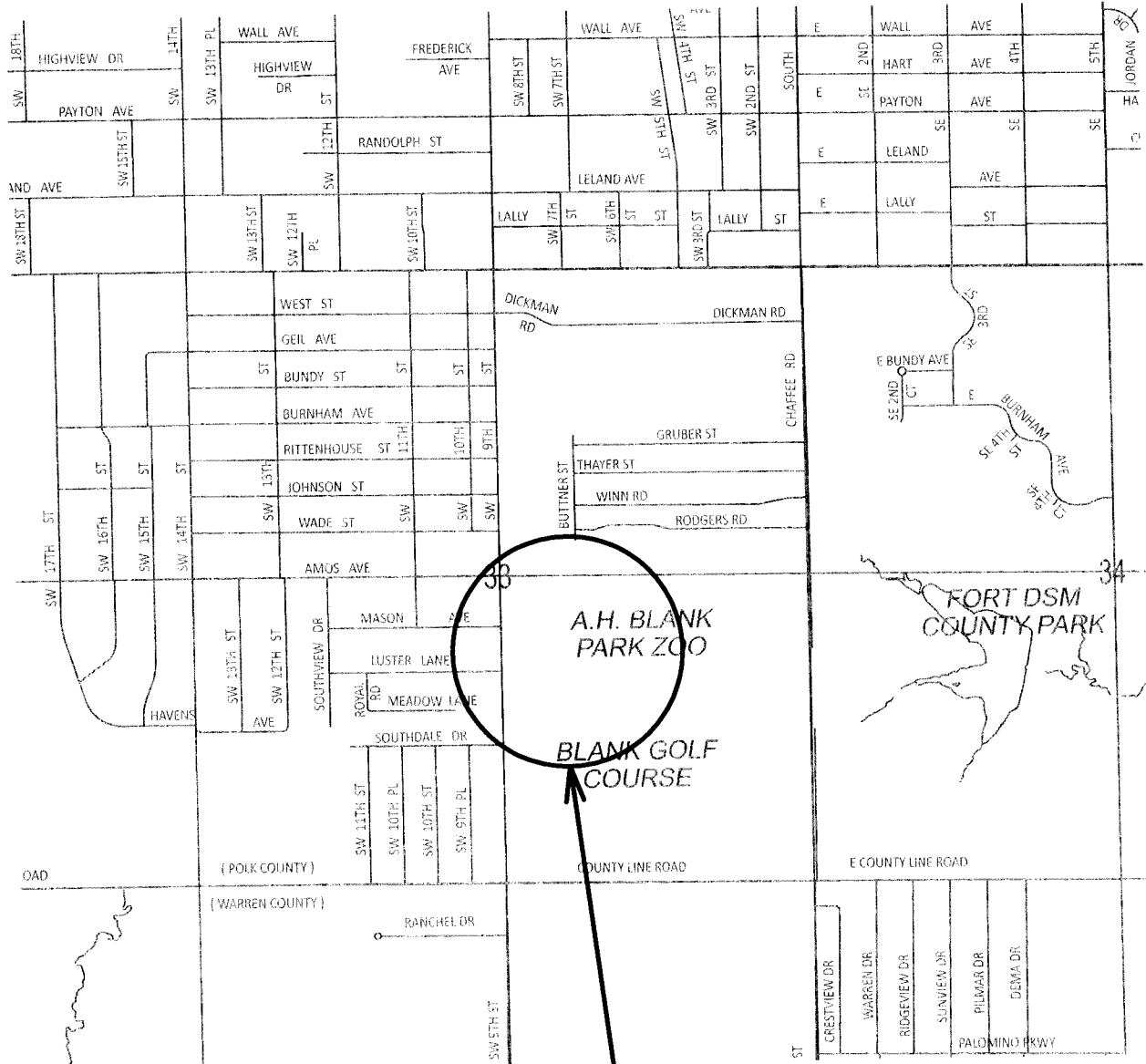

**PROJECT
LOCATION**

**BLANK PARK ZOO
ENTRANCE IMPROVEMENTS**

ACTIVITY I.D. 11-2011-001



PROJECT SUMMARY

Blank Park Zoo Entrance Improvements

Activity ID 11-2011-001

On June 27, 2011, under Roll Call No. 11-1159, the Council awarded the contract for the above improvements to Larson & Larson Construction LLC, in the amount of \$1,889,870.93. Tabulated below is a history of project change orders.

Change Order No.	Initiated By	Description	Amount
1	Consultant	8/19/2011 Modify roadway lighting, pond feature lighting, and the demolition of picnic shelter.	\$(3,395.00)
2	Consultant	8/29/2011 Contractor to incorporate fly ash treatment into the subgrade in lieu of subgrade preparation.	\$21,434.54
3	Consultant	9/29/2011 Require additional clearing and grubbing, HMA paving, and additional quantities to accomodate various field conditons.	\$9,501.62
4	Consultant	11/29/2011 Additional sod. Additional clearing and grubbing and revisions to the waterfall and picnic shelter.	\$15,842.41
5	Consultant	12/23/2011 Delete the relocation of sign due to age and condition of existing sign. Addition of a flagpole for the venting of the plumbing. Contractor to provide and install a timer switch for the control of entrance sign (archway) lights.	\$(4,075.38)
6	Consultant	4/19/2012 The women's restroom stall door required revisions to allow it to open and close properly; substitute fixtures for light poles; adjust contract quantities to match as-built quantities.	\$(16,262.05)
7	Engineering	9/6/2012 Adjust contract quantities to match as-built quantities.	\$9,792.23
Original Contract Amount			\$1,889,870.93
Total Change Orders			\$32,838.37
Percent of Change Orders to Original Contract			1.74%
Total Contract Amount			\$1,922,709.30

November 5, 2012

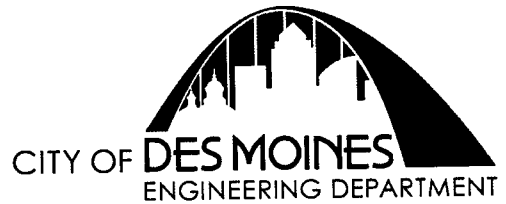

CERTIFICATION OF COMPLETION

AGENDA HEADING:

Accepting completed construction and approving final payment for the Blank Park Zoo Entrance Improvements, Larson & Larson Construction LLC.

SYNOPSIS:

Approve the Engineer's Certification of Completion, accept construction of said improvement, and authorize final payment to the contractor.

FISCAL IMPACT:

Amount: \$1,922,709.30 As-Built Contract Cost

Funding Source: 2012-2013 CIP, Page Parks - 5, Blank Park Zoo Entrance, PKS174, Being: IDOT - RISE RM-1945(780)--9D-77, \$395,936.79 (50% of construction cost up to grant maximum of \$449,725); RIFF Funding from Iowa Department of Corrections, \$999,964.44 (\$604,027.65 plus \$395,936.79 match to RISE Grant, with maximum funding of \$1,000,000), and the remaining \$526,808.07, Blank Park Zoo Foundation

CERTIFICATION OF COMPLETION:

On June 27, 2011, under Roll Call No. 11-1159, the City Council awarded a contract to Larson & Larson Construction LLC, Jeffrey C. Larson, President, 10703 Justin Drive, Urbandale, IA 50322 for the construction of the following improvement:

Blank Park Zoo Entrance Improvements, 11-2011-001

The improvement includes street paving twenty-six (26) feet wide B/B with Portland Cement Concrete seven (7) inches thick with integral curb, sidewalks, water main, storm sewer, subdrain, retaining walls, landscaping, and surface restoration. Also included in the project is playground areas, shelter building with restrooms, decorative arch signs, water features, and street lighting together with other incidental items; all in accordance with the contract documents, including Plan File Nos. 532-024/071, at the Blank Park Zoo, 7401 S.W. 9th Street, in an area north of the existing parking lot to the intersection at Rittenhouse Street and SW 9th Street, Des Moines, Iowa.

I hereby certify that the construction of said Blank Park Zoo Entrance Improvements, Activity ID 11-2011-001, has been completed in substantial compliance with the terms of said contract, and I hereby recommend that the work be accepted. The work commenced on July 28, 2012, and was completed on October 29, 2012.

I further certify that \$1,922,709.30 is the total construction cost of which \$1,826,573.83 has been paid to the Contractor, with a final partial payment of \$0.00 to be paid now, and the remaining balance of \$96,135.47 be paid at the end of thirty days, provided no claims or liens have been filed against said project, and provided that a release of this payment has been approved by the Iowa Department of Transportation through the Department of Engineering for the City of Des Moines, Iowa. Said Engineering Department shall not release this payment until all project audits have been completed, and any monetary penalties resulting from audit deficiencies shall be deducted from said balance of \$96,135.47 before being released to the Contractor. The amount of completed work is shown on the attached Estimate of Construction Completed.



Jeb E. Brewer, P.E.
Des Moines City Engineer



ESTIMATE OF CONSTRUCTION COMPLETED
FOR WORK DONE FROM 09/22/12 to 10/15/12
FINAL PAYMENT (PAYMENT NO. 10)

Proj No: 11-2011-001
Activity ID: 11-2011-001
Date: 10/15/12

PROJECT: BLANK PARK ZOO ENTRANCE IMPROVEMENTS
CONTRACTOR: LARSON & LARSON CONSTRUCTION LLC

LINE NO.	DESCRIPTION	UNIT	UNITS			TOTAL AMOUNT
			ESTIMATED	AUTHORIZED	CONSTRUCTED TO DATE	
1	Clearing and Grubbing	AC	7.8	7.790	7.79	\$20,179.14
2	Topsoil, On-Site	CY	7,709.0	7,709,000	7709.00	\$23,127.00
3	Excavation, Class 10	CY	21,606.0	21,606,000	21606.00	\$55,959.54
4	Subgrade Preparation	SY	6,202.0	585,000	585.00	\$1,333.80
5	Subbase, Modified Backfill	SY	6,202.0	6,202,000	6202.00	\$45,894.80
6	Compaction Testing	LS	1.0	1,000	1.00	\$2,729.76
7	Sanitary Sewer Gravity Main, 4" Dia.	LF	24.0	15,000	15.00	\$2,816.10
8	Sanitary Sewer Force Main, 2" Dia.	LF	250.0	537,000	537.00	\$9,778.77
9	Storm Sewer, Trenched, PVC, 4"	LF	142.0	133,000	133.00	\$4,389.00
10	Storm Sewer, Trenched, RCP, 15"	LF	740.0	804,000	804.00	\$40,248.24
11	Storm Sewer, Trenched, RCP, 18"	LF	222.0	223,000	223.00	\$11,671.82
12	Storm Sewer, Trenched, RCP, 24"	LF	160.0	161,000	161.00	\$15,204.84
13	Removal of Storm Sewer, 6"	LF	31.0	31,000	31.00	\$987.66
14	Removal of Storm Sewer, 10"	LF	200.0	335,000	335.00	\$10,673.10
15	Removal of Storm Sewer, 12"	LF	122.0	122,000	122.00	\$3,886.92
16	Pipe Apron, RCP, 15"	EA	3.0	4,000	4.00	\$6,890.60
17	Pipe Apron, RCP, 18" (Relocate)	EA	1.0	1,000	1.00	\$2,008.25
18	Pipe Apron, RCP, 24"	EA	1.0	1,000	1.00	\$2,147.06
19	Subdrain, Corrugated PVC, 6"	LF	2,579.0	2,579,000	2579.00	\$46,963.59
20	Subdrain Cleanout, Type A-1, 6"	EA	5.0	5,000	5.00	\$1,365.40
21	Subdrain Outlet and Connections, Intake and Manhole, 6"	EA	20.0	19,000	19.00	\$4,993.96
22	Water Main, 8" Dia. (Lowered)	LF	88.0	0,000	0.00	\$0.00
23	Water Service, 2" Dia.	LF	242.0	242,000	242.00	\$12,942.16
24	Relocate Existing Drinking Fountain	EA	1.0	1,000	1.00	\$7,987.47
25	Manhole, SW-301, 48" (Sanitary Sewer)	EA	1.0	1,000	1.00	\$2,255.15
26	Manhole, SW-401, 48" (Storm Sewer)	EA	4.0	5,000	5.00	\$13,204.35
27	Intake, SW-501, Single Grate	EA	7.0	7,000	7.00	\$15,746.22
28	Intake, SW-503, Single Grate Combination Manhole	EA	2.0	2,000	2.00	\$6,087.32
29	Intake, SW-505, Double Grate	EA	1.0	1,000	1.00	\$3,588.67

LINE NO.	DESCRIPTION	UNIT	UNITS			CONSTRUCTED TO DATE	UNIT PRICE	TOTAL AMOUNT
			ESTIMATED	AUTHORIZED				
30	Intake, SW-506, Double Grate Combination Manhole	EA	1.0	1.000	1.00	\$5,973.54	\$5,973.54	
31	Intake, SW-511, Rectangular Area	EA	1.0	1.000	1.00	\$2,081.07	\$2,081.07	
32	Intake, SW-513, Open-Sided Area	EA	1.0	1.000	1.00	\$3,124.44	\$3,124.44	
33	Manhole Adjustment (Sanitary Sewer)	EA	1.0	2.000	2.00	\$1,092.30	\$2,184.60	
34	Removal Storm Manhole	EA	1.0	1.000	1.00	\$802.16	\$802.16	
35	Removal Intake	EA	1.0	1.000	1.00	\$802.16	\$802.16	
36	Pavement, 6" P.C.C.	SY	451.0	451.000	451.00	\$34.13	\$15,392.63	
37	Pavement, 7" P.C.C.	SY	4,595.0	4,648.000	4648.00	\$38.00	\$176,624.00	
38	Pavement, 8" P.C.C.	SY	454.0	502.000	502.00	\$52.34	\$26,274.68	
39	P.C.C. Pavement Samples and Testing	LS	1.0	1.000	1.00	\$2,844.54	\$2,844.54	
40	Pavement Removal	SY	1,554.0	1,625.000	1625.00	\$9.10	\$14,787.50	
41	Removal of Sidewalk	SY	165.0	165.000	165.00	\$9.10	\$1,501.50	
42	Recreational Trail, 5" P.C.C.	SY	899.0	899.000	899.00	\$33.00	\$29,667.00	
43	Sidewalk, 4" P.C.C.	SY	286.0	299.000	299.00	\$30.72	\$9,185.28	
44	Sidewalk, 5" P.C.C.	SY	744.0	744.000	744.00	\$33.00	\$24,552.00	
45	Detectable Warning Panel	SF	118.0	104.000	104.00	\$36.41	\$3,786.64	
46	Conventional Seeding, Seeding, Fertilizing and Mulching, Turf Grass	AC	4.9	4.900	4.90	\$2,104.96	\$10,314.30	
47	Conventional Seeding, Seeding, Fertilizing and Mulching, Native Grasses/W	AC	1.2	1.200	1.20	\$1,843.26	\$2,211.91	
48	Plants, Deciduous Overstory Trees	EA	47.0	47.000	47.00	\$232.11	\$10,909.17	
49	Plants, Deciduous Ornamental Trees	EA	21.0	21.000	21.00	\$180.91	\$3,799.11	
50	Plants, Coniferous Trees	EA	49.0	49.000	49.00	\$188.88	\$9,255.12	
51	Plants, Ornamental Grasses	EA	465.0	461.000	461.00	\$12.52	\$5,771.72	
52	Plants, Shrubs	EA	215.0	228.000	228.00	\$30.72	\$7,004.16	
53	Plants, Perennials	EA	314.0	339.000	339.00	\$13.65	\$4,627.35	
54	Tree Protection	LS	1.0	1.000	1.00	\$967.14	\$967.14	
55	Tree Protection Fencing	LF	1,850.0	1,850.000	1850.00	\$1.82	\$3,367.00	
56	Mulch, Shredded Hard Wood	SF	17,800.0	17,800.000	17800.00	\$0.23	\$4,094.00	
57	Metal Edging	LF	675.0	675.000	675.00	\$4.55	\$3,071.25	
58	Storm Water Pollution Prevention	LS	1.0	1.000	1.00	\$1,422.27	\$1,422.27	
59	Erosion Control Mulching, Conventional Mulch	AC	7.2	5.700	5.70	\$398.24	\$2,269.97	
60	Turf Reinforcement Mat (TRM)	SY	659.0	684.000	684.00	\$10.87	\$7,435.08	
61	Filter Sock, Installation, Maintenance and Removal	LF	32.0	180.000	180.00	\$4.55	\$819.00	
62	Sediment Basin Outlet, Installation, Maintenance and Removal	EA	2.0	2.000	2.00	\$766.89	\$1,533.78	
63	Silt Fence, Installation, Maintenance and Removal	LF	3,742.0	1,978.000	1978.00	\$1.82	\$3,599.96	
64	Stabilized Construction Entrance	TON	105.0	105.000	105.00	\$24.35	\$2,556.75	
65	Inlet Protection Device, Installation, Maintenance and Removal	EA	11.0	11.000	11.00	\$68.27	\$750.97	
66	Outlet Protection, ScourStop	SF	208.0	208.000	208.00	\$18.21	\$3,787.68	
67	Concrete Washout Pit	EA	3.0	2.000	2.00	\$909.30	\$1,818.60	

LINE NO.	DESCRIPTION	UNIT	UNITS			CONSTRUCTED TO DATE	UNIT PRICE	TOTAL AMOUNT
			ESTIMATED	AUTHORIZED				
68	Fence, Chain Link with Security Top, 120" Height (Type 1)	LF	725.0	725.000		725.00	\$45.23	\$32,791.75
69	Fence, Chain Link, 96" Height (Type 2)	LF	1,677.0	1,677.000		1677.00	\$20.18	\$33,841.86
70	Fence, Chain Link, 42" Height (Type 3)	LF	117.0	117.000		117.00	\$32.00	\$3,744.00
71	Remove Existing Fence	LF	1,311.0	1,311.000		1311.00	\$2.73	\$3,579.03
72	Gate, 30' Double Swing Chain Link With Security Top, 120" Height (Type 1)	EA	1.0	1.000		1.00	\$1,223.01	\$1,223.01
73	Gate, 12' Double Swing Chain Link With Security Top, 120" Height (Type 1)	EA	1.0	1.000		1.00	\$761.64	\$761.64
74	Gate, 30' Double Swing Chain Link, 96" Height (Type 2)	EA	1.0	1.000		1.00	\$1,045.70	\$1,045.70
75	Gate, 12' Double Swing Chain Link, 96" Height (Type 2)	EA	1.0	1.000		1.00	\$676.29	\$676.29
76	Gate, 7' Single Swing Chain Link, 96" Height (Type 2)	EA	1.0	1.000		1.00	\$346.67	\$346.67
77	Gate, 54' Rolling Chain Link, 96" Height	EA	1.0	1.000		1.00	\$3,125.71	\$3,125.71
78	Retaining Wall, Modular Block	SF	805.0	873.000		873.00	\$19.89	\$17,363.97
79	Steps, P.C.C.	SF	150.0	150.000		150.00	\$26.52	\$3,978.00
80	Handrail (Ramp)	LF	218.0	218.000		218.00	\$34.10	\$7,433.80
81	Building Demolition (Existing Restrooms/Fountain/Playground)	LS	1.0	1.000		1.00	\$11,367.91	\$11,367.91
82	Traffic Control	LS	1.0	1.000		1.00	\$3,592.26	\$3,592.26
83	Traffic Signs (Relocate)	EA	2.0	2.000		2.00	\$341.04	\$682.08
84	Traffic Signs	EA	5.0	5.000		5.00	\$228.13	\$1,140.65
85	Painted Pavement Markings	STA	32.2	32.210		32.21	\$219.40	\$7,066.87
86	Painted Pavement Symbols	EA	5.0	5.000		5.00	\$250.09	\$1,250.45
87	Waterfall System	LS	1.0	1.000		1.00	\$79,650.97	\$79,650.97
88	Stone, Winnebago Stone	TON	82.0	82.000		82.00	\$484.62	\$39,738.84
89	Stone, Lannon Stone	TON	118.0	118.000		118.00	\$353.49	\$41,711.82
90	PVC Duct, Trenched, 24" Depth	LF	1,850.0	1,850.000		1850.00	\$18.76	\$34,706.00
91	Handhole, Electrical	EA	11.0	11.000		11.00	\$776.54	\$8,541.94
92	Entry Lights	EA	3.0	3.000		3.00	\$23,832.07	\$71,496.21
93	Roadway Light	EA	6.0	6.000		6.00	\$5,212.27	\$31,273.62
94	Pedestrian Light	EA	2.0	2.000		2.00	\$4,293.19	\$8,586.38
95	Pond Feature Light	EA	5.0	5.000		5.00	\$570.15	\$2,850.75
96	Light Pole Bases & Installation	EA	13.0	13.000		13.00	\$944.16	\$12,274.08
97	Light Controller Box	EA	1.0	1.000		1.00	\$171.04	\$171.04
98	Relocation of Light Pole	EA	2.0	2.000		2.00	\$1,670.53	\$3,341.06
99	Entrance Sign (Archway)	LS	1.0	1.000		1.00	\$171,795.22	\$171,795.22
100	Relocation of Blank Park Zoo Entrance Sign	LS	1.0	1.000		1.00	\$13,563.71	\$13,563.71
101	Picnic Shelter/Restroom	LS	1.0	1.000		1.00	\$343,575.60	\$343,575.60
102	Play Area, Play Structures	LS	1.0	1.000		1.00	\$24,676.63	\$24,676.63
103	Play Area, Engineered Wood Fiber Surface	CY	82.0	82.000		82.00	\$59.50	\$4,879.00
104	Play Area, PCC Curb Edge	LF	175.0	175.000		175.00	\$25.44	\$4,452.00
105	Play Area, Under Drain	LS	1.0	1.000		1.00	\$2,851.68	\$2,851.68

LINE NO.	DESCRIPTION	UNIT	UNITS			TOTAL AMOUNT
			ESTIMATED	AUTHORIZED	CONSTRUCTED TO DATE	
106	Construction Survey	LS	1.0	1.000	1.00	\$11,275.53
107	Mobilization	LS	1.0	1.000	1.00	\$55,000.00
1.01	Additional Clearing and Grubbing	LS	0.0	1.000	1.00	\$1,072.50
1.02	Building Demolition Modifications	LS	0.0	1.000	1.00	\$4,532.50
1.03	Roadway Lighting Modifications	LS	0.0	1.000	1.00	-\$450.00
1.04	Pond Feature Light Modifications	LS	0.0	1.000	1.00	-\$3,650.00
1.05	Picnic Shelter/Restroom Modifications	LS	0.0	1.000	1.00	-\$4,900.00
2.01	Subgrade Treatment, Class C Fly Ash	SY	0.0	5,746.000	5746.00	\$7.15
2.02	Geotechnical Analysis for Fly Ash Subgrade Treatment	LS	0.0	1.000	1.00	\$242.00
3.01	ADDITIONAL CLEARING AND GRUBBING	LS	0.0	1.000	1.00	\$1,100.00
3.02	Subgrade Preparation, Fine Grading	SY	0.0	5,746.000	5746.00	\$1.07
3.03	SUBDRAIN OUTLET, RF-19E, 6"	EACH	0.0	1.000	1.00	\$440.00
3.04	Trench Excavation, Existing Water Main	LF	0.0	50.000	50.00	\$22.00
3.05	PAVEMENT, H.M.A. OVERLAY	TON	0.0	6.000	6.00	\$440.00
4.01	ADDITIONAL CLEARING AND GRUBBING	LS	0.0	1.000	1.00	\$2,310.00
4.02	Sodding	SY	0.0	200.000	200.00	\$66.00
4.03	Water Feature Modification	LS	0.0	1.000	1.00	\$7,943.10
4.04	Revisions to Picnic Shelter/Restroom	LS	0.0	1.000	1.00	\$507.31
5.01	Revisions to Relocation of Sign	LS	0.0	1.000	1.00	(\$10,155.91)
5.02	Flagpole/Vent Pipe for Picnic Shelter/Restroom	LS	0.0	1.000	1.00	\$6,080.53
6.01	Revisions to Bid Item #101 Picnic Shelter/Restroom	LS	0.0	1.000	1.00	\$1,216.60
6.02	Revisions to Bid Item #92 Entry Lights	LS	0.0	1.000	1.00	(\$17,892.00)
6.03	Revisions to Bid Item #93 and #94	LS	0.0	1.000	1.00	(\$18,719.00)
7.01	Shelter Water Service Check Valve	LS	0.0	1.000	1.00	\$364.10
7.02	Shelter Roof Edging	LS	0.0	1.000	1.00	\$304.00
7.03	Wetland Seeding	LS	0.0	1.000	1.00	\$737.00

LINE NO.	DESCRIPTION	UNIT	UNITS		UNIT PRICE	TOTAL AMOUNT
			ESTIMATED	AUTHORIZED		
	TOTAL CONTRACT AMOUNT PLUS CHANGE ORDERS		\$1,922,709.30			
	PARTIAL PAYMENT NO. 1		\$80,166.55			
	PARTIAL PAYMENT NO. 2		\$398,605.51			
	PARTIAL PAYMENT NO. 3		\$501,839.70			
	PARTIAL PAYMENT NO. 4		\$491,242.37			
	PARTIAL PAYMENT NO. 5		\$153,175.41			
	PARTIAL PAYMENT NO. 6		\$86,784.03			
	PARTIAL PAYMENT NO. 7		\$95,739.52			
	PARTIAL PAYMENT NO. 8		\$9,632.71			
	PARTIAL PAYMENT NO. 9		\$9,388.03			
	THIS PARTIAL PAYMENT		\$38,454.19			
	TOTAL PARTIAL PAYMENTS		\$1,865,028.02			
	BALANCE		\$57,681.28			
	TOTAL					\$1,922,709.30
	RETAINAGE					\$57,681.28
	TOTAL LESS RETAINAGE					\$1,865,028.02
	LESS PREVIOUS PAYMENT					\$1,826,573.83
	AMOUNT DUE					\$38,454.19

PREPARED BY: 

CHECKED BY: 

CONTRACTOR: 

FINAL PAYMENT (PAYMENT NO. 10)