

9A

DATE January 14, 2013

ACCEPTING COMPLETED CONSTRUCTION AND APPROVING FINAL PAYMENT FOR EASTON BOULEVARD BRIDGE OVER FOUR MILE CREEK, HERBERGER CONSTRUCTION CO., INC.

BE IT RESOLVED BY THE CITY COUNCIL OF THE CITY OF DES MOINES, IOWA: That the attached report of the Des Moines City Engineer, showing the cost of the construction of the Easton Boulevard Bridge over Four Mile Creek, 12-2007-004, in accordance with the contract approved between Herberger Construction Co., Inc., Dean Herberger, President, 2508 West 2nd Avenue, P.O. Box 326, Indianola, IA 50125, under Roll Call No. 10-982, of June 14, 2010, and the City of Des Moines, and recommending the acceptance thereof, be and the same is hereby approved, and accepted, and

BE IT FURTHER RESOLVED: That \$1,467,638.72 is the total cost, of which \$1,409,478.03 has been paid the Contractor, and \$28,160.69 is now due and is hereby approved as final partial payment for the above project, the remaining balance of \$30,000.00 is to be paid at the end of thirty days, with funds retained for unresolved claims on file in accordance with Iowa Code Chapter 573.

BE IT FURTHER RESOLVED: That the Des Moines Finance Director be and is hereby authorized to release said retainage if suit is not filed as above provided.

Moved by _____ to adopt.

FORM APPROVED:

FUNDS AVAILABLE

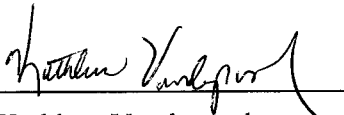

Kathleen Vanderpool
Deputy City Attorney



Scott E. Sanders
Des Moines Finance Director

Funding Source: 2012-2013 CIP, Page Bridge - 6, Easton Boulevard over Four Mile Creek, BRV042, Being: Federal Highway Bridge Program funds for 80% of construction costs with a \$1,000,000 maximum, and the remaining \$467,638.72 in gaming monies.

DEB

BRM-1945(729)--8N-77

★ **Roll Call Number**

Agenda Item Number

9A

DATE January 14, 2013

COUNCIL ACTION	YEAS	NAYS	PASS	ABSENT
COWNIE				
COLEMAN				
GRIESS				
HENSLEY				
MAHAFFEY				
MEYER				
MOORE				
TOTAL				

MOTION CARRIED

APPROVED

Mayor

I, Diane Rauh, City Clerk of said City Council, hereby certify that at a meeting of the City Council, held on the above date, among other proceedings the above was adopted.

IN WITNESS WHEREOF, I have hereunto set my hand and affixed my seal the day and year first above written.

City Clerk

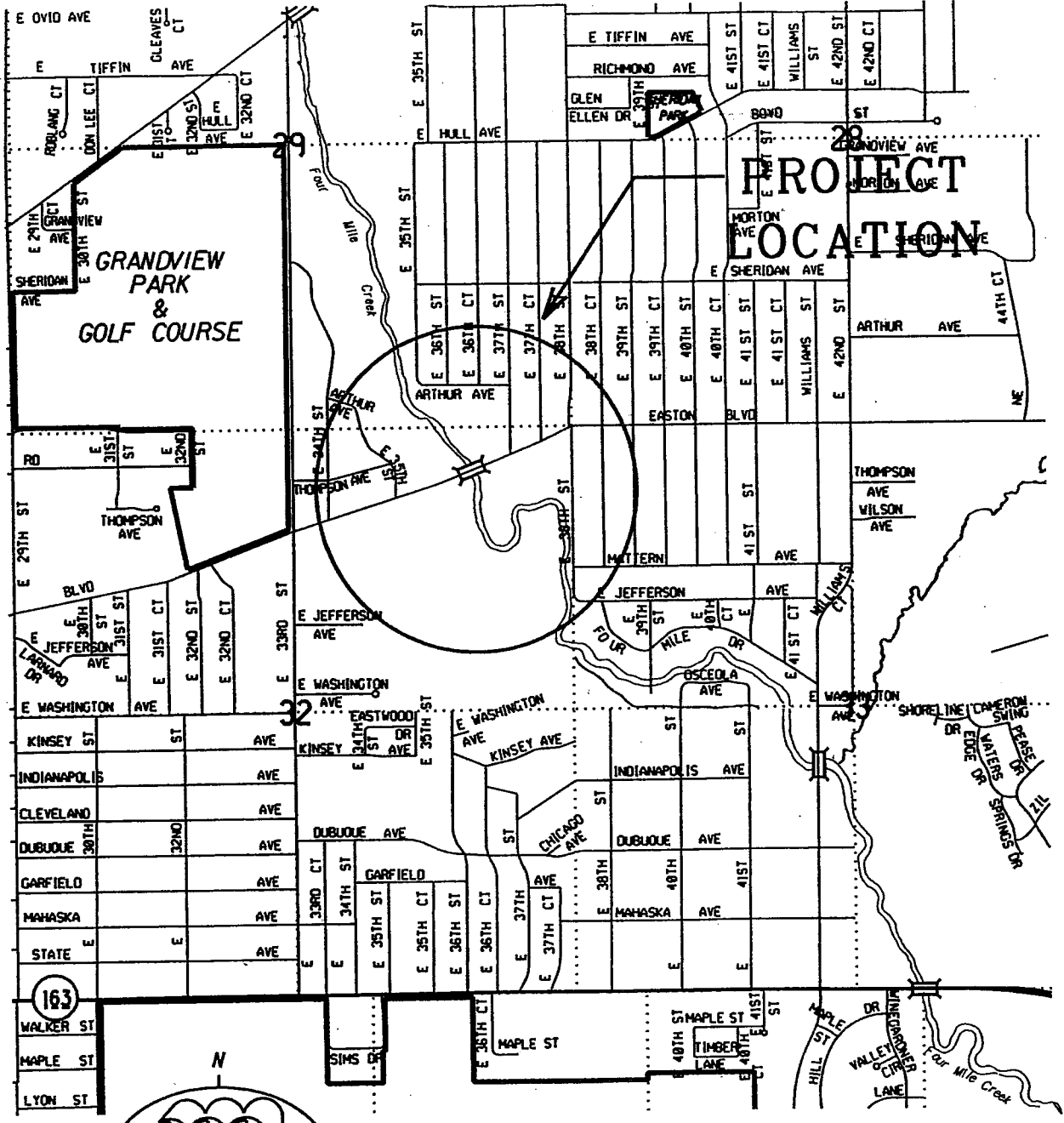

**PROJECT
LOCATION**

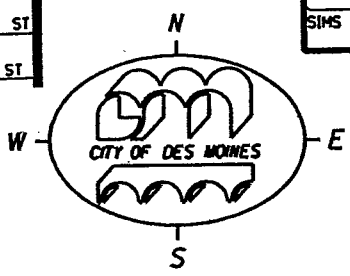

**EASTON BOULEVARD BRIDGE
OVER FOUR MILE CREEK
ACTIVITY ID 12-2007-004**

sf/jr-dates

PROJECT SUMMARY

Easton Boulevard Bridge over Four Mile Creek

Activity ID 12-2007-004

On June 14, 2010, under Roll Call No. 10-982, the Council awarded the contract for the above improvements to Herberger Construction Co., Inc., in the amount of \$1,348,338.76. Tabulated below is a history of project change orders.

Change Order No.	Initiated By	Description	Amount
1	Engineering	1/25/2011 Modification of pedestrian handrail bracket to provide 5' sidewalk width, and installation of construction site fence to mitigate vandalism.	\$23,872.00
2	Engineering	1/31/2011 Installation of underground utility conduit for bridge construction. Longitudinal grooving in deck concrete.	\$24,795.25
3	Engineering	2/8/2011 Epoxy reinforcing steel supports for traffic rail reinforcing. Excavation of old foundation and pavement. Heating and protection of bridge deck, north and south traffic barrier rails. Installation of temporary barrier rail.	\$20,314.57
4	Engineering	2/21/2011 Construct temporary pavement on east side of project.	\$22,854.65
5	Engineering	3/7/2011 Construct temporary pavement on west side of project.	\$18,742.95
6	Engineering	3/23/2011 Equipment and labor for installation of asphalt millings for approach roadway construction. Asphalt milling material for approach roadway construction.	\$20,664.60
7	Engineering	10/10/2011 Add metered electrical service for underbridge lighting; footing for USGS gauge on Four Mile Creek; partial removal of submerged pier footing.	\$20,287.66
8	Engineering	Adjust Final Quantities to As-Built Quantities.	\$(32,231.72)

9A

Original Contract Amount	\$1,348,338.76
Total Change Orders	\$119,299.96
Percent of Change Orders to Original Contract	8.85%
Total Contract Amount	\$1,467,638.72

9A

January 14, 2013

CERTIFICATION OF COMPLETION



AGENDA HEADING:

Accepting completed construction and approving final payment for the Easton Boulevard Bridge over Four Mile Creek, Herberger Construction Co., Inc..

SYNOPSIS:

Approve the Engineer's Certification of Completion, accept construction of said improvement, and authorize final payment to the contractor.

FISCAL IMPACT:

Amount: \$1,467,638.72 As-Built Contract Cost

Funding Source: 2012-2013 CIP, Page Bridge - 6, Easton Boulevard over Four Mile Creek, BRV042, Being: Federal Highway Bridge Program funds for 80% of construction costs with a \$1,000,000 maximum, and the remaining \$467,638.72 in gaming monies.

CERTIFICATION OF COMPLETION:

On June 14, 2010, under Roll Call No. 10-982, the City Council awarded a contract to Herberger Construction Co., Inc., Dean Herberger, President, 2508 West 2nd Avenue, P.O. Box 326, Indianola, IA 50125 for the construction of the following improvement:

Easton Boulevard Bridge over Four Mile Creek, 12-2007-004

The improvement includes the following:

- Division I: Excavation Class 10 Channel, Removal of Existing Bridge, Excavation Class 20 and 21, Structural Concrete (Bridge), Colored Sealer Coating for Structural Concrete, Reinforcing Steel, Epoxy Coated Reinforcing Steel, Concrete Open Railing, Steel Pipe Pedestrian Railing, Structural Steel Pedestrian Railing, Piles Steel, Engineering Fabric, Revetment Class E, Electrical Circuits, Mobilization, Light Fixture;
- Division II: Clearing and Grubbing, Excavation Class 10 Roadway and Borrow, Top Soil Strip and Spread, Compaction with Moisture and Density Control, Bridge Approach Pavement, Standard or Slip Form 9" PCC Pavement Class C, Removal of Existing Structures, Aprons Concrete 30" and 48", Remove and Reinstall Concrete Pipe Aprons, Manhole Storm Sewer, Storm Sewer (Class II) 30" and 3000 (Class IV) 48", Removal of Storm Sewer Pipe, Removal of Steel Guard Rail, Erosion Stone, Removal of Pavement, Removal Intakes and Utility Access, Removal of Recreational Trail, Recreational Trail 6" and 8" PCC, Special Compaction of Subbase, Removal of Sidewalk, Sidewalk PCC 4" and 8", Detectable Warnings for Curb Ramps, Concrete Barrier Rail, Safety Closure, Fence Chain Link 48", Construction Survey, Painted Pavement Markings, Traffic Control, Fencing, Mulching, Seeding and Sodding, Silt Fence. All work shall be in accordance with the contract documents, including Plan File Nos. 519-001/047 for Easton Boulevard Bridge over Four Mile Creek in Des Moines, Iowa.

9A

I hereby certify that the construction of said Easton Boulevard Bridge over Four Mile Creek, Activity ID 12-2007-004, has been completed in substantial compliance with the terms of said contract, and I hereby recommend that the work be accepted. The work commenced on July 22, 2010, and was completed on December 20, 2012.

I further certify that \$1,467,638.72 is the total cost of said improvement, of which \$1,409,478.03 has been paid the Contractor and \$28,160.69 is now due and is hereby approved as final partial payment for the above project, the remaining balance of \$30,000.00 is to be paid at the end of thirty days, with funds retained for unresolved claims on file in accordance with Iowa Code Chapter 573. The amount of completed work is shown on the attached Estimate of Construction Completed.



Jeb E. Brewer, P.E.
Des Moines City Engineer



ENGINEERING DEPARTMENT
CITY OF DES MOINES, IOWA

ESTIMATE OF CONSTRUCTION COMPLETED
FOR WORK DONE FROM 08/27/2011 to 01/30/2012
PARTIAL PAYMENT NO. 7 - FINAL

Proj No: BRM-1945(729)-8N-77
Activity ID: 12-2007-004
Date: 12/20/2012

PROJECT: EASTON BLVD. BRIDGE OVER FOUR MILE CREEK REPLACEMENT
CONTRACTOR: HERBERGER CONSTRUCTION INC.

LINE NO.	DESCRIPTION	UNIT	UNITS			CONSTRUCTED TO DATE	UNIT PRICE	TOTAL AMOUNT
			ESTIMATED	AUTHORIZED				
1	EXCAVATION, CLASS 10, CHANNEL	CY	1,300,000	466,670	466,670	\$7.30	\$3,406.69	
2	REMOVAL OF EXISTING BRIDGE	LS	1,000	1,000	1,000	\$60,000.00	\$60,000.00	
3	EXCAVATION, CLASS 20	CY	194,000	194,000	194,000	\$24.00	\$4,656.00	
4	EXCAVATION, CLASS 21	CY	80,000	80,000	80,000	\$230.00	\$18,400.00	
5	STRUCTURAL CONCRETE (BRIDGE)	CY	929,200	929,200	929,200	\$455.00	\$422,786.00	
6	COLOR SEALER COATING FOR STRUC. CONC.	SY	758,000	758,000	758,000	\$19.00	\$14,402.00	
7	REINFORCING STEEL	LB	19,908,000	19,908,000	19,908,000	\$0.85	\$16,921.80	
8	REINFORCING STEEL, EPOXY COATED	LB	165,704,000	165,704,000	165,704,000	\$0.85	\$140,848.40	
9	CONCRETE OPEN RAILING	LF	342,000	342,000	342,000	\$98.00	\$33,516.00	
10	STL PIPE PEDESTRIAN HAND RAIL (1-8 HEIGHT)	LF	321,170	321,170	321,170	\$42.00	\$13,489.14	
11	STRUCTURAL STEEL PEDESTRIAN HAND RAILING	LF	341,340	341,340	341,340	\$109.00	\$37,206.06	
12	PILES, STEEL, HP 10 X 42	LF	1,125,000	1,125,000	1,125,000	\$33.00	\$37,125.00	
13	PILES, STEEL, HP 14 X 73	LF	1,800,000	1,800,000	1,800,000	\$46.00	\$82,800.00	
14	PREBORED HOLES	LF	180,000	175,000	175,000	\$41.00	\$7,175.00	
15	ENGINEERING FABRIC	SY	1,350,000	576,130	576,130	\$3.15	\$1,814.81	
16	REVTMENT, CLASS E	TON	850,000	338,140	338,140	\$50.00	\$16,907.00	
17	ELECTRICAL CIRCUITS	LF	1,261,000	1,380,000	1,380,000	\$11.50	\$15,870.00	
18	MOBILIZATION	LS	1,000	1,000	1,000	\$9,000.00	\$9,000.00	
19	LIGHT FIXTURE	EACH	2,000	2,000	2,000	\$930.00	\$1,860.00	
20	CLEARING AND GRUBBING	ACRE	0.840	0.840	0.840	\$10,400.00	\$8,736.00	
21	CLEARING AND GRUBBING	UNIT	107,600	107,600	107,600	\$56.00	\$6,025.60	
22	EXCAVATION, CLASS 10, ROADWAY AND BORROW	CY	3,896,000	3,896,000	3,896,000	\$4.70	\$18,311.20	
23	TOPSOIL, STRIP, SALVAGE AND SPREAD	CY	220,000	220,000	220,000	\$15.00	\$3,300.00	
24	COMPACTION WITH M AND D CONTROL	CY	565,000	400,000	400,000	\$3.80	\$1,520.00	
25	BRIDGE APPROACH PAVEMENT, AS PER PLAN	SY	589,500	589,500	589,500	\$120.00	\$70,740.00	
26	PCC PAVEMENT, CL. C, CL. 2 DURABILITY, 9 IN.	SY	1,357,000	1,383,280	1,383,280	\$48.50	\$67,089.08	
27	REMOVAL OF EXISTING STRUCTURES	LS	1,000	1,000	1,000	\$3,800.00	\$3,800.00	
28	APRONS, CONCRETE, 30 IN. DIA.	EACH	1,000	1,000	1,000	\$2,500.00	\$2,500.00	
29	APRONS, CONCRETE, 48 IN. DIA.	EACH	1,000	1,000	1,000	\$4,570.00	\$4,570.00	
30	REMOVE/REINSTALL CONC PIPE APRONS >36 IN.	EACH	1,000	1,000	1,000	\$1,870.00	\$1,870.00	
31	MANHOLE, STORM SEWER, SW-401, 84 IN.	EACH	1,000	1,000	1,000	\$9,000.00	\$9,000.00	
32	INTAKE, SW-508	EACH	2,000	2,000	2,000	\$4,570.00	\$9,140.00	
33	STORM SEWER, RCP, 2000D (CLASS III), 30 IN.	LF	115,000	115,000	115,000	\$95.00	\$10,925.00	
34	STORM SEWER, RCP, 3000D (CLASS IV), 24 IN.	LF	49,000	49,000	49,000	\$79.00	\$3,871.00	
35	REMOVE STORM SEWER PIPE < OR EQUAL TO 36 IN.	LF	101,000	113,000	113,000	\$19.50	\$2,203.50	
36	REMOVAL OF STEEL BEAM GUARDRAIL	LF	87,500	87,500	87,500	\$12.00	\$1,050.00	
37	EROSION STONE	TON	40,000	3,350	3,350	\$78.00	\$261.30	
38	REMOVAL OF PAVEMENT	SY	1,822,200	1,822,200	1,822,200	\$4.10	\$7,471.02	
39	REMOVAL OF INTAKES AND UTILITY ACCESSSES	EACH	2,000	2,000	2,000	\$800.00	\$1,600.00	
40	REMOVAL OF RECREATIONAL TRAIL	SY	720,600	720,600	720,600	\$3.40	\$2,450.04	
41	REC TRAIL, PCC, 6 IN.	SY	728,800	793,070	793,070	\$34.00	\$26,964.38	
42	REC TRAIL, PCC, 8 IN.	SY	53,200	32,370	32,370	\$48.50	\$1,569.95	

9A

LINE NO.	DESCRIPTION	UNIT	UNITS			CONSTRUCTED TO DATE	UNIT PRICE	TOTAL AMOUNT
			ESTIMATED	AUTHORIZED				
43	SPL COMPACTION OF SUBGRADE FOR REC TRAIL	STA	6.500	5.300	5.300	\$700.00	\$3,710.00	
44	REMOVAL OF SIDEWALK	SY	397.000	397.000	397.000	\$4.00	\$1,588.00	
45	SIDEWALK, P.C. CONCRETE, 4 IN.	SY	214.100	240.710	240.710	\$36.90	\$8,882.20	
46	SIDEWALK, P.C. CONCRETE, 8 IN.	SY	8.300	4.670	4.670	\$48.50	\$226.50	
47	DETECTABLE WARNINGS FOR CURB RAMPS	SF	82.000	72.000	72.000	\$17.00	\$1,224.00	
48	CONCRETE BARRIER RAIL, BA-108	EACH	4.000	4.000	4.000	\$2,500.00	\$10,000.00	
49	SAFETY CLOSURE	EACH	4.000	4.000	4.000	\$210.00	\$840.00	
50	FENCE, CHAIN LINK, 48 IN. HEIGHT	LF	230.000	287.300	287.300	\$16.30	\$4,682.99	
51	CONSTRUCTION SURVEY	LS	1.000	1.000	1.000	\$5,100.00	\$5,100.00	
52	PAINTED PAVE MARKING, WATERBORNE OR SOLVENT	STA	18.580	39.560	39.560	\$62.00	\$2,452.72	
53	TRAFFIC CONTROL	LS	1.000	1.000	1.000	\$9,000.00	\$9,000.00	
54	PROTECTION FENCE	LF	3,445.000	2,288.000	2,288.000	\$1.48	\$3,386.24	
55	REMOVAL OF FENCE	LF	372.000	372.000	372.000	\$3.10	\$1,153.20	
56	TREE PROTECTION	LS	1.000	1.000	1.000	\$1,600.00	\$1,600.00	
57	MULCHING	ACRE	1.450	1.450	1.450	\$700.00	\$1,015.00	
58	SEEDING AND FERTILIZING (URBAN)	ACRE	1.450	1.450	1.450	\$1,800.00	\$2,610.00	
59	SODDING	SQ	35.500	55.948	55.948	\$36.00	\$2,014.13	
60	SILT FENCE	LF	1,275.000	1,760.000	1,760.000	\$1.80	\$3,168.00	
61	CLEAN-OUT OF SILT FENCE	LF	1,275.000	0.000	0.000	\$0.30	\$0.00	
CHANGE ORDERS								
CO No. 1	1.01 Railing Brackets to Provide for 5' Sidewalk Width	LS	-	1.000	1.000	\$9,170.00	\$9,170.00	
	1.02 Security Fencing for Site	LS	-	1.000	1.000	\$14,702.00	\$14,702.00	
CO No. 2	2.01 Utility Conduits Supply and Install	LS	-	1.000	1.000	\$16,536.85	\$16,536.85	
	2.02 Longitudinal Grooving in concrete	SY	-	12.000	1.000	\$8,258.40	\$8,258.40	
CO No. 3	3.01 Epoxy reinforcing steel supports	LB	-	1,460.000	1,460.000	\$0.915966	\$1,337.31	
	3.02 Excavation for old foundation	LS	-	1.000	1.000	\$2,350.76	\$2,350.76	
	3.03 Heating and Protection of Bridge Deck	CY	-	671.600	671.600	\$12.00	\$8,059.20	
	3.04 Heating and Protection of North Rail	CY	-	18.950	18.950	\$12.00	\$227.40	
	3.05 Heating and Protection of South Rail	CY	-	18.950	18.950	\$12.00	\$227.40	
	3.06 Temporary Barrier Rail	LF	-	737.500	737.500	\$11.00	\$8,112.50	
CO No. 4	4.01 Temporary Approach Pavement (East side)	SY	-	637.330	637.330	\$35.86	\$22,854.65	
CO No. 5	5.01 Temporary Approach Pavement West side	SY	-	522.670	522.670	\$35.86	\$18,742.95	
CO No. 6	6.01 Equipment and labor for installation of HMA Millings	LS	-	1.000	1.000	\$11,929.50	\$11,929.50	
	6.02 HMA Millings for subgrade under Temporary Pavement	TON	-	794.100	794.100	\$11.00	\$8,735.10	
CO No. 7	7.01 Metered Electrical Service Supply and Install	LS	-	1.000	1.000	\$3,284.60	\$3,284.60	
	7.02 USGS Gauging Stion Footing	LS	-	1.000	1.000	\$1,350.00	\$1,350.00	
	7.03 Removal of submerged Abutment and Pier 2 Paving	LS	-	1.000	1.000	\$2,350.78	\$2,350.78	
	7.04 Repair damaged Barrier Rail due to Collision	LS	-	1.000	1.000	\$1,441.00	\$1,441.00	
	7.05 Removal of submerged Rip Rap and Pier - Pier 1 and West Abutment	LS	-	1.000	1.000	\$5,557.28	\$5,557.28	
	7.06 CMS for Closure of Easton Blvd. after Winter Shutdown	LS	-	1.000	1.000	\$1,320.00	\$1,320.00	
	7.08 Concrete Material Cost Increase due to Utility Delay	LS	-	1.000	1.000	\$4,984.00	\$4,984.00	
CO No. 8	8.00 Adjust Final Quantities to As Built	LS	-	-	-	-	\$0.00	
	8.01 - 8015 Replace primary electrical service	LS	-	1.000	1.000	\$302.09	\$302.09	
ORIGINAL CONTRACT AMOUNT \$1,348,338.76								
AMOUNT OF APPROVED CHANGE ORDERS 1 TO 8 \$119,299.96								
TOTAL CONTRACT AMOUNT PLUS CHANGE ORDERS \$1,467,638.72								

9A

LINE NO.	DESCRIPTION	UNIT	UNITS		CONSTRUCTED TO DATE	UNIT PRICE	TOTAL AMOUNT
			ESTIMATED	AUTHORIZED			
	PARTIAL PAYMENT NO. 1		\$253,584.26				
	PARTIAL PAYMENT NO. 2		\$688,303.64				
	PARTIAL PAYMENT NO. 3		\$158,010.42				
	PARTIAL PAYMENT NO. 4		\$89,182.90				
	PARTIAL PAYMENT NO. 5		\$186,789.54				
	PARTIAL PAYMENT NO. 6		\$33,607.27				
	THIS PARTIAL PAYMENT		\$28,160.69				
	TOTAL PARTIAL PAYMENTS		\$1,437,638.72				
	BALANCE		\$30,000.00				
			PERCENT COMPLETE				
				97.96%			
					TOTAL	\$1,467,638.72	
					RETAINAGE	\$30,000.00	
					TOTAL LESS RETAINAGE	\$1,437,638.72	
					LESS PREVIOUS PAYMENT	\$1,409,478.03	
					AMOUNT DUE	\$28,160.69	

PARTIAL PAYMENT NO. 7 - FINAL

PREPARED BY: [Signature]
 CHECKED BY: [Signature]
 CONTRACTOR ACCEPTANCE: [Signature]