

DATE March 25, 2013

PUBLIC HEARING, APPROVING PLANS, SPECIFICATIONS, FORM OF CONTRACT DOCUMENTS, AND ENGINEER'S ESTIMATE ON 4500 BLOCK OF WAKONDA PARKWAY SANITARY SEWER; RECEIVE AND FILE BIDS; AND DESIGNATION OF LOWEST RESPONSIVE, RESPONSIBLE BIDDER AS T K CONCRETE INC., TONY J. VER MEER, PRESIDENT, \$54,143.50

WHEREAS, on February 25, 2013, under Roll Call No. 13-0290, plans, specifications, form of contract documents, and Engineer's estimate of construction cost were filed with the City Clerk, for the construction of the following improvement:

4500 Block of Wakonda Parkway Sanitary Sewer, 07-2012-012

The improvement includes construction of a new sanitary sewer lateral main to service three properties on the 4500 block of Wakonda Parkway. This project will allow for the abandonment of deteriorated and obsolete septic systems that are located on these properties. This contract includes construction of the sanitary sewer, a sanitary manhole, sanitary sewer service stubs, restoration of pavement, and other incidental items; all in accordance with the contract documents including Plan File Nos. 549-041/047

WHEREAS, notice of the hearing on the plans, specifications, form of contract documents, and Engineer's estimate of construction cost was published as required by law.

NOW, THEREFORE, BE IT RESOLVED BY THE CITY COUNCIL OF THE CITY OF DES MOINES, IOWA: That the hearing on the plans, specifications, form of contract documents, and Engineer's estimate of construction cost for said improvement be closed; and that said plans, specifications, form of contract documents, and Engineer's estimate of construction cost are hereby approved as the plans, specifications, form of contract documents, and Engineer's estimate of construction cost for said improvement.

BE IT FURTHER RESOLVED: That sealed bids for said improvement were submitted by the following bidders:

★ **Roll Call Number**

Agenda Item Number

52

DATE March 25, 2013

T K Concrete Inc.	Pella, IA
Sandstone Management, LTD.	Carlisle, IA
Vanderpool Construction, Inc.	Indianola, IA
The Underground Company, Ltd.	Carlisle, IA
MPS Engineers, P.C.	Des Moines, IA
J & K Contracting, LLC	Ames, IA
Raccoon Valley Contractors, LLC.	Waukee, IA
Keller Excavating, Inc.	Boone, IA
Pohlmeier Construction, Inc.	Bondurant, IA

which were received and opened at a public meeting presided over by the Engineer in the City Council Chambers, 2nd Floor, City Hall, 400 Robert D. Ray Drive, Des Moines, Iowa at 11:00 a.m. on March 12, 2013. Said bids and the attached tabulation of bids for said improvement be and are hereby received and filed.

BE IT FURTHER RESOLVED: That the Des Moines City Engineer, as the Engineer, has determined that the lowest responsive, responsible bid for the construction of said improvement was submitted by T K Concrete Inc., Tony J. Ver Meer, President, 1608 Fifield Road, Pella, IA, 50219 in the amount of \$54,143.50, and said bid be and the same is hereby accepted.

BE IT FURTHER RESOLVED: That the bid security of the unsuccessful bidders be and is hereby authorized and directed to be returned.

★ **Roll Call Number**

Agenda Item Number

52

DATE March 25, 2013

BE IT FURTHER RESOLVED: That the Engineer is hereby directed to secure execution by the lowest responsible, responsive Bidder and its surety of the contract documents in the form heretofore approved by this Council; that the Engineer is directed to thereafter present said contract documents to this Council for approval and authorization to the Mayor to sign; and that no contract shall be deemed to exist between the City of Des Moines and said Bidder until said contract has been executed by the Bidder, and shall have been approved by this Council and executed by the Mayor and attested to by the City Clerk.

BE IT FURTHER RESOLVED: That the City Council hereby authorizes the necessary road closures for the Project.

(City Council Communication Number 13141 attached.)

Moved by _____ to adopt.

FORM APPROVED:

FUNDS AVAILABLE

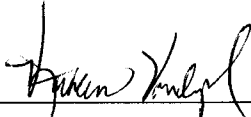

Kathleen Vanderpool
Deputy City Attorney



Scott E. Sanders
Des Moines Finance Director

Funding Source: 2013-2014 CIP, Page Sanitary - 6, City-wide Sanitary Sewers, SAE054, Being: \$29,125 from Special Assessments against benefited property owners and the remaining \$25,018.50 in Sanitary Sewer funds

DEB

COUNCIL ACTION	YEAS	NAYS	PASS	ABSENT
COWNIE				
COLEMAN				
GRIESS				
HENSLEY				
MAHAFFEY				
MEYER				
MOORE				
TOTAL				

MOTION CARRIED

APPROVED

Mayor

I, Diane Rauh, City Clerk of said City Council, hereby certify that at a meeting of the City Council, held on the above date, among other proceedings the above was adopted.

IN WITNESS WHEREOF, I have hereunto set my hand and affixed my seal the day and year first above written.

City Clerk

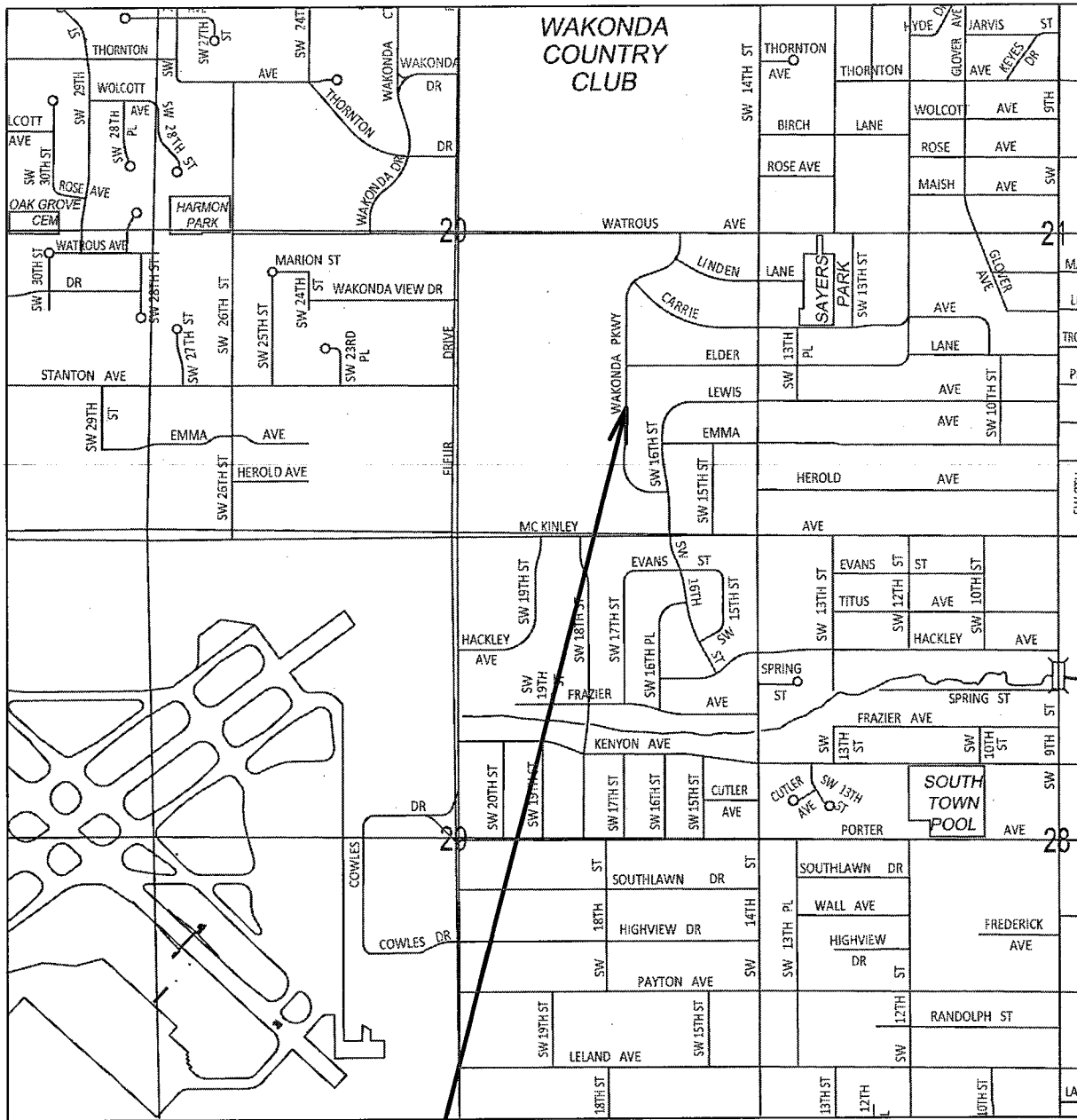

**PROJECT
LOCATION**

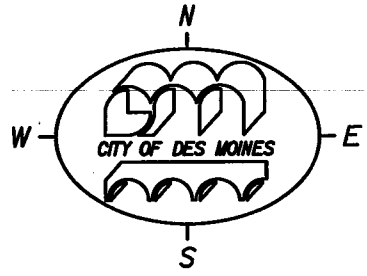

**4500 BLOCK OF WAKONDA
PARKWAY SANITARY SEWER
ACTIVITY I.D. 07-2012-012**

APPROVED BY: M. Becker
CHECKED BY: [Signature]

CONTRACTOR'S BID TABULATION
PROJECT: 4500 BLOCK OF WAKONDA PARKWAY SANITARY SEWER

ESTIMATE

ITEM	DESCRIPTION	QUANTITY	UNIT PRICE	AMOUNT	BID PRICE	UNIT PRICE	AMOUNT
1	SW-301 Sanitary Manhole	1 EACH	\$4,500.00	\$4,500.00			
2	Sanitary Sewer, 8"	135 LF	\$70.00	\$9,450.00			
3	Sanitary Sewer Service Stub	135 LF	\$65.00	\$8,775.00			
4	Connection to Existing Manhole	1 EACH	\$500.00	\$500.00			
5	Pavement Removal	500 SY	\$15.00	\$7,500.00			
6	Modified Subbase	83.3 CY	\$40.00	\$3,332.00			
7	Pavement PCC, 6"	500 SY	\$40.00	\$20,000.00			
8	Aggregate Surfacing	50 TON	\$20.00	\$1,000.00			
9	Sod	42 SQR	\$40.00	\$1,680.00			
10	Filter Sock	150 LF	\$2.50	\$375.00			
11	Tree Protection	1 LS	\$600.00	\$600.00			
12	Tree Protection Fence	150 LF	\$2.50	\$375.00			
13	Project Sign Small, Standard	1 EACH	\$150.00	\$150.00			
14	Traffic Control	1 LS	\$1,500.00	\$1,500.00			
15	Mobilization	1 LS	\$4,263.00	\$4,263.00			
				\$64,000.00			

TOTAL CONSTRUCTION COST
PERCENT OF ENGINEER'S ESTIMATE

\$54,143.50
-15.40%
Low

TK Concrete, Inc. Pella, Iowa	BID SECURITY 10% Bid Bond	BID PRICE
UNIT PRICE	AMOUNT	
\$3,300.00	\$3,300.00	
\$40.00	\$5,400.00	
\$25.00	\$3,375.00	
\$750.00	\$750.00	
\$10.00	\$5,000.00	
\$45.00	\$3,748.50	
\$36.00	\$18,000.00	
\$25.00	\$1,250.00	
\$85.00	\$3,570.00	
\$4.00	\$600.00	
\$500.00	\$500.00	
\$3.00	\$450.00	
\$250.00	\$250.00	
\$1,250.00	\$1,250.00	
\$6,700.00	\$6,700.00	
		\$54,143.50
		-15.40%
		Low

Sandstone Management Carlisle, Iowa	BID SECURITY 10% Bid Bond	BID PRICE
UNIT PRICE	AMOUNT	
\$3,400.00	\$3,400.00	
\$44.34	\$5,985.90	
\$46.37	\$6,259.95	
\$1,250.00	\$1,250.00	
\$9.55	\$4,775.00	
\$38.25	\$3,186.23	
\$49.50	\$24,750.00	
\$43.00	\$2,150.00	
\$49.50	\$2,079.00	
\$2.50	\$375.00	
\$700.00	\$700.00	
\$5.50	\$825.00	
\$125.00	\$125.00	
\$1,000.00	\$1,000.00	
\$2,785.92	\$2,785.92	
		\$59,647.00
		-6.80%

Vanderpool Construction Indianola, Iowa	BID SECURITY 10% Bid Bond	BID PRICE
UNIT PRICE	AMOUNT	
\$3,700.00	\$3,700.00	
\$65.00	\$8,775.00	
\$65.00	\$8,775.00	
\$2,200.00	\$2,200.00	
\$7.00	\$3,500.00	
\$72.00	\$5,997.60	
\$52.00	\$26,000.00	
\$22.50	\$1,125.00	
\$47.25	\$1,984.50	
\$2.50	\$375.00	
\$630.00	\$630.00	
\$5.25	\$787.50	
\$80.00	\$80.00	
\$955.00	\$955.00	
\$4,500.00	\$4,500.00	
		\$69,384.60
		+8.41%

52

TABULATED BY: M. Becker
CHECKED BY: *ML*

APPROVED BY: _____

CONTRACTOR'S BID TABULATION
PROJECT: 4500 BLOCK OF WAKONDA PARKWAY SANITARY SEWER

ESTIMATE

ITEM	DESCRIPTION	QUANTITY	AMOUNT		UNIT PRICE		BID PRICE	BID PRICE
			AMOUNT	PRICE	PRICE	AMOUNT		
1	SW-301 Sanitary Manhole	1 EACH	\$4,500.00	\$4,500.00	\$3,870.00	\$3,870.00	\$5,000.00	\$5,000.00
2	Sanitary Sewer, 8"	135 LF	\$9,450.00	\$70.00	\$13,230.00	\$98.00	\$82.00	\$11,070.00
3	Sanitary Sewer Service Stub	135 LF	\$8,775.00	\$65.00	\$6,480.00	\$48.00	\$49.00	\$6,615.00
4	Connection to Existing Manhole	1 EACH	\$500.00	\$500.00	\$9,700.00	\$9,700.00	\$875.00	\$875.00
5	Pavement Removal	500 SY	\$7,500.00	\$15.00	\$5,000.00	\$10.00	\$12.00	\$6,000.00
6	Modified Subbase	83.3 CY	\$3,332.00	\$40.00	\$3,332.00	\$40.00	\$42.00	\$3,498.60
7	Pavement PCC, 6"	500 SY	\$20,000.00	\$40.00	\$24,000.00	\$48.00	\$56.25	\$28,125.00
8	Aggregate Surfacing	50 TON	\$1,000.00	\$20.00	\$1,250.00	\$25.00	\$20.00	\$1,000.00
9	Sod	42 SQR	\$1,680.00	\$40.00	\$2,310.00	\$55.00	\$59.00	\$2,478.00
10	Filter Sock	150 LF	\$375.00	\$2.50	\$337.50	\$2.25	\$2.50	\$375.00
11	Tree Protection	1 LS	\$600.00	\$600.00	\$600.00	\$600.00	\$802.00	\$802.00
12	Tree Protection Fence	150 LF	\$375.00	\$2.50	\$750.00	\$5.00	\$2.50	\$375.00
13	Project Sign Small, Standard	1 EACH	\$150.00	\$150.00	\$75.00	\$75.00	\$165.00	\$165.00
14	Traffic Control	1 LS	\$1,500.00	\$1,500.00	\$909.00	\$909.00	\$1,045.00	\$1,045.00
15	Mobilization	1 LS	\$4,263.00	\$4,263.00	\$1,100.00	\$1,100.00	\$5,750.00	\$5,750.00
			\$64,000.00		\$72,943.50		\$73,173.60	\$73,173.60
					+13.97%		+14.33%	+20.91%

TOTAL CONSTRUCTION COST
PERCENT OF ENGINEER'S ESTIMATE

The Underground Company
Carlisle, Iowa

BID SECURITY
10% Bid Bond

MPS Engineers
Des Moines, Iowa

BID SECURITY
10% Bid Bond

J&K Contracting, LLC
Ames, Iowa

BID SECURITY
Bid Bond \$7744

52

TABULATED BY: M. Becker
CHECKED BY: *Duk*
APPROVED BY: _____

CONTRACTOR'S BID TABULATION
PROJECT: 4500 BLOCK OF WAKONDA PARKWAY SANITARY SEWER

-----ESTIMATE-----

ITEM	DESCRIPTION	QUANTITY	UNIT PRICE	AMOUNT	Raccoon Valley Contractors Waukee, Iowa	Keller Excavating Boone, Iowa	Pohlmeier Construction Bondurant, Iowa
					BID PRICE	BID PRICE	BID PRICE
1	SW-301 Sanitary Manhole	1 EACH	\$4,500.00	\$4,500.00			
2	Sanitary Sewer, 8"	135 LF	\$70.00	\$9,450.00			
3	Sanitary Sewer Service Stub	135 LF	\$65.00	\$8,775.00			
4	Connection to Existing Manhole	1 EACH	\$500.00	\$500.00			
5	Pavement Removal	500 SY	\$15.00	\$7,500.00			
6	Modified Subbase	83.3 CY	\$40.00	\$3,332.00			
7	Pavement PCC, 6"	500 SY	\$40.00	\$20,000.00			
8	Aggregate Surfacing	50 TON	\$20.00	\$1,000.00			
9	Sod	42 SQR	\$40.00	\$1,680.00			
10	Filter Sock	150 LF	\$2.50	\$375.00			
11	Tree Protection	1 LS	\$600.00	\$600.00			
12	Tree Protection Fence	150 LF	\$2.50	\$375.00			
13	Project Sign Small, Standard	1 EACH	\$150.00	\$150.00			
14	Traffic Control	1 LS	\$1,500.00	\$1,500.00			
15	Mobilization	1 LS	\$4,263.00	\$4,263.00			
				\$64,000.00	\$83,706.00	\$96,388.20	\$133,840.00
					+30.79%	+50.61%	+109.13%

TOTAL CONSTRUCTION COST
PERCENT OF ENGINEER'S ESTIMATE