



Roll Call Number

Agenda Item Number

41

Date October 21, 2024

An Ordinance entitled, "AN ORDINANCE to amend the Municipal Code of the City of Des Moines, Iowa, 2000, adopted by Ordinance No. 13,827, passed June 5, 2000, as heretofore amended, is hereby amended, by amending Sections 114-2669, 114-2699, 114-2823, 114-2993, 114-3017, 114-3152, 114-3361, 114-3387, and 114-3564, and adding Sections 114-2358.7, relating to traffic and vehicle regulations",

which was considered and voted upon for the first time under Roll Call No. 24-_____ of September 16, 2024, and considered and voted upon for the second time under Roll Call No. 24-_____ of October 7, 2024, again presented.

Moved by _____ that this ordinance do now pass. Seconded by _____.

ORDINANCE NO. _____

COUNCIL ACTION	YEAS	NAYS	PASS	ABSENT
BOESEN				
SIMONSON				
VOSS				
COLEMAN				
WESTERGAARD				
MANDELBAUM				
GATTO				
TOTAL				
MOTION CARRIED	APPROVED			

CERTIFICATE

I, LAURA BAUMGARTNER, City Clerk of said City hereby certify that at a meeting of the City Council of said City of Des Moines, held on the above date, among other proceedings the above was adopted.

IN WITNESS WHEREOF, I have hereunto set my hand and affixed my seal the day and year first above written.

_____ Mayor

_____ City Clerk

COUNCIL COMMUNICATION			
	Number:	24-391	Meeting: <u>October 7, 2024</u>
	Agenda Item:	41	Roll Call: [<u>24-1370</u>]
	Submitted by:	Steven L. Naber, P.E., City Engineer	

AGENDA HEADING:

Amending Chapter 114 of the Municipal Code regarding Traffic Regulation Changes as follows:

- A. Parking Modification – SW 9th Street between Rose Avenue and Watrous Avenue
- B. Parking Modification – 24th Street between Cottage Grove Avenue and Drake Park Avenue
- C. Traffic Control Modification – E Vine Street at intersections with E 15th/SE 15th Street, Astor/SE Astor Street, and E 16th/SE 16th Street
- D. Code Correction – 7th Street between Clark Street and College Avenue
- E. Code Correction – E Lacona Avenue at SE 8th Street
- F. Corner Clearance Parking Restrictions –
 - 1. Arthur Avenue and E 42nd Street
 - 2. Bennett Avenue and 30th Street
 - 3. E Diehl Avenue and Jordan Drive
 - 4. E Payton Avenue and SE 3rd Street

SYNOPSIS:

Recommend approval of the staff recommendation and the ordinance regarding the traffic regulation changes.

FISCAL IMPACT:

Amount: Costs for sign installations and periodic maintenance of signs.

Funding Source: Fiscal Year (FY) 2024-2025 Operating Budget, Page 72, Engineering Department T&T – Sign, Painting, Signal and Lighting, EG062080, Road Use Tax Fund

ADDITIONAL INFORMATION:

- A. Currently parking is allowed on the west side of SW 9th Street from Rose Avenue to Watrous Avenue between the hours of 1:00 a.m. and 1:00 p.m. on Sundays. SW 9th Street is an arterial street which serves as a truck route, bus route, emergency response route and a snow route. Per the City’s Parking Restriction Policy, parking should be restricted at all times on SW 9th Street based on the roadway width if the average daily traffic volume (ADT) exceeds 18,000 vehicles per day (vpd). Based on the traffic volumes collected in 2023 on SW 9th Street, the ADT on SW 9th Street

in this area is 20,000 vpd. In addition, the City observed on-street parking on SW 9th Street on Sunday to see if it was being utilized. No vehicles were parked on SW 9th Street during the time when parking is allowed on Sunday. A letter notifying the adjacent property owners of the proposed parking change and the Council meeting date was sent in advance of the Council meeting. The proposed code modifications will restrict parking on the west side of SW 9th Street between Rose Avenue and Watrous Avenue at all times. The following modifications to the Municipal Code will place this change into effect.

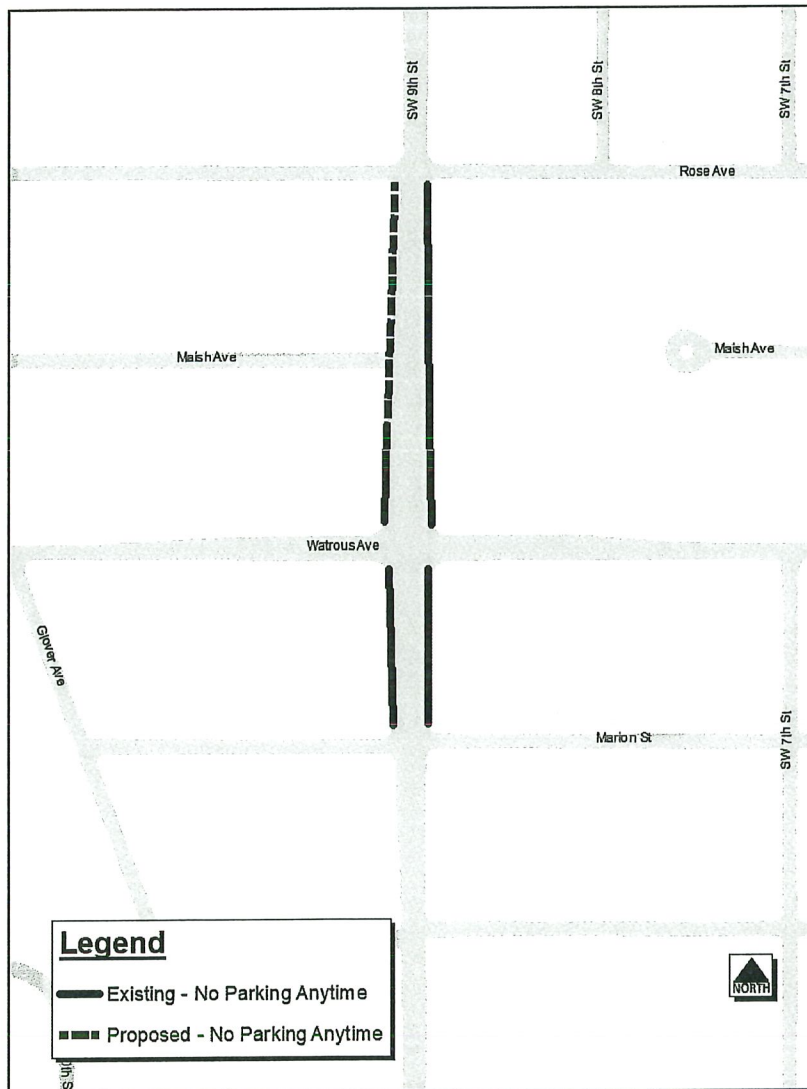

Sec. 114-2699. Southwest Ninth Street--Park Avenue to County Line Road.

Southwest Ninth Street, on the west side, from Park Avenue to Rose Avenue Luster Lane, no parking any time.

Southwest Ninth Street, on the west side, from Rose Avenue to a point 100 feet north of Watrous Avenue, no parking 1:00 p.m. Sunday through 1:00 a.m. the following Sunday.

Southwest Ninth Street, on the west side, from a point 100 feet north of Watrous Avenue to Luster Lane, no parking any time.

B. Staff received a request from the Drake Neighborhood Association on behalf of the Cottage Grove Church requesting to allow parking on the east side of 24th Street between Cottage Grove Avenue and Drake Park Avenue. Based on the width of 24th Street, parking may be permitted on both sides of 24th Street per the City's Parking Restriction Policy. The proposed code modifications will allow parking on both sides of 24th Street between Cottage Grove Avenue and Drake Park Avenue. Parking restriction at the intersections to maintain sight distance and maneuverability (corner clearances) will be maintained. The following modifications to the Municipal Code will place this change into effect.

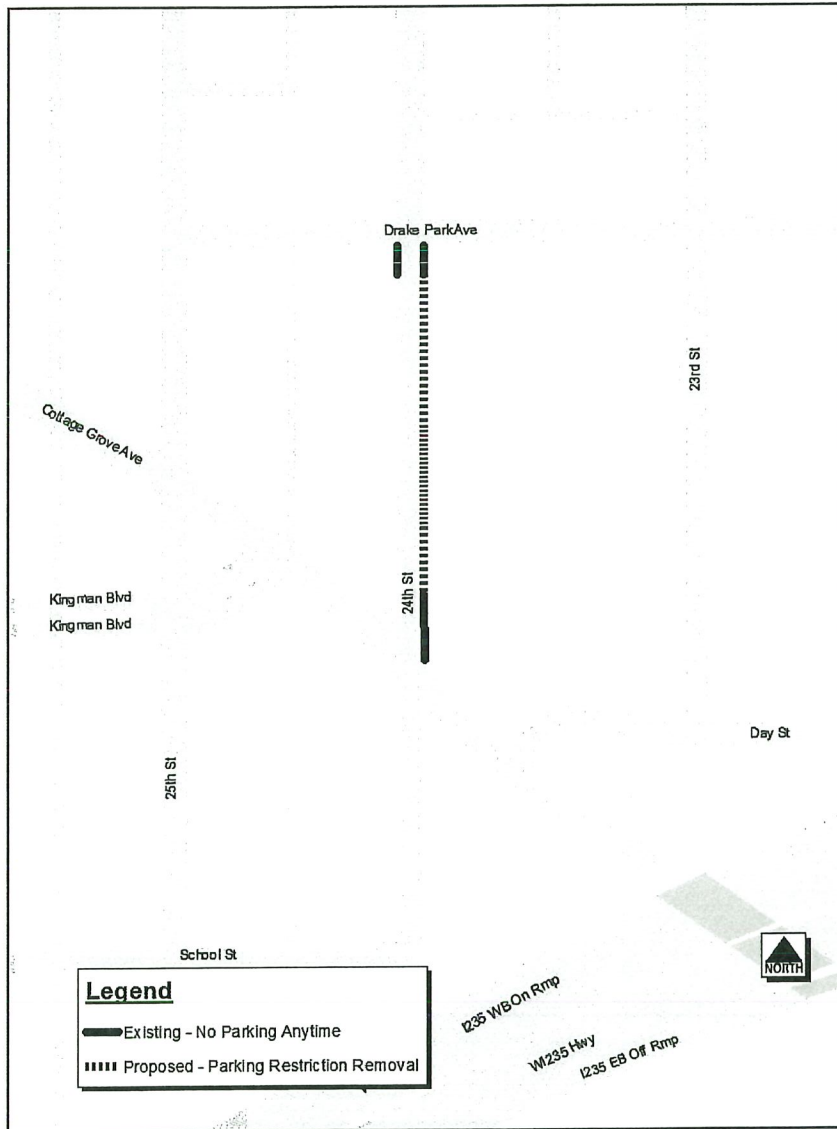

Sec. 114-2823. Twenty-fourth Street--Ingersoll Avenue to Bennett Avenue.

Twenty-fourth Street, on the east side, from School Street to a point 50 60 feet north of Drake Park Avenue Cottage Grove Avenue, no parking any time.

Twenty-fourth Street, on the west side, from a point 50 feet south of Drake Park Avenue to a point 50 feet north of Drake Park Avenue, no parking any time.

Twenty-fourth Street, on both sides, from a point 75 feet south of Drake Park Avenue to a point 60 feet north of Drake Park Avenue, no parking any time.

- C. During a field review of E Vine Street between E 14th Street and E 16th Court it was found that three (3) of the intersections are currently uncontrolled. Based on the City's current practices for determining intersection traffic control, the intersections of E Vine Street and E/SE 15th Street, E Vine Street and Astor/SE Astor Street, and E Vine Street and E/SE 16th Street should be two (2)-way stop controlled. Staff recommends installing stop signs on E/SE 15th Street, Astor/SE Astor Street, and E/SE 16th Street where they intersect with E Vine Street. The following revisions to the Municipal Code will place these changes into effect.

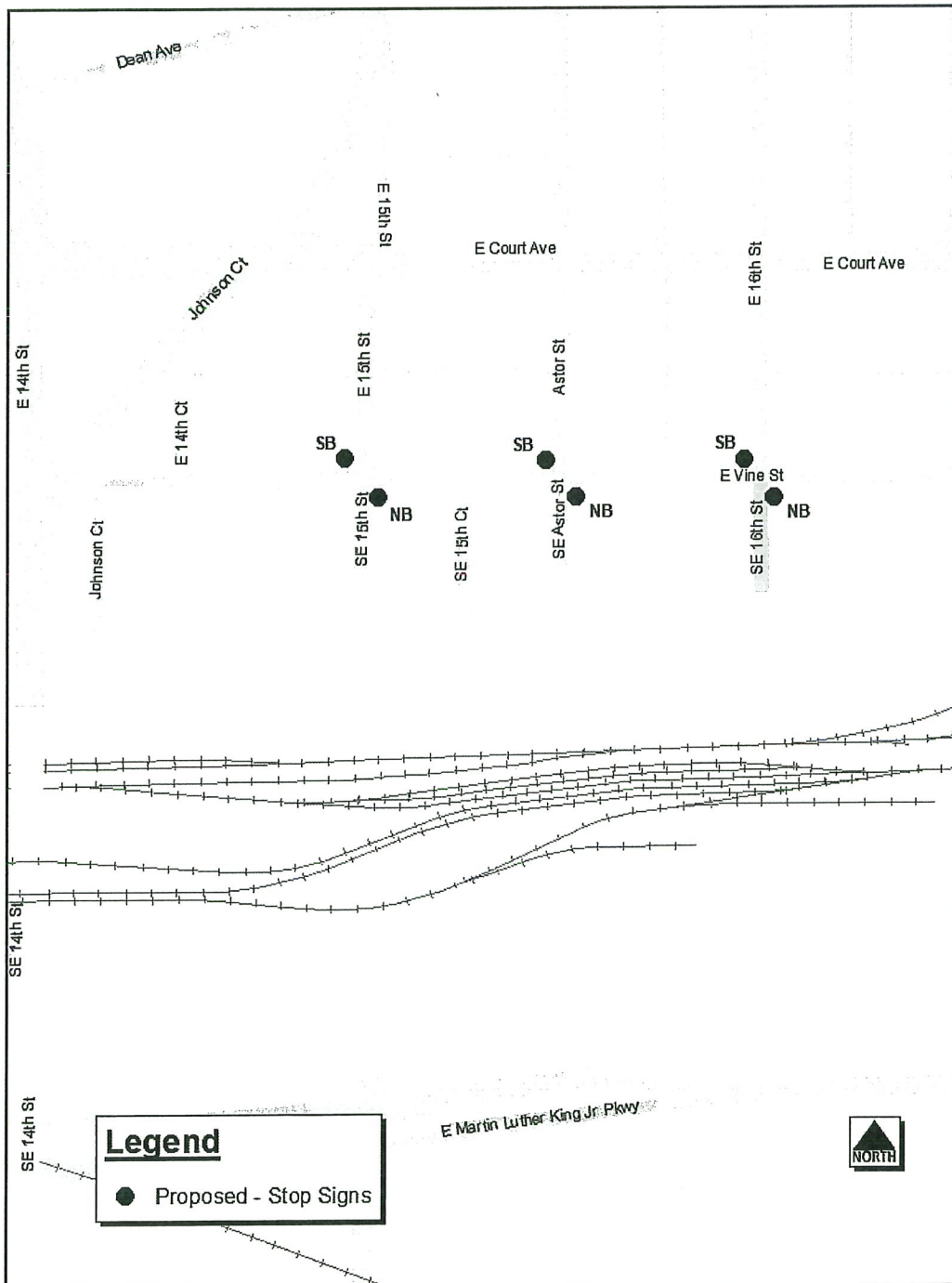

Sec. 114-2358.7. East Vine Street.

East Vine Street, at East Fifteenth Street/Southeast Fifteenth Street, stop.

East Vine Street, at Astor Street/Southeast Astor Street, stop.

East Vine Street, at East Sixteenth Street/Southeast Sixteenth Street, stop.

D. During a field review, staff found that the Municipal Code does not match field conditions for the loading zone on the east side of 7th Street south of College Avenue. The proposed code modifications will correct the parking restriction and loading zone on the east side of 7th Street south of College Avenue in the Municipal Code. The following modifications to the Municipal Code will place this change into effect.

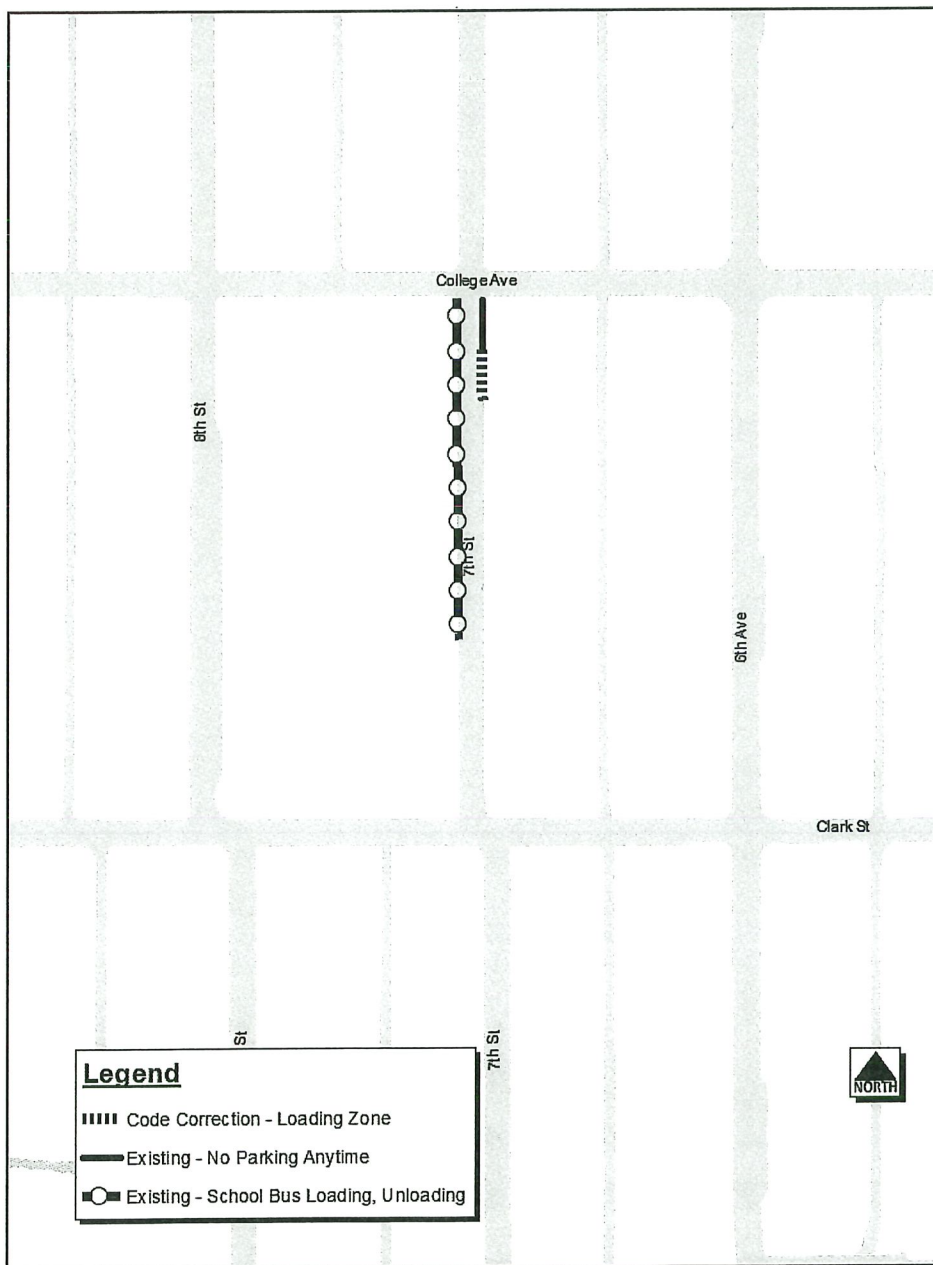

Sec. 114-2669. Seventh Street--Indiana Avenue to Shawnee Avenue.

~~Seventh Street, on the east side, from a point 90 feet south of College Avenue to a point 25 feet south thereof, commercial loading zone.~~

Seventh Street, on the east side, from a point 120 feet south of College Avenue to a point 50 feet north thereof, loading zone.

- E. Parking is restricted on the south side of E Lacona Avenue from 60 feet west of SE 8th Street to 50 feet east of SE 8th Street. During a review of the Municipal Code in this area, it was found that the Municipal Code incorrectly states this parking restriction is on the north side of E Lacona Avenue. The proposed code modifications will correct the parking restriction on E Lacona Avenue and SE 8th Street in the Municipal Code. The following modifications to the Municipal Code will place this change into effect.

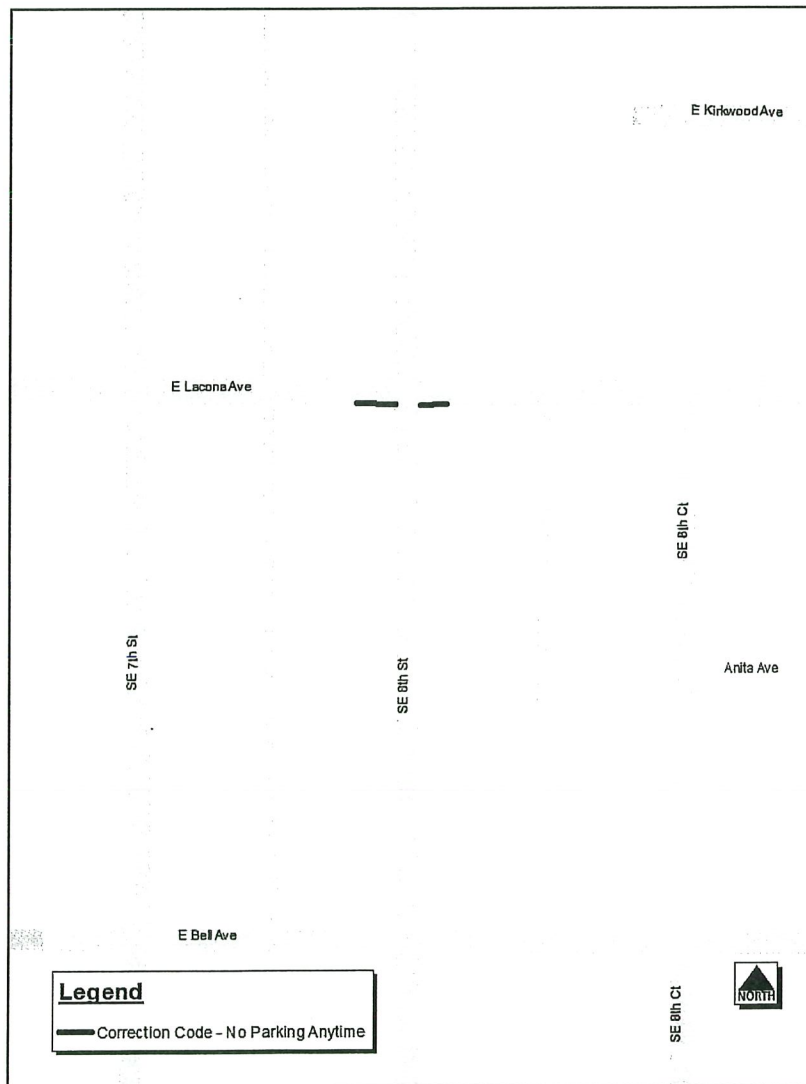

Sec. 114-3387. East Lacona Avenue--Southeast Sixth Street to dead end east of Southeast Nineteenth Street.

East Lacona Avenue, on the ~~north~~ south side, from a point 60 feet west of Southeast Eighth Street to a point 50 feet east of Southeast Eighth Street, no parking any time.

F. A corner clearance is a parking restriction that extends 150 feet or less from an intersection. Corner clearances are typically installed to provide required sight distance at the intersection or facilitate turning movements onto narrow, residential streets where a parked vehicle might prevent two (2)-way traffic. A request for a corner clearance is typically generated from resident concerns. Staff has reviewed the following locations and determined corner clearances are necessary.

1. Arthur Avenue and E 42nd Street
2. Bennett Avenue and 30th Street
3. E Diehl Avenue and Jordan Drive
4. E Payton Avenue and SE 3rd Street

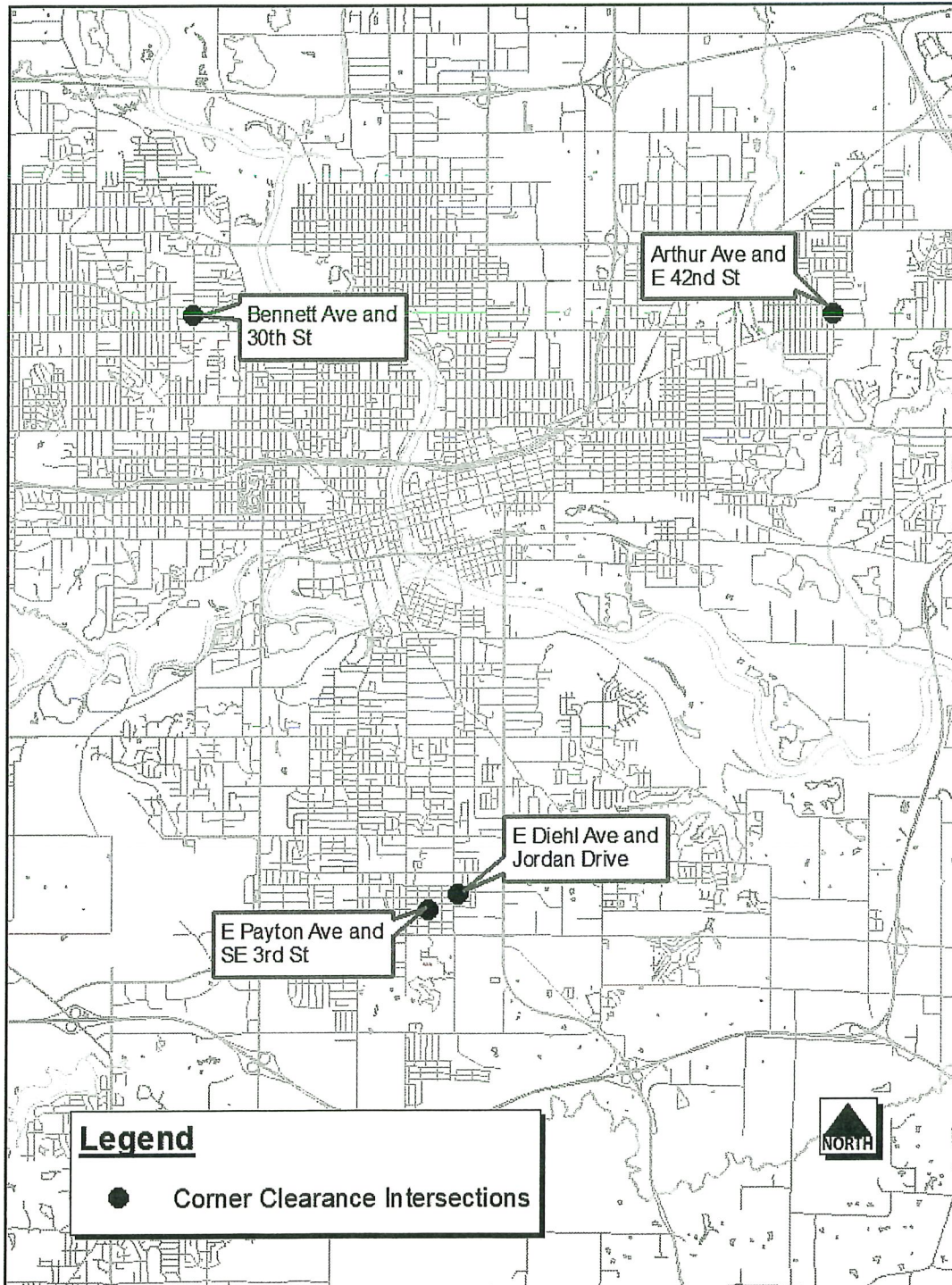

Sec. 114-2993. Arthur Avenue--First Street to east city limits.

Arthur Avenue, on the south side, from East Forty-second Street to a point 50 feet east thereof, no parking any time.

Sec. 114-3017. Bennett Avenue--Martin Luther King Jr Parkway to Thirtieth Street.

Bennett Avenue, on the south side, from a point 50 feet east of Thirtieth Street to Thirtieth Street, no parking any time.

Sec. 114-3152. East Diehl Avenue--South Union Street to Southeast Thirty-second.

East Diehl Avenue, on the north side, from Jordan Drive to a point 50 feet east thereof, no parking any time.

Sec. 114-3361. Jordan Drive--Southeast Fifth Street to Hart Avenue.

Jordan Drive, on the east side, from a point 90 feet north of East Diehl Avenue to a point 80 feet south of East Diehl Avenue, no parking any time.

Sec. 114-3564. East Payton Avenue--South Union Street to East City Limits.

East Payton Avenue, on the north side, from a point 50 feet west of Southeast Third Street to a point 50 feet east of Southeast Third Street, no parking any time.

PREVIOUS COUNCIL ACTION(S): NONE

BOARD/COMMISSION ACTION(S): NONE

ANTICIPATED ACTIONS AND FUTURE COMMITMENTS: NONE

For more information on this and other agenda items, please call the City Clerk's Office at 515-283-4209 or visit the Clerk's Office on the first floor of City Hall, 400 Robert D Ray Drive. Council agendas are available to the public at the City Clerk's Office on Thursday afternoon preceding Monday's Council meeting. Citizens can also request to receive meeting notices and agendas by email by calling the Clerk's Office or sending their request via email to cityclerk@dmgov.org.

ORDINANCE NO. _____

AN ORDINANCE to amend the Municipal Code of the City of Des Moines, Iowa, 2000, adopted by Ordinance No. 13,827, passed June 5, 2000, as heretofore amended, by amending Sections 114-2669, 114-2699, 114-2823, 114-2993, 114-3017, 114-3152, 114-3361, 114-3387, and 114-3564, and adding Section 114-2358.7, relating to traffic and vehicle regulations.

Be It Ordained by the City Council of the City of Des Moines, Iowa:

Section 1. That the Municipal Code of the City of Des Moines, Iowa, 2000, adopted by Ordinance No. 13,827, passed June 5, 2000, as heretofore amended, by amending Sections 114-2669, 114-2699, 114-2823, 114-2993, 114-3017, 114-3152, 114-3361, 114-3387, and 114-3564, and adding Section 114-2358.7, relating to traffic and vehicle regulations, as follows:

Sec. 114-2358.7. East Vine Street.

East Vine Street, at East Fifteenth Street/Southeast Fifteenth Street, stop.

East Vine Street, at Astor Street/Southeast Astor Street, stop.

East Vine Street, at East Sixteenth Street/Southeast Sixteenth Street, stop.

Sec. 114-2669. Seventh Street--Indiana Avenue to Shawnee Avenue.

Seventh Street, on the east side, from Indiana Avenue to Forest Avenue, no parking any time.

Seventh Street, on the west side, from Forest Avenue to a point 40 feet south thereof, no parking any time.

Seventh Street, on the west side, from a point 210 feet north of Clark Street to College Avenue, school bus loading and unloading.

Seventh Street, on the east side, from a point ~~90~~120 feet south of College Avenue to a point ~~25~~50 feet ~~south~~north thereof, ~~commercial~~ loading zone.

Seventh Street, on the east side, from a point 50 feet south of Franklin Avenue to Hickman Road, no parking any time.

Seventh Street, on the west side, from a point 50 feet south of Franklin Avenue to a point 50 feet north of Franklin Avenue, no parking any time.

Seventh Street, on the west side, from New York Avenue to Corning Avenue, no parking any time.

Seventh Street, on the east side, from Corning Avenue to a point 210 feet south thereof, no parking any time.

Seventh Street, on the east side, from Boston Avenue to Ovid Avenue, no parking any time.

Seventh Street, on the east side, from Douglas Avenue to a point 375 feet south of Madison Avenue, no parking any time.

Seventh Street, on the west side, from Madison Avenue to a point 50 feet south of Madison Avenue, no parking any time.

Seventh Street, on the east side, from Madison Avenue to a point 375 feet south thereof, school passenger loading and unloading.

Seventh Street, on the east side, from Madison Avenue to Shawnee Avenue, no parking any time.

Sec. 114-2699. Southwest Ninth Street--Park Avenue to County Line Road.

Southwest Ninth Street, on the east side, from Park Avenue to County Line Road, no parking any time.

Southwest Ninth Street, on the west side, from Park Avenue to ~~Rose Avenue~~ Luster Lane, no parking any time.

~~Southwest Ninth Street, on the west side, from Rose Avenue to a point 100 feet north of Watrous Avenue, no parking 1:00 p.m. Sunday through 1:00 a.m. the following Sunday.~~

~~Southwest Ninth Street, on the west side, from a point 100 feet north of Watrous Avenue to Luster Lane, no parking any time.~~

Southwest Ninth Street, on the west side, from County Line Road to a point 300 feet north thereof, no parking any time.

Sec. 114-2823. Twenty-fourth Street--Ingersoll Avenue to Bennett Avenue.

Twenty-fourth Street, on the west side, from Ingersoll Avenue to a point 95 feet north of Woodland Avenue, no parking any time.

Twenty-fourth Street, on the east side, from High Street to and including the dead end north of Olive Avenue, no parking any time.

Twenty-fourth Street, on the west side, from a point 50 feet south of Pleasant Street to a point 50 feet north of Pleasant Street, no parking any time.

Twenty-fourth Street, on the west side, from a point 50 feet south of Center Street to a point 50 feet north of Center Street, no parking any time.

Twenty-fourth Street, on the west side, from a point 50 feet south of Rollins Avenue to a point 50 feet north of Rollins Avenue, no parking any time.

Twenty-fourth Street, on the west side, from Olive Avenue to and including the dead end north thereof, no parking any time.

Twenty-fourth Street, on the east side, from School Street to a point ~~50~~ 60 feet north of ~~Drake Park~~ Cottage Grove Avenue, no parking any time.

~~Twenty-fourth Street, on the west side, from a point 50 feet south of Drake Park Avenue to a point 50 feet north of Drake Park Avenue, no parking any time.~~

Twenty-fourth Street, on both sides, from a point 75 feet south of Drake Park Avenue to a point 60 feet north of Drake Park Avenue, no parking any time.

Twenty-fourth Street, on the east side, from a point 295 feet south of University Avenue to a point 25 feet north thereof, is designated a handicapped parking space and is subject to the same prohibition as is found in section 114-616(a) of this Code.

Twenty-fourth Street, on the east side, from a point 270 feet south of University Avenue to a point 110 feet north thereof, two-hour parking, 9:00 a.m. to 4:00 p.m.

Twenty-fourth Street, on the west side, from a point 260 feet south of University Avenue to University Avenue, two-hour parking, 9:00 a.m. to 4:00 p.m.

Twenty-fourth Street, on the east side, from a point 50 feet south of University Avenue to a point 50 feet north of University Avenue, no parking any time.

Twenty-fourth Street, on the west side, from University Avenue to a point 205 feet south of Carpenter Avenue, no parking any time.

Twenty-fourth Street, on the east side, from a point 250 feet north of University Avenue to a point 50 feet north thereof, loading zone.

Twenty-fourth Street, on the east side, from a point 300 feet north of University Avenue to a point 50 feet north of Carpenter Avenue, no parking any time.

Twenty-fourth Street, on the west side, from a point 205 feet south of Carpenter Avenue to a point 180 feet north thereof, two-hour parking, 9:00 a.m. to 4:00 p.m.

Twenty-fourth Street, on the west side, from a point 25 feet south of Carpenter Avenue to a point 65 feet north of Carpenter Avenue, no parking any time.

Twenty-fourth Street, on the west side, from Forest Avenue to a point 50 feet north thereof, no parking any time.

Twenty-fourth Street, on the west side from a point 60 feet south of Clark Street to Twenty-fourth Drive, no parking any time.

Twenty-fourth Street, on the east side, from Forest Avenue to a point 53 feet north of Clark Street, no parking any time.

Twenty-fourth Street, on the east side, from a point 50 feet south of College Avenue to College Avenue, no parking any time.

Twenty-fourth Street, on the east side, from a point 50 feet south of Twenty-fourth Drive to and including the dead end north of Franklin Avenue, no parking any time.

Twenty-fourth Street, on the east side, from Hickman Road to Bennett Avenue, no parking any time.

Twenty-fourth Street, on the west side, from Hickman Road to a point 75 feet north thereof, no parking any time.

Twenty-fourth Street, on the west side, from a point 100 feet south of Holcomb Avenue to a point 100 feet north of Holcomb Avenue, no parking any time.

Twenty-fourth Street, on the west side, from a point 50 feet south of Bennett Avenue to Bennett Avenue, no parking any time.

Sec. 114-2993. Arthur Avenue--First Street to east city limits.

Arthur Avenue, on the north side, from First Street to a point 75 feet east of East Fourteenth Street, no parking any time.

Arthur Avenue, on the south side, from a point 50 feet west of Amherst Street to a point 130 feet east of Amherst Street, no parking any time.

Arthur Avenue, on the south side, from East Ninth Street to a point 50 feet west thereof, no parking any time.

Arthur Avenue, on the south side, from a point 50 feet west of East Eleventh Street to a point 50 feet east of East Eleventh Street, no parking any time.

Arthur Avenue, on the south side, from East Fourteenth Street to a point 75 feet west thereof, no parking any time.

Arthur Avenue, on the south side, from East Fourteenth Street to Glenbrook Drive, no parking any time.

Arthur Avenue, on the north side, from Glenbrook Drive to a point 50 feet west thereof, no parking any time.

Arthur Avenue, on the south side, from East Twenty-third Street to East Twenty-fourth Street, no parking any time.

Arthur Avenue, on the north side, from Lay Street to Farwell Road, no parking any time.

Arthur Avenue, on the south side, from East Twenty-fifth Street to a point 50 feet east thereof, no parking any time.

Arthur Avenue, on the south side, from a point 50 feet west of Richland Avenue to a point 60 feet east of Richland Avenue, no parking any time.

Arthur Avenue, on the north side, from a point 130 feet west of Farwell Road and any part of the cul-de-sac to Reynolds Lane, no parking any time.

Arthur Avenue, on the south side, from Avenue Frederick M. Hubbell to East Twenty-ninth Street, no parking any time.

Arthur Avenue, on the north side, from East Thirty-fourth Street to East Thirty-fifth Street, no parking any time.

Arthur Avenue, on the south side, from East Thirty-fourth Street to a point 50 feet east thereof, no parking any time.

Arthur Avenue, on the south side, from East Thirty-sixth Street to East Thirty-seventh Street, no parking any time.

Arthur Avenue, on the north side, from East Forty-second Street to east city limits, no parking any time.

Arthur Avenue, on the south side, from East Forty-second Street to a point 50 feet east thereof, no parking any time.

Sec. 114-3017. Bennett Avenue--Martin Luther King Jr Parkway to Thirtieth Street.

Bennett Avenue, on the south side, from Martin Luther King Jr Parkway to Twenty-fourth Street, no parking any time.

Bennett Avenue, on the south side, from Twenty-fourth Street to a point 50 feet west thereof, no parking any time.

Bennett Avenue, on the north side, from Twenty-fourth Street to a point 320 feet west thereof, no parking any time.

Bennett Avenue, on the north side, from Twenty-seventh Place to Thirtieth Street, no parking any time.

Bennett Avenue, on the south side, from a point 50 feet east of Thirtieth Street to Thirtieth Street, no parking any time.

Sec. 114-3033.0003. East Broadway Avenue/Hubbell Avenue North Frontage Road—East Broadway Avenue to Hubbell Avenue.

East Broadway Avenue/Hubbell Avenue North Frontage Road, on the north side, from East Broadway Avenue to a point 160 feet east thereof, no parking any time.

East Broadway Avenue/Hubbell Avenue North Frontage Road, on the north side, from a point 470 feet east of East Broadway Avenue to a point 480 feet east thereof, no parking any time.

East Broadway Avenue/Hubbell Avenue North Frontage Road, on the north side, from a point 190 feet west of Hubbell Avenue to Hubbell Avenue, no parking any time.

Sec. 114-3152. East Diehl Avenue--South Union Street to Southeast Thirty-second.

East Diehl Avenue, on the south side, from Southeast Fifth Street to a point 70 feet west thereof, no parking any time.

East Diehl Avenue, on the south side, from South Union Street to a point 60 feet east thereof, no parking any time.

East Diehl Avenue, on the north side, from South Union Street to Southeast Fifth Street, no parking any time.

East Diehl Avenue, on the north side, from Jordan Drive to a point 50 feet east thereof, no parking any time.

East Diehl Avenue, on the north side, from a point 630 feet west of Southeast Fourteenth Street to a point 50 feet east of Southeast Fourteenth Street, no parking any time.

East Diehl Avenue, on the south side, from Jordan Drive to Southeast Nineteenth Street, no parking any time.

East Diehl Avenue, on the south side, from East Porter Avenue to Southeast Thirty-second Street, no parking any time.

Sec. 114-3361. Jordan Drive--Southeast Fifth Street to Hart Avenue.

Jordan Drive, on the west side, from Southeast Fifth Street to Hart Avenue, no parking any time.

Jordan Drive, on the east side, from a point 90 feet north of East Diehl Avenue to a point 80 feet south of East Diehl Avenue, no parking any time.

Sec. 114-3387. East Lacona Avenue--Southeast Sixth Street to dead end east of Southeast Nineteenth Street.

East Lacona Avenue, on the north side, from Southeast Sixth Street to a point 85 feet east thereof, no parking any time.

East Lacona Avenue, on the south side, from Southeast Sixth Street to a point 45 feet east thereof, no parking any time.

East Lacona Avenue, on the south side, from a point 60 feet west of Southeast Seventh Street to a point 50 feet east of Southeast Seventh Street, no parking any time.

East Lacona Avenue, on the north side, from a point 50 feet west of Southeast Seventh Street to a point 60 feet east of Southeast Eighth Street, no parking any time.

East Lacona Avenue, on the ~~north-south~~ side, from a point 60 feet west of Southeast Eighth Street to a point 50 feet east of Southeast Eighth Street, no parking any time.

East Lacona Avenue, on the south side, from a point 60 feet west of Southeast Eighth Court to a point 50 feet east of Southeast Eighth Court, no parking any time.

East Lacona Avenue, on the north side, from a point 50 feet west of Southeast Tenth Street to a point 60 feet east of Southeast Tenth Street, no parking any time.

East Lacona Avenue, on the south side, from a point 335 feet west of Southeast Fourteenth Street to a point 165 feet east thereof, no parking any time.

East Lacona Avenue, on the north side, from a point 120 feet west of Southeast Fourteenth Street to a point 630 feet east of Southeast Seventeenth Street, no parking any time.

East Lacona Avenue, on the south side, from a point 75 feet west of Southeast Fourteenth Street to a point 365 feet east of Southeast Fourteenth Street, no parking any time.

East Lacona Avenue, on the south side, from Southeast Eighteenth Street east to and including the cul-de-sac, no parking any time.

Sec. 114-3564. East Payton Avenue--South Union Street to East City Limits.

East Payton Avenue, on the north side, from South Union Street to a point 50 feet east thereof, no parking any time.

East Payton Avenue, on the south side, from South Union Street to Southeast Fifth Street, no parking any time.

East Payton Avenue, on the north side, from a point 50 feet west of Southeast Third Street to a point 50 feet east of Southeast Third Street, no parking any time.

Section 2. This ordinance shall be in full force and effect from and after its passage and publication as provided by law.

FORM APPROVED:

Reagan Peterson
Assistant City Attorney