



**Roll Call Number**

**Agenda Item Number**

13c

**Date** August 4, 2025

**ACCEPTING COMPLETED CONSTRUCTION AND APPROVING FINAL PAYMENT FOR  
DES MOINES LEVEE ALTERATIONS - PHASE B, PETERSON CONTRACTORS, INC.**

BE IT RESOLVED BY THE CITY COUNCIL OF THE CITY OF DES MOINES, IOWA: That the attached report of the Des Moines City Engineer, showing the cost of the construction of the Des Moines Levee Alterations - Phase B, Activity ID 082020004, in accordance with the contract approved between Peterson Contractors, Inc., Cordell Peterson, President, 104 Blackhawk Street, PO Box A, Reinbeck, IA, 50669, under Roll Call No. 22-0587 of April 18, 2022, and the City of Des Moines, and recommending the acceptance thereof, be and the same is hereby approved, and the construction of said project is hereby accepted.

BE IT FURTHER RESOLVED: That \$13,273,645.56 is the total cost, of which \$12,875,436.19 has been paid to the Contractor, and \$0.00 is now due and is hereby approved as final partial payment for the above project, the remaining balance of \$398,209.37 is to be paid at the end of thirty days, with funds retained for unresolved claims on file in accordance with Iowa Code Chapter 573.

BE IT FURTHER RESOLVED: That the City Manager be and is hereby authorized and directed to certify the Pollution Prevention Plan Inspection Summary and the NPDES Stormwater General Permit Notice of Discontinuation for the above referenced project on behalf of the City of Des Moines and submit said documents to the Iowa Department of Natural Resources.

BE IT FURTHER RESOLVED: That the Director of Finance be and is hereby authorized to release said retainage if suit is not filed as above provided.

Moved by \_\_\_\_\_ to adopt. Second by \_\_\_\_\_

FORM APPROVED:

FUNDS AVAILABLE:

/s/ Glenna K. Frank

Nickolas J. Schaul

Glenna K. Frank  
Deputy City Attorney

Nickolas J. Schaul  
Director of Finance

Funding Source: 2025-26 CIP, Page 102, Flood Mitigation Improvements, SM087, Being: Storm Water Utility Funds and Flood Mitigation Sales Tax

SLN

COUNCIL ACTION	YEAS	NAYS	PASS	ABSENT
BOESEN				
COLEMAN				
GATTO				
MANDELBAUM				
SIMONSON				
VOSS				
WESTERGAARD				
TOTAL				
MOTION CARRIED	APPROVED			

\_\_\_\_\_  
Mayor

**CERTIFICATE**

I, Laura Baumgartner, City Clerk of said City hereby certify that at a meeting of the City Council of said City of Des Moines, held on the above date, among other proceedings the above was adopted.

IN WITNESS WHEREOF, I have hereunto set my hand and affixed my seal the day and year first above written.

\_\_\_\_\_  
City Clerk

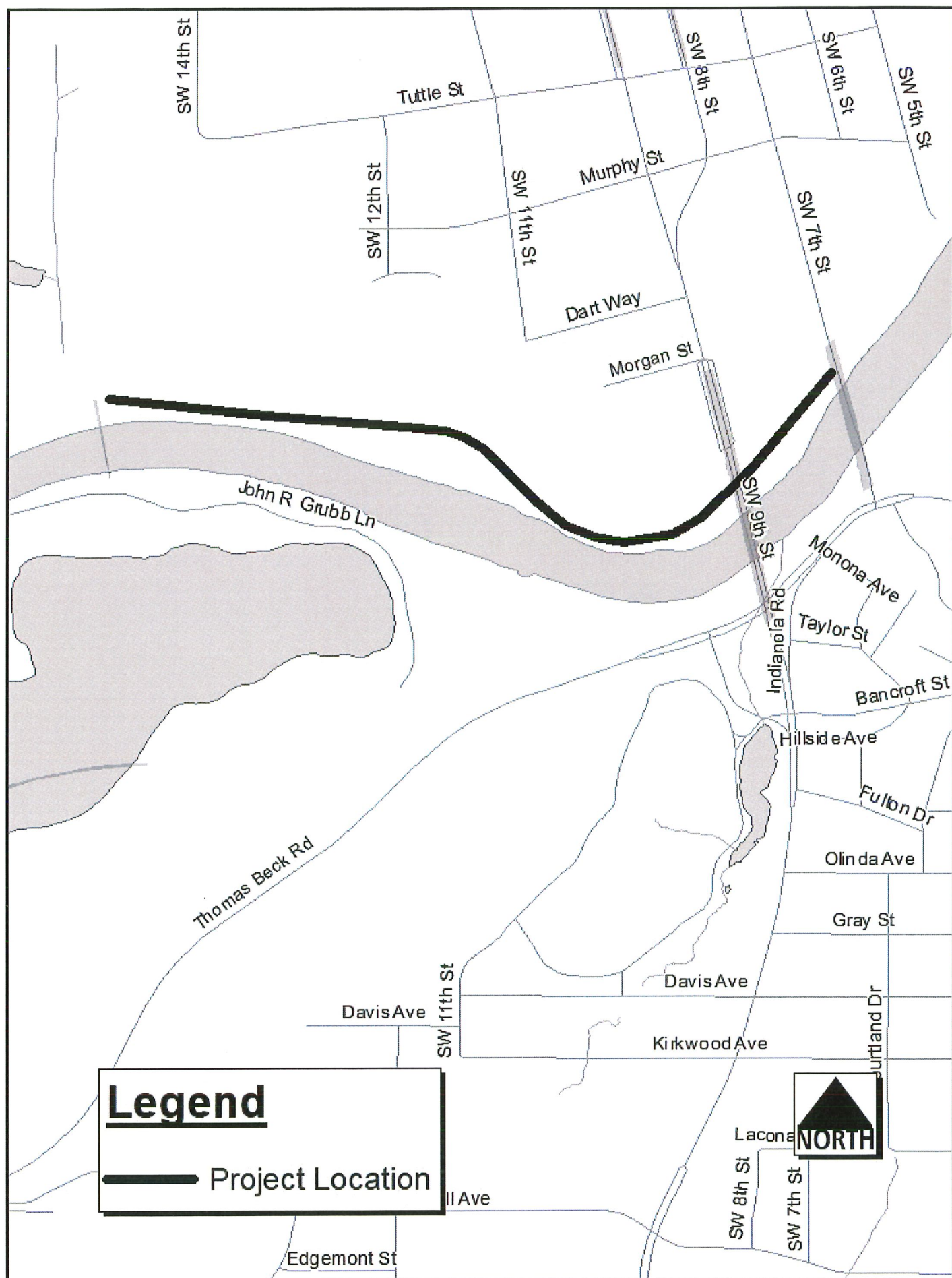



## PROJECT SUMMARY

### Des Moines Levee Alterations - Phase B

#### Activity ID 082020004

On April 18, 2022, under Roll Call No. 22-0587, the Council awarded the contract for the above improvements to Peterson Contractors, Inc., in the amount of \$12,686,390.85. Tabulated below is a history of project change orders.

Change Order No.	Initiated By	Description	Amount
1	Engineering	6/3/2022 Addition of abandon railroad track removal on former Norfolk Southern Railroad property south of DICO.	\$45,950.00
2	Engineering	9/13/2022 Addition of remove and reset fencing at DART for storm sewer installation and relocation of lighting control cabinet for floodwall construction.	\$23,948.31
3	Engineering	2/6/2023 Addition of retaining wall reinstallation, CMP storm sewer reinstallation, borrow site test pits to determine material suitability, unsuitable soils encountered, HMA mill and fill, new levee access gate, parking lot lighting repairs, and as-built quantity adjustments.	\$503,039.80
4	Consultant	10/4/2023 Addition of Gatewell 143 modifications.	\$84,240.77
5	Contractor	10/26/2023 Addition of parking lot roadstone, rip-rap fill stone, reinstall Des Moines Waterworks signs, water valve box extension, major manhole adjustments, object marker signs, extra railroad shoring design, and as-built quantity adjustments.	\$56,352.71
6	Engineering	3/5/2024 Addition of safety rail removal, construction survey, fencing, modifications to gatewell pipe, and installation of granular surfacing to protect the top of the levee.	\$77,618.40
7	Engineering	12/4/2024 Addition of construction survey for railroad track monitoring, under bridge erosion stone, and subdrain between the toe of the levee and the Miracle League outfield fencing.	\$49,478.79
8	Engineering	3/7/2025 Addition of bollards at Gatewell 182 for stem protection, access hatch straps for three Gatewells, and a concrete retaining wall for increased levee height at Gatewell 135 A-B.	\$10,125.00

Engineering

\$(263,499.07)

Adjustment of quantities to the as-built quantities.

<b>Original Contract Amount</b>	<b>\$12,686,390.85</b>
---------------------------------	------------------------

<b>Total Change Orders</b>	<b>\$587,254.71</b>
----------------------------	---------------------

<b>Percent of Change Orders to Original Contract</b>	4.63%
--	-------

<b>Total Contract Amount</b>	<b>\$13,273,645.56</b>
------------------------------	------------------------



Department of Engineering  
City of Des Moines, Iowa



August 4, 2025

## **CERTIFICATION OF COMPLETION**

### **AGENDA HEADING:**

Accepting completed construction and approving final payment for the Des Moines Levee Alterations - Phase B, Peterson Contractors, Inc.

### **SYNOPSIS:**

Approve the Engineer's Certification of Completion, accept construction of said improvement, and authorize final payment to the contractor.

### **FISCAL IMPACT:**

Amount: \$13,273,645.56 As-Built Contract Cost

Funding Source: 2025-26 CIP, Page 102, Flood Mitigation Improvements, SM087, Being: Storm Water Utility Funds and Flood Mitigation Sales Tax

### **CERTIFICATION OF COMPLETION:**

On April 18, 2022, under Roll Call No. 22-0587, the City Council awarded a contract to Peterson Contractors, Inc., Cordell Peterson, President, 104 Blackhawk Street, PO Box A, Reinbeck, IA 50669-0155 for the construction of the following improvement:

Des Moines Levee Alterations - Phase B, 082020004

The improvement includes earthen levee raise and widening, earthwork, clearing, excavation, cast-in-place floodwall, cast-in-place floodwall raises, cast-in-place retaining wall, gatewells, gatewell structural modifications, stoplog structure and stoplogs, revetment, manholes, storm sewer pipe and repair, articulated concrete block, utility abandonment and removal, pavement removal, Portland Cement Concrete (PCC) pavement, Hot Mix Asphalt (HMA) pavement, lighting removal and installation, fencing, erosion control, seeding, other incidental items and miscellaneous associated work including cleanup; all in accordance with the contract documents, including Plan File No. 639-113/259, with improvements located along the Raccoon River from the confluence of the Des Moines River to Martin Luther King Jr. Parkway, in Des Moines, Iowa

I hereby certify that the construction of said Des Moines Levee Alterations - Phase B, Activity ID 082020004, has been completed in substantial compliance with the terms of said contract, and I hereby recommend that the work be accepted. The work commenced on May 9, 2022, and was completed on June 16, 2025.

I further certify that \$13,273,645.56 is the total cost of said improvement, of which \$12,875,436.19 has been paid the Contractor and \$0.00 is now due and is hereby approved as final partial payment for the above project, the remaining balance of \$398,209.37 is to be paid at the end of thirty days, with funds retained for unresolved claims on file in accordance with Iowa Code Chapter 573. The amount of completed work is shown on the attached Estimate of Construction Completed.

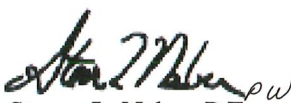
  
Steven L. Naber, P.E.  
Des Moines City Engineer

13C

**ENGINEERING DEPARTMENT  
CITY OF DES MOINES, IOWA**



**ESTIMATE OF CONSTRUCTION COMPLETED  
FOR WORK DONE FROM 6/11/25 to 6/13/25  
PARTIAL PAYMENT NO. 25 (FINAL)**

**PROJECT: DES MOINES LEVEE ALTERATIONS - PHASE B  
CONTRACTOR: PETERSON CONTRACTORS, INC.**

**ACTIVITY ID: 08-2020-004  
DATE: 6/13/2025**

ITEM NO.	DESCRIPTION	UNIT	QUANTITIES				UNIT PRICE	TOTAL AMOUNT
			ESTIMATED	AUTHORIZED	CONSTRUCTED TO DATE	CONSTRUCTED THIS PERIOD		
1	CLEARING AND GRUBBING	AC	3.40	5.07	5.07	0.00	\$ 13,500.00	\$68,445.00
2	TOPSOIL, ON-SITE	CY	14,670.00	14,670.00	14,670.00	0.00	\$ 7.00	\$102,690.00
3	EXCAVATION, CLASS 10	CY	39,750.00	43,128.00	43,128.00	0.00	\$ 15.25	\$657,702.00
4	REMOVAL OF STRUCTURE, CONCRETE BARRIER	EA	4.00	4.00	4.00	0.00	\$ 125.00	\$500.00
5	REMOVAL OF STRUCTURE, FLAPGATE, 4"	EA	1.00	0.00	0.00	0.00	\$ 450.00	\$0.00
6	REMOVAL OF STRUCTURE, FLAPGATE, 10"	EA	1.00	1.00	1.00	0.00	\$ 750.00	\$750.00
7	REMOVAL OF STRUCTURE, FLAPGATE, 12"	EA	3.00	0.00	0.00	0.00	\$ 750.00	\$0.00
8	REMOVAL OF STRUCTURE, FLAPGATE, 18"	EA	3.00	2.00	2.00	0.00	\$ 950.00	\$1,900.00
9	REMOVAL OF STRUCTURE, FLAPGATE, 24"	EA	2.00	2.00	2.00	0.00	\$ 950.00	\$1,900.00
10	REMOVAL OF STRUCTURE, FLAPGATE, 30"	EA	1.00	1.00	1.00	0.00	\$ 1,200.00	\$1,200.00
11	REMOVAL OF STRUCTURE, FLAPGATE, 42"	EA	1.00	1.00	1.00	0.00	\$ 1,400.00	\$1,400.00
12	REMOVAL OF STRUCTURE, APRON, 24"	EA	2.00	2.00	2.00	0.00	\$ 650.00	\$1,300.00
13	REMOVAL OF STRUCTURE, FLOODWALL, DM-III	LF	313.00	313.00	313.00	0.00	\$ 265.00	\$82,945.00
14	REMOVAL OF STRUCTURE, GUARDRAIL	LF	28.00	28.00	28.00	0.00	\$ 18.00	\$504.00
15	REMOVAL OF STRUCTURE, GATEWELL 131	EA	1.00	1.00	1.00	0.00	\$ 25,000.00	\$25,000.00
16	REMOVAL OF STRUCTURE, GATEWELL 186	EA	1.00	1.00	1.00	0.00	\$ 20,000.00	\$20,000.00
17	REMOVAL OF CONCRETE WALL AND DRAIN	EA	1.00	0.00	0.00	0.00	\$ 15,000.00	\$0.00
18	TREE PROTECTION FENCE, 48" HEIGHT	LF	7,150.00	1,539.00	1,539.00	0.00	\$ 3.75	\$5,771.25
19	SPECIAL PIPE EMBEDMENT	LF	2,074.00	1,967.31	1,967.31	0.00	\$ 20.00	\$39,346.20
20	REMOVAL OF SANITARY SEWER, RCP, 36"	LF	30.00	30.00	30.00	0.00	\$ 50.00	\$1,500.00
21	STORM SEWER TRENCHED, RCP, CLASS III, 15"	LF	386.00	397.00	397.00	0.00	\$ 140.00	\$55,580.00
22	STORM SEWER TRENCHED, RCP, CLASS III, 18"	LF	50.00	44.00	44.00	0.00	\$ 150.00	\$6,600.00
23	STORM SEWER TRENCHED, RCP, CLASS III, 24"	LF	1,491.00	1,491.00	1,491.00	0.00	\$ 180.00	\$268,380.00
24	STORM SEWER TRENCHED, RCP, CLASS III, 30"	LF	41.00	38.00	38.00	0.00	\$ 250.00	\$9,500.00
25	STORM SEWER TRENCHED, PVC, SDR 23.5, 4"	LF	29.00	29.00	29.00	0.00	\$ 95.00	\$2,755.00
26	STORM SEWER TRENCHED, DIP, CLASS 350, 12"	LF	27.00	0.00	0.00	0.00	\$ 225.00	\$0.00
27	STORM SEWER TRENCHED, DIP, CLASS 350, 36"	LF	50.00	50.00	50.00	0.00	\$ 1,500.00	\$75,000.00
28	REMOVAL OF STORM SEWER, RCP, 12"	LF	188.00	188.00	188.00	0.00	\$ 55.00	\$10,340.00
29	REMOVAL OF STORM SEWER, RCP, 18"	LF	65.00	65.00	65.00	0.00	\$ 80.00	\$5,200.00
30	REMOVAL OF STORM SEWER, RCP, 24"	LF	16.00	16.00	16.00	0.00	\$ 135.00	\$2,160.00
31	REMOVAL OF STORM SEWER, RCP, 72"	LF	21.00	16.00	16.00	0.00	\$ 250.00	\$4,000.00
32	REMOVAL OF STORM SEWER, CMP, 10"	LF	65.00	65.00	65.00	0.00	\$ 30.00	\$1,950.00
33	REMOVAL OF STORM SEWER, CMP, 30"	LF	65.00	65.00	65.00	0.00	\$ 45.00	\$2,925.00
34	REMOVAL OF STORM SEWER FORCE MAIN	LS	1.00	1.00	1.00	0.00	\$ 20,000.00	\$20,000.00
35	FLAPGATE, 18"	EA	1.00	1.00	1.00	0.00	\$ 5,000.00	\$5,000.00



ITEM NO.	DESCRIPTION	UNIT	QUANTITIES				UNIT PRICE	TOTAL AMOUNT
			ESTIMATED	AUTHORIZED	CONSTRUCTED TO DATE	CONSTRUCTED THIS PERIOD		
36	FLAPGATE, 24"	EA	2.00	2.00	2.00	0.00	\$ 6,000.00	\$12,000.00
37	FLAPGATE, 30"	EA	1.00	1.00	1.00	0.00	\$ 7,500.00	\$7,500.00
38	HEADWALL, 18"	EA	1.00	1.00	1.00	0.00	\$ 9,500.00	\$9,500.00
39	HEADWALL, 24"	EA	2.00	2.00	2.00	0.00	\$ 12,500.00	\$25,000.00
40	HEADWALL, 30"	EA	1.00	1.00	1.00	0.00	\$ 15,500.00	\$15,500.00
41	PIPE APRON, RCP, CLASS III, 24"	EA	1.00	1.00	1.00	0.00	\$ 5,000.00	\$5,000.00
42	BYPASS PUMPING	LS	1.00	1.00	1.00	0.00	\$ 10,000.00	\$10,000.00
43	SPOT REPAIRS BY PIPE REPLACEMENT, RCP, CLASS III, 24"	EA	1.00	1.00	1.00	0.00	\$ 5,500.00	\$5,500.00
44	SPOT REPAIRS BY PIPE REPLACEMENT, RCP, CLASS III, 36"	EA	1.00	1.00	1.00	0.00	\$ 11,500.00	\$11,500.00
45	SPOT REPAIRS BY PIPE REPLACEMENT, RCP, CLASS III, 72"	EA	1.00	1.00	1.00	0.00	\$ 12,500.00	\$12,500.00
46	SPOT REPAIRS BY PIPE REPLACEMENT, RCP, CLASS III, 24"	LF	16.00	16.00	16.00	0.00	\$ 800.00	\$12,800.00
47	SPOT REPAIRS BY PIPE REPLACEMENT, RCP, CLASS III, 36"	LF	30.00	30.00	30.00	0.00	\$ 1,000.00	\$30,000.00
48	SPOT REPAIRS BY PIPE REPLACEMENT, RCP, CLASS III, 72"	LF	16.00	16.00	16.00	0.00	\$ 1,500.00	\$24,000.00
49	STORM SEWER ABANDONMENT, FILL AND PLUG, CIP, 4"	LF	100.00	40.00	40.00	0.00	\$ 70.00	\$2,800.00
50	STORM SEWER ABANDONMENT, FILL AND PLUG, CIP, 10"	LF	52.00	20.80	20.80	0.00	\$ 130.00	\$2,704.00
51	STORM SEWER ABANDONMENT, FILL AND PLUG, CMP, 12"	LF	65.00	65.00	65.00	0.00	\$ 60.00	\$3,900.00
52	STORM SEWER ABANDONMENT, FILL AND PLUG, CMP, 18"	LF	170.00	170.00	170.00	0.00	\$ 65.00	\$11,050.00
53	STORM SEWER ABANDONMENT, FILL AND PLUG, CMP, 24"	LF	163.00	163.00	163.00	0.00	\$ 70.00	\$11,410.00
54	STORM SEWER ABANDONMENT, FILL AND PLUG, RCP, 12"	LF	70.00	35.00	35.00	0.00	\$ 60.00	\$2,100.00
55	SANITARY SEWER ABANDONMENT, FILL AND PLUG, RCP, 15"	LF	173.00	69.20	69.20	0.00	\$ 65.00	\$4,498.00
56	SANITARY SEWER ABANDONMENT, FILL AND PLUG, RCP, 42"	LF	188.00	188.00	188.00	0.00	\$ 150.00	\$28,200.00
57	STORM SEWER PIPE, CLASS 350 DI PIPE SPOOL, PE x PE, 8" DIA.	LF	38.00	38.00	38.00	0.00	\$ 300.00	\$11,400.00
58	STORM SEWER PIPE, CLASS 53 DI PIPE SPOOL, FL x PE, 4" DIA.	LF	3.00	3.00	3.00	0.00	\$ 400.00	\$1,200.00
59	STORM SEWER PIPE, CLASS 53 DI PIPE SPOOL, FL x PE, 8" DIA.	LF	7.00	7.00	7.00	0.00	\$ 300.00	\$2,100.00
60	VALVE, PLUG, FL, 4" DIA.	EA	1.00	1.00	1.00	0.00	\$ 4,000.00	\$4,000.00
61	VALVE, PLUG, FL, 8" DIA.	EA	3.00	3.00	3.00	0.00	\$ 4,500.00	\$13,500.00
62	VALVE, AIR/VACUUM, FL, 4" DIA.	EA	1.00	1.00	1.00	0.00	\$ 3,500.00	\$3,500.00
63	VALVE, AIR/VACUUM, FL, 8" DIA.	EA	3.00	3.00	3.00	0.00	\$ 6,000.00	\$18,000.00
64	FITTING, 22.5° BEND, MJ, 8" DIA.	EA	2.00	2.00	2.00	0.00	\$ 1,500.00	\$3,000.00
65	FITTING, 22.5° BEND, MJ, 36" DIA.	EA	6.00	6.00	6.00	0.00	\$ 20,000.00	\$120,000.00
66	FITTING, 90° BEND, MJ, 8" DIA.	EA	4.00	4.00	4.00	0.00	\$ 1,500.00	\$6,000.00
67	FITTING, 90° BEND, MJ, 36" DIA.	EA	12.00	12.00	12.00	0.00	\$ 22,000.00	\$264,000.00
68	FITTING, RESTRAINED JOINT ADAPTER, 4" DIA.	EA	2.00	2.00	2.00	0.00	\$ 30.00	\$60.00
69	FITTING, RESTRAINED JOINT ADAPTER, 8" DIA.	EA	13.00	13.00	13.00	0.00	\$ 60.00	\$780.00
70	FITTING, RESTRAINED JOINT ADAPTER, 36" DIA.	EA	12.00	12.00	12.00	0.00	\$ 1,500.00	\$18,000.00
71	FITTING, BOLT THROUGH MJ RESTRAINED ADAPTER, 8" DIA.	EA	2.00	2.00	2.00	0.00	\$ 1,200.00	\$2,400.00
72	FITTING, BOLT THROUGH MJ RESTRAINED ADAPTER, 36" DIA.	EA	15.00	15.00	15.00	0.00	\$ 5,000.00	\$75,000.00
73	FITTING, TEE, MJ, 8" x 4" x 8"	EA	1.00	1.00	1.00	0.00	\$ 2,500.00	\$2,500.00
74	FITTING, TEE, MJ, 36" x 8" x 36"	EA	3.00	3.00	3.00	0.00	\$ 25,000.00	\$75,000.00
75	MANHOLE, SW-401, 48" DIA.	EA	13.00	12.00	12.00	0.00	\$ 9,000.00	\$108,000.00
76	MANHOLE, SW-401, 60" DIA.	EA	2.00	2.00	2.00	0.00	\$ 12,000.00	\$24,000.00
77	MANHOLE, SW-404, 4.0' X 6.0'	EA	1.00	0.00	0.00	0.00	\$ 30,000.00	\$0.00
78	MANHOLE, SW-404, 4.5' X 9.5'	EA	1.00	1.00	1.00	0.00	\$ 40,000.00	\$40,000.00



ITEM NO.	DESCRIPTION	UNIT	QUANTITIES				UNIT PRICE	TOTAL AMOUNT
			ESTIMATED	AUTHORIZED	CONSTRUCTED TO DATE	CONSTRUCTED THIS PERIOD		
79	INTAKE, SW-512, 18" DIA.	EA	1.00	1.00	1.00	0.00	\$ 10,000.00	\$10,000.00
80	INTAKE ADJUSTMENT, MINOR	EA	1.00	3.00	3.00	0.00	\$ 2,500.00	\$7,500.00
81	REMOVE INTAKE, 12" DIA.	EA	2.00	2.00	2.00	0.00	\$ 2,000.00	\$4,000.00
82	REMOVE INTAKE, 18" DIA.	EA	2.00	2.00	2.00	0.00	\$ 2,500.00	\$5,000.00
83	GATEWELL 131	EA	1.00	1.00	1.00	0.00	\$ 135,000.00	\$135,000.00
84	GATEWELL 133A	EA	1.00	1.00	1.00	0.00	\$ 125,000.00	\$125,000.00
85	GATEWELL 182	EA	1.00	1.00	1.00	0.00	\$ 95,000.00	\$95,000.00
86	GATEWELL 186	EA	1.00	1.00	1.00	0.00	\$ 192,000.00	\$192,000.00
87	GATEWELL 185C, GATEWELL STRUCTURE RAISE	EA	1.00	1.00	1.00	0.00	\$ 25,000.00	\$25,000.00
88	CAST-IN-PLACE FLOODWALL, STA. 512+00 TO STA. 516+68	CY	462.00	462.00	462.00	0.00	\$ 1,020.00	\$471,240.00
89	CAST-IN-PLACE FLOODWALL RAISE SEGMENT STA. 437+14 TO STA. 440+14	CY	7.00	7.00	7.00	0.00	\$ 6,615.00	\$46,305.00
90	CAST-IN-PLACE FLOODWALL RAISE SEGMENT STA. 440+14 TO STA. 443+14	CY	6.00	6.00	6.00	0.00	\$ 8,015.00	\$48,090.00
91	ABANDONMENT OF STRUCTURE, GATEWELL 181	EA	1.00	1.00	1.00	0.00	\$ 25,000.00	\$25,000.00
92	ABANDONMENT OF STRUCTURE, GATEWELL 165	EA	1.00	1.00	1.00	0.00	\$ 25,000.00	\$25,000.00
93	ABANDONMENT OF STRUCTURE, GATEWELL 275	EA	1.00	1.00	1.00	0.00	\$ 25,000.00	\$25,000.00
94	ABANDONMENT OF STRUCTURE, SANITARY SEWER MH	EA	1.00	1.00	1.00	0.00	\$ 8,000.00	\$8,000.00
95	STOPLOG STRUCTURE AND STOPLOGS	EA	1.00	1.00	1.00	0.00	\$ 195,000.00	\$195,000.00
96	CURB AND GUTTER, 2' WIDE, 6" THICK	LF	374.00	406.00	406.00	0.00	\$ 46.00	\$18,676.00
97	DROP CURB AND GUTTER, 2' WIDE, 6" THICK	LF	19.00	19.00	19.00	0.00	\$ 80.00	\$1,520.00
98	REMOVAL OF SIDEWALK	SY	84.00	80.00	80.00	0.00	\$ 11.00	\$880.00
99	REMOVAL OF SHARED USE PATH	SY	3,039.00	3,036.00	3,036.00	0.00	\$ 6.25	\$18,975.00
100	REMOVAL OF DRIVEWAY	SY	2,035.00	1,143.00	1,143.00	0.00	\$ 8.50	\$9,715.50
101	REMOVAL OF CURB	LF	40.00	40.00	40.00	0.00	\$ 9.50	\$380.00
102	SHARED USE PATH, HMA, 6" THICK	SY	2,687.00	2,687.00	2,687.00	0.00	\$ 52.35	\$140,664.45
103	SHARED USE PATH, PCC, 6" THICK	SY	456.00	424.00	424.00	0.00	\$ 66.00	\$27,984.00
104	SIDEWALK, PCC, 6" THICK	SY	251.00	191.50	191.50	0.00	\$ 76.00	\$14,554.00
105	DETECTABLE WARNING	SF	32.00	28.00	28.00	0.00	\$ 65.00	\$1,820.00
106	DRIVEWAY, PAVED, PCC, 6" THICK	SY	1,574.00	944.00	944.00	0.00	\$ 65.00	\$61,360.00
107	DRIVEWAY, GRANULAR	TONS	1,017.00	963.60	963.60	0.00	\$ 35.00	\$33,726.00
108	REMOVE AND STOCKPILE EXISTING TRAIL LIGHTING	EA	12.00	12.00	12.00	0.00	\$ 1,675.00	\$20,100.00
109	DEMOLISH EXISTING LIGHTING FOUNDATION	EA	12.00	12.00	12.00	0.00	\$ 600.00	\$7,200.00
110	RE-INSTALL EXISTING TRAIL LIGHTING	EA	11.00	11.00	11.00	0.00	\$ 5,950.00	\$65,450.00
111	REMOVE AND STOCKPILE EXISTING SIGN	EA	22.00	22.00	22.00	0.00	\$ 80.00	\$1,760.00
112	RESET STOCKPILED EXISTING SIGN	EA	22.00	12.00	12.00	0.00	\$ 205.00	\$2,460.00
113	FLEXIBLE DELINEATOR POSTS	EA	24.00	12.00	12.00	0.00	\$ 205.00	\$2,460.00
114	PAINTED PAVEMENT MARKINGS, SOLVENT/WATERBORNE, 4" WIDE	LF	1,008.00	920.00	920.00	0.00	\$ 27.00	\$24,840.00
115	PAINTED PAVEMENT MARKINGS, SOLVENT/WATERBORNE, 7" WIDE	LF	8.00	8.00	8.00	0.00	\$ 37.00	\$296.00
116	PAVEMENT SYMBOLS AND LEGENDS	EA	1.00	3.00	3.00	0.00	\$ 300.00	\$900.00
117	TEMPORARY TRAFFIC CONTROL	LS	1.00	1.00	1.00	0.00	\$ 225,500.00	\$225,500.00
118	HYDRAULIC SEEDING, SEEDING, FERTILIZING, AND MULCHING - DES	AC	39.33	29.06	29.06	0.00	\$ 5,600.00	\$162,736.00
119	HYDRAULIC SEEDING, SEEDING, FERTILIZING, AND MULCHING - WE	AC	0.03	0.00	0.00	0.00	\$ 5,500.00	\$0.00
120	WARRANTY, SEEDING	LS	1.00	1.00	1.00	0.00	\$ 25,000.00	\$25,000.00
121	SOD	SQ	537.00	0.00	0.00	0.00	\$ 76.00	\$0.00



ITEM NO.	DESCRIPTION	UNIT	QUANTITIES				UNIT PRICE	TOTAL AMOUNT
			ESTIMATED	AUTHORIZED	CONSTRUCTED TO DATE	CONSTRUCTED THIS PERIOD		
122	STORMWATER POLLUTION PREVENTION PLAN (SWPPP)	LS	1.00	1.00	1.00	0.00	\$ 14,800.00	\$14,800.00
123	TEMPORARY RECP, TYPE 3.B	SY	50,410.00	54,080.50	54,080.50	0.00	\$ 1.60	\$86,528.80
124	WATTLE, STRAW, 12"	LF	12,035.00	5,764.00	5,764.00	0.00	\$ 2.35	\$13,545.40
125	WATTLE, REMOVAL	LF	12,035.00	935.00	935.00	0.00	\$ 1.25	\$1,168.75
126	RIP RAP, IDOT CLASS A	TON	8,425.00	9,377.53	9,377.53	0.00	\$ 68.00	\$637,672.04
127	RIP RAP, IDOT CLASS B	TON	19,682.00	25,019.02	25,019.02	0.00	\$ 67.00	\$1,676,274.34
128	RIP RAP, IDOT CLASS E	TON	47,080.00	47,393.11	47,393.11	0.00	\$ 66.00	\$3,127,945.26
129	SILT FENCE	LF	18,060.00	5,484.00	5,484.00	0.00	\$ 1.85	\$10,145.40
130	SILT FENCE, REMOVAL OF DEVICE	LF	18,060.00	4,745.00	4,745.00	0.00	\$ 1.05	\$4,982.25
131	EROSION CONTROL MULCHING, HYDROMULCHING	AC	20.00	9.57	9.57	0.00	\$ 2,200.00	\$21,054.00
132	INLET PROTECTION DEVICE, SURFACE APPLIED	EA	5.00	0.00	0.00	0.00	\$ 170.00	\$0.00
133	INLET PROTECTION DEVICE, WATTLES, STRAW	EA	13.00	0.00	0.00	0.00	\$ 125.00	\$0.00
134	INLET PROTECTION DEVICE, MAINTENANCE	EA	13.00	0.00	0.00	0.00	\$ 50.00	\$0.00
135	STABILIZED CONSTRUCTION ENTRANCE	TON	414.00	285.00	285.00	0.00	\$ 75.50	\$21,517.50
136	ZINC-COATED CHAINLINK, 72" HEIGHT	LF	1,858.00	910.00	910.00	0.00	\$ 23.50	\$21,385.00
137	PVC-COATED CHAINLINK, 96" HEIGHT	LF	220.00	220.00	220.00	0.00	\$ 48.00	\$10,560.00
138	GATE, CANTILEVER, ZINC-COATED STEEL, 30' WIDE, 72" HEIGHT	EA	1.00	0.00	0.00	0.00	\$ 6,000.00	\$0.00
139	GATE, SINGLE SWING, ZINC-COATED STEEL, 12' WIDE, 72" HEIGHT	EA	1.00	1.00	1.00	0.00	\$ 1,300.00	\$1,300.00
140	GATE, DOUBLE SWING, ZINC-COATED STEEL, 20' WIDE, 72" HEIGHT	EA	1.00	1.00	1.00	0.00	\$ 1,600.00	\$1,600.00
141	GATE, SINGLE SWING, PVC-COATED STEEL, 4' WIDE, 96" HEIGHT	EA	2.00	2.00	2.00	0.00	\$ 1,100.00	\$2,200.00
142	GATE, DOUBLE SWING, PVC-COATED STEEL, 20' WIDE, 96" HEIGHT	EA	2.00	2.00	2.00	0.00	\$ 2,000.00	\$4,000.00
143	BARBED WIRE, 3 STRAND, TYPE II ARMS	LF	1,199.00	1,435.00	1,435.00	0.00	\$ 3.85	\$5,524.75
144	REMOVAL OF FENCE	LF	2,172.00	1,075.00	1,075.00	0.00	\$ 3.00	\$3,225.00
145	COMBINED CONCRETE SIDEWALK AND RETAINING WALL	CY	200.00	200.00	200.00	0.00	\$ 1,120.00	\$224,000.00
146	HANDRAIL, SPECIAL, ALUMINUM	LF	221.00	221.00	221.00	0.00	\$ 250.00	\$55,250.00
147	ARTICULATED CONCRETE BLOCK MATTING	SF	54,370.00	54,370.00	54,370.00	0.00	\$ 12.75	\$693,217.50
148	WINDROW AND STOCKPILE RIP RAP	TON	4,531.00	4,531.00	4,531.00	0.00	\$ 19.50	\$88,354.50
149	PLUG OR ABANDON MONITORING WELL	EA	3.00	2.00	2.00	0.00	\$ 1,500.00	\$3,000.00
150	CONSTRUCTION SURVEY	LS	1.00	1.00	1.00	0.00	\$ 70,000.00	\$70,000.00
151	MONUMENT PRESERVATION OR REPLACEMENT	LS	1.00	1.00	1.00	0.00	\$ 12,000.00	\$12,000.00
152	MOBILIZATION	LS	1.00	1.00	1.00	0.00	\$ 940,000.00	\$940,000.00
153	CONCRETE WASHOUT	LS	1.00	1.00	1.00	0.00	\$ 6,000.00	\$6,000.00
154	FLOOD CONTINGENCY PLAN	LS	1.00	1.00	1.00	0.00	\$ 200,000.00	\$200,000.00
155	RAILROAD PROTECTIVE INSURANCE AND COORDINATION (IAIR)	LS	1.00	1.00	1.00	0.00	\$ 12,000.00	\$12,000.00
156	RAILROAD PROTECTIVE INSURANCE AND COORDINATION (UPRR)	LS	1.00	1.00	1.00	0.00	\$ 12,000.00	\$12,000.00
	<b>Stored Materials</b>							
75	MANHOLE, SW-401, 48" DIA. - Grate, Frame, & Cover	EA	0.00	13.00	0.00	0.00	\$ 449.23	\$0.00
76	MANHOLE, SW-401, 60" DIA. - Grate, Frame, & Cover	EA	0.00	2.00	0.00	0.00	\$ 540.00	\$0.00
77	MANHOLE, SW-404, 4.0'x6.0' - Grate, Frame, & Cover	EA	0.00	1.00	0.00	0.00	\$ 335.00	\$0.00
78	MANHOLE, SW-404, 4.5'x9.5' - Grate, Frame, & Cover	EA	0.00	1.00	0.00	0.00	\$ 335.00	\$0.00
79	INTAKE, SW-512, 18" DIA - Grate, Frame, & Cover	EA	0.00	1.00	0.00	0.00	\$ 225.00	\$0.00
83	GATEWELL 131 - Sluice Gate and Materials	EA	0.00	1.00	0.00	0.00	\$ 26,387.25	\$0.00



ITEM NO.	DESCRIPTION	UNIT	QUANTITIES				UNIT PRICE	TOTAL AMOUNT
			ESTIMATED	AUTHORIZED	CONSTRUCTED TO DATE	CONSTRUCTED THIS PERIOD		
84	GATEWELL 133A - Sluice Gate and Materials	EA	0.00	1.00	0.00	0.00	\$ 26,387.25	\$0.00
	<b>Change Order Items</b>							
8001	ABANDON RAILROAD TRACK REMOVAL	LF	0.00	1,838.00	1,838.00	0.00	\$ 25.00	\$45,950.00
8002	REMOVE AND REINSTALL CHAIN LINK FENCE, 96" HEIGHT	LF	0.00	605.00	605.00	0.00	\$ 45.10	\$27,285.50
8003	LIGHTING CONTROL CABINET, REMOVE AND REINSTALL	LS	0.00	1.00	1.00	0.00	\$ 16,882.31	\$16,882.31
8004	RETAINING WALL, SALVAGE AND REINSTALL	LS	0.00	1.00	1.00	0.00	\$ 18,518.58	\$18,518.58
8005	STORM SEWER, 12" CMP, REMOVE AND RELOCATE	LS	0.00	1.00	1.00	0.00	\$ 2,493.81	\$2,493.81
8006	TEST PIT EXCAVATION	EACH	0.00	6.00	6.00	0.00	\$ 380.00	\$2,280.00
8007	UNSUITABLE SOILS	CY	0.00	3,378.00	3,378.00	0.00	\$ 2.15	\$7,262.70
8008	HMA, 2" MILL AND FILL	SY	0.00	877.00	877.00	0.00	\$ 41.80	\$36,658.60
8009	GATE, DOUBLE SWING, ZINC-COATED STEEL, 16 FT WIDE, 72 IN HEIGHT	LS	0.00	1.00	1.00	0.00	\$ 1,529.00	\$1,529.00
8010	PARKING LOT LIGHTING REPAIRS	LS	0.00	1.00	1.00	0.00	\$ 1,762.00	\$1,762.00
8011	GATEWELL 143 MODIFICATIONS	LS	0.00	1.00	1.00	0.00	\$ 84,240.77	\$84,240.77
8012	PARKING LOT ROADSTONE	TON	0.00	58.94	58.94	0.00	\$ 38.00	\$2,239.72
8013	FILL STONE	TON	0.00	280.00	280.00	0.00	\$ 55.00	\$15,400.00
8014	SIGN, REMOVE AND REINSTALL	EACH	0.00	2.00	2.00	0.00	\$ 1,200.00	\$2,400.00
8015	VALVE BOX EXTENSION	EACH	0.00	1.00	1.00	0.00	\$ 350.00	\$350.00
8016	MAJOR MANHOLE ADJUSTMENT	VF	0.00	24.00	24.00	0.00	\$ 2,200.00	\$52,800.00
8017	OBJECT MARKER SIGN	EACH	0.00	3.00	3.00	0.00	\$ 467.33	\$1,401.99
8018	UPRR, APPLICATION FEE AND ADDITIONAL SHORING DESIGN	LS	0.00	1.00	1.00	0.00	\$ 4,575.00	\$4,575.00
8019	SAFETY RAIL REMOVAL	LS	0.00	1.00	1.00	0.00	\$ 2,060.00	\$2,060.00
8020	CONSTRUCTION SURVEY, ADDITIONAL WORK	LS	0.00	1.00	1.00	0.00	\$ 715.00	\$715.00
8021	CHAIN LINK FENCE, REMOVE AND REPLACE, 84-INCH	LF	0.00	80.00	80.00	0.00	\$ 44.13	\$3,530.40
8022	CHAIN LINK FENCE, REMOVE AND REINSTALL	LF	0.00	107.00	107.00	0.00	\$ 44.00	\$4,708.00
8023	GATEWELL 131, FLOW LINE MODIFICATION	LS	0.00	1.00	1.00	0.00	\$ 3,850.00	\$3,850.00
8024	TOPSOIL, STRIP AND EXPORT, TOP OF LEVEE	CY	0.00	693.00	693.00	0.00	\$ 23.50	\$16,285.50
8025	MODIFIED SUBBASE, TOP OF LEVEE	TON	0.00	1,250.00	1,250.00	0.00	\$ 35.50	\$44,375.00
8026	CONSTRUCTION SURVEY, RAILROAD TRACK MONITORING	LS	0.00	1.00	1.00	0.00	\$ 19,891.39	\$19,891.39
8027	EROSION STONE, UNDER BRIDGE	TON	0.00	365.05	365.05	0.00	\$ 59.00	\$21,537.95
8028	ENGINEERING FABRIC, UNDER BRIDGE	SY	0.00	400.00	400.00	0.00	\$ 7.10	\$2,840.00
8029	SUBDRAIN, 4" PERFORATED, MIRACLE LEAGUE	LF	0.00	215.00	215.00	0.00	\$ 24.23	\$5,209.45
8030	GATEWELL ACCESS HATCH STRAPS	LS	0.00	1.00	1.00	0.00	\$ 1,870.00	\$1,870.00
8031	BOLLARD, GATEWELL 182	EACH	0.00	2.00	2.00	0.00	\$ 1,127.50	\$2,255.00
8032	CONCRETE RETAINING WALL, GATEWELL 135 -B	LS	0.00	1.00	1.00	0.00	\$ 6,000.00	\$6,000.00
	ORIGINAL CONTRACT AMOUNT		\$ 12,686,390.85					
	TOTAL CHANGE ORDERS		\$ 587,254.71					
	ORIGINAL CONTRACT AMOUNT PLUS CHANGE ORDERS		\$ 13,273,645.56					
	PARTIAL PAYMENT 1		\$ 95,642.00					
	PARTIAL PAYMENT 2		\$ 2,057,054.31					
	PARTIAL PAYMENT 3		\$ 876,332.12					



ITEM NO.	DESCRIPTION	UNIT	QUANTITIES				UNIT PRICE	TOTAL AMOUNT
			ESTIMATED	AUTHORIZED	CONSTRUCTED TO DATE	CONSTRUCTED THIS PERIOD		
	PARTIAL PAYMENT 4		\$ 1,260,273.64					
	PARTIAL PAYMENT 5		\$ 766,469.02					
	PARTIAL PAYMENT 6		\$ 1,322,618.47					
	PARTIAL PAYMENT 7		\$ 1,758,388.73					
	PARTIAL PAYMENT 8		\$ 990,796.50					
	PARTIAL PAYMENT 9		\$ 254,023.18					
	PARTIAL PAYMENT 10		\$ 703,178.70					
	PARTIAL PAYMENT 11		\$ 350,455.04					
	PARTIAL PAYMENT 12		\$ 362,805.72					
	PARTIAL PAYMENT 13		\$ 444,449.15					
	PARTIAL PAYMENT 14		\$ 94,960.70					
	PARTIAL PAYMENT 15		\$ 200,636.44					
	PARTIAL PAYMENT 16		\$ 159,830.54					
	PARTIAL PAYMENT 17		\$ 46,920.35					
	PARTIAL PAYMENT 18		\$ 11,526.90					
	PARTIAL PAYMENT 19		\$ 294,207.43					
	PARTIAL PAYMENT 20		\$ 340,635.46					
	PARTIAL PAYMENT 21		\$ 117,248.78					
	PARTIAL PAYMENT 22		\$ 296,392.50					
	PARTIAL PAYMENT 23		\$ 16,761.60					
	PARTIAL PAYMENT 24		\$ 53,828.91					
	THIS PARTIAL PAYMENT 25 (FINAL)		\$0.00					
	TOTAL PARTIAL PAYMENTS		\$ 12,875,436.19					
	BALANCE		\$ 398,209.37					
	APPROXIMATE PERCENT COMPLETE		98.0%					

PREPARED BY:

Juan Arellanes  
Project Inspector

CHECKED BY:

Daniel Sturm  
Project Engineer

TOTAL	\$13,273,645.56
RETAINAGE	\$ 398,209.37
TOTAL LESS RETAINAGE	\$12,875,436.19
LESS PREVIOUS PAYMENT	\$ 12,875,436.19
AMOUNT DUE	\$0.00

PARTIAL PAYMENT NO. 25 (FINAL)