



Date August 18, 2025

RESOLUTION CONTINUING PUBLIC HEARING FOR CONVEYANCE OF PROPERTY INTERESTS TO POLK COUNTY FOR IOWA CONFLUENCE WATER TRAILS PROJECT

WHEREAS, the City of Des Moines, Iowa (“City”) is the owner of certain excess real estate locally known as 1550 Grays Parkway, Des Moines, Iowa, more particularly described below; and

WHEREAS, Polk County, Iowa (“Polk County”) has agreed to acquire a portion of the afore-mentioned real property for no consideration in accordance with Iowa Code §364.7(3) for the public purpose of creating a public park and recreation area as part of the Iowa Confluence Water Trails project (hereinafter “Project”), subject to a permanent easement upon, over and within said real property for the continued use and maintenance of and the right of access to any existing utilities and flood protection levee improvements now in place; and

WHEREAS, Polk County has also requested the conveyance by the City of a Permanent Easement for River Infrastructure, a Permanent Easement for Public Ingress and Egress, a Permanent Easement for Storm Sewer and Surface Water Flowage, a Permanent Easement for Recreational Trail and a Temporary Easement for Construction and Construction-Related Activities, all on City-owned property, as legally described below (collectively with the above-described fee conveyance, “Property”), for no consideration in accordance with Iowa Code §364.7(3) for the public purpose of creating a public park and recreation area as part of the Project; and

WHEREAS, there is no known current or future public need or benefit for the City Property proposed to be conveyed, and the City will not be inconvenienced by the conveyance of said Property; and

WHEREAS, on July 14, 2025, by Roll Call No. 25-0975, it was duly resolved by the City Council of the City of Des Moines, Iowa, that the proposed conveyance be set down for hearing on August 4, 2025, at 5:00 p.m., in the City Council Chambers, City Hall, 400 Robert D. Ray Drive, Des Moines, Iowa; and

WHEREAS, due notice of said proposal to convey the Property was given to all necessary parties as provided by law, setting forth the time and place for hearing on said proposal; and

WHEREAS, additional time was requested by Polk County to negotiate, with the City Engineering Department and City Manager, an Agreement between Polk County and the City of Des Moines with Respect to Real Estate for the Central Iowa Water Trails Systems (“Agreement”) setting forth the terms and conditions of said proposed conveyance, and thus a continuation of the public hearing to August 18, 2025 was required and was approved by City Council on August 8, 2025 pursuant to Roll Call No. 25-1080; and

WHEREAS, the parties thereafter have agreed that Polk County will submit the Agreement to its Board of Supervisors for approval prior to City Council consideration, which Board meeting is set for August 26, 2025, and which requires a further continuance of the City’s public hearing to September 8, 2025.



Roll Call Number

Agenda Item Number

43

Date August 18, 2025

NOW, THEREFORE, BE IT RESOLVED by the City Council of the City of Des Moines, Iowa, that the public hearing for consideration of conveyance of the Property to Polk County as described above, be and is hereby opened and continued to September 8, 2025, at 5:00p.m. in the City Council Chambers, City Hall, 400 Robert D. Ray Drive, Des Moines, Iowa.

Moved by _____ to adopt.

Second by _____.

APPROVED AS TO FORM:

/s/ Glenna K. Frank

Glenna K. Frank, Deputy City Attorney

COUNCIL ACTION	YEAS	NAYS	PASS	ABSENT
BOESEN				
COLEMAN				
GATTO				
MANDELBAUM				
SIMONSON				
VOSS				
WESTERGAARD				
TOTAL				
MOTION CARRIED			APPROVED	

CERTIFICATE

I, Laura Baumgartner, City Clerk of said City hereby certify that at a meeting of the City Council of said City of Des Moines, held on the above date, among other proceedings the above was adopted.

IN WITNESS WHEREOF, I have hereunto set my hand and affixed my seal the day and year first above written.

City Clerk



Roll Call Number

25-1080

43
Agenda Item Number

56

Date August 4, 2025

RESOLUTION CONTINUING PUBLIC HEARING FOR CONVEYANCE OF PROPERTY INTERESTS TO POLK COUNTY FOR IOWA CONFLUENCE WATER TRAILS PROJECT

WHEREAS, the City of Des Moines, Iowa (“City”) is the owner of certain excess real estate locally known as 1550 Grays Parkway, Des Moines, Iowa, more particularly described below; and

WHEREAS, Polk County, Iowa (“Polk County”) has agreed to acquire a portion of the afore-mentioned real property for no consideration in accordance with Iowa Code §364.7(3) for the public purpose of creating a public park and recreation area as part of the Iowa Confluence Water Trails project (hereinafter “Project”), subject to a permanent easement upon, over and within said real property for the continued use and maintenance of and the right of access to any existing utilities and flood protection levee improvements now in place; and

WHEREAS, Polk County has also requested the conveyance by the City of a Permanent Easement for River Infrastructure, a Permanent Easement for Public Ingress and Egress, a Permanent Easement for Storm Sewer and Surface Water Flowage, a Permanent Easement for Recreational Trail and a Temporary Easement for Construction and Construction-Related Activities, all on City-owned property, as legally described below (collectively with the above-described fee conveyance, “Property”), for no consideration in accordance with Iowa Code §364.7(3) for the public purpose of creating a public park and recreation area as part of the Project; and

WHEREAS, there is no known current or future public need or benefit for the City Property proposed to be conveyed, and the City will not be inconvenienced by the conveyance of said Property; and

WHEREAS, on July 14, 2025, by Roll Call No. 25-0975, it was duly resolved by the City Council of the City of Des Moines, Iowa, that the proposed conveyance be set down for hearing on August 4, 2025, at 5:00 p.m., in the City Council Chambers, City Hall, 400 Robert D. Ray Drive, Des Moines, Iowa; and

WHEREAS, due notice of said proposal to convey the Property was given to all necessary parties as provided by law, setting forth the time and place for hearing on said proposal; and

WHEREAS, additional time has been requested by Polk County to negotiate, with the City Engineering Department and City Manager, an Agreement between Polk County and the City of Des Moines with Respect to Real Estate for the Central Iowa Water Trails Systems (“Agreement”) setting forth the terms and conditions of said proposed conveyance, and thus a continuation of the public hearing to August 18, 2025 is required.

NOW, THEREFORE, BE IT RESOLVED by the City Council of the City of Des Moines, Iowa, that the public hearing for consideration of conveyance of the Property to Polk County as described above, be and is hereby opened and continued to August 18, 2025, at 5:00p.m. in the City Council Chambers, City Hall, 400 Robert D. Ray Drive, Des Moines, Iowa.



Roll Call Number

25-1080

Agenda Item Number

56

43

Date August 4, 2025

Moved by Mandelbaum to adopt.

Second by Gatto.

APPROVED AS TO FORM:

/s/ Glenna K. Frank

Glenna K. Frank, Deputy City Attorney

COUNCIL ACTION	YEAS	NAYS	PASS	ABSENT
BOESEN	✓			
COLEMAN	✓			
GATTO	✓			
MANDELBAUM	✓			
SIMONSON	✓			
VOSS	✓			
WESTERGAARD	✓			
TOTAL	7			

MOTION CARRIED

APPROVED

Connie Boesen

Mayor

CERTIFICATE

I, Laura Baumgartner, City Clerk of said City hereby certify that at a meeting of the City Council of said City of Des Moines, held on the above date, among other proceedings the above was adopted.

IN WITNESS WHEREOF, I have hereunto set my hand and affixed my seal the day and year first above written.

Laura Baumgartner

City Clerk

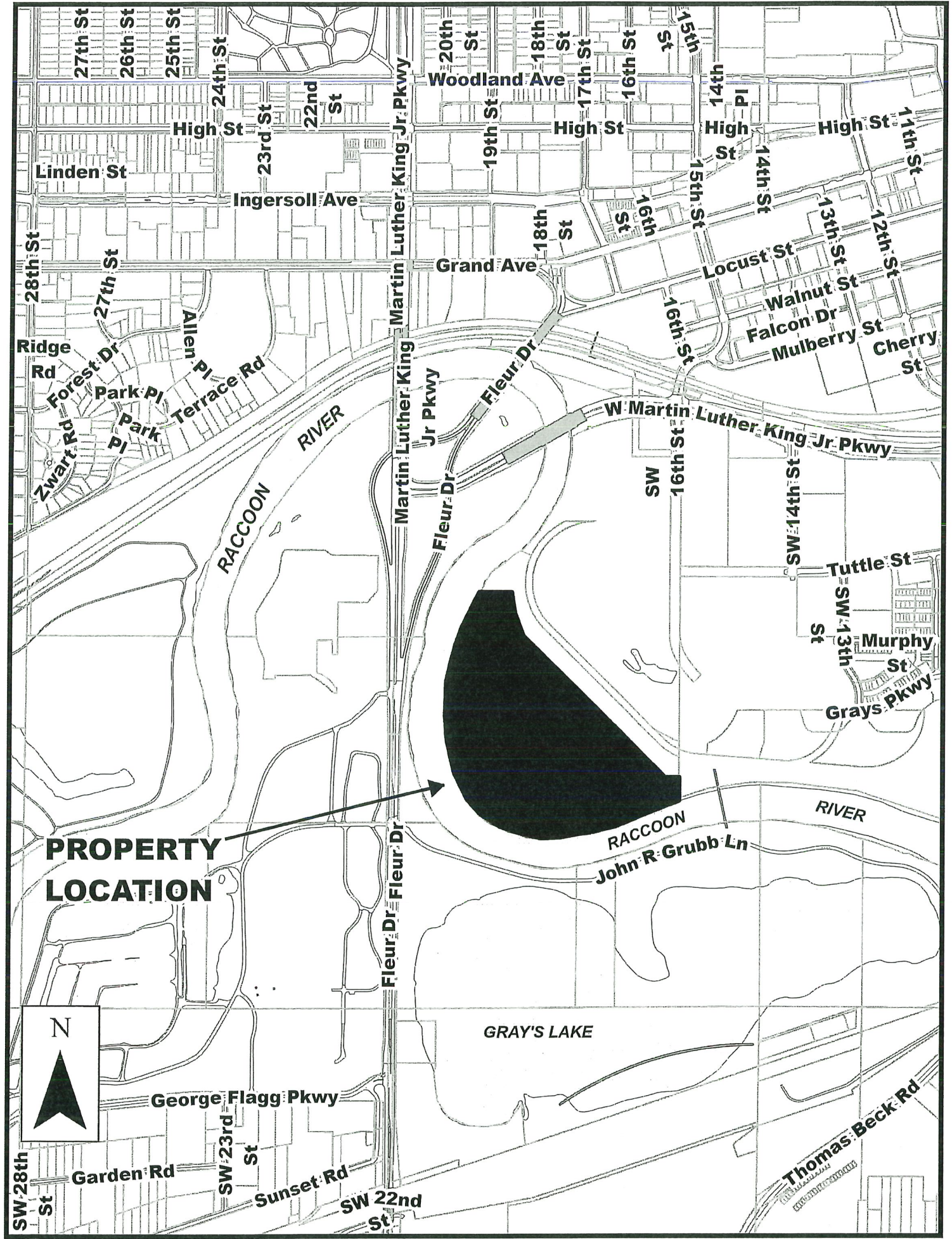

**PROPERTY
LOCATION**



25-0975
25-1080
24 gda13

REGISTER ORDER NO. 13063 ROLL CALL LEGAL BULLETIN BOARD FOLLOW UP

NOTICE OF PROPOSAL TO CONVEY CITY-OWNED REAL ESTATE

NOTICE IS HEREBY GIVEN that the City Council has adopted a resolution relating to a proposal to convey a portion of the excess City property locally known as 1550 Grays Parkway, Des Moines, Iowa, as legally described, subject to a permanent easement upon, over and within said property for the continued use and maintenance of and the right of access to any existing utilities and flood protection levee improvements now in place, and to convey a Permanent Easement for River Infrastructure, a Permanent Easement for Public Ingress and Egress, a Permanent Easement for Storm Sewer and Surface Water Flowage, a Permanent Easement for Recreational Trail and a Temporary Easement for Construction and Construction-Related Activities, all on City-owned property, as legally described below, to Polk County, Iowa for no consideration in accordance with Iowa Code §364.7(3) for the public purpose of creating a public park and recreation area as part of the Iowa Confluence Water Trails project:

FEE SIMPLE CONVEYANCE

AN IRREGULAR SHAPED PORTION OF LOT 2, DICO PLAT NO.1, AN OFFICIAL PLAT, DES MOINES, POLK COUNTY, IOWA, MORE PARTICULARLY DESCRIBED AS FOLLOWS: COMMENCING AT THE SOUTHEASTERLY CORNER OF LOT A IN SAID DICO PLAT NO.1, SAID POINT BEING A NORTHEASTERLY CORNER OF SAID LOT 2; THENCE S00°02'56"W ALONG THE EAST LINE OF SAID LOT 2, A DISTANCE OF 144.38 FEET TO THE POINT OF BEGINNING; THENCE CONTINUING S00°02'56"W ALONG THE EAST LINE OF SAID LOT 2, A DISTANCE OF 165.10 FEET TO THE SOUTHEAST CORNER OF SAID LOT 2; THENCE THE FOLLOWING 22 COURSES ALONG THE BANK OF THE RACCOON RIVER AS LOCATED MARCH OF 2022; S69°45'21"W, 91.78 FEET; THENCE S68°45'08"W, 172.66 FEET; THENCE S67°46'59"W, 145.57 FEET; THENCE S68°33'04"W, 89.46 FEET; THENCE S77°14'09"W, 144.51 FEET; THENCE S80°04'02"W, 249.91 FEET; THENCE S86°49'33"W, 144.00 FEET; THENCE N77°01'29"W, 143.26 FEET; THENCE N71°45'57"W, 163.27 FEET; THENCE N57°05'57"W, 159.89 FEET; THENCE N42°06'21"W, 140.69 FEET; THENCE N25°54'06"W, 215.47 FEET; THENCE N12°50'38"W, 228.64 FEET; THENCE N04°11'48"W, 175.94 FEET; THENCE N01°37'31"E, 127.45 FEET; THENCE N01°33'15"E, 116.48 FEET; THENCE N12°37'20"E, 118.41 FEET; THENCE N14°42'23"E, 150.65 FEET; THENCE N19°42'57"E, 140.90 FEET; THENCE N26°27'08"E, 103.10 FEET; THENCE N26°14'38"E, 92.58 FEET; THENCE N27°07'27"E, 75.40 FEET; THENCE LEAVING THE RIVER BANK N90°00'00"E, A DISTANCE OF 225.44 FEET; THENCE S09°18'39"E, A DISTANCE OF 153.78 FEET; THENCE S20°08'39"E, A DISTANCE OF 170.00 FEET; THENCE S45°34'08"E, A DISTANCE OF 1436.30 FEET; THENCE N89°55'25"E, A DISTANCE OF 102.99 FEET TO THE POINT OF BEGINNING. SAID TRACT CONTAINS 38.00 ACRES

PERMANENT EASEMENT FOR RIVER INFRASTRUCTURE

AN IRREGULAR SHAPED EASEMENT OVER AND ACROSS A PORTION OF GOVERNMENT LOT 12 OF SECTION 8, TOWNSHIP 78 NORTH, RANGE 24 WEST OF THE 5TH P.M., IN DES MOINES, POLK COUNTY, IOWA, ALL MORE PARTICULARLY DESCRIBED AS: COMMENCING AT THE SOUTHWEST CORNER OF PARCEL 2019-147, AS SHOWN ON THE PLAT OF SURVEY RECORDED IN BOOK 17708 AT PAGE 704; THENCE S00°02'56"W ALONG THE SOUTHERLY EXTENSION OF THE WEST LINE OF SAID PARCEL 2019-147, A DISTANCE OF 223.01 FEET; THENCE S69°13'48"W, A DISTANCE OF 76.09 FEET TO THE POINT OF BEGINNING; THENCE S27°10'12"E, A DISTANCE OF 29.88 FEET; THENCE S70°14'24"W, A DISTANCE OF 90.06 FEET; THENCE N27°30'23"W, A DISTANCE OF 25.39 FEET; THENCE N65°46'07"E, A DISTANCE OF 47.85 FEET; THENCE N69°13'48"E, A DISTANCE OF 41.94 FEET TO THE POINT OF BEGINNING. CONTAINING 2,551 SQUARE FEET

PERMANENT EASEMENT FOR PUBLIC INGRESS AND EGRESS

AN IRREGULAR SHAPED PORTION OF LOT 1, LOT A AND LOT 2, DICO PLAT NO. 1, AN OFFICIAL PLAT, DES MOINES, POLK COUNTY, IOWA, MORE PARTICULARLY DESCRIBED AS: BEGINNING AT THE NORTHEAST CORNER OF SAID LOT A; THENCE S00°02'56"W ALONG THE EAST LINE OF SAID LOT A AND SAID LOT 2, A DISTANCE OF 198.54 FEET; THENCE S89°55'25"W, A DISTANCE OF 102.99 FEET; THENCE N45°34'08"W, A DISTANCE OF 621.26 FEET; THENCE N44°25'52"E, A DISTANCE OF 253.16 FEET; THENCE S49°45'09"E, A DISTANCE OF 340.30 FEET; THENCE N00°02'56"E, A DISTANCE OF 229.84 FEET; THENCE N43°06'48"E, A

Chamber, City Hall, 400 Robert D. Ray Drive, Des Moines, Iowa. Persons interested in the proposal will be given the opportunity to express their views at that hearing.

Published in the Des Moines Register on July 23, 2025.

45-1080
56



PO Box 631851 Cincinnati, OH 45263-1851

AFFIDAVIT OF PUBLICATION

Laura Baumgartner
Des Moines, City Of
400 Robert D. Ray Drive
Des Moines IA 50309

STATE OF WISCONSIN, COUNTY OF BROWN

The Des Moines Register and Tribune Company, a newspaper printed and published in the city of Des Moines, Polk County, State of Iowa, and personal knowledge of the facts herein state and that the notice hereto annexed was Published in said newspapers in the issue:

07/23/2025

and that the fees charged are legal.
Sworn to and subscribed before on 07/23/2025

Legal Clerk

Notary, State of WI, County of Brown

My commission expires

Publication Cost:	\$193.60	
Tax Amount:	\$0.00	
Payment Cost:	\$193.60	
Order No:	11486233	# of Copies:
Customer No:	1235896	0
PO #:	LIOW0332102	

THIS IS NOT AN INVOICE!

Please do not use this form for payment remittance.

VICKY FELTY
Notary Public
State of Wisconsin

P013063; \$193.60

NOTICE OF PROPOSAL TO CONVEY
CITY-OWNED REAL ESTATE

NOTICE IS HEREBY GIVEN that the City Council has adopted a resolution relating to a proposal to convey a portion of the excess City property locally known as 1550 Grays Parkway, Des Moines, Iowa, as legally described, subject to a permanent easement upon, over and within said property for the continued use and maintenance of and the right of access to any existing utilities and flood protection levee improvements now in place, and to convey a Permanent Easement for River Infrastructure, a Permanent Easement for Public Ingress and Egress, a Permanent Easement for Storm Sewer and Surface Water Flowage, a Permanent Easement for Recreational Trail and a Temporary Easement for Construction and Construction-Related Activities, all on City-owned property, as legally described below, to Polk County, Iowa for no consideration in accordance with Iowa Code §364.7(3) for the public purpose of creating a public park and recreation area as part of the Iowa Confluence Water Trails project:

FEE SIMPLE CONVEYANCE
AN IRREGULAR SHAPED PORTION OF LOT 2, DICO PLAT NO.1, AN OFFICIAL PLAT, DES MOINES, POLK COUNTY, IOWA, MORE PARTICULARLY DESCRIBED AS FOLLOWS: COMMENCING AT THE SOUTHEAST-ERLY CORNER OF LOT 1 IN SAID DICO PLAT NO.1, SAID POINT BEING A NORTHEASTERLY CORNER OF SAID LOT 2; THENCE S00°02'56"W ALONG THE EAST LINE OF SAID LOT 2, A DISTANCE OF 144.38 FEET TO THE POINT OF BEGINNING; THENCE CONTINUING S00°02'56"W ALONG THE EAST LINE OF SAID LOT 2, A DISTANCE OF 165.10 FEET TO THE SOUTHEAST CORNER OF SAID LOT 2; THENCE THE FOLLOWING 22 COURSES ALONG THE BANK OF THE RACCOON RIVER AS LOCATED MARCH OF 2022: S69°45'21"W, 91.78 FEET; THENCE S68°45'08"W, 172.66 FEET; THENCE S67°44'59"W, 145.57 FEET; THENCE S68°33'04"W, 89.46 FEET; THENCE S77°14'09"W, 144.51 FEET; THENCE S80°04'02"W, 249.91 FEET; THENCE S86°49'33"W, 144.00 FEET; THENCE N77°01'29"W, 143.25 FEET; THENCE N71°12'57"W, 163.27 FEET; THENCE N57°05'57"W, 159.89 FEET; THENCE N42°06'21"W, 140.69 FEET; THENCE N25°54'06"W, 215.47 FEET; THENCE N12°50'38"W, 228.64 FEET; THENCE N04°11'48"W, 175.94 FEET; THENCE N01°33'15"E, 127.45 FEET; THENCE N12°37'20"E, 116.48 FEET; THENCE N14°42'23"E, 150.65 FEET; THENCE N19°42'57"E, 140.90 FEET; THENCE N26°27'08"E, 103.10 FEET; THENCE N26°41'38"E, 92.58 FEET; THENCE N27°07'27"E, 75.40 FEET; THENCE LEAVING THE RIVER BANK N90°00'00"E, A DISTANCE OF 225.44 FEET; THENCE S09°18'39"E, A DISTANCE OF 153.78 FEET; THENCE S20°08'39"E, A DISTANCE OF 170.00 FEET; THENCE S45°34'08"E, A DISTANCE OF 1436.30 FEET; THENCE N89°55'25"E, A DISTANCE OF 102.99 FEET TO THE POINT OF BEGINNING. SAID TRACT CONTAINS 38.00 ACRES

PERMANENT EASEMENT FOR RIVER INFRASTRUCTURE
AN IRREGULAR SHAPED EASEMENT OVER AND ACROSS A PORTION OF GOVERNMENT LOT 12 OF SECTION 8, TOWNSHIP 78 NORTH, RANGE 24 WEST OF THE 5TH P.M., IN DES MOINES, POLK COUNTY, IOWA, ALL MORE PARTICULARLY DESCRIBED AS: COMMENCING AT THE SOUTHWEST CORNER OF PARCEL 2019-147, AS SHOWN ON THE PLAT OF SURVEY RECORDED IN BOOK 17708 AT PAGE 704; THENCE S00°02'56"W ALONG THE SOUTHERLY EXTENSION OF THE WEST LINE OF SAID PARCEL 2019-147, A DISTANCE OF 223.01 FEET; THENCE S69°13'48"W, A DISTANCE OF 76.09 FEET TO THE POINT OF BEGINNING; THENCE S27°10'12"E, A DISTANCE OF 29.88 FEET; THENCE S70°14'24"W, A DISTANCE OF 90.06 FEET; THENCE N27°30'23"W, A DISTANCE OF 25.39 FEET; THENCE N65°46'07"E, A DISTANCE OF 47.85 FEET; THENCE N69°13'48"E, A DISTANCE OF 41.94 FEET TO THE POINT OF BEGINNING. CONTAINING 2,551 SQUARE FEET

PERMANENT EASEMENT FOR PUBLIC INGRESS AND EGRESS
AN IRREGULAR SHAPED PORTION OF LOT 1, LOT A AND LOT 2, DICO PLAT NO. 1, AN OFFICIAL PLAT, DES MOINES, POLK COUNTY, IOWA, MORE PARTICULARLY DESCRIBED AS: BEGINNING AT THE NORTHEAST CORNER OF SAID LOT A; THENCE S00°02'56"W ALONG THE EAST LINE OF SAID LOT A AND SAID LOT 2, A DISTANCE OF 198.54 FEET; THENCE S89°55'25"W, A DISTANCE OF 102.99 FEET; THENCE N45°34'08"W, A DISTANCE OF 621.26 FEET; THENCE N44°25'52"E, A DISTANCE OF 253.16 FEET; THENCE S49°45'09"E, A DISTANCE OF 340.30 FEET; THENCE N00°02'56"E, A DISTANCE OF 229.84 FEET; THENCE N43°06'48"E, A DISTANCE OF 161.10 FEET TO THE EAST LINE OF SAID LOT 1; THENCE S00°02'56"W ALONG SAID EAST LINE, A DISTANCE OF 544.59 FEET TO THE POINT OF BEGINNING. CONTAINING 203,208 SQUARE FEET

PERMANENT EASEMENT FOR STORM SEWER AND SURFACE WATER FLOWAGE
A 30.00 FOOT WIDE EASEMENT

OVER AND ACROSS A PORTION OF LOT 1, DICO PLAT NO.1, AN OFFICIAL PLAT, DES MOINES, POLK COUNTY, IOWA, MORE PARTICULARLY DESCRIBED AS: COMMENCING AT THE SOUTHEAST CORNER OF SAID LOT 1; THENCE N00°02'56"E ALONG THE EAST LINE OF SAID LOT 1, A DISTANCE OF 72.03 FEET TO THE POINT OF BEGINNING; THENCE N39°45'12"W, A DISTANCE OF 122.21 FEET; THENCE N50°14'48"E, A DISTANCE OF 30.00 FEET; THENCE S39°45'12"E, A DISTANCE OF 86.20 FEET TO THE EAST LINE OF SAID LOT 1; THENCE S00°02'56"W ALONG THE EAST LINE OF SAID LOT 1, A DISTANCE OF 46.86 FEET TO THE POINT OF BEGINNING. CONTAINING 3,126 SQUARE FEET

PERMANENT EASEMENT FOR RECREATIONAL TRAIL
AN IRREGULAR SHAPED EASEMENT OVER AND ACROSS A PORTION OF PARCEL 2019-147 IN DES MOINES, POLK COUNTY, IOWA, AS SHOWN ON THE PLAT OF SURVEY RECORDED IN BOOK 17708 AT PAGE 704, ALL MORE PARTICULARLY DESCRIBED AS: COMMENCING AT THE SOUTHWEST CORNER OF SAID PARCEL 2019-147; THENCE N00°02'56"E ALONG THE WEST LINE OF SAID PARCEL 2019-147, A DISTANCE OF 198.35 FEET TO THE POINT OF BEGINNING; THENCE CONTINUING N00°02'56"E ALONG SAID WEST LINE, A DISTANCE OF 147.33 FEET TO THE NORTHWEST CORNER OF SAID PARCEL 2019-147; THENCE SOUTHEASTERLY ALONG THE NORTH LINE OF SAID PARCEL 2019-147 AND ALONG A 414.19 FOOT RADIUS CURVE CONCAVE NORTHERLY, A DISTANCE OF 130.34 FEET, SAID CURVE HAVING A CHORD BEARING OF S76°25'43"E AND A CHORD LENGTH OF 129.80 FEET; THENCE S85°26'37"E ALONG SAID NORTH LINE, A DISTANCE OF 82.30 FEET; THENCE S11°54'57"E, A DISTANCE OF 66.65 FEET; THENCE N78°10'53"E, A DISTANCE OF 15.00 FEET; THENCE S11°54'57"E, A DISTANCE OF 40.00 FEET; THENCE S78°10'53"W, A DISTANCE OF 15.00 FEET; THENCE S11°54'57"E, A DISTANCE OF 24.93 FEET; THENCE SOUTHWESTERLY ALONG A 345.00 FOOT RADIUS CURVE CONCAVE NORTHERLY, A DISTANCE OF 104.40 FEET, SAID CURVE HAVING A CHORD BEARING OF S87°58'58"W AND A CHORD LENGTH OF 104.00 FEET; THENCE N83°29'54"W, A DISTANCE OF 54.25 FEET; THENCE NORTHWESTERLY ALONG A 470.00 FOOT RADIUS CURVE CONCAVE NORTHERLY, A DISTANCE OF 79.37 FEET TO THE POINT OF BEGINNING. SAID CURVE HAVING A CHORD BEARING OF N78°30'39"W AND A CHORD LENGTH OF 79.27 FEET. CONTAINING 31,502 SQUARE FEET.

TEMPORARY EASEMENT FOR CONSTRUCTION AND CONSTRUCTION-RELATED ACTIVITIES
AN IRREGULAR SHAPED EASEMENT OVER AND ACROSS A PORTION OF PARCEL 2019-147 IN DES MOINES, POLK COUNTY, IOWA, AS SHOWN ON THE PLAT OF SURVEY RECORDED IN BOOK 17708 AT PAGE 704, ALL MORE PARTICULARLY DESCRIBED AS: COMMENCING AT THE SOUTHWEST CORNER OF SAID PARCEL 2019-147; THENCE N00°02'56"E ALONG THE WEST LINE OF SAID PARCEL 2019-147, A DISTANCE OF 345.68 FEET TO THE NORTHWEST CORNER OF SAID PARCEL 2019-147; THENCE SOUTHEASTERLY ALONG THE NORTH LINE OF SAID PARCEL 2019-147 AND ALONG A 414.19 FOOT RADIUS CURVE CONCAVE NORTHERLY, A DISTANCE OF 130.34 FEET, SAID CURVE HAVING A CHORD BEARING OF S76°25'43"E AND A CHORD LENGTH OF 129.80 FEET; THENCE S85°26'37"E ALONG SAID NORTH LINE, A DISTANCE OF 82.30 FEET; THENCE S11°54'57"E, A DISTANCE OF 66.65 FEET TO THE POINT OF BEGINNING; THENCE N78°10'53"E, A DISTANCE OF 40.85 FEET; THENCE S11°49'07"E, A DISTANCE OF 40.00 FEET; THENCE S78°10'53"W, A DISTANCE OF 40.78 FEET; THENCE N11°54'57"W, A DISTANCE OF 40.00 FEET TO THE POINT OF BEGINNING. CONTAINING 1,633 SQUARE FEET., AND

AN IRREGULAR SHAPED EASEMENT OVER AND ACROSS A PORTION OF PARCEL 2019-147 IN DES MOINES, POLK COUNTY, IOWA, AS SHOWN ON THE PLAT OF SURVEY RECORDED IN BOOK 17708 AT PAGE 704, ALL MORE PARTICULARLY DESCRIBED AS: BEGINNING AT THE SOUTHWEST CORNER OF SAID PARCEL 2019-147; THENCE N00°02'56"E ALONG THE WEST LINE OF SAID PARCEL 2019-147, A DISTANCE OF 30.66 FEET; THENCE N67°30'04"E, A DISTANCE OF 49.58 FEET; THENCE S49°54'42"E, A DISTANCE OF 38.94 FEET TO THE SOUTH LINE OF SAID PARCEL 2019-147; THENCE S72°00'41"W ALONG THE SOUTH LINE OF SAID PARCEL 2019-147, A DISTANCE OF 79.52 FEET TO THE POINT OF BEGINNING. CONTAINING 2,016 SQUARE FEET.

NOTICE IS FURTHER GIVEN that the City Council of the City of Des Moines, Iowa, will consider the proposed conveyance after a public hearing to be held at 5:00 p.m. on August 4, 2025, in the City Council Chamber, City Hall, 400 Robert D. Ray Drive, Des Moines, Iowa. Persons interested in the proposal will be given the opportunity to express their views at that hearing. Published in the Des Moines Register on July 23, 2025.
July 23 2025
LIOW0332102

25-1080

P013063; \$193.60